

#19457

Jay Flight SLX



Serial #: 1UJBC0AKXT1YF0180
Model: 197MB JAY FLIGHT SLX TT

Model Year: 2026 Dealer Name: HILLTOP CAMPER AND RV
8250 MAIN STREET NE
FRIDLEY, MN 55432
USA

Manufacturer's Suggested Retail Price \$33,653.00

TOTAL AMOUNT DOES NOT INCLUDE STATE AND LOCAL TAXES OR LICENSE FEES. THE PRICE SHOWN ABOVE MAY OR MAY NOT BE REPRESENTATIVE OF THE ACTUAL SELLING PRICE OF SIMILAR RECREATIONAL VEHICLES IN YOUR AREA.

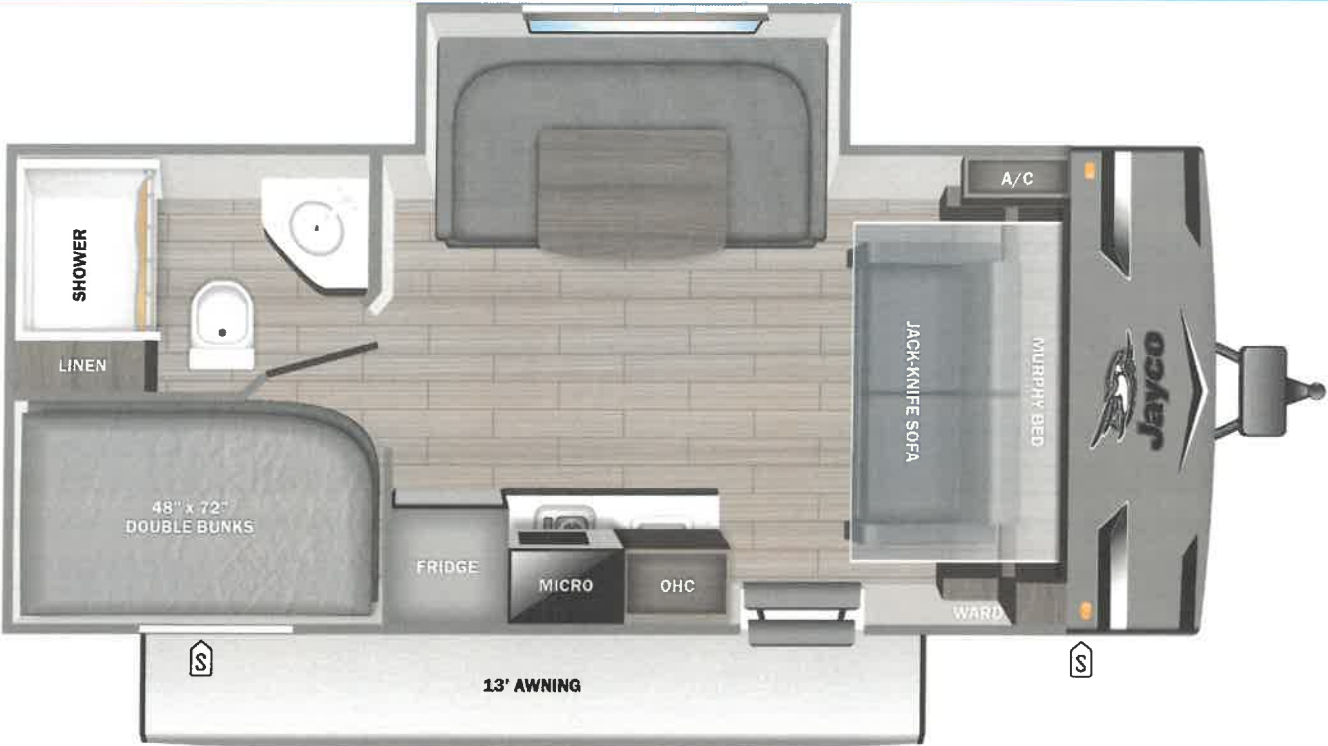

UVW 4318 lbs **Sleeps** **Length** 23' 7"

DIMENSIONS		CAPACITIES	
Exterior height:	114.75"	Fresh water tank (gals.):	30.00
Exterior width:	96.00"	Gray water tank (gals.):	39.00
WEIGHTS		Black water/toilet tank (gals.):	39.00
GVWR:	4995	Propane (lbs.):	20
GAWR (front):	4400	Propane (gals.):	4
GAWR (rear):	0	Water heater (gals.):	0.25
Approx. Gross Cargo Carrying Capacity (GCCC):	677	SEATING & SLEEPING	
TIRES			
Tire size (front):	ST225/75R15E		
Tire size (mid):			
Tire size (rear):			
Tire size (spare):	ST225/75R15E		

Standard Equipment		Optional Equipment	
THE FOLLOWING ITEMS ARE STANDARD ON THIS MODEL		OPTIONAL EQUIPMENT INSTALLED ON THIS VEHICLE BY MANUFACTURER	
STANDARD EXTERIOR EQUIPMENT	STANDARD INTERIOR EQUIPMENT	Base price	26,468.00
- 30-amp service	- 300 lb. rated single bunk beds	USA STANDARDS	n/c
- 8,000 BTU wall mount A/C (single axle models)	- 600 lb. rated double bunk beds	CUSTOMER VALUE PACKAGE	5,250.00
- 13,500 BTU Roof A/C (double axle models)	- Digital TV antenna	OVERLANDER SOLAR PACKAGE	443.00
- Axles with electric, self-adjusting brakes and easy-lube hubs	- Heavy-duty, 75 lb., full-extension, steel ball-bearing drawer guides	13,500 BTU ROOF MOUNTED AC	593.00
- Exterior cable TV hookup	- High rise kitchen faucet	FIBERGLASS SIDEWALL	899.00
- Fully-integrated A-frame	- Marine-grade toilet with foot flush	BLACK SPOKE RIMS	n/c
- Galvanized-steel, impact resistant wheel wells	- Plywood bed platforms		
- Large exterior downspouts	- Queen mattress		
- LP quick connect (outside grill prep) [N/A on Sport Edition]	- Residential-style hidden cabinet door hinges		
- Magnum Truss™ Roof System	- Residential-style kitchen countertops		
- Nitrogen filled radial tires	- Shower curtain with curved shower track (select models)		
- PVC roofing membrane (limited lifetime warranty)	- Solid hardwood cabinet doors with screwed stile construction and hidden hinges		
	- Vinyl flooring throughout		
CUSTOMER VALUE PACKAGE (MANDATORY)			
- 8 cu. ft. 12V refrigerator			
- Backup camera prep			
- Bathroom skylight			
- Bathroom vent			
- Detachable power cord			
- Entry door with window and shade prep			
- Fitted bed sheet			
- G20 dark tinted privacy windows			
- Keyed-Alike™ entry and baggage doors			
- Large folding entry door grab handle			
- LED interior and exterior light			
- Microwave oven			
- On-demand tankless water heater			
- Power awning with LED lights			
- Range hood			
- MoRyde Step Above® entry steps			
- Spare tire with cover			
- Stabilizer jacks			
- Tub/shower surround			
- Window shades			
		UNIT TOTAL	33,653.00
		DEALER INSTALLED OPTIONS	

Some dimensions may be rounded and may vary from the actual dimensions
Weights may be estimated calculations and may vary from the actual weight - refer to the vehicle weight labels for actual weights
Floorplans, features and specifications are subject to change without notice.

