

#19338

Jay Feather Air



Serial #: 1UJBB0AJ3T1HC0058
Model: 15MRB JAY FEATHER AIR TT

Model Year: 2026 Dealer Name: HILLTOP CAMPER AND RV
8250 MAIN STREET NE
FRIDLEY, MN 55432
USA

Standard Equipment

Optional Equipment

THE FOLLOWING ITEMS ARE STANDARD ON THIS MODEL

OPTIONAL EQUIPMENT INSTALLED ON THIS VEHICLE
BY MANUFACTURER

- STANDARD EXTERIOR EQUIPMENT**
- 1.5 in. fresh water drain valve
 - 2 in. Stronghold VBL™ floor with 2 lb. density foam
 - Aerodynamic, rounded front profile with aluminum framing
 - American-made Norco Z-frame with integrated A-frame
 - Battery quick-disconnect
 - Dark-tinted safety-glass windows
 - Exterior TV 120V recept and cable hook-ups
 - Front diamond plating
 - Galvanized steel and impact resistant wheel wells
 - Magnum Truss™ Roof System
 - PVC roofing membrane (limited lifetime warranty)
 - Swing-out entry door assist handle
 - Slide-topper prepped

- CUSTOMER VALUE PACKAGE (MANDATORY)**
- Radial tires with self-adjusting electric brakes
 - 13,500 BTU roof-mounted Quiet Series A/C
 - Vacuum bonded sidewalls w/ interior & exterior Azdel
 - 2 Burner cooktop w/glass stove top cover
 - 20 lb. LP gas bottles with auto-regulator, ABS cover & fill gauge
 - 55 gal. fresh water tank
 - Automotive-style aluminum rims
 - Black tank flush
 - Convection microwave
 - Detachable power cord
 - Inverter pre-wire outlets
 - Max-length power awning with LED light
 - On-demand water heater
 - Power tongue jack
 - Rear back-up camera prep
 - Under-mount spare tire
 - Hidden cabinet hinges
 - Roller shades w/ radiant barrier backer

- STANDARD INTERIOR EQUIPMENT**
- 4 in. high-density dinette cushions with vinyl backing
 - 4 in. soft-touch bunk mats (select models)
 - 75 lb. full extension drawer guides
 - Decorative kitchen backsplash
 - Bathroom skylight
 - Handcrafted, hardwood door/drawer fronts
 - High output auto-ignition LP gas furnace
 - LED lighting throughout
 - Plywood dinette, bed, bunk and shower/tub bases
 - Powered roof vent in bathroom
 - Residential vinyl flooring throughout
 - Seamless countertops throughout
 - Screwed and glued cabinet stiles
 - USB charging ports (multiple locations throughout)
- JAY AIR PACKAGE (Mandatory)**
- 11 cu. ft. 12V fridge
 - 2 in. rear receiver prep
 - App monitored TPMS (compatible w/ most Apple Car Play & Android Auto)
 - Climate Shield (zero to 100 degree tested weather insulation package)
 - Invision kitchen appliance package
 - Solid fold-down step w/ aluminum tread on main entry door step
 - LED smart TV
 - Modern graphics package
 - Stainless steel single basin kitchen sink
 - Overlander 1 solar package: (1) 200W solar panel and 30-amp digital controller
 - Keyed Alike Doors
 - Rear exterior ladder
 - Dark tinted privacy windows
- BAJA PACKAGE**
- Off-road tires
 - Torsion axle
 - Rear 2" receiver hitch
 - Rear diamond plating
 - Rock Solid Jacks
 - Baja graphics

Base price	32,468.00
USA STANDARDS	n/c
CUSTOMER VALUE PACKAGE	6,000.00
JAY AIR PACKAGE	3,750.00
NO BAJA PACKAGE	n/c
OVERLANDER I SOLAR PACKAGE	n/c
13,500 BTU AC	n/c
MAXXAIR VENT FAN	143.00
20# LP GAS BOTTLES	n/c
ROCK SOLID STABILIZER SYSTEM	293.00
TAMARACK TIRES	n/c
2" REAR RECEIVER	188.00

UNIT TOTAL 42,842.00

DEALER INSTALLED OPTIONS

Manufacturer's Suggested Retail Price \$42,842.00

TOTAL AMOUNT DOES NOT INCLUDE STATE AND LOCAL TAXES OR LICENSE FEES. THE PRICE SHOWN ABOVE MAY OR MAY NOT BE REPRESENTATIVE OF THE ACTUAL SELLING PRICE OF SIMILAR RECREATIONAL VEHICLES IN YOUR AREA.

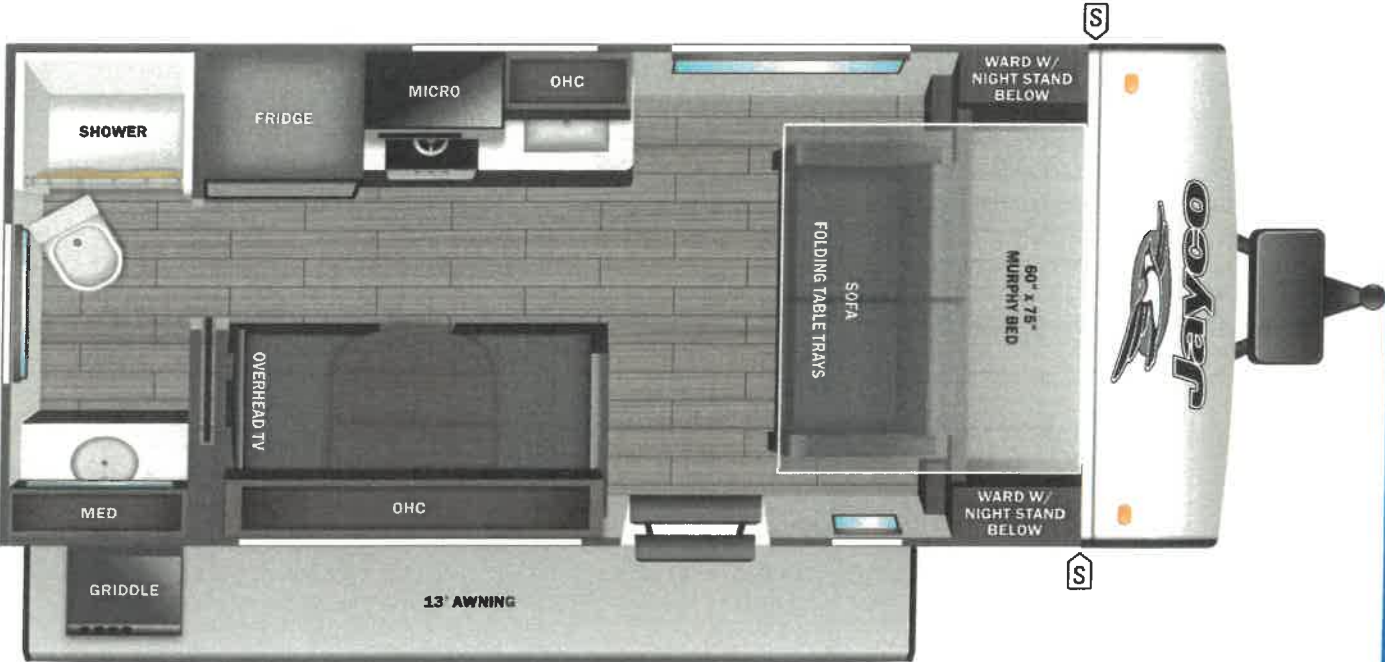

UVW
3779 lbs



Sleeps



Length
20' 1.88"

DIMENSIONS

Exterior height:.....129.63"
Exterior width:.....96.00"

WEIGHTS

GVWR:.....4995
GAWR (front):.....4400
GAWR (rear):.....0
Approx. Gross Cargo Carrying Capacity (GCCC):.....1216

TIRES

Tire size (front):.....ST225/75R15E
Tire size (mid):.....
Tire size (rear):.....
Tire size (spare):.....ST225/75R15E

CAPACITIES

Fresh water tank (gals.):...55.00
Gray water tank (gals.):....38.00
Black water/toilet tank (gals.):.....30.00
Propane (lbs.):.....40
Propane (gals.):.....9
Water heater (gals.):.....0.25

SEATING & SLEEPING

Some dimensions may be rounded and may vary from the actual dimensions
Weights may be estimated calculations and may vary from the actual weight - refer to the vehicle weight labels for actual weights
Floorplans, features and specifications are subject to change without notice.

