

#19180

Jay Flight SLX



Serial #: 1UJBC0AJ3S1YG0569
Model: 175FQ JAY FLIGHT SLX TT

Model Year: 2025 Dealer Name: HILLTOP CAMPER AND RV
8250 MAIN STREET NE
FRIDLEY, MN 55432
USA

Standard Equipment

Optional Equipment

THE FOLLOWING ITEMS ARE STANDARD ON THIS MODEL

OPTIONAL EQUIPMENT INSTALLED ON THIS VEHICLE BY MANUFACTURER

- STANDARD EXTERIOR EQUIPMENT**
- 30-amp service
 - 8,000 BTU wall mount A/C (single axle models)
 - Axles with electric, self-adjusting brakes and easy-lube hubs
 - Exterior cable TV hookup
 - Fully-integrated A-frame
 - Galvanized-steel, impact resistant wheel wells
 - Large exterior downspouts
 - LP quick connect (outside grill prep)(N/A on Sport Edition)
 - Magnum Truss™ Roof System
 - Nitrogen filled radial tires
 - PVC roofing membrane (limited lifetime warranty)

- STANDARD INTERIOR EQUIPMENT**
- 300 lb. rated single bunk beds
 - 600 lb. rated double bunk beds
 - Digital TV antenna
 - Heavy-duty, 75 lb., full-extension, steel ball-bearing drawer guides
 - High rise kitchen faucet
 - Marine-grade toilet with foot flush
 - Plywood bed platforms
 - Queen mattress
 - Residential-style hidden cabinet door hinges
 - Residential-style kitchen countertops
 - Shower curtain with curved shower track (select models)
 - Solid hardwood cabinet doors with screwed stile construction and hidden hinges
 - Vinyl flooring throughout
 - Wood-trimmed mirror in bathroom

- CUSTOMER VALUE PACKAGE (MANDATORY)**
- 8 cu. ft. 12V refrigerator
 - AM/FM/Bluetooth® stereo
 - Backup camera prep
 - Bathroom skylight
 - Bathroom vent
 - Detachable power cord
 - Entry door with window and shade prep
 - Fitted bed sheet
 - G20 dark tinted privacy windows
 - Keyed-Alike™ entry and baggage doors
 - Large folding entry door grab handle
 - LED interior and exterior lights
 - Marine grade exterior stereo speakers
 - Microwave oven
 - On-demand tankless water heater
 - Power awning with LED lights
 - Range hood
 - Solid Step® entry steps
 - Spare tire with cover
 - Stabilizer jacks
 - Tub/shower surround
 - Window shades

Base price	21,368.00
USA STANDARDS	n/c
CUSTOMER VALUE PACKAGE	5,250.00
NO STX EDITION	n/c
OVERLANDER SOLAR PACKAGE	593.00
13,500 BTU ROOF MOUNTED	
AC	593.00
FIBERGLASS SIDEWALL	899.00
BLACK SPOKE RIMS	n/c

UNIT TOTAL 28,703.00

DEALER INSTALLED OPTIONS

Manufacturer's Suggested Retail Price \$28,703.00

TOTAL AMOUNT DOES NOT INCLUDE STATE AND LOCAL TAXES OR LICENSE FEES. THE PRICE SHOWN ABOVE MAY OR MAY NOT BE REPRESENTATIVE OF THE ACTUAL SELLING PRICE OF SIMILAR RECREATIONAL VEHICLES IN YOUR AREA.

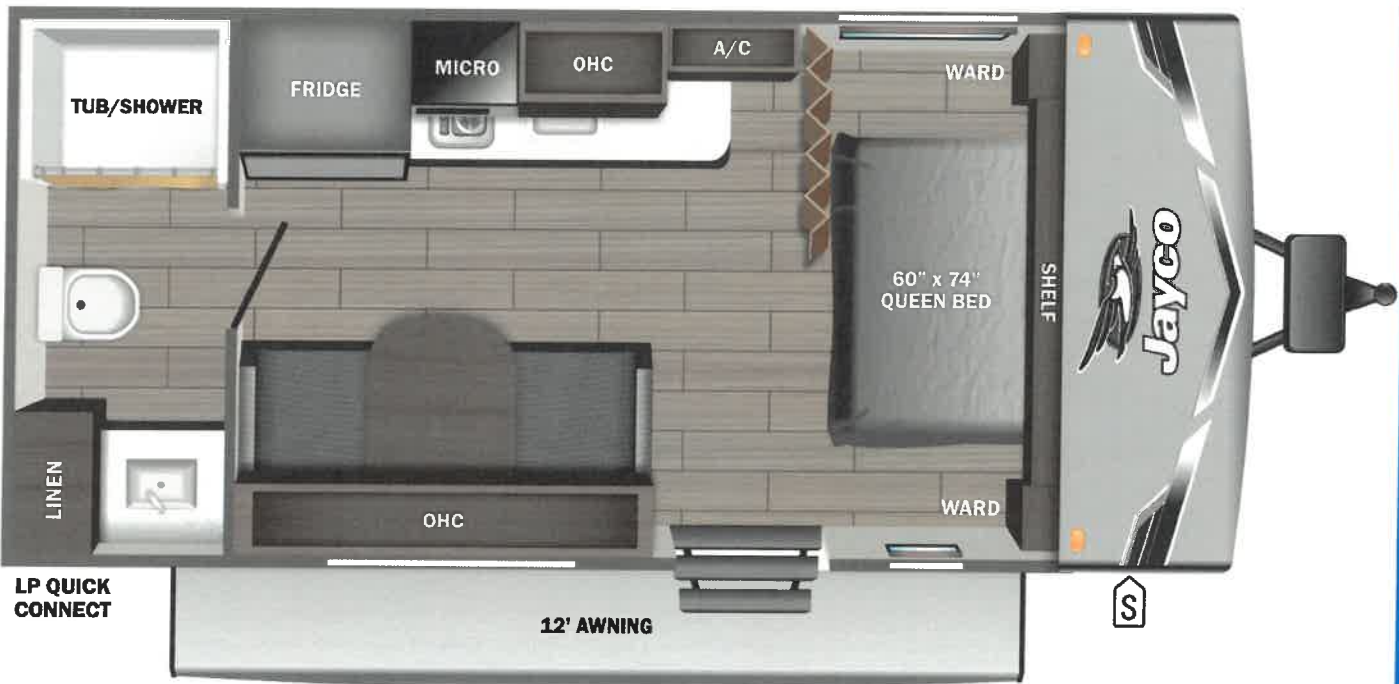

**UVW**
3651 lbs

**Sleeps**

**Length**
21' 11"

DIMENSIONS	
Exterior height:	125.25"
Exterior width:	96.00"
WEIGHTS	
GVWR:	4500
GAWR (front):	4400
GAWR (rear):	0
Approx. Gross Cargo Carrying Capacity(GCCC):	849
CAPACITIES	
Fresh water tank (gals.):	30.00
Gray water tank (gals.):	19.90
Black water/toilet tank (gals.):	19.90
Propane (lbs.):	20
Propane (gals.):	4
Water heater (gals.):	0.25

TIRES	
Tire size (front):	ST225/75R15E
Tire size (mid):	
Tire size (rear):	
Tire size (spare):	ST225/75R15E

SEATING & SLEEPING

Some dimensions may be rounded and may vary from the actual dimensions
Weights may be estimated calculations and may vary from the actual weight - refer to the vehicle weight labels for actual weights
Floorplans, features and specifications are subject to change without notice.

