



Jay Flight SLX



Serial #: 1UJBC0BR2S1Y20315
 Model: 263BHS JAY FLIGHT SLX TT

Model Year: 2025 Dealer Name: HILLTOP CAMPER AND RV
 1240 LAKE SHADY AVE. SOUTH
 ORONOCO, MN 55960
 USA

Standard Equipment

THE FOLLOWING ITEMS ARE STANDARD ON THIS MODEL

Optional Equipment

OPTIONAL EQUIPMENT INSTALLED ON THIS VEHICLE
 BY MANUFACTURER

- STANDARD EXTERIOR EQUIPMENT**
- 30-amp service
 - 8,000 BTU wall mount A/C (single axle models)
 - Axles with electric, self-adjusting brakes and easy-lube hubs
 - Exterior cable TV hookup
 - Fully-integrated A-frame
 - Galvanized-steel, impact resistant wheel wells
 - Large exterior downspouts
 - LP quick connect (outside grill prep)(N/A on Sport Edition)
 - Magnum Truss™ Roof System
 - Nitrogen filled radial tires
 - PVC roofing membrane (limited lifetime warranty)

- STANDARD INTERIOR EQUIPMENT**
- 300 lb. rated single bunk beds
 - 600 lb. rated double bunk beds
 - Digital TV antenna
 - Heavy-duty, 75 lb., full-extension, steel ball-bearing drawer guides
 - High rise kitchen faucet
 - Marine-grade toilet with foot flush
 - Plywood bed platforms
 - Queen mattress
 - Residential-style hidden cabinet door hinges
 - Residential-style kitchen countertops
 - Shower curtain with curved shower track (select models)
 - Solid hardwood cabinet doors with screwed stile construction and hidden hinges
 - Vinyl flooring throughout
 - Wood-trimmed mirror in bathroom

- CUSTOMER VALUE PACKAGE (MANDATORY)**
- 8 cu. ft. 12V refrigerator
 - AM/FM/Bluetooth® stereo
 - Backup camera prep
 - Bathroom skylight
 - Bathroom vent
 - Detachable power cord
 - Entry door with window and shade prep
 - Fitted bed sheet
 - G20 dark tinted privacy windows
 - Keyed-Alike™ entry and baggage doors
 - Large folding entry door grab handle
 - LED interior and exterior lights
 - Marine grade exterior stereo speakers
 - Microwave oven
 - On-demand tankless water heater
 - Power awning with LED lights
 - Range hood
 - Solid Step® entry steps
 - Spare tire with cover
 - Stabilizer jacks
 - Tub/shower surround
 - Window shades

Base price	33,893.00
USA STANDARDS	n/c
CUSTOMER VALUE PACKAGE	5,250.00
OVERLANDER SOLAR PACKAGE	593.00
ELITE PACKAGE	1,943.00
13,500 BTU ROOF MOUNTED AC	n/c
NO 2ND AC	n/c
30 AMP SERVICE	n/c
JACK KNIFE SOFA	n/c

UNIT TOTAL **41,679.00**

DEALER INSTALLED OPTIONS

Manufacturer's Suggested Retail Price \$41,679.00

TOTAL AMOUNT DOES NOT INCLUDE STATE AND LOCAL TAXES OR LICENSE FEES. THE PRICE SHOWN ABOVE MAY OR MAY NOT BE REPRESENTATIVE OF THE ACTUAL SELLING PRICE OF SIMILAR RECREATIONAL VEHICLES IN YOUR AREA.

Stock # 19073

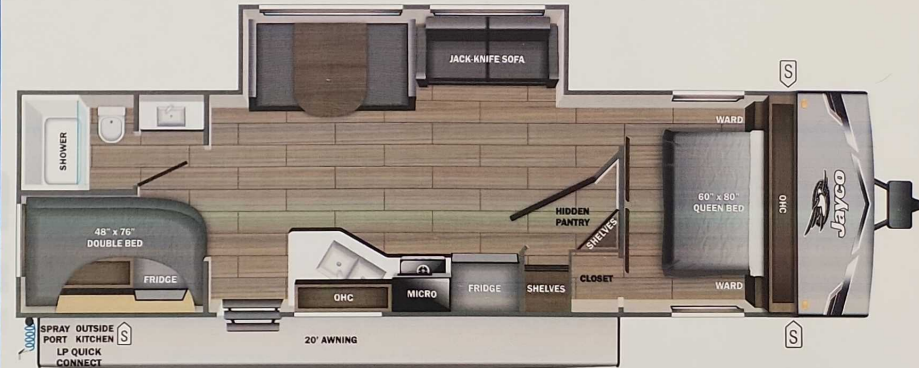

UVW
6687 lbs



Sleeps



Length
32' 6.75"

DIMENSIONS

Exterior height:	133.00"
Exterior width:	96.00"
WEIGHTS	
GVWR:	7600
GAWR (front):	3500
GAWR (rear):	3500
Approx. Gross Cargo Carrying Capacity (GCCC):	913

CAPACITIES

Fresh water tank (gals.):	52.00
Gray water tank (gals.):	71.25
Black water/toilet tank (gals.):	39.00
Propane (lbs.):	4.0
Propane (gals.):	9
Water heater (gals.):	0.25

SEATING & SLEEPING

TIRES

Tire size (front):	ST205/75R14D
Tire size (mid):	ST205/75R14D
Tire size (rear):	ST205/75R14D
Tire size (spare):	ST205/75R14D

Some dimensions may be rounded and may vary from the actual dimensions

Weights may be estimated calculations and may vary from the actual weight - refer to the vehicle weight labels for actual weights

Floorplans, features and specifications are subject to change without notice.

