



Eagle SLE



Serial #: 1UJCA0BS9S1G30138
 Model: 28BHU EAGLE SLE FW

Model Year: 2025 Dealer Name: HILLTOP CAMPER AND RV
 7324 NOVOTNY ROAD
 BRAINERD, MN 56401
 USA

Manufacturer's Suggested Retail Price \$57,992.00

TOTAL AMOUNT DOES NOT INCLUDE STATE AND LOCAL TAXES OR LICENSE FEES. THE PRICE SHOWN ABOVE MAY OR MAY NOT BE REPRESENTATIVE OF THE ACTUAL SELLING PRICE OF SIMILAR RECREATIONAL VEHICLES IN YOUR AREA.

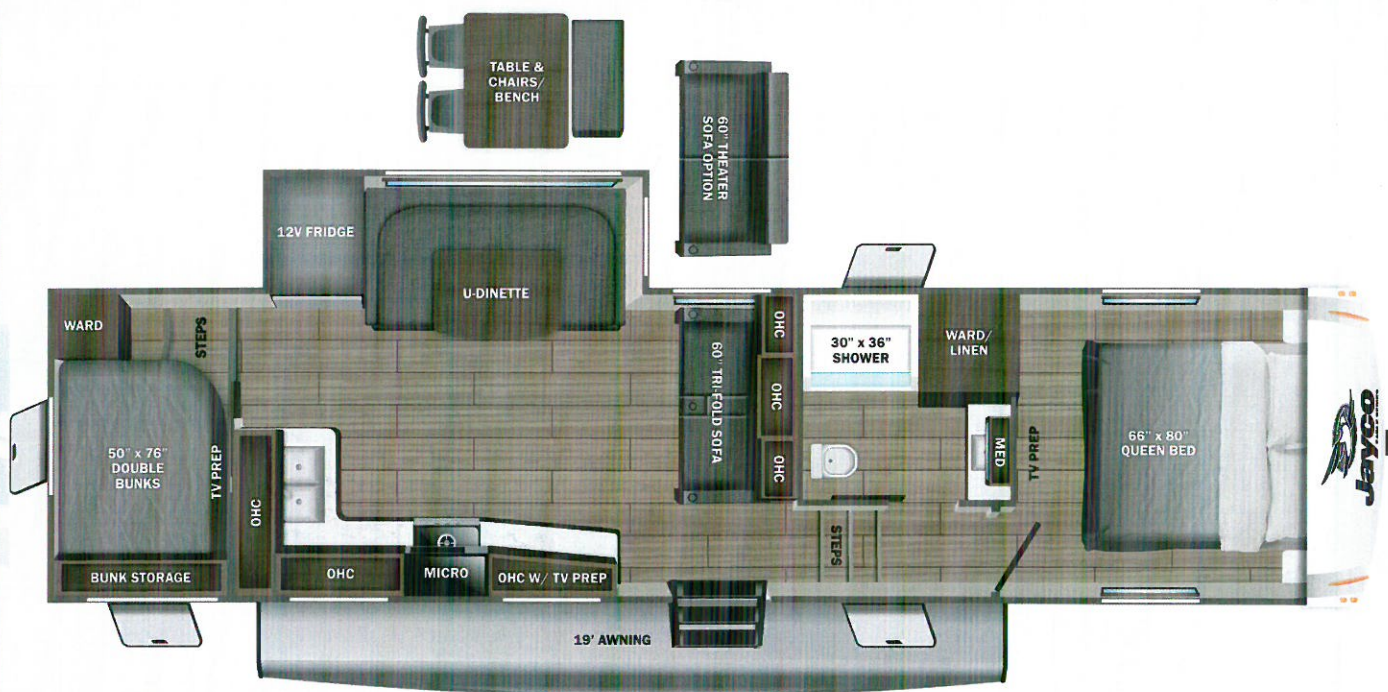

Standard Equipment

Optional Equipment

THE FOLLOWING ITEMS ARE STANDARD ON THIS MODEL

OPTIONAL EQUIPMENT INSTALLED ON THIS VEHICLE BY MANUFACTURER

- Standard Exterior Equipment**
- 1.5 in. fresh water drain valve
 - 5 in. Magnum Truss™ w/ Plywood Roof Decking
 - Alpha Ply TPO Roof membrane (thickest roof membrane w/ Limited Lifetime Warranty)
 - 50-amp detachable power cord
 - LED lighting in pass through area
 - Auto-grade vinyl graphics
 - Automotive style front cap with max turn radius
 - Black tank flush
 - Additional Dump Valve @ Termination
 - Fully enclosed and heated underbelly (ducted)
 - 30,000 BTU furnace
 - Double layer fiberglass batt insulation in ceiling and floor
 - PEX plumbing
 - Dual 30 lb. LP bottles
 - Factory installed roof ladder prep
 - HELIX Cooling System™ (industry exclusive):
 - * Jayco exclusive insulated dual duct design
 - * Directional and closeable A/C vents
 - * Larger return air vents with user accessible filters
 - Independent satellite and cable hookups (pass through storage areas)
 - LED exterior lighting package
 - LP quick connect for gas griddle
 - Metal slam latch baggage doors
 - Nitrogen filled undermount spare tire
 - Quick connect water connections (door side hot/cold)
 - Stronghold VBL™ walls (laminated sidewalls, rear walls and slide out walls)
 - Overlander Solar Prep (Roof)
 - 15 in. wheels/tires
 - Dexter® Axles with NEV-R-Adjust® brakes and E-Z Lube® hubs
 - Dexter® rubberized suspension

- Standard Interior Equipment**
- 2-piece high gloss bathroom surround
 - Teak Seat Shower Prep
 - 5/8 in. tongue-and-groove plywood flooring
 - 75 lb. full extension drawer guides
 - Bathroom skylight
 - Bedroom TV, SAT, CABLE prep
 - C.P.A.P. prepped bedroom (both sides)
 - Gas strutted under bed storage
 - Handcrafted and glazed door/drawer fronts
 - Medicine cabinet with custom framed mirror
 - Matte black kitchen faucet with pull-out sprayer
 - Porcelain foot flush toilet
 - Residential vinyl flooring throughout (NO CARPET)
 - Tri-fold hide-a-bed sofa with residential memory foam sleep surface (select models)
 - USB 12v charging ports (multiple locations throughout)
 - Water Shutoff at all faucet locations
 - 100% No Floor Vents
 - Blackout pleated shades throughout
- Customer Value Package (Mandatory)**
- Residential 60 in. x 80 in. queen mattress
 - Backup Camera prep (rear)
 - 8 cu.ft. 12V refrigerator
 - Microwave with vent
 - Black and stainless 17 in. range
 - Magnetic Catches for all Drawers & Doors
 - Inverter pre-wire throughout (multiple locations)
 - 15K BTU "Whisper Quiet" A/C & bedroom A/C Prep
 - Interior Bluetooth audio connect w/ MB Quart speakers
 - 50AMP Service w/ dual A/C ducts
 - 60K on-demand water heater w/mixing tank
 - Custom machined aluminum rims
 - Electric patio awning with LED lighting
 - Keyed-a-like lock system
 - MORyde® step above entrance step
 - Bathroom power vent
 - Rear 2" towing receiver w/ 4 pin wire harness
 - Winegard air 360 antenna w/ router prep

Base price	50,993.00
USA STANDARDS	n/c
CUSTOMER VALUE PACKAGE	6,263.00
OVERLANDER I SOLAR PACKAGE	443.00
ROOF VENT IN BEDROOM	n/c
ELECTRIC REAR STABILIZER JACKS	293.00
DINETTE	n/c
TRI-FOLD SOFA	n/c

UNIT TOTAL **57,992.00**

DEALER INSTALLED OPTIONS

UVW
8612 lbs

Sleeps

Length
34' 6.38"

DIMENSIONS

Exterior height:.....155.50"

Exterior width:.....96.75"

WEIGHTS

GVWR:.....9995

GAWR (front):.....5145

GAWR (rear):.....5145

Approx. Gross Cargo Carrying Capacity (GCCC):.....1383

TIRES

Tire size (front):.....ST225/75R15E

Tire size (mid):.....

Tire size (rear):.....ST225/75R15E

Tire size (spare):.....ST225/75R15E

CAPACITIES

Fresh water tank (gals.):...51.00

Gray water tank (gals.):...82.00

Black water/toilet tank (gals.):.....45.00

Propane (lbs.):.....60

Propane (gals.):.....14

Water heater (gals.):.....0.25

SEATING & SLEEPING

Some dimensions may be rounded and may vary from the actual dimensions

***Weights may be estimated calculations and may vary from the actual weight

- refer to the vehicle weight labels for actual weights***

Floorplans, features and specifications are subject to change without notice.

