

STOCK#18352

Greyhawk



Serial #: 1UJLJCBR8R1MV4267  
 Model: 29MV GREYHAWK MHC  
 VIN#: 1FDXE4FN7RDD48065  
 Model Year: 2024 Dealer Name: HILLTOP CAMPER AND RV  
 7324 NOVOTNY ROAD  
 BRAINERD, MN 56401  
 USA

Manufacturer's Suggested Retail Price \$179,612.00

TOTAL AMOUNT DOES NOT INCLUDE STATE AND LOCAL TAXES OR LICENSE FEES. THE PRICE SHOWN ABOVE MAY OR MAY NOT BE REPRESENTATIVE OF THE ACTUAL SELLING PRICE OF SIMILAR RECREATIONAL VEHICLES IN YOUR AREA.

Standard Equipment

Optional Equipment

THE FOLLOWING ITEMS ARE STANDARD ON THIS MODEL AT NO EXTRA CHARGE

OPTIONAL EQUIPMENT INSTALLED ON THIS VEHICLE BY MANUFACTURER

- STANDARD EXTERIOR EQUIPMENT**
- Ford® E-450 chassis
  - GVWR- 14,500 lb.
  - GCWR- 22,000 lb.
  - 7.3L V-8 325 HP engine with 450 ft.-lb. torque
  - 6-speed TorqShift® series transmission with overdrive
  - 210-amp alternator
  - Catalytic converter theft deterrent
  - E-rated highway tires- LT225/75R16
  - Tire pressure monitoring system (TPMS)
  - Power anti-lock brakes with power steering
  - 7,500 lb. hitch with 750 lb. tongue capacity and 7-pin plug
  - 12V chassis battery
  - 55 gal. fuel tank
  - StrongholdVBL™ roof, floor and sidewalls
  - Bead-foam insulation (R-24 max roof, R-9 max floor, R-5 max walls)
  - One-piece, seamless, fiberglass front cap
  - Automotive-bonded, panoramic window in front cap with power shade
  - One-piece, seamless, crowned fiberglass roof
  - Fiberglass running boards and transition wings
  - Fiberglass exterior walls with vinyl graphics
  - Remote keyless cab entry
  - Entrance door with industry's largest travel-view window
  - Electric-powered entrance step with integrated house battery compartment
  - (2) high-output, marine-grade exterior speakers
  - Slideout awning(s)
  - Lockable storage compartments with slam latches
  - Third brake light
  - Roof ladder (27U, 29MV, 31F)
  - 4 in. bumper tube with sewer hose storage
  - Prep for satellite dish
  - Cable TV hookup with RG-6 coax
  - Winegard 2.0 Wi-Fi/4G antenna
  - 4,000W generator with auto-gen start
  - 200W solar panel with dual controller with second house battery
  - 12V house battery
  - Transfer switch with reverse polarity protection
  - 30-amp electrical service
  - 16.5 gal. propane tank (56 lb.)
  - LP quick-connect hookup
  - Heated holding tanks (12V pads)
  - Exterior utility center
  - Winterization drain system
  - Black tank flush
  - Outside shower
  - 12V demand water pump
  - Water filtration system

- STANDARD INTERIOR EQUIPMENT**
- Swivel driver and passenger seats
  - Chrome, heated, remote-controlled, side-view mirrors
  - Tilt steering wheel
  - Power windows and door locks
  - Cruise control
  - Hill start assist
  - Electronic stability control
  - Traction control
  - Auxiliary start switch
  - Driver and passenger airbags
  - Privacy curtain for cab area
  - Overhead bunk with 750 lb. capacity and safety net
  - BMPRO total coach control system with wall-mounted touchscreen and mobile app
  - 84 in. interior ceiling height with padded vinyl ceiling
  - High-intensity, recessed LED ceiling lights
  - LED-lit hardwood fascia
  - Hardwood cabinet doors and drawer fronts
  - Ball-bearing drawer guides
  - Interior command center
  - Blackout night roller shades
  - 30,000 BTU auto-ignition furnace
  - Electric fireplace (30Z)
  - 6 gal. gas/electric DSI auto-ignition water heater
  - Jayco-exclusive, easy-operation legless dinette table
  - 2-point lap safety belts in all designated seating locations
  - Car seat tethers (select floorplans)
  - 10 cu. ft. 12V refrigerator
  - Furrion® all-in-one cooktop and oven
  - Residential-size microwave
  - Recessed stainless steel kitchen sink with cutting board and grate sink cover
  - LED-lit pressed countertops
  - Flip-up countertop extension (select models)
  - Decorative kitchen backsplash
  - Pop-up charging station with 120V outlet and USB plugs
  - Shower with decorative surround, glass door, skylight and light
  - Stainless steel bathroom sink
  - Toilet with foot flush
  - Powered roof vent in bathroom with wall switch
  - Walk-around queen-size bed with bedspread and nightstands (king size in 27U)
  - USB port and wireless charging in nightstands
  - Under-bed storage (select models)
  - Large wardrobes
  - Bunks with industry-exclusive 300 lb. capacity each (31F)
  - Wall-mounted tablet holder in each bunk (31F)
  - Smoke alarm
  - Carbon monoxide detector
  - Fire extinguisher

Base price	169,043.00
MODERN FARMHOUSE	443.00
PRIMO GRAPHICS PACKAGE	n/c
USA STANDARDS	n/c
24 FD E45 14500 158"	
7.3L WHITE RC10	n/c
CUSTOMER VALUE PACKAGE	9,000.00
BEDROOM TV	383.00
15,000 BTU AC WITH HEAT PUMP	n/c
10 CU. FT. 12V REFRIGERATOR	n/c
STEEL RIMS	n/c
STANDARD HOUSE BATTERY	n/c
THEATER SEATING SOFA	743.00

UNIT TOTAL 179,612.00

DEALER INSTALLED OPTIONS

- CUSTOMER VALUE PACKAGE**
- JRide® Plus: Computer-balanced driveshaft, Koni® FSD shocks, heavy-duty rear stabilizer bar, standard front stabilizer bar, Hellwig® helper springs, rubber isolation mounts
  - Automatic hydraulic leveling jacks
  - Frameless windows
  - Electric patio awning with LED lights
  - 15,000 BTU A/C with heat pump
  - 1,000W inverter
  - Sony® infotainment center with Apple® CarPlay™ and Android Auto™
  - Backup and side-view cameras
  - LED HD Smart TV in living area

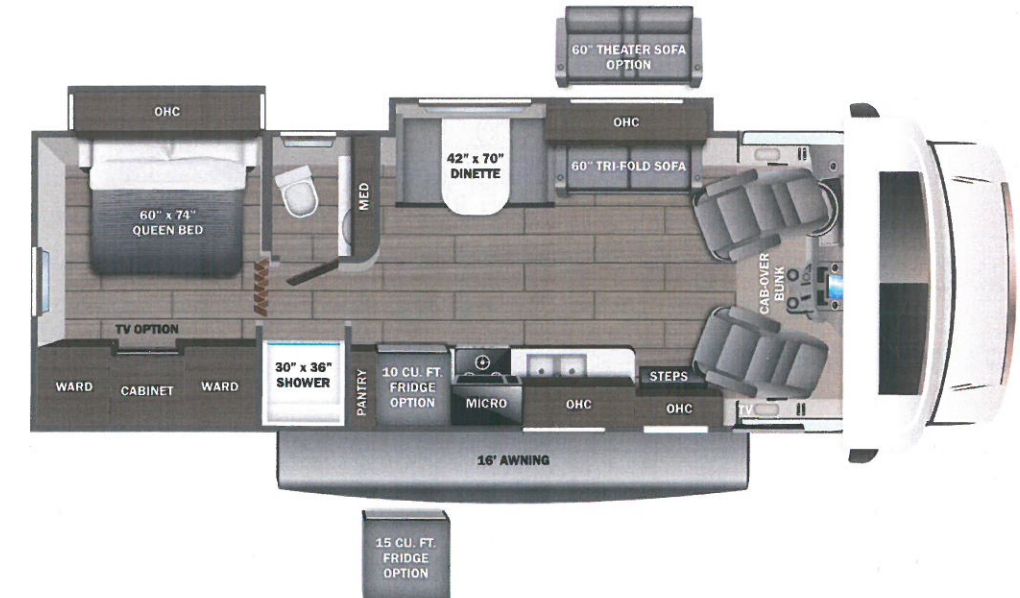

DIMENSIONS

Exterior height:.....140.00"  
 Exterior width:.....100.00"

CAPACITIES

Fresh water tank (gals.):...47.00  
 Gray water tank (gals.):...41.00  
 Black water/toilet tank (gals.):.....32.00  
 Propane (lbs.):.....56  
 Propane (gals.):.....13  
 Water heater (gals.):.....6.00

TIRES

Tire size (front):.....LT225/75R16E  
 Tire size (mid):.....  
 Tire size (rear):.....LT225/75R16E

\*\*\*Some dimensions may be rounded and may vary from the actual dimensions\*\*\*  
 \*\*\*Weights may be estimated calculations and may vary from the actual weight - refer to the vehicle weight labels for actual weights\*\*\*  
 Floorplans, features and specifications are subject to change without notice.

