



Jay Flight



Serial #: 1UJBC0BT8R17T0334
 Model: 324BDS JAY FLIGHT TT

Model Year: 2024 Dealer Name: HILLTOP CAMPER AND RV
 1240 LAKE SHADY AVE. SOUTH
 ORONOCO, MN 55960
 USA

Manufacturer's Suggested Retail Price \$51,393.00

TOTAL AMOUNT DOES NOT INCLUDE STATE AND LOCAL TAXES OR LICENSE FEES. THE PRICE SHOWN ABOVE MAY OR MAY NOT BE REPRESENTATIVE OF THE ACTUAL SELLING PRICE OF SIMILAR RECREATIONAL VEHICLES IN YOUR AREA.

Stock # 18111

Standard Equipment

Optional Equipment

THE FOLLOWING ITEMS ARE STANDARD ON THIS MODEL AT NO EXTRA CHARGE

OPTIONAL EQUIPMENT INSTALLED ON THIS VEHICLE BY MANUFACTURER

- EXTERIOR**
 20 lb. LP bottles with cover (2)
 Enclosed and heated underbelly
 Axles with electric, self-adjusting brakes and sty-lube hubs
 I-Class™ cambered structural steel I-beams
 5/8 in. tongue-and-groove plywood floor decking
 Magnum Truss™ Roof system with plywood decking
 PVC roofing membrane (limited lifetime warranty)
 Large exterior downspouts
 Galvanized steel, impact-resistant wheel wells
 30-amp service
 Front diamond plate
 Exterior TV mount and bracket
 LP quick connect (outside gas grill prep)

- INTERIOR**
 - 81 in. ceiling height
 - 8 cu. ft. 12V refrigerator
 - Shower/tub surround
 - Solid hardwood cabinet doors
 - J-Steel™ jackknife sofa with armrest & cup holders (most models)
 - Vinyl flooring throughout (including slide floors)
 - Window shades
 - Residential-style kitchen countertops
 - Heavy-duty, 75 lb., full-extension, steel ball-bearing drawer guides
 - USB charging station
 - Queen mattress
 - Plywood bed platforms
 - Main bed struts
 - 300 lb. rated bunk beds (select models)
 - 600 lb. rated bunk beds (double bunks)
 - Privacy curtains in bunk areas (select models)
 - Vented bunk windows (select models)
 - 4 in. thick bunk mats (select models)
 - Wooden bedroom doors (select models)
 - Shower curtain with curved shower track (select models)

- CUSTOMER VALUE PACKAGE (Mandatory)**
 - Black tank flush
 - Overlander 1 Solar Package: (1) 200W solar panel and 30-amp digital controller
 - Large main entry door grab handle
 - Solid Step® entry steps (N/A 380DQS)
 - On-demand tankless water heater
 - Goodyear® Endurance® tires (made in the USA)
 - Outside shower
 - Power tongue jack
 - Spare tire with cover
 - Power awning with LED lights
 - Marine grade exterior speakers
 - Keyed-Alike™ entry and baggage doors
 - Bathroom power vent
 - Bathroom skylight
 - 13.5K BTU A/C
 - AM/FM/Bluetooth® stereo
 - Backup and side view camera prep
 - Bathroom medicine cabinet
 - Detachable power cord
 - Fitted bed sheet
 - Friction hinge entry door with window and shade prep
 - G20 dark tinted privacy windows
 - Inverter pre-wire
 - LED exterior and interior lights
 - Marine grade exterior speakers
 - Microwave oven
 - One-piece front fiberglass exterior wall
 - Oven with 3-burner recessed cooktop with glass cover
 - Flange hood
 - Rock-Solid Stabilizer System
 - Seamless countertops
 - Sink cover

Base price	44,514.00
USA STANDARDS	n/c
CUSTOMER VALUE PACKAGE	5,250.00
15,000 BTU AC	300.00
NO 2ND AC	n/c
50 AMP SERVICE	443.00
METAL SIDEWALL	n/c
BLACK SPOKE RIMS	n/c
20# LP GAS BOTTLES	n/c
ROOF LADDER	188.00
HIDE-A-BED SOFA	593.00
REAR JACK KNIFE SOFA WITH FOLDING BUNK	105.00

UNIT TOTAL **51,393.00**

DEALER INSTALLED OPTIONS

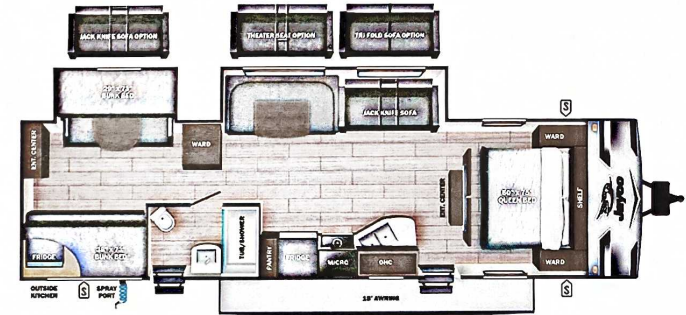

UVW
7861 lbs



Sleeps



Length
36' 3.75"

DIMENSIONS

Exterior height:.....134.75"
 Exterior width:.....96.00"

WEIGHTS

GVWR:.....9000
 GAWR (front):.....4400
 GAWR (rear):.....4400
 Approx. Gross Cargo Carrying Capacity (GCCC):.....1139

TIRES

Tire size (front):.....ST225/75R15E
 Tire size (mid):.....
 Tire size (rear):.....ST225/75R15E
 Tire size (spare):.....ST225/75R15E

CAPACITIES

Fresh water tank (gals.):...52.00
 Gray water tank (gals.):...32.50
 Black water/toilet tank (gals.):...39.00
 Propane (lbs.):.....40
 Propane (gals.):.....9
 Water heater (gals.):.....0.00

SEATING & SLEEPING

Some dimensions may be rounded and may vary from the actual dimensions

***Weights may be estimated calculations and may vary from the actual weight

- refer to the vehicle weight labels for actual weights***

Floorplans, features and specifications are subject to change without notice.

