



Jay Feather

Serial #: 1UJB0BL1R1J10170
 Model: 21MML JAY FEATHER TT



Model Year: 2024 Dealer Name: HILLTOP CAMPER AND RV
 1240 LAKE SHADY AVE. SOUTH
 ORONOCO, MN 55960
 USA

Manufacturer's Suggested Retail Price \$51,053.00

TOTAL AMOUNT DOES NOT INCLUDE STATE AND LOCAL TAXES OR LICENSE FEES. THE PRICE SHOWN ABOVE MAY OR MAY NOT BE REPRESENTATIVE OF THE ACTUAL SELLING PRICE OF SIMILAR RECREATIONAL VEHICLES IN YOUR AREA.

Stock # 179 31

Standard Equipment

THE FOLLOWING ITEMS ARE STANDARD ON THIS MODEL
 AT NO EXTRA CHARGE

- EXTERIOR**
- Aerodynamic, rounded front profile with aluminum framing
 - 17" height VRL™, w/ale with double sided Azdel composite (sidepods, rear walls and slide out boxes)
 - 2 in. Stronghold VRL™ floor with 2 lb density foam
 - Keyed Alike™ lock system
 - Magnum Truss™ Roof System with limited lifetime warranty
 - American-made Norco Z-frame with integrated A-frame
 - Dark-tinted safety-glass windows
 - Marine grade exterior speakers with blue LED accent lighting
 - 30-amp service
 - Bumper-mount bracket for 17 in. griddle
 - Outdoor camp kitchen with galvanized steel bases (select models)
 - Battery quick disconnect
 - Exterior TV bracket with 120V and cable hook-ups
 - 1.5 in. Fresh water drain valve
 - Automotive-style aluminum rims
 - Factory installed rear roof ladder
 - Front and rear decorative cap (select models)
 - Mounted ladder bracket (or pre-wired slide and rear back-up prep)
 - Swing-out entry door assist handle
- JAY SPORT PACKAGE (Mandatory)**
- LCI Solid Step fold-down aluminum tread steps on main entry door
 - Modern graphics package with dual-colored sidewall graphics
 - Solar Package: (1) 200W solar panel and (3) 30 amp controller
 - Corimate Shield zero to 100 degree tested weather insulation package)
 - 32 in. or 39 in. LED Smart TV
 - Drying rack/sink cover
 - MAXXAIR® power roof vent (main living area)
 - Dual-hinge 10 cu. ft. 12V fridge

Optional Equipment

OPTIONAL EQUIPMENT INSTALLED ON THIS VEHICLE
 BY MANUFACTURER

- INTERIOR**
- LED lighting throughout
 - Fabricated, hardwood door/drawer fronts
 - Beveled solid vinyl floor (no grout)
 - Plywood dinette, bed, bunk and shower/tub bases
 - 75 lb. full extension drawer guides
 - Residential style kitchen countertops
 - Decorative backsplash
 - 4 in. high-density drette cushions with vinyl backing
 - 4 in. Teddy Bear soft-touch bunk mats (select models)
 - USB charging ports (multiple locations throughout)
 - Bathroom skylight
 - Decorative roller shades with reflective backer
 - Residential residential queen beds (60 x 78 in. in Murphy bed models)
 - Directional and closable A/C vents (select models)
 - Foldable and portable dinette table with solid steel base
 - Gas strolled under bed storage (most models)
 - Hidden-hinged cabinet doors
 - High output auto-ignition LP gas furnace
 - Powered roof vents in bathroom and main bedroom (most models)
- CUSTOMER VALUE PACKAGE (Mandatory)**
- American-made nitro-filled Goodyear® radial tires with self-adjusting electric brakes
 - Automotive-style aluminum rims
 - 20 lb. LP gas bottles with auto-regulator and ABS cover
 - 13,500 BTU roof-mounted A/C
 - Spare tire
 - Detachable power cord
 - Max-length power awning with LED light
 - Black tank flush
 - Dishes/stove
 - Power storage
 - Rock Solid Stabilizer System
 - On-demand water heater
 - 55 gal. Fresh water tank
 - AM/FM/Bluetooth stereo with roof-mounted speakers
 - Side and rear back-up camera prep
 - Inverter pre-wire (2 bedroom nightstand outlets, main TV and outlet for outside kitchen fridge)

Base price	42,503.00
USA STANDARDS	n/c
CUSTOMER VALUE PACKAGE	5,250.00
JAY SPORT PACKAGE	3,000.00
OVERLANDER I SOLAR PACKAGE	n/c
NO JAYCOMMAND CONTROL SYSTEM	n/c
15,000 BTU A/C	300.00
20# LP GAS BOTTLES	n/c
ROOF LADDER (STD)	n/c

UNIT TOTAL **51,053.00**

DEALER INSTALLED OPTIONS

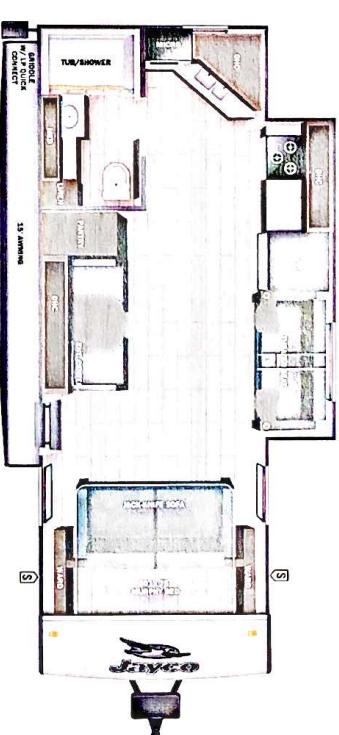

UWW 5210 lbs **Sleeps** **Length** 25' 11.88"

DIMENSIONS

Exterior height:.....127.75"
 Exterior width:.....95.50"

WEIGHTS

GVWR:.....6500
 GAWR (front):.....3500
 GAWR (rear):.....3500
 Approx. Gross Cargo Carrying Capacity(GCCC):.....1290

TIRES

Tire size (front):.....ST205/75R14D
 Tire size (mid):.....
 Tire size (rear):.....ST205/75R14D
 Tire size (spare):.....ST205/75R14D

CAPACITIES

Fresh water tank (gals.):.....55.00
 Gray water tank (gals.):.....30.50
 Black water/toilet tank (gals):.....30.50
 Propane (lbs.):.....40
 Propane (gals.):.....9
 Water heater (gals.):.....0.25

SEATING & SLEEPING

Some dimensions may be rounded and may vary from the actual dimensions
 Weights may be estimated calculations and may vary from the actual weight - refer to the vehicle weight labels for actual weights
 Floorplans, features and specifications are subject to change without notice.

