



# Jay Feather



Serial #: 1UJBB0AK4P1JM0057  
 Model: 199MBS JAY FEATHER TT

Model Year: 2023 Dealer Name: HILLTOP CAMPER AND RV  
 1240 LAKE SHADY AVE. SOUTH  
 ORONOCO, MN 55960  
 USA

**Manufacturer's Suggested Retail Price \$50,147.00**

TOTAL AMOUNT DOES NOT INCLUDE STATE AND LOCAL TAXES OR LICENSE FEES. THE PRICE SHOWN ABOVE MAY OR MAY NOT BE REPRESENTATIVE OF THE ACTUAL SELLING PRICE OF SIMILAR RECREATIONAL VEHICLES IN YOUR AREA.

Stock # 16830

### Standard Equipment

THE FOLLOWING ITEMS ARE STANDARD ON THIS MODEL AT NO EXTRA CHARGE

- EXTERIOR**
- Aerodynamic, rounded front profile with diamond plate
  - Modern retro graphics package with two-colored sidewall
  - Stronghold VBL™ vacuum-bonded floor & walls with double-sided Azdel composite on walls
  - Keyed-Alike™ lock system
  - Magnum Truss™ Roof System with one-piece seamless roof material
  - American-made frame with integrated A-frame
  - G20 tinted safety-glass windows
  - Marine-grade exterior speakers with blue LED accent lighting (2)
  - 30-amp service
  - Outside grill propane quick-connect port
  - LCI Solid Step® fold-down aluminum tread entry steps
  - Battery quick disconnect
  - Slide topper prep (select models with slide rooms)
- CUSTOMER VALUE PACKAGE (MANDATORY)**
- Aluminum rims
  - 20 lb. propane bottles with auto regulator (2)
  - 15,000 BTU A/C
  - Spare tire
  - Detachable power cord
  - Power awning with LED lights
  - Black tank flush
  - Outside shower
  - Power tongue jack
  - Rock Solid stabilizer system
  - Tankless water heater
  - 55 gal fresh water tank
  - Pan/meter brush guards
  - Side-marker camera prep
  - Rear camera backup prep
  - Outside grille for JayPort system
  - Power roof vent (main living area)

- INTERIOR**
- Choice of two interior design packages- Modern Farmhouse or Vintage Washed Grey
  - LED lighting throughout
  - Smoked glass decorative inserts (select overhead cabinets)
  - Screwed and glued cabinetry
  - Residential vinyl flooring with cold crack resistance
  - Plywood dinette, bunk and bed bases (applicable models)
  - Ball-bearing drawer guides with 75 lb. capacity
  - 3-burner recessed cooktop with glass cover
  - Residential-style kitchen countertops
  - Microwave
  - Decorative backsplash
  - 4 in. high-density dinette cushions with vinyl backing (select models)
  - Jayco exclusive Teddy Bear "soft-touch" residential-style bed mats (select models)
  - 120V outlet and cargo net in fixed bunks (bunk models only)
  - Plastic foot flush toilet
  - Bathroom skylight and roof vent
  - Decorative roller shades with reflective backing

- JAY PRO PACKAGE (MANDATORY)**
- 16 in. Goodyear® off-road tires with self-adjusting electric brakes
  - Rubber torsion axle
  - Glacier Package includes enclosed underbelly
  - Roof-mount solar prep
  - Inverter pre-wire
  - 6 cu. ft. gas/electric refrigerator
  - 32 in. 12V LED TV with built-in soundbar and AM/FM/Bluetooth®

### Optional Equipment

OPTIONAL EQUIPMENT INSTALLED ON THIS VEHICLE BY MANUFACTURER

Base price	40,793.00
Modern Farmhouse	n/c
USA Standards	n/c
Customer Value Package	4,875.00
Jay Pro Package	3,000.00
Overlander Solar Package	593.00
No JayCommand Control System	n/c
Microwave	n/c
8 Cu. Ft. 12v Refrigerator	293.00
Standard Suspension	n/c
20# LP Gas Bottles	n/c
Accessory Roof Rack	593.00

UNIT TOTAL **50,147.00**

DEALER INSTALLED OPTIONS

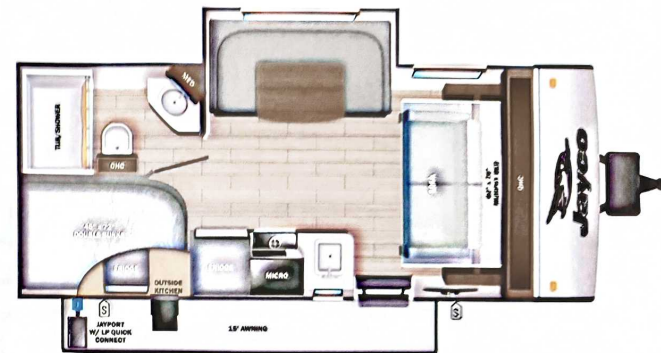

**lb** U**V****W**  
4701 lbs

**Sleeps**  
Sleeps

**Length**  
23' 1.63"

#### DIMENSIONS

Exterior height:.....125.13"  
 Exterior width:.....100.50"

#### WEIGHTS

GVWR:.....5750  
 GAWR (front):.....4870  
 GAWR (rear):.....0  
 Approx. Gross Cargo Carrying Capacity (GCCC):.....1049

#### CAPACITIES

Fresh water tank (gals.):...55.00  
 Gray water tank (gals.):...30.50  
 Black water/toilet tank (gals.):...30.50  
 Propane (lbs.):.....40  
 Propane (gals.):.....9  
 Water heater (gals.):.....6.00

#### SEATING & SLEEPING

#### TIRES

Tire size (front):.....LT225/75R16E  
 Tire size (mid):.....  
 Tire size (rear):.....  
 Tire size (spare):.....LT225/75R16E

\*\*\*Some dimensions may be rounded and may vary from the actual dimensions\*\*\*

\*\*\*Weights may be estimated calculations and may vary from the actual weight - refer to the vehicle weight labels for actual weights\*\*\*

Floorplans, features and specifications are subject to change without notice.

