

STOCK# 18165

Super Lite



Manufacturer's Suggested Retail Price \$43,553.00

TOTAL AMOUNT DOES NOT INCLUDE STATE AND LOCAL TAXES OR LICENSE FEES. THE PRICE SHOWN ABOVE MAY OR MAY NOT BE REPRESENTATIVE OF THE ACTUAL SELLING PRICE OF SIMILAR RECREATIONAL VEHICLES IN YOUR AREA.

STARCRAFT

Serial #: 1SABV0BK2R3YB5102
Model: 212FB SUPER LITE TT

Model Year: 2024 Dealer Name: HILLTOP CAMPER AND RV
7324 NOVOTNY ROAD
BRainerD, MN 56401
USA

Standard Equipment

Optional Equipment

THE FOLLOWING ITEMS ARE STANDARD ON THIS MODEL AT NO EXTRA CHARGE

OPTIONAL EQUIPMENT INSTALLED ON THIS VEHICLE BY MANUFACTURER

- EXTERIOR**
- 5/8" main floor decking
 - Door side spray port
 - Exterior grill/griddle quick connect port
 - Flexible LP lines
 - Foldable grab handle
 - Fully-walkable roof
 - In-frame battery rack
 - Magnetic baggage door catches
 - Oversized pass-through storage with motion lighting
 - PVC roofing membrane (limited lifetime warranty)
 - Rain guttering with molded drip spouts
 - Rear observation camera prep
 - Safety bumper with drain hose carrier and end caps
 - Self-adjusting electric brakes
 - Side camera prep marker lights
 - Solid swing-down entry steps
 - Thermal Seal- enclosed, insulated and heated underbelly with fully insulated roof with a PVC roofing membrane
 - Tinted safety-glass windows throughout
 - TuffShell™ - vacuum bonded laminated construction, reinforced with heavy-duty fiberglass and welded aluminum frames
 - Xtend Solar I Package (200 watt solar panel with 30 amp solar controller)

- INTERIOR**
- 10 cu. ft. 12V refrigerator
 - 5G antenna
 - 60" x 80" residential queen bed with storage drawers below
 - 75 lb. ball bearing drawer guides
 - 81" interior height
 - Cable and satellite prep
 - Electrical outlets and USB ports in master bedroom
 - Flush floor slides with residential vinyl flooring
 - Hardwood cabinet doors
 - Kitchen sink covers
 - LED interior lighting
 - Medicine cabinet
 - Powered 12V bathroom vent
 - Range hood
 - Residential high-rise faucet
 - Roller blackout night shades
 - Soft closing foot flush toilet
 - Stainless steel single basin under-mount kitchen sink
 - Tri-fold sofa (select models)
- CUSTOMER CONVENIENCE PACKAGE (Mandatory)**
- 15,000 BTU roof mounted A/C
 - 2-30 lb. LP bottles
 - 3-burner range with 17" oven and flush mount glass cover
 - Dome style digital TV antenna with Wi-Fi prep
 - Enclosed exterior docking station with black tank flush
 - Entrance door with screen door, window and magnet door catch
 - EZ-store detachable cord
 - Gas/electric water heater
 - JBL® Aura Cube stereo with Bluetooth® and miZONE™ technology
 - JBL® Premium indoor and outdoor multizone speakers
 - Microwave
 - Molded front cap with LED lighting and stoneguard protection
 - Nitrogen filled radial tires with aluminum rims
 - Pop up wireless and USB charger in bedroom
 - Power awning with LED lighting
 - Power tongue jack
 - Pressed membrane countertops
 - Rear roof access ladder
 - Smart HDTV

Base price	39,053.00
USA STANDARDS	n/c
CUSTOMER CONVENIENCE PACKAGE	4,500.00
XTEND SOLAR I PACKAGE	n/c
MANUAL STAB JACKS	n/c
L-SOFA	n/c

UNIT TOTAL **43,553.00**

DEALER INSTALLED OPTIONS

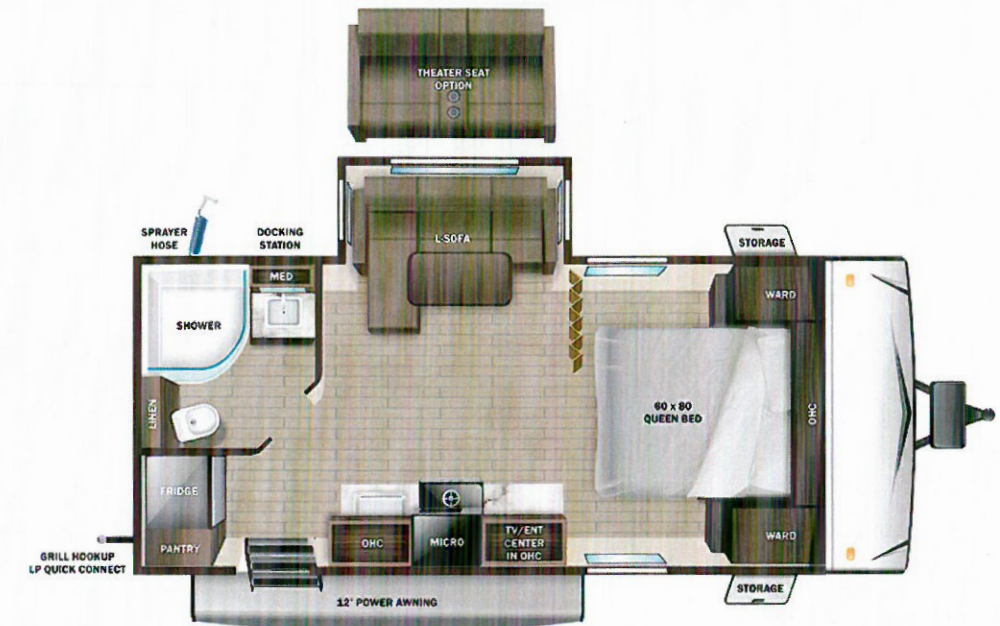

UVW
4955 lbs

Sleeps

Length
23' 3.13"

DIMENSIONS

Exterior height:.....132.63"

Exterior width:.....96.75"

WEIGHTS

GVWR:.....6400

GAWR (front):.....3500

GAWR (rear):.....3500

Approx. Gross Cargo Carrying Capacity(GCCC):.....1445

Capacity(GCCC):.....1445

TIRES

Tire size (front):.....ST205/75R14D

Tire size (mid):.....

Tire size (rear):.....ST205/75R14D

CAPACITIES

Fresh water tank (gals.):...45.00

Gray water tank (gals.):...29.00

Black water/toilet tank (gals.):.....29.00

Propane (lbs.):.....60

Propane (gals.):.....14

Water heater (gals.):.....6.00

SEATING & SLEEPING

Some dimensions may be rounded and may vary from the actual dimensions
Weights may be estimated calculations and may vary from the actual weight - refer to the vehicle weight labels for actual weights
Floorplans, features and specifications are subject to change without notice.

