

STOCK#16467

White Hawk



Serial #: 1UJBJ0BP7N14N0116  
 Model: 25MBH WHITE HAWK TT

Model Year: 2022 Dealer Name: HILLTOP CAMPER AND RV  
 7324 NOVOTNY ROAD  
 BRAINERD, MN 56401  
 USA

Manufacturer's Suggested Retail Price \$61,156.00

TOTAL AMOUNT DOES NOT INCLUDE STATE AND LOCAL TAXES OR LICENSE FEES. THE PRICE SHOWN ABOVE MAY OR MAY NOT BE REPRESENTATIVE OF THE ACTUAL SELLING PRICE OF SIMILAR RECREATIONAL VEHICLES IN YOUR AREA.

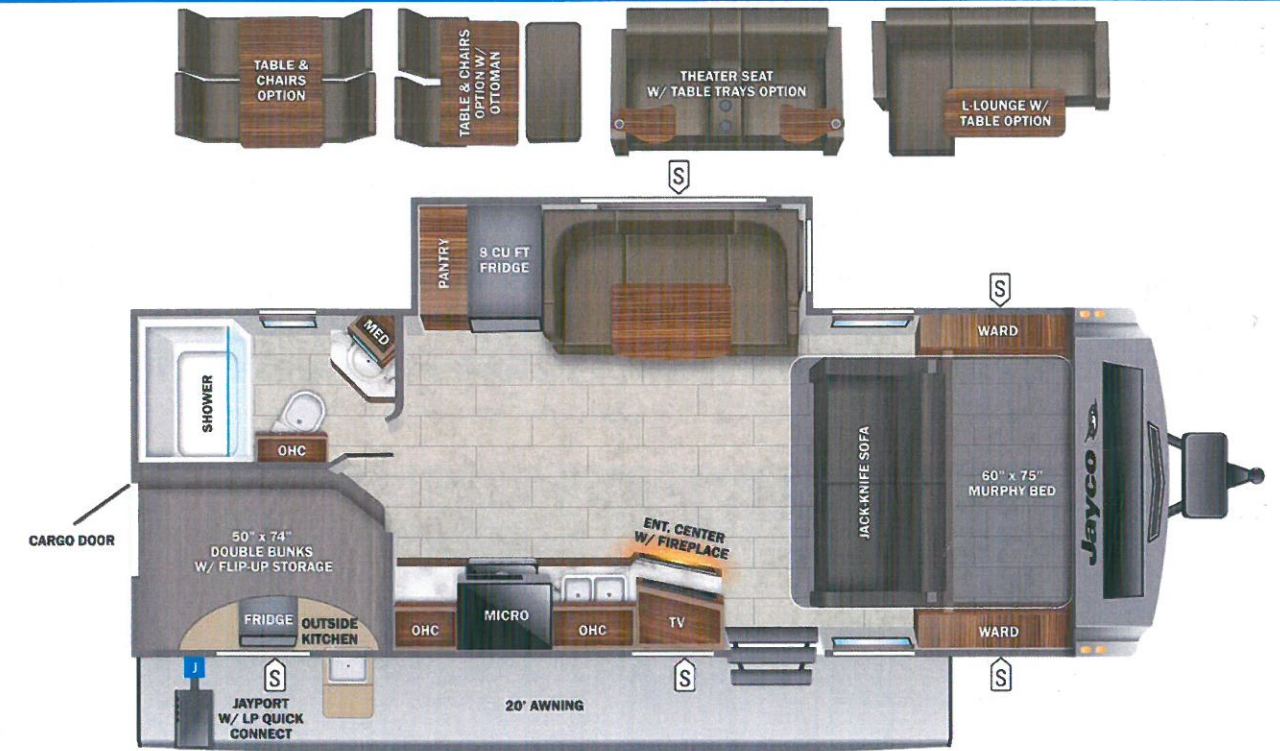

**Standard Equipment**

**Optional Equipment**

THE FOLLOWING ITEMS ARE STANDARD ON THIS MODEL AT NO EXTRA CHARGE

OPTIONAL EQUIPMENT INSTALLED ON THIS VEHICLE BY MANUFACTURER

- EXTERIOR**
- Aerodynamic, rounded front profile with front diamond plate
  - Stronghold VBL™ vacuum-bonded, laminated side and rear walls with Azdel composite (including slideout room walls)
  - Magnum Truss™ Roof System with one-piece seamless roof material with 20 year warranty
  - 5/8 in. tongue-and-groove plywood decked flooring
  - American-made frame with integrated A-frame
  - G20 dark tinted safety-glass windows
  - 30 in. friction-hinged main entry doors (select models)
  - Swing out grab handle
  - Exterior TV bracket with 120V and cable outlets
  - Outdoor camp kitchen with embossed metal countertops (select models)
  - Slam latches on front pass-through storage doors (select models)
  - Marine-grade exterior speakers with blue LED accent lighting (2)
  - Galvanized steel and impact-resistant wheel wells
  - 30-amp service
  - Stabilizer jacks with sand pads (4)
  - Mounted camera bracket for pre-wired side and rear backup prep
  - Keyed-Alike™ lock system
  - Detachable power cord
  - A-frame mounted solar prep
  - Battery quick disconnect
  - Black tank flush
  - ABS propane bottle cover
  - Automotive-style aluminum rims
  - Spare tire with cover
  - Inverter pre-wire
  - MORryde® StepAbove™ entrance steps
- LUXURY PACKAGE (MANDATORY)**
- Climate Shield™ zero-degree tested weather protection:
  - Fully enclosed and heated underbelly (ducted)
  - 35,000 BTU output furnace
  - Double layer fiberglass batt insulation in ceiling and floor
  - Double sided radiant barrier insulation (roof, floor, cap, and slide room floors)
  - PEX plumbing
  - Front molded fiberglass cap with automotive-style windshield and blue LED accent lighting
  - Frameless windows
  - Fold-down aluminum tread entry steps (main entry), aluminum tread entry steps (second entry, select models)
  - JaySMART™ (Safety Markers And Reverse Travel) LED lighting (patent-pending)
  - Roof-mount solar prep
  - Kitchen skylight with shade
  - Power roof vent (main living area)
  - JAYCOMMAND® "Smart RV" system with TPMS

- INTERIOR**
- Arched interior ceiling
  - LED lighting throughout
  - Electric fireplace (mandatory)
  - Directional and closeable central A/C vents
  - Plywood dinette, bunk and bed bases (applicable models)
  - Decorative wall clock in main living area (select models)
  - Residential vinyl flooring with cold crack resistance
  - High output auto-ignition 35,000 BTU furnace with wall thermostat
  - Front windshield with roller shade with radiant barrier backer
  - Solid hardwood, joined cabinets with screwed and glued lumbercore cabinet stiles
  - Deep, split bowl, stainless steel sink with high-rise, pull-out faucet and dry rack/sink cover combo
  - Decorative backsplash
  - Ball-bearing drawer guides with 75 lb. capacity
  - Wood panel fridge inserts
  - 60 in. x 80 in. queen bed (60 in. x 75 in. in Murphy bed models)
  - 72 in. x 80 in. king bed (n/a 26FK)
  - Murphy bed design allowing pass-through exterior storage access (24MRB & 25MBH)
  - Fixed bunks with 120V outlet and cargo net (bunk models only)
  - Jayco exclusive Teddy Bear "soft-touch" bunk mats (bunk models only)
  - Powered roof vents in bathroom and main bedroom
- CUSTOMER VALUE PACKAGE (MANDATORY)**
- American-made nitro-filled Goodyear® radial tires with self-adjusting brakes (made in the USA)
  - 6 gal. gas/electric DSI water heater
  - 55 gal. fresh water tank
  - 30 lb. propane bottles (2)
  - Outside shower
  - Power awning with LED light
  - Power tongue jack
  - Slide topper prep
  - LED TV
  - 14,500 BTU A/C
  - AM/FM/Bluetooth® stereo with speakers
  - 8 cu. ft. gas/electric refrigerator
  - Oven with 3-burner recessed cooktop
  - Microwave
  - Porcelain foot flush toilet
  - Showers with solid enclosures
  - Bathroom skylight

Base price	52,463.00
Vintage Washed Grey	n/c
USA Standards	n/c
Customer Value Package	5,250.00
Luxury Package	3,000.00
Solar Power Package Prep	n/c
No 2nd AC	n/c
30 AMP Service	n/c
Fireplace	443.00
8 Cu. Ft. Gas/Electric Refrigerator	n/c
Manual Stabilizer Jacks	n/c
Roof Ladder (Std)(14N)	n/c
Dinette	n/c

UNIT TOTAL **61,156.00**

DEALER INSTALLED OPTIONS

**UVW** 6420 lbs **Sleeps** **Length** 30' 8.13"

**DIMENSIONS**

Exterior height:.....135.63"  
 Exterior width:.....96.00"  
**WEIGHTS**  
 GVWR:.....7750  
 GAWR (front):.....4400  
 GAWR (rear):.....4400  
 Approx. Gross Cargo Carrying Capacity(GCCC):.....1330

**CAPACITIES**

Fresh water tank (gals.):...55.00  
 Gray water tank (gals.):...30.50  
 Black water/toilet tank (gals.):...30.50  
 Propane (lbs.):.....60  
 Propane (gals.):.....14  
 Water heater (gals.):.....6.00

**SEATING & SLEEPING**

**TIRES**

Tire size (front):.....ST225/75R15E  
 Tire size (mid):.....  
 Tire size (rear):.....ST225/75R15E  
 Tire size (spare):.....ST225/75R15E

\*\*\*Some dimensions may be rounded and may vary from the actual dimensions\*\*\*  
 \*\*\*Weights may be estimated calculations and may vary from the actual weight - refer to the vehicle weight labels for actual weights\*\*\*  
 Floorplans, features and specifications are subject to change without notice.

