



## Jay Feather Air



Serial #: 1UJBB0AJ0S1HC0162  
Model: 15MRB JAY FEATHER AIR TT

Model Year: 2025 Dealer Name: HILLTOP CAMPER AND RV  
1240 LAKE SHADY AVE. SOUTH  
ORONOCO, MN 55960  
USA

### Standard Equipment

THE FOLLOWING ITEMS ARE STANDARD ON THIS MODEL

**STANDARD EXTERIOR EQUIPMENT**

- 1.5 in. fresh water drain valve
- 18 in. rear roof ladder - factory installed
- 2 in. Stronghold VBL™ floor with 2 lb. density foam
- Stronghold VBL™ walls with double-sided Azdel composite (sidewalls, rear walls and slide out boxes)
- Aerodynamic, rounded front profile with aluminum framing
- American-made Norco Z-frame with integrated A-frame
- Automotive-style aluminum rims
- Battery quick-disconnect
- Dark-tinted safety-glass windows
- Exterior TV bracket with 120V and cable hook-ups
- Front diamond plating backed with Azdel
- Galvanized steel and impact resistant wheel wells
- Keyed-Alike™ locking system
- Magnum Truss™ Roof System
- Mounted camera bracket for pre-wired side and rear back-up prep
- PVC roofing membrane (limited lifetime warranty)
- Swing-out entry door assist handle

**JAY AIR PACKAGE (MANDATORY)**

- 11 cu. ft. 12V fridge
- 2 in. rear receiver prep
- App monitored TPMS
- Climate Shield (zero to 100 degree tested weather insulation package)
- Invision appliance package
- LCI Solid Step fold-down aluminum tread steps on main entry door
- LED smart TV
- MAXXAIR® power roof vent (main living area)
- Modern graphics package with dual-colored sidewall
- Overlander 1 Solar Package: (1) 200W solar panel and 30-amp digital controller
- Stainless steel kitchen & bathroom sink

**STANDARD INTERIOR EQUIPMENT**

- 4 in. high-density dinette cushions with vinyl backing
- 4 in. soft-touch bunk mats (select models)
- 75 lb. full extension drawer guides
- Bathroom skylight
- Decorative backplash
- Decorative roller shades with reflective barrier
- Handcrafted, hardwood door/drawer fronts
- Hidden-hinged cabinet doors
- High output auto-ignition LP gas furnace
- LED lighting throughout
- Plywood dinette, bed, bunk and shower/tub bases
- Powered roof vents in bathroom and main bedroom (most models)
- Residential vinyl flooring throughout
- Residential-style seamless countertops throughout
- Screwed and glued cabinet stiles
- USB charging ports (multiple locations throughout)

**CUSTOMER VALUE PACKAGE (MANDATORY)**

- Radial tires with self-adjusting electric brakes
- 13,500 BTU roof-mounted A/C
- 2 Burner cooktop
- 20 lb. LP gas bottles with auto-regulator and ABS cover
- 55 gal. fresh water tank
- Automotive-style aluminum rims
- Black tank flush
- Convection microwave
- Detachable power cord
- Inverter pre-wire
- Max-length power awning with LED light
- On-demand water heater
- Power tongue jack
- Rock Solid Stabilizer System
- Side and rear back-up camera prep
- Under-mount spare tire

### Optional Equipment

OPTIONAL EQUIPMENT INSTALLED ON THIS VEHICLE BY MANUFACTURER

Base price	31,118.00
USA STANDARDS	n/c
CUSTOMER VALUE PACKAGE	6,000.00
JAY AIR PACKAGE	3,750.00
OVERLANDER 1 SOLAR PACKAGE	n/c
13,500 BTU AC	n/c
20# LP GAS BOTTLES	n/c
RANIER TIRES	n/c
2" REAR RECEIVER	188.00

UNIT TOTAL

41,056.00

DEALER INSTALLED OPTIONS

## Manufacturer's Suggested Retail Price \$41,056.00

TOTAL AMOUNT DOES NOT INCLUDE STATE AND LOCAL TAXES OR LICENSE FEES. THE PRICE SHOWN ABOVE MAY OR MAY NOT BE REPRESENTATIVE OF THE ACTUAL SELLING PRICE OF SIMILAR RECREATIONAL VEHICLES IN YOUR AREA.

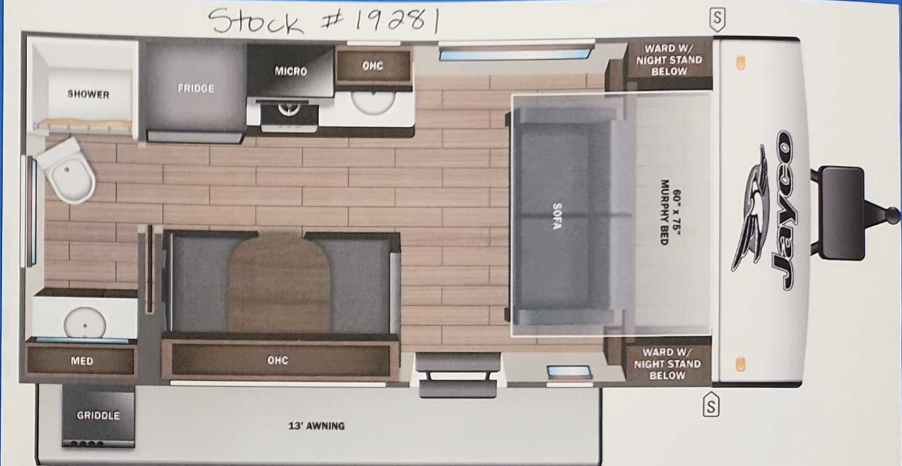

**UVW**  
3851 lbs



**Sleeps**



**Length**  
20' 1.94"

### DIMENSIONS

Exterior height:.....130.50"  
Exterior width:.....96.00"

### WEIGHTS

GVWR:.....4995  
GAWR (front):.....4400  
GAWR (rear):.....0  
Approx. Gross Cargo Carrying Capacity (GCCC):.....1144

### CAPACITIES

Fresh water tank (gals.):...55.00  
Gray water tank (gals.):...38.00  
Black water/toilet tank (gals.):...30.00  
Propane (lbs.):...40  
Propane (gals.):...9  
Water heater (gals.):...0.25

### SEATING & SLEEPING

### TIRES

Tire size (front):.....ST225/75R15E  
Tire size (mid):.....  
Tire size (rear):.....  
Tire size (spare):.....ST225/75R15E

\*\*\*Some dimensions may be rounded and may vary from the actual dimensions\*\*\*  
\*\*\*Weights may be estimated calculations and may vary from the actual weight\*\*\*  
- refer to the vehicle weight labels for actual weights\*\*\*  
Floorplans, features and specifications are subject to change without notice.

**2+3**  
YEAR | YEAR  
LIMITED STRUCTURAL  
WARRANTY