

NEXT LEVEL NORTHWOOD

ARCTIC FOX

TRUCK CAMPERS

**ARCTIC FOX
CAMPERS**

NiW



WWW.NORTHWOODMFG.COM

NEXT LEVEL QUALITY

QUALITY CONSTRUCTION, DISTINCTIVE DESIGN,
FULL WALL TRUCK CAMPERS DONE RIGHT.

ARCTIC FOX CAMPERS



THREE INTERIORS TO CHOOSE FROM



*GRAY LEATHER USED FOR SOFA OPTION

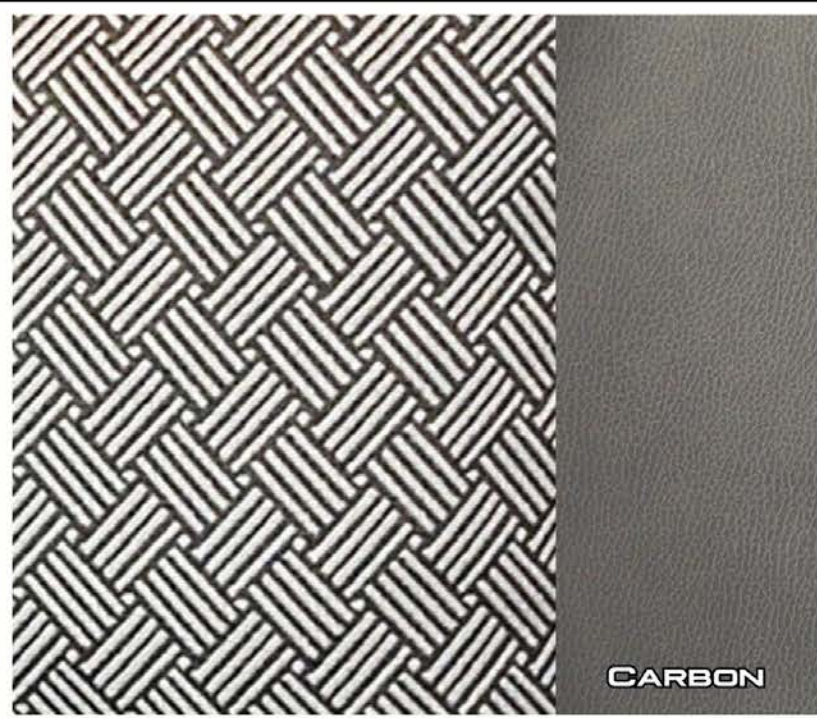
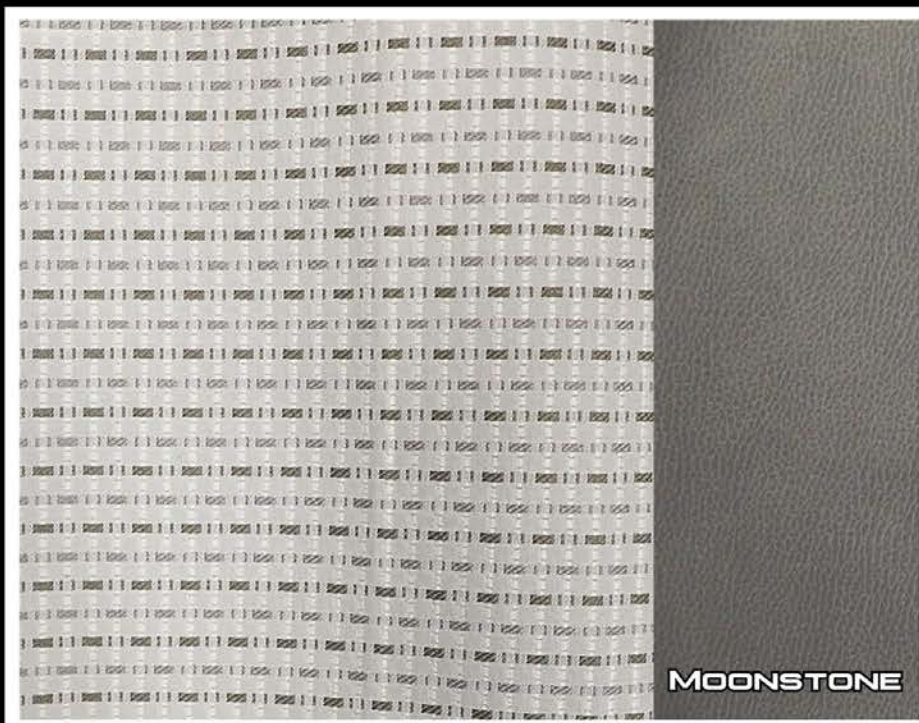

ARCTIC FOX

TRUCK CAMPERS

'The reason for my adulation sits squarely in the brilliant non-slide, mid-bath floor plan and its high-quality execution. The panoramic rear view, full-booth dinette, straight kitchen, large wet bath, and cabover bedroom separation make the floor plan work beautifully. Northwood's top notch quality makes the final product a real winner.'

2019 Arctic Fox 865 Review - Truck Camper Magazine - March 26, 2019

- Huge Load Capacity w/ 4" Additional Head Room and 5" Thick Rigid Foam at the Crown of the Cathedral Arch Ceiling
- Heated Enclosed Large Capacity Holding Tanks
- Solid Wood Cabinet Doors & Drawer Faces
- One Piece, Laminated Fiberglass Exterior Siding
- See the Video '36 on the Roof' on the Website
- Electric Jacks w-6 Function Remote
- All Conditions 4 Season Insulation
- Fully Welded Aluminum Frame
- Large Capacity Storage Compartments
- Large Battery and LPG Capacities



Long & Short Box Option Available

865





CARBON



My favorite features would be that it has a good amount of storage on the interior. Also it has two 7 gallon propane tanks, a 50 gallon water tank, and is four-season rated, all great features for extended stays while boondocking. The camper came equipped with a 2,500 watt propane onboard generator and a 100 watt solar panel on the roof. I also have an 80 watt portable solar panel that I direct towards the sun. I primarily use solar to recharge my two 105 amp hour AGM batteries. I don't have a big need for power so it keeps up pretty good unless it's cloudy all day then I'll top the batteries off with the generator. It's been a great setup for me so far.

Kirk Harris - Full Timer/ Owner of an Arctic Fox 811 -

Interview provided courtesy of Mike Smith of TruckCamperAdventure.com



Long & Short Box Option Available
(Generator only available in Short Box Campers)

811



- Huge Load Capacity w/ 4" Additional Head Room and 5" Thick Rigid Foam at the Crown of the Cathedral Arch Ceiling
- See the video '36 on the Roof' on the website
- Heated Enclosed Large Capacity Holding Tanks
- Solid Wood Cabinet Doors & Drawer Faces
- One Piece, Laminated Fiberglass Exterior Siding
- Electric Jacks w-6 Function Remote
- All Conditions 4 Season Insulation
- Fully Welded Aluminum Frame
- Large Capacity Storage Compartments
- Large Battery and LPG Capacities



CARBON

ALUMINUM SUPERSTRUCTURE

Anchor blocking gives substantial strength at main connection points.

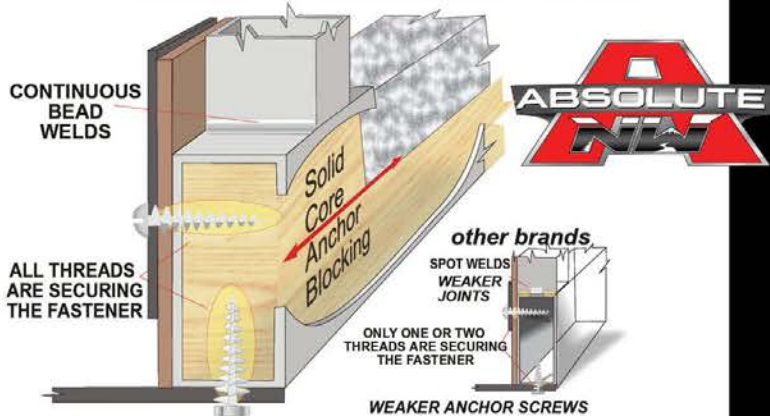

Thick wall aluminum basement floor joists support our holding tanks under the basement of every Arctic Fox Truck Camper.

'Big' holding tanks require a 'Big' floor structure...



ABSOLUTE NORTHWOOD

FULLY WELDED
THICK WALL
ALUMINUM
TUBE FRAME
WITH
SOLID CORE
ANCHOR
BLOCKING
AND
HEAVY DUTY
ALUMINUM
BASEMENT
FLOOR FRAME



The Fox Landing offers a large entry platform, convenient fold away stairs and an intermediate step for easy access. The stairway can be installed to the left or right of the landing and the platform folds up out of the way for travel or when hitching your boat or trailer. Check it out!

4 Equal Height Steps

- * Mid Step (Between Bumper & Threshold)
- * Wide Bumper
- * Left or Right Hand Accessible
- * Steps Fold Up in Seconds
- * Single Pin Locks Into Position
- * ...Exclusively in Northwood Campers!!!

Please Note:
The Mid Step is an option when adding a Fox Landing to a previously purchased camper.



1. Steps in the down position.



2. Treads fold up.



3. Landing folds up, and pin locks it into place

SOLID WOOD
CABINETRY
MOUNTED TO
THE WALLS AND
THE CEILING



By using solid wood face frame construction and then integrating the cabinet with the structure of the ceiling and walls, our coaches and our cabinets are both made stronger.

Our fully enclosed, insulated and heated holding tank area circulates air around the suspended tanks providing the best protection from freezing. All our dump valves are also enclosed and heated to ensure smooth operation, even in cold northern climates.

4 SEASON ALL
WEATHER CAMPER





990

NW

- Huge Load Capacity w/ 4" Additional Head Room and 5" Thick Rigid Foam at the Crown of the Cathedral Arch Ceiling
- See the video '36 on the Roof' on the website
- Heated Enclosed Large Capacity Holding Tanks
- Solid Wood Cabinet Doors & Drawer Faces
- One Piece, Laminated Fiberglass Exterior Siding
- Electric Jacks w-6 Function Remote
- All Conditions 4 Season Insulation
- Fully Welded Aluminum Frame
- Large Capacity Storage Compartments
- Large Battery and LPG Capacities



ARCTIC FOX CAMPER STANDARD FEATURES

STANDARD FEATURES:

Fully Welded, Thick-Wall Aluminum Frame Construction
 Corona Treated Fiberglass
 Laminated, Multi-Layered Substrate Walls & Floor
 High Density Foam Block Insulation
 Aerodynamic Front Fiberglass Cap
 Cathedral Arched Ceiling
 Swing Out Brackets (1140,1150)
 Full-Wall Dinette Slide (NA 865)
 Heated Holding Tanks
 Deluxe Bumper w/Hose Carrier
 Rear View Camera Ready / Lighted Exterior Grab Bar
 LED Exterior Lighting
 SolX 4 - 400 Watt Solar Package
 LPG Quick Connect
 Black Water Flush System
 Automatic Change-Over Regulator
 Exterior Shower
 Entry Door Friction Hinge
 6 Gal DSI Gas/Elect Quick Recovery Water Heater
 20K BTU Auto Ignition Furnace w/Digital Thermostat
 Marine Style Detachable Shore Cord
 12-Volt Disconnect Switch
 Frameless Thermal Pane Windows
 Large Exterior Folding Grab Handle (1140)
 Rear Back-Up Window
 Generator Ready
 Satellite Ready
 LED Interior Utility & Decorative Lighting
 Interior Command Center
 Custom One Piece Formed Countertops & Dinette Table
 Ceiling Carpet Front To Back
 Roller Bearing Drawer Glides
 Fabric Night Shade Window Treatments
 AM/FM Stereo w/Bluetooth
 Smoke, LPG & CO Leak Detectors
 Charge Wizard w/Li Switch
 High Output 3-Burner Cook Top
 Microwave Oven
 Daylitter Kitchen Skylight w/ Shade
 Porcelain, Foot-Pedal Toilet
 Bath Skylight
 Full Fiberglass, One-piece Shower
 NW TruRest Queen Mattress w/ Bedspread
 Privacy Curtitition in Cab Over
 USB Charging Ports & 110 Outlets on Both Sides of Bed

FOX VALUE PACKAGE:

Rear Electric Awning w/LED Lights
 Sliding Battery Rack
 Dual 30lb LP Tanks
 Roof Handle & HD Ladder
 Electric Jacks w-6 function remote
 Outside Speakers
 "Joey" Sliding Storage Tray
 Omni-Directional TV Antenna
 Diamond Plate Knee Wall Armor
 12 Volt Refrigerator
 Large 22" Oven
 Microwave Oven w/Air Fryer
 Multi-Speed Reversible
 Premium Fan Vent
 Below Dinette Access Door & Drawer
 Front Bedroom Shelf
 Hardwood Hamper Doors

Aluminum Superstructure



Roll-Over Lounge



The Long & The Short of it.

Customers often ask... 'What's the deal with 'long box/short box' designation on Arctic Fox campers?'

A brief explanation: 'The Box' we are referring to is the truck bed.

In a short box (bed) truck, the distance from the bulk head to the rear bumper is less, so more of your camper will extend beyond the rear bumper. That extra overhang makes it possible for additional storage or for a generator compartment. A long bed (box) pickup has more of the camper inside the bed and less overhang.

See the schematic below:

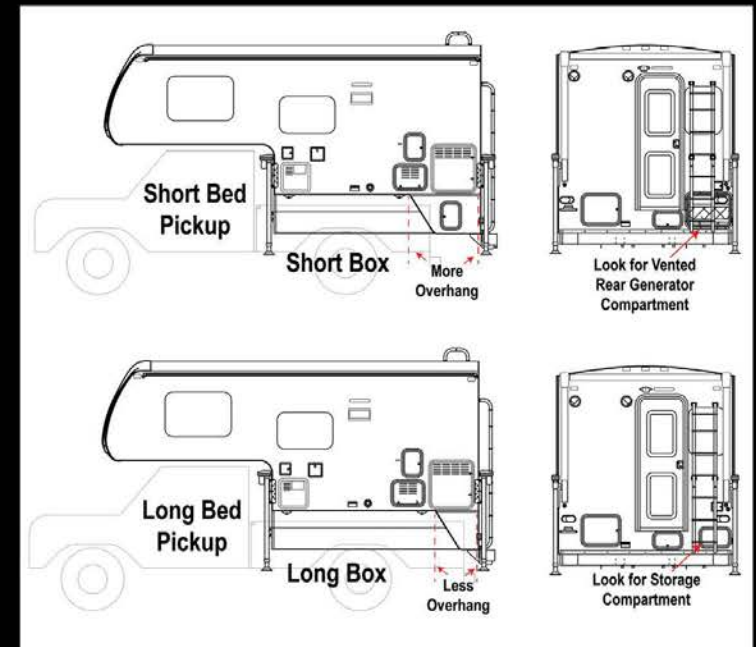

Dual Rams
 Dual Ram Rack
 and Pinion
 Slide Assembly
 in All Slide Outs



Dual Battery Rack

Sliding Dual Battery Tray
 Holds Two Full Size Batteries
 420 Amp Total Capacity
 on Metal Roller Bearings

Dual LPG Tanks

Dual 30# LPG Tanks
 w/Auto Change-over
 Regulator and Lock-able
 Security Strap



Overhead Bunk Dinette



Full Wall Wardrobe in the Bedroom



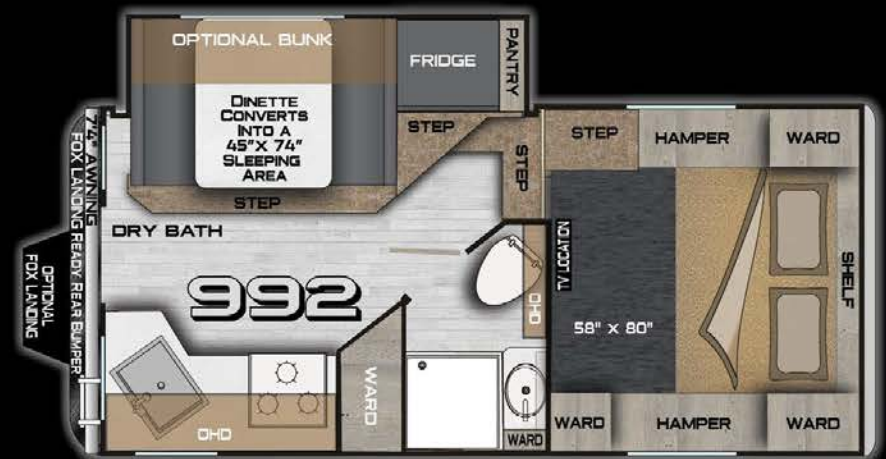

992

- Huge Load Capacity w/ 4" Addl. Head Room and 5" Thick Rigid Foam at the Crown
- See the video '36 on the Roof' on the website
- Heated Enclosed Large Capacity Holding Tanks
- Solid Wood Cabinet Doors & Drawer Faces
- One Piece, Laminated Fiberglass Exterior Siding
- Electric Jacks w-6 Function Remote

- All Conditions 4 Season Insulation
- Fully Welded Aluminum Frame
- Cathedral Arch Ceiling
- Large Storage Compartments
- Large Battery and LPG Capacities

Here we are at Lake Shasta, California.
This is our first real camping trip in our new Arctic Fox 992.
Love, Love the camper!
Mike and Linda Godsil



36 ON THE ROOF

When Northwood advertises a
“Full Walk-On Roof”
for our Arctic Fox truck campers, you
not only can walk everywhere on the
roof, but you could invite a couple
dozen of your friends
to join you!!

We tested the strength of our
AF 990 full-wall slide model by
loading the roof with 36 of our
camper line employees.

(A good testimonial for our camper jacks, too!).

SEE THE VIDEO



When we say ‘FULL WALK ON ROOF’ we mean it!

Don't try this with your camper, especially if it's a competitor's model! Our employees are in, on and around campers all day long. Please, be safe!

CAMPER SAFETY TIPS:

For your safety while driving, use mirrors that allow you to view past the camper to the rear on both sides. Trucks can be purchased with extended mirror options or you may purchase mirror extensions. Truck manufacturers state that you should not exceed the GVWR for the vehicle that carries your camper. The configuration of your truck will determine what size camper your vehicle can carry. A dual rear wheel truck is advisable for Arctic Fox campers. Adjustable air bags will help to level your vehicle, transfer rear axle weight forward for comfort and safety, and are recommended for all Arctic Fox applications. Some states allow passengers to ride in the camper, but it is not recommended as there are no seat belts available. When driving in any adverse weather condition it is always best to reduce your speed. The pickup should be outfitted with a durable rubber mat liner to reduce shifting while traveling. The mat will also protect the truck bed and camper from scratching while loading and unloading.

Use  **TORKLIFT** frame mounted camper tie downs for greatest safety.



More About Torklift

ABSOLUTE NORTHWOOD CAMPERS

ROOF

- ✓ Full Walk On Roof with Vacuum Bonded Cathedral Arched Ceiling Forming an Incredibly Strong Unified Structure

FRAME

- ✓ Thick Wall Aluminum w/Solid Anchor Blocking

FLOORS

- ✓ Commercial Grade Linoleum, Fully Insulated
- ✓ Laminated Aluminum Floor Structure - Double Layer Luan

CABINETS

- ✓ Wall & Ceiling Mounted, Face Frame Construction

INSULATION

- ✓ A True 4 Season Coach

A ABSOLUTE NORTHWOOD CAMPER ROOF

- 1 Heavy Gauge One Piece Roof Membrane
- 2 Luan Roof Sheathing
- 3 Arched High Density Thick Solid Block Foam
- 4 Ultra-Strong Vacu-Bonded Roof System
- 5 Interior Lamination Grade Luan Plywood
- 6 Ozite Ceiling Carpet

B HIGH DENSITY ONE PIECE LAMINATED WALLS

- 8 Designer Interior Decor Finish
- 9 Lamination Grade Luan Plywood Interior Wall
- 10 Heavy Gauge Fully Welded Aluminum Superstructure
- 11 Solid Wood Fill - Full Thread Depth Anchor Blocking
- 12 Virgin 2 lb Rigid Dense Block Foam Insulation
- 13 Steel Inlaid Bonderizer Anchor Strips
- 14 Lamination Grade Luan Plywood Exterior Wall Layer
- 15 Polyurethane Hot Glue w/ Climate Controlled Application
- 16 Corona Treated High Durability Fiberglass Outer Layer

C HIGH DURABILITY FLOOR STRUCTURE

- 17 Residential Quality Plush Commercial Carpeting
- 18 Commercial Grade Linoleum with 20 mil Surface
- 19 Laminated Aluminum Floor Structure - Double Layer Luan
- 20 R-7 Residential Grade Fiberglass Insulation
- 21 Laminated High Durability Moisture Barrier
- 22 Heated and Insulated Large Capacity Holding Tanks

D MORE ABSOLUTE NORTHWOOD QUALITY FEATURES

- 23 Aerodynamic Front Fiberglass Cap
- 24 4 Electric Jacks
- 25 11K BTU Air Conditioner
- 26 Diamond Plate Basement Walls



ALUMINUM SUPERSTRUCTURE

ARCTIC FOX: THE BEST AVAILABLE

We love our 2018 Arctic Fox 811.

A lot of research went into what our truck camper needed for us to be able to live full time in it. Bill and Ryan of Truck Camper Warehouse in West Chesterfield, NH (which is where we lived) answered all our questions, so we were able to find and create our perfect home.

On the inside, we love the warm brown tones, the ambiance rope lighting, dinette slide out, storage in all available spaces, size of the appliances and just overall it has the coziness of home.

We sold our home and everything last May and became Truck Camper Living. We have traveled 10,000 miles across the country so far and had no issues with the

Arctic Fox 811. We came back to NH for the holidays and even with the cold temperatures we experienced no issues with making minor modifications.

We welcome you to check out our You Tube channel - Truck Camper Living, and see our tutorials of our Arctic Fox 811 as well as our journey. Also, find us on Facebook, Instagram and the web at <http://www.truckcamperliving.net>

As far as we are concerned Arctic Fox is the best truck camper available with it's solid construction, attention to details and insulation values.

We hope to see you along our journey...

Elaine & Arnie Croteau
Truck Camper Living LLC

FOX TALK

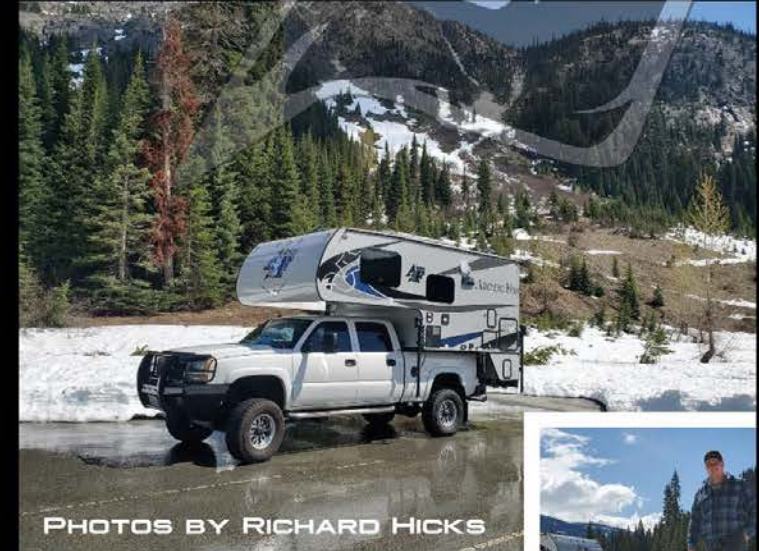

Customer photos and testimonials do not necessarily reflect the views or recommendations of Northwood Manufacturing

- Welded Aluminum Frame
- Huge Load Capacity w/ 4" Additional Head Room and 5" Thick Rigid Foam at the Crown of the Cathedral Arch Ceiling
- Large Capacity Holding Tanks
- Large Capacity Storage Compartments
- Large Battery and LPG Capacities
- Solid Wood Cabinet Doors And Drawer Faces
- One Piece, Laminated Fiberglass Exterior Siding
- Electric Jacks w-6 Function Remote
- All Conditions 4 Season Insulation Package w/ Enclosed Heated Holding Tanks

1140



NW





At the Arctic Circle with our Arctic Fox

PHOTOS & ADVENTURES BY BRETT BINNS



The Badlands NP, South Dakota.



We loved our 2011 AF 1150 Dry Bath and had the opportunity to upgrade to a new one this summer...love all the upgrades and changes over the last few years you have made. This picture is at Morrow County OHV in September
-Elliot P Groeneveld

FOX TALK

NW



SUNRISE AT GREEN SWAMP, FLORIDA

We bought our first truck camper with the intention of traveling to Alaska and selling it upon our return to the lower 48 States. However, our experience with the truck camper was so good that we decided to make it our summer travel camping vehicle. In September 2018, we traded in our first truck camper for our Arctic Fox 990. Among the reasons we chose to change units are Arctic Fox's 4 Season Package, the location of the slide room on the 990, and the ability to access the camper with the slide in.

Our summer journey usually starts in early April and ends some time around Halloween, and we average over 20,000

miles. Because of the ease of travel and finding campsites while using our truck camper, we have a general idea of where we're heading for the day, but can easily change direction and plans as something else draws our interest. Our camper is also used during the winter season as we are snowbirds in Florida and go off on weekend excursions with friends from time to time.

Jodie & Chuck Ramsey



PORTLAND HEAD LIGHT, CAPE ELIZABETH, MAINE

Customer photos and testimonials do not necessarily reflect the views or recommendations of Northwood Manufacturing

ARCTIC FOX

- Welded Aluminum Frame
- Huge Load Capacity w/ 4" Additional Head Room and 5" Thick Rigid Foam at the Crown of the Cathedral Arch Ceiling
- Large Capacity Holding Tanks
- Large Capacity Storage Compartments
- Large Battery and LPG Capacities
- Solid Wood Cabinet Doors And Drawer Faces
- One Piece, Laminated Fiberglass Exterior Siding
- Electric Jacks w-6 Function Remote
- All Conditions 4 Season Insulation Package w/ Enclosed Heated Holding Tanks



1150

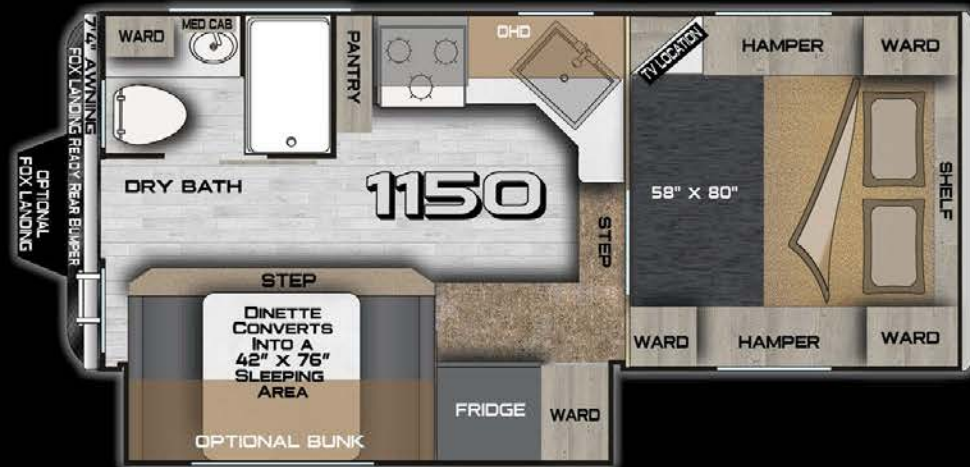



This was our first big trip in our new 2021 AF 811 on our 2020 Ford F350. We drove from our home in NJ to the Canadian Rockies in October of this year. The Truck Camper handled well on the road and was very comfortable and warm through the cold Canadian nights.

Steve J.



AVAILABLE OPTIONS

Some of these options are not available in all models.
Please see your dealer for specific option availability in certain models.

24" 12v LED TV (select models)	Swing Out Brackets (select models)
32" 12v LED TV (select models)	Full Wall Ward Curb Side
Arctic Fox Camper Seat-Step	Coleman Mach 10 11K BTU A/C
Fox Landing	3 Burner Cooktop
Pull Out Mid Step	RV BBQ
Addl. Fox Landing steps	24" Add-a-Step
2.5 Onan LP Generator	10' Side Box awning
SolX 6 +200 Watts of Solar	Slide OutTopper
3000 Watt Inverter w/400AH Lithium Battery	Rear View Camera
Dual 100AH Lithium Batteries w/C4 Monitor	Gateway Router
400AH Lithium Battery w/C4 Monitor	
Wet Bath - (some models)	
Overhead Bunk In Dinette(NA 865)	



I've camped throughout the southwestern United States and Alaska, with and without my horses but always with my camper. I just love that I can have the comforts of home and yet squeeze into the most inviting of places. And inside, my Arctic Fox is roomy. There is plenty of space for a couple of people and my large dog.

I have been interested in an Arctic Fox camper for a long time but several years ago dismissed it because in my research it appeared that all Arctic Foxes had slide outs. I didn't want a slide out and so I settled for another brand that didn't have one.

I was very disappointed in that particular camper. Then last winter while camping at a horse motel, I got to know a woman who had an Arctic Fox with a slide out. She mentioned that Arctic Fox does have a model without a slide out. I was thrilled and started looking for one immediately. It didn't take long to find one and it is just perfect. The quality of these campers is so impressive. This is my fifth camper. It is the best made of all of them; it has more storage; the layout has been well thought out. I am now a happy camper!

Charmi W. Show Low, Az.

Customer photos and testimonials do not necessarily reflect the views or recommendations of Northwood Manufacturing

ARCTIC FOX TRUCK CAMPERS

NW



VALUE PACK

Fox Value Pack is a mandatory option bundle that includes all of the following high value features:

Electric Rear Awning w/ LED Lights
Sliding Battery Rack
Electric Jacks w-6 Function Remote
Dual 30 lb. LP Tanks
Outside Speakers
Roof Handle and HD Ladder
Rear Sliding Storage Tray
Omni-Directional TV Antenna
Diamond Plate Knee Wall Armor
12 Volt Refrigerator/Freezer
Large 22" Oven (Most Models)
Microwave Oven w/Air Fryer
Premium Fan Vent – Multi-Speed/Reversible
Dinette Storage Door
Dinette Storage Drawer
Bedroom Front Shelf
Hardwood Hamper Doors
Weight: 596 lbs.

OPTION WEIGHTS

Approximate weight of specific additional features:

Feature	Est. Weight	
Weight Unit of Measure	Lbs.	Kgs.
OHD Bunk	40	18
Swing Out Brackets	21	10
11M BTU Air Cond.	90	41
SolX 6 + 200 Watts of Solar	42	20
Side Box Awning	63	29
Generator Ready	25	11
Generator	78	35
Barbeque	22	10
One Battery	30	14
Typical Water Full (8.3 Lb/Gal)	458	208
Propane Full	60	27
Bumper	49	23
Fox Landing	24	11
TV w/Bracket	20	9
12V Power Awning (Unit)	5	3

Use these figures to estimate the total weight of the coach with added options.
Camper Weight + All Options

ITEMS INCLUDED IN UNIT WEIGHT ESTIMATION

All Unit Weights Include All of The Following Features Below:

Fiberglass Exterior; Heavy-Duty Camper Tie Downs;
Exterior Rinse Station; 20 K BTU Auto Ignition
Furnace with Thermostat Control;
58"x 80" Tru-Rest Comfort Mattress;
Pre-wire for Solar and Satellite;
Pre-wire for TV Antenna;
Pre-wire for Microwave Oven;
Pre-wire for Air Conditioner;
Large 3 Burner Range; Range Cover;
Range Hood w/ Light and Exhaust Fan; DSI Gas
Electric Water Heater w/ Insulated Porcelain Tank;
Water Heater By-pass Valve; Semi-Automatic
Winterization System; Night/Privacy Shades; Galley
Skylight w/Shade; 25 Watt Speakers; Fire
Extinguisher; LPG Leak, Smoke and CO Detectors.

***All dry weights are calculated before adding options.**
Verify the load capacity of your vehicle. If you don't know or aren't sure, you should ask your automotive dealership or contact your vehicle manufacturer.

All weights above are average approximations and may vary. Specifications are subject to change without notice.

Approximate Overall Weight and Measure Specifications For Arctic Fox Campers:

Description	Arctic Fox Truck Campers					
Model Number	865	811	990	992	1140	1150
Dry Weight Lbs.	2641	2873	3010	3235	3465	3358
Dry Weight Kgs.	1198	1303	1365	1467	1571	1523
Width	8'1"	8'1"	8'1"	8'1"	8'1"	8'1"
Exterior Height	8'7"-10'0"w/AC	8'7"-10'0"w/AC	8'7"-10'0"w/AC	8'7"-10'0"w/AC	8'7"-10'0"w/AC	8'7"-10'0"w/AC
Interior Height	6'7"	6'7"	6'7"	6'7"	6'7"	6'7"
Floor Length	9'4"	9'0"	9'10"	10'2"	11'4"	11'4"
Overall Length	17	16'8"	17'6"	17'10"	19'0"	19'0"
Fresh Water w/Water Heater	42	50	59	46	59	59
Gray Water	32	38	39	39	35	35
Black Water	31	23	43	37	43	43
LPG Capacity (approx. gallons)	14	14	14	14	14	14
Auto Ignition Furnace (1000 BTU's)	20	20	20	20	20	20

Your Northwood Dealer



Updated Sep. 2025