

VENGEANCE 26L140 FLOORPLAN

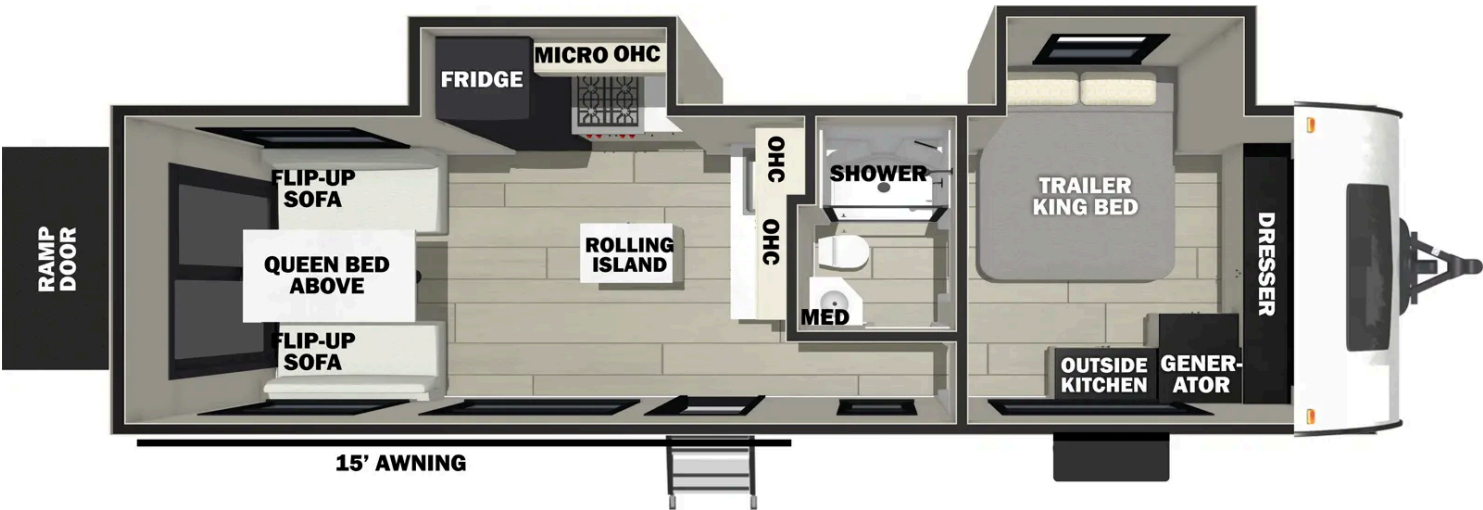

Hitch Weight	1,465 lb.	GVWR	13,465 lb.
UVW	8,704 lb.	CCC	4,761 lb.
Exterior Length	34' 0"	Exterior Height	12' 10"
Exterior Width	102"	Fresh Water	102 gal.
Gray Water	50 gal.	Black Water	50 gal.
Awning Size	18'		

SPECIFICATIONS DEFINITIONS

GVWR (Gross Vehicle Weight Rating) – is the maximum permissible weight of the unit when fully loaded. It includes all weights, inclusive of all fluids, cargo, optional equipment and accessories. For safety and product performance do NOT exceed the GVWR.

GCWR (Gross Combined Weight Rating) – is the maximum permissible loaded weight of your motor home and any towed trailer or towed vehicle. Actual GCWR of this vehicle may be limited by the sum of the GVWR and the installed hitch receiver maximum capacity rating; see hitch rating label for detail.

GAWR (Gross Axle Weight Rating) – is the maximum permissible weight, including cargo, fluids, optional equipment and accessories that can be safely supported by a combination of all axles.

UVW (Unloaded Vehicle Weight)* – is the typical weight of the unit as manufactured at the factory. It includes all weight at the unit's axle(s) and tongue or pin and LP Gas. The UVW does not include cargo, fresh potable water, additional optional equipment or dealer installed accessories.

*Estimated Average based on standard build optional equipment.

CCC (Cargo Carrying Capacity) ** – is the amount of weight available for fresh potable water, cargo, additional optional equipment and accessories. CCC is equal to GVWR minus UVW. Available CCC should accommodate fresh potable water (8.3 lbs per gallon). Before filling the fresh water tank, empty the black and gray tanks to provide for more cargo capacity.

****Estimated Average based on standard build optional equipment.**

Each Forest River RV is weighed at the manufacturing facility prior to shipping. A label identifying the unloaded vehicle weight of the actual unit and the cargo carrying capacity is applied to every Forest River RV prior to leaving our facilities.

The load capacity of your unit is designated by weight, not by volume, so you cannot necessarily use all available space when loading your unit.

Actual towing capacity is dependent upon your particular loading and towing circumstances, which includes the GVWR, GAWR and GCWR as well as adequate trailer brakes. Please refer to the Operator's Manual of your vehicle for further towing information.

Note: Specifications are subject to change without notice.

EXTERIOR AMENITIES

- 102" Wide Body Construction
- Aluminum Frame Sidewalls
- Laminated Sidewalls, Slideout Walls and Ceiling
- Armored Ultra-View Windshield
- Generator Prep with Start/Stop Switch, and Hour Meter & Fuel Gauge
- 30 Gal. Fuel Station with Digital Readout
- Ramp Door Patio System
- Spare Tire & Carrier
- Dual LED Ramp Cargo Lights
- Exterior Compartment Lights
- 360 Degree Surround Lighting when Back Up Lights are Activated
- LED Brake/Tail Lights
- Solar Reflective Windows
- Power Awning w/LED Lights
- LP Quick Connect
- Tire Pressure Monitor System
- Outside Shower/Sprayer
- Radius PVC Walk On Roof

INTERIOR AMENITIES

- 10.7 Cu. Ft. 12 Volt Black Glass Residential-Style Refrigerator
- 30" Residential-Style Microwave
- 3 Burner Range w/Oven
- Solid Surface Countertops
- Zebra Shades in Living Areas
- Recliner Sofas w/ Heated Seats, LED Lights, and Massage
- LED Batten Lighting w/ Dimmer Switch in Living Areas
- LED Flatscreen TV with Bluetooth Stereo Sound Bar
- 4K Projector with Pull Down Screen in Master Bedroom
- Black Glass Entry Doors
- Multiple USB Charging Stations
- Multi Function Kitchen Sink
- Pull Down Spray Faucet
- Spa Shower in Master Bath
- Glass Shower Doors
- Porcelain Foot Flush Toilets
- Padded Headboard with Arm Rests & Cup Holders
- Skylight Over Shower

- Power Vent Fan in Master Bath

EQUIPMENT

- LED Smart TV with Bluetooth Soundbar
- 200 Watt Roof Mounted Solar Charging System
- 6,000 lb. Axles
- " Aluminum Wheels
- On Demand Tankless Water Heater
- 50AMP Service with Detachable Power Cord
- Four Point Backup/Observation Camera ready
- 35,000 BTU Furnace with Ducted Heating
- 15,000 BTU A/C
- Heated Enclosed Holding Tanks w/12 Volt Heat Pads on Every Tank
- 102 Gallon Fresh Tank Capacity

GARAGE AMENITIES

- Quick Set Garage Bed System
- Flip-up Garage Sofas w/ Table
- 5,000 lb. Tie Downs Mounted Thru Steel Chassis Plates
- DuraPoxy® Gas/Oil Resistant Flooring
- Solid Seal Glass Vapor Door
- Rear Screen Wall
- Ram Air Vents (2)
- Power Fan Roof Vent
- 3,000 lb. Rated Ramp Door
- Ducted A/C, Ducted Heat
- Snap On Blackout Shades
- Exterior Entry Door

ROGUE PREMIUM PACKAGE (STANDARD)

- 100% LED Batten Lighting with Dimmer Switch
- 3 Burner Stovetop with " Oven & Matching Drawer
- Turntable Microwave
- 50AMP Electrical Service and Marine Style Detachable Power Cord
- 65 Amp Converter
- 8' Weatherproof Ramp Door
- Armored Underbelly Tank Enclosure and Forced Air Heat to All Holding Tanks
- Living Room Entertainment Center with TV and Sound Bar
- DUR-A-POXY Garage Floor with 5,000lb Tie Downs
- Exterior TV Hook Up
- Laminated Sidewalls, Slide Out End Walls and Roof

- Video Projector in Bedroom
- 360 Degree "Surround" Exterior Lighting when Truck is In Reverse
- Multiple USB Charging Ports in Bedroom, Living Area and Garage
- Pre Wired for additional A/C
- Real Blackout Glass, Safety Slam, Friction Hinge Entry Door with Window
- Multi-Function Stainless Steel Kitchen Sink
- Seamless PVC Roofing Membrane with Heat Reflectivity
- Blue Accent Wheels
- Central Air Conditioning Unit (15,000 BTU) with Quick Cool Air Dump Feature
- Solar Reflective Safety Glass Windows

ROGUE READY PACKAGE (STANDARD)

- 12V Master Switch-Battery Disconnect
- Carbon Monoxide Detector
- Detachable Power Cord
- Outside Shower with Hot and Cold Water
- Spare Tire
- Quad Observation Camera Prep (Rear/Garage/Left and Right Front Marker light)
- 10.7 Cubic ft. Double Door Refrigerator
- 15,000 BTU Air Conditioner
- Fuel Station with Pump, Generator Prep and Transfer Switch
- 6,000# Axles with 8 Lug Wheels
- King Bed with Comfort Sit Headboard
- Exclusive POWER MAXX Wide Spread Chassis
- Ramp Door Patio System
- Rogue Stable Step at Main Entrance Door
- Garage Screen Wall / Tent Wall
- TST Tire Pressure Monitoring System
- Ultracold Heated Holding Tank Pads
- Zebra Shades (Light Filtering and Blackout Capable)
- Tankless On Demand Water Heater
- Extra Large Entry Door Handrail
- 200 Watt Solar System with 30AMP Controller