

WESTERN EDITION

# BULLET

CROSSFIRE, BULLET & PREMIER TRAVEL TRAILERS



KEYSTONE  
RV COMPANY

CAMP BETTER

## 2023 BULLET | EXCEPTIONAL FEATURES

- WALKABLE ROOF & REAR LADDER\*
  - REAR LADDER PREP (CROSSFIRE ONLY)
  - HYPERDECK™ WATER-RESISTANT FLOORING
  - HEATED AND ENCLOSED UNDERBELLY FOR EXTENDED SEASON CAMPING
  - LCI SOLID STEP\*
  - POWER STABILIZER JACKS, TONGUE JACK, AND AWNINGS
  - GIGGY BOX 12V DISTRIBUTION CENTER FOR ADDED ORGANIZATION AND PROTECTION
  - EXTERIOR DOCKING STATION\*
  - 51 CU. FT. PASS-THROUGH STORAGE WITH PEG BOARD STORAGE PANEL\*
  - DOMED CEILINGS\*
  - **NEW** GIRARD TANKLESS WATER HEATER
  - DREAM DINETTE™ (SELECT MODELS)\*
  - STAINLESS STEEL FARMHOUSE STYLE SINK
  - CONVERTIBLE CABINETS
  - RESIDENTIAL, 60" X 80" QUEEN-SIZED BED\*
  - PILLOW-SIDE SHELVING, DESIGNED FOR CPAP MACHINES
  - LAUNDRY CHUTE
  - SOLARFLEX 200 AND 400I SOLAR POWER PACKAGES W/OPTIONAL DRAGONFLY ENERGY LITHIUM-ION BATTERIES
  - FULL MOLDED FIBERGLASS FRONT CAP (PREMIER MODELS ONLY)
  - SOLID SURFACE COUNTERTOPS (PREMIER ONLY)
- \*N/A ON CROSSFIRE MODELS



"I knew that I wanted a fiber-glass camper shell, no slides, a large picture window, a full kitchen, a full bathroom, a separate bedroom, and tons of storage - all in an RV under 22 feet. Keystone RV delivered. My floorplan has a murphy bed and that created the feel of a separate sleeping space while having the bed completely out of sight during the daytime. As for storage? I currently have a 4-person hot tub in the basement storage of my travel trailer!"



@ALEXISCHATEAU\_ — **BULLET CROSSFIRE 1800RB OWNERS**



"I choose Keystone RV for the workmanship and the pride they take in their products. I choose my Keystone Premier 22RBPR because the layout fits my lifestyle perfectly. Normally I travel on my own and it's the perfect amount of space for me, and if my fiancé Ali comes there's enough space for the two of us and even our dog Piper. We love our Keystone Premier!"



@KYLE\_PEPERZ — **BULLET PREMIER 22RBPR OWNER**





BULLET 287QBS



BULLET 332BHS



PREMIER 25RKPR

VISIT OUR WEBSITE FOR PHOTOS, 360° TOURS, AND FULL PRODUCT DETAILS



# FIRST TIME CAMPER SERIES



**NEW TO CAMPING?** Keystone RV's Matt Ardent & Bart Taylor walk you through everything you need to know from your pre-travel checklist to full campsite set-up. You can find this series on Keystone's YouTube channel or follow this QR code to our website.

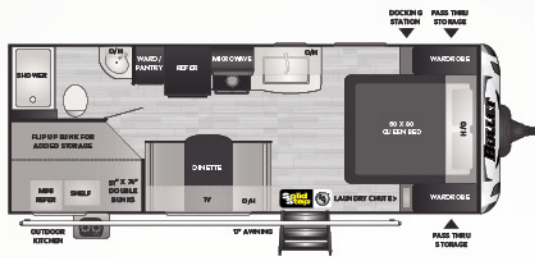

**211BHSWE** | WEIGHT 4648 | LENGTH 26' 5"

• DOUBLE BUNKS, WALK-AROUND QUEEN, OUTSIDE KITCHEN

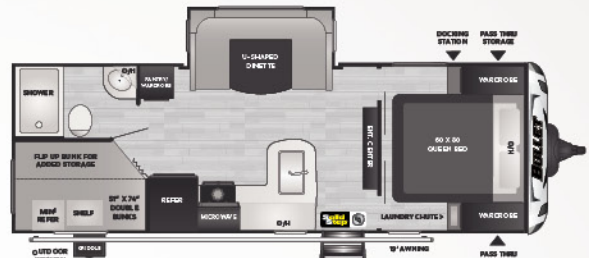

**243BHSWE** | WEIGHT 5354 | LENGTH 28' 10"

• DOUBLE BUNKS, DINETTE SLIDE, OUTSIDE KITCHEN

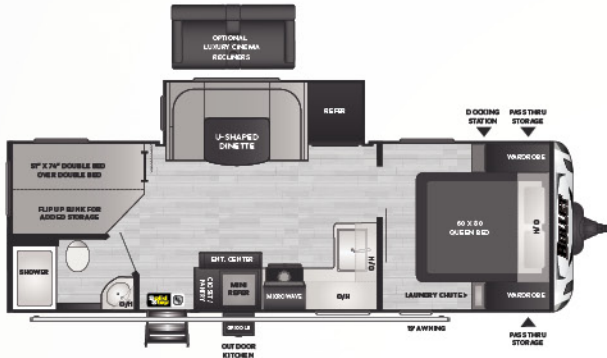

**250BHSWE** | WEIGHT 5524 | LENGTH 28' 8"

• DOUBLE BUNKS, DINETTE SLIDE, OUTSIDE KITCHEN

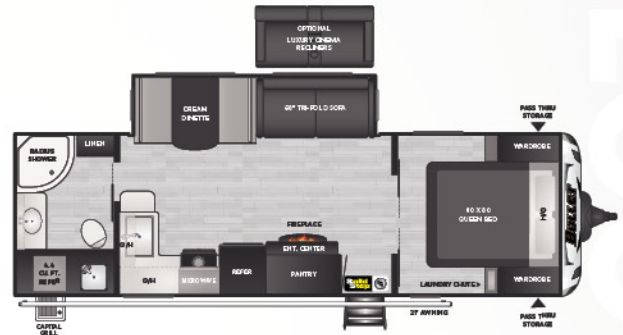

**NEW!** **260RBSWE** | WEIGHT TBD | LENGTH TBD

• REAR BATH, OUTSIDE KITCHEN

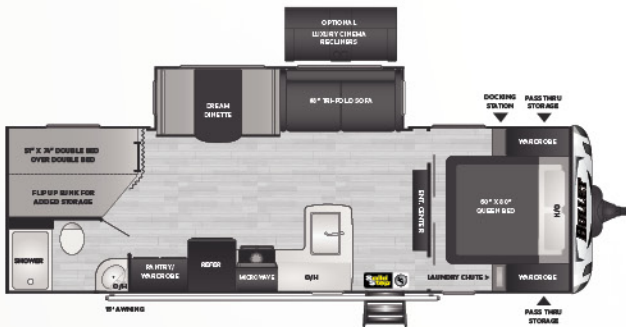

**273BHSWE** | WEIGHT 5746 | LENGTH 31' 9"

• DOUBLE BUNKS, SUPER SLIDE

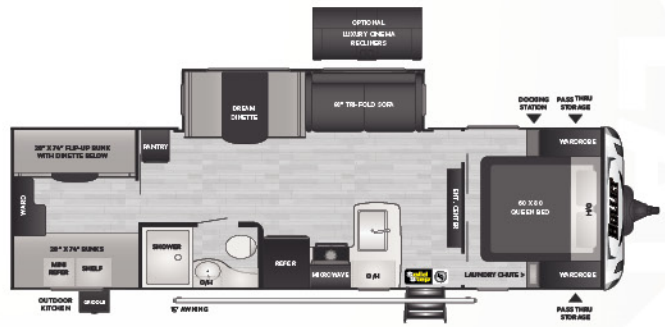

**287QBSWE** | WEIGHT 6170 | LENGTH 33' 10"

• QUAD BUNKROOM, SUPER SLIDE, OUTSIDE KITCHEN

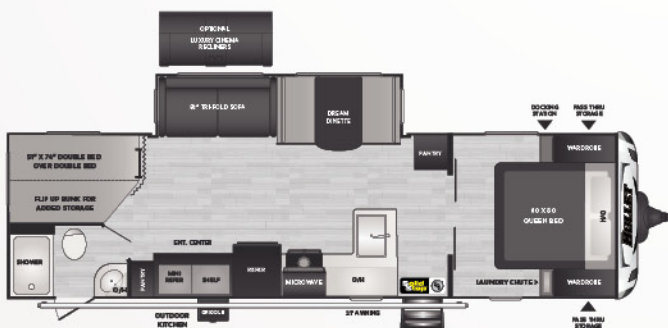

**290BHSWE** | WEIGHT 6150 | LENGTH 33' 9"

• DOUBLE BUNKS, SUPER SLIDE, OUTSIDE KITCHEN

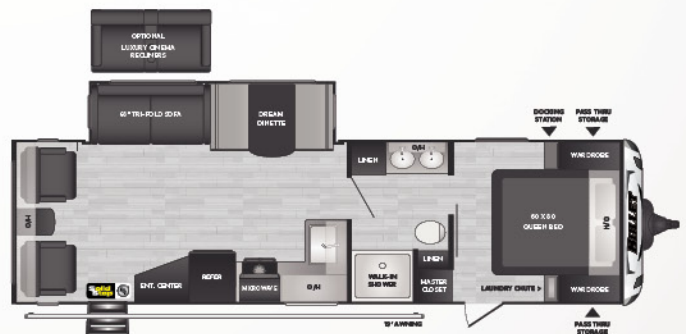

**291RLSWE** | WEIGHT 6192 | LENGTH 33' 11"

• REAR LIVING, SUPER SLIDE



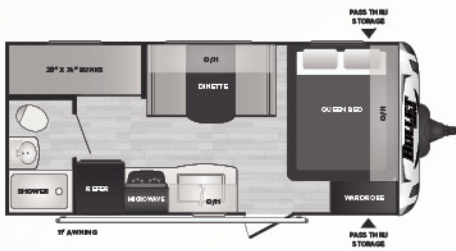

**1700BH** | WEIGHT 3694 | LENGTH 21' 4"  
**CROSSFIRE** • BUNKS, SINGLE AXLE



**1800RB** | WEIGHT 3657 | LENGTH 21' 4"  
**CROSSFIRE** • REAR BATH, MURPHY BED, SINGLE AXLE

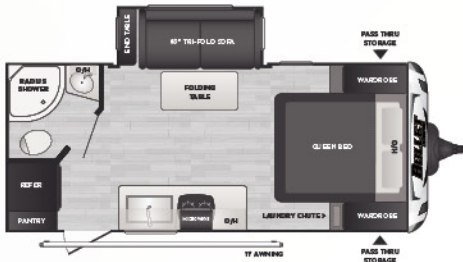

**1850RB** | WEIGHT 4175 | LENGTH 22' 4"  
**CROSSFIRE** • REAR LIVING, STACKABLE W/D PREP, THREE SLIDES

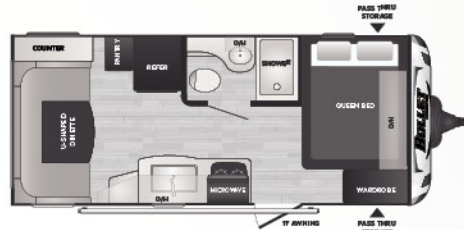

**1900RD** | WEIGHT 3760 | LENGTH 21' 11"  
**CROSSFIRE** • REAR DINETTE, SINGLE AXLE

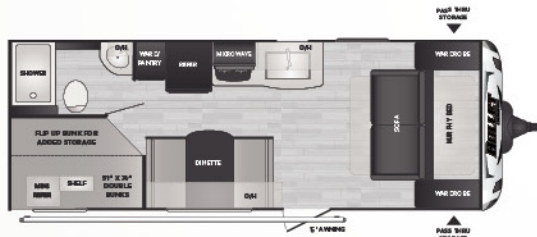

**2200BH** | WEIGHT 4487 | LENGTH 25' 4"  
**CROSSFIRE** • DOUBLE BUNKS, MURPHY BED, OUTSIDE KITCHEN

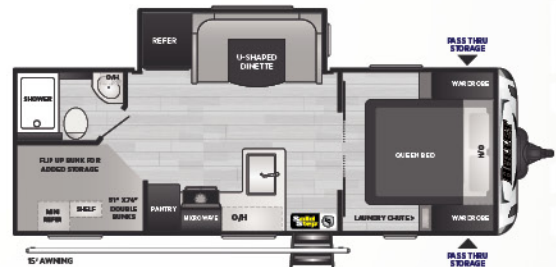

**NEW!** **2290BH** | WEIGHT TBD | LENGTH 27' 0"  
**CROSSFIRE** • REAR BATH, DOUBLE BUNKS

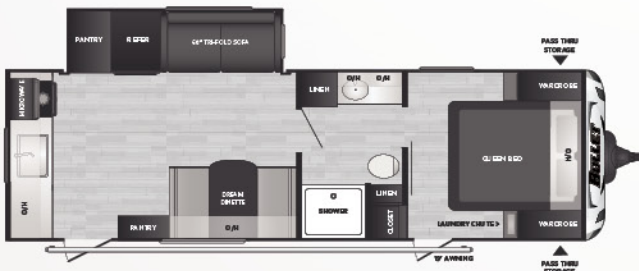

**2500RK** | WEIGHT 5630 | LENGTH 29' 11"  
**CROSSFIRE** • REAR KITCHEN, SOFA SLIDE

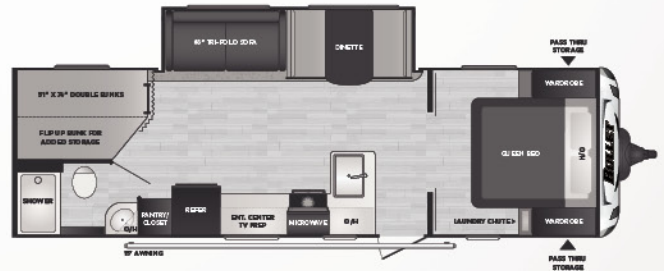

**2730BHS** | WEIGHT 5544 | LENGTH 31' 2"  
**CROSSFIRE** • DOUBLE BUNKS, SUPER SLIDE

CROSSFIRE

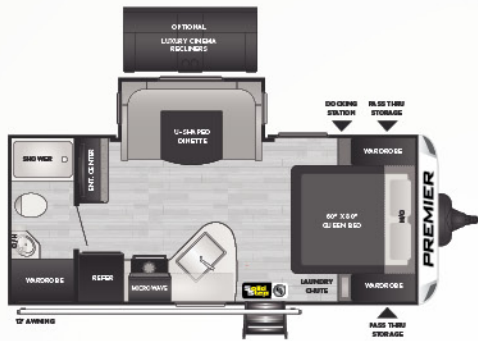

**19FBPR** | WEIGHT 4713 | LENGTH 24' 0"  
**PREMIER** • REAR BATH, DINETTE SLIDE

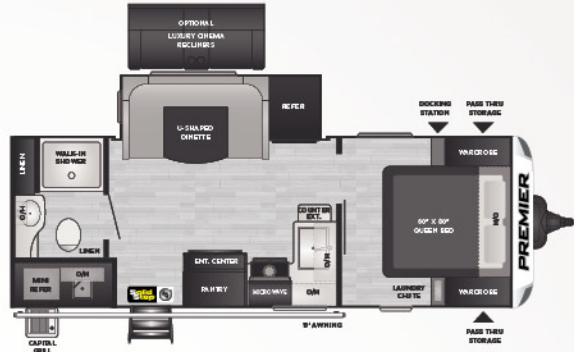

**23RBPR** | WEIGHT 5554 | LENGTH 27' 5"  
**PREMIER** • REAR BATH, DINETTE SLIDE, OUTSIDE KITCHEN

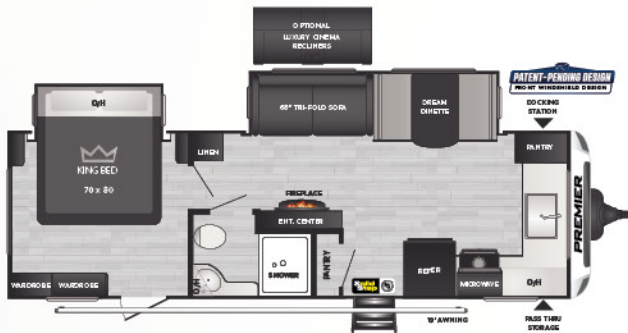

**25FKPR** | WEIGHT 6535 | LENGTH 30' 10"  
**PREMIER** • FRONT KITCHEN, KING BED, BEDROOM SLIDE



**25RKPR** | WEIGHT 6165 | LENGTH 29' 11"  
**PREMIER** • REAR KITCHEN, OPPOSING SLIDES

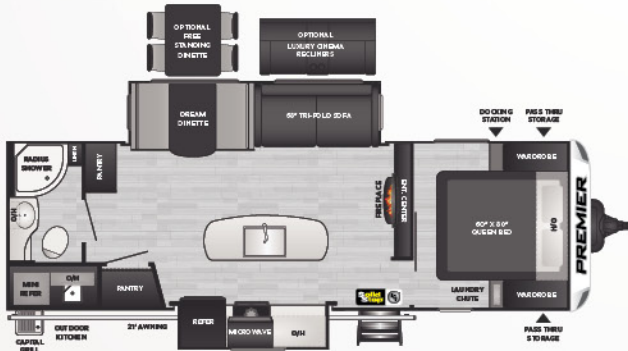

**26RBPR** | WEIGHT 6560 | LENGTH 31' 10"  
**PREMIER** • REAR BATH, ISLAND KITCHEN, OUTSIDE KITCHEN

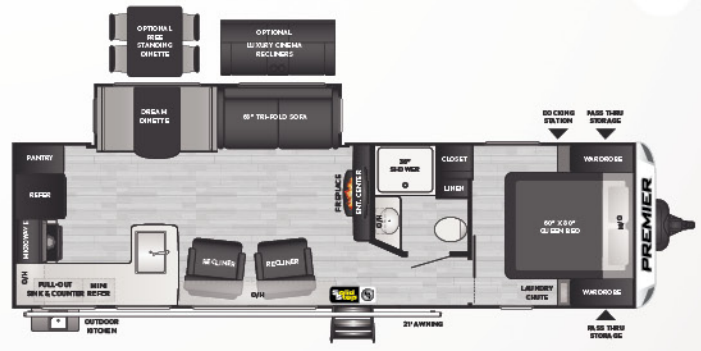

**29RKPR** | WEIGHT 6890 | LENGTH 34' 3"  
**PREMIER** • REAR KITCHEN, SUPER SLIDE, OUTSIDE KITCHEN

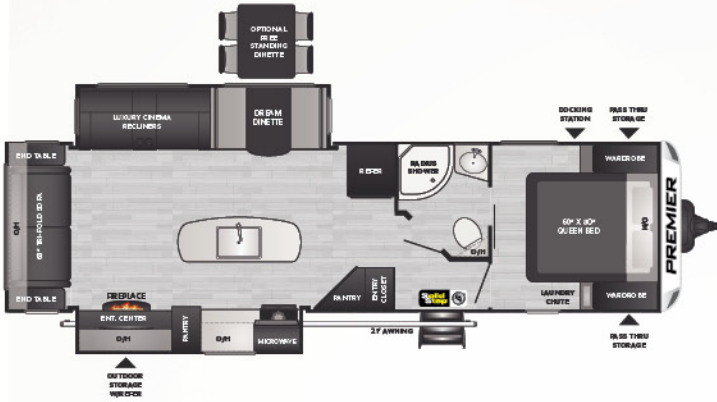

**30RIPR** WEIGHT 7241 LENGTH 35' 9"

PREMIER • REAR LIVING, ISLAND KITCHEN, OUTSIDE ENTERTAINMENT

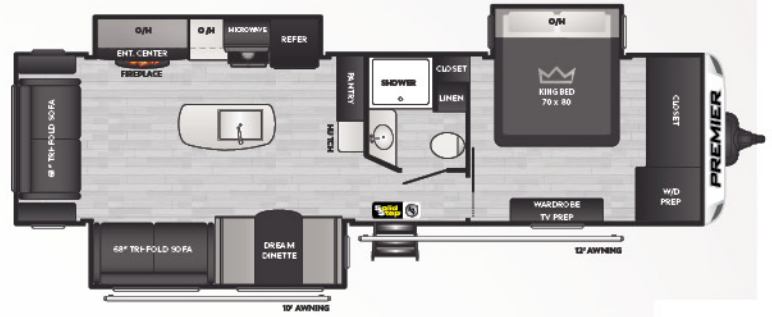

**NEW! 31REPR** WEIGHT TBD LENGTH TBD

PREMIER • REAR ENTERTAINMENT, ISLAND KITCHEN, KING BED SLIDE

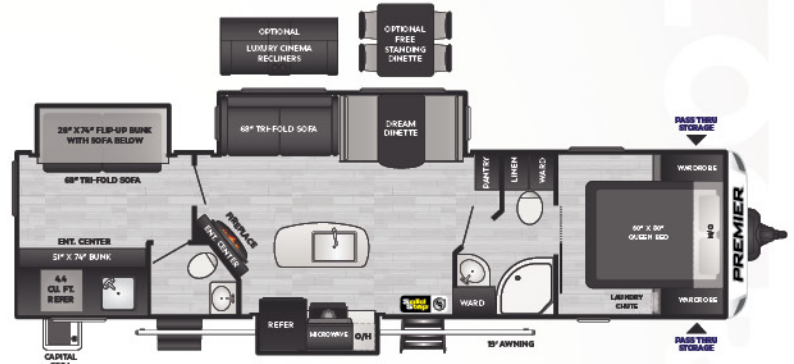

**NEW! 33BKPR** WEIGHT 8185 LENGTH 37' 11"

PREMIER • REAR BUNKROOM, BATH AND A HALF

\*\*EFFECTIVE W/ MODELS BUILT ON 10/1/22 AND LATER (EASTERN BUILD ONLY)

| MODEL    | WEIGHT | CARRYING CAPACITY | HITCH WEIGHT | FRESH WATER** | WASTE WATER | GRAY WATER | LPG | LENGTH* | WIDTH | HEIGHT  | AWNING |
|----------|--------|-------------------|--------------|---------------|-------------|------------|-----|---------|-------|---------|--------|
| 211BHSWE | 4648   | 1752              | 470          | 54            | 38          | 38         | 40  | 26' 5"  | 8'    | 10' 9"  | TBD    |
| 243BHSWE | 5354   | 1146              | 630          | 54            | 38          | 38         | 40  | 28' 10" | 8'    | 10' 9"  | 19'    |
| 250BHSWE | 5524   | 1876              | 700          | 54            | 38          | 76         | 40  | 28' 8"  | 8'    | 10' 8"  | 21'    |
| 260RBSWE | TBD    | TBD               | TBD          | 54            | 30          | 60         | 40  | 30' 6"  | 8'    | 10' 8"  | 19'    |
| 273BHSWE | 5746   | 1854              | 675          | 54            | 38          | 38         | 40  | 31' 9"  | 8'    | 10' 9"  | 19'    |
| 287QBSWE | 6170   | 1430              | 746          | 54            | 38          | 38         | 40  | 33' 10" | 8'    | 10' 8"  | 15'    |
| 290BHSWE | 6150   | 1450              | 690          | 54            | 38          | 76         | 40  | 33' 9"  | 8'    | 10' 8"  | 21'    |
| 291RLSWE | 6192   | 1408              | 690          | 54            | 38          | 38         | 40  | 33' 11" | 8'    | 10' 8"  | 19'    |
| 1700BH   | 3694   | 1006              | 375          | 54            | 30          | 30         | 40  | 21' 4"  | 8'    | 10' 4"  | 11'    |
| 1800RB   | 3657   | 743               | 480          | 54            | 30          | 30         | 40  | 21' 4"  | 8'    | 10' 5"  | 11'    |
| 1850RB   | 4175   | 525               | 430          | 54            | 30          | 30         | 40  | 22' 4"  | 8'    | 10' 10" | 11'    |
| 1900RD   | 3760   | 940               | 490          | 54            | 30          | 30         | 40  | 21' 11" | 8'    | 10' 5"  | 11'    |
| 2200BH   | 4487   | 1813              | 425          | 54            | 30          | 30         | 40  | 25' 4"  | 8'    | 10' 4"  | 15'    |
| 2290BH   | TBD    | TBD               | TBD          | 54            | 30          | 30         | 40  | 27' 0"  | 8'    | 10' 8"  | 15'    |
| 2500RK   | 5630   | 1870              | 660          | 54            | 30          | 60         | 40  | 29' 11" | 8'    | 10' 8"  | 19'    |
| 2730BH   | 5544   | 2056              | 630          | 54            | 30          | 30         | 40  | 31' 2"  | 8'    | 10' 8"  | 15'    |
| 19FBPR   | 4713   | 1787              | 480          | 54            | 30          | 30         | 40  | 24' 0"  | 8'    | 11' 0"  | 12'    |
| 23RBPR   | 5554   | 1446              | 655          | 54            | 30          | 60         | 40  | 27' 5"  | 8'    | 11' 0"  | 15'    |
| 25FKPR   | 6535   | 1065              | 725          | 54            | 30          | 60         | 40  | 30' 10" | 8'    | 11' 0"  | 21'    |
| 25RKPR   | 6165   | 1435              | 795          | 54            | 30          | 60         | 40  | 29' 11" | 8'    | 11' 0"  | 19'    |
| 26RBPR   | 6560   | 940               | 755          | 54            | 30          | 60         | 40  | 31' 10" | 8'    | 11' 0"  | 21'    |
| 29RKPR   | 6890   | 1000              | 890          | 54            | 30          | 60         | 40  | 34' 3"  | 8'    | 11' 1"  | 21'    |
| 30RIPR   | 7241   | 959               | 865          | 54            | 30          | 60         | 40  | 35' 9"  | 8'    | 11' 2"  | 21'    |
| 31REPR   | TBD    | TBD               | TBD          | 54            | TBD         | TBD        | TBD | TBD     | TBD   | TBD     | TBD    |
| 33BKPR   | 8185   | 1615              | 1050         | 54            | 60          | 60         | 40  | 37' 11" | 8'    | 11' 4"  | 21'    |





## TAKE CHARGE OF HOW YOU CAMP

EXCEPTIONAL QUALITY, IMPOSSIBLY VERSATILE, SolarFlex™ IS SHATTERING CUSTOMER'S EXPECTATIONS OF FACTORY-INSTALLED SOLAR POWER. EXCLUSIVELY AVAILABLE ON ALL KEYSTONE RV MODELS.



Relieve battery anxiety with legendary Lithium-ion deep cycle batteries – the ultimate replacement for lead acid. Lightweight, reliable, and longer-lasting, Dragonfly Energy batteries are made in the USA and available exclusively from Keystone RV and authorized dealers.

## MY KEYSTONE OWNER'S APP

THE ONLY APP YOU'LL NEED...

» MANUALS & QUICK START GUIDES

» HOW-TO VIDEOS



» FIRST-TIME CAMPER'S ADVICE

» ACCESS TO YOUR RV'S MOBILE APPS

Available for iOS and Android devices.



FOLLOW US FOR THE LATEST!



DISCLAIMER: Product Information is as accurate as possible as of the date of publication of this brochure. All features, floor plans, and specifications in this brochure are subject to change without notice. Please also consult Keystone's web site at [www.keystonerv.com](http://www.keystonerv.com) for more current product information and specifications. Tow Vehicle Disclaimer. CAUTION: Owners of Keystone recreational vehicles are solely responsible for the selection and proper use of tow vehicles. All customers should consult with a motor vehicle manufacturer or their dealer concerning the purchase and use of suitable tow vehicles for Keystone products. Keystone disclaims any liability or damages suffered as a result of the selection, operation, use or misuse of a tow vehicle. KEYSTONE'S LIMITED WARRANTY DOES NOT COVER DAMAGE TO THE RECREATIONAL VEHICLE OR THE TOW VEHICLE AS A RESULT OF THE SELECTION, OPERATION, USE OR MISUSE OF THE TOW VEHICLE. \*Length is defined as the distance from the centerline of hitch pin/coupler to rear bumper of trailer. \*\* Fresh water capacity includes water heater. Please review owner's manual prior to purchase for more information on service warranties, extended use, towing and maintenance. Owner's manuals can be found at [keystonerv.com](http://keystonerv.com).

PRINT 09.2022