

1999 INTRUDER  
CLASS A MOTORHOMES

Now you're going places



*Damon*  
Value by Design

# 1999 Intruder

## *EASILY YOURS*

Living affordably is one thing. Living well is another. Or is it? An Intruder Motorhome could change your mind. Go ahead. Take a good look at it. It's a luxury RV, right? All those gorgeous appointments make that clear. Ah, but you're in for a pleasant surprise. You see, at Damon, we have years of experience building for value. We know how to get genuine luxury into an RV without putting it out of your reach. And nothing shows this better than our 1999 Intruder. Yes, yes, we know. Everybody says their RVs are affordable. Or a great value. But where's the value in getting a lot of features you don't need just because the price is right? Intruder's value lies in practical, pleasurable features like these:

- Exceptionally roomy, open floor plans that let you stretch out and relax — some models even have space-adding slideouts
- A choice of Cotillion, BlackTie or Protocol decor packages, all of which include rich wood cabinet doors and fashionable, understated wall coverings

Model 349 • BlackTie decor • Light Oak





# r u d e r

- Interior details that truly define luxury — such as designer pillows; elegant residential-style lighting; a big, plush super-comfortable sofa — L-shaped in select models, with the L-section reclinable; a functional high-low table in L-shaped-sofa living rooms; and attractive plank flooring standard in the kitchen area
- Abundant storage space — why leave anything behind? Intruder lets you bring it all
- A spacious freestanding wood dinette with plush, decor-coordinated upholstery and a striking profile — or the option of a new booth-style dinette
- Large windows for optimum visibility, ventilation and light
- Elegant window treatments — including smart, contemporary, fabric-covered lambrequins and decorator valances
- Day/night shades, standard, for added privacy
- A windshield drape for extra privacy — with a new traverse rod that not only looks smarter but simplifies opening and closing the drape



Model 351 • Cotillion decor • Light Oak



- A unique StepSaver™ kitchen — thoughtfully laid out to make meal preparation quick and easy; among its many standards are a big, oak-front, double-door refrigerator; a three-burner range; a carousel microwave; a slideout pantry in select models; a cutlery drawer; a European-styled, double-bowl sink that resists stains, scratches, dents and heat; a sink cover that increases your countertop space; and a solid-surface, decor-coordinated countertop that's as easy to clean as it is on the eyes
- A bedroom you'll welcome for its eye-pleasing, body-embracing comforts: rich cabinetry and trim; decorator lighting; a queen-size bed with a mirrored headboard; a plush pillow-top mattress; and a designer bedspread that matches the window treatments
- A charming, fully appointed bathroom complete with beautiful cabinetry; an oak-framed, mirrored medicine cabinet; a solid-surface, decor-coordinated countertop; and a full-height fiberglass tub or shower (depending on the model) with a built-in skylight for greater brightness and a more open, airy feeling
- Supreme comfort in any climate, year-round, thanks to Intruder's exclusive Comfort Control Center™



Model 351 • BlackTie decor



Model 349 • BlackTie decor • Light Oak





# r u d e r

## STORAGE, STORAGE ... AND MORE STORAGE



Veteran RVers know it. First-timers soon discover it. You can never have too much storage in an RV. Intruder Motorhomes take it to the max.

Most models, for instance, have an exterior pass-through storage compartment that provides a whopping 106 cubic feet of space for stowing bulky items like bicycles. These compartments are made of seamless, high-density, rotocast polyethylene, which is much stronger than galvanized steel. You'll like the fact that the entire basement storage area is heated and insulated too — so it's perfect for cold-weather storage. And interior lighting makes nighttime loading or unloading a snap. Oh yes: We can't forget to mention that our exterior storage compartment doors now have easy-to-grip paddle handles with latches that grip immediately to keep the doors shut, just like car doors.

Intruder's inside storage is equally impressive. There's a roomy, provision-accommodating pantry with slideout shelving bins in the StepSaver™ kitchen. Then, in the bedroom, you'll find a huge, cedar-lined storage area under the bed and large-drawered nightstands on either side of it.

Of course, there's plenty more storage in the handsome drawers, cupboards and shelves we've installed throughout Intruder. As far as we're concerned, storage is no luxury ... it's a necessity.

Model 351 • Cotillion decor • Light Oak

## EXPAND ON DEMAND

You want more living space in your Intruder? You've got it! All it takes is the push of a button, and Damon slideouts glide smoothly into position, expanding a room like magic.

Note too how big our slideout windows are. They really help "open up" the interior, giving it a lighter, airier feel — and giving you a better view of your surroundings.



## TAKE COMMAND OF THE ROAD

No doubt about it, the Intruder is a lot of motorhome. But you wouldn't know that to drive it: It handles like a dream. In fact, it's one of the most driveable RVs on the road today. And that's due in no small measure to the comforts we provide in the cab.

Take the dashboard. Its standard burl finish is especially striking. More important, all instruments here are positioned for easy viewing and easy access. The AM/FM/cassette player is standard. But, if you like, you have the option of an AM/FM/CD player. And the dash-mounted heating and cooling controls now have the simpler, more familiar automotive-style configuration.

The driver and passenger seats provide maximum comfort, maximum back support. They're easy to get in and out of too: both swivel and recline. An optional driver's door is also available to make the cab more accessible.

Plus, you get all the best "driveability" features standard, such as an automatic transmission, cruise control, power steering, automotive-style heat and air conditioning, and much more.

Intruder's vast, panoramic windshield gives you a clear, uninterrupted view of the road ahead. And, because it's tinted, there's less glare — you're spared the eyestrain that often results from long drives. Pantographic dual-arm windshield wipers and remote-controlled dual side mirrors add more safety and convenience. Those side mirrors, by the way, are positioned slightly forward of the windshield so they can be viewed peripherally without having to turn your attention from the road ahead. They also let you see all along the sides of your Intruder, front to back.

Intruder also offers an optional backup monitor system that lets you look directly behind your motorhome when you've got it in reverse. The monitor is mounted so you can watch it without losing sight of the sideview mirrors.



## DAMON DESIGNER DETAILS™

It's the level of detail in every Intruder Motorhome that sets it apart from the competition and makes it such an incredible value. To name just a few of its special accents:

- decorator pillows
- an especially large, horizon-expanding picture window
- contemporary lambrequin window treatments
- a designer wall clock and mirror
- a bathroom skylight
- aisle lights throughout the coach to brighten the interior and provide extra safety at night
- lights in the bedroom wardrobe



# r u d e r



## MORE DAMON STANDARDS TO KEEP LIFE SIMPLE

Here's a Damon feature that really saves you work: Our slideout rooms come with an awning. As the room slides out, the awning automatically unrolls to provide a sloping roof that allows water and debris to run off. No more climbing on the roof for cleanups.



In our utility hookup compartment, you'll find the added bonus of a standard exterior shower featuring hot and cold running water. It's perfect for hosing off dirty feet or for cleaning gear before you come inside.



# r CONSTRUCTION HIGHLIGHTS

Great news. Damon has simplified the task of emptying RV waste tanks. With our exclusive One Flush System™ you can do it from a single, convenient location. Cleanups are nice and tidy too, thanks to the sprayer hose we provide.

Beyond convenience, Intruder offers you peace of mind. This is one tough RV. The roof, for starters, is crowned and laminated, built on a rugged aluminum frame with lauan decking. Up to three inches of expanded polystyrene block-foam insulation helps increase energy efficiency.

This super-solid assembly is then covered with a seamless, one-piece roof top. It's formulated to resist the effects of sun and weather exposure. Not only that, but it acts as a sound barrier, helping to keep the interior quiet. Rest assured, it'll last. It comes with a 12-year warranty.

Here's something else you'll like: 1999 Intruders have a new drivetrain, which effectively increases their payloads. That means you can haul a lot more gear. Plus, you'll find the handling better on hills, sharp curves and rough terrain.



At Damon, we're committed to keeping you on the road, committed to making your getaways as pleasant and trouble-free as humanly possible. That's why, as part of our continuous improvement effort, we've inaugurated Total Quality Service. Among its benefits is a computerized communication network that will link Damon dealers across the country to our corporate offices. Dealers can get parts in a snap. They can also handle your warranty claims faster and more efficiently. And, from our end, we can make sure our dealers always have the latest, most up-to-date service information. Oh, yes, another TQS advantage is that you can now get quality Damon service not just from a Damon dealer, but from virtually any RV dealer anywhere in the country. Damon and TQS. "Now you're going places" for sure!

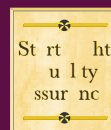

This is a strenuous 400-point inspection test that every Intruder Motorhome must pass before it leaves the factory. We've set our standards high because we know yours are. And it's our goal, always, to go beyond your expectations ... to go the extra mile for you. Result? You're assured years of safe, trouble-free camping.



## BUILT TO ENDURE

Every Intruder Motorhome, indeed, every Damon RV, benefits not only from our years of experience, but from modern, computer-aided design and innovative manufacturing technologies. They help us build products that last, products that retain their value over the years and miles.

Of course, it helps that Intruders offer so much value to begin with. Here, you'll find more standard features, more practical innovations, more storage and living space and more Designer Details™ than in any other motorhomes in their class. And the construction is absolutely first-rate. Features like those shown below make the difference.

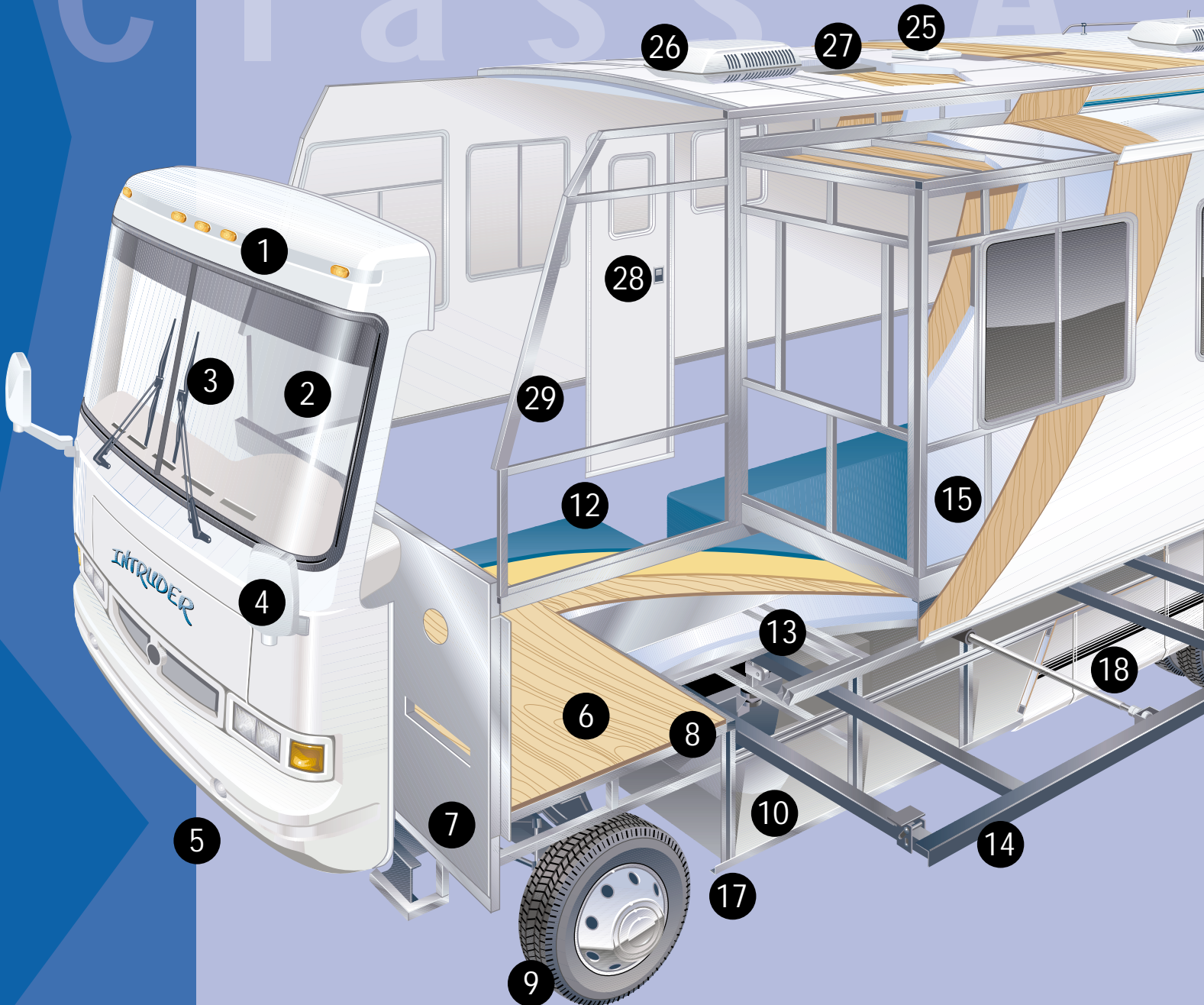

## WARRANTY INFORMATION

One-piece rubber roof - 12 years

Awning - 5 years

Water heater - 2 years

Range - 2 years

Refrigerator - 2 years

Gas sensor - 2 years

General - 3 years

Toilet - 2 years

Power converter - 2 years

Everything else - 1 year



# r u d e r



- 1 A sleek, automotive-looking, fully integrated fiberglass front cap
- 2 A tinted front windshield that not only reduces glare but bars solar heat
- 3 Pantographic, dual-arm windshield wipers that sweep away rain, sleet and snow with ease, giving you maximum visibility
- 4 A front-mounted convex exterior sideview mirror, remote-controlled to allow easy, precise adjustment
- 5 Standard fog lights for increased touring safety
- 6 1/2", seamless, one-piece floor decking for a floor that's solid, level and not as prone to squeak
- 7 A steel firewall that, besides its obvious safety use, adds strength to the front of your Intruder
- 8 Damon's Gentle Ride™ system that reduces noise, vibration and road harshness to give you a smoother, more comfortable ride
- 9 Computerized wheel alignment (part of Damon's 400-point StartRight Quality Assurance Program™) that also helps smooth the ride
- 10 Strong, watertight exterior storage compartments made of seamless, high-density, rotocast polyethylene — much stronger than galvanized steel and easier to clean; interior lights make them easy to load or unload at night
- 11 Sturdy, lightweight, insulated baggage doors with easy-to-grip paddle handles and latches that grip immediately to keep the doors shut — just like car doors
- 12 A high-quality residential carpet with padding for superior comfort and lasting good looks — not to mention the extra insulation it provides
- 13 Heavy-duty, 14-gauge steel trusses welded to the chassis for additional strength and safety
- 14 Damon's electric, gear-driven slideout system with smooth, simple push-button operation
- 15 Full 1/2" expanded polystyrene block-foam insulation in the sidewalls and floor to increase energy efficiency; it also acts as an excellent acoustical barrier
- 16 A fully enclosed and heated freshwater tank with an extra-large, 75-gallon capacity — great for extended travel with fewer stops
- 17 Undercoating and a foam seal to keep the elements out from below
- 18 Damon's exclusive One Flush System™ that allows you to empty your water tanks from one convenient location; a sprayer hose makes cleanups easy
- 19 An increased-capacity (98-gallon) wastewater holding tank that's totally enclosed and heated for worry-free extended use
- 20 Attractive, white, anodized aluminum, radius window frames with large sliding-glass windows that are tinted to keep out solar heat
- 21 An elegant-looking Ice White™ exterior made of durable, easy-to-maintain, one-piece fiberglass with a high-gloss, gel-coat finish
- 22 A fully integrated, aerodynamic rear fiberglass cap with a large-capacity trunk for stowing bulky items (most Intruders average 106 cubic feet of exterior storage space)
- 23 A one-piece seamless roof that comes with a full 12-year warranty and is specifically formulated to resist the ravages of the sun and the elements
- 24 A painted aluminum roof ladder for convenient access to roof storage
- 25 Standard ceiling vents to provide ventilation throughout the coach
- 26 Two ducted roof air conditioners, standard, as part of Damon's Comfort Control Center™: 13.5-BTU in front; 11.0-BTU in back to distribute cool air extra efficiently
- 27 Block-foam insulation for superior energy efficiency; it's integrated with the extruded aluminum framework and lauan decking to create a super-solid crowned roof assembly
- 28 A smart-looking radius-cornered entry door with a white anodized frame
- 29 Aluminum framing throughout to increase strength and prevent leaks

# FLOOR PLANS

- ▲ = Under floor storage
- = Exterior wash down kit

341

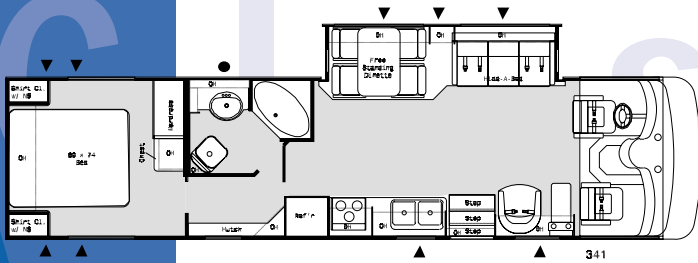

Features: China cabinet • Linen closet • Large garden tub  
• Ample wardrobe storage • Hutch

347

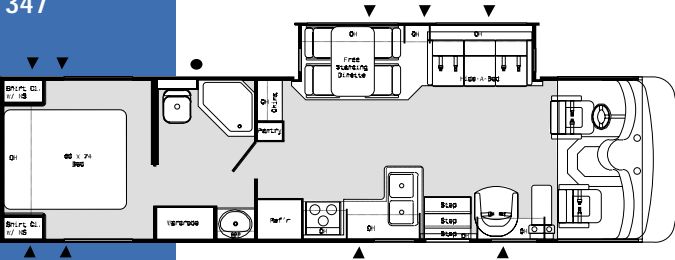

Features: Slideout room • Efficient L-shaped kitchen  
• Freestanding dinette

349

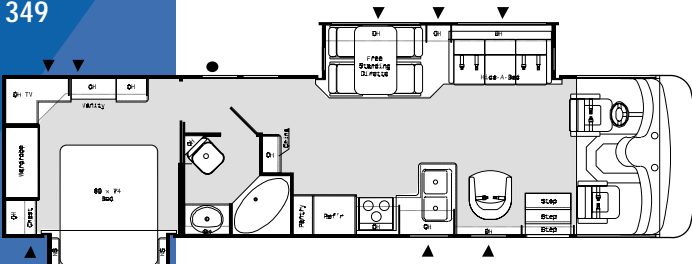

Features: China hutch • Bedroom slideout • Living room  
slideout • Garden tub • Bedroom vanity

## Model 341

Options	A, B, D
Chassis	Ford
Wheelbase	228"
GVWR (lbs.)	20,500
Fuel tank	75
Overall length	35'10"
Overall height with A/C	11'7"
Width	100"
Fresh water system (appx. gal.)	97
Grey water (appx. gal.)	53
Black water (appx. gal.)	53
Sleeping capacity	4
LP gas capacity (appx.)	100 lbs./31gal.

## Model 347

Options	A, D
Chassis	Ford
Wheelbase	216.5"
GVWR (lbs.)	20,500
Fuel tank	75
Overall length	34'6"
Overall height with A/C	11'7"
Width	100"
Fresh water system (appx. gal.)	97
Grey water (appx. gal.)	53
Black water (appx. gal.)	53
Sleeping capacity	4
LP gas capacity (appx.)	100 lbs./31gal.

## Model 349

Options	C, D
Chassis	Ford
Wheelbase	228"
GVWR (lbs.)	20,500
Fuel tank	75
Overall length	35'10"
Overall height with A/C	11'7"
Width	100"
Fresh water system (appx. gal.)	97
Grey water (appx. gal.)	53
Black water (appx. gal.)	53
Sleeping capacity	4
LP gas capacity (appx.)	100 lbs./31gal.



# runder

351

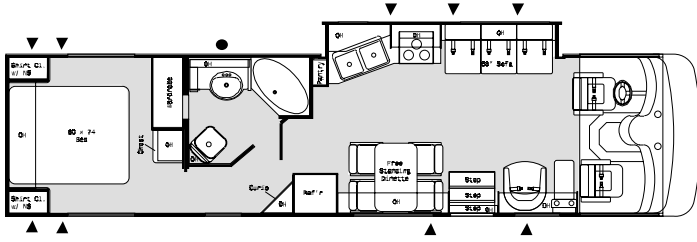

Features: Slideout kitchen • Large garden tub • Pantry in kitchen  
• Freestanding dinette • Curio display cabinet

## Model 351

Options	A, B, E
Chassis	Ford
Wheelbase	228"
GVWR (lbs.)	20,500
Fuel tank	75
Overall length	35'10"
Overall height with A/C	11'7"
Width	100"
Fresh water system (appx. gal.)	97
Grey water (appx. gal.)	53
Black water (appx. gal.)	53
Sleeping capacity	4
LP gas capacity (appx.)	100 lbs./31gal.

352

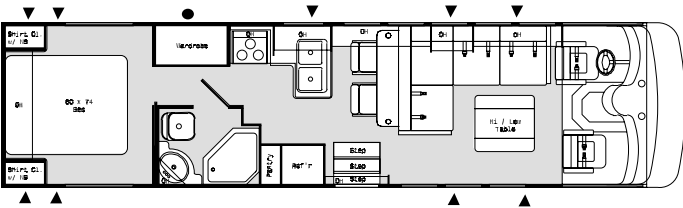

Features : L-shaped sofa • Wide-open living room • Pantry in kitchen  
• Ample wardrobe storage

## Model 352

Options	A, C
Chassis	Ford
Wheelbase	228"
GVWR (lbs.)	20,500
Fuel tank	75
Overall length	35'10"
Overall height with A/C	11'7"
Width	100"
Fresh water system (appx. gal.)	97
Grey water (appx. gal.)	53
Black water (appx. gal.)	53
Sleeping capacity	4
LP gas capacity (appx.)	100 lbs./31gal.

## Options



Option A



Option B



Option C



Option D



Option E

352 546 347 552

# SPECIFICATIONS

	341	347	349	351	352
<b>Exterior</b>					
Ice White™	S	S	S	S	S
Molded fiberglass sidewalls	S	S	S	S	S
Fog lights	S	S	S	S	S
2 porch lights	S	S	S	S	S
Paint package (skirt and mask)	S	S	S	S	S
Awning rail	S	S	S	S	S
Awning*	S	S	S	S	S
Full basement pass-through storage	S	S	S	S	S
Rotocast storage	S	S	S	S	S
Lighted storage	S	S	S	S	S
Locking exterior storage doors	S	S	S	S	S
Gas pistons on exterior storage doors	S	S	S	S	S
Radius corner domed roof	S	S	S	S	S
Roof ladder	S	S	S	S	S
Roof rack	S	S	S	S	S
Rubber roof	S	S	S	S	S
Exterior GFCI receptacle	S	S	S	S	S
Outside shower	S	S	S	S	S
Aerodynamic front fiberglass cap	S	S	S	S	S
Aerodynamic full fiberglass rear cap with trunk storage	S	S	S	S	S
Contoured front and rear integrated bumpers	S	S	S	S	S
Removable grill for service accessibility	S	S	S	S	S
Upgrade gel coat wall	S	S	S	S	S

\*Awnings not available on 100" wide models in some locations. Check local regulations for applicable laws.

	341	347	349	351	352
<b>Living Area</b>					
Skylight with shade	N/A	N/A	N/A	N/A	O
Fantastic power vent	O	O	O	O	O
Video package (control center and player)	S	S	S	S	S
Remote reclining footrest chair	O	O	O	O	N/A
100% nylon carpeting with stain treatment and padding	S	S	S	S	S
Day/night shades	S	S	S	S	S
Fabric ceiling	S	S	S	S	S
Lounge table	S	S	N/A	S	N/A
Wall clock and mirror	S	S	S	S	S
Decorator wall vinyl	S	S	S	S	S
Aisle lights	S	S	S	S	S
Barrel chair	S	S	S	S	N/A

	341	347	349	351	352
<b>Entry</b>					
Electric entrance step	S	S	S	S	S
Radius top entrance door	S	S	S	S	S
Exterior entry-assist lighted grab handle	S	S	S	S	S
Hardwood entry-assist handle	S	S	S	S	S
Deadbolt door lock	S	S	S	S	S

S = Standard    O = Optional    N/A = Not Available



# runder

	341	347	349	351	352
<b>Kitchen</b>					
Booth dinette (slideout)	O	O	O	O	N/A
Freestanding dinette with 4 chairs	S	S	S	S	N/A
Padded dinette top and end	O	O	O	O	N/A
Side-by-side refrigerator	N/A	N/A	O	N/A	O
Solid-wood refrigerator front*	S	S	S	S	S
Large double-door refrigerator	S	S	S	S	S
Ice maker in refrigerator	O	O	O	O	O
Solid-surface countertops	S	S	S	S	S
3-burner range and oven	S	S	S	S	S
Folding range cover	S	S	S	S	S
Lighted power range hood with monitor panel (includes LPG readout)	S	S	S	S	S
Microwave oven	S	S	S	S	S
Coffee maker	S	S	S	S	S
Dust buster	S	S	S	S	S
Faucet/sprayer	S	S	S	S	S
Wood plank flooring*	S	S	S	S	S
Double-bowl, porcelain sink	S	S	S	S	S
Two solid surface sink covers	S	S	S	S	S
Cutlery drawer	S	N/A	N/A	S	N/A
Solid-wood cabinet doors throughout*	S	S	S	S	S
Mini blinds	S	S	S	S	S
Slideout pantry	N/A	N/A	S	S	S
Fire extinguisher	S	S	S	S	S
Wood edge dinette top	O	O	O	O	N/A
Wallpaper border	S	S	S	S	S

\* Light Oak or Pearwood

	341	347	349	351	352
<b>Bathroom</b>					
Power vent	S	S	S	S	S
Full-height fiberglass tub or shower with door	S	S	S	S	S
Medicine cabinet with oak framed door	S	S	S	S	S
Skylight	S	S	S	S	S
Solid-surface countertops	S	S	S	S	S
Porcelain toilet with sprayer	S	S	S	S	S
Wallpaper border	S	S	S	S	S

S = Standard    O = Optional    N/A = Not Available



	341	347	349	351	352
<b>Bedroom</b>					
Twin beds with headboard and bedspreads	0	0	N/A	0	0
Bedspread	S	S	S	S	S
Headboard	S	S	N/A	S	S
Upgrade window treatment	S	S	S	S	S
Cedar-lined bed base	S	S	S	S	S
Queen-size pillow top mattress	S	S	S	S	S
Twin-size pillow top mattresses	0	0	N/A	0	0
Day/night shades	S	S	S	S	S
Wardrobe lights	S	S	S	S	S
AM/FM bedroom stereo	0	0	0	0	0
TV cabinet with jack	S	S	S	S	S
13" TV	0	0	N/A	0	0
19" TV	N/A	N/A	0	N/A	N/A
Carpet-lined wardrobe with mirrored front	S	S	S	S	S

	341	347	349	351	352
<b>Cockpit</b>					
Burl dash	S	S	S	S	S
Dash fans	S	S	S	S	S
Dash air conditioning	S	S	S	S	S
Driver's door with power window	0	0	0	0	0
Ultra leather captain's chairs (set of 2)	0	0	0	0	0
Power 6-way seat (driver only)	0	0	0	0	0
Reclining swivel captain's chairs	S	S	S	S	S
Cruise control	S	S	S	S	S
Protector sun visors (pair)	S	S	S	S	S
Full instrumentation	S	S	S	S	S
Large tinted wraparound windshield	S	S	S	S	S
Full-view bus-style mirrors	S	S	S	S	S
Power steering	S	S	S	S	S
Tilt steering wheel	S	S	S	S	S
Floor mats	S	S	S	S	S
Map lights	S	S	S	S	S
Windshield privacy drape with traverse rod	S	S	S	S	S
Back-up monitor system ready	S	S	S	S	S
Back-up monitor system	0	0	0	0	0
Drink tray	S	S	S	S	S
AM/FM/cassette upgrade stereo	S	S	S	S	S
AM/FM/CD/radio with 10-disc CD changer	0	0	0	0	0

S = Standard    0 = Optional    N/A = Not Available

## PAINT PACKAGES



Misty Jade



Jade Stone



Antique Bronze



Utilities	341	347	349	351	352
50-AMP service	S	S	S	S	S
13.5-BTU central air conditioner in living room	S	S	S	S	S
Air conditioning – 15.0-BTU central in place of 13.5 (front) (N/A with solar battery charger)	O	O	O	O	O
Air conditioning – 11.0-BTU central (bedroom)	S	S	S	S	S
Generator: Onan 5.0	S	S	S	S	S
Generator: Onan 6.5	O	O	O	O	O
Solar battery charger (N/A with 15.0 BTU AC)	O	O	O	O	O
Battery disconnect	S	S	S	S	S
Dual RV batteries	S	S	S	S	S
Telephone hookup	O	O	O	O	O
Water filtration system	O	O	O	O	O
City water hookup	S	S	S	S	S
6-gal. gas water heater with electric ignition	S	S	S	S	S
Heated fresh water tank	S	S	S	S	S
Heated holding tanks	S	S	S	S	S
Water heater by-pass kit	S	S	S	S	S
12-volt demand water pump	S	S	S	S	S
TV antenna with booster	S	S	S	S	S
Cable TV hookup	S	S	S	S	S
19" front color TV with remote	S	S	S	S	S
50-AMP, 120-volt marine power cord	S	S	S	S	S
45-AMP, 12-volt power converter	S	S	S	S	S
35M BTU – electronic ignition floor ducted furnace	S	S	S	S	S
Automatic emergency-start circuit with central control	S	S	S	S	S
Carbon monoxide detector	S	S	S	S	S
LP gas detector	S	S	S	S	S
Smoke detector	S	S	S	S	S

S = Standard    O = Optional    N/A = Not Available



Light Oak

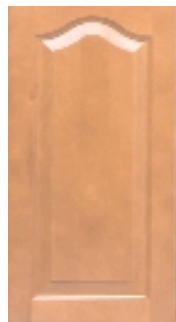

Pearwood



Cotillion



BlackTie



Protocol

## INTRUDER VIDEO OFFER

See an Intruder up close and personal, inside and out, with Damon Corporation's special video tour – just \$10.00 by mail. Send your check, name and address to:

Damon Corporation – Intruder Video  
P.O. Box 2888  
Elkhart, IN 46515



Go RVing.

Your Intruder dealer:

*Damon*

P.O. Box 2888  
Elkhart, IN 46515  
800-577-5692  
[www.DamonRV.com](http://www.DamonRV.com)



Due to constant product improvements, the equipment, specifications, component parts and standard/optional equipment are subject to change without notice or obligation. Product photography or diagrams may show equipment that is optional. Damon Corporation reserves the right to make changes in prices and models, and to discontinue models without notice or obligation. Components, parts, or chassis may have been manufactured at times other than the model year indicated. All capacities are approximate and dimensions are nominal. All dry weights are based on standard model features and do not include optional features or equipment.