



REACHING NEW HEIGHTS

LIGHTWEIGHT • EASY TO TOW
CONTEMPORARY STYLING



ULTRA LITE

NANO



Extended campers and adventure seekers alike will appreciate the award winning 293RLDS. With a standard tri-fold Hide-a-bed sofa, wall hugger recliners and a fireplace, this comfortable coach is a great place to kick back and relax. The contemporary, bar height kitchen island with a generous countertop and plenty of storage will make any cook feel at home.





293RLDS

Apex has always been a leader in Ultra Lites. As Winner of the RV News Best of Show for Lightweight Travel Trailers, Apex 293RLDS continues this tradition! Contemporary interior styling along with functional appointments gives Apex 293RLDS the competitive edge.



The two-tone shower surround and basin found in all our Apex Ultra-Lites are standard on all models. 293RLDS and 226BH also include the upgraded tri-slide shower door (shown).

APEX

By Coachmen

ULTRA LITE

PERFECT FOR SMALLER TOW VEHICLES

Apex Ultra Lites are ideal for towing with half ton trucks and most smaller SUV's, with weights ranging from under 3000 lbs. up to 6500 lbs. All Apex floor plans are designed with rich, warm interiors, contemporary cabinetry, fabrics and flooring. These durable travel trailers are incredibly easy to tow with fully laminated aluminum framed roof and floor, plus lightweight Azdel sidewalls.

Apex is Constructed with Azdel Composite Panels.

AZDEL is 50% lighter than wood, increases insulation value, and won't rot, mold or sustain water damage for years of trouble free camping. Plus it's odor and formaldehyde free.

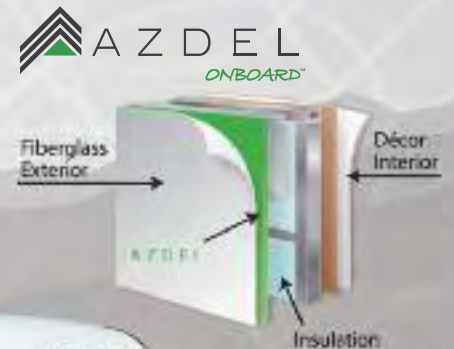



The open, well planned Apex 287BHSS offers a convenient galley/living area with a direct view from the sofa to the TV. An easy flip lower bunk, at the rear of the coach, has a stow-and-go storage door for larger gear. (Shown in Quartz decor)





ULTRA LITE

STANDARD FEATURES

Value Package (Mandatory)

- Vacuum Bond Azdel Fiberglass Walls
- Vacuum Bond Laminated Crowned Roof
- Laminated Floor
- Aluma-cage Construction
- Spare Tire
- Outside Speakers w/LED Lights
- Stabilizer Jacks (4)
- TV Antenna w/Cable Hook-ups
- Enclosed Underbelly w/Forced Air Heat (N/A 7.5' models)
- 13.5 BTU A/C
- Stainless Steel Microwave
- Stainless Steel Double Door Refrigerator
- Lighted Stainless Steel 3 Burner High Output Range w/Oven
- AM/FM/CD/DVD Stereo w/Bluetooth
- Skylight in Bath
- Ball Bearing Drawer Guides
- Evergreen Sleep Mattress
- Two-Tone Grey Fiberglass Exterior Sidewalls
- Dark Grey Exterior Front & Rear Walls
- LED Interior Lighting Throughout
- Power Awning w/LED lights
- LP Port
- Exterior Cable Connection
- Interior Convenience Center
- Solar Prep
- LED Motion Sensor Light in Exterior Storage Area
- Back-up Camera Mount
- Hard Valances
- Night Shades
- LED TV
- Access Doors Under Dinette
- Ground Effects (Metal skirting and ABS fender skirts)
- Magnetic Door Catches

- Diamond Plate Stone Guard
- Hot/Cold Outside Shower
- Bottle Covers
- Black Tank Flush Kit
- USB Charging Station
- Swing Away Assist Handle

Interior and Décor

- Pewter Maple Cabinetry
- Overhead Bedroom Cabinets w/Side Wardrobes
- Seamless Edge Countertops
- Congoleum Diamond Flooring
- Grey Night Shades Throughout
- Pedestal Dinette Table
- Large Oversized Booth w/Sliding Door Storage Access
- U-shaped Dinette w/Sliding Door Storage Access
- 68" Residential Sofa (Most models)
- Hardwood Mortise and Tenon Cabinet Door Frames
- Stile and Rail Cabinet Front Construction
- 32" LED TV (40" – 265RBSS, 287BHSS, 293RLDS)
- LP Leak Alarm
- Fire Extinguisher
- Smoke Alarm
- Carbon Monoxide Detector

Electrical/Heating/AC

- Furnace – Forced Air/Ducts Per Floorplan
- 55 Amp Power Center
- Outside Receptacle GFI
- Ducted Air Conditioner (8' Wides)
- Detachable Marine Style Power Cord

Galley

- Power LED Lighted Range Hood
- Matte Black Hardware

Bath and Water

- Power Bath Vent
- 6 Gal. Gas/Elec. DSI Hot Water Heater
- Water Heater Bypass Valve
- Demand Water Pump
- Medicine Cabinet
- Below Floor Low Point Drains
- Foot Flush Toilet
- Tub Surround
- Glass Shower Door – 34" Neo-angle Showers

Sleeping

- Bunk Shelves – Double Over Double
- Bedroom Vent (28" and up)

Exterior/Construction

- Double 20# LP Tanks
- Aluma-Cage Construction
- Fully Laminated Aluminum Framed, Aluminum Truss, Dacor Crossflex Roof (R-11 – 7 1/2' wide, R-14 – 8' wide)
- Vacuum Bond Laminated Azdel Fiberglass Sidewalls (R-9)
- Laminated Aluminum Framed Floor (R-11)
- Gutter Rail
- Dead Bolt Lock
- Tinted Safety Glass Radius Windows
- Radius Entrance Door
- Radius Thumb Latch Baggage Doors
- I-beam Chassis Construction
- Corrosion Resistant Powder Coated Frame
- Dual Battery Tray
- Heated/Enclosed Underbelly and Holding Tanks (8' Wides)
- Break Away Switch
- Schwintek Slide Room System (N/A Deep slides)
- Double/Triple Entry Step
- Dexter® E-Z Lube® Axles
- Nitro Filled Radial Tires

OPTIONAL FEATURES

Summit Package

- Fiberglass Front Cap w/LED Lighting and Front Window
- Power Tongue Jack
- High Rise Flex Pull Kitchen Faucet
- LED Accent Lighting

- Backsplash Along Kitchen Countertop
- Stonecast Sink
- Aluminum Wheels
- Flush Mount Sink Covers
- Slam Latch Baggage Doors at Pass-thru
- LED Step Light

Additional Options

- Frameless Windows
- Hide-A-Bed Sofa (Deep Slides Only – STD on 293RLDS)
- 15K BTU A/C Upgrade
- 50 Amp Service w/Second (Forced) 13.5K BTU A/C
- Murphy Bed (226BH ONLY)



All storage-friendly Apex master suites have full length and depth hanging closets, easy access overhead storage and under bed storage. Shown with the integrated front cap window, available in the optional Summit Package.



A handy walk in storage closet is located directly behind the well-placed TV (Shown in Shale decor with an optional tri-fold Hide-a-bed sofa)





APEX CONSTRUCTION

These Ultra Lite Travel Trailers are designed for towing by today's half-ton trucks, minivans and SUVs. From 18' to 34' – All units are available under 6,500 lbs.

Construction Features

- I. 3M Breathable graphics
2. Tinted, safety glass windows
3. Welded aluminum structure, vacuum-bonded sidewalls, floor and roof
4. Aluminum reinforced laminated roof
5. Dicor Crossflex roofing
6. Azdel composite sidewall panels
7. Aerodynamic front profile (Shown with optional gelcoat fiberglass with integrated window - Summit Package)
8. Dual 20 lb. LP gas tanks (Nanos have a single 20 lb. LP tank)
9. Insulated slam latch doors with magnetic hold ups (Summit Package)
10. Smooth exterior fiberglass skin
- II. Aluminum framed openings
12. Fully enclosed, heated underbelly (8' Wide models)
13. Fully welded tubular aluminum floor structure
14. Schwintek™ and rack and pinion slide systems (Deep slides)
15. Congoleum® flooring
16. Powder E-coated, welded I-beam frame
17. Dexter® E-Z Lube® axle hubs
18. Nitrogen filled radial tires

Dicor Crossflex Synthetic Thermoplastic Roofing System

- Extreme tear and puncture resistance
- Flexible
- Lightweight
- High solar reflectance
- High thermal emissivity



Lower Center of Gravity for Better Towability

LIGHTWEIGHT DURABILITY

Available Fiberglass Front Cap

- ¾ Front fiberglass gel coat cap for superior strength
- Automotive glass front window with superior UV protection
- Diamond plate lower stone guard
- Integrated LED accent lights

Vacuum Bonded Sidewalls, Roof and Floor

- Stronger construction
- Lighter weight

Apex Is Certified Green TRA Gold Level Rated

As a Certified Green RV, APEX utilizes effective production techniques in combination with healthy materials, plus efficient usage of energy and water to produce a high quality RV with less environmental impact.

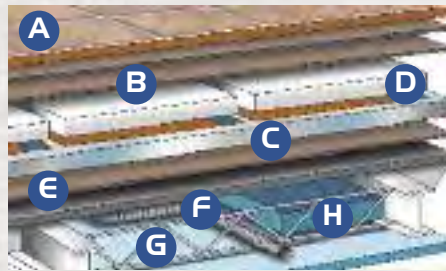

Six Layer Bonded Floor

- A Residential durable insulated floor covering
- B Double layer Luan plywood top decking
- C Welded aluminum frame
- D Block foam structural insulation
- E Luan plywood bottom decking
- F Darco waterproof floor wrap
- G Cross member support
- H Holding tanks



Apex Is Constructed With Azdel Composite Panels



AZDEL is 50% lighter than wood, increases insulation value, and won't rot, mold or sustain water damage for years of trouble free camping. Plus, Azdel is odor and formaldehyde free.



Entertainment Center

Comes complete with an AM/FM/CD/DVD stereo with Bluetooth, LED TV and upgraded stereo speakers. (Available on 265RBSS, 287BHSS, and 293RLDS)



LED Interior Lighting

Energy efficient, bright and long lasting



Welded Aluminum Framing

Durable, lightweight aluminum frame on all cutouts – windows, compartments, doors and vents



Aluminum Reinforced Laminated Roof

Walk-on roof has evenly distributed insulation for enhanced structural integrity.



Magnetic Door Closures

Holds door up and out of the way while accessing storage



Kitchen Backsplash

Easy to clean kitchen backsplash (N/A Nano)



Stonecast Sink

This double bowl sink is stain resistant and heat resistant up to 500° (N/A Nano models)



One-Piece Seamless Countertop

This stain resistant, lighter weight countertop with No T-mold (Helps prevent water damage)



Wardrobe/Pantry Storage

Most Apex Ultra Lites have extra wardrobe and pantry storage. (287BHSS shown)



Nano 208BHS Exterior Camp Kitchen

Includes a Coleman® grill, refrigerator and convenient storage areas



Outside Kitchen

Includes a Coleman® grill, large refrigerator, plumbed sink, gooseneck faucet and additional storage. (Standard on 203RBK, 215RBK, 251RBK, and 300BHS models.)



Camp Kitchen

Keep cold drinks and hot snacks close by! (Available on 208BHS, 245BHS, 265RBSS, 269RBKS, 287BHSS, and 289TBSS.)



Exterior Steps

LED lights enhance safety



Shown with the Summit Package option

APEX NANO

By Coachmen

Apex Nanos are the perfect lightweight solution for families on the go. They're easy to tow – and easy to set up for years of fun-filled outdoor adventure.

NANO STANDARD FEATURES

Nano Package (Mandatory)

- Vacuum Bond Azdel/Fiberglass Walls
- Vacuum Bond Laminated Crowned Roof/Ceiling
- Aluma-cage Construction
- Vacuum Bond Laminated Aluminum Framed Floor
- Schwintek Slide System (N/A 15X, 185BH, 187RB)
- Outside Speakers
- Stabilizer Jacks (4)
- TV Antenna w/Cable Hookups
- DSI Water Heater
- Stainless Steel Microwave
- 2 Burner Cooktop
- AM/FM Stereo w/Bluetooth
- Skylight in Bath
- Evergreen Sleep Mattress
- Two-Tone Grey Fiberglass Exterior Sidewall
- Dark Grey Exterior Front & Rear Walls (N/A 15X)
- LED Interior Lighting Throughout
- LP Port
- Double Door Refrigerator (N/A 15X)
- Solar Prep
- Outside Shower
- Assist Handle

Interior and Décor

- Pewter Maple Cabinetry
- Overhead Bedroom Cabinets w/Wardrobes
- Congoleum Diamond Flooring
- Grey Night Shades Throughout
- Pedestal Dinette Table
- Large Oversized Booth
- Hardwood Mortise and Tenon Cabinet Door Frames
- Residential Comforter (Select models)
- Stile and Rail Cabinet Front Construction
- 2" Thick Insulated Floor
- LP Leak Alarm
- Fire Extinguisher
- Smoke Alarm
- Carbon Monoxide Detector

Electrical/Heating/AC

- Outside Receptacle GFI
- Detachable Marine Style Power Cord

Galley

- Double Bowl Sink
- Seamless Edge Countertops
- Matte Black Hardware

Bath and Water

- Power Bath Vent
- Water Heater Bypass Valve
- Demand Water Pump
- Hand-crafted Wood Medicine Cabinet

- Below Floor Low Point Drains
- Foot Flush Toilet
- Separate Sink and Shower/Tub Plumbing

Exterior/Construction

- Aluma-Cage Construction
- Fully Laminated Aluminum Framed, Aluminum Truss, Dicor Crossflex Roof (R-11 7 1/2' wide)
- Vacuum Bond Laminated Azdel/Fiberglass Sidewalls (R-9)
- Laminated Aluminum Framed Floor (R-11)
- 20# LP Tank
- Dicor Crossflex Synthetic Thermoplastic Roofing System
- Gutter Rail
- Deadbolt Lock
- Tinted Safety Glass Radius Windows
- Radius Entrance Door with Window
- Radius Thumb Latch Baggage Doors
- Corrosion Resistant Powder Coated Frame
- Dual Battery Tray
- Break Away Switch
- Stone Guard
- Pass-thru Storage
- Double Entry Step
- Dexter® E-Z Lube® Axles
- Nitro Filled Radial Tires

NANO OPTIONAL FEATURES

Comfort Package

- 20,000 Direct Vent Furnace
- Power Awning w/LED Lighting

Summit Package: (N/A 15X)

- Fiberglass Front Cap with Integrated Window
- Black Tank Flush
- Dinette Door
- Kitchen Drawer
- Magnetic Door Catches

Additional Options

- 13.5k BTU A/C
- Spare Tire
- Murphy Bed (203RBK, 208BHS ONLY)





Nano 213RDS makes camping comfortable and convenient for two, with abundant storage, a sofa and a separate dinette. (Shown in Shale decor)

208BHS offers big amenities in a smaller package, with large bunks, a convertible sleeper/dinette, extra storage and an open living space.

The Apex E-Z Murphy Bed provides additional seating when stowed. This option is available on 208BHS and 203RBK Nano models. (Shown in Quartz decor)





By Coachmen

NANO

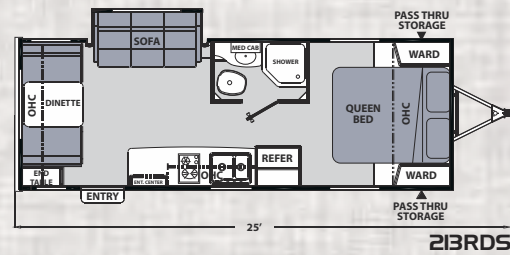
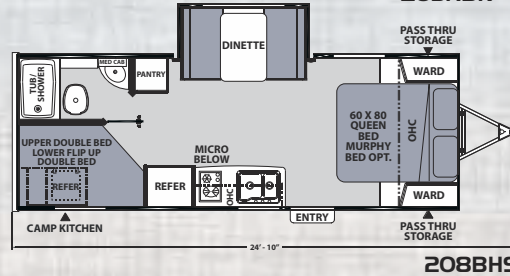
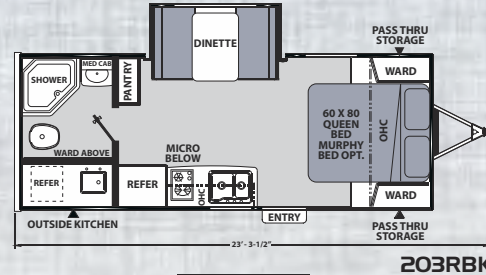
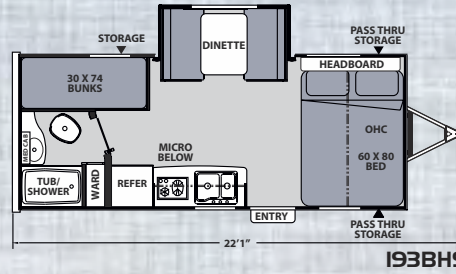
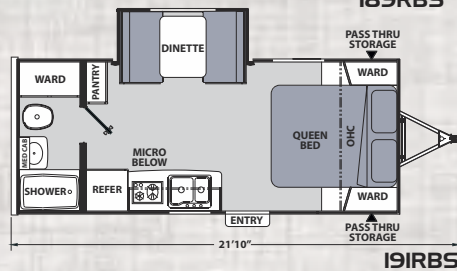
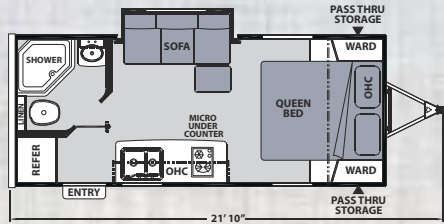
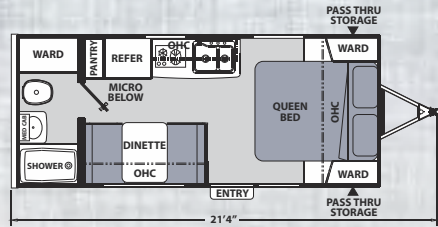
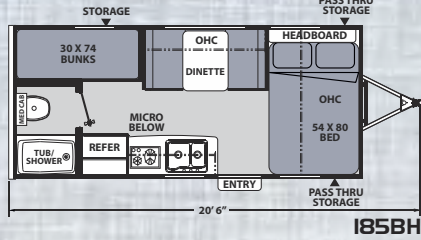
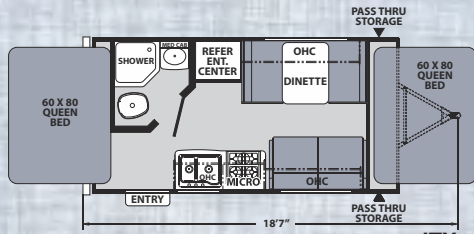

7-1/2' WIDE ULTRA LITE

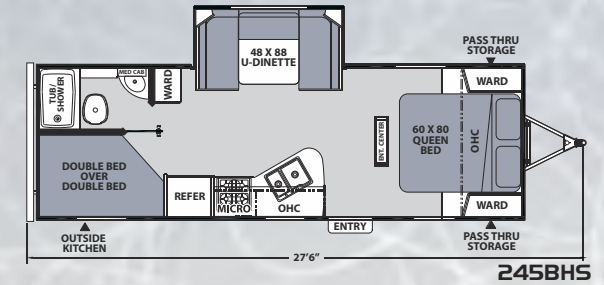
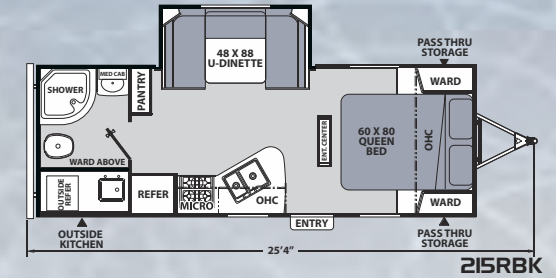

Apex Nano	15X	185BH	187RB	189RBS	191RBS	193BHS	203RBK	208BHS	213RDS
UVW	2,920	2,850	3,034	3,453	3,446	3,495	3,896	3,928	3,806
Hitch Weight	360	350	316	418	406	370	478	516	467
Carrying Capacity	880	950	766	1,247	1,254	1,205	2,104	2,072	2,194
GVWR	3,800	3,800	3,800	4,700	4,700	4,700	6,000	6,000	6,000
Exterior Length (Bumper to Hitch)	18'7"	20'6"	21'4"	21'10"	21'10"	22'1"	23'4"	24'11"	25'
Exterior Height (w/A/C)	9'9"	9'9"	9'9"	10'	10'	10'	10'	10'	10'
Fresh Water Capacity (gal.)	30	30	30	30	30	30	30	30	30
Grey Water Capacity (gal.)	30	30	30	30	30	30	30	30	30
Waste Water Capacity (gal.)	30	30	30	30	30	30	30	30	30
Awning Length	12'	12'	12'	12'	12'	12'	15'	14'	15'

Apex 7.5' Wide	215RBK	245BHS
UVW	4,365	4,586
Hitch Weight	446	578
Carrying Capacity	2,135	1,914
GVWR	6,500	6,500
Exterior Length (Bumper to Hitch)	25'4"	27'6"
Exterior Height (Includes A/C)	10'3"	10'3"
Fresh Water Capacity (gal.)	30	30
Grey Water Capacity (gal.)	30	30
Waste Water Capacity (gal.)	30	30
Awning Length	13'	18'

8' WIDE

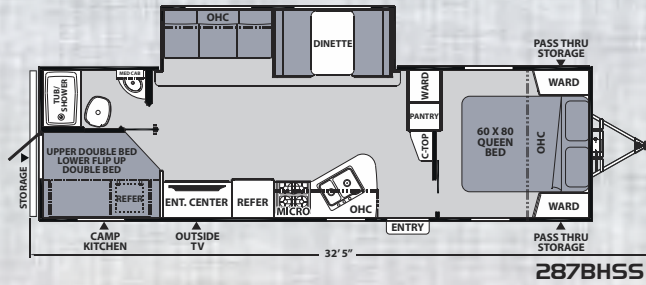
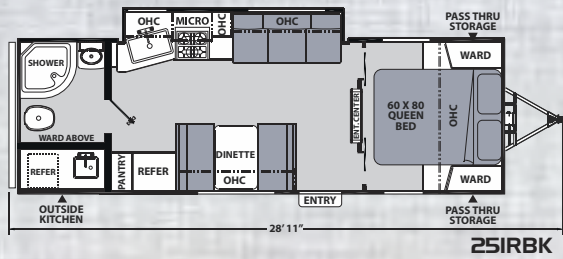
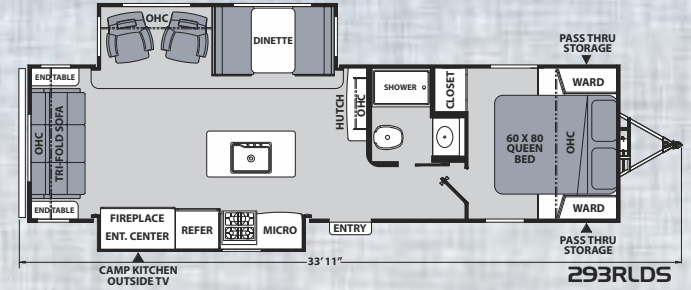
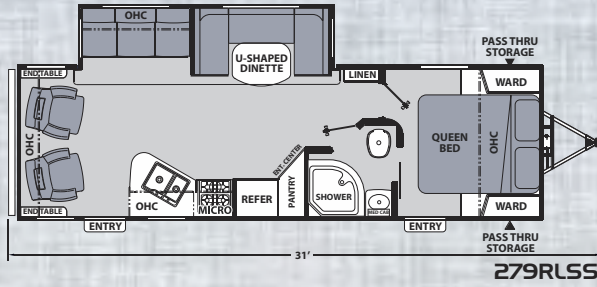
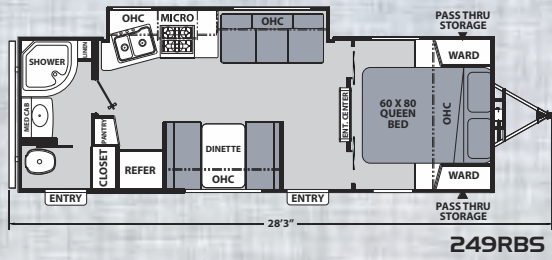
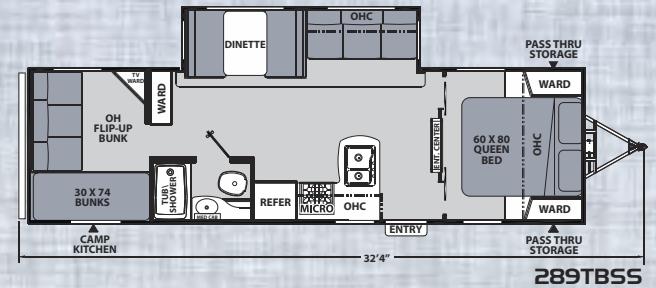
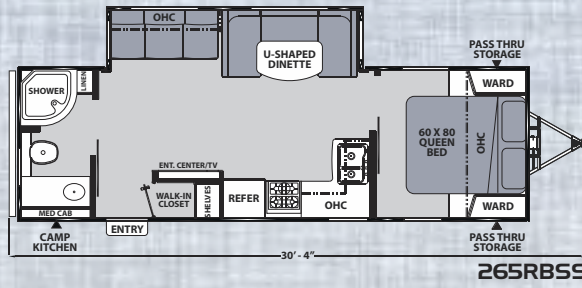
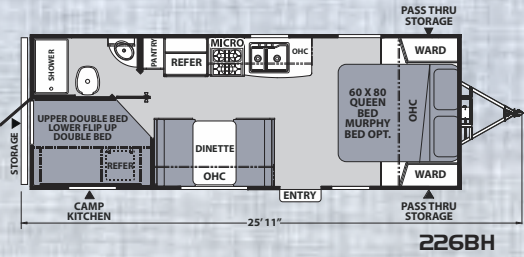

As Winner of the RV News Best of Show for Lightweight Travel Trailers, Apex 293RLDS continues this tradition! Contemporary interior styling along with functional appointments gives Apex 293RLDS the competitive edge.

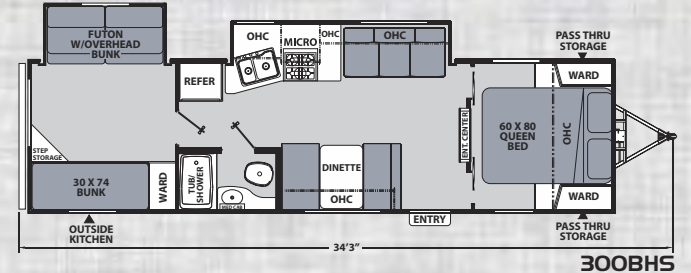
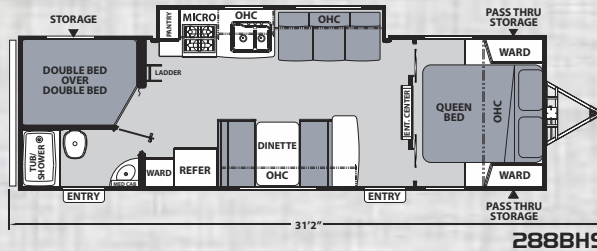

Apex 8' Wide	226BH	249RBS	251RBK	265RBSS	279RLSS	287BHSS	288BHS	289TBSS	293RLDS	300BHS
UVW	4,436	4,770	4,984	5,652	5,490	5,946	4,882	5,720	6,440	5,977
Hitch Weight	501	480	570	734	620	792	585	715	832	672
Carrying Capacity	2,064	2,230	2,016	1,948	2,110	1,654	2,118	1,880	1,360	1,623
GVWR	6,500	7,000	7,000	7,600	7,600	7,600	7,000	7,600	7,800	7,600
Exterior Length (Bumper to Hitch)	25'11"	28'3"	28'11"	30'4"	31'	32'5"	31'2"	32'4"	33'11"	34'3"
Exterior Height (w/A/C)	10'3"	10'3"	10'3"	10'3"	10'3"	10'3"	10'3"	10'3"	10'3"	10'3"
Fresh Water Capacity (gal.)	50	50	50	50	50	50	50	50	50	50
Grey Water Capacity (gal.)	35	35	35	70	35	35	35	35	70	35
Waste Water Capacity (gal.)	35	35	35	70	35	35	35	35	70	35
Awning Length	18'	16'	16'	18'	18'	18'	16'	18'	18'	18'



NAHO

Apex is designed for towing with today's half-ton trucks, minivans and SUVs, with weights ranging from under 3,000 to 6,500 lbs.



PERFECT FOR SMALLER TOW VEHICLES

TWILIGHT



SHALE



QUARTZ



Coachmen Interactive Mobile Manuals

Download your Coachmen mobile app or visit our dynamic online manual to enhance your ownership experience. These interactive options provide incredible ease and insight into use, maintenance and enjoyment of your Coachmen product. Ranging from "How-To" videos, pictures and illustrations of various components, systems and features to fully searchable content and downloadable PDFs for individual component owner's manuals, answers are always just a click away.

YOUR APEX DEALER



423 N. Main Street ■ P.O. Box 30 ■ Middlebury, IN 46540
To learn more about Coachmen RV and our products and see how Coachmen is making the easy life easier, visit www.coachmenrv.com.

24/7 EMERGENCY ROADSIDE ASSISTANCE WITH VEHICLE PURCHASE*

TOWING
JUMP-STARTS
TIRE CHANGES
FLUID DELIVERY
LOCKOUT
SERVICE

WINCH-OUT
MOBILE MECHANIC
TECHNICAL
SUPPORT
DEALER LOCATOR
SERVICES



*VALID FOR 1 YEAR FROM DATE OF PURCHASE



Learn More
Scan this barcode using a QR Reader on your smart phone to learn more about Forest River.



A Berkshire Hathaway company.

GVWR (Gross Vehicle Weight Rating) - is the maximum permissible weight of the unit when fully loaded. It includes all weights, inclusive of all fluids, cargo, optional equipment and accessories. For safety and product performance do NOT exceed the GVWR.

GAWR (Gross Axle Weight Rating) - is the maximum permissible weight, including cargo, fluids, optional equipment and accessories that can be safely supported by a combination of all axles.

UVW (Unloaded Vehicle Weight)* - is the typical weight of the unit as manufactured at the factory. It includes all weight at the unit's axle(s) and tongue or pin and LP Gas. The UVW does not include cargo, fresh potable water, additional optional equipment or dealer installed accessories.

*Estimated Average based on standard build optional equipment.

CCC (Cargo Carrying Capacity)** - is the amount of weight available for fresh potable water, cargo, additional optional equipment and accessories. CCC is equal to GVWR minus UVW. Available CCC should accommodate fresh potable water (8.3 lbs per gallon). Before filling the fresh water tank, empty the black and grey tanks to provide for more cargo capacity.

**Estimated average based on standard build optional equipment.

Each Forest River RV is weighed at the manufacturing facility prior to shipping. A label identifying the unloaded vehicle weight of the actual unit and the cargo carrying capacity is applied to every Forest River RV prior to leaving our facilities. The load capacity of your unit is designated by weight, not by volume, so you cannot necessarily use all available space when loading your unit.

All information contained in this brochure is believed to be accurate at the time of publication. However, during the model year, it may be necessary to make revisions and Forest River, Inc., reserves the right to make all such changes without notice, including prices, colors, materials, equipment and specifications as well as the addition of new models and the discontinuance of models shown in this brochure. Therefore, please consult with your Forest River dealer and confirm the existence of any materials, design or specifications that are material to your purchase decision. ©2018 Apex by Coachmen RV, a Division of Forest River, Inc., a Berkshire Hathaway company. All rights reserved. 12/18