

ROCKWOOD

FREEDOM * PREMIER * HIGH WALL * HARD SIDE TENT CAMPERS

ROCKWOOD

FREEDOM * PREMIER * HIGH WALL * HARD SIDE TENT CAMPERS





02

1970



ROCKWOOD FREEDOM

MAKING YOUR INVESTMENT GO A LONG WAY.

Rockwood takes pride in packing the most value possible into our Freedom series. While coming standard with many features, you still have flexibility to incorporate as many options as you choose to fit your camping preferences.



Water Pump w/ Filter
(Std.)



Easy glide scissorpole bed supports
(Except LTDs)



Plywood Bed Ends
(N/A Hard Side)

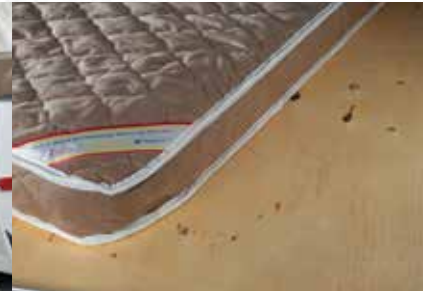

Heated Mattress
(Std. Opt.)



Outside grill with work table
(Std. Freedom, Premier, Hard Side, High Wall)



Sliding Storage Trunk
(Some Models)



Crank Down stabilizer Jack *(Std.)*



Swing down galley *(Except LTDs, Hard Side, High Wall)*

ROCKWOOD PREMIER

A PROVEN TRACK RECORD MAKES THIS UNIT PREMIER

Year in and year out the Premier series consistently delivers with outstanding features and styling to enhance your camping experience. The swing down galley and standard power lift make the Premier a breeze to set up. The expansive seating throughout the camper gives everyone plenty of room to sit and enjoy themselves.



Hanging Shirt Bar
(Std. Premier, Hard Side & High Wall)

LED Bunk Light and Fan
(Std. Premier & High Wall)

Metal Full Extension Drawer Guides
(Std.)



Bike Rack Option
(Most Models)

Fantastic Fan *(Except LTDs.)*

Outside Shower
*(Incl. w/ Hot Water Pkg:
Std. Premier, Hard Side,
High Wall and Opt: Freedom)*

Large Entry Assist Handle
(Except LTDs)

One-piece Door
(Except LTD, Hard Side)





2716G





ROCKWOOD HIGH WALL

IT'S YOUR VACATION. WHY NOT GO IN STYLE?

The Rockwood High Wall campers are perfect for those families who want the luxurious features of a travel trailer in a much lighter towable option. The Cherry colored cabinetry, stainless steel finishes and beautiful tile-look flooring puts this camper in a class of its own.



AM/FM Stereo with CD
Player *(Std. Premier, Hard
Side & High Wall, HW296
Std. w/ AM/FM/CD Stereo
with DVD Player)*

Hanging Wardrobe
*(Opt. all Models Except
Freedom, Hard Side & LTD's)*

Power Lift *(Std. Premier,
High Wall and Freedom XR
models. Opt. MAC/LTD)*

Double Entry Step
*(Std. Freedom XR Models
and All HW Models)*



Beautiful hardwall shower with a residential-style flush toilet complete with a 12-gallon black water holding tank. *(Std. High Wall)*



Black water hose storage *(Std. HW models)*



Add-a-Room with Privacy Panels *(Opt. all Models Except Hard Side)*



ROCKWOOD SUPERIOR CONSTRUCTION

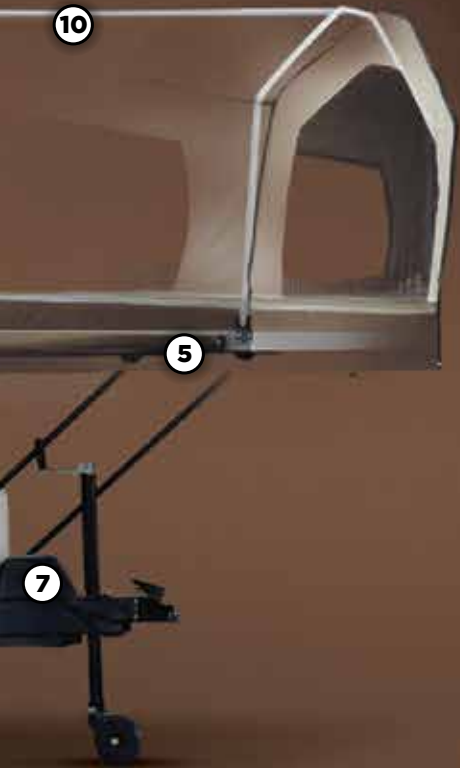

- 1) Three Stage Double Arm Lifter Posts (*NA Hard Side*)
- 2) Fiberglass Vacuum Bonded Radius Roof w/ No Center Seam (*NA Hard Side*)
- 3) Five-Piece Vinolon Supreme Tenting (*NA Hard Side*)
- 4) E-Z Crank Down Stabilizer Jacks w/Sand Pads
- 5) Full Perimeter Aluminum Bed Frames (*NA Hard Side*)
- 6) Plywood Bunk Ends (*NA Hard Side*)
- 7) Seven-Way Pigtail Wiring
- 8) Under Floor 20 Gallon Fresh Water Tank (*LTDs 11 Gallon Above Floor*)
- 9) Powder Coated Tubular Steel Frame
- 10) Powder Coated Rafter Poles and Bed Bows (*NA Hard Side*)
- 11) Air Conditioner Reinforcing Laminated Into Roof (*NA Hard Side*)
- 12) Steel Belted Radial Tires
- 13) Easy Lube Axles (*Except LTDs*)
- 14) Smooth Fiberglass Vacuum Bonded Exterior (*NA on Freedoms*)
- 15) One-Piece Door (*Except LTDs & Hard Side*)



The UltraLube™ Hubs allow you to repack bearings quickly and easily without disassembly.

AL-KO® TORSION AXLES AND EASY LUBE HUBS

AL-KO Axles offer many advantages over conventional axles:

- Fully Independent Wheel Suspension
- No Metal to Metal Contact and No Springs, Shackles, Hangers, or U-bolts to Break or Wear Out
- Lower Trailer Center of Gravity For Improved Stability

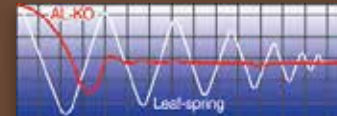

Note: Torsion Axles on Premier's, HS's and HW's only. Easy-Lube Hubs on all units except LTDs.

ROCKWOOD HARD SIDE

VACATIONS LIKE A TRAILER & STORES LIKE A CAMPER.

The Hard Side tent camper brings a smooth, fiberglass vacuum bonded exterior with quick, easy set up, while retaining the towing and storage advantages of the Premier tent camper. Making it the perfect product for your camping adventure.



Hard Side Awning & Screen Room option.

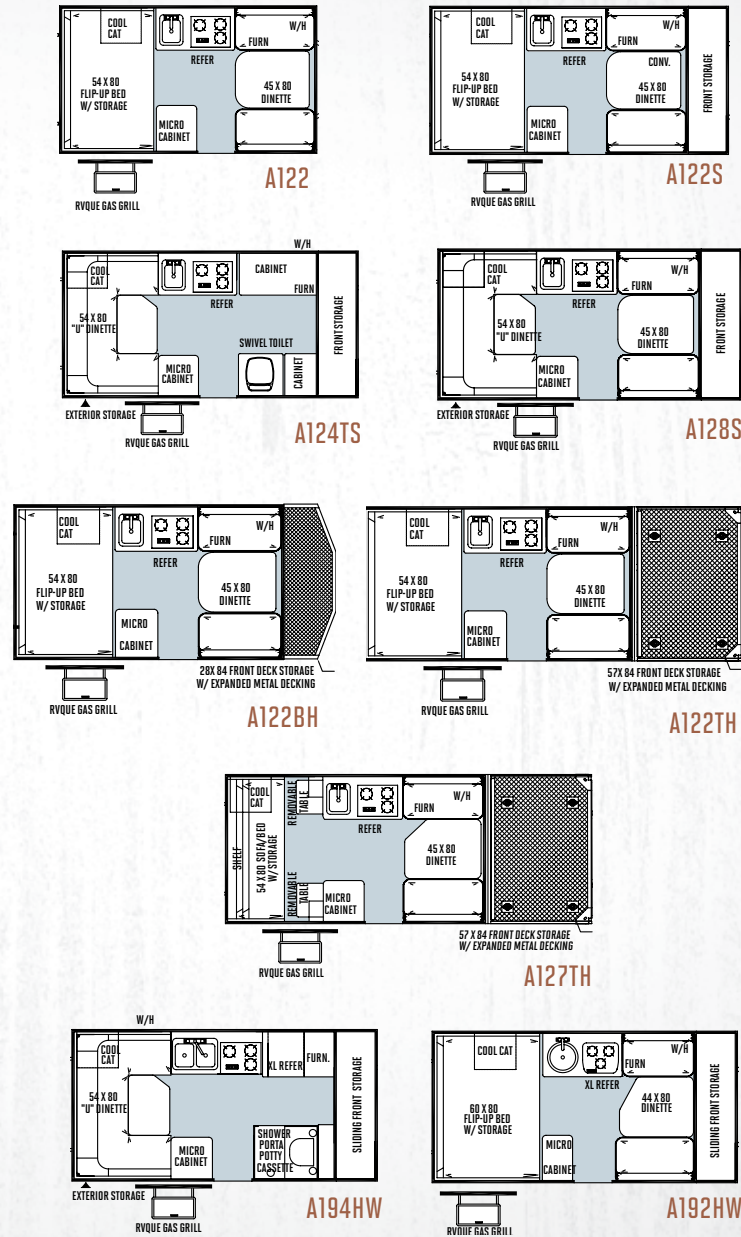

SPECIFICATIONS

Model number of any particular unit does not necessarily reflect the overall length of the unit itself. Dry weights are estimates.

MODEL	A122	A122S	A124TS	A128S	A122BH	A122TH	A127TH	A194HW	A192HW
BASE/DRY UNIT WEIGHT	1893	1955	1982	1886	1943	2186	2152	2052	2100
BASE DRY HITCH WEIGHT	247	283	268	275	268	354	349	327	330
BASE DRY AXLE WEIGHT	1646	1672	1714	1611	1675	1832	1803	1725	1770
CARGO CAPACITY	1005	1217	1217	1217	1217	1630	1678	1237	1192
BOX SIZE	12' 12'	12' 12'	12' 12'	12' 12'	12' 12'	12' 12'	12' 12'	12' 12'	12' 12'
TRAILER SIZE (CLOSED W/ HITCH)	17' 1"	18' 11"	18' 11"	18' 11"	19' 2"	22' 1"	22' 1"	18' 11"	18' 11"
HEIGHT (CLOSED)	60"	60"	60"	60"	60"	65"	65"	66"	66"
FRESH WATER CAPACITY	26	26	26	26	26	26	26	26	26

*For more on the Rockwood Hard Side High Wall go to the back cover.





A124TS



ROCKWOOD PREMIER

SPECIFICATIONS

Model number of any particular unit does not necessarily reflect the overall length of the unit itself.
Dry weights are estimates.

MODEL	23176	25146	25166	27166
BASE/DRY UNIT WEIGHT	2445	2446	2473	2555
BASE DRY HITCH WEIGHT	358	303	292	370
BASE DRY AXLE WEIGHT	2087	2143	2181	2185
CARGO CAPACITY	894	838	800	796
BOX SIZE	12'	12'	12'	14'
TRAILER SIZE (Closed w/ Hitch)	19' 1"	19' 1"	19' 1"	19' 4"
HEIGHT (Closed)	61"	61"	61"	61"
TRAILER LENGTH (Open)	23' 9"	23' 9"	23' 9"	25' 9"
FRESH WATER CAPACITY	26	26	26	26

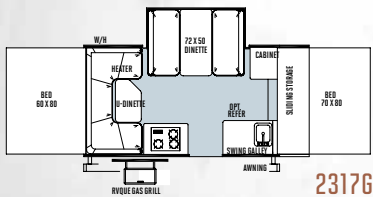

23176

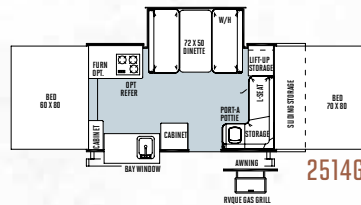

25146

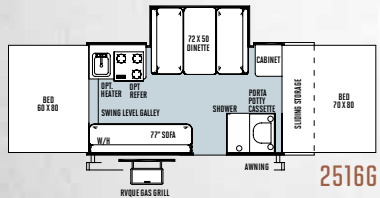

25166

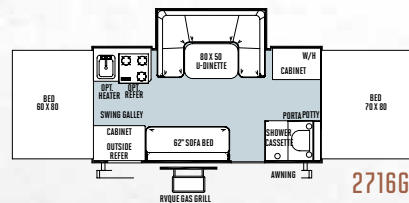

27166

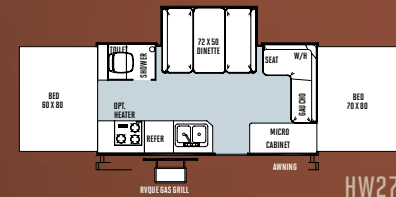

HW276

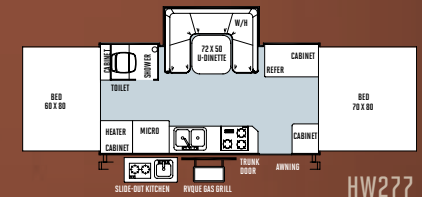

HW277

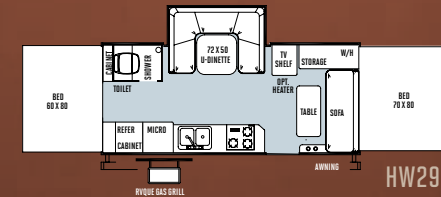

HW296

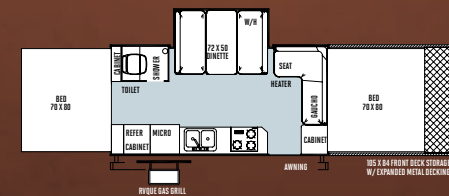

HW316TH

SPECIFICATIONS

Model number of any particular unit does not necessarily reflect the overall length of the unit itself.
Dry weights are estimates.

MODEL	HW 276	HW 277	HW 296	HW 316TH
BASE/DRY UNIT WEIGHT	2806	2962	3135	3738
BASE DRY HITCH WEIGHT	279	370	373	337
BASE DRY AXLE WEIGHT	2527	2592	2762	3401
CARGO CAPACITY	935	870	1217	2317
BOX SIZE	14'	14'	16'	14'
TRAILER SIZE (Closed w/ Hitch)	19' 4"	19' 4"	21' 4"	28' 4"
HEIGHT (Closed)	71"	71"	72"	71"
TRAILER LENGTH (Open)	25' 9"	25' 9"	27' 9"	33' 9"
FRESH WATER CAPACITY	26	26	26	26
GRAY WATER CAPACITY	12	12	12	12
BLACK WATER CAPACITY	12	12	12	12

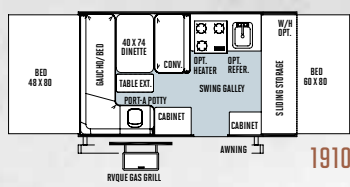

1910

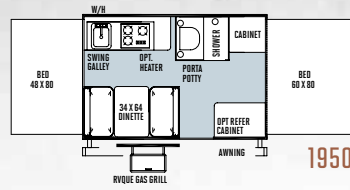

1950

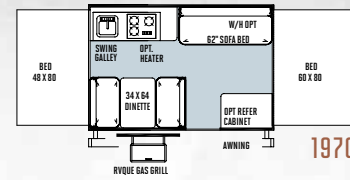

1970

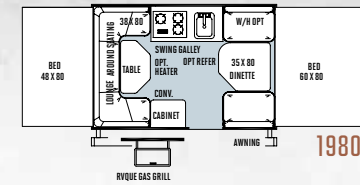

1980

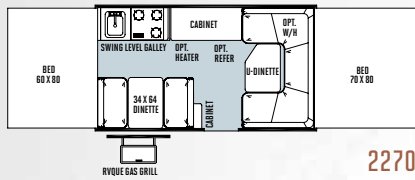

2270

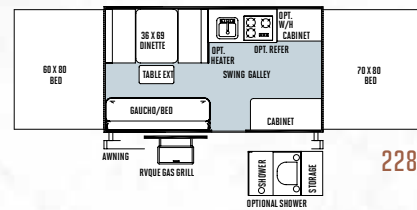

2280

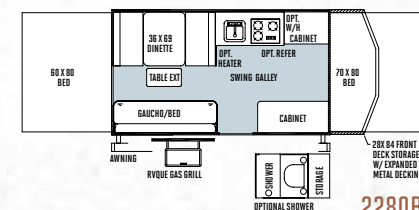

2280BH

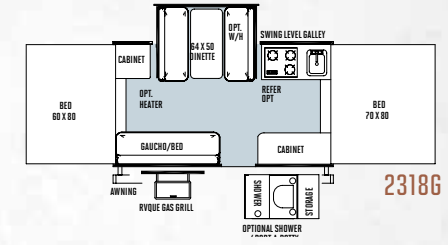

23186

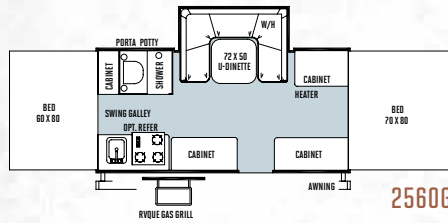

25606

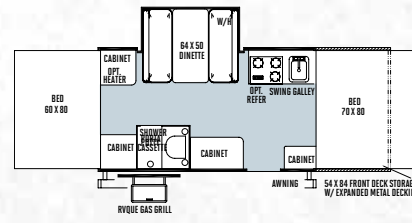

232XR

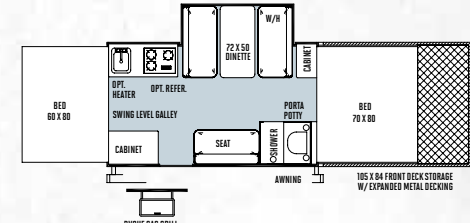

282TXR

ROCKWOOD FREEDOM

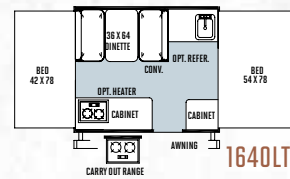

1640LTD

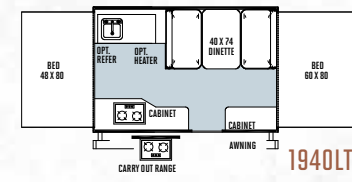

1940LTD

SPECIFICATIONS

Model number of any particular unit does not necessarily reflect the overall length of the unit itself.
Dry weights are estimates.

MODEL	1910	1950	1970	1980	2270	2280	2280BH	23186	25606	232XR	282TXR	1640LTD	1940LTD
BASE/DRY UNIT WEIGHT	1944	1732	1764	1737	2006	2050	2122	2153	2364	2579	2975	1344	1493
BASE DRY HITCH WEIGHT	245	240	252	219	293	331	382	313	249	310	219	190	174
BASE DRY AXLE WEIGHT	1699	1492	1512	1518	1713	1719	1740	1840	2115	2269	2756	1154	1319
CARGO CAPACITY	1032	917	866	866	966	966	991	891	866	1212	2317	683	762
BOX SIZE	10'	10'	10'	10'	12'	12'	12'	12'	14'	12'	12'	8'	10'
TRAILER SIZE (Closed w/ Hitch)	17' 1"	15' 3"	15' 3"	15' 3"	17' 2"	17' 2"	18' 8"	17' 2"	19' 2"	21' 9"	26'	12'	14'
HEIGHT (Closed)	57"	57"	57"	57"	57"	57"	57"	57"	57"	62.5"	62.5"	56"	56"
TRAILER LENGTH (Open)	20' 4"	20' 1"	20' 1"	20' 1"	23' 10"	23' 10"	23' 10"	23' 10"	25' 10"	26' 5"	30' 8"	17' 1"	20' 1"
FRESH WATER CAPACITY	20	26	20	20	20	20	20	20	26	26	26	11	11

STANDARDS & OPTIONS

Standards & Options are subject to change.

MODELS	LTD	F	P	HS	HW
STANDARD & OPTIONAL FEATURES					
Cherry Interior with "Tile-Look" Linoleum	--	--	S	S	S
Hickory Interior with "Tile-Look" Linoleum	S	S	--	--	--
Two-Tone Fabric Interiors	S	S	S	S	S
Residential Style Kitchen Faucet	S	S	S	S	--
Stainless Steel Look Appliances and Sink	--	--	S	S	S
Double Pan Sink with High Rise Faucet					
(HS: A194HW Only)	--	--	--	S*	S
Electric Water Pump	S	S	S	S	S
Hot Water Package (Incl. Water Filter, Outside Shower, Six Gallon DSI Hot Water Heater)					
(F: 1910, 1970, 1980, 2270, 2280, 2280BH, 2318G)	--	0*	S	S	S
Port-a-Potty (F: 1910 ONLY P: 2514G HS: A122, A122S, A122BH, A122TH, A127TH, A128S, A192HW)	--	S*	S*	S*	--
Cassette Swivel Toilet w/ Fresh Water Flush (HS: A124TS Only)	--	--	--	S*	--
Shower Cassette Package Incl. Water Filtration System, Six Gallon DSI Hot Water Heater, Demand Water Pump, and Cassette Toilet (Opt. F: 2280, 2280BH, 2318G) (Std. F: 1950, 2560G, 232XR, 282TXR, P: 2516G 2716G HW: 194HW)	--	S*/0*	S*	S*	--
Hard Wall Shower with Residential Flush Toilet	--	--	--	--	S*
Fold Over Galley with Upper and Lower Storage (Std. P: 2514G Only)	S	--	S*	--	--
Two Burner Free-Standing Range	S	--	--	--	--
Swing Level Galley with Storage (N/A P: 2514G, 2317G)	--	S	S*	--	--
Permanently Mounted 3-Burner Indoor Range w/ Stove Cover	--	S	--	--	--
Permanently Mounted 3-Burner Indoor Range w/ Glass Stove Top Cover	--	--	S	S	--

MODELS	LTD	F	P	HS	HW
Three Burner Glass Top Stove with Oven (HS: A194HW Only)	--	--	--	S*	S
Microwave	--	--	--	S	S
Large Built-In Icebox	S	S	S	--	--
110V Electric Outside Accessible Refer (P: 2716G Only)	--	--	S*	--	--
3 Way Refer 1.9 cu. ft.	0	0	--	--	--
3 Way Refer 2.5 cu. ft.	--	--	0	S	--
Extra Large 3 Way Refer (HS: A194HW, A192HW Only)	--	--	--	S*	0
Free Standing Lite-Ply Table-High Pressure Laminate	S	S	S	S	S
Comfortable Family Style Dinette w/ 4" Cushions	S	OPA	S	S	S
Residential Style Raised Panel Doors	--	--	S	S	S
Wood Drawers w/ Full Extension Metal Guides	S	S	S	S	S
Large Clothes Bar	--	--	S	S	S
Hanging Wardrobe	--	--	0	--	0
Hanging Pantry	--	0	0	--	0
AM/FM Stereo with CD player	--	--	S	S	S
AM/FM Stereo with CD and DVD player (HW296 Only)	--	--	--	--	S*
TV Outlet with Cable and Satellite Hook Up	--	S	S	S	S
LCD TV (HW296 Only)	--	--	--	--	S*
30 Amp Detachable Power Cord w/ Storage Bag	--	S	S	S	S
25 Amp Converter w/ Built in Battery Charger	S	--	--	--	--
35 Amp Converter w/ Built in Battery Charger	--	S	S	S	S
12V Safety Breaker	S	S	S	S	S
Roof Vent	S	--	--	--	--
Create-A Breeze Three Speed Fantastic Fan	--	SO	SO	SO	SO
Air Conditioner Wiring Kit	0	0	0	--	0
10k BTU Cool Cat Heat Pump	--	--	--	S	--
13.5k BTU Air Conditioner (Factory Installed)	--	--	--	--	0
20k BTU Forced Air Furnace w/ Electric Ignition	0	0	0	0	0
Interior Floor Lights	--	--	--	S	S
2 Ceiling LED Lights w/ Jacks for Accessories	S	--	--	--	--

MODELS	LTD	F	P	HS	HW
2 Ceiling LED Lights	--	--	--	S	--
3 Ceiling LED Lights w/ Jacks for Accessories	--	S	S*	--	--
4 Ceiling LED Lights w/ Jacks for Accessories (P: 2716G Only)	--	--	S*	--	S
Bunk LED Light with Fan	--	--	S	--	S
LED Bunk Light (F: 2318G, 2560G, 232XR, 282TXR Only)	--	S*	S	--	S
LP Leak Detector	S	S	S	S	S
Carbon Monoxide Detector	0	0	0	0	0
Privacy Curtains	S	OPA	S	S	S
Roof Valances	--	OPA	S	--	S
Quilted Top Bed Mattresses	S	S	--	--	--
Quilted Top Innerspring Mattresses (HS: A122, A122S, A122BH, 122TH Only)	--	--	S	S*	S
Quilted Top 60" x 80" Innerspring Mattresses (HS: A192HW Only)	--	--	--	S*	--
Thermostatically Controlled Heated Mattresses (HS: A122, 122S, A122BH, A122TH, A192HW Only)	SO	SO	SO	S*	SO
Leaf-Spring Axle	S	S	--	--	--
Independent Torsion Axles	--	--	S	S	S
Easy Lube Axles	--	S	S	S	S
Spare Tire, Cover and Mount	S	OPB	OP1	S	OP1
12" Radial Tires	S	--	--	--	--
13" Radial Tires (F: Except XR Models)	--	S*	--	--	--
13" Radial Tires w/ Aluminum Wheels (HS: Except TH Models)	--	--	S	S*	--
14" Radial Tires w/ Aluminum Wheels	--	--	--	--	S
15" Mud Rover Radial Tires, Aluminum Wheels (Std. A122TH, A127TH Only) w/ Shocks (Std. F: 232XR, 282TXR Only)	--	S*	--	S*	--
Electric Brakes	0	S	S	S	S

LTD = LIMITED
F = FREEDOM
P = PREMIER

HS = HARD SIDE
HW = HIGH WALL

S = STANDARD
SO = STANDARD OPTION
O = OPTIONAL

-- NOT AVAILABLE
OP = OPTION PACKAGES
* = SELECTED MODELS



MODELS	LTD	F	P	HS	HW
Slam Latches on Front Trunk Side Doors (P: 2317G, 2514G, 2516G Only)	--	--	S*	--	--
Sliding Storage Tray on All Front Trunk Models (HS: A192HW, A194HW Only)	--	S*	S*	S*	--
28.5" Front Storage Deck w/ 200 # Weight Capacity (Std. F: 2280BH, HS: A122BH Only)	--	S*	--	S*	--
54" Frt. Storage Deck w/ 650 # Wt. Capacity (Std. F: 232XR)	--	S*	--	--	--
57" Frt. Storage Deck w/ 650 # Wt. Capacity (Std. HS: A122TH, A127TH)	--	--	--	S*	--
105" Front Storage Deck w/ 1300 # Weight Capacity (Std. F: 282TXR, HW: HW316TH Only)	--	S*	--	--	S*
(4) Bike Rack (N/A F: 232XR, 282TXR HS: A122TH, A127TH HW: HW316TH) (Note: HS: A122 - 2 Bikes only)	0	0*	0	0*	0*
Power Lift System (Std. F: 232XR, 282TXR)	0	0*	S	--	S
Built-in A-Frame Mounting Provision for Equalizer					
Hitch Bar Installation	S	S	S	S	S
Battery Box and Wiring Kit	0	S	S	S	S
20 lb. LP Bottle	S	S	S	--	--
(2) 20 lb. LP Bottles (Std. F: 232XR, 282TXR Only)	--	S*	--	--	--
Dual 20 lb. LP Bottles with Cover	--	0	0	S	S
Automatic LP Regulator	--	0	0	S	S
Diamond Plated Front Cap	--	--	--	--	S
Diamond Plated Front, Rear and Side Skirt (F: 232XR, 282TXR Only)	--	S*	--	--	--
Awning	S	OPB	OP1	--	OP1
Awning/Screen Room	--	--	--	0	--
Screen Room w/ Privacy Panels	0	0	0	--	0
Outdoor Gas Grill w/ Worktable	0	S	S	S	S
Outside Speaker	--	--	S	S	S
Patio Light (LTD: 1940 Only)	S*	OPA	S	S	S

MODELS	LTD	F	P	HS	HW
Courtesy Light on Front (F: 2280BH, 232XR, 282TXR, HS: All Models)	--	S*	--	S	--
110V Exterior Outlet (LTD: 1940 only)	S*	OPA	S	S	S
Black Water Hose Storage	--	--	--	--	S
Door Step	S	OPB*	OP1	S	OP1
Double Door Step (F: 232XR, 283TXR Only, HW: All Models)	--	S*	--	--	S
One Piece Screen Door	--	S	S	--	S
Vented Entrance Door Window w/ Screen	--	--	--	S	--
Folding Grab Handle	--	S	S	S	S
Exterior Graphic Design	S	S	S	S	S
OPTION PACKAGE 1 (Incl. Spare Tire, Tire Bracket, Tire Cover, Installed Step, Awning)	--	--	0	--	0
OPTION PACKAGE B (Incl. Spare Tire, Tire Bracket, Tire Cover, Installed Step, Awning)	--	0	--	--	--
OPTION PACKAGE A (Incl. Privacy Curains, Roof Valances, 4" Foam Cushions w/ Cover, Under Floor 20 Gallon Fresh Water Tank, A/C Bracing, Patio Light, 110V Exterior Outlet)	--	0	--	--	--
STANDARD CONSTRUCTION FEATURES					
Completely Enclosed Living Area	--	--	--	S	--
Fiberglass Vacuum Bonded Roof with Metal Interior Roof	--	--	--	S	--
Large Rear Roof Tinted Sky Light with Shade	--	--	--	S	--
Two Front Roof Tinted Windows with Shades	--	--	--	S	--
Fiberglass Vacuum Bonded Radius Roof w/ No Center Seam	S	S	S	--	S
Steel Air Conditioner Vent Reinforcing Laminated Into Roof	S	OPA	S	--	S
CP 3-Stage Double Arm Lifter Posts	S	S	S	--	S

MODELS	LTD	F	P	HS	HW
Smooth Fiberglass Vacuum Bonded Exterior w/ Black Accents	--	--	S	S	S
Lower Door Operational in Closed Position	S	S	S	--	S
Five Piece Sectionalized Vinolon Supreme Tenting	S	S	S	--	S
Tent Permanently Attached on Bunk Ends and Slide Out	S	S	S	--	S
Plywood Bunk Ends	S	S	S	--	S
Full Perimeter Aluminum Bed Frames	S	S	S	--	S
Easy Glide Scissor Pole Bed Supports	--	S	S	--	S
Powder Coated Rafter Poles and Bed Bows	S	S	S	--	S
Tinted Vinyl Windows	S	S	S	--	S
Large, Opening Picture Window	--	--	--	S	--
One Piece Undercoated Structure Wood Floor	S	S	S	S	S
Powder Coated Tubular Steel Frame	S	S	S	S	S
Rear Crank Down Stabilizer Jacks w/ Sand Pads	S	--	--	--	--
(4) E-Z Crank-Down Stabilizer Jacks w/ Sand Pads	--	S	S	S	S
Seamless, High Density Polyethylene Wheel Wells	S	S	S	S	S
11 Gallon Fresh Water Tank	S	--	--	--	--
Under Floor 20 Gallon Fresh Water Tank	--	S	S	S	S
12 Gallon Gray Water Holding Tanks	--	--	--	--	S
12 Gallon Black Water Holding Tank	--	--	--	--	S
2000 lb. Tongue Jack w/ Swivel Wheel	S	S	S	S	S
Power Front Jack	--	--	--	0	0
7-Way Pigtail Plug	S	S	S	S	S

LTD = LIMITED
 F = FREEDOM
 P = PREMIER

HS = HARD SIDE
 HW = HIGH WALL

S = STANDARD
 SO = STANDARD OPTION
 O = OPTIONAL

-- NOT AVAILABLE
 OP = OPTION PACKAGES
 * = SELECTED MODELS



PRE-DELIVERY INSPECTION FACILITY

20,000 square feet of quality assurance. The bare essentials for a premium product. This state-of-the-art facility gives immediate daily feedback to production for quality assurance in every unit built.



Forest River, Inc. encourages our customers to purchase their Forest River products from a local dealership whenever possible for the following reasons:

It is the goal of Forest River, Inc. that all of our RV owners fully enjoy the RV experience and that customer satisfaction meets or exceeds their expectations!

- 1) Forest River, Inc. dealers are independently owned and operated businesses so priority service and scheduling is at their discretion and is often provided to customers that purchased their unit at that dealership.
- 2) Purchasing locally allows customers to establish meaningful relationships with a dealer, enhancing the RV experience through assistance with product questions, user tips or RV regulations for your state or country, and much more!
- 3) Canadian customers must meet requirements to bring an RV purchased out of the country to their home. These requirements may involve additional inspections and certifications, taxes and fees. Your local Canadian Dealer is a professional at meeting these requirements.
- 4) Scheduling timely warranty repairs and adjustments through a local dealership provides far greater flexibility and convenience to you, the customer!

24/7 EMERGENCY ROADSIDE ASSISTANCE

For a worry-free ownership experience

Forest River includes one

year of Coach-Net RV Technical & Roadside

Assistance with each RV purchase. Whether

new to the RV lifestyle or an experienced RV enthusiast,

Forest River owners have 24/7 access to technical,

operational and emergency road service

coverage throughout the US & Canada.

Coach-Net's fast, dependable

service is just a phone

call away.

Coach-Net[®]

RV Technical & Roadside Assistance

INTRODUCING THE ROCKWOOD HARD SIDE HIGH WALL.

These models bring added conveniences and taller counter tops to our Hard Side line of campers.

* See page 10 for floorplans.



A194HW



ROCKWOOD WARRANTY

For details on Rockwood's complete warranty program, see your Rockwood dealer. When it comes to backing products with the same quality and commitment it does when it begins the manufacturing process, the only name you have to remember when you're looking for a recreational vehicle is Rockwood. Rockwood offers the following additional limited warranties to the original purchasers. Consult written warranty for details.

1. Five-year roof warranty, 2. Twenty-five-year floor warranty, 3. Five-year frame warranty, 4. Five-year tent warranty, 5. Five-year warranty on torsion axle suspension, 6. Limited lifetime warranty of lifter system, 7. One-year bumper to bumper. Ask your dealer about the available lifetime structural warranty.

YOUR ROCKWOOD DEALER

201 West Elm Millersburg, IN 46543 | www.forestriverinc.com/Rockwood
574.642.2640



Learn More

Scan this barcode using a QR Reader on your smart phone to learn more about Forest River.



A Berkshire Hathaway company.

All specifications contained herein are based on the latest product information at time of printing. Forest River reserves the right to make changes in colors, materials, equipment and specifications at any time without notice and assumes no responsibility for any errors in this brochure. Litho. U.S.A P & W: 2013.11.06