

Winnebago
VIATM
2010





Winnebago VIA™

Welcome to the next generation of motor homes. The revolutionary new Via offers full Class A comfort, unparalleled fuel economy and SmartSpace™ design elements you won't find in any other motor home. It's the first Class A motor home designed and built on the versatile Dodge®/Mercedes-Benz® Sprinter chassis, featuring a Mercedes-Benz turbo-diesel engine and automotive drivability. It comes in two 25-foot models, including a full-wall slide on the 25R. The future of motor home design and function is here: the Winnebago Via.

Lofty Expectations

Introducing the latest space-saving innovation from Winnebago Industries: the StudioLoft. This SmartSpace feature turns the cab area into a second bedroom with a large bed that drops down from the ceiling. A fabric wrap gives the StudioLoft instant privacy. With the StudioLoft raised, the Flexsteel cab seats lift six inches and rotate to become an integral part of the living area.

In the living area you'll find a 26" (25T) or 32" (25R) LCD TV. The 26" TV is mounted on a unique bracket that allows for easy viewing from multiple angles. Beautiful cabinetry houses plenty of storage space while vinyl flooring provides an easy-to-clean surface throughout the coach. The stereo system features a CD/DVD player—the perfect excuse to relax in the UltraLeather furniture that comes standard in every Via.



GoWinnebago.com Watch key feature videos, take interactive tours, see the latest promotional offers and a whole lot more at GoWinnebago.com.



StudioLoft The exclusive StudioLoft drops down from the ceiling to create a front bedroom.



TV Versatility Innovative bracketing for the 26" TV in the 25T slides for optimal viewing even when the slideroom is not extended.



Adjustable Shades Built-in shades rise from the window base so you can maintain privacy while enjoying a fresh breeze.



Removable Freezer The freezer compartment can be removed from the refrigerator to create more space and cold-storage flexibility.



25T Newport with Mocha Cherry

Dining Table The pedestal dining table provides a classic dining experience and stows away when not in use.

Eat Right

Save time and space in the galley featuring the Apollo® microwave/convection oven that cooks and browns like a conventional oven in half the time. You'll also have plenty of prep space thanks to space-saving amenities such as the hidden, two-burner range top with a vented range hood. To top it off, a gorgeous backsplash wraps the entire galley. It's everything you need to prepare a delicious meal on the road.

Flexible Space
Flip-up glass covers provide extra counter space when the stove and sink are not in use.





Make Your Bed

The Via 25T introduces the Flex Bed system, allowing you to customize the bedroom depending on your sleeping preference. The bed sleeps as two twin beds or you can choose to add the available Flex Bed kit which allows you to easily convert them into a queen-sized bed. Storage is abundant in either configuration with upper cabinets and large drawers beneath the beds. The 25T also features a 19" LCD TV in the bedroom. A classic queen bed comes standard in the 25R.



Flex Bed System One queen bed or two twin beds? It's your choice in the Via.

Storage Drawers

A storage drawer beneath each twin bed holds extra linens.



Shower

The bathroom features a skylight, handheld showerhead and retractable shower door that wipes clean as it closes.





Automotive Performance

The Dodge/Mercedes-Benz Sprinter chassis makes the Via the most automotive Class A coach on the road. The dash is designed to make driving easier and an available wood-grain appliqué adds to the luxury.

The Jensen™ radio features an LCD touch-screen that doubles as the monitor for the side and rearview cameras. You can also upgrade to the Sirius® satellite radio and enjoy over 120 digital channels and a complimentary six-month subscription.



Cab Seats The UltraLeather seats have multiple adjustment points to keep you comfortable on the road.



IntelliSense™ The new IntelliSense monitor provides critical information and allows you to control key systems on an intuitive touch screen.



Sunvisor A powered sunvisor drops down at the touch of a button.



Side-View Cameras Side-view cameras activate with the turn signals for easier turn navigation.

The New Look in Class A

Select your style from three new exciting full-body paint schemes. Combined with the new aerodynamic body, you're sure to turn heads wherever you go. A 16' electric awning provides plenty of shade at the campsite.

Setting up at your destination is easy with color-coded labels for hookups and an available exterior wash station for quick cleanups. There is even a winterization package included for hassle-free cold-weather storage. An abundance of exterior storage is created by space-saving design considerations, such as an LP tank tucked between the frame rails.



Storage Bring more from home with over 87 cubic feet of storage in the 25T.



TRUELEVEL The TrueLevel holding-tank monitoring system uses sonar technology to read liquid levels from outside the tank. There are no probes to corrode or clog, just accurate readings time after time.



LP Tank Switch The LP tank has a remote switch for simple, safe operation.



Wash Station Rinse off dusty items outside the coach.

We Built a Better Door

You've never seen a motor home door like this before. Inspired by airplane technology, the new Threshold RV Door™ features dual seals, dual latches and hidden hinges that reduce wind and road noise and provide a secure seal. The interior and exterior handles are set at separate, ideal heights for entering and exiting. A built-in screened window provides ventilation with the door closed.



Threshold RV Door The Via features the most advanced entrance door in the industry.

The Foundation of Fun

The Via's revolutionary design starts with the versatile Dodge/Mercedes-Benz Sprinter F50 chassis. A powerful Mercedes-Benz turbo-diesel engine makes the Via a coach that is fun to drive and easy to call home.



- 11,030-lb. GVWR
- Mercedes-Benz 3.0L turbo-diesel engine
- Adaptive ESP® technology
- 5-speed automatic transmission
- 180-amp. alternator
- 5,000-lb.⁵ towing capacity
- Available stylized aluminum wheels

Floorplans & Specifications

Dimensions shown are for sleeping space only and may vary due to styling differences. Dashed lines denote overhead storage areas. Floorplans and specifications are also available online at GoWinnebago.com.



25R Weights & Measures

Length	25'5"
Exterior Height ¹	10'10"
Exterior Width	7'6"
Exterior Storage ² (cu. ft.)	49.9
Awning Length	16'
Interior Height	6'5"
Interior Width	7'3"
Freshwater Capacity w/Heater ³ (gal.)	36
Holding Tank Capacity - Black/Gray ³ (gal.)	30/40
LP Capacity ⁴ (gal.)	13
Fuel Capacity (gal.)	25.0
GCWR ⁵ (lbs.)	15,250
GVWR (lbs.)	11,030
GAWR - Front (lbs.)	4,410
GAWR - Rear (lbs.)	7,720
Wheelbase	170"

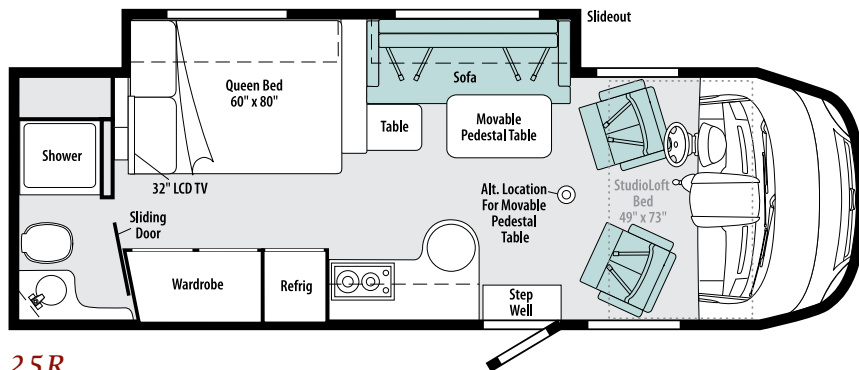

25R
NEW

25T Weights & Measures

Length	25'5"
Exterior Height ¹	10'10"
Exterior Width	7'6"
Exterior Storage ² (cu. ft.)	87.2
Awning Length	16'
Interior Height	6'5"
Interior Width	7'3"
Freshwater Capacity w/Heater ³ (gal.)	35
Holding Tank Capacity - Black/Gray ³ (gal.)	36/36
LP Capacity ⁴ (gal.)	13
Fuel Capacity (gal.)	25.0
GCWR ⁵ (lbs.)	15,250
GVWR (lbs.)	11,030
GAWR - Front (lbs.)	4,410
GAWR - Rear (lbs.)	7,720
Wheelbase	170"

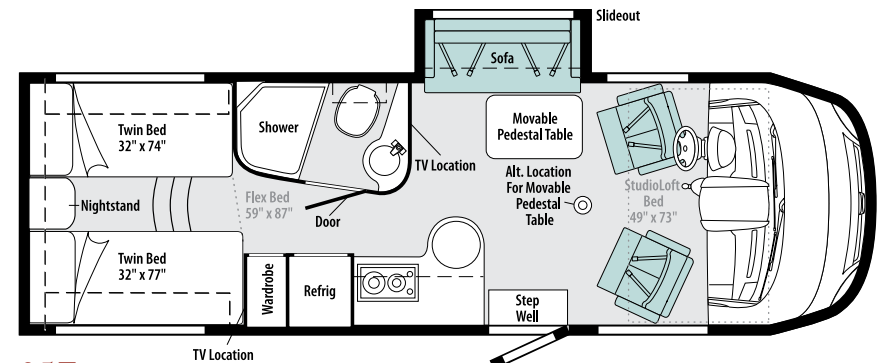

25T
NEW

Dodge®/Mercedes-Benz® Sprinter F50 Chassis

154-hp Mercedes-Benz 3.0L 6-cylinder turbo-diesel engine

5-speed automatic transmission w/tip shift

Hydraulic brakes w/ABS

Adaptive ESP® technology

180-amp. alternator

Trailer Hitch⁵: 5,000-lb. drawbar/500-lb. maximum vertical tongue weight w/7-pin connector

Stainless steel wheel liners

Optional Equipment

- Stylized aluminum wheels

Cab Conveniences

Stereo: AM/FM, CD player, LCD screen, iPod interface connector and remote

Cab Seats: armrest, adjustable lumbar support, power lift, swivel/slide, recline and headrest

Power, tilt/telescoping steering wheel

12-volt powerpoints

Power mirrors w/defrost

Cruise control

Chassis/house battery radio power switch

Side-view video camera system

Powered sunvisor

Front wraparound curtain

Rearview monitor system w/one-way audio

Optional Equipment

- Sirius® satellite radio w/complimentary 6-month subscription
- Dash appliqué package

Interior

LCD touch monitor panel

Key-activated slideroom master lock switch

StudioLoft™

Privacy curtain

Stereo System: AM/FM, alarm clock, CD/DVD, input jack

26" LCD TV (25T)

32" LCD TV (25R)

Satellite system ready

Removable carpet mats

Dual-pane windows w/built-in screen and shade

Amplified digital TV antenna system

Powered roof vent (bath)

Optional Equipment

- Satellite TV antenna system w/elevation sensing unit
- Roof vent w/powerd ventilator fan (bath)

Galley

Apollo® Half Time microwave/convection oven w/range fan

2-burner range top w/glass cover

Refrigerator w/removable freezer compartment

Stainless steel sink w/glass cover and folding faucet

Laminate countertops

Optional Equipment

- Water filtration system w/cold water faucet

Bedroom

Twin beds w/foam mattresses and access to storage below (25T)

Queen bed w/foam mattress (25R)

Room divider privacy curtain

19" LCD TV (25T)

Optional Equipment

- Flex Bed kit w/panels and cushions

Bath

Shower w/wall surround

Flexible showerhead

Retractable self-cleaning shower door

Skylight

Exterior

Electric patio awning

Automatic entrance door steps

Lighted storage compartment

Mud flaps (rear)

Porch light

Optional Equipment

- Lower front protective mask

Heating & Cooling System

13,500 BTU roof-mount air conditioner

20,000 BTU furnace

Optional Equipment

- High-efficiency A/C heat pump

Electrical System

Service Center: cable TV input, power cord, portable satellite dish hook-up

AC/DC load center, 45-amp. converter/charger

IntelliSense™ electrical system monitor panel

Auxiliary start circuit

Battery disconnect system (coach)

2 deep-cycle, Group 24 RV batteries

Automatic dual-battery charge control

3,200-watt Cummins Onan® diesel generator

30-amp. power cord

300-watt DC/AC inverter

Plumbing System

Service Center: color-coded labels, city water hookup/tank diverter fill, drainage valves, 10' sewer hose

TrueLevel™ holding-tank monitoring system

6-gallon 120 VAC/LP water heater

Winterization Package: water heater bypass valve and siphon tube

On-demand water pump

Manual dump valve

Permanent-mount LP tank w/remote fill

Optional Equipment

- Heated drainage system
- Exterior wash station

Safety

Seat belts

LP, smoke and carbon monoxide detectors

10 BC fire extinguisher

Ground fault interrupter

High-mount brake lamps

Daytime running lamps

Fog lamps

Warranty⁶

12-month/15,000-mile basic warranty⁷

36-month/36,000-mile limited warranty on structure⁷

10-year limited parts-and-labor warranty on roof skin⁷

- Optional
- NA Not Available

- The height of each model is measured to the top of the tallest standard feature and is based on the curb weight of a typically equipped unit. The actual height of your vehicle may vary by several inches depending on chassis or equipment variations. Please contact your dealer for further information.
- The load capacity of your motor home is designated by weight, not by volume, so you cannot necessarily use all available space when loading your motor home.
- Capacities are based on measurements prior to tank installation. Slight capacity variations can result due to installation applications.
- Capacities shown are tank manufacturer's listed water capacity (WC.) Actual filled LP capacity is 80% of listing due to overfilling prevention device on tank.
- Actual towing capacity is dependent upon your particular loading and towing circumstances, which includes the GVWR, CAWR and GCWR as well as adequate trailer brakes. Please refer to the Operator's Manual of your vehicle for further towing information.
- See separate chassis warranty.
- See your dealer for complete warranty information.

Not all items available in combination. See dealer for details.

Winnnebago Industries™ continuing program of product improvement makes specifications, equipment, model availability and prices subject to change without notice. Comparisons to other motor homes are based on the most recent information available at printing.

Exteriors

The Legacy Rolls On

For more than fifty years, Winnebago Industries® has been creating the RVs and motor homes that have enabled people to live their dreams, see the country, visit friends and enjoy more time together as a family. The Via™ continues the Winnebago legacy of combining innovations, features and quality in a coach you'll be proud to call home.



Diamond
FULL-BODY PAINT



Nightgold
FULL-BODY PAINT



Red Accent
FULL-BODY PAINT



THE MOST RECOGNIZED
NAME IN MOTOR HOMES™

Interior Décor

Choose from three fabric collections and two cabinet woods.

ULTRA-LEATHER

ACCENT

VINYL FLOOR

BEDSPREAD



Newport with Sandbox UltraLeather™

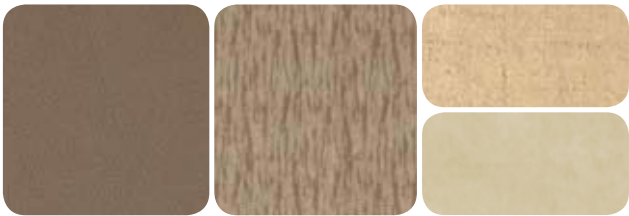

Split Rock with Bark UltraLeather



Bombay with Putty UltraLeather



Sunset Cherry



Mocha Cherry



Built by Winnebago Industries. Built to last.

Winnebago motor homes are built by Winnebago Industries, the company that defined motor homes. The company that built its reputation on quality construction. The company that transformed the motor home concept into a way of life.



Today, Winnebago Industries brings that reputation for quality and more than fifty years of RV innovation to the design and construction of every motor home. It's all a part of SuperStructure®, our exclusive system of proprietary structural components that instills in each motor home improved strength and durability.

Solid Foundation Steel and aluminum truss work provides a solid, flat foundation for the floor and sidewalls. Our engineers enhance the handling and stability by taking special care to properly distribute the weight of all components.



Interlocking Joints The floor, sidewalls and roof are all integrally connected using interlocking joints. This ensures the Via body is a cohesive unit with maximum strength and durability.

Attention to Detail Whether it's sending every Via through a high-pressure water tunnel to check for leaks or labeling individual wires and barcoding parts to save time and frustration during service, Winnebago Industries considers every detail to ensure your Winnebago motor home provides you with years of pleasure.

Strong as Steel Key appliances and cabinetry are secured to a metal substructure for added stability and safety.

E-Coating Winnebago Industries employs an automotive-style dip tank process to apply an advanced electro-deposition coating on critical steel components for corrosion protection.

Thermo-Panel® Sidewalls Invented by Winnebago Industries, Thermo-Panel construction combines a fiberglass panel, high-density block-foam insulation and aluminum support structures to create some of the most long-lasting, lightweight sidewalls in the industry.



Winnebago 1-year-old fiberglass roof



Competitor's 1-year-old rubber roof

Fiberglass Roof The Via features a crowned, one-piece fiberglass roof, backed with a 10-year limited parts-and-labor roof skin warranty. Fiberglass offers superior strength, attractiveness and durability over the rubber roofs found on many competitive models which can chalk, streak and degrade over time. Fiberglass also provides increased puncture and tear resistance.



GoWinnebago.com
Visit us on the web for more information on all of our motor homes, the latest product updates and a host of web-exclusive content.



Take a Tour We're proud of our process, state-of-the-art facilities and the people who make Winnebago Industries number one. We invite you to visit our complex in Forest City, Iowa, for a first-hand look at the dedication and technology behind every motor home we build.



Recognized Quality The Recreation Vehicle Dealer Association annually rates RV manufacturers and awards the Quality Circle Award to manufacturers that provide exceptional products, service and support. Winnebago Industries is proud to be the only manufacturer that has received this award every year since its inception.



Committed to Service We back our motor homes with the industry's best service after the sale:

- 12-month/15,000-mile basic limited warranty
- 36-month/36,000-mile warranty on structure
- 10-year standard limited parts-and-labor roof skin warranty
- Complimentary 24-hour roadside assistance program

- RV Technical Assistance Hotline
- RV Service Appointment Assistance
- Emergency Trip Interruption
- Emergency Message Service
- Nationwide Trip Routing
- Fee-Free Travelers Cheques



- TripSaver Fast Track Parts guarantees that in-stock warranty parts ship directly to your dealer within 24 hours
- National dealer service network



WIT Club Winnebago owners are like family. Joining the Winnebago-Itasca Travelers Club is a great way to meet and travel with other Winnebago enthusiasts. Members enjoy:

- Caravans and rallies
- Local and state group activities
- RV travel benefits

For Sales and Service Information Contact:



THE MOST RECOGNIZED
NAME IN MOTOR HOMES™

NYSE listing: WGO

Printed in USA

Seat belts are your most important hookup. Always buckle up.
© 2009 Winnebago Industries, Inc.