

Travel Trailers • Fifth Wheels • Toy Haulers • Destination Trailers

**PUMA**  
by PALOMINO

# PUMA

by PALOMINO

*Travel Trailers • Fifth Wheels  
Toy Haulers • Destination Trailers*



*Always an adventure...*





### **30RLIS Premier Edition**

*This convenient, entertainment friendly Premier Edition package option is loaded with "open concept" styling. The kitchen features a spacious island equipped with an undermount, double-bowl sink, a pull-down gooseneck faucet and Living Stone solid surface countertops. Stainless steel appliances, a decorative backsplash, plus Espresso raised panel cabinet and refrigerator doors add residential appeal. LED lights highlight plush furnishings throughout the living spaces. The rack and pinion flush-floor slide out adds head room. Shown in Sand decor with optional theater seating Beauflor® tile flooring.*



# PUMA

by PALOMINO

### **30RLIS Premier Edition**

*Whatever your travel lifestyle, there's an easy to tow Puma model for you. Puma floorplan configurations are designed with convenient features to make the most of leisure living – including a variety of kid's bunk room models.*

*The 30RLIS features generous linen storage, a residential style vanity with medicine cabinet, plus a glass door shower with a seat and skylight.*





### **30RLIS Premier Edition**

*This stylish upgraded slide out galley/entertainment center is shown with an Espresso wood panel 8 cu. ft. double door refrigerator, an extra large pantry, plus an easy to clean glass stove cover. Kick back and relax with a Soundbar, equipped with DVD/CD Bluetooth technology. Durable, abrasion resistant surf(x)<sup>®</sup> 3D laminates provide a long-lasting "like new" appearance and years of use. Bright, inviting LED lighting and smooth rack and pinion flush-floor slide rooms add to the open feel. Shown in Sand decor and Beauflor<sup>®</sup> tile flooring with these options: a 39" LED TV and a fireplace with faux stone insert.*







The 30 RKSS bath features a spacious linen closet, a glass door 30" x 48" shower with a seat and skylight.

This spacious slide out features a large radiused booth dinette, angled, overhead cabinets and a plush, tri-fold sofa that converts to an additional sleeping area. Designer valances are shown with optional night shades.

### 30RKSS

Now you're cooking with plenty of counter space, a glass stove cover, a large 60/40 undermount sink and a built-in spice rack. Sleek black kitchen appliances include a large oven and a 6 cu. ft. refrigerator/freezer. Large picture windows let in plenty of fresh air and natural light. Chocolate decor with Vagabond cabinetry and Beauflor plank flooring (with a 7-year cold crack warranty) shown.





# PUMA

by PALOMINO



Puma is constructed with durable, abrasion resistant surf(x)<sup>®</sup> 3D laminates throughout, for a long-lasting "like new" appearance. A handy built-in spice rack saves cabinet space. All Pumas are equipped with a centrally located multiple switch panel that controls the slides, interior lights, exterior porch light, water pump, water heater, and monitors battery and tank capacities. The corner entertainment center has an AM/FM/CD/DVD/Bluetooth stereo with sound bar and provides a great view from any vantage point. The 39" LED TV is an available option.

## 297RLSS

This popular model has standard push-back recliners and an extra large picture window. Shown with Vagabond cabinetry in Mist decor with optional night shades.





# PUMA

by PALOMINO

## Travel Trailers

Puma offers 19 Travel Trailer floor plans.

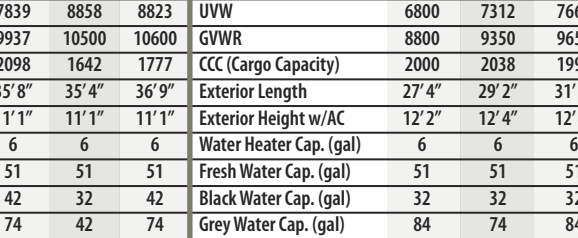
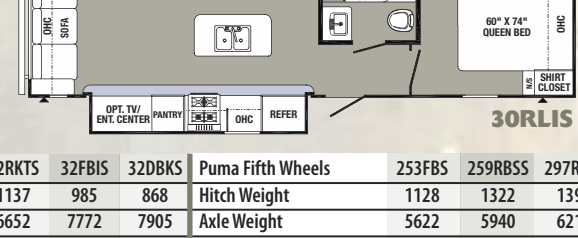
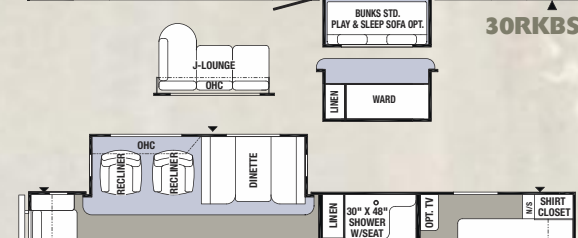
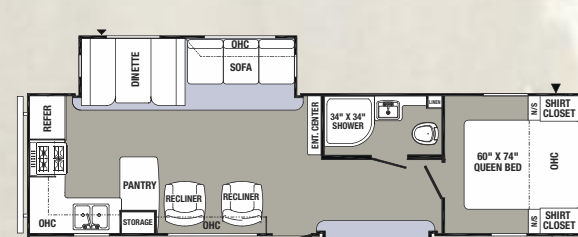
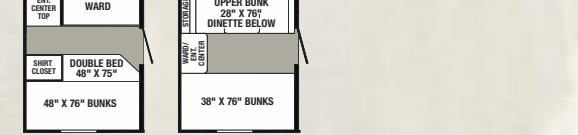
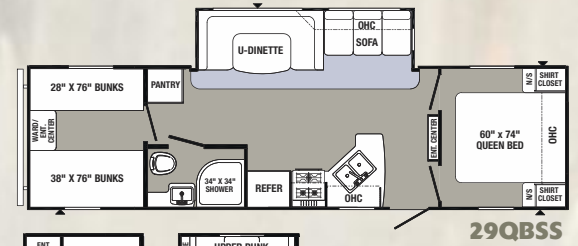
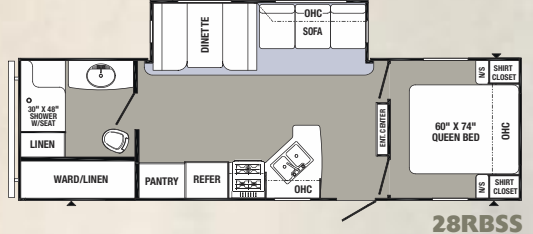
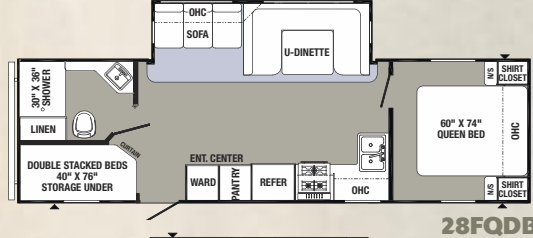
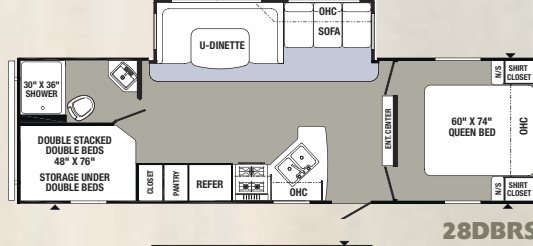
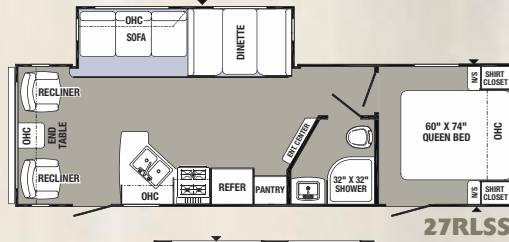
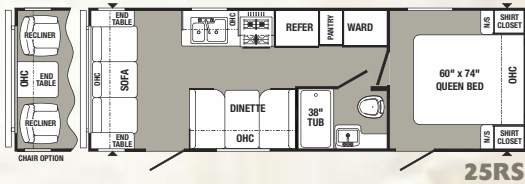
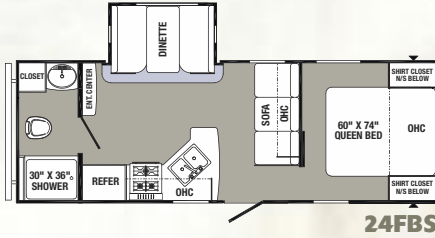
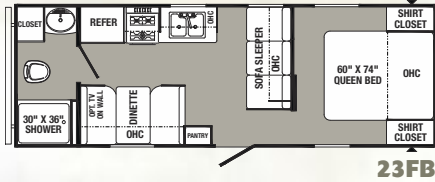
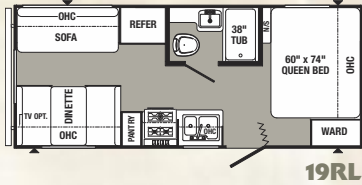

Puma Travel Trailers	19RL	23FB	24 FBS	25RS	27RLSS	28DBRS	28FQDB	28RBSS	29QBSS	30RKBS	30RLIS	30RKSS	30FBSS	30FKSS	31DBTS	31BHSS	32RKTS	32FBIS	32DBKS	Puma Fifth Wheels	253FBS	259RBSS	297RLSS	295BHSS
Hitch Weight	495	744	570	700	756	659	664	900	740	925	835	837	1209	1228	714	912	1137	985	868	Hitch Weight	1128	1322	1398	1358
Axle Weight	3916	4049	4780	4454	5409	6052	5668	5803	6116	6009	6890	6167	6896	6714	7561	6996	6652	7772	7905	Axle Weight	5622	5940	6212	7336
UVW	4449	4831	5388	5192	6203	6749	6370	6753	6906	6984	7775	7004	8155	7992	8325	7958	7839	8858	8823	UVW	6800	7312	7660	8744
GVWR	6000	6500	6800	6700	7756	8250	8000	8500	8500	8500	9635	8800	9950	9950	9950	9600	9937	10500	10600	GVWR	8800	9350	9650	10750
CCC (Cargo Capacity)	1551	1669	1412	1508	1553	1501	1630	1747	1594	1516	1860	1746	1795	1958	1625	1642	2098	1642	1777	CCC (Cargo Capacity)	2000	2038	1990	2006
Exterior Length	23' 7"	27' 4"	27' 4"	28'	31' 5"	33' 0"	33' 0"	31' 11"	33' 11"	34' 9"	34' 5"	33' 10"	34' 7"	34' 9"	34' 5"	35' 4"	35' 8"	35' 4"	36' 9"	Exterior Length	27' 4"	29' 2"	31' 8"	33' 8"
Exterior Height w/AC	10' 5"	10' 5"	10' 5"	10' 5"	11' 1"	11' 1"	11' 1"	11' 1"	11' 1"	11' 1"	11' 1"	11' 1"	11' 1"	11' 1"	11' 1"	11' 1"	11' 1"	11' 1"	11' 1"	Exterior Height w/AC	12' 2"	12' 4"	12' 4"	12' 4"
Water Heater Cap. (gal)	6	6	6	6	6	6	6	6	6	6	6	6	6	6	6	6	6	6	6	Water Heater Cap. (gal)	6	6	6	6
Fresh Water Cap. (gal)	51	51	51	51	51	51	51	51	51	51	51	51	51	51	51	51	51	51	51	Fresh Water Cap. (gal)	51	51	51	51
Black Water Cap. (gal)	32	42	42	42	42	32	32	32	42	32	42	42	42	42	32	32	42	32	42	Black Water Cap. (gal)	32	32	32	32
Grey Water Cap. (gal)	42	42	42	42	42	74	74	84	42	84	42	84	42	74	42	42	74	42	74	Grey Water Cap. (gal)	84	74	84	84
Tire Size (in)	14"	14"	14"	14"	15"	15"	15"	15"	15"	15"	15"	15"	15"	15"	15"	15"	15"	15"	15"	Tire Size (in)	15"	15"	15"	15"
Awning Size (ft)	12'	16'	16'	16'	21'	21'	20'	17'	19'	21'	21'	16'	19'	20'	18'	21'	18'	16'	13'	Awning Size (ft)	16'	19'	20'	18'

Please refer to the chart on the back cover for definitions.

Fifth wheel weights include standard 13.5 BTU roof air, double door refrigerator, awning and an optional oven.



## Fifth Wheels

Puma offers four Fifth Wheel floor plans.

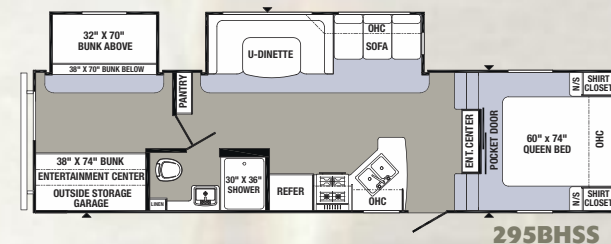
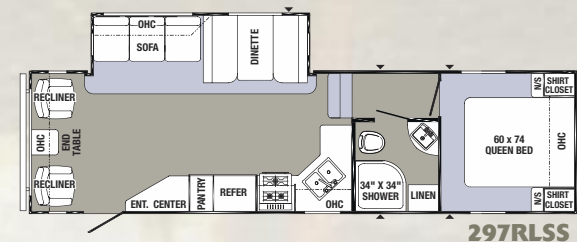
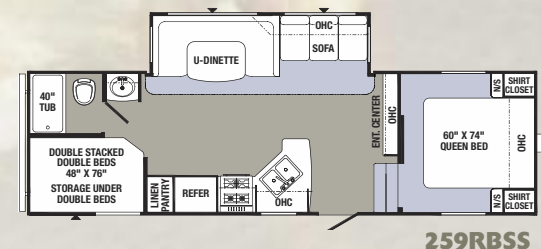
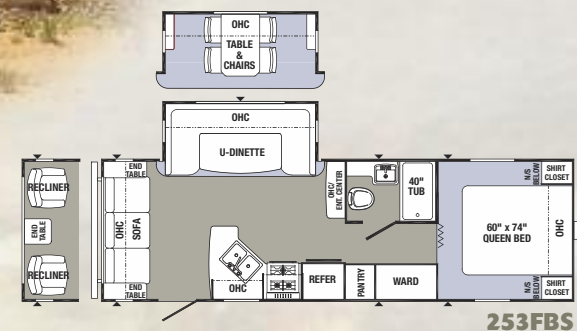
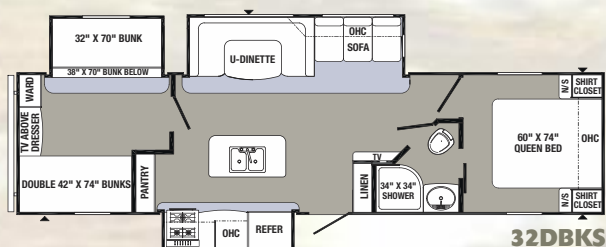
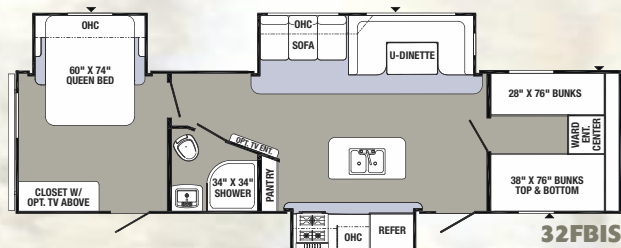
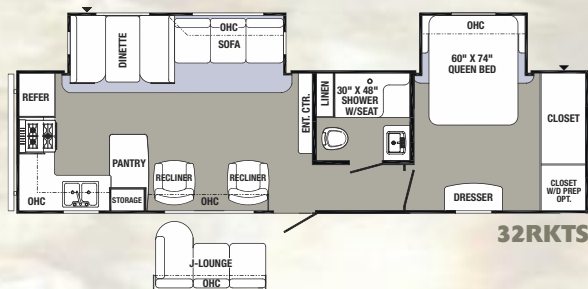
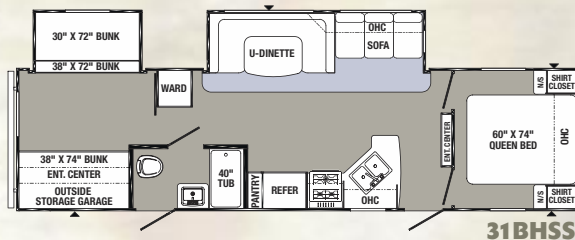
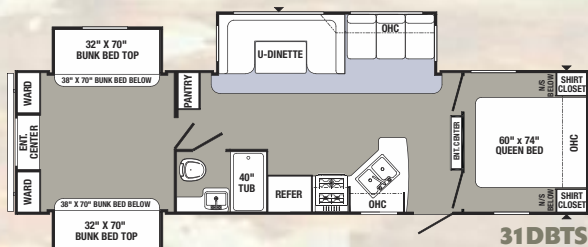
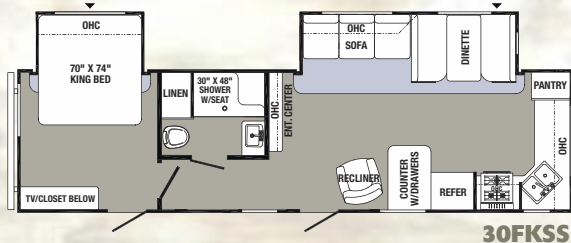
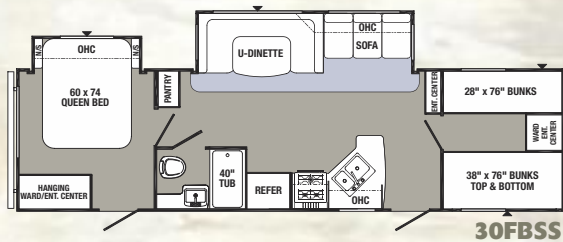
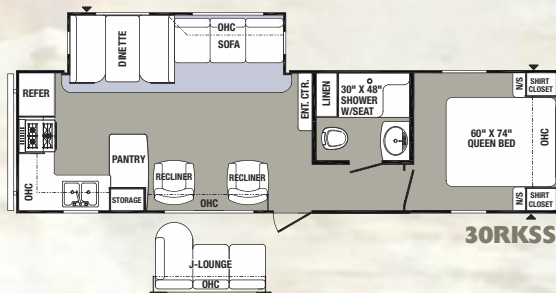

## Outside Kitchen Options



OUTSIDE KITCHEN OPT.  
W/GRILL

28RBSS, 29QBSS, 30FBSS,  
31BHSS, 31DBTS, 32FBIS,  
32DBKS, 259RBSS,  
295BHSS



MINI CAMP KITCHEN OPT.  
W/GRILL

28DBRS, 28FQDB, 28RBSS,  
29QBSS, 30FBSS, 31BHSS,  
31DBTS, 32FBIS, 32DBKS  
259RBSS, 295BHSS



MINI CAMP  
KITCHEN OPT.

30RLIS





# PUMA

by PALOMINO

## Destination Trailers

Puma offers Seven Destination Trailer floor plans.

### 39BHT

Experience the perfect vacation home. Puma Destination Trailers offer comfortable living with seven spacious floor plans, and a choice of two bedroom and den options for a private retreat. Residential style furnishings and a large master bedroom with king size bed give a well appointed feeling of home. Vagabond cabinetry shown with Prairie decor.



All Destination models include a large, California king sized bed.



The 39BHT features a standard double bunk slide out with an optional tri-fold sofa.



### 39BHT

The 39BHT features a 18' flush-floor slide out with large bay windows that let in plenty of natural light. All Puma Destination trailers include a four burner residential range a with a pull-out broiler pan, a 16 cu. ft. refrigerator with an ice maker, and exceptional counter space. Shown with Vagabond cabinetry in Prairie decor with these options: Beauflor® tile flooring, a free standing dinette with four chairs, and a ceiling fan.



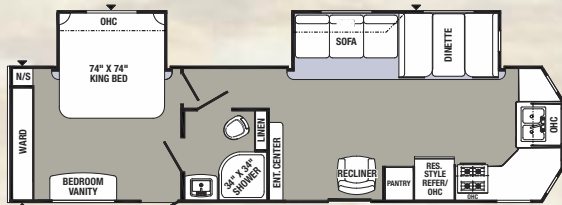

**32DFK**

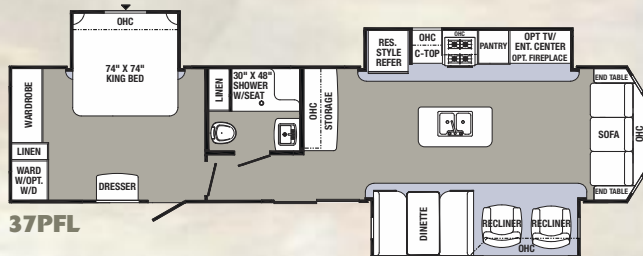

**37PFL**

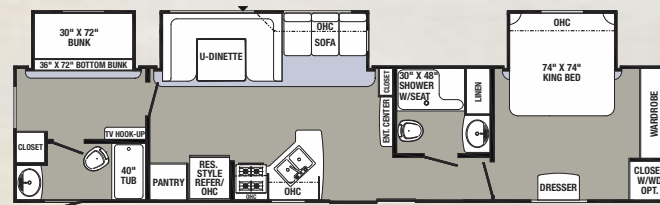

**38PTB**

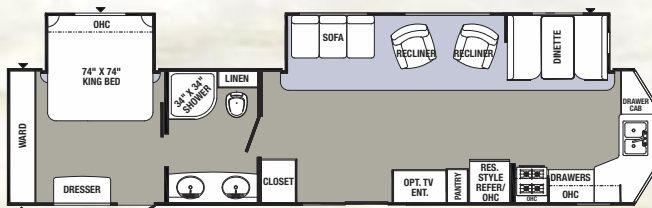

**39PFK**

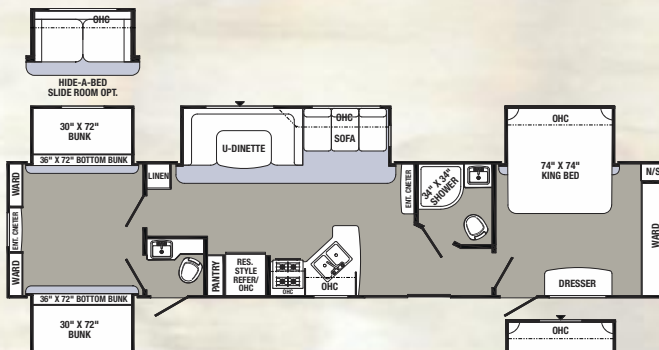

**39PQB**

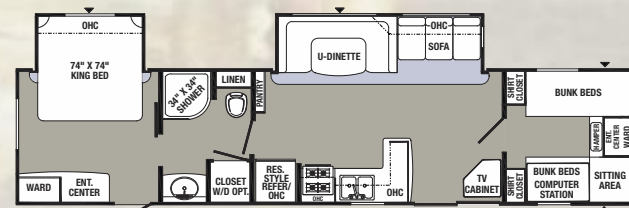

**39PBS**

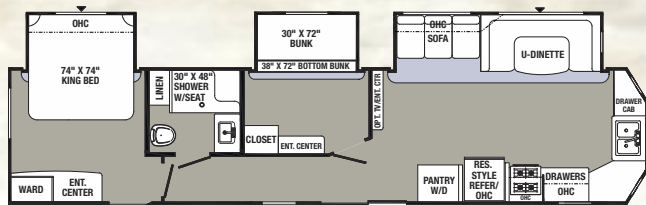

**39BHT**

## Outside Kitchen Option



OUTSIDE KITCHEN OPT.  
W/GRILL

**39PBS, 39PQB**

## 39BHT

All Pumas are built with durable, abrasion resistant surf(x)<sup>®</sup> 3D laminates for a long-lasting "like new" appearance. Destination models include a free-standing four burner range, tinted glass sliding patio doors, and LED lighting throughout. 39BHT has a full, walk-in closet, large enough to accommodate a washer/dryer. The storage friendly entertainment center features a Soundbar and is shown with optional 39" LED TV.

Puma Destination Trailers	32DFK	37PFL	38PTB	39PBS	39PFK	39PQB	39BHT
Hitch Weight	1342	1780	1350	1450	1854	1413	1509
Axle Weight	6352	7914	8330	7736	8091	9237	8271
UVW	7744	9744	9730	9110	9995	10700	9830
GVWR	10142	11940	11510	11610	12014	13413	11669
CCC (Cargo Capacity)	2398	2196	1780	2500	2019	2713	1839
Exterior Length	35'4"	40'6"	41'6"	39'7"	40'6"	41'11"	40'6"
Exterior Height w/AC	11'9"	11'9"	11'9"	11'9"	11'9"	11'9"	11'9"
Water Heater Cap. (gal)	6	12	12	12	12	12	12
Fresh Water Cap. (gal)	51	51	51	51	51	51	51
Black Water Cap. (gal)	42	42	64	32	32	74	42
Grey Water Cap. (gal)	74	74	116	84	84	116	84
Tire Size (in)	15"	15"	15"	15"	15"	16"	16"
Awning Size (ft) OPT.	17'	20'	21'	21'	21'	21'	21'

Please refer to the chart on the back cover for definitions.





# PUMA

by PALOMINO

## Toy Haulers

Experience the ultimate in convenience on your off-road adventure. Take your gear, toys and friends and head out for the time of your life, complete with everything you need to play hard all day, and rest easy all night!

### 359THKS Premier Edition

This Premier Edition package option features a spacious island equipped with an undermount, double-bowl sink, a pull-down gooseneck faucet and Living Stone solid surface countertops. Stainless steel appliances and an 8 cu. ft. two door refrigerator with raised panel cabinet doors, plus abundant pantry storage make life on the go convenient. Espresso cabinetry shown with Sand decor.



This standard plush L-trifold sofa converts to an additional sleeping area.



Choose the configuration that fits your style. Select from optional double electric trac beds (shown), single trac bed or the HappiJac dinette. Frame mounted D-rings for maximize stability. Dovetail ramps provide easy cargo area access. Standard industrial black TPO flooring is easy to keep clean.





## 359THKS Premier Edition

Includes a colored fiberglass front cap with LED lights, plus an LED strip light on the awning, a large grab handle, aluminum wheels, an exterior shower and exterior speakers.



## Toy Haulers Fifth Wheels

Puma offers five Toy Hauler Fifth Wheel floor plans.

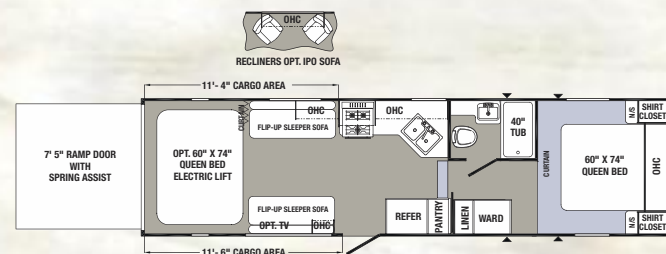

298FQU

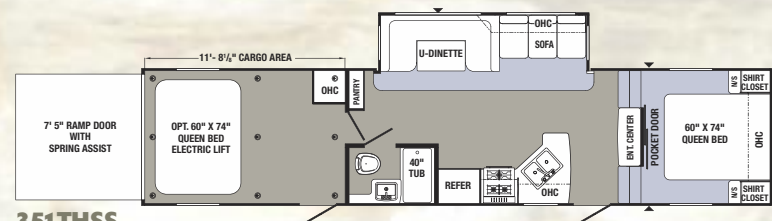

351THSS

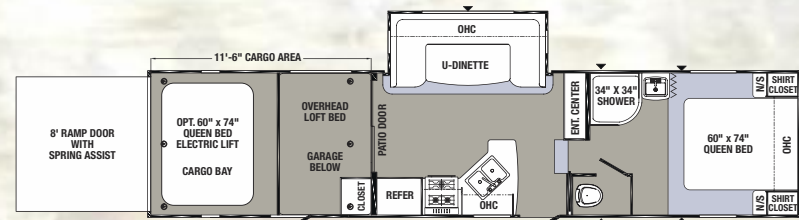

356QLB

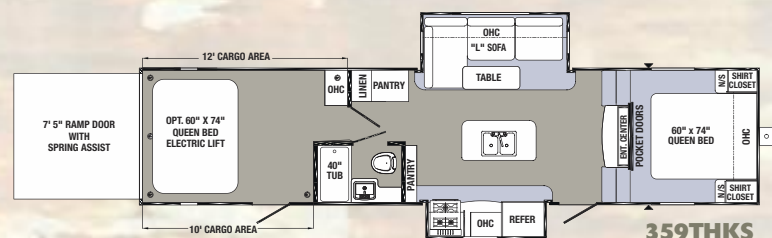

359THKS

Puma Toy Haulers TT	21TFU	25TFS	27SBU	30THSS	Puma Toy Haulers FW	298FQU	351THSS	356QLB	359THKS	373QSI
Hitch Weight	922	779	905	1174	Hitch Weight	1830	1845	1844	2367	1924
Axle Weight	4496	6162	6530	6604	Axle Weight	5790	7665	7757	7530	7660
UVW	5456	6991	7485	7828	UVW	7670	9560	9651	9947	9634
GVWR	7922	10491	11065	11334	GVWR	11170	13560	13651	13947	13924
Cargo Capacity	2466	3500	3580	3506	CCC (Cargo Cap.)	3500	4000	4000	4000	4290
Exterior Length	24' 10"	29' 8"	30' 5"	35' 4"	Exterior Length	30' 11"	37' 0"	35' 10"	36' 8"	37' 11"
Exterior Height w/AC	12' 0"	12' 0"	12' 0"	12' 0"	Exterior Height w/AC	12' 0"	12' 0"	13' 2"	13' 2"	13' 2"
Water Heater Cap. (gal)	6	6	6	6	Water Heater Cap. (gal)	6	6	6	6	6
Fresh Water Cap. (gal)	51	100	100	100	Fresh Water Cap. (gal)	100	100	100	100	100
Black Water Cap. (gal)	32	42	32	42	Black Water Cap. (gal)	42	32	32	32	32
Grey Water Cap. (gal)	42	42	42	42	Grey Water Cap. (gal)	32	32	84	42	74
Tire Size (in)	15"	15"	15"	15"	Tire Size (in)	15"	16"	16"	16"	16"
Awning Size (ft)	14'	14'	14'	16'	Awning Size (ft)	17'	18'	21'	21'	19'

Please refer to the chart on the back cover for definitions.

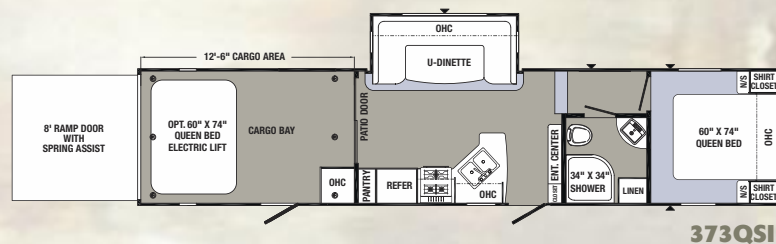

373QSI

## Toy Haulers Travel Trailers

Puma offers four Toy Hauler Travel Trailer floor plans.

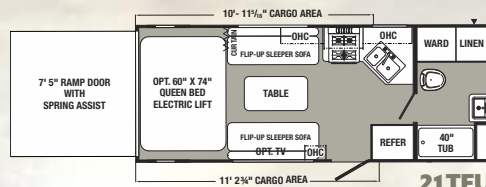

21TFU

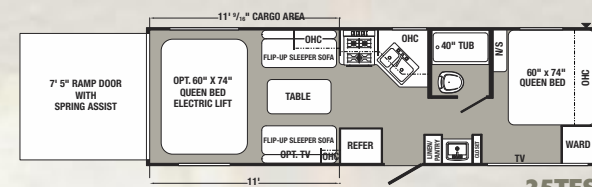

25TFS

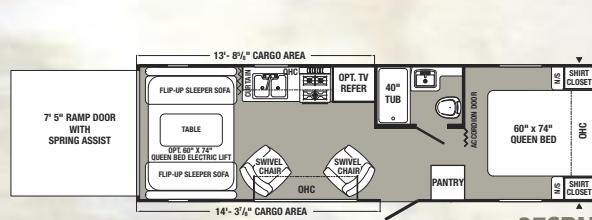

27SBU

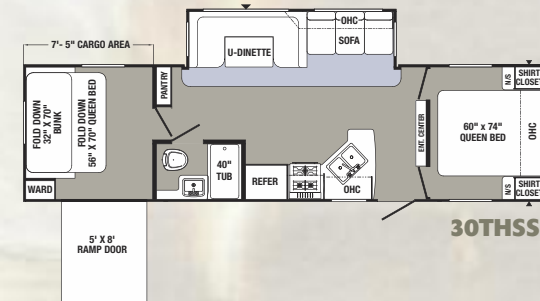

30THSS

## Options



25TFS



25TFS

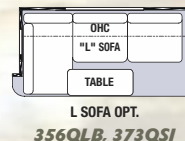

356QLB, 373QSI



# PUMA

by PALOMINO

Construction – Longer Lasting • Better Built



All Pumas are equipped with long-life LED lighting inside.



- A.** Rubber Roof (12 year warranty)
- B.** Rugged, Powder Coated Steel I-Beam Frame
- C.** Sturdy .024 Gauge Aluminum Skin
- D.** Exterior Amber Lens Patio Light
- E.** Exterior Hitch Light for Night-Time Hook Up
- F.** 51 Gallon Fresh Water Tank
- G.** Bold Exterior Graphics
- H.** Residential Grade Carpet with Pad
- I.** Color Band Metal Enhances Exterior Looks
- J.** Sidewall Studding Spaced 16" Apart
- K.** Longitudinal Floor Studding Spaced 12" Apart

- L.** 5/8" One Piece Floor Decking
- M.** Beauflor® Linoleum Flooring with a Seven Year Cold Crack Warranty
- N.** R 7 Fiberglass Insulation Cut and Glued Between Sidewall Studs
- O.** 4-1/2" Crowned Truss Roof Rafters
- P.** Steel Crossmembers for Added Support
- Q.** Floor Ducted Heat

- R.** Insulated Wrapped Ducted Air Conditioning Runs
- S.** 3/8" Roof Decking
- T.** Puma Next Generation™ Enclosed and Heated Water Tank
- U.** Radius Exterior Doors



## Standard Features



LED Interior Lighting



Prewired for Solar Charging System



Back-up Camera Ready



Glass Range Cover



King Jack TV Antenna



Mini Blinds



Kitchen Drawer Glides



6 Cu. Ft. Double Door Refrigerator



Beauflor® Wood Grain Linoleum



Quilted Bedspread



AM/FM/CD/DVD/Bluetooth Stereo with Sound Bar



Bedroom TV Hook-up



Durable, lightweight, Shaker style mortise and tenon cabinet doors perfect color match



Switch panel controls slides, lights, porch light, water pump/heater; monitors battery and tank capacities



Electric Awning with LED Strip Light (Opt. Destination trailers)



Seamless Countertop with Undermount Sink and Cover



30" x 48" ABS Shower with Seat and Glass Shower Doors (Available on select models)

## Options



Optional Beauflor® Tile Linoleum



Optional Night Shades



Optional Theater Seating



8 Cu. Ft. Double Door Refrigerator with Raised Panel Doors (Standard on Premier, optional on Puma)



Optional 30 gallon fuel station (Fifth wheel toy haulers)

Garages include heavy duty D-ring tie-downs, anchored into an 8" x 14" steel plate welded to the frame for secure travel. Dovetail diamond plate for safe, easy access.



Generator Box on Toyhaulers



Aluminum Wheels (Standard on Premier Edition)

## Side Paw Kitchen

This convenient 30FBS outside kitchen puts you where the action is. Watch the game on the outside entertainment center, while enjoying the fresh air. It includes a microwave, a 4 cu. ft. refrigerator and a standard grill (not shown).





# PUMA

by PALOMINO

## Value Shopper Package

(Mandatory Upgrade All Models)

- Back-up Camera Ready
- Pre-wired for Solar System
- LED Lighting
- 13,500 BTU Ducted Air Conditioner
- 6 Cu. Ft. Double-door Refrigerator
- 16.2 Cu. Ft. Residential Refrigerator (Destination)

- Electric Awning with LED Strip Light (Opt. Destination)
- Beauflor® Woodgrain Linoleum with 7-Year Cold Crack Warranty
- Bedspread
- Bedroom TV Hook-up
- TV Antenna with Booster and Cable Hook-up

- Mini Blinds
- ABS Tub Surround
- AM/FM CD/DVD Stereo with Sound Bar
- Glass Range Cover
- 60/40 Undermount Acrylic Kitchen Sink with Cover(s)
- Patio Door (Destination)

## Travel Trailers & Fifth Wheels

### Standard Features

#### Exterior

- Radius Entry Doors
- Powder Coated Frames
- EZ Lube Axles
- Tinted Safety Glass
- Clamp Ring Windows
- Double Entry Doors (Where Applicable)
- Pass-Thru Storage (Where Applicable)
- Power Awning
- Colored Front Fiberglass Cap with Diamond Plate (Fifth Wheels)
- Upgraded Colored Metal
- Rubber Roof - 12 Year Manufacturer's Warranty
- 9" Three-Tier Steps
- Rain Gutters with Large Drop Spouts
- Automotive Style Fender Skirts
- Radius Baggage Doors
- Darco Wrapped Underbelly
- One-piece, 24' Sheet, 5/8" Floor Decking (25 Year Manufacturer's Limited Warranty)
- 2" x 3" Flush Joists on 12" Centers
- Pass-Thru Exterior Baggage Compartments (Where Applicable)
- 2-20 lb. Gas Bottles
- 6 Gal. DSI Hot Water Heater
- Rack and Pinion Electric Slide System with Manual Override (Standard on all Slide-Out Models)
- Heavy Duty Storage Door for the Puma Den Option

- Clamp Ring Luggage Doors
- Large 14" x 34" Front Pass Thru Baggage Door (TT Only)

#### Interior

- 80" Interior Height
- Floor Ducted Heat
- 30,000 BTU Furnace
- Flush-floor Slide-outs
- 16" Deep Overhead Cabinets in Super-Slide Models
- Decorative Kitchen Splashboard
- Kitchen Ball Bearing Drawer Guides
- Spice Rack (Kitchen)
- Divided Silverware Drawer
- New High Rise Tea Pot Handle Kitchen Faucet
- Suburban 3-Burner, High Output Range
- Built-in Knife Rack
- NEW LED Lights
- Upgrade Window Treatment
- 55 Amp Converter with Battery Charger
- AM/FM CD/DVD Bluetooth Stereo
- Push-back Recliner(s)\*
- Wood Medicine Cabinet with Mirrored Door
- Power Vent in Bath
- Glass Shower Door\*
- 12V Shower LED Light
- Evergreen High Density Foam Mattress
- Bedroom Carpet (FW)
- Upgraded Soft Teddy Bear Bunk Mats
- Shirt Closet in Front Bedrooms

- Nightstands in Front Bedrooms
- Four Interior Decors
- Coat Hooks in Entry Way (Most models)
- Satin Nickel Hardware, Light and Bath Fixtures
- Overhead Cabinets in Super Slide Room\*
- Radius Dinette Seats
- Upgraded Carpet (16 oz. with Pad)
- Designer Window Treatments (Living Room)
- New Larger Countertops (Most Models)

### Standard Safety Features

- CO<sub>2</sub> Detector
- LP Leak Detector
- Fire Extinguisher
- Smoke Detector

### Options

#### ■ Puma Premier Edition Package

- Grab Bar
- 8 Cu. Ft. Refrigerator
- Night Shades
- Espresso Color Raised Cabinet Doors with Refrigerator Insert
- Pull-down Faucet
- Stainless Steel Appliances
- Upgraded Galley Backsplash
- Upgraded Mattress
- Solid Surface Countertops
- Recessed Glass Stove Top
- Colored Fiberglass Cap
- Aluminum Rims

- Black Tank Flush
- Enclosed Underbelly
- 6 Gal. Gas/Electric Water Heater
- 32" TV
- Outside Shower
- Outdoor Speakers
- 30 lb. Gas Bottles and Cover

#### ■ Advantage Package

- Enclosed Underbelly
- Outside Speakers
- 6 Gal. Gas/Electric Water Heater
- Outside Shower
- Night Shades
- Spare Tire
- Microwave

#### ■ Electric Power Package

- 4 Electric Stabilizer Jacks (TT)
- 2 Electric Stabilizer Jacks (FW)
- 3,500 Lb. Electric Tongue Jack (TT)
- 2 Power Front Jacks (FW)
- Espresso Cabinets
- Solid Surface Countertops
- 6 Gal. Gas/Electric DSI Hot Water Heater
- Water Heater By-Pass (Forced Option)
- 17" Oven
- Microwave
- Create-a-Breeze™ Fan (Exchange)
- Extra Roof Vent
- 15,000 BTU Ducted A/C

- Outside Grill
- Night Shades
- 2 Stabilizer Jacks (FW)
- 4 Stabilizer Jacks (TT)
- Outside Shower
- Power Front Jacks (Fifth Wheels Only)
- 30 Lb. Gas Bottles and Cover
- 32" LCD TV
- 39" LED TV
- Spare Tire and Carrier
- PUMA Den\*
- 5.1 Dolby Surround Sound System with AM/FM/ DVD/Bluetooth Player and Plug-In for iPod
- Bath Skylights
- Free Standing Dinette\*
- Tri-fold Sofa\*
- Theater Seating\*
- Roof Ladder
- Heated Tanks
- Stacked Bunk Option
- Upgraded iRelax Mattress
- Enclosed Underbelly

### Residential Package

- Residential Style 16.2 Cu. Ft. Refrigerator
  - Patio Door
  - Free-Standing Range
- \*Available on select models.

## Decor Options





## Destination Trailers

### Additional Standards

- 6 Gal. Gas/Electric DSI Hot Water Heater
- TV Antenna with Booster and Cable Hook-Up
- Designer Window Treatments
- Overhead Cabinets in Super Slide Room
- Push-back Recliner(s)
- Bedroom TV Hook-Up
- Bedroom Roof Vent
- Upgraded iRelax® Mattress
- King Bedspread
- Tub Surround
- Glass Shower Door\*
- Home Theater DVD Surround Sound AM/FM/CD Player
- Free Standing Range
- Tinted Safety Glass
- Upgraded Colored Metal
- Sink Cover
- New Larger Countertops
- 35,000 BTU Furnace

### Options

- Espresso Cabinets
- Solid Surface Countertops
- 12 Gal. Gas/Electric DSI Water Heater
- Water Heater By-Pass
- Oven
- Microwave
- 32" LCD TV
- 5.1 Dolby Surround Sound System with AM/FM/DVD/Bluetooth Player and Plug-In for iPod
- 50 Amp Service
- Washer/Dryer Prep with 50 Amp Service
- Stackable Washer/Dryer Includes Prep

- Convection Microwave/Cook Top
- Create-A-Breeze™ Fan (Exchange)
- Fantastic Vent Fan
- 12 V Ceiling Fan in Living Room
- 12 V Ceiling Fan in Bedroom
- 15,000 BTU Ducted Air Conditioning
- Outside Grill
- Outside Shower
- 30" Entry Door IPO of Sliding Patio Door
- Bath Skylight
- Night Shades
- Freestanding Dinette
- Bar Stools (2 per Floorplan)\*
- 2 Exterior Speakers
- Tri-fold Sofa
- Theater Seating\*
- Electric Awning with LED Strip Light
- 2 Stabilizer Jacks
- 4 Stabilizer Jacks
- Roof Ladder
- 30 Lb. Gas Bottles and Cover
- Heated Tanks
- Spare Tire and Carrier
- Folding Grab Handle
- Carbon Monoxide Detector
- Fireplace with Faux Stone\*
- Z240

### ■ Residential Package

- 16.2 Cu. Ft. Residential Refrigerator with Ice Maker
- Free-Standing Range
- \*Available on select models.

## Toy Haulers

### Additional Standards

- Heavy Duty I-Beam Frames with EZ Lube Axles
- 1/4" x 8" Tie Down Reinforcement Plates for Secure Cargo Tie Downs
- Beaver Tail Rear Floor for Easy Loading
- Diamond Plate
- Flood Lights
- Upgraded Colored Metal
- Colored Front Fiberglass Cap with Diamond Plate (Fifth Wheels)
- 2" x 2" Wood Framed Sidewalls on 16" Centers
- 2" x 3" Floor Joist on 10" Centers
- R-7 Insulation Floor, Walls, and Ceiling for Comfort
- One Piece 5/8" Floor Decking with a 25 Year Limited Warranty
- 3/8" Walkable Roof Decking Over 4-1/2" Crowned Roof Rafters
- One Piece Rubber Roof with 12 Year Warranty
- Insulated Duct For Air Conditioning in Ceiling
- Floor Ducted Heat
- 55 Amp Converter Standard
- 7'5" Rear Ramp Door, (8' on 356 QLB, 373 QSI)
- Front Baggage Compartment
- Front Exterior Baggage Compartment
- 32" LED TV with Movable Bracket for Easy Mounting Inside or Outside (Most Models)
- Overhead Cabinets in Super Slide Room
- Prewired for Satellite
- TV Antenna with Booster and Cable Hook-Up
- Double Door Refrigerator

- 13,500 BTU Ducted Air Conditioning
- Sofas Fold-Down into Queen Bed
- Tinted Safety Glass
- Bedspread
- Tub Surround
- Glass Shower Door\*

### Options

#### ■ Advantage Package

- Enclosed Underbelly
- Outside Speakers
- 6 Gal. Gas/Electric Water Heater
- Outside Shower
- Night Shades
- Spare Tire
- Microwave

#### ■ Electric Power Package

- 4 Electric Stabilizer Jacks (TT)
- 2 Electric Stabilizer Jacks (FW)
- 3,500 Lb. Electric Tongue Jack (TT)
- 2 Power Front Jacks (FW)

- Espresso Cabinets
- Solid Surface Countertops
- 6 Gal. Gas/Elec. DSI Hot Water Heater
- Water Heater By-Pass
- Oven
- Microwave
- Convection Microwave/Cook Top
- Create-A-Breeze™ Fan (Exchange)
- Fantastic Vent Fan on Travel Trailers)
- 32" LCD TV (IPO) Where Available
- 2 Exterior Speakers
- 5.1 Dolby Surround Sound System with AM/FM/DVD/Bluetooth Player and Plug-in for iPod

- Extra Roof Vent
- 15,000 BTU Ducted Air Conditioning
- Single Electric Track Queen Bed
- Double Electric Track Queen Bed
- Happi Jack Electric Sofa
- Bath Skylight
- Night Shades
- Electric Awning with LED Strip Light
- 2 Stabilizer Jacks
- 4 Stabilizer Jacks (Travel Trailers Only)
- Power Front Jacks (Fifth Wheels Only)
- Roof Ladder
- Outside Shower
- Outside Grill
- NEW 5.5 KW Gas Onan Generator
- 4.0 KW Gas Onan Generator
- 30 Gal. Fuel Pump Station
- 30 Lb. Gas Bottles and Cover
- Zip Screen
- Hide-a-Screen
- Hitch Cover (Fifth Wheels Only)
- Mission Aluminum Modified Rim
- Heated Tanks
- Wash Down Kit
- Spare Tire and Carrier
- Folding Grab Handle
- Carbon Monoxide Detector
- Upgraded iRelax Mattress (Select models)
- Enclosed Underbelly
- Power Package
- \*Available on select models.

Prairie

Sand



# PUMA

by PALOMINO

Travel Trailers • Fifth Wheels • Toy Haulers • Destination Trailers



SINCE 1968

**PALOMINO**

*Recreational Vehicles*

*Puma has a wide variety of models and floorplans to fit your lifestyle. Always an adventure...enjoy leisure living at its best!*

Puma by Palomino, a Division of Forest River, Inc.  
2551 Century Drive ■ Goshen, IN 46528  
[www.palominorv.com](http://www.palominorv.com)



## PRE-DELIVERY INSPECTION FACILITY

20,000 square feet of quality assurance. The bare essentials for a premium product. This state-of-the-art facility gives immediate daily feedback to production for quality assurance in every unit built.



Forest River, Inc. encourages our customers to purchase their Forest River products from a local dealership whenever possible for the following reasons:

- 1) Forest River, Inc. dealers are independently owned and operated businesses so priority service and scheduling is at their discretion and is often provided to customers that purchased their unit at that dealership.
- 2) Purchasing locally allows customers to establish meaningful relationships with a dealer, enhancing the RV experience through assistance with product questions, user tips or RV regulations for your state or country, and much more!
- 3) Canadian customers must meet requirements to bring an RV purchased out of the country to their home. These requirements may involve additional inspections and certifications, taxes and fees. Your local Canadian Dealer is a professional at meeting these requirements.
- 4) Scheduling timely warranty repairs and adjustments through a local dealership provides far greater flexibility and convenience to you, the customer!

It is the goal of Forest River, Inc. that all of our RV owners fully enjoy the RV experience and that customer satisfaction meets or exceeds their expectations!

## 24/7 EMERGENCY ROADSIDE ASSISTANCE

For a worry-free ownership experience Forest River includes one year of Coach-Net RV Technical & Roadside Assistance

**Coach-Net®**

RV Technical & Roadside Assistance Assistance with each RV purchase. Whether new to the RV lifestyle or an experienced RV enthusiast, Forest River owners have 24/7 access to technical, operational and emergency road service coverage throughout the US & Canada. Coach-Net's fast, dependable service is just a phone call away.



**Learn More**  
Scan this barcode using a QR Reader on your smart phone to learn more about Forest River.



A Berkshire Hathaway company.

**FREE MEMBERSHIP**  
to Forest River Owners' Group

[www.forestriverfrog.com](http://www.forestriverfrog.com)



**GVWR (Gross Vehicle Weight Rating)** - is the maximum permissible weight of the unit when fully loaded. It includes all weights, inclusive of all fluids, cargo, optional equipment and accessories. For safety and product performance do NOT exceed the GVWR.

**GAWR (Gross Axle Weight Rating)** - is the maximum permissible weight, including cargo, fluids, optional equipment and accessories that can be safely supported by a combination of all axles.

**UVW (Unloaded Vehicle Weight)\*** - is the typical weight of the unit as manufactured at the factory. It includes all weight at the unit's axle(s) and tongue or pin and LP Gas. The UVW does not include cargo, fresh potable water, additional optional equipment or dealer installed accessories.

**CCC (Cargo Carrying Capacity)\*\*** - is the amount of weight available for fresh potable water, cargo, additional optional equipment and accessories. CCC is equal to GVWR minus UVW. Available CCC should accommodate fresh potable water (8.3 lbs. per gallon). Before filling the fresh water tank, empty the black and gray tanks to provide for more cargo capacity.

\*Estimated average based on standard build optional equipment. \*\*Estimated average based on standard build optional equipment.

Each Forest River RV is weighed at the manufacturing facility prior to shipping. A label identifying the unloaded vehicle weight of the actual unit and the cargo carrying capacity is applied to every Forest River RV prior to leaving our facilities.

The load capacity of your unit is designated by weight, not by volume, so you cannot necessarily use all available space when loading your unit.

All information contained in this brochure is believed to be accurate at the time of publication. However, during the model year, it may be necessary to make revisions and Forest River, Inc., reserves the right to make all such changes without notice, including prices, colors, materials, equipment and specifications as well as the addition of new models and the discontinuance of models shown in this brochure. Therefore, please consult with your Forest River dealer and confirm the existence of any materials, design or specifications that are material to your purchase decision.

©2015 Puma by Palomino a Division of Forest River, Inc., a Berkshire Hathaway company. All Rights Reserved. 7/16

**Your Puma Dealer**