

04

Arctic Fox



by Northwood



Welcome

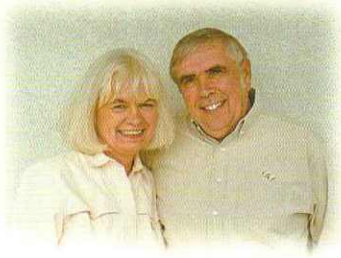

*Ron & Sherry Nash
welcome you to the camping comforts
of the Arctic Fox travel trailers
and 5th-wheels.*

Our goal at Northwood is to provide "no nonsense construction" in a unit built strong to withstand off-road use without neglecting the comforts of home.

Those of us living in the rugged Northwest know the importance of constructing travel trailers and 5th-wheels insulated well enough to withstand adverse weather conditions and durable enough for extended cross-country and off-road travel.

Your choice of 5th wheel floor plans.



Roomy dining and living area w/flush-floor and slide-out overheads.

All Foxes have R-18 blanket insulation in the ceiling, R-7 in the walls and floor—40 to 60% more protection from extreme temperatures than you will find in other units on the market today. We make you as cozy as a little Fox!

From the basics to the frills built into the Arctic Fox, you will see the pride of workmanship reflected in the finished unit.



Diamond Plate Bulkhead protects and beautifies.

You will appreciate the integrity of the structural steel chassis which has been designed to carry the weight of your unit and provide adequate carrying capacity for your personal belongings. 5/8" exterior plywood floors not strand board provide additional strength and resilience to the coach.





Spacious galley areas feature oak raised-panel doors and drawers with abundant storage.

See for yourself why Northwood has one of the highest highway safety ratings in the industry. Structural steel chassis frames (C-channel smaller units—"I" beam for super slide models) are engineered for superior strength and structural integrity specific for each model. The straight axles provide extra ground clearance for off-road use. The tandem axles are strategically located to offer the perfect balance for your tow vehicle. Tires with appropriate load range are selected for each model for maximum carrying capacity and safety. Retractable non skid double steps (triple steps on slide models) provide safe and easy access.

The durable laminated hardwall surfaces are easy to maintain. The tough diamond plate rockguard (small travel

trailers) and diamond plate bumper wrap leave a lasting impression of no-nonsense construction. More important, the exterior fiberglass is resistant to flying road debris, chips and dents. Fiberglass front and rear caps come standard on larger Foxes.



Charming bedroom areas offer extensive wardrobe and storage space.

The full walk-on roof has been specifically designed to withstand heavy snow loads and shed water quickly. The Northwood 4 1/2" or 5 1/2" crowned roof truss system is topped with 3/8" plywood (not strand board) and sealed with one-piece laminated rubber. The roof is finished with oversized rain gutters with down spouts to divert water away from the side of the coach.

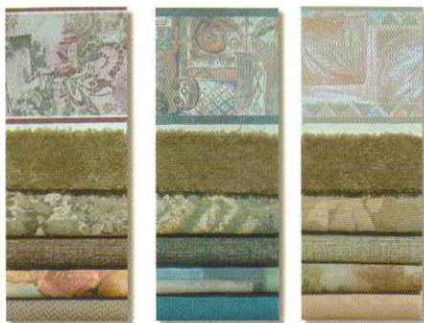

Raisin Denim Heather
Choice of 3 rich color schemes.



From the basics to the frills built into the Arctic Fox you will see the pride of workmanship reflected in the finished unit.

With so much emphasis placed on the structure of the Fox, we at Northwood want to assure you that we did not forget the amenities. Every Fox is equipped with ducted roof air conditioning, awning, microwave, TV antenna, dual axle shock absorbers, enclosed-heated holding tanks, black holding tank flush system, DSI gas/electric water heater, tinted windows, spare tire group and many more features to enhance the beauty and convenience of your traveling home and insure your comfort away from home. Generators are available on some Foxes starting with the 22H. Check out the complete list of features and compare the value.



Expand your horizon with FOX super slide!

Travel Trailer Floorplans

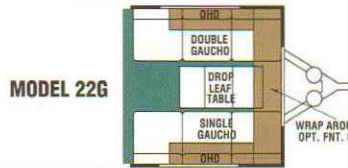
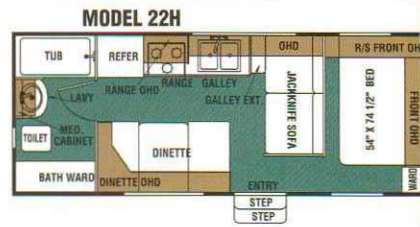
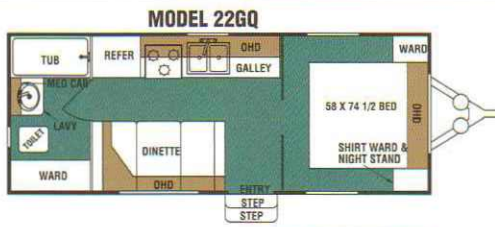
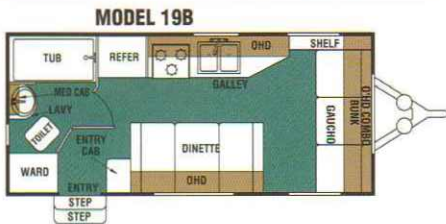

Slide Out Models

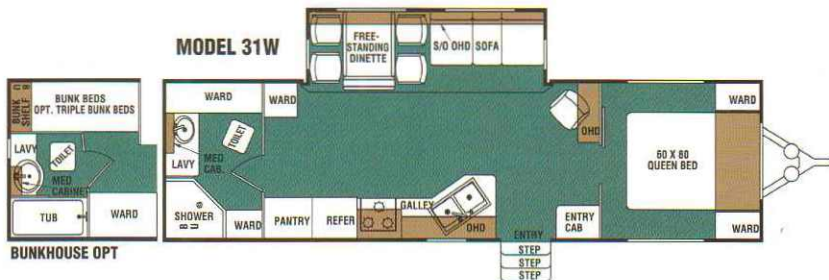
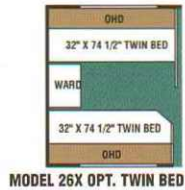
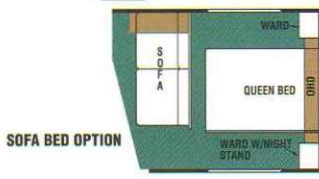
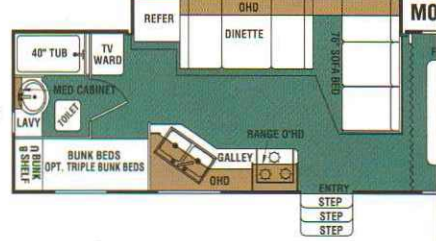
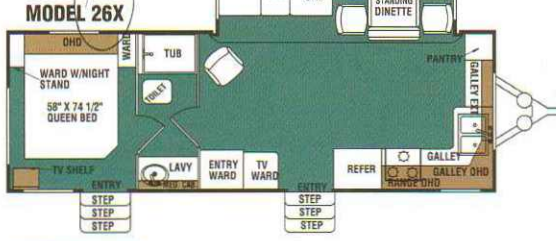
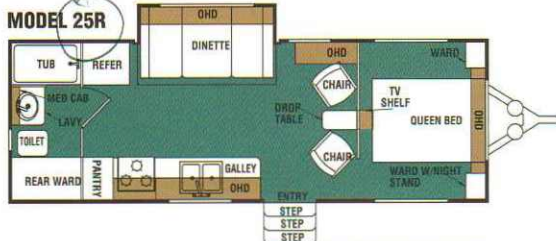

5th Wheel Floorplans

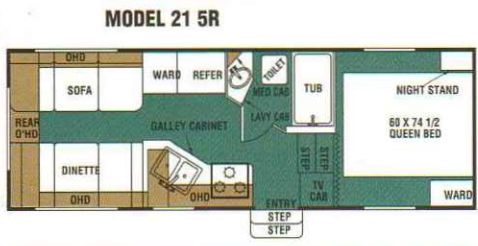

Slide Out Models

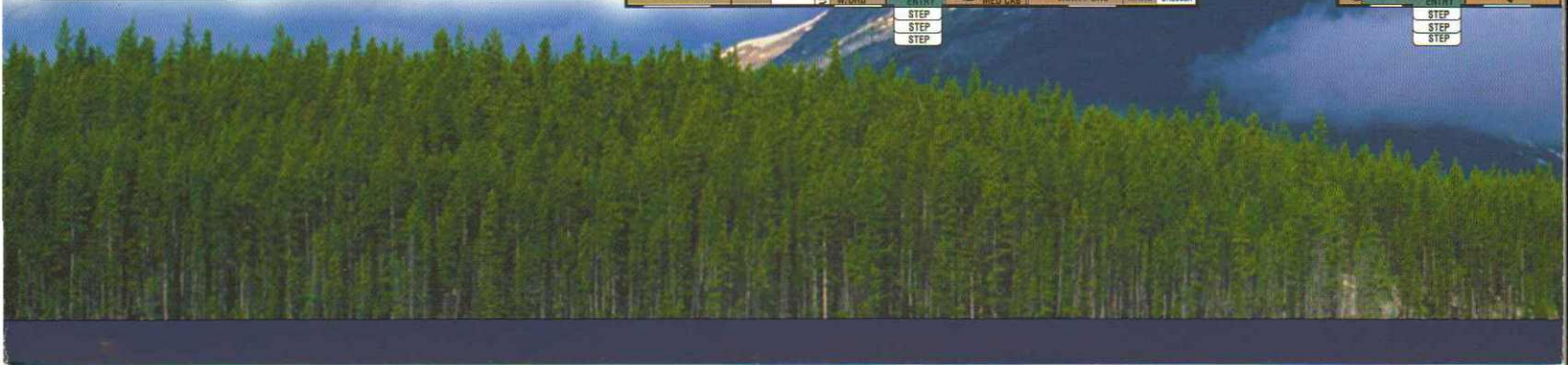
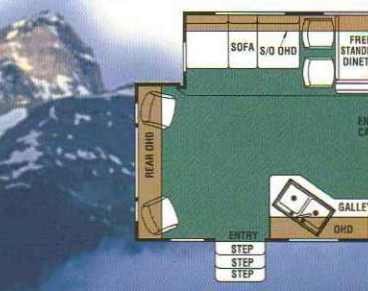
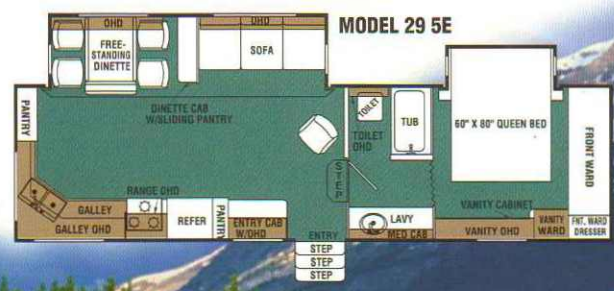
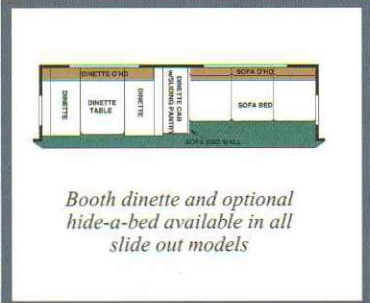
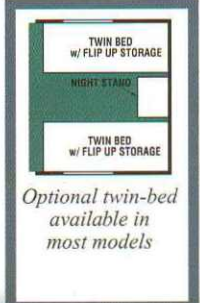
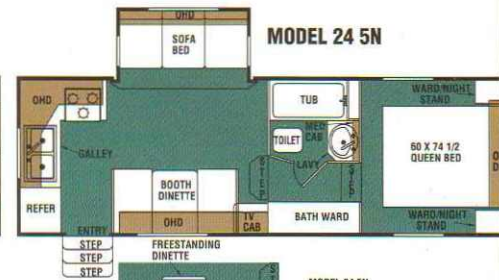

MODEL 25S

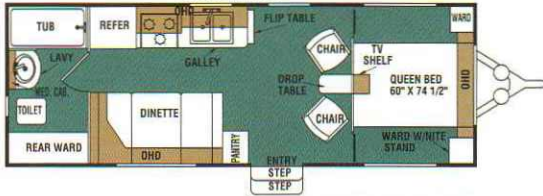

MODEL 26J

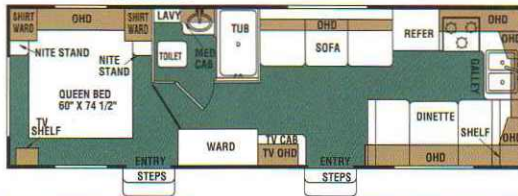

MODEL 27Y

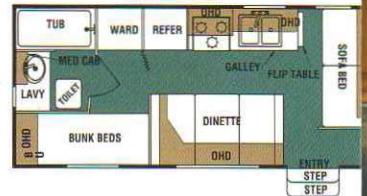

SOFA BED OPTION

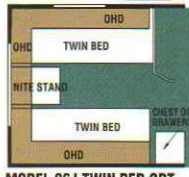

MODEL 26J TWIN BED OPT

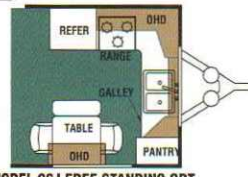

MODEL 26J FREE STANDING OPT

MODEL 26Z

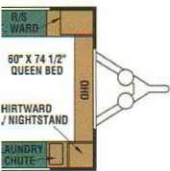

MODEL 27F

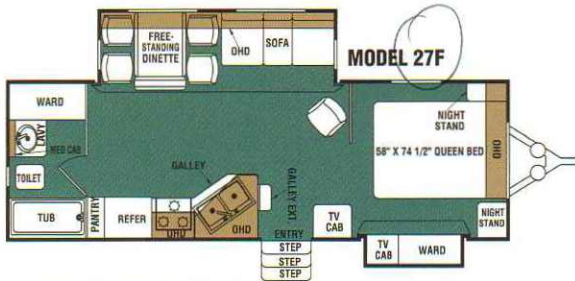

MODEL 29V

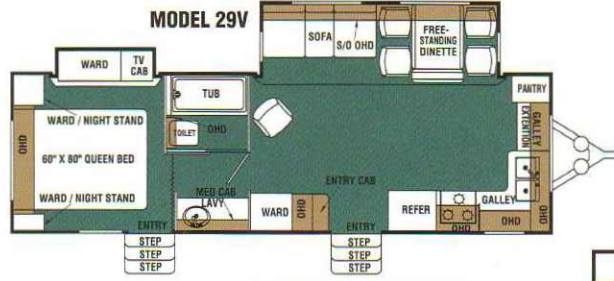

MODEL 32D

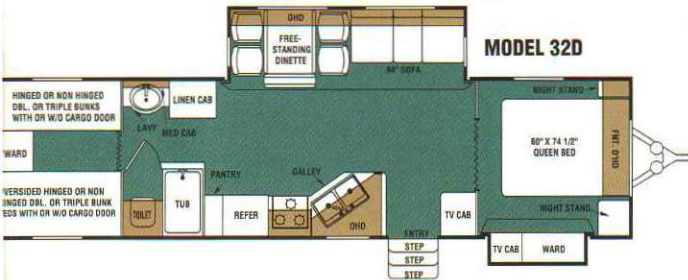

MODEL 33A

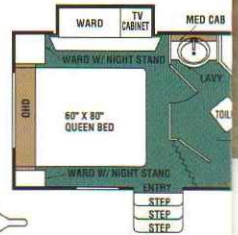
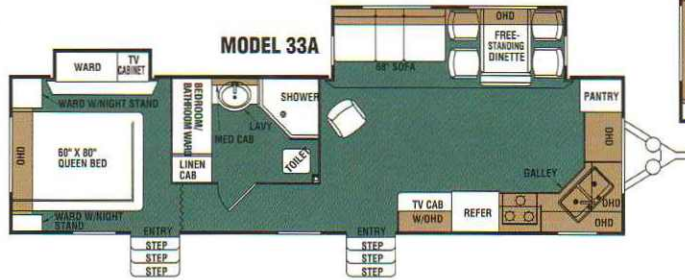

MODEL 26 5C

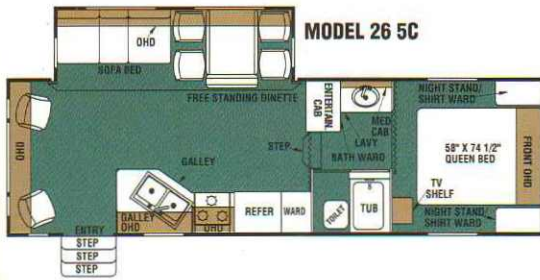

MODEL 27 5L

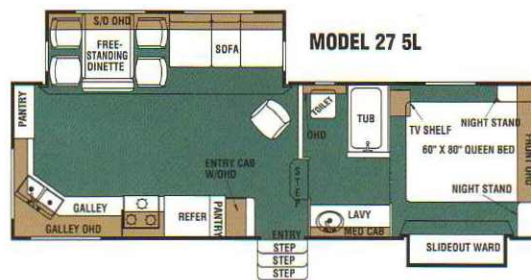

MODEL 27 5R

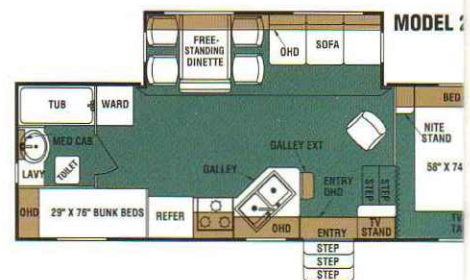

MODEL 29 5T



MODEL 33 5V

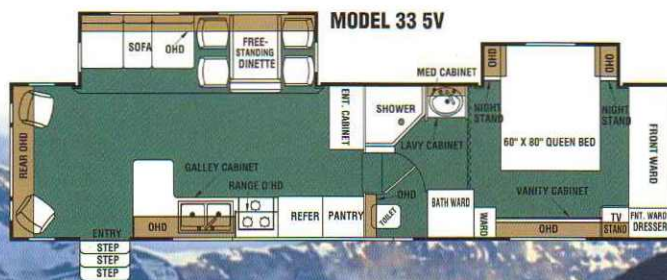

MODEL 34 5B

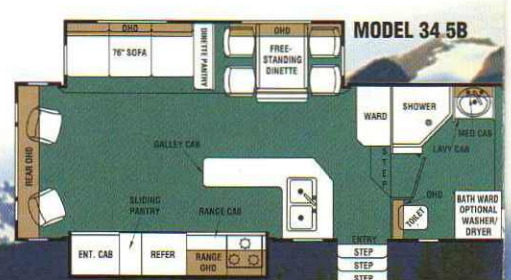

MODEL 26J



MODEL 27Y

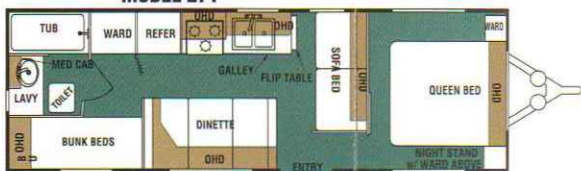

IN BED OPT

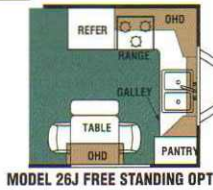

MODEL 26J FREE STANDING OPT

MODEL 30U

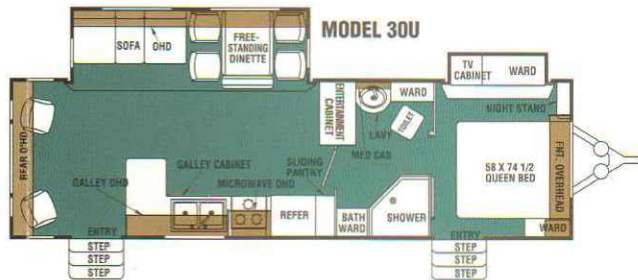

MODEL 29V

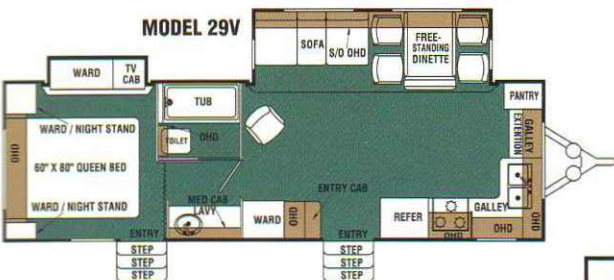

MODEL 38L

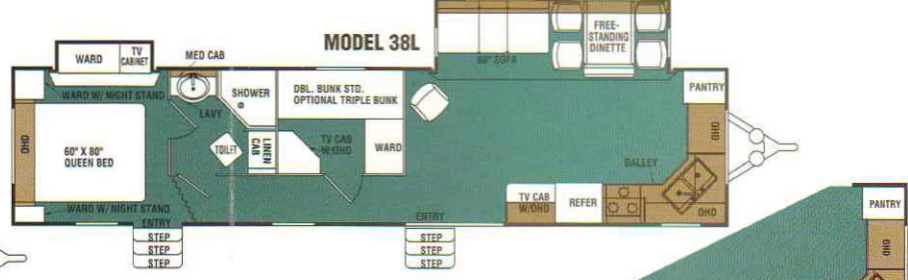

MODEL 33A

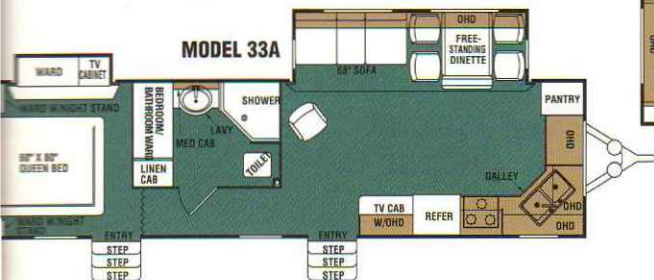

OPTION 30\"X72\" ENTRY DOOR



MODEL 27 5L

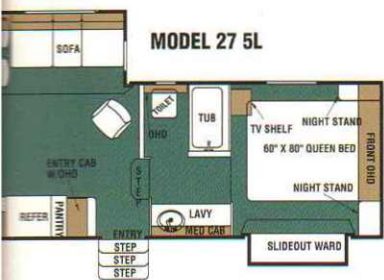

MODEL 28 5D

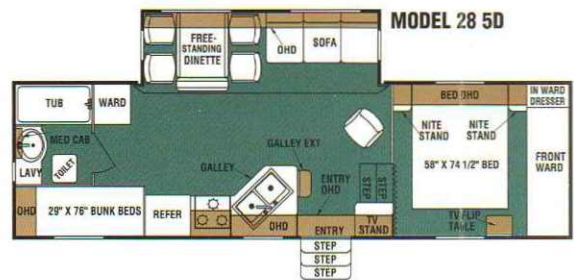

28 5D OPT. REAR BATH

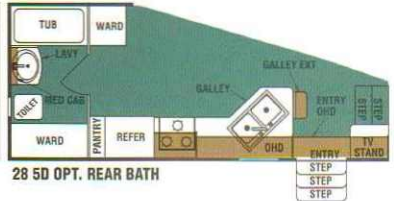

MODEL 33 5V



MODEL 34 5B

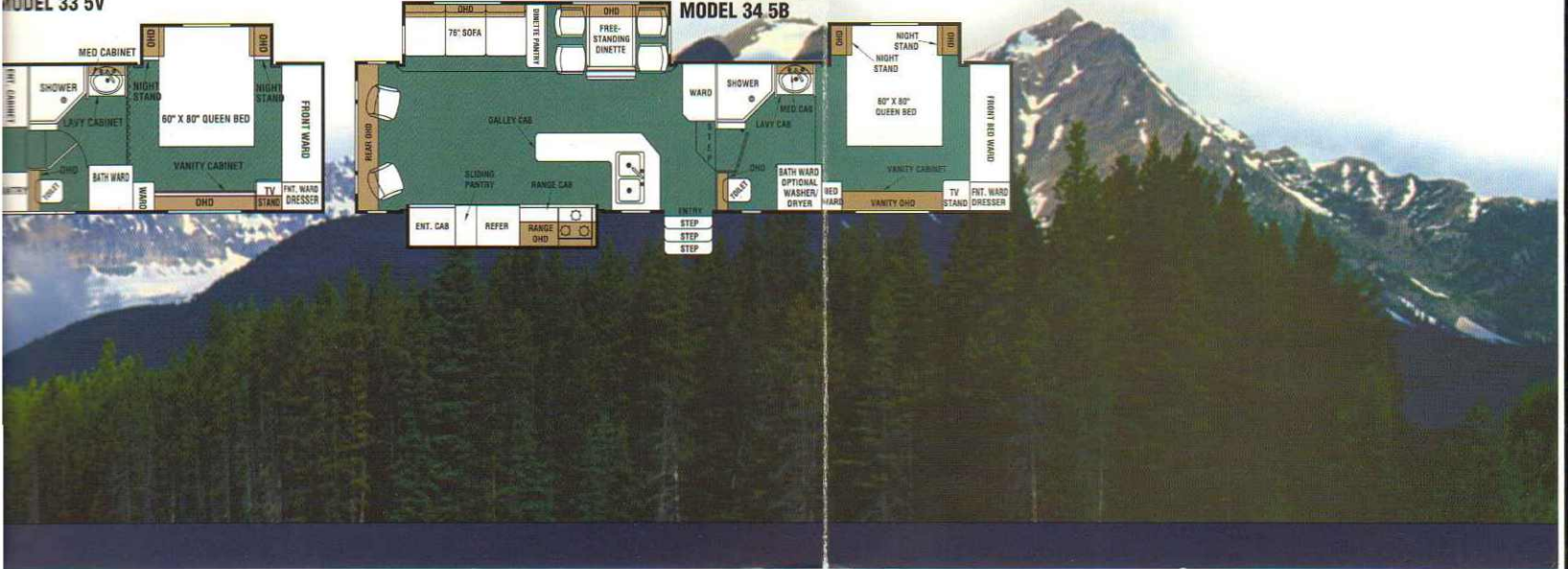
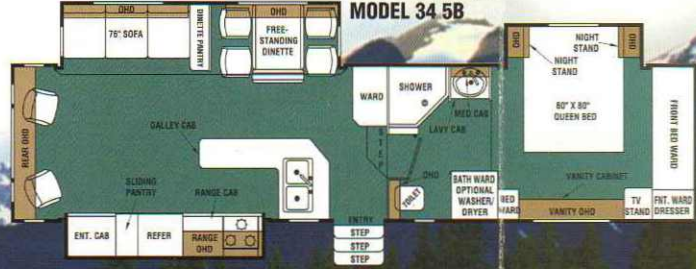



1" insulated and locking exterior storage compartments are finished with smooth fiber glass and sealed with an all-weather rubber gasket. Access is simplified with the handy finger pull and metal exterior door catch.



Chair pockets in free-standing dinette models secure dinette chairs for travel.



FOX uses only top quality KENWOOD stereos/CDs with a powerful speaker system.

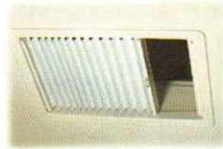

Kitchen skylight with skylight shade is standard on all Foxes.



Standard Black Water Flush System keeps your tank clean and fresh.



30" cargo doors available in bunkhouse models allows easy exterior access for storage.



Holding tank covers (heated) integrated into the beefy Rustoleum® coated chassis, heated with the furnace, not electrical hot pads.



FOX's exclusive R-18 ceiling insulation compared to the standard R-7 helps keep you warm in the winter and cool in the summer.



Dual axle shock absorbers as standard equipment.



LPG Quick Connect for accessories.

Travel Trailer & Fifth Wheel Features and Specifications

CONSTRUCTION AND EXTERIOR FEATURES

- * HARDWALL
- * STRUCTURAL STEEL CHASSIS
- * DOUBLE PRIMED WELDS AND RUSTOLEUM® COATED CHASSIS TO REDUCE RUSTING
- * ONE-PIECE RUBBER ROOF
- * FOX INSULATION (R-18 IN CEILING)
- ** 2" X 3" FLOOR
- * NORTHWOOD ROOF TRUSS SYSTEM
- * TINTED WINDOWS
- * RADIUS CORNERED WINDOWS W/INTERIOR FASTENERS

HIGH PAYLOAD AXLES, TIRES AND WHEELS

- * STRAIGHT AXLES
- * DOUBLE STEPS - TRIPLE STEPS ON SLIDES
- * TANDEM AXLES
- * ELECTRIC BRAKES ON ALL FOUR WHEELS
- * DUAL AXLE SHOCKS
- * RADIAL TIRES W/CHROME WHEELS
- * CHROME LUG NUTS & HUB COVERS
- * SPARE TIRE GROUP
- * AUTOMOTIVE RECESSED TAIL LIGHTS W/ BACKUP LIGHT

ADDITIONAL EXTERIOR BENEFITS

- * AWNING
- * EXTERIOR SHOWER
- * STABILIZING JACKS
- * DIAMOND PLATE ROCKGUARD (BRA) SMALL TRAVEL TRAILERS ONLY
- * DIAMOND PLATE BUMPER WRAP
- * ROOF, RACK & LADDER
- * SEMI-AUTOMATIC WINTERIZATION SYSTEM
- * 4 1/2" SEWER HOSE CARRIER
- * EXTRA LARGE CAPACITY WATER & HOLDING TANKS
- * HEATED HOLDING TANKS
- ** DUAL 30 OR 40 LB LPG BOTTLES W/AUTOMATIC CHANGE OVER AND COVER
- ** DUAL BATTERY RACK
- * FREEZE RESISTANT 1/2" WATER LINES
- * SKYLIGHT ROOF VENTS & POWER BATH VENT
- * 1" INSULATED LOCKING EXTERIOR STORAGE COMPARTMENTS
- * RETRACTABLE ENTRY STEPS
- * MOLDED FRONT ROCKGUARD AWNING TRAVEL TRAILERS ONLY
- ** RADIUS 30" X 72" ENTRY DOOR W/WINDOW
- * FLUSH MOUNT ENTRY DOOR LOCK W/DEAD BOLT
- * SCREEN DOOR W/KICK PANEL
- * MUD FLAPS
- * VENTILATING EMERGENCY EXIT WINDOWS
- * BLACK HOLDING TANK FLUSH SYSTEM

CONVENIENCE FEATURES

- * KENWOOD AM/FM CD PLAYER W/QUALITY SPEAKER SYSTEM
- * AIR CONDITIONER W/DUCTING
- * MICROWAVE OVEN
- * TV ANTENNA
- * WIRED FOR CABLE TV W/PARK RECEPTACLE
- * DSI GAS/ELEC WATER HEATER
- W/INSULATED PORCELAIN TANK
- * 12-VOLT PATIO, HITCH & WASTE DUMP LIGHTS
- * RV SYSTEMS MONITOR PANEL
- * PHONE JACK & SATELLITE READY
- ** OPTIONAL GENERATOR OR GENERATOR READY

ESSENTIAL SAFETY FEATURES

- * SMOKE DETECTOR
- * LPG LEAK DETECTOR
- * FIRE EXTINGUISHER
- * LARGE EXTERIOR ENTRY DOOR ASSIST HANDLE
- * INTERIOR ENTRY DOOR ASSIST HANDLE
- * GFI CIRCUIT PROTECTION
- * DOORSIDE GFI PATIO RECEPTACLE
- ** CO DETECTOR

SPACIOUS WORK SPACE IN GALLEY

- * DOUBLE DOOR CLIMATE CONTROL REFER W/ADJUSTABLE HUMIDITY CONTROL & LIGHT W/RAISED OAK PANEL INSERTS
- * EXTRA LARGE RANGE W/22" OVEN
- * RANGE COVER
- * HI-RISE GALLEY FAUCET
- * KITCHEN SKYLIGHT W/SHADE
- * RANGE HOOD W/LIGHT & EXHAUST FAN
- ** EXTRA LARGE/DEEP 60/40 GALLEY SINK
- * OAK CUTTING BOARD SINK COVER
- * RESIDENTIAL STYLE SELF-EDGED COUNTER TOPS
- ** GALLEY PANTRY
- * DRAWERS SLIDE ON ROLLER GUIDES
- * DESIGNER APPLIANCES
- * 12" ACRYLIC BACKSPLASH SURROUNDS RANGE

PRACTICAL BATHROOM DESIGN

- * FOOT PEDAL TOILET
- ** LARGE LAVY BOWL
- * HAND-CRAFTED MEDICINE CABINET W/LEADED-STYLE MIRROR
- * SHOWER OR TUB ENCLOSURE
- * SHOWER SCREEN
- * BATH SKYLIGHT
- ** WINDOW IN BATHROOM

SLIDEOUT UNITS

- ** SLIDEOUT SIDE WINDOWS OPEN FOR ADDITIONAL VENTILATION
- * FLUSH FLOOR JUMBO SLIDE
- ** ATTRACTIVE OVERHEAD CABINETS IN MOST SLIDES

ADDITIONAL INTERIOR BENEFITS

- ** IN-FLOOR DUCTED HEAT W/RESIDENTIAL METAL FLOOR REGISTERS
- ** 35M BTU AUTO IGNITION FURNACE
- * AC/DC POWER CONVERTER W/BATTERY CHARGER
- * 12-VOLT INTERIOR LIGHTING SYSTEM
- * FLUORESCENT LIGHTING
- * OVERHEAD CABINETS W/BEVELED MIRRORS
- * CLOTH ACCORDION PLEATED SHADES
- * COORDINATED VALANCE TREATMENT WITH ATTRACTIVE LAMBREQUINS
- ** CUSTOM RESIDENTIAL STYLE SOFA
- ** CONVERTIBLE SOFA MAKES INTO FULL-SIZE BED
- ** OPTIONAL HIDE-A-BED
- * 20 MIL VINYL FLOORING (COMMERCIAL GRADE)
- ** AMPLE STORAGE UNDER BED
- ** STRUT SUPPORTS UNDER BED BASE
- ** UPGRADE DELUXE 7" INNER-SPRING MATTRESS
- ** BEDSPREAD
- * RAISED PANEL OAK DOORS THROUGHOUT
- * RADIUS FINISHED EDGES ON OVERHEAD CABINETS
- * BEVELED MIRRORS IN FEATURE OVERHEAD OPTIONAL BARBQUE
- * CHOICE OF INTERIOR DECOR COLORS
- * FULL TWO YEAR WARRANTY

STANDARD ON EVERY MODEL

- ** NOT ALL FEATURES ARE AVAILABLE ON ALL MODELS

★★★★

The 2004 ARCTIC FOX has a 4 Star average rating in the RV Rating Book published by the RV Consumer Group—a non-profit RV consumer organization that rates all RV's based on VALUE, RELIABILITY & HIGHWAY SAFETY.

Your Arctic Fox Dealer is



2004 Specifications	ARCTIC FOX TRAVEL TRAILERS (*) Designates Slide																		ARCTIC FOX 5th-Wheel Models (*) Designates Slide									
	19B	22G	22H	25S	25J	27Y	25R	26Z	26X	27F	29V	30U	31W	32D	33A	38L	21-5R	23-5A	24-5N	26-5C	27-5L	28-5D	29-5E	29-5T	EST 33-5V	34-5B		
Dry Axle Weight (approx. Lbs.)	3965	4450	4340	4780	5120	5000	5720	6460	6380	6615	7209	7080	7260	7340	7740	8280	4390	5520	5940	6640	7300	7190	7890	7700	8250	8955		
Dry Hitch Weight (approx. Lbs.)	395	580	540	600	620	560	640	880	1100	1025	1000	1140	980	1020	1140	1200	950	1100	1180	1500	1560	1600	1600	1620	1800	2360		
Net Carrying Capacity	2620	2470	2620	2495	2135	2315	3680	2660	3320	3465	3491	3480	3480	3340	2820	2220	2920	3380	4880	4860	4140	4210	3540	3680	4950	3685		
Gross Dry Weight-lbs	4380	5030	4860	5380	5740	5580	6380	7340	7480	7635	8209	8220	8240	8360	8880	9480	5340	6620	7120	8140	8860	8790	9460	9320	10050	11315		
Gross Vehicle Weight Rating (GVW)-Lbs	7000	7500	7500	7875	7875	7875	10000	10000	10800	10800	11700	11700	11700	11700	11700	11700	8250	10000	12000	13000	13000	13000	13000	13000	15000	15000		
Exterior Length (approx. w/hitch)	20'9"	23'6"	23'6"	26'6"	27'10"	28'6"	27'1"	29'5"	27'8"	28"	29'9"	31'11"	32'7"	34'9"	33'11"	39'1"	22'10"	23'10"	25"	28'6"	27"	29'3"	30"	30"	34'1"	35'1"		
Exterior Height (approx. w/o A/C)	9'5"	9'5"	9'5"	9'5"	9'6"	9'6"	9'6"	9'6"	9'10"	9'10"	9'10"	9'10"	9'10"	9'10"	9'10"	9'10"	9'10"	10'6"	10'6"	10'11"	10'11"	11'1"	11'1"	11'1"	11'2"	11'2"		
Exterior Width (approx. w/o awning)	8'	8'	8'	8'	8'	8'	8'	8'	8'	8'	8'	8'	8'	8'	8'	8'	8'	8'	8'	8'	8'	8'	8'	8'	8'	8'		
Tire Size	ST205 75R15	ST205 75R15	ST205 75R15	ST205 75R15	ST205 75R15	ST205 75R15	ST225 75R15	ST225 75R15	ST225 75R15	ST225 75R15	ST225 75R15	ST225 75R15	ST225 75R15	ST225 75R15	ST225 75R15	ST225 75R15	ST225 75R15	ST225 75R15	ST225 75R15	ST225 75R15	ST225 75R15	ST225 75R15	ST225 75R15	ST225 75R15	ST225 75R15	ST225 75R15		
Load Range	C	C	C	C	C	C	D	D	D	D	D	D	D	D	D	D	G	G	D	D	D	D	E	E	E	E		
Fresh Water Capacity (approx. gallons)	45	44	46	58	47	45	58	58	67	67	67	67	66	66	66	66	44	45	58	66	76	58	58	58	77	67		
Gray Water Tank (approx. gallons)	44	41	41	41	34	44	41	40	30/25	40	35/25	54	40	40	36/24	24/42	30	30	35/35	50	55/35	40	35/35	50	58	34		
Black Water Tank (approx. gallons)	35	35	35	35	35	35	35	35	44	34	44	42	34	42	46	46	40	40	35	42	35	40	35	35	42	42		
LPG Capacity (approx. gallons)	14	14	14	14	14	14	14	14	14	14	14	14	14	14	14	14	10	10	14	14	20	20	20	20	20	20		
Certified in Canada	yes	yes	yes	yes	yes	yes	yes	yes	yes	yes	yes	yes	yes	yes	yes	yes	yes	yes	yes	yes	yes	yes	yes	yes	yes	yes		

SO YOU ARE NOT OUT FOXED, THESE WEIGHTS INCLUDE A/C, AWNING, MICRO, TV ANT, STAB JACKS AND SPARE TIRE GROUP.

Photos and drawings are representative of ARCTIC FOX travel trailers and 5th-wheels and may differ slightly from actual production models. We at Northwood continually upgrade and improve our FOX products and reserve the right to change specifications without notice. Check with your authorized dealer for updated information. Northwood, 59948 Downs Road, P.O. Box 3359, La Grande, OR 97850 (541)962-6274. Northwood, 380 Battaille Dr., P.O. Box 2630, Winchester, VA 22604 (540) 542-6140 www.nashtraveltrailers.com Printing by Color Press. 1/04 67828