

NASH



**CERTIFIED
CHASSIS**



**PACIFIC WEST
ASSOCIATES, INC.**
STRUCTURAL RECONSTRUCTION, INTERIOR RENOVATION,
REWORKING, REMODELING AND MORE...
OFFERING PERFORMANCE AND VALUE.
BUILT BY NORTHWOOD



www.northwoodmfg.com

FORGED ON THE FRONTIER

NASH RUGGED FROM THE GROUND UP!

A good idea is always a good idea. Ron Nash broke into the RV business with his no-nonsense Northwest Rugged "Pretty One in Work Boots"...The Nash Travel Trailer, and that idea took off like wildfire. The Nash remains true to its roots as an affordable, well-made trailer that will last for years; a durable RV you can take off-road and be used in any season. The concept is sensible and simple. We build RVs how YOU like

them. It was a good idea 20 years ago and it's a good idea today!

The Nash is equipped to not only meet the needs of the introductory RV buyer, but also offers amazing features not found on other entry level RVs. The Nash has always been known for rugged off-road durability but never before has it come so fully equipped and so reasonably priced. This new Nash is loaded with standard features:

- ✓ Equaflex Suspension
 - ✓ Certified Off-Road Chassis
 - ✓ TG Plywood Floor Decking
 - ✓ Plywood Roof Decking
 - ✓ Multi Layered Fiberglass Wall
- ...and standard amenities such as:
- ✓ 12 Volt Power Awning
 - ✓ Rear Receiver Hitch
 - ✓ 10 Gal. Water Heater
 - ✓ Generator Ready

That's correct - you can have an optional generator on any Nash model. If you are concerned about being fully self-contained, the Nash is your best answer! So, whether your idea of camping is an elk camp in winter or the campsite nearest the swimming pool at your favorite campground, you will feel equally at home in your new Nash.



www.northwoodmfg.com



**...AND ALL
THESE
FEATURES ARE
STANDARD!**



Equaflex Suspension



**Northwood Built Structural Steel
Certified Off-Road Chassis**



10 Gal. Water Heater



**Tongue & Groove Plywood Floor
Decking & Plywood Roof Deck**



**Multi Layered Laminated
Fiberglass Wall**



Rear Receiver Hitch



Generator Ready



12 Volt Power Awning



Nash 17K

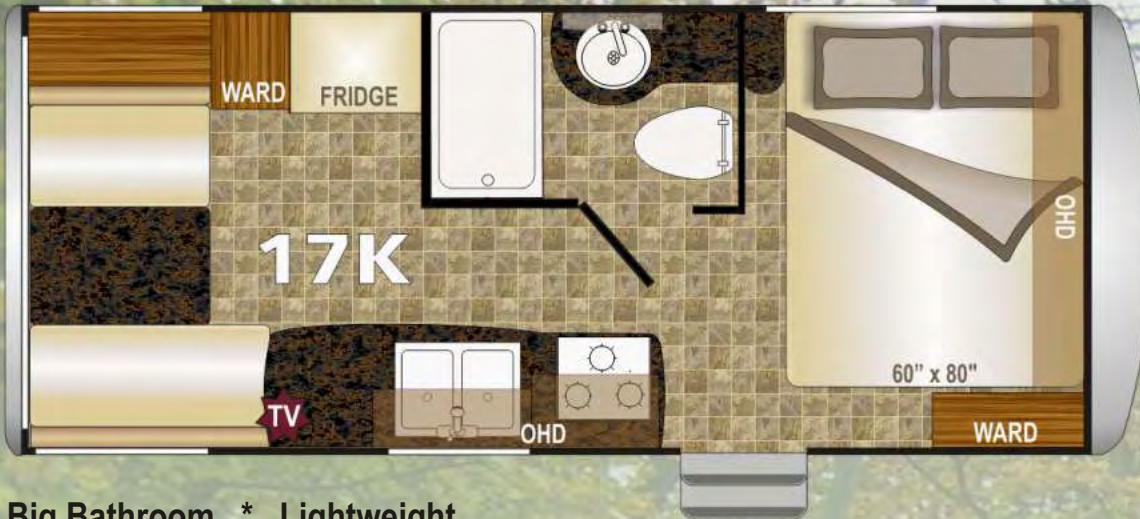

Big Bathroom * Lightweight
 Lots of Storage * Large Double Door Fridge

- 17K** Model Number
- 3537 Dry Axle Weight (approx. Lbs.)
- 500 Dry Hitch Weight (approx. Lbs.)
- 2963 Net Carrying Capacity (approx. Lbs.)
- 4037 Gross Dry Weight-lbs (approx. Lbs.)
- 7000 Gross Vehicle Weight Rating (GVWR)-Lbs.
- 22' 4" Exterior Length (approx. w/hitch)
- 10'7" Exterior Height (approx. incl. AC unit)
- 8'0" Exterior Width (approx. w/o awning)
- ST205/75R15 Tire Size
- C Load Range
- 50 Fresh Water w/ Water Heater (approx. gal.)
- 35 Gray Water Tank (approx. gal.)
- 36 Black Water Tank (approx. gal.)
- 14 LPG Capacity (approx. gal.)
- YES CSA - Canadian Dealers Only
- 25 Auto Ignition Furnace (1,000 BTUs)

We continually upgrade & improve our products and reserve the right to change any specifications without notice.





Big Living / Dining Area * Pantry Cabinet
 Big Bunkhouse / Sleeps 7 * Convenience Bathroom Sink

Nash 18L

18L Model Number

- 3752 Dry Axle Weight (approx. Lbs.)
- 520 Dry Hitch Weight (approx. Lbs.)
- 2728 Net Carrying Capacity (approx. Lbs.)
- 4272 Gross Dry Weight-lbs (approx. Lbs.)
- 7000 Gross Vehicle Weight Rating (GVWR)-Lbs.
- 23'3" Exterior Length (approx. w/hitch)
- 10'7" Exterior Height (approx. incl. AC unit)
- 8'0" Exterior Width (approx. w/o awning)
- ST205/75R15 Tire Size
- C Load Range
- 50 Fresh Water w/ Water Heater (approx. gal.)
- 42 Gray Water Tank (approx. gal.)
- 35 Black Water Tank (approx. gal.)
- 14 LPG Capacity (approx. gal.)
- YES CSA - Canadian Dealers Only
- 25 Auto Ignition Furnace (1,000 BTUs)

We continually upgrade & improve our products and reserve the right to change any specifications without notice.



Morning Dew



High Desert

Nash 23B



Sit-N-Sleep Sofa Option
 Bunkhouse * Lots of Storage * Huge U-Shaped Dinette

- 23B** Model Number
- 4312 Dry Axle Weight (approx. Lbs.)
- 430 Dry Hitch Weight (approx. Lbs.)
- 2258 Net Carrying Capacity (approx. Lbs.)
- 4742 Gross Dry Weight-lbs (approx. Lbs.)
- 7000 Gross Vehicle Weight Rating (GVWR)-Lbs.
- 27'7" Exterior Length (approx. w/hitch)
- 10'7" Exterior Height (approx. incl. AC unit)
- 8'0" Exterior Width (approx. w/o awning)
- ST205/ Tire Size
- 75R15
- C Load Range
- 50 Fresh Water w/ Water Heater (approx. gal.)
- 42 Gray Water Tank (approx. gal.)
- 35 Black Water Tank (approx. gal.)
- 14 LPG Capacity (approx. gal.)
- YES CSA - Canadian Dealers Only
- 25 Auto Ignition Furnace (1,000 BTUs)

We continually upgrade & improve our products and reserve the right to change any specifications without notice.



www.Northwoodmfg.com

Morning Dew



Morning Dew

Nash 23D



Sit-N-Sleep Sofa Option
 Lots of Storage * Large Kitchen & Bath * Huge U-Shaped Dinette

- 23D Model Number**
- 4482 Dry Axle Weight (approx. Lbs.)
 - 500 Dry Hitch Weight (approx. Lbs.)
 - 2018 Net Carrying Capacity (approx. Lbs.)
 - 4982 Gross Dry Weight-lbs (approx. Lbs.)
 - 7000 Gross Vehicle Weight Rating (GVWR)-Lbs.
 - 25'10" Exterior Length (approx. w/hitch)
 - 10'11" Exterior Height (approx. incl. AC unit)
 - 8'0" Exterior Width (approx. w/o awning)
 - ST205/75R15 Tire Size
 - C Load Range
 - 50 Fresh Water w/ Water Heater (approx. gal.)
 - 42 Gray Water Tank (approx. gal.)
 - 35 Black Water Tank (approx. gal.)
 - 14 LPG Capacity (approx. gal.)
 - YES CSA - Canadian Dealers Only
 - 25 Auto Ignition Furnace (1,000 BTUs)

We continually upgrade & improve our products and reserve the right to change any specifications without notice.



Morning Dew



Morning Dew

What is ABSOLUTE NORTHWOOD?



Our Guarantee of

Quality
Strength
Durability



When you purchase a Northwood Product, you are investing in the best quality materials, construction and craftsmanship. That is why the resale value in a Northwood RV remains higher, and your investment retains its value longer. If you ever decide to trade in your RV, you will get top dollar. That is why you don't see many used Northwood RVs on the market, folks buy them up as quickly as they become available because they have a reputation for durability and longevity.

ABSOLUTE CHASSIS

✓ Custom Built, Tested, Certified

ABSOLUTE FRAME

✓ Select 16" OC Framing, Anchor Blocking & Steel Hurricane Plates

ABSOLUTE ROOF

✓ Full Walk On, Bonded Roof Truss System

ABSOLUTE CABINETS

✓ Wall & Ceiling Mounted, Face Frame Construction

ABSOLUTE INSULATION

✓ A True 4 Season Coach

www.Northwoodmfg.com

NORTHWOOD BUILT CERTIFIED CHASSIS



WE BUILD OUR OWN HEAVY DUTY STRUCTURAL STEEL OFF-ROAD CHASSIS

We are one of the few manufacturers that build their own chassis. The name NORTHWOOD is known throughout the industry for quality chassis and we certify ours through an independent testing laboratory for quality assurance.



GLUE BONDED FRAME w/1-PIECE FIBERGLASS, MULTI-LAYER WALLS

Our wall studs are 16" on center select lumber (better than competitor's #2 grade). We use R7 fiberglass insulation which is hand tucked and secured. We apply a one-piece laminated exterior wall of corona treated fiberglass and double layers of lauan plywood.

This wall forms an amazingly strong one piece seamless panel. Industrial strength construction adhesives glue bonds the framing to triple layered, laminated exterior siding.



All these features combine to provide the "Absolute strength" of the Nash sidewall.



A True 4 Season Coach

R-7 Fiberglass in Walls & Floor
R-14 Fiberglass in the Roof
R-15 Reflective Foil - Ceiling & Floor
Heated & Enclosed Tanks
Heated & Enclosed Valves



OUR BONDED ROOF TRUSS SYSTEM ENSURES A FULL WALK-ON ROOF

BONDED ROOF TRUSS SYSTEM



The Northwood Bonded Roof Truss System bonds all the components of the roof structure together as a unit. The ceiling, trusses and roof plywood are unified in a bonded system that gives superior load distribution and maximum load bearing capacity.



Top quality exterior grade plywood panels are bonded to the trusses and a thick one piece roofing membrane is then applied for a durable, long lasting seal to protect you and your coach from the elements.

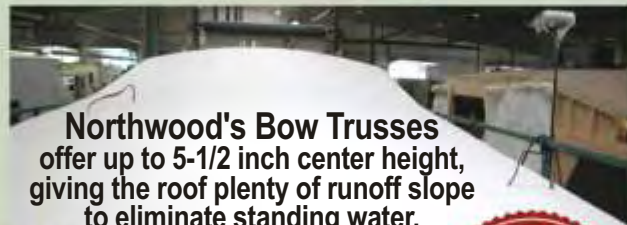

Northwood's Bow Trusses offer up to 5-1/2 inch center height, giving the roof plenty of runoff slope to eliminate standing water.



CUSTOM BUILT FACE FRAME CABINETS

CABINERY w/SOLID WOOD DOORS, BUILT USING RESIDENTIAL FACE FRAME CONSTRUCTION METHODS & INTEGRATED WITH THE WALL & CEILING.

BEAUTIFUL & STRONG



MATERIALS

Solid Wood cabinet doors ensure lasting beauty and rugged strength.



CONSTRUCTION

Face Frame construction gives our cabinets 'high end' residential quality.



INSTALLATION

Structurally Integrated cabinetry is anchored to the walls and ceiling structure of our coaches making both the RV and the cabinets stronger.

A TRUE FOUR SEASON ALL CONDITIONS UNIT



HEATED ENCLOSED HOLDING TANKS & DUMP VALVES DESIGNED FOR COLD NORTHERN/HOT SOUTHERN CLIMATES

Northwood builds true 4-Season coaches. Our fully insulated holding tank area circulates warm air around the suspended tanks providing the best protection from freezing. Our knife valves are also enclosed to keep them from freezing. Our 4-Season coaches are insulated with various types of residential quality Rigid Foam, Batten & Reflective Foil insulation to protect you from the winter cold & summer heat.



Nash 23F



Massive Storage Capacity
Large Rear Bath * Big Living Area * Private Bedroom

- 23F Model Number**
- 4132 Dry Axle Weight (approx. Lbs.)
- 420 Dry Hitch Weight (approx. Lbs.)
- 2448 Net Carrying Capacity (approx. Lbs.)
- 4552 Gross Dry Weight-lbs (approx. Lbs.)
- 7000 Gross Vehicle Weight Rating (GVWR)-Lbs.
- 26'4" Exterior Length (approx. w/hitch)
- 10'7" Exterior Height (approx. incl. AC unit)
- 8'0" Exterior Width (approx. w/o awning)
- ST205/75R15 Tire Size
- C Load Range
- 50 Fresh Water w/ Water Heater (approx. gal.)
- 42 Gray Water Tank (approx. gal.)
- 35 Black Water Tank (approx. gal.)
- 14 LPG Capacity (approx. gal.)
- YES CSA - Canadian Dealers Only
- 25 Auto Ignition Furnace (1,000 BTUs)

We continually upgrade & improve our products and reserve the right to change any specifications without notice.



High Desert



High Desert

Nash 24M



Big Rear Bathroom

Full Pass Thru Storage * Dual Entry * Huge Bath Wardrobe * Fridge/Pantry

24M Model Number

- 4594 Dry Axle Weight (approx. Lbs.)
- 467 Dry Hitch Weight (approx. Lbs.)
- 1939 Net Carrying Capacity (approx. Lbs.)
- 5061 Gross Dry Weight-lbs (approx. Lbs.)
- 7000 Gross Vehicle Weight Rating (GVWR)-Lbs.
- 27'3" Exterior Length (approx. w/hitch)
- 10'11" Exterior Height (approx. incl. AC unit)
- 8'0" Exterior Width (approx. w/o awning)
- ST205/75R15 Tire Size
- C Load Range
- 50 Fresh Water w/ Water Heater (approx. gal.)
- 42 Gray Water Tank (approx. gal.)
- 35 Black Water Tank (approx. gal.)
- 14 LPG Capacity (approx. gal.)
- YES CSA - Canadian Dealers Only
- 25 Auto Ignition Furnace (1,000 BTU's)

We continually upgrade & improve our products and reserve the right to change any specifications without notice.



Nash 25C



Bunkhouse
Huge U-Shaped Dinette * Dual Entry * Large Bath

- 25C Model Number**
- 4823 Dry Axle Weight (approx. Lbs.)
 - 555 Dry Hitch Weight (approx. Lbs.)
 - 2622 Net Carrying Capacity (approx. Lbs.)
 - 5378 Gross Dry Weight-lbs (approx. Lbs.)
 - 8000 Gross Vehicle Weight Rating (GVWR)-Lbs.
 - 28'8" Exterior Length (approx. w/hitch)
 - 10'11" Exterior Height (approx. incl. AC unit)
 - 8'0" Exterior Width (approx. w/o awning)
 - ST225/ Tire Size
 - 75R15
 - D Load Range
 - 50 Fresh Water w/ Water Heater (approx. gal.)
 - 42 Gray Water Tank (approx. gal.)
 - 35 Black Water Tank (approx. gal.)
 - 14 LPG Capacity (approx. gal.)
 - YES CSA - Canadian Dealers Only
 - 25 Auto Ignition Furnace (1,000 BTUs)

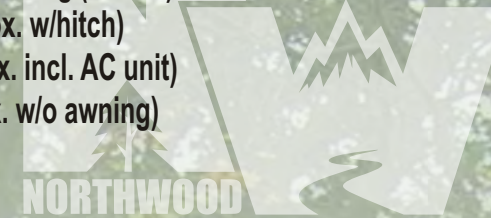

We continually upgrade & improve our products and reserve the right to change any specifications without notice.



www.Northwoodmfg.com

Morning Dew



Morning Dew

NASH

STANDARD FEATURES & OPTIONS

Standard Construction Features

Northwood built / certified / off-road chassis
Equaflex suspension
Enclosed and heated fresh water tanks
Durable, seamless, exterior fiberglass siding
5/8" T&G plywood main floor decking
Fully decked 3/8" plywood 'Full Walk-On' roof
One-piece, seamless, roof membrane
Wood structural framing throughout
2" X 2" studs, 16" O/C in walls, front & rear
2" X 3" longitudinal joists 16" on center
5" residential-style tapered wood roof trusses
R-7 fiberglass insulation in sidewalls and floor
Double R-7 roof insulation w/ reflective foil
Reflective Foil insulation throughout floor
Darco one-piece RV under siding
1/2" plywood bed and bunk platforms
2" thick laminated route-out dinette platforms
Electric-power rack and pinion slideouts

Standard Interior Features

Stereo/AM/FM/CD
Structurally integrated cabinetry throughout
Solid wood mortise and tenon cabinet doors
Solid wood drawer faces
Armstrong residential wear surface floor covering
Designer décor border
Valance window treatments
Jack knife sofa (converts for sleeping)
LED utility interior lighting
110 electrical outlets throughout
Square cabinet door frames
Mini-blind privacy shades throughout
Residential furniture by Homestyle
10" electric brakes on all wheels
Roller bearing drawer glides



Standard Exterior Features

Generator ready
Solar Ready
20 watt solar panel
LED Exterior lighting
LPG quick connect
Rear receiver for cargo rack / bike carrier
15" radial tires
Metal wheels and hub covers
Leaf spring suspension & straight axles
Amber patio light w/interior switch & hitch light
Large luggage compartments
Luggage doors w/radius corner & metal pulls
Non-skid retractable entry step
Entry assist handle and hurricane door latch
Bumper with drain hose storage and end caps
Galvanized steel wheel wells
Insulated wheel wells on non-slide models
Mud flaps
Molded ABS LPG tank cover
Fiberglass entry door with radius top corners
Screen door with kick panel
Rain gutters with oversized down spouts
Diamond plate front gravel guard
Radius cornered windows with screens
Dual battery rack welded into A-frame
Park cable TV hook-up with RG6 cable
Digital TV antenna w/signal booster
Roof-mount antenna for radio
Hook-up for satellite TV reception
12 volt power awning
Custom gray fiberglass exterior
Exterior shower

Standard Safety Features

Dual safety chains on A-frame
Break-away switch
GFCI circuit protection
Smoke alarm
LPG leak detector
Carbon monoxide detector
Fire extinguisher
Dead bolt lock on entry door
Egress windows (for emergency escape)

Standard Bathroom Features

Marine toilet
Shower surround
Shower curtain with curved track
Additional décor shower curtain
Skylight above tub/shower
Exhaust fan
Wall mounted light switch
Large bathroom sink
Medicine cabinet with mirror
Towel bar
Towel ring
Toilet paper holder
Electrical outlet with GFCI circuit protection

Standard Bedroom Features

Bedroom roof vent
Quilted bedspread with reverse sham
Designer headboard
Camping clothes storage
Below-bed storage with gas strut assist
Night stand top and drawer
Reading lights
Mini blind privacy shades
Electrical outlets
Campers Comfort mattress
Designer privacy curtain
TV mount pre-block w/ hook-ups

Standard Heat, Power, and Water Equipment

12V electrical system
Deluxe 110V 45-amp power converter
30 amp park power cord - 30 feet
Auto-ignition furnace with wall thermostat
In-floor heat ducting
In-ceiling A/C ducting
120V GFCI circuit protected exterior patio outlet
12V demand water pump system
Hook-up for city water
10-gal gas water heater
Two (2) 30 lbs. propane gas tanks w/ regulator
ABS holding tanks
Systems monitor panel
Water system winterization kit
Water heater by-pass
Black tank flush

Standard Kitchen Features

Nash signature key holder
3-burner cook top with one 9,000 BTU burner
Large oven
Range hood with light and exhaust fan
Back splash protection behind cook top
Double door gas/electric refrigerator (most models)
Designer refrigerator door panel inserts
Acrylic residential-style sink
High profile galley faucet
Sink cover / cutting board
Large drawers in galley cabinet
Galley overhead storage cabinets
Ventilating window at galley sink
Large picture window at dinette
Large dinette table
Access to dinette booth storage
Laminated countertops
Microwave oven with carousel

Options

Aussie stainless steel BBQ grill
Obe-Co convenience center
Exterior marine grade stereo speakers
AM/FM Stereo w/ Blue Tooth
Sit -N- Sleep sofa sleeper (some models)
Heated and enclosed holding tanks
Stabilizer jacks - front and rear
Air conditioner
Range cover
Generator
Cargo rack
Bike rack
LCD TV



MORE ABOUT NASH



Thank you
Ron and Sherry Nash

When you've been in the RV industry for nearly 1/2 a century, you've seen it all, and one thing never changes, quality sells and re-sells.

We started Northwood in 1993, building the best quality RV for the best price. That principle has never changed and we are absolutely committed to maintaining our reputation for quality in the RV industry.

Thank you for your continued interest in our product.

We have owned both Nash and Arctic Fox products from Northwood.

In 1996 we bought our first Northwood product, the Nash 26J and we used it for 6 years. We did a lot of traveling in the Nash. We then decided to move to a slide-out model and got our 25R Fox. In 10 years of use, our 25R Fox has followed our 4x4 Dodge wherever we have gone, on and off the pavement. It has aged better than we have!



We love to boondock, so we seldom go into RV parks except for rallies and visiting relatives. We do a lot of volunteer work with Rocky Mountain Elk, Oregon Hunters and work on projects with the Forest Service and Fish and Wildlife, so we mostly camp in remote sites.

We first met Ron and Sherry Nash at the Eugene RV Show back in 1993 where they were showing their new products. We also met them a few times at the Portland RV shows. When they came out with the 26J in 1996, we bought one.

While owning the Nash, we were able to make a number of suggestions to Ron Nash and Matt Turley about design considerations on our trailer and for future product upgrades. I was impressed to see a number of those suggestions implemented in newer models. Ron always had an ear for us and he would greet us 'Hi Linda and Dave', with a cup of coffee. I feel very good about the team Ron has assembled and the way they are moving the company forward. I am proud to say that we may have been the first owners of a Nash with heated and enclosed holding tanks because of our hunting camp use. This 4-Season feature soon became standard on all Nash products.

We have been 'trailer' for over 45 years and the Nash was our 8th trailer, so we are not new to the RV industry.

It has really been fun watching Northwood develop and having a part in some of the changes. Thanks for a great product and wonderful, personal service, Northwood!"



Our first Northwood product was a 2002 Nash 29V and we pretty much ran the tires off of it. The service people here at Northwood have been excellent. They have saved me a great deal of time, and Northwood is probably the best manufacturer I have ever dealt with. The fit and finish in the Nash is 'all there!' I can't give high enough praise for the product and the backing the company gives you.

Dave Thomas
Eugene, Oregon



Hello Ron and Sherry Nash,

My husband and I have just returned from a three week tour of the Grand Teton, Yellowstone, and Glacier National Parks—in our brand new Nash 17K. We wanted to share some of our photos and some of our story.

This was the longest trip we have taken in a recreational vehicle. Though we have owned larger RVs in the past, mostly motorized Class A and C motorhomes, we have never been on the road this many consecutive nights and days. Our most recent RV was a deluxe tent trailer, and we knew it would be an inadequate way to travel this far, this long, and this old.

We decided to look into a small travel trailer we could tow with our Toyota Tundra. Fully expecting to purchase something used, we decided to give our local business a first look: The owner let us go scouting his inventory of new and used trailers. Once in his yard, we spotted three new trailers that were somehow “different”: different color, different shape, and different size.

All these features were attractive.



www.Northwoodmfg.com



He had three models of Nash on his lot. After going in and out of all three models about fifty times each, we told him we would take this small, compact 17K. Apparently your new Nash designs had not been on the lot for more than a few days, and he was embarrassed to say that he really did not have all the info on them—but he would get it.

One week later, our Nash was parked on our property and ready to be packed for a one-night trial before we got busy on our serious trip. All systems worked perfectly in our remote, rustic campsite outside Quemado, NM, and they continued to surpass our expectations for capability, reliability, and easability.

We are 100% satisfied customers! We would be happy to answer any questions other potential buyers might ask.

Sincerely,
Steve and Jealyn White
Silver City, New Mexico



NASH

FORGED ON THE FRONTIER

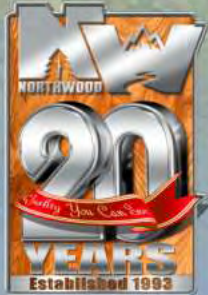

Model Number	17K	18L	23B	23D	23F	24M	25C
Dry Axle Weight (approx. Lbs.)	3537	3752	4312	4482	4132	4594	4823
Dry Hitch Weight (approx. Lbs.)	500	520	430	500	420	467	555
Net Carrying Capacity	2963	2728	2258	2018	2448	1939	2622
Gross Dry Weight-lbs (approx. Lbs.)	4037	4272	4742	4982	4552	5061	5378
Gross Vehicle Weight Rating (GVWR)-Lbs.	7000	7000	7000	7000	7000	7000	8000
Exterior Length (approx. w/hitch)	22' 4"	23' 3"	27' 7"	25' 10"	26' 4"	27' 3"	28' 8"
Exterior Height (approx. incl. AC unit)	10' 7"	10' 7"	10' 7"	10' 11"	10' 7"	10' 11"	10' 11"
Exterior Width (approx. w/o awning)	8' 0"	8' 0"	8' 0"	8' 0"	8' 0"	8' 0"	8' 0"
Tire Size	ST205 75R15	ST205 75R15	ST205 75R15	ST205 75R15	ST205 75R15	ST205 75R15	ST225 75R15
Load Range	C	C	C	C	C	C	D
Fresh Water w/ Water Heater (approx. gal.)	50	50	50	50	50	50	50
Gray Water Tank (approx. gal.)	35	42	42	42	42	42	42
Black Water Tank (approx. gal.)	36	35	35	35	35	35	35
LPG Capacity (approx. gal.)	14	14	14	14	14	14	14
CSA - Canadian Dealers Only	YES	YES	YES	YES	YES	YES	YES
Auto Ignition Furnace (1,000 BTUs)	25	25	25	25	25	25	25

***All dry weights are calculated before adding options.**

Specifications are subject to change without notice.

Verify the towing capacity of your tow vehicle. If you don't know or aren't sure, you can ask your automotive dealership or contact your tow vehicle manufacturer. All weights above are average approximations and may vary.

Your Local Dealer:



Updated July 2013



www.northwoodmfg.com

Northwood Manufacturing, 59948 Downs Rd., PO Box 3359, La Grande, OR 97850 (541) 962-6274 - www.northwoodmfg.com

Photos, drawings, dimensions and weights are presented as accurate but may differ from current production models. We continually upgrade & improve our products and reserve the right to change any specifications without notice. Please see your authorized Northwood dealer for updated information.