



**Jayco**<sup>®</sup>

Generations of family fun.

# EAGLE

2015 TRAVEL TRAILERS AND FIFTH WHEELS BY JAYCO



This 1986 brochure cover inspired our 2015 literature.

**2**  
**YEAR**  
WARRANTY



# BUILT FOR FAMILY-SIZED getaways



**On the cover:** The 1986 brochure artwork, illustrated by Tim MacDonald, was part of a successful ad campaign. These illustrations inspired the 2015 Jayco brochure covers, which are live re-creations of Tim's artwork.

For 45 years, Jayco has helped create generations of family fun, and over the course of that time, fun still looks remarkably the same. From campfires to fishing, from relaxing to eating, fun has the same feel generations later—and all with a Jayco RV nearby. Today, we're the largest family-owned RV manufacturer in the world, and our promise is to continually strive to build family-friendly products that will outlast just about everything but your memories. Join us in our generations of family fun.





Scan this QR code to watch how Jayco delivers Generations of Family Fun or visit [www.GenerationsOfFamilyFun.com](http://www.GenerationsOfFamilyFun.com).

**Every family defines fun a little differently**, but thanks to our robust 2015 Eagle lineup, it's easier than ever to find the perfect family getaway. Introducing the Eagle family:



### Eagle Travel Trailers



Jayco's top-of-the-line travel trailer — PAGE 4

	TRAVEL LENGTH	33' 11" - 39' 3"
	WEIGHT	6,605-8,710 lbs.
	SLEEPS	3-12



### Eagle HT



Our lightest fifth wheel yet — PAGE 8

	TRAVEL LENGTH	25' 5" - 33' 9"
	WEIGHT	6,220-8,300 lbs.
	SLEEPS	3-10



### Eagle Fifth Wheels



A family-favorite fifth wheel — PAGE 10

	TRAVEL LENGTH	33' 3" - 37' 1"
	WEIGHT	8,650-10,305 lbs.
	SLEEPS	3-10



### Eagle Premier

Jayco's luxury fifth wheel — PAGE 14

	TRAVEL LENGTH	34' 3" - 42' 4"
	WEIGHT	10,510-13,005 lbs.
	SLEEPS	3-11





EAGLE TRAVEL TRAILER 338RETS | ALMOND

# Eagle

## Travel Trailers

The 2015 Jayco Eagle travel trailer delivers top-of-the-line comfort in this family-friendly lineup. Brimming with a list of premium standard features, like a room-brightening skylight and a spacious 8 cu. ft. refrigerator, Eagle will put the word *treat* into your next family retreat.



EAGLE TRAVEL TRAILER | 8 CU. FT. FRIDGE



EAGLE TRAVEL TRAILER 338RETS | ALMOND





## PREMIUM STANDARDS

You won't find other travel trailers loaded with so many premium standard features, like LED lighting, a kitchen skylight, dark-tinted frameless windows, residential Shaw carpeting and a command center.



EAGLE TRAVEL TRAILER 338RETS | ALMOND

EAGLE TRAVEL TRAILER 338RETS | ALMOND

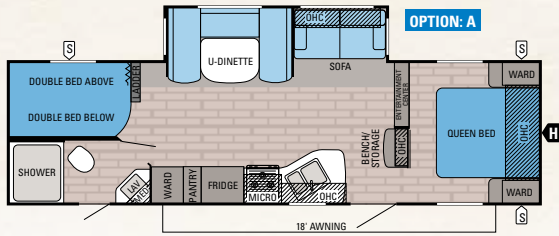

**EAGLE TRAVEL TRAILER | 284BHBE**

Ext. Length: 33' 11" Ext. Height: 137" Unloaded Wt. (lbs.): 6,605 Sleeps: 8-10

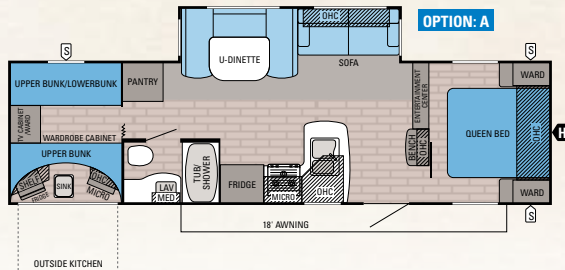

**EAGLE TRAVEL TRAILER | 294QBOK**

Ext. Length: 34' 9" Ext. Height: 138" Unloaded Wt. (lbs.): 6,985 Sleeps: 7-9

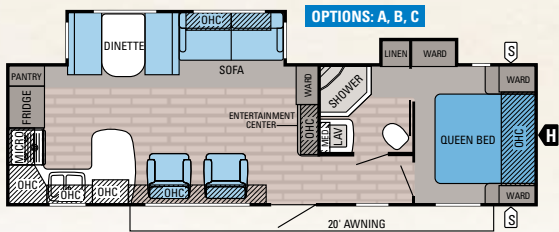

**EAGLE TRAVEL TRAILER | 306RKDS**

Ext. Length: 34' 5" Ext. Height: 138" Unloaded Wt. (lbs.): 7,095 Sleeps: 3-6

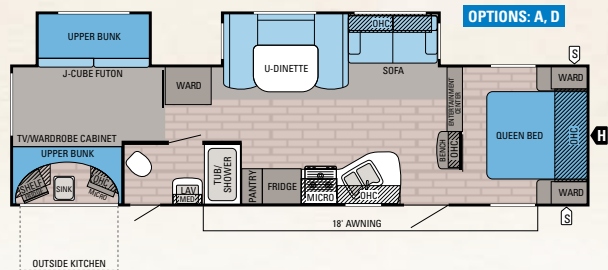

**EAGLE TRAVEL TRAILER | 314BHDS**

Ext. Length: 37' 3" Ext. Height: 137" Unloaded Wt. (lbs.): 7,710 Sleeps: 8-10

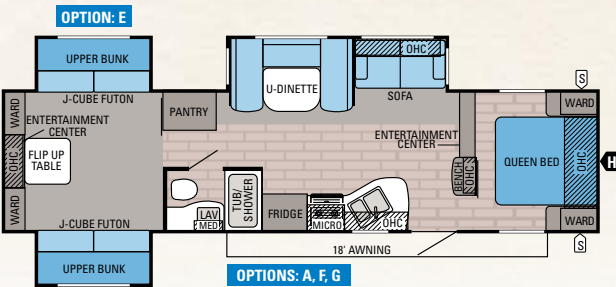

**EAGLE TRAVEL TRAILER | 314TSBH**

Ext. Length: 37' 10" Ext. Height: 137" Unloaded Wt. (lbs.): 7,945 Sleeps: 9-12

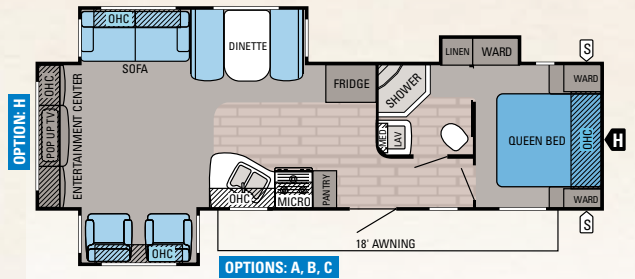

**EAGLE TRAVEL TRAILER | 318RETS**

Ext. Length: 35' 3" Ext. Height: 136" Unloaded Wt. (lbs.): 7,275 Sleeps: 3-6

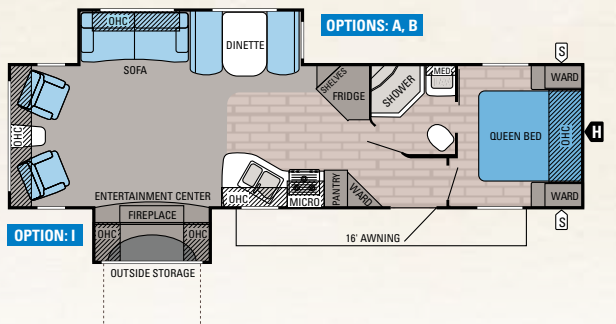

**EAGLE TRAVEL TRAILER | 321RLDS**

Ext. Length: 35' 11" Ext. Height: 139" Unloaded Wt. (lbs.): 7,475 Sleeps: 3-6

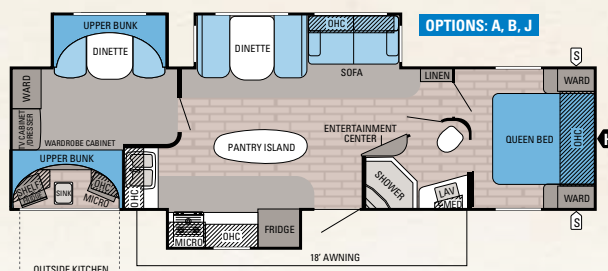

**EAGLE TRAVEL TRAILER | 324BHTS**

Ext. Length: 37' 2" Ext. Height: 138" Unloaded Wt. (lbs.): 8,240 Sleeps: 6-10

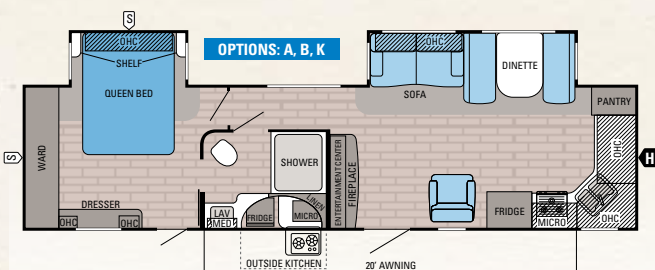

**EAGLE TRAVEL TRAILER | 336FKDS**

Ext. Length: 37' 8" Ext. Height: 138" Unloaded Wt. (lbs.): 8,110 Sleeps: 3-6

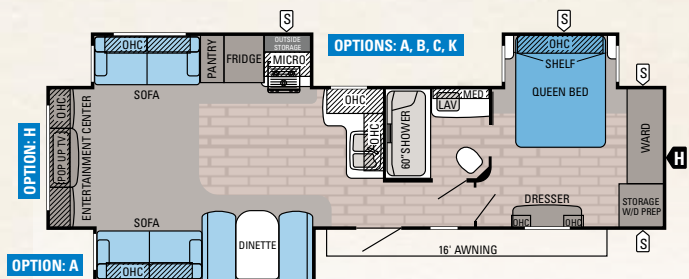

**EAGLE TRAVEL TRAILER | 338RETS**

Ext. Length: 39' 3" Ext. Height: 138" Unloaded Wt. (lbs.): 8,710 Sleeps: 3-8



## FLOORPLAN OPTIONS

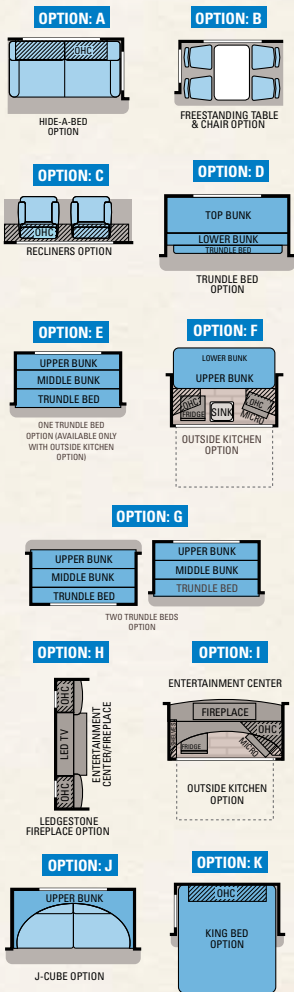

## STANDARD EXTERIOR EQUIPMENT

Deluxe Graphics Package  
High-gloss, Ivory fiberglass shell  
TuffShell vacuum-bonded, laminated sidewalls, slideout walls and rear wall  
Fully enclosed and heated underbelly  
80-plus gallon freshwater tank  
Magnum Truss Roof System with one-piece DiFlex II material  
Climate Shield

- Enclosed, insulated, heated underbelly
- High-BTU output furnace
- Astrofoil in roof and floors

I-Class cambered, structural steel I-beams  
Radial tires  
Aluminum rims  
MOR/ryde CRE3000 suspension system  
Completely enclosed and protected slide mechanisms  
30" x 72" main entrance door  
Extendable main entrance grab handle  
Oversized entry step with safety light  
Exterior marine-grade speakers (2)  
Frameless, G20 dark-tinted, safety-glass windows  
Pass-thru basement storage with slam latches and light  
Electric patio awning with LED lights  
Outside kitchen (294QBOK, 314BHDS, 324BHTS)  
Dual-battery capacity  
30-amp power service  
Black tank flush  
Cable/satellite prep  
Digital TV antenna  
Under-mounted spare tire  
Frame fully prepped for bike rack/cargo tray

## STANDARD INTERIOR EQUIPMENT

Steel ball bearing drawer guides, 75-lb. capacity, full extension  
Large, split kitchen sink with (2) cutting board covers and pull-out-style kitchen faucet  
18-gallon/hr. quick recovery gas/electric DSI water heater (6-gallon)  
8 cu. ft. refrigerator  
LED interior lights throughout  
Command center for switches (includes USB charger)  
Arched 84" ceiling with decorative transitions  
Closeable and directional air conditioner vents  
Residential window casing in living areas  
Sofa pillows  
Pleated night shades  
Glass shower enclosure  
Porcelain bath stool with foot flush  
Pillowtop Denver Mattress with quilted bedspread  
300-lb. bunk bed capacity (600-lb. in 284BHBE)

## CUSTOMER VALUE PACKAGE (MANDATORY)

Outside shower  
13,500-BTU dual-ducted air conditioner with Chillgrille feature  
Cap-integrated, dual, 30-lb. propane bottles with auto-regulator  
Microwave  
Oven  
Water heater bypass  
Bathroom fan  
Bath skylight  
ABS tile-look tub/shower surround

## PREMIER PACKAGE

Gel-coat sidewalls  
Remote for slideouts, awnings, patio lights and jacks  
Raised-panel cabinetry with lumbercore, screwed-style construction  
Large bath power vent

## OPTIONS

Customer Value Package with 13,500-BTU air conditioner  
Customer Value Package with 15,000-BTU air conditioner  
Premier Package  
2nd air conditioner in bedroom (15,000-BTU)  
Thermal-pane, tinted, safety-glass windows  
Electric tongue jack  
Electric stabilizer jacks (4)  
Outside kitchen (314TSBH and 321RLDS)  
32" LED HDTV (forced option on 321RLDS; n/a 318RETS or 338RETS with Ledgestone option)  
40" LED HDTV (forced option on 336FKDS)  
Wireless backup/rearview camera and monitor kit  
Bumper-mounted grill  
Bike rack/cargo tray  
50-amp service with 2nd air conditioner prep (dual-ducted) (std 321RLDS, 336FKDS, 338RETS)  
Roof ladder  
Solid-surface kitchen countertops with under-mount sink and covers  
Free-standing table and chairs (select models)  
Linoleum in living area (306RKDS, 318RETS, 321RLDS and 338RETS)  
Ledgestone fireplace with 40" LED HDTV (318RETS and 338RETS)  
Recliner in lieu of swivel chair (336FKDS)  
Recliners in lieu of swivel chairs (306RKDS, 318RETS and 321RLDS)  
Recliners in lieu of door-side sofa (338RETS)  
Door-side hide-a-bed (338RETS)  
Hide-a-bed sofa with tri-fold Denver Mattress  
King-sized bed (336FKDS, 338RETS)  
Trundle bed in lieu of J-Cube futon (314BHDS, 314TSBH)  
Two trundle beds in lieu of J-Cube futons (314TSBH; n/a with outside kitchen option)  
J-Cube futon with folding bunk (324BHTS)

## SPECIFICATIONS

MODELS	DIMENSIONS				WEIGHTS (LBS.)				TANKS (GALS.)		
	FLOORPLAN	EXTERIOR TRAVEL LENGTH	EXTERIOR WIDTH	EXT. HEIGHT (WITH A/C)	INTERIOR HEIGHT	UNLOADED VEHICLE WEIGHT*	DRY HITCH WEIGHT	GROSS VEHICLE WEIGHT RATING	CARGO CARRYING CAPACITY	FRESH (INCLUDES WATER HEATER)	GRAY
284BHBE	33' 11"	96"	137"	84"	6,605	630	9,250	2,645	82	32.5	32.5
294QBOK	34' 9"	96"	138"	84"	6,985	760	9,500	2,515	82	40.5	32.5
306RKDS	34' 5"	96"	138"	84"	7,095	1,025	9,750	2,655	82	65	32.5
314BHDS	37' 3"	96"	137"	84"	7,710	920	9,975	2,265	82	40.5	32.5
314TSBH	37' 10"	96"	137"	84"	7,945	860	10,750	2,805	82	40.5	32.5
318RETS	35' 3"	96"	136"	84"	7,275	815	9,975	2,700	82	32.5	32.5
321RLDS	35' 11"	96"	139"	84"	7,475	1,035	10,250	2,775	86	32.5	32.5
324BHTS	37' 2"	96"	138"	84"	8,240	940	10,950	2,710	86	65	32.5
336FKDS	37' 8"	96"	138"	84"	8,110	1,055	10,750	2,640	86	65	32.5
338RETS	39' 3"	96"	138"	85"	8,710	1,140	10,950	2,240	84	65	32.5

\*The weights of certain options and/or option packages are not included in the UVW listed in the specification charts.

**Unloaded Vehicle Weight (UVW):** Sometimes referred to as "Dry Weight," UVW means the typical weight of this trailer as built at the factory. The UVW, as used in product literature and other promotional materials, does not include cargo, fresh water, propane, options or dealer-installed accessories.

**Gross Vehicle Weight Rating (GVWR):** GVWR means the maximum permissible weight of the trailer, including the UVW plus passengers, personal items, all cargo, fluids, options, and dealer-installed accessories. The GVWR is equal to or greater than the sum of the UVW and the CCC.

**Cargo Carrying Capacity (CCC):** CCC means the maximum weight of all passengers, personal items, food, fresh water, propane, tools, other cargo and dealer-installed accessories that can be carried by the trailer. CCC is equal to or less than GVWR minus UVW. The addition of options will decrease the CCC.

**Hitch Weight (HW):** The hitch weight, as used in product literature and other promotional materials, does not include cargo, fresh water, propane gas, options or dealer-installed accessories. The addition of these types of items will either add to or subtract from the stated hitch weight.

It is important for your safety and enjoyment that your tow vehicle be adequately sized and equipped to tow and handle the GVWR of the RV you select. Review weights and rating of your tow vehicle and consult a competent advisor for questions or advice. Whether you are new to RVing or a veteran, get a feel for the performance of your tow vehicle before heading out on the roadways. When you tow an RV, you must drive differently than when you drive a single vehicle. Practice hooking up, driving, backing up and braking in a safe environment or seek out professional instruction. Jayco affixes a weight label to each RV which lists weight information for that vehicle. See specifications chart above.



EAGLE HT FIFTH WHEEL 29.5BHDS | PEWTER

# Eagle HT

## Lightweight Fifth Wheels

The 2015 Eagle HT is our lightest fifth wheel yet, but don't let its lightweight label fool you. This spacious model is loaded with conveniences that make it just as fun to camp in as it is to tow. From full-featured kitchens — inside and out — to a myriad of sleeping arrangements, including Denver Mattress bunk beds, Eagle HT packs lightweight fun.

### YOUR TRUCK HAS MET ITS LIGHTWEIGHT MATCH

MAKE	MODEL	ENGINE	CAB/BED	AXLE RATIO / EQUIPMENT
<b>Chevrolet</b>	Silverado 1500 2WD	6.2L V-8	Extended/Standard	3.73:1, Towing Package
<b>Dodge</b>	Ram 1500 2WD	5.7L V-8	Regular/Short	3.73:1, 5-speed AT
<b>Ford</b>	F-150 2WD	5.0L V-8	Regular/Long	3.73:1
<b>GMC</b>	Sierra 1500 2WD	6.2L V-8	Extended/Standard	3.73:1, Towing Package
<b>Nissan</b>	Titan 2WD	5.6L V-8	King/Short	Premium Utility Package
<b>Toyota</b>	Tundra 2WD	5.7L V-8	Regular/Long	Towing Package

\*It is important for your safety and enjoyment that your tow vehicle be adequately sized and equipped to tow and handle the GVWR of the RV you select. Review weights and rating of your tow vehicle and consult a competent advisor for questions or advice.



EAGLE HT FIFTH WHEEL 29.5BHDS | PEWTER



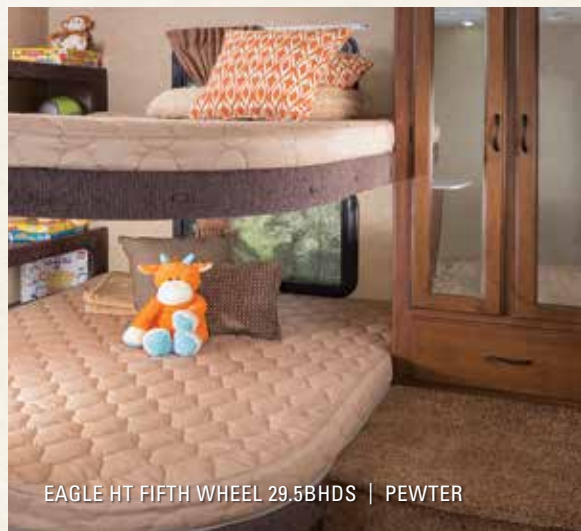

EAGLE HT FIFTH WHEEL 29.5BHDS | PEWTER

#### STANDARD EXTERIOR EQUIPMENT

- MOR/ryde CRE3000 rubberized suspension
- Ivory exterior fiberglass
- Ivory gel-coated front cap with integrated LED lights
- Frameless windows
- 15" radial tires
- I-Class structural I-beam frame
- Box-tube steel upper deck framing
- TuffShell vacuum-bonded, laminated walls
- Magnum Truss Roof System
- Completely enclosed and protected electric slideout mechanisms
- 3-step, extra-sturdy entrance steps
- 30" x 72" entrance door
- Slam-latch baggage doors
- Exterior marine-grade speakers
- 30-amp power service with detachable cord
- Cable/satellite hookup
- Digital TV antenna
- Outside grill prep
- Under-mounted spare tire
- Frame prepped for bolt-on Reese hitch (300-lb. tongue, 3,000-lb. tow rating)
- Climate Shield insulation package
- Magnetic latches on select baggage doors
- Hidden saddlebag storage with lid and restraint netting in pass-through
- Sidewall-mounted exterior convenience center

#### STANDARD INTERIOR EQUIPMENT

- 60" x 80" queen pillowtop Denver Mattress
- Under-bed storage
- Porcelain stool
- Hand-crafted, cherry-stained cabinetry
- Heavy-duty 75-lb. ball bearing drawer guides
- 8 cu. ft. gas/electric refrigerator with freezer
- Decorative ceiling light
- 32" LED HDTV
- USB charging port
- Congoleum "wood plank" Diamondflor vinyl flooring
- Shaw residential carpeting with R2X stain guard
- Heritage Collection furniture
- Hide-a-bed sofa with Denver sleep surface
- Pleated window shades
- Hand-crafted overhead cabinetry
- 5/8" tongue-and-groove joined plywood flooring
- LED interior lighting throughout
- Hidden switch command center with USB charger
- Directional and closeable A/C vents

#### CUSTOMER VALUE PACKAGE (MANDATORY)

- 13,500- or 15,000-BTU dual-ducted "Whisper Quiet" A/C
- 30-lb. propane bottles
- Machined aluminum rims
- Bathroom skylight
- Bluetooth sound system with AM/FM/CD/DVD and MP3 input jack
- Pillowtop Denver Mattress sleep system
- Electric patio awning with LED light
- Microwave
- Outside shower
- Sink covers (2)
- Solar prep
- Under-mounted spare tire
- Tub surround
- Water heater bypass

#### OPTIONS

- Customer Value Package with 13,500-BTU air conditioner
- Customer Value Package with 15,000-BTU air conditioner
- Electric fireplace (26.5BHS, 27.5RKDS, 27.5RLTS, 28.5RSTS)
- Living area carpeting (n/a 23.5RBS, 26.5RKS, 29.5BHDS)
- Free-standing table with 4 chairs (n/a 23.5RBS, std. on 27.5RLTS, 28.5RSTS)
- Wireless backup/rearview camera and monitor kit
- 50-amp service with dual A/C ducting
- 2nd bedroom A/C (15,000-BTU; requires 50-amp service)
- MOR/ryde rubberized pin box
- Reese Revolution 90-degree pin box
- Rear electric stabilizer jacks
- Bolt-on rear hitch
- Thermal-pane, tinted, safety-glass windows
- Bumper-mount grill
- Roof ladder





EAGLE FIFTH WHEEL 345BHTS | CHESTNUT

# Eagle

## Fifth Wheels

The 2015 Eagle fifth wheel gives you countless reasons to love camping, starting with the newest touches we've added to this popular lineup. Boasting functional kitchens, kid-favorite bunk rooms and a private bedroom with Denver Mattress, you're certain to find a perfect getaway. The 2015 lineup delivers stylish functionality with solid-surface countertops, skylights and LED lighting throughout.



EAGLE FIFTH WHEEL 323LKTS | ALMOND



EAGLE FIFTH WHEEL 323LKTS | ALMOND





EAGLE FIFTH WHEEL 323LKTS | ALMOND

**STANDARD EXTERIOR EQUIPMENT**

- MOR/ryde CRE3000 rubberized suspension
- I-Class structural I-Beam frame
- TuffShell vacuum-bonded, laminated walls
- Magnum Truss Roof System
- Completely enclosed and protected electric slideout mechanisms
- 3-step, extra-sturdy entrance steps
- 30" x 72" entrance door
- Slam-latch baggage doors
- Exterior marine-grade speakers
- Vista View doorside campsite windows
- Triple battery compartment with disconnect
- Heated, enclosed Uni-dock exterior utility center
- 50-amp power service with detachable Powersmart LED cord
- Cable/satellite hookup
- Digital TV antenna
- Outside grill prep
- Under-mounted spare tire
- Frame prepped for rear cargo accessory hitch
- Roof ladder
- MOR/ryde EZ-Stow toolbox in cargo area
- Climate Shield insulation package
- Magnetic latches on select baggage doors

**STANDARD INTERIOR EQUIPMENT**

- Home on the Road Master Suite: 60" x 80" residential queen pillowtop Denver Mattress, bathroom linen closet storage, oversized wardrobes and drawers, under-bed storage, dual-entrance bathroom and porcelain stool
- 48" residential-sized shower with sliding glass door (select models)
- Dual-ducted 2nd A/C prep
- Residential-style pantry storage
- Kitchen faucet with pullout sprayer
- Hand-crafted raised-panel cabinetry
- Heavy-duty, 75-lb. ball bearing drawer guides
- 8 cu. ft. gas/electric refrigerator with freezer
- Tinted skylight ceiling feature with integrated LED lights
- USB charging port
- Extra 110V power outlets in kitchen and slide rooms
- Flush-mount sink covers
- Congoleum "Wood-plank" Diamondflor vinyl flooring
- Shaw residential carpeting with R2X stain guard
- Heritage Collection furniture
- Hide-a-bed sofa with Denver sleep surface
- Pleated window shades
- Hand-crafted overhead cabinetry
- 5/8" tongue-and-groove joined plywood floor decking
- LED interior lighting throughout
- 110V ceiling fan (n/a 339FLOS)
- Hidden-switch command center
- Built-in bench locker/coat storage (n/a 339FLOS, 345BHTS)
- Directional and closeable A/C vents

**CUSTOMER VALUE PACKAGE (MANDATORY)**

- 13,500-BTU dual-ducted "Whisper Quiet" A/C system
- Bathroom power vent
- Bath skylight
- Pillowtop Denver Mattress sleep system
- Electric patio awning with integrated LED lights
- Over-the-range microwave with exhaust fan
- Water heater bypass
- Outside shower
- Machined aluminum rims
- Solar prep

**LUXURY PACKAGE (MANDATORY)**

- 4-point electric auto-leveling system
- 40" LED HDTV
- AM/FM/CD/DVD/USB A/V system with Bluetooth audio
- Rounded Barnwood and Ledgestone fireplace
- Frameless, tinted windows
- High-gloss Ivory fiberglass exterior
- Recessed LED front cap lighting
- Solid-surface LG kitchen countertops
- Stainless steel kitchen sink

**OPTIONS**

- Customer Value Package with 13,500-BTU A/C
- Customer Value Package with 15,000-BTU A/C
- Luxury Package
- 12 cu. ft. refrigerator (n/a 345BHTS)
- Carpeting in living area (291RSTS, 321RSTS, 323LKTS, 337RSTS)
- Sleeper sofa (replaces J-Cube futon on 345BHTS, standard on 325BHQS)
- Party sofa with stowable tables and hide-a-bed in lieu of dinette booth/theater seating (325BHOS, 345BHTS)
- Free-standing table and 4 chairs (std. on 291RSTS, 321RSTS, 323LKTS, 339FLOS)
- 2nd ducted A/C in bedroom (15,000 BTU)
- MOR/ryde rubberized pin box
- Reese Revolution 90-degree pin box
- Rear cargo accessory receiver
- Wireless backup/rearview camera and monitor kit
- Thermal-pane, tinted, safety-glass windows
- 2nd power awning (291RSTS, 321RSTS, 323LKTS, 337RSTS)
- Outside grill





## EAGLE HT FLOORPLANS

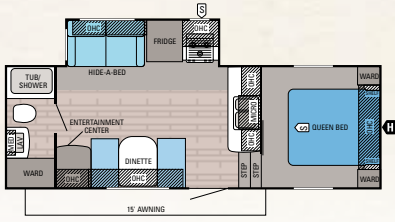

**EAGLE HT FIFTH WHEEL | 23.5RBS**

Ext. Length: **25' 5"** Ext. Height: **141"** Unloaded Wt. (lbs.): **6,220** Sleeps: **4-6**

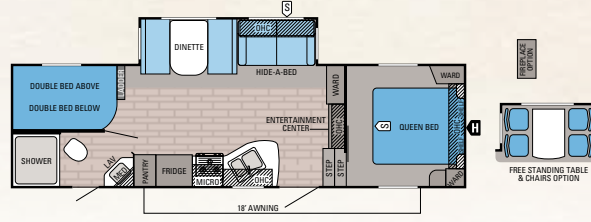

**EAGLE HT FIFTH WHEEL | 26.5BHS**

Ext. Length: **30' 6"** Ext. Height: **149"** Unloaded Wt. (lbs.): **6,795** Sleeps: **8-10**

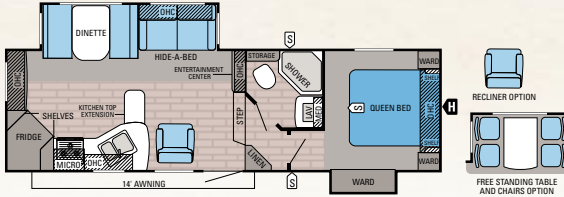

**EAGLE HT FIFTH WHEEL | 26.5RKS**

Ext. Length: **29' 4"** Ext. Height: **145"** Unloaded Wt. (lbs.): **7,040** Sleeps: **6**

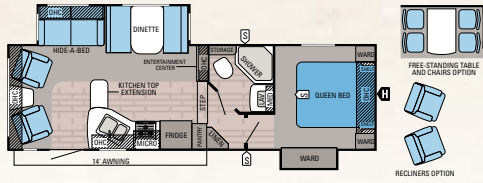

**EAGLE HT FIFTH WHEEL | 26.5RLS**

Ext. Length: **29'** Ext. Height: **147"** Unloaded Wt. (lbs.): **7,170** Sleeps: **5**

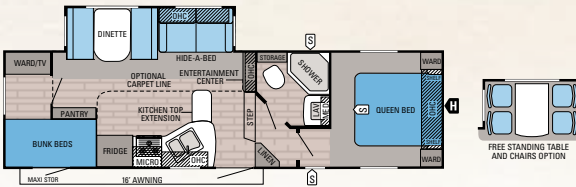

**EAGLE HT FIFTH WHEEL | 27.5BHS**

Ext. Length: **30' 11"** Ext. Height: **147"** Unloaded Wt. (lbs.): **7,195** Sleeps: **8**

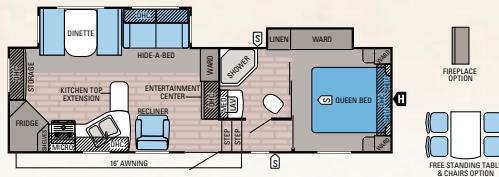

**EAGLE HT FIFTH WHEEL | 27.5RKDS**

Ext. Length: **TBD** Ext. Height: **TBD** Unloaded Wt. (lbs.): **TBD** Sleeps: **4-6**

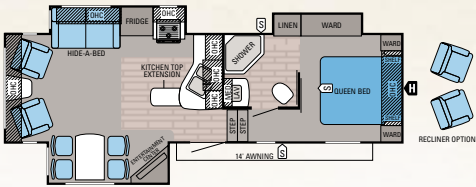

**EAGLE HT FIFTH WHEEL | 27.5RLTS**

Ext. Length: **30'** Ext. Height: **141"** Unloaded Wt. (lbs.): **7,625** Sleeps: **3**

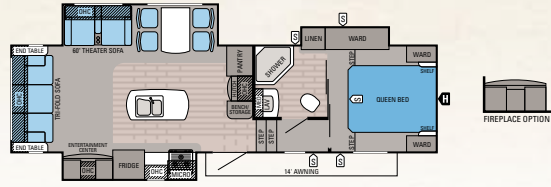

**EAGLE HT FIFTH WHEEL | 28.5RSTS**

Ext. Length: **32' 5"** Ext. Height: **144"** Unloaded Wt. (lbs.): **8,110** Sleeps: **3-4**

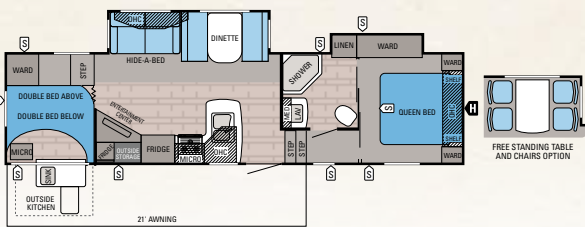

**EAGLE HT FIFTH WHEEL | 29.5BHDS**

Ext. Length: **33' 9"** Ext. Height: **148"** Unloaded Wt. (lbs.): **8,300** Sleeps: **8-10**

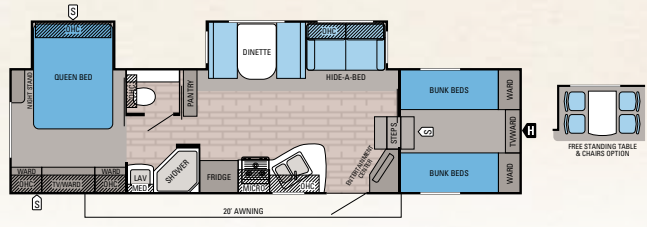

**EAGLE HT FIFTH WHEEL | 29.5FBDS**

Ext. Length: **33' 5"** Ext. Height: **148"** Unloaded Wt. (lbs.): **7,900** Sleeps: **7-10**

## EAGLE HT SPECIFICATIONS

MODELS	DIMENSIONS				WEIGHTS (LBS.)				TANKS (GALS.)			
	FLOORPLAN	EXTERIOR TRAVEL LENGTH*	EXTERIOR WIDTH	EXT. HEIGHT (WITH A/C)	INTERIOR HEIGHT	UNLOADED VEHICLE WEIGHT**	DRY HITCH WEIGHT	GROSS VEHICLE WEIGHT RATING	CARGO CARRYING CAPACITY	FRESH (INCLUDES WATER HEATER)	GRAY	BLACK
23.5RBS	23.5RBS	25' 5"	96"	141"	73"	6,220	1,235	9,950	3,730	48	65	32.5
26.5BHS	26.5BHS	30' 6"	96"	149"	75"	6,795	1,335	9,950	3,155	49	32.5	32.5
26.5RKS	26.5RKS	29' 4"	96"	145"	75"	7,040	1,380	9,950	2,910	48	65	32.5
26.5RLS	26.5RLS	29'	96"	147"	77"	7,170	1,325	9,950	2,780	48	65	32.5
27.5BHS	27.5BHS	30' 11"	96"	147"	79"	7,195	1,340	9,950	2,755	48	65	32.5
27.5RKDS	27.5RKDS	TBD	96"	TBD	TBD	TBD	TBD	TBD	TBD	48	65	32.5
27.5RLTS	27.5RLTS	30'	96"	141"	74"	7,625	1,260	9,950	2,325	48	65	32.5
28.5RSTS	28.5RSTS	32' 5"	96"	144"	74"	8,110	1,435	9,950	1,840	48	65	32.5
29.5BHDS	29.5BHDS	33' 9"	96"	148"	74"	8,300	1,515	9,950	1,650	48	73	32.5
29.5FBDS	29.5FBDS	33' 5"	96"	148"	88"	7,900	1,545	9,950	2,050	49	65	32.5

\*Distance from the pin box to the bumper; total exterior length may be longer. \*\*The weights of certain options and/or option packages are not included in the UUV listed in the specification charts.



# EAGLE FIFTH WHEEL FLOORPLANS

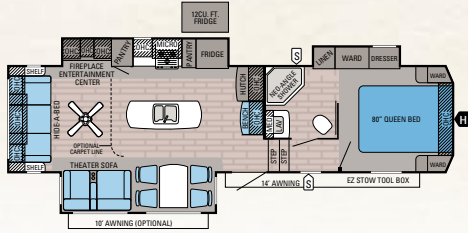

**EAGLE FIFTH WHEEL | 291RSTS**  
Ext. Length: 33' 5" Ext. Height: 152" Unloaded Wt. (lbs.): 9,160 Sleeps: 4

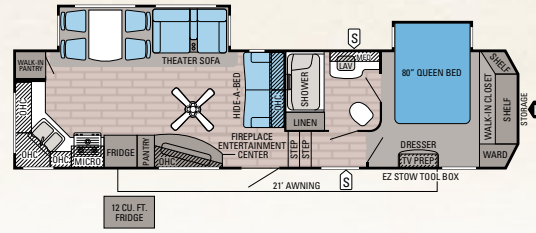

**EAGLE FIFTH WHEEL | 293RKDS**  
Ext. Length: TBD Ext. Height: TBD Unloaded Wt. (lbs.): TBD Sleeps: 4

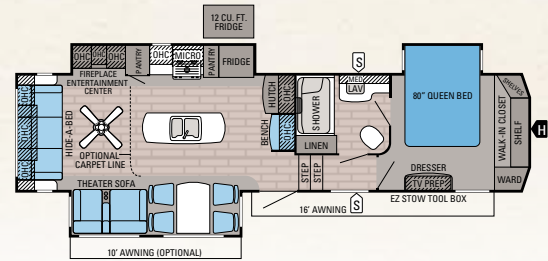

**EAGLE FIFTH WHEEL | 321RSTS**  
Ext. Length: 35' 1" Ext. Height: 152" Unloaded Wt. (lbs.): 9,620 Sleeps: 4

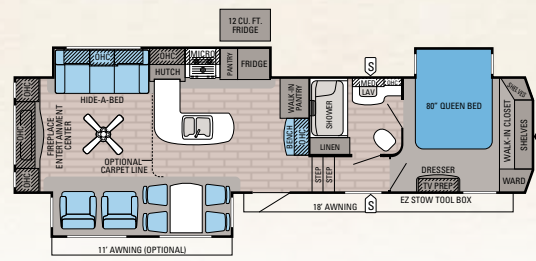

**EAGLE FIFTH WHEEL | 323LKTS**  
Ext. Length: 36' 4" Ext. Height: 152" Unloaded Wt. (lbs.): 10,210 Sleeps: 4

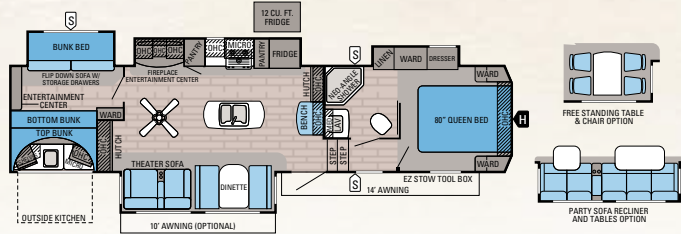

**EAGLE FIFTH WHEEL | 325BHQS**  
Ext. Length: 37' 9" Ext. Height: 157" Unloaded Wt. (lbs.): 10,730 Sleeps: 6-7

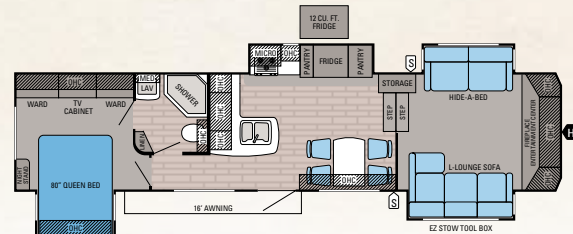

**EAGLE FIFTH WHEEL | 339FLOS**  
Ext. Length: 36' 10" Ext. Height: 161" Unloaded Wt. (lbs.): 9,875 Sleeps: 4-6

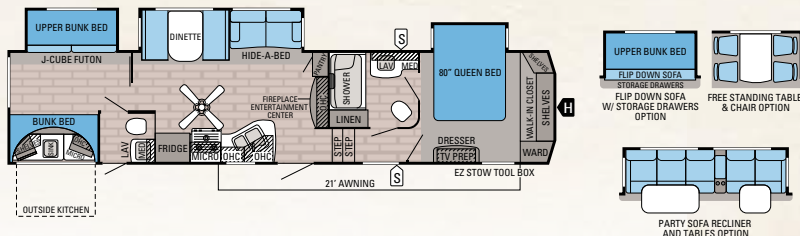

**EAGLE FIFTH WHEEL | 345BHTS**  
Ext. Length: 38' 8" Ext. Height: 149" Unloaded Wt. (lbs.): 10,530 Sleeps: 8-9

# EAGLE FIFTH WHEEL SPECIFICATIONS

MODELS	DIMENSIONS					WEIGHTS (LBS.)				TANKS (GALS.)		
	FLOORPLAN	EXTERIOR TRAVEL LENGTH*	EXTERIOR WIDTH	EXT. HEIGHT (WITH A/C)	EXT. HEIGHT (WITH OPT. BEDROOM A/C)	INTERIOR HEIGHT	UNLOADED VEHICLE WEIGHT**	DRY HITCH WEIGHT	GROSS VEHICLE WEIGHT RATING	CARGO CARRYING CAPACITY	FRESH (INCLUDES WATER HEATER)	GRAY
291RSTS	33' 5"	96"	152"	156"	78"	9,160	1,720	12,000	2,840	81	85	50
293RKDS	34' 5"	96"	154"	156"	78"	9,030	1,790	13,000	2,965	81	87	50
321RSTS	35' 1"	96"	152"	156"	77"	9,620	2,035	12,500	2,880	81	87	50
323LKTS	36' 4"	96"	152"	156"	77"	10,210	2,055	12,950	2,740	81	87	50
325BHQS	37' 9"	96"	157"	157"	78"	10,730	2,120	13,750	3,020	81	85	50
339FLOS	36' 10"	96"	161"	161"	95"	9,875	2,485	12,600	2,725	81	74	37
345BHTS	38' 8"	96"	149"	156"	77"	10,530	2,074	13,250	2,720	81	95	50

\*Distance from the pin box to the bumper; total exterior length may be longer. \*\*The weights of certain options and/or option packages are not included in the UWW listed in the specification charts.

**Unloaded Vehicle Weight (UWW):** Sometimes referred to as "Dry Weight," UWW means the typical weight of this trailer as built at the factory. The UWW, as used in product literature and other promotional materials, does not include cargo, fresh water, propane, options or dealer-installed accessories.

**Gross Vehicle Weight Rating (GVWR):** GVWR means the maximum permissible weight of the trailer, including the UWW plus passengers, personal items, all cargo, fluids, options, and dealer-installed accessories. The GVWR is equal to or greater than the sum of the UWW and the CCC.

**Cargo Carrying Capacity (CCC):** CCC means the maximum weight of all passengers, personal items, food, fresh water, propane, tools, other cargo and dealer-installed accessories that can be carried by the trailer. CCC is equal to or less than GVWR minus UWW. The addition of options will decrease the CCC.

**Hitch Weight (HW):** The hitch weight, as used in product literature and other promotional materials, does not include cargo, fresh water, propane gas, options or dealer-installed accessories. The addition of these types of items will either add to or subtract from the stated hitch weight.

It is important for your safety and enjoyment that your tow vehicle be adequately sized and equipped to tow and handle the GVWR of the RV you select. Review weights and rating of your tow vehicle and consult a competent advisor for questions or advice. Whether you are new to RVing or a veteran, get a feel for the performance of your tow vehicle before heading out on the roadways. When you tow an RV, you must drive differently than when you drive a single vehicle. Practice hooking up, driving, backing up and braking in a safe environment or seek out professional instruction. Jayco affixes a weight label to each RV which lists weight information for that vehicle. See specifications chart above.





EAGLE PREMIER FIFTH WHEEL 361REQS | BROWNSTONE

# Eagle Premier

**Luxury Fifth Wheels**

The name *Eagle Premier* says it all. This extraordinary fifth wheel delivers more premium upgrades than anything in its price range, making it the envy of the campground. Starting in the kitchen and moving into the bathroom, Premier flaunts stunning solid-surface countertops and Amish-crafted cabinetry. Outside, select model exterior kitchens boast a standard 32" LED television.



EAGLE PREMIER 361REQS | BROWNSTONE



EAGLE PREMIER FIFTH WHEEL 361REQS | BROWNSTONE





## PREMIUM COMFORT

The Eagle Premier wouldn't be premier without high-end comforts. From the new Heritage Series furniture line to the master suite's cedar-lined, walk-in closet, this fifth wheel has it all.



EAGLE PREMIER FIFTH WHEEL 375BHFS | ALMOND



EAGLE PREMIER 361REQS | BROWNSTONE



# EAGLE PREMIER FIFTH WHEEL FLOORPLANS

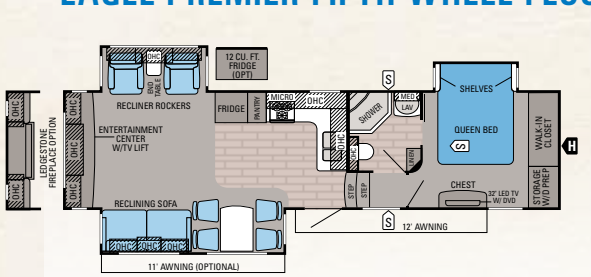

## EAGLE PREMIER | 321RLTS

Ext. Length: 34' 3" Ext. Height: 159" Unloaded Weight (lbs.): 10,510 Sleeps: 4-6

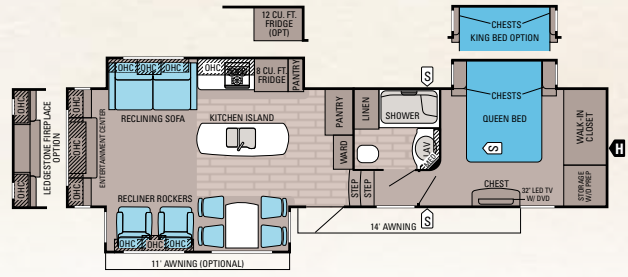

## EAGLE PREMIER | 331RETS

Ext. Length: 36' 8" Ext. Height: 159" Unloaded Wt. (lbs.): 11,150 Sleeps: 3-4

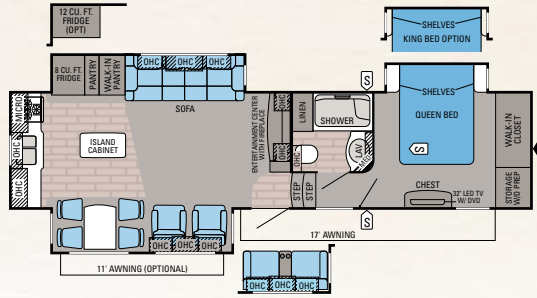

## EAGLE PREMIER | 331RKTS

Ext. Length: 36' 5" Ext. Height: 160" Unloaded Wt. (lbs.): 11,045 Sleeps: 3

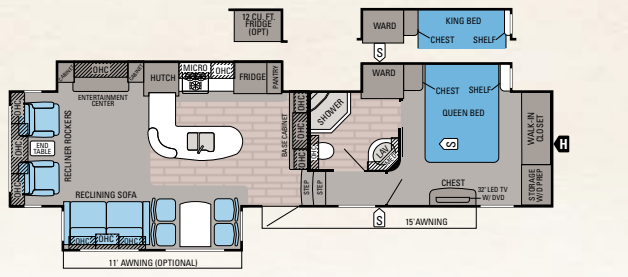

## EAGLE PREMIER | 351MKTS

Ext. Length: 38' 4" Ext. Height: 156" Unloaded Wt. (lbs.): 11,275 Sleeps: 4

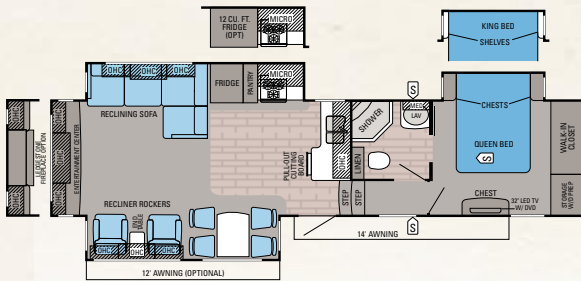

## EAGLE PREMIER | 351RLTS

Ext. Length: 37' 5" Ext. Height: 159" Unloaded Wt. (lbs.): 11,340 Sleeps: 4

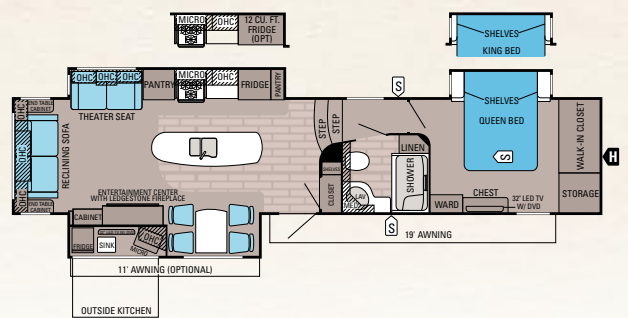

## EAGLE PREMIER | 351RSTS

Ext. Length: 40' 9" Ext. Height: 158" Unloaded Weight (lbs.): 12,005 Sleeps: 3

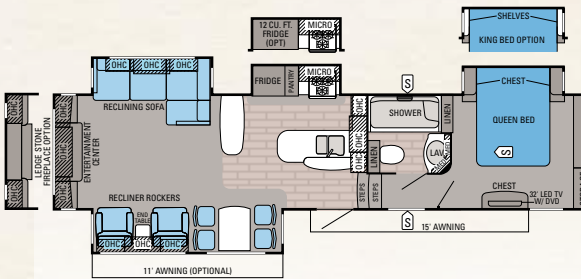

## EAGLE PREMIER | 361REQS

Ext. Length: 39' 1" Ext. Height: 156" Unloaded Weight (lbs.): 11,825 Sleeps: 4-6

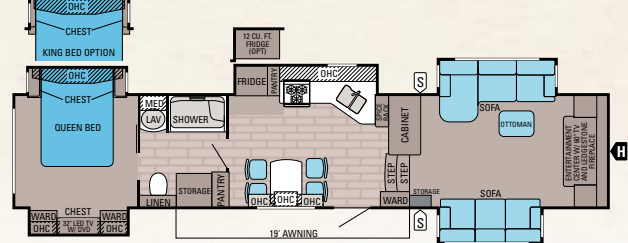

## EAGLE PREMIER | 371FLFS

Ext. Length: 42' 4" Ext. Height: 160" Unloaded Wt. (lbs.): 11,860 Sleeps: 4-5

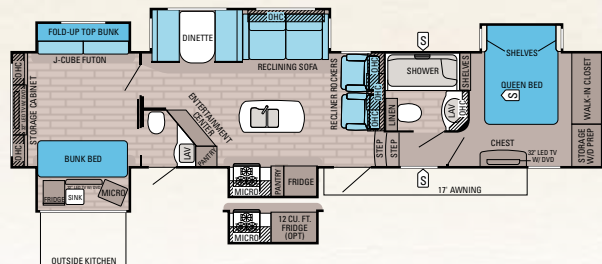

## EAGLE PREMIER | 375BHFS

Ext. Length: 41' 9" Ext. Height: 159" Unloaded Wt. (lbs.): 13,005 Sleeps: 8-11

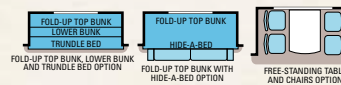



### STANDARD EXTERIOR EQUIPMENT

TuffShell vacuum-bonded, laminated walls  
 Ultra high-gloss, Ivory gel-coat exterior  
 Aerodynamic front cap with LED lighting  
 Seamless roof covering  
 Magnum Truss Roof System with one-piece DiFlex II material  
 Climate Shield

- Enclosed, insulated, heated underbelly
- High-BTU output furnace
- Astrofoil in roof and floors

10" I-Class cambered, structural I-beams  
 Completely enclosed and protected slideout mechanisms  
 Frameless, dark-tinted, safety-glass windows  
 30" x 72" entry door with oversized window  
 Heavy-duty entrance step  
 Front awning arm convenience outlet  
 16" radial tires  
 Nev-R-Adjust brakes  
 E-Z Lube axles  
 MOR/ryde CRE3000 suspension system  
 Wide-stance front landing gear  
 Exterior kitchen with 32" LED TV, sink, refrigerator and microwave (351RSTS and 375BHFS)  
 Enclosed, protected basement drop frame  
 Stor-Galore pass-through basement storage with slam latches and strut assist  
 Cable TV and outlet in basement  
 Exterior marine-grade speakers (2)  
 Sliding propane tray with 30-lb. bottles  
 Dual battery compartment with disconnect  
 Heated, enclosed Uni-Dock utility center  
 50-amp power service with detachable cord  
 35,000-BTU furnace (minimum)  
 75-gallon fresh water tank  
 70-gallon gray tank capacity (minimum)  
 44-gallon black tank capacity (minimum)  
 Cable/satellite prep  
 Digital TV antenna  
 Under-mounted spare tire  
 Outside grill prep  
 Frame prepped for rear cargo accessory receiver  
 Roof ladder

### STANDARD INTERIOR EQUIPMENT

Raised-panel cabinetry with screwed construction and hidden hinges  
 Steel ball bearing drawer guides, 75-lb. capacity, full extension

Hardwood slideout fascias  
 Large, split, under-mount kitchen sink with covers  
 Pull-out kitchen faucet  
 LG brand, high-gloss, solid-surface kitchen countertops  
 Water heater bypass  
 8 cu. ft. refrigerator with high-gloss front  
 Oversized 21" oven with 3-burner cooktop and range cover  
 Diamondfloor deluxe linoleum flooring  
 Free-standing table and 4 chairs (optional 375BHFS)  
 90-amp power center with Charge Wizard  
 Backlit command center for switches with cell phone charger  
 Floor-level convenience light switch for safe entry  
 Remote for slideouts, patio awning and patio light  
 Ceiling fan (n/a 371FLFS)  
 LED ceiling lights throughout  
 Ceiling mantle  
 Closeable and directional A/C vents  
 Prep for 2nd ducted A/C  
 Solar prep  
 46" LED HDTV (60" in 371FLFS)  
 Recliner rockers (n/a 351RSTS and 371FLFS)  
 Reclining sofas  
 Pleated day/night shades (main living area)  
 6' 5"-tall living area slideouts  
 One-piece, fiberglass shower with glass doors (select models)  
 Porcelain bath stool with foot flush  
 Robe hooks in bath  
 Deluxe bedding package  
 Full-trunk, under-bed storage  
 Walk-in style front closet with dual hanging rods  
 Combo washer/dryer prep (select models)  
 Stackable washer/dryer prep (select models)  
 Floor-to-ceiling bedroom dresser with 32" LED TV/DVD player and opera-style window (n/a 371FLFS)

### CUSTOMER VALUE PACKAGE (MANDATORY)

Aluminum rims  
 Folding exterior grab handle at main entrance  
 Large patio scare lights (2)  
 Electric patio awning with LED lighting  
 30" over-the-range residential microwave  
 20-gallon/hr. quick recovery gas/electric DSI water heater (10-gallon)  
 Canister style, in-line water filter  
 15,000-BTU low-profile Whisper Quiet air conditioner  
 Arched interior ceiling

Multi-media premium sound system with Bluetooth AM/FM/CD/DVD/MP3 player with toggle switch for outside speakers  
 Bath power vent  
 Bath skylight  
 Denver Mattress Advanced queen-sized (60" x 80") pillowtop mattress  
 Under-bed floor safe

### LUXURY PACKAGE

Kitchen power vent  
 MOR/ryde pin box  
 6-point electric auto-leveling system

### OPTIONS

Customer Value Package  
 Customer Value Package with heat pump  
 Luxury Package  
 Slideout awnings  
 2nd electric power patio awning, mounted on slideout (n/a 371FLFS, 375BHFS)  
 Keyless entry at main entrance  
 Thermal-pane, tinted, safety-glass windows  
 Generator prep  
 5,500-watt gasoline generator (includes prep)  
 Power cord reel (manual)  
 Rear cargo accessory receiver  
 Outside grill  
 12 cu. ft. refrigerator  
 30" residential convection microwave with oven  
 LedgeStone fireplace (321RLTS, 331RETS, 351RLTS, 361REQS) (standard on 351RSTS and 371FLFS)  
 Fireplace (n/a 351RSTS and 371FLFS)  
 Theater-seating ILO (2) recliners (331RKTS)  
 Free-standing table and 4 chairs (375BHFS)  
 Living-area linoleum (n/a 371FLFS, 375BHFS)  
 King-sized mattress (select models)  
 2nd 15,000-BTU low-profile, ducted A/C  
 Dyson cordless vacuum  
 Bunk beds with trundle bed on off-doorside (375BHFS)  
 Bunk bed with hide-a-bed on off-doorside (375BHFS)

## EAGLE PREMIER FIFTH WHEEL SPECIFICATIONS

MODELS	DIMENSIONS					WEIGHTS (LBS.)				TANKS (GALS.)		
	FLOORPLAN	EXTERIOR TRAVEL LENGTH*	EXTERIOR WIDTH	EXT. HEIGHT (WITH A/C)	EXT. HEIGHT (WITH OPT. BEDROOM A/C)	INTERIOR HEIGHT	UNLOADED VEHICLE WEIGHT**	DRY HITCH WEIGHT	GROSS VEHICLE WEIGHT RATING	CARGO CARRYING CAPACITY	FRESH (INCLUDES WATER HEATER)	GRAY
321RLTS	34' 3"	96"	159"	159"	81"	10,510	2,300	14,500	3,990	85	87	50
331RETS	36' 8"	96"	159"	159"	81"	11,150	2,345	14,900	3,750	85	87	50
331RKTS	36' 5"	96"	160"	160"	81"	11,045	2,250	14,995	3,950	85	87	50
351MKTS	38' 4"	96"	156"	157"	77"	11,275	2,265	14,995	3,720	85	87	50
351RLTS	37' 5"	96"	159"	159"	81"	11,340	2,340	14,995	3,655	85	85	50
351RSTS	40' 9"	96"	158"	158"	81"	12,005	2,445	15,500	3,495	85	95	50
361REQS	39' 1"	96"	156"	158"	81"	11,825	2,475	14,995	3,170	85	70	50
371FLFS	42' 4"	96"	160"	160"	91"	11,860	2,455	15,975	4,115	85	70	44
375BHFS	41' 9"	96"	159"	159"	80"	13,005	2,550	15,975	2,970	85	93	94

\*Distance from the pin box to the bumper; total exterior length may be longer. \*\*The weights of certain options and/or option packages are not included in the UUV listed above.

**Unloaded Vehicle Weight (UUV):** Sometimes referred to as "Dry Weight," UUV means the typical weight of this trailer as built at the factory. The UUV, as used in product literature and other promotional materials, does not include cargo, fresh water, propane, options or dealer-installed accessories.

**Gross Vehicle Weight Rating (GVWR):** GVWR means the maximum permissible weight of the trailer, including the UUV plus passengers, personal items, all cargo, fluids, options, and dealer-installed accessories. The GVWR is equal to or greater than the sum of the UUV and the CCC.

**Cargo Carrying Capacity (CCC):** CCC means the maximum weight of all passengers, personal items, food, fresh water, propane, tools, other cargo and dealer-installed accessories that can be carried by the trailer. CCC is equal to or less than GVWR minus UUV. The addition of options will decrease the CCC.

**Hitch Weight (HW):** The hitch weight, as used in product literature and other promotional materials, does not include cargo, fresh water, propane gas, options or dealer-installed accessories. The addition of these types of items will either add to or subtract from the stated hitch weight.

It is important for your safety and enjoyment that your tow vehicle be adequately sized and equipped to tow and handle the GVWR of the RV you select. Review weights and rating of your tow vehicle and consult a competent advisor for questions or advice. Whether you are new to RVing or a veteran, get a feel for the performance of your tow vehicle before heading out on the roadways. When you tow an RV, you must drive differently than when you drive a single vehicle. Practice hooking up, driving, backing up and braking in a safe environment or seek out professional instruction. Jayco affixes a weight label to each RV which lists weight information for that vehicle. See specifications chart above.



# WE START WITH ONE OF THE INDUSTRY'S strongest foundations

Jayco builds on custom-sized frames, designed specifically for each floorplan. Other manufacturers use stock frames, stretching and welding the frame to fit.

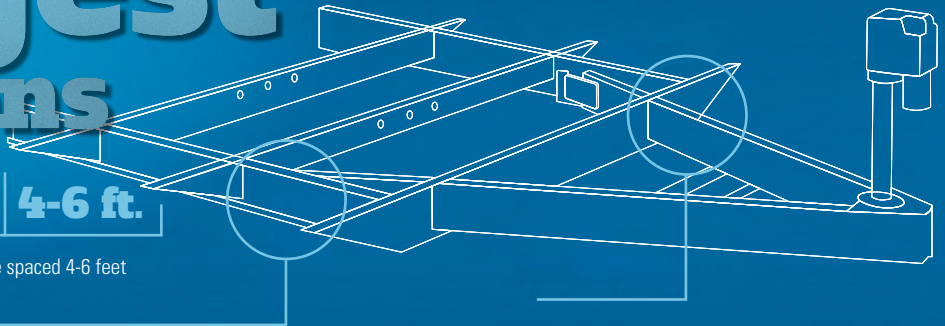

**4-6 ft.**  
Full-width outriggers: We build on full-width outriggers that are spaced 4-6 feet apart (vs. 8 ft.) to better support the weight of the wall.

**I-Class cambered structural steel I-beams:** Jayco uses a unique molded, one-piece design to prevent unit from twisting; competing three-piece I-beams can warp over time at the welded seams.

**Eagle travel trailer integrated A-frame:** The A-frame runs through the main frame, preventing the hitch from buckling like competing tack-welded frames.

**so we can build the industry's most reliable RV**



## CLIMATESHIELD

The Climate Shield features the following R-values.

### Eagle models (TT, HT, FW)

VALUE	UNIT AREA
R-5	All vertical walls
R-15	Behind front cap
R-27	Roof
R-29	Main floor
R-14	Slide floor
R-22	Bedroom floor
R-14	Inside open pin box

### Eagle Premier models

VALUE	UNIT AREA
R-7	All vertical walls
R-11	Behind front cap
R-30	Roof
R-22	Main floor
R-14	Slide floor
R-22	Bedroom floor
R-14	Inside open pin box
R-14	Enclosed drop-frame overhang

## Extend your camping season

with the Jayco Climate Shield — the ultimate in weather protection. Designed for efficient heating and cooling, Climate Shield protects against extreme heat and extreme freezing — even when temperatures hit a high of 100° F or a low of 0° F.

#### LIVING ROOM



#### KITCHEN



#### BATHROOM



#### HOLDING TANK



#### BEDROOM



\* Eagle was tested in 0° F and 100° F weather over an extended period of time in a controlled environment and all functions of the coach were fully operational. Testing cannot account for natural elements, such as wind or moisture. In actual use, unit may not perform as well. In addition, outside components are subject to freezing and require steps to properly insulate. Jayco's warranty does not cover damage caused by freezing.



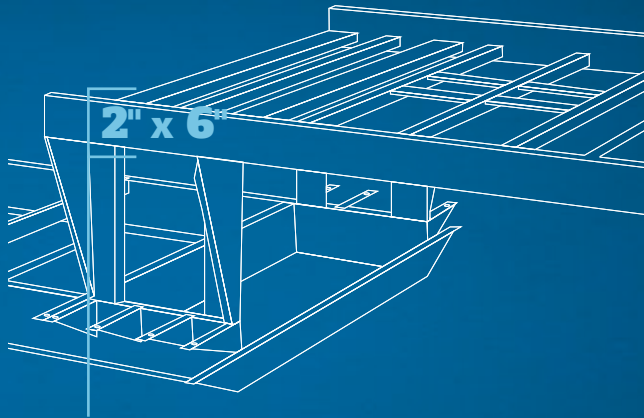

**Fifth wheel frame:** The frame over the truck bed is built on a superior 2"x 6" tube perimeter structure to better support the bedroom sidewalls. Competing fifth wheels have a smaller frame; these manufacturers add a sidewall support seam to compensate for expansion joints.



## THE MAGNUM TRUSS ROOF SYSTEM 50 percent stronger

In a side-by-side comparison test, Jayco's exclusive Magnum Truss Roof System withstood 4,500 lbs. — 50 percent more than other roofs. The difference?

- 1 Jayco uses 4 1/2" crowned wood trusses, solid-wood studs and oversized nail plates to maximize the roof's load capacity. (Eagle Premier uses 5" arched, stamped steel.)
- 2 Then, we screw down 3/8" roof decking at every seam, a process that is more durable than stapled construction.
- 3 Finally, our one-piece, sidewall-wrapped DiFlex II material provides the ultimate in leak protection.

## WALL CONSTRUCTION vacuum-bonded walls



- 4 Eagle features durable, vacuum-bonded, laminated sidewalls with smooth, high-gloss fiberglass exteriors that provide long-lasting appeal.
- 5 Welded aluminum frames give Eagle a durable, lightweight structure.

## FIFTH WHEEL CONSTRUCTION extra measures for extra warmth

- 6 In the upper deck of the fifth wheel floorplan, Jayco uses a double layer of fiberglass insulation behind the front cap, along with Flexfoam and fiberglass insulation in the floor, to provide extra warmth where it's needed most — in the bedroom.
- 7 Jayco's aerodynamic front cap is engineered to withstand the rigors of the road. Pigment-infused and gel coated, this fiberglass cap features more support with 1/4" plywood bracing, not typically found on other fifth wheels.

## EAGLE INTERIOR DÉCOR CHOICES

### ALMOND



### CHESTNUT



### BROWNSTONE

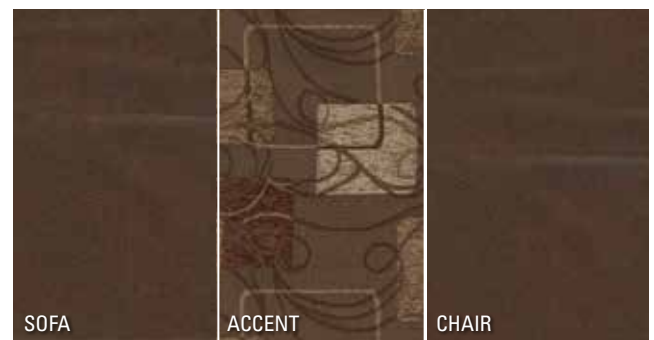

### HAVANA

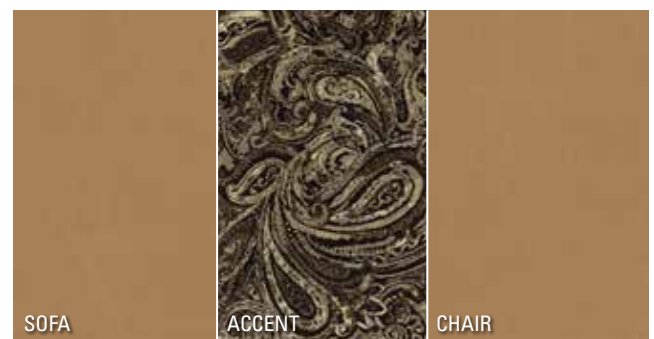

### RESIDENTIAL SHAW CARPET WITH R2X STAIN AND SOIL RESISTANCE





**2**  
**YEAR**  
WARRANTY



**Jayco**<sup>®</sup>

Generations of family fun.

Bumper-to-front limited warranty\*

# FAMILY **fun** starts with peace of mind

At Jayco, we build our RVs to handle every adventure, then we back our products with an industry-leading 2-year limited warranty. You won't find a better warranty in the business because the only strings we attach are those that deliver the ultimate in reliability. That's the Jayco difference. So go explore. We have the warranty that will follow you anywhere.

\*For a copy of our 2-year limited warranty with full terms and conditions, please contact your local Jayco dealer.

## FREE Roadside Assistance

Travel worry-free with Jayco's Customer First Roadside Assistance program, yours at no cost during the first year of ownership. This program is offered through Coach-Net, the country's largest RV emergency road service, and gives you immediate access to assistance.

**eco**advantage™

Jayco's long-term commitment  
to generations of family fun



Scan this QR code with your smartphone to watch a video about our efforts and the impact we're making on our planet.

[ecoadvantage.jayco.com](http://ecoadvantage.jayco.com)

The fun starts with your local Jayco dealer

Your local dealer

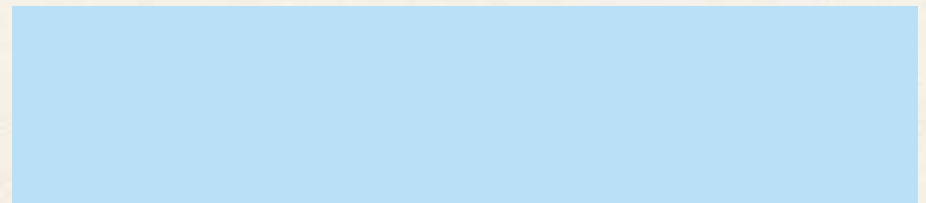

From giving advice to selling and servicing products, we consider our loyal dealers the glue in our family bond. Establishing a solid relationship with your local Jayco dealer is a key component in the enjoyment of your new Jayco. By purchasing from a local dealer, you will have a convenient location for sales, parts and service support. We hope you consider them a part of your camping family.

Follow Jayco



Jayco, Inc., P.O. Box 460, Middlebury, IN 46540, [www.jayco.com](http://www.jayco.com) See dealer for further information and prices. All information in this brochure is the latest available at the time of publication approval. Jayco reserves the right to make changes and to discontinue models without notice or obligation. Photos in this brochure may show optional equipment and props for photography purposes. RVs built for sale in Canada may differ to conform to Canadian codes. ©2015 Jayco, Inc. 15-EAGL-PL 0215-10K Printed in U.S.A.