

# *Flagstaff*

MICRO LITE XLT, MICRO LITE & SHAMROCK



FOREST RIVER PRESENTS

# *Flagstaff*

MICRO LITE XLT, MICRO LITE & SHAMROCK

## MICRO LITE XLT SERIES

The Flagstaff Micro Lite XLT is unlike anything in it's class. It has a long list of std features including a full size regular awning, 13.5 K AC, LED exterior lights, Euro Style Jealousy windows, full size furnace and so much more. All of these features and the XLT is still towable by a small SUV or Mini-van makes this trailer sound like a perfect fit.

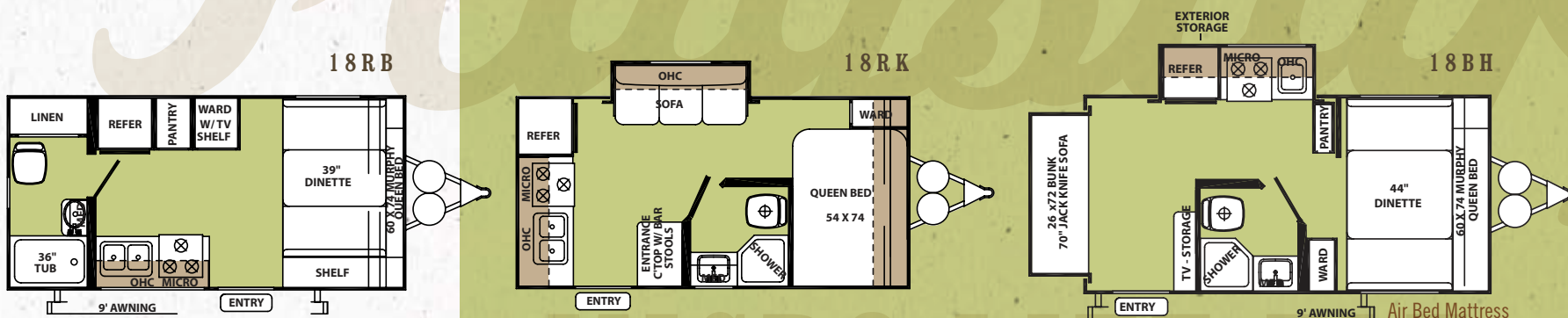

FOREST RIVER PRESENTS

## MICRO LITE XLT SERIES SPECIFICATIONS

MODEL	18RB	18RK	18BH
GVWR (Gross Vehicle Weight Rating)	3648	3786	3858
BASE/DRY UNIT WEIGHT	2611	2773	3136
BASE DRY HITCH WEIGHT	347	286	358
BASE DRY AXLE WEIGHT	1988	2108	2405
CARGO CAPACITY	1000	1000	1058
LENGTH	18' 5"	18' 5"	18' 5"
WIDTH	90"	90"	90"
HEIGHT W/O A/C	105"	105"	105"
INTERIOR HEIGHT	78"	78"	78"
FRESH WATER CAPACITY	37 gal	37 gal	37 gal
GRAY WATER CAPACITY	30 gal	30 gal	30 gal
BLACK WATER CAPACITY	30 gal	30 gal	30 gal

MICRO LITE XLT



Model number of any particular unit does not necessarily reflect the overall length of the unit itself. Dry weight are estimates.

GREEN DECOR WITH TUSCAN CREAM



LIVING AREA | MODEL 18RK

BLUE DECOR WITH CHERRY



# MICRO LITE SERIES

In our light-weight entry trailers, the Flagstaff Micro Lite places a premium on superior craftsmanship. The three-burner range and innerspring heated mattresses and many residential features stand out above other products in its class. If you care about quality and safety in this size trailer, the Micro Lite is the best choice.

FOREST RIVER PRESENTS

# Flagstaff

MICRO LITE

18FBR

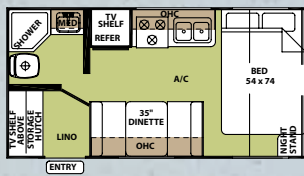

18FBR S

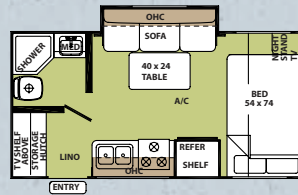

21FB

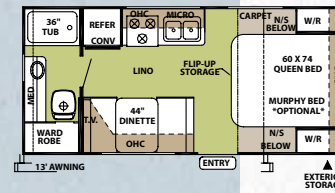

23FB

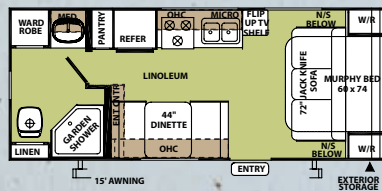

23LB

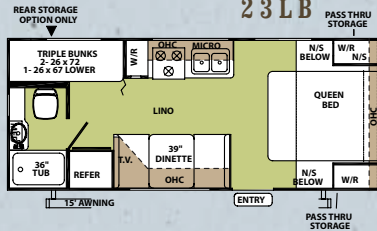

25DS

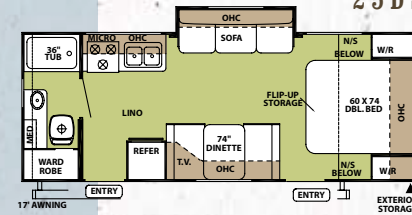

## MICRO LITE SERIES SPECIFICATIONS

MODEL	18FBR	18FBR S	21FB	23FB	23LB	25DS
GVWR (Gross Vehicle Weight Rating)	4229	4300	4634	4761	4670	5756
BASE/DRY UNIT WEIGHT	2958	3029	3052	3139	3291	3885
BASE DRY HITCH WEIGHT	137	263	390	490	270	401
BASE DRY AXLE WEIGHT	2821	2766	2662	2649	3021	3484
CARGO CAPACITY	1233	1233	1233	1233	1233	1833
LENGTH	20' 1"	20' 1"	22'	23' 4"	23' 8"	25' 7"
WIDTH	96"	96"	96"	96"	96"	96"
HEIGHT W/O A/C	105"	105"	112"	112"	112"	112"
INTERIOR HEIGHT	78"	78"	78"	78"	78"	78"
FRESH WATER CAPACITY	37 gal	37 gal	37 gal	37 gal	37 gal	37 gal
GRAY WATER CAPACITY	30 gal	30 gal	30 gal	30 gal	30 gal	30 gal
BLACK WATER CAPACITY	30 gal	30 gal	30 gal	30 gal	30 gal	30 gal

FOREST RIVER PRESENTS



MICRO LITE

# FLAGSTAFF POPULAR STANDARD AND OPTIONAL FEATURES

TUSCAN CREAM DÉCOR OPTION



WOOD-LOOK LINOLEUM  
(ONLY AVAILABLE WITH TUSCAN CREAM DÉCOR)

GREEN



BLUE



CINNAMON



CHERRY DÉCOR OPTION



OAK DÉCOR OPTION  
(N/A XLT)

STANDARD LINOLEUM

A



A. RVQ grill (Opt.)

B

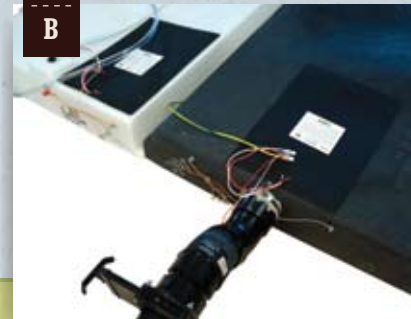

B. Heated holding tanks with 12 volt heat pads. (Opt. N/A on XLT)

C



C. Exterior shower (Std. N/A on XLT)

D



D. Fantastic Fan (Std. Opt)

E



E. Aluminum dinette frame with storage

F



F. Heated Innerspring Mattresses (Std. Opt.)

# FOREST RIVER PRESENTS



A. Power Awning with Adjustable Rain Dump (Opt.)

B. Hardwood Doors & Drawers

C. Aluminum Rims (Opt. but Std. on XLT)

D. Water Filter (Std. Opt.)

E. Outside Speaker (Opt.)



## HIGH QUALITY CONSTRUCTION

A. Flagstaff is one of the strongest light weight trailers on the market because the trailers are vacuum bonded on all six sides. The walls, floors, roof and fronts and backs have been vacuum bonded to make sure your trailer is light weight and built to last.

B. Structurally engineered materials makes our vacuum-bonded walls some of the strongest in the industry.



FOREST RIVER PRESENTS

# Flagstaff

## CONSTRUCTION





A. All Steel "I" beam frame construction  
(Most Models)

B. Glued and screwed cabinetry

C. Power Awning with adjustable rain  
dump (Opt.)



D. ALKO® AXLES AND EASY LUBE HUBS  
· Fully independent wheel suspension.  
· Lower trailer center of gravity for  
improved stability.  
· No metal to metal contact and no springs,  
shackles, hangers, or U-bolts to break or  
wear out.



E. Large dinette storage drawers with full  
extension drawer guides

F. Full extension metal drawer guides in  
the kitchen

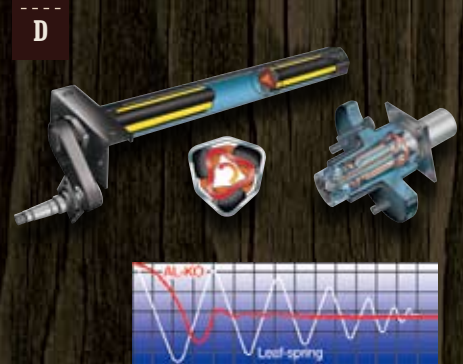

CINNAMON DECOR WITH TUSCAN CREAM



LIVING AREA | MODEL 233S

## SHAMROCK SERIES

Summer days or rainy nights have little affect on the interior thanks to the fully vacuum bonded exterior. Flagstaff Shamrock is proud to be the only fully vacuum bonded expandable with a full vacuum bonded radius roof.

When you're on vacation, sleeping comfortably should be a given. So we added heated innerspring mattress keep you warm on chilly nights. Take advantage of the bunk light fan to read a couple chapters before bed and circulate the air while you sleep. If comfort is important to you, consider the Flagstaff Shamrock. It's the best in it's class.

FOREST RIVER PRESENTS

# Flagstaff

## SHAMROCK

A. Exterior RVQ grill (Opt.)

C. Fantastic Fan (Std. Opt)

F. Outside speaker

G. Bunk Cables (Std.)

I. Aluminum Rims (Std. on XLT,

B. Heated Innerspring  
Mattresses (Std. Opt.)

D. Exterior shower (Std. N/A XLT)  
E. Bunk Light Fan (Std.)

(Std. on XLT, C.P. on Shamrock  
& Micro Lite)

(No poles needed)  
H. Water Filter (Std. Opt.)

Opt. on Shamrock and Micro Lite)



A. Power awning with adjustable rain dump (Opt.)



B. Aluminum dinette frame with storage



C1. Vacuum bonded radius roof



C2. Radius roof foam with built in A/C ducts (N/A XLT and models w/o ducted air)



D. Vacuumed bonded floor with 16" on center floor joists (Shamrock only)

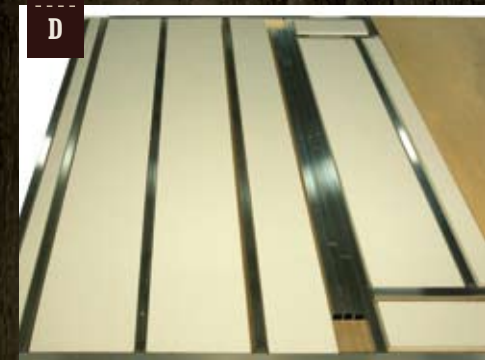

## SHAMROCK SERIES SPECIFICATIONS

MODEL	17	183	183L	19	19L	21SS	21SSL	21BH	233	233S	23SS	21RS	23RS
GVWR (Gross Vehicle Weight Rating)	3852	4638	7262	4639	7216	5626	7335	4753	5504	5964	6322	5273	6061
BASE/DRY UNIT WEIGHT	2789	3202	3946	3170	3602	3972	4783	3189	3633	4093	4108	3659	3847
BASE DRY HITCH WEIGHT	352	238	300	239	298	645	335	413	433	565	509	594	625
BASE DRY AXLE WEIGHT	2437	2964	3646	2931	3602	3327	4448	2776	3200	3528	3599	3065	3222
CARGO CAPACITY	1025	1233	2900	1233	2900	1233	2224	1233	1833	1833	1833	1233	1833
LENGTH	18'11"	20'9"	31'1"	20'9"	31'	21'6"	32'	22'	23'9"	23'9"	24'6"	21'8"	23'9"
TRAILER LENGTH (OPEN)	22'11"	24'9"	33'5"	24'9"	33'5"	25'6"	35'6"	22'6"	27'9"	27'9"	28'6"	25'2"	27'3"
WIDTH	96"	96"	96"	96"	96"	96"	96"	96"	96"	96"	96"	96"	96"
HEIGHT W/O A/C	112"	112"	112"	112"	112"	112"	118"	112"	112"	112"	112"	112"	112"
INTERIOR HEIGHT	78"	78"	78"	78"	78"	78"	78"	78"	78"	78"	78"	78"	78"
FRESH WATER CAPACITY	37 gal	37 gal	37 gal	37 gal	37 gal	37 gal	37 gal	37 gal	37 gal	37 gal	37 gal	37 gal	37 gal
GRAY WATER CAPACITY	30 gal	30 gal	30 gal	30 gal	30 gal	30 gal	30 gal	30 gal	30 gal	30 gal	30 gal	30 gal	30 gal
BLACK WATER CAPACITY	30 gal	30 gal	30 gal	30 gal	30 gal	30 gal	30 gal	30 gal	30 gal	30 gal	30 gal	30 gal	30 gal

Model number of any particular unit does not necessarily reflect the overall length of the unit itself. Dry weight are estimates.

## SHAMROCK SERIES FLOORPLANS

17

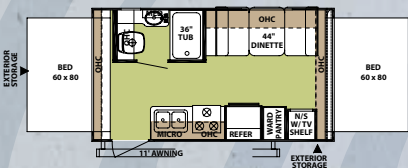

19

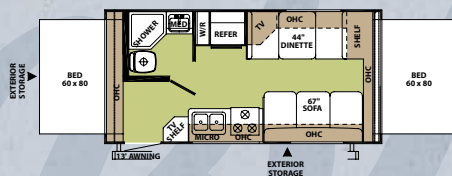

19L

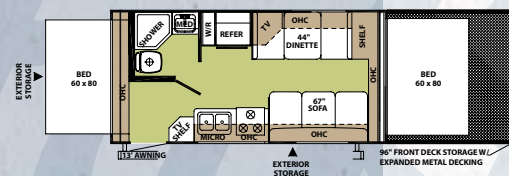

21BH

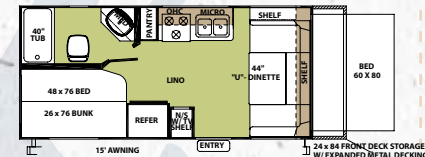

21RS

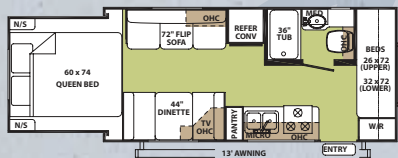

21SS

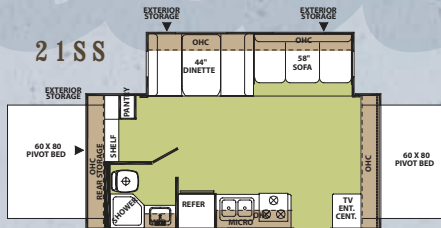

21SSL

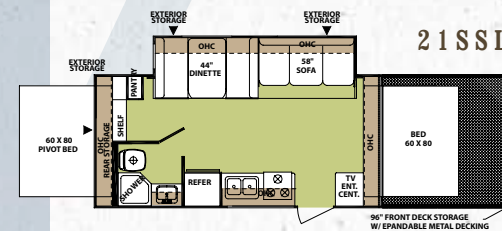

23RS

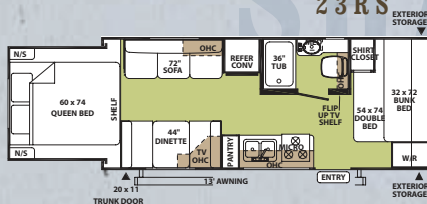

23SS

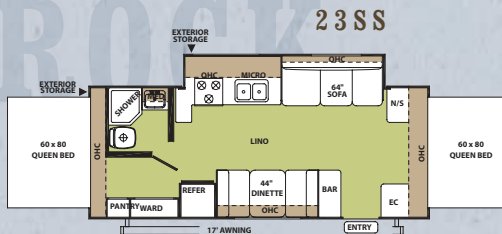

183

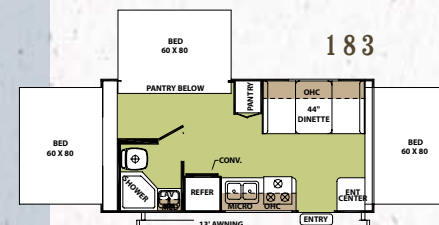

183L

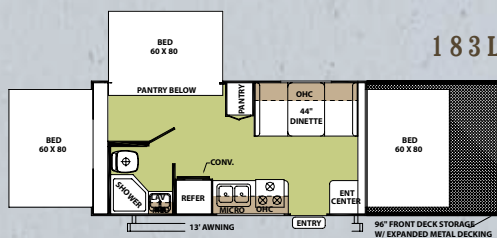

233

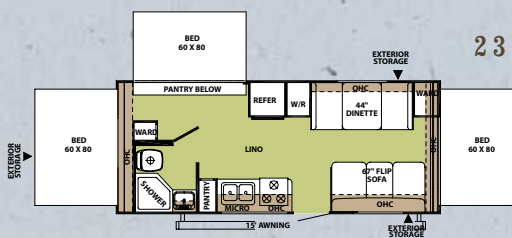

233S

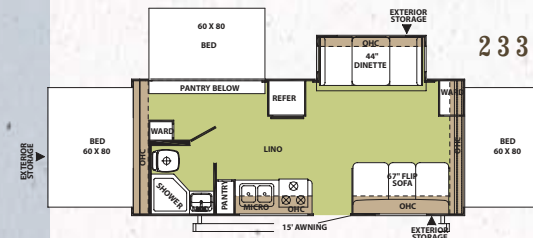

Standards and options are subject to change

## FLAGSTAFF MICRO LITE XLT, MICRO LITE AND SHAMROCK STANDARDS & OPTIONS

MODELS	XLT	ML	S
· Fully Laminated Aluminum Frame (Floor, Sidewall, & Roof)	S	S	S
· Insulation Factors R-7 Side Wall, R-12 Floors and R-14 Ceiling	--	S	S
· R-7 Sidewalls and Ceiling, R-12 Floors	S	--	--
· Easy Lube Axles	S	S	S
· Foot Flush Toilets	S	S	S
· Aluminum Bed and Dinette Frames	S	S	S
· Laminated Filon Fiberglass Sidewalls	S	S	S
· Screwed and Glued Cabinetry	S	S	S
· Vinyl Roof	--	S	S
· Fiberglass Roof	S	--	--
· Torsion Axle, Rubber-Ryde Suspension	S	S	S
· Electric Slide-Out (where available)	S	S	S
· Ducted Furnace	S	S	S
· Solid Wood Raised Panel Doors and Drawers	S	S	S
· Digital AM/FM/CD/DVD w/ Remote	S	S	S

MODELS	XLT	ML	S
· Residential One-Piece Sink Cover/ Cutting Board	S	S	S
· Monitor Panel	S	S	S
· Tub Surround	S	S	S
· Three Burner High Output Gas Range	S	S	S
· Six Gallon "Quick Recovery" Water Heater	S	S	S
· Water Heater By-Pass Kit	S	S	S
· Outside Shower	--	S	S
· Phone Jack	S	S	S
· Two-20 Lb Gas Bottles	S	S	S
· Molded Bottle Cover	S	S	S
· Bathroom Skylight	S	S	S
· 55 Amp Converter With Charger	S	S	S
· Auto Gas/Electric Refrigerator	S	S	S
· Stabilizer Jacks	S	S	S
· Residential Drawer Guides	S	S	S
· Directional Reading Lights on Sofa Slides	S	S	S

MODELS	XLT	ML	S
· Create-A-Breeze Three Speed			
· Fantastic Vent	SO	SO	SO
· <b>Extra</b> Create-a-Breeze Fan (N/A on 17, 19, 232 Shamrocks and 25DS Micro Lite only)	--	0	0
· Heated Mattress (N/A 18BH)	SO	SO	SO
· Water-Pur Filtration System	SO	SO	SO
· 13,500 BTU Ducted Air (25DS only)	--	CP	CP
· 13,500 Air (N/A Micro Lite 25DS, Shamrock models 183, 183L, 19L, 19 and 17)	S	CP	CP
· Microwave	S	CP	CP
· Gas Oven	S	0	0
· Awning	S	CP	CP
· Power Awning with Rain Dump (N/A 17, 21RS & 23RS Shamrock)	0	0	0
· Outside Gas Grill and Worktable	0	0	0
· 110 DSI Gas/Electric Water	--	0	CP
· Raised Refrigerator Panels	--	0	0

XLT = MICRO LITE XLT, ML = MICRO LITE, S = SHAMROCK

S = STANDARD

0 = OPTIONAL

CP = CONVENIENCE PACKAGE

SO = STANDARD OPTION

-- NOT AVAILABLE

# FOREST RIVER PRESENTS

Standards and options are subject to change

## FLAGSTAFF MICRO LITE XLT, MICRO LITE AND SHAMROCK STANDARDS & OPTIONS

MODELS	XLT	ML	S
· Tuscan Cream Raised Refer Fronts	--	0	0
· Electronically Controlled Heated Holding Tanks	--	0	0
· Spare Tire Carrier & Cover	S	CP	0
· Aluminum Wheels	S	0	0
· Slide Out Toppers	--	--	0
· Stainless Steel Appliances	--	0	0
· CSA	0	0	0
· Outside Speakers	S	CP	CP
· Tinted Safety Glass	--	CP	CP
· Euro-Styled Jealousy Window with Built in Sun Shade	S	--	--
· LED Exterior Lights	S	--	--
· 15" LCD TV	0	CP	0
· Tire Pressure Monitoring System	--	0	0
· Carbon Monoxide Detector	SO	SO	SO
· Murphy Bed Option (21FB Micro Lite only, Std. 18RB & 18BH, 23FB)	S	0	--

MODELS	XLT	ML	S
· Radius Roofs	--	S	S
· Automotive Radial Tires	S	S	S
· Radius Corner Windows and Doors	S	S	S
· Decorative Frame Skirting	--	--	S
· Industrial Lockable Bed Latches	--	--	S
· Bed Cable System (No Poles)	--	--	S
· 14" Tires with Double Step	--	0	S
· Decorative Valances	--	S	S
· Bunk Fan/Light Combination with Each Bed	--	--	S
· Large Dinette Picture Window	S	S	S
· Indoor/Outdoor Table	S	S	S
· Sliding Front Storage Tray (Where Available)	--	--	0
· Power Jack	--	--	0
· Storm Windows	--	0	0
· Chrome-look Wheel Covers	--	0	0
· TV Antenna w/ Cable & Satellite Hook-Up	S	S	CP



XLT = MICRO LITE XLT, ML = MICRO LITE, S = SHAMROCK

S = STANDARD

0 = OPTIONAL

CP = CONVENIENCE PACKAGE

SO = STANDARD OPTION

-- NOT AVAILABLE



## PEACE OF MIND.

Forest River has yet another exclusive feature to offer: One year of free roadside assistance will be given to every 2010 Flagstaff customer. This is just one more way to say "Thank you" and to ensure an enjoyable traveling experience.



## *Forest River's Hallmark of Excellence* PRE-DELIVERY INSPECTION FACILITIES

Brought online in 2005, Forest River is proud of its state-of-the-art test facility. This beautiful building blends many of the old tried and true methods of testing our diverse types of RVs with new innovative ways of solving quality issues. Being centrally located to most Forest River manufacturing facilities, this 20,000 square foot PDI (Pre-delivery Inspection) test building gives immediate daily feedback to individual managers. This assures the production facilities that nothing has slipped by the plant's quality assurance personnel and the units are "green" and ready to ship.

## YOUR FLAGSTAFF DEALER

For details on Flagstaff's complete warranty program, see your Flagstaff dealer. When it comes to backing products with the same quality and commitment it has when it begins the manufacturing process, the only name you have to remember when you're looking for a recreational vehicle is Flagstaff. Flagstaff offers the following additional limited warranties to the original purchasers. Consult written warranty for details.

1. Twelve-year vinyl roof warranty, 2. Two-year fiberglass warranty, 3. Five-year axle warranty, 4. Five-year tent warranty, 5. One-year bumper to bumper warranty, 6. Available second-year warranty

All specifications contained herein are based on the latest product information at time of printing. Forest River reserves the right to make changes in colors, materials, equipment and specifications at any time Without notice and assumes no responsibility for any errors in this brochure.



Forest River, Inc. 55470 C.R. 1 Elkhart, IN 46515 574.389.4600 [www.forestriverinc.com](http://www.forestriverinc.com)  
[www.forestriveraccessories.com](http://www.forestriveraccessories.com) LITHO U.S.A FOR 0735