

BULLET

BULLET / CROSSFIRE TRAVEL TRAILERS

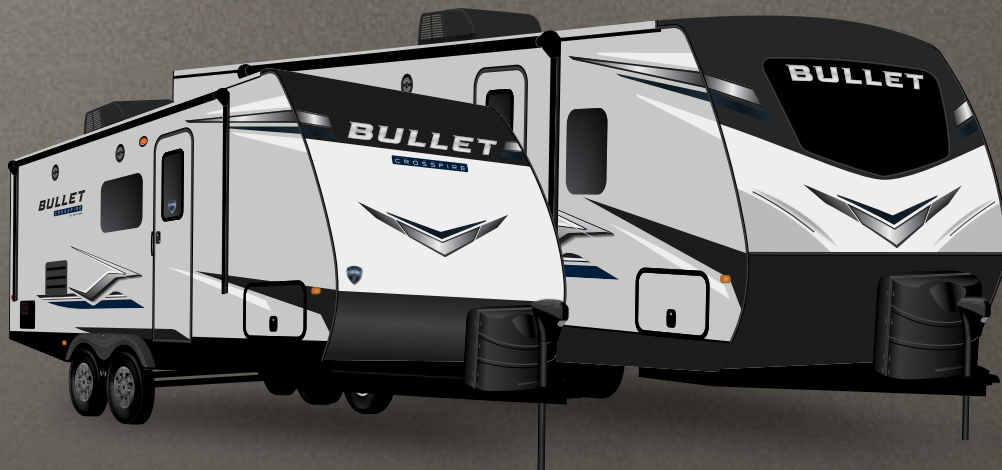

KEYSTONE
RV COMPANY

CAMP BETTER
KINDNESS · COMMUNITY · PLANET

KEYSTONE OWNER'S SUPPORT

Keystone makes operating and maintaining your new RV easy with world-class resources and support. Owners have access to a wide variety of support tools and services via the MyKeystone mobile app and the Owner's section of KeystonerRV.com.

FIRST TIME CAMPER'S VIDEO SERIES

A comprehensive guide to RV camping basics with Keystone's Matt & Bart.

PRO TIPS DIY OPERATION & MAINTENANCE VIDEO LIBRARY

Visit our growing collection of step-by-step video and written guides to operating, maintaining, and repairing your Keystone RV.

DIGITAL OWNER'S MANUAL

Our new online owner's manual is fully searchable and features helpful visual and video support.

DIY REPAIR PROGRAM*

Which includes free parts for small repairs within your first year of ownership

1-YEAR LIMITED BASE WARRANTY*

3-YEAR LIMITED STRUCTURAL WARRANTY*

*See KeystoneRV.com for full details. PRO TIP: Owners should work with their dealers or other Keystone authorized service center or mobile tech to document all warranty claims within the warranty period.

BULLET SPECIFICATIONS

*Estimated Weights And Lengths Listed, Visit Keystonerv.com For Full Specifications

MODEL	WEIGHT	CARRYING CAPACITY	HITCH WEIGHT	FRESH WATER**	WASTE WATER	GRAY WATER	LPG	LENGTH*	WIDTH	HEIGHT	AWNING
1700BH	3485	1340	425	37	30	30	20	21' 5"	8'	10' 5"	11'
1900RD	3510	1310	420	37	30	30	20	21' 11"	8'	10' 5"	11'
1890RB/WE	4883	2465	615	37	30	30	40	23' 1"	8'	10' 8"	10'
2200BH/WE	4794	2332	535	37	30	30	40	25' 10"	8'	10' 8"	15'
2210BH/WE	5330	2241	625	37	30	60	40	26' 4"	8'	10' 8"	15'
2220ML/WE	5590	2549	700	54	38	38	40	27' 4"	8'	10' 8"	19'
2290BH	5155	1845	720	54	38	38	40	26' 9"	8'	10' 8"	15'
2530RD/WE	5709	1940	835	54	38	60	40	29' 10"	8'	10' 8"	21'
2680BH	6170	2125	700	54	38	76	40	30' 10"	8'	10' 8"	19'
2870QB/WE	6166	2100	750	54	38	76	40	33' 3"	8'	10' 8"	21'
260RBS	6226	1374	725	54	38	76	40	30' 6"	8'	10' 8"	21'
265FKS	7085	1415	1205	54	38	76	40	30' 3"	8'	11' 3"	19'
287RLS	7110	2150	860	54	38	76	40	33' 0"	8'	11' 2"	10'/10'
290BHS	6380	1220	705	54	30	60	40	33' 6"	8'	10' 8"	21'
310RES	7945	1255	920	54	38	76	40	36' 0"	8'	11' 2"	11'/11'
330BKQ	7995	1805	1165	54	76	76	40	37' 11"	8'	11' 4"	21'

SOLARTM FLEX



NEW 2024 PACKAGE UPDATES

For more information scan the QR code
or visit keystonerv.com.

TAKE *CHARGE* OF HOW YOU CAMP

EXCEPTIONAL QUALITY, IMPOSSIBLY VERSATILE, SolarFlexTM
IS SHATTERING CUSTOMER'S EXPECTATIONS OF FACTORY-INSTALLED SOLAR POWER.
EXCLUSIVELY AVAILABLE ON ALL KEYSTONE RV MODELS.



Keystone RV is proud to partner with Dragonfly Energy to offer their legendary heated Lithium-ion batteries exclusively on all Keystone models.



FOLLOW US FOR THE LATEST!



DISCLAIMER: Product information is as accurate as possible as of the date of publication of this brochure. All features, floor plans, and specifications in this brochure are subject to change without notice. Please also consult Keystone's web site at www.keystonerv.com for more current product information and specifications. Tow Vehicle Disclaimer. CAUTION: Owners of Keystone recreational vehicles are solely responsible for the selection and proper use of tow vehicles. All customers should consult with a motor vehicle manufacturer or their dealer concerning the purchase and use of suitable tow vehicles for Keystone products. Keystone disclaims any liability or damages suffered as a result of the selection, operation, use or misuse of a tow vehicle. KEYSTONE'S LIMITED WARRANTY DOES NOT COVER DAMAGE TO THE RECREATIONAL VEHICLE OR THE TOW VEHICLE AS A RESULT OF THE SELECTION, OPERATION, USE OR MISUSE OF THE TOW VEHICLE. *Length is defined as the distance from the centerline of hitch pin/coupler to rear bumper of trailer. ** Fresh water capacity includes water heater. Please review owner's manual prior to purchase for more information on service warranties, extended use, towing and maintenance. Owner's manuals can be found at keystonerv.com.

PRINT 09.2023

ULTRA-LIGHTWEIGHT CAMPING IN STYLE

Discover a new era of RVing with Bullet and Bullet Crossfire Ultra-Lite travel trailers—your gateway to towing confidence, unparalleled style, and versatility. Explore a world where towing becomes effortless, where sleek design merges seamlessly with functionality, and where your journey is only limited by your imagination. Bullet's main product line offers distinctive bunkhouses and couples coaches with more features and amenities. Bullet Crossfire includes smaller, single- and dual-axle models designed with comfort and affordability in mind.

Your path to unforgettable adventures starts here, with RVs that not only reflect your style but enhance every moment of your travel.

ALL BULLET & CROSSFIRE STANDARD FEATURES

*N/A ON SINGLE AXLE FLOORPLANS (1700BH & 1900RD)

- NEW Goodyear™ Endurance Tires*
- NEW Dexter® TORFLEX® Rubber Torsion Suspension Axles*
- NEW AlphaPly™ TPO Roof Membrane W/Lifetime Warranty
- Fully E-Coated, High Strength - Low Alloy, USA Built, Steel Chassis By Norco™ (EASTERN FLOORPLANS ONLY)
- Hyperdeck™ High-Performance, Water-Resistant Floors
- Giggy Box 12V Distribution Center w/ Battery Disconnect*
- Power Stabilizer Jacks, Tongue Jack*
- NEW Lights for Stabilizer Jack & Termination Valve Locations
- Power Awnings w/ LED lighting
- Fully Walkable Roof & Rear Ladder*
- NEW Motion Lights On Pass Through Storage, Entrance To Coach
- LIPPERT Solid Step® Entry Steps*
- Universal Exterior Docking Station (SELECT MODELS)
- NEW 1-1/4" Rear Bumper Accessory Hitch* (150 lbs max)
- 30,000 BTU Heated & Enclosed Underbelly for Extended Season Camping*
- Girard™ Tankless On-Demand Water Heater
- NEW Furrion® 15K BTU Chill HE Air Conditioner w/ 30° Delta T & Alternating Dual Fan
- NEW Furrion® Kitchen Appliances*
- NEW Airfryer Microwave*
- NEW 12V Refrigerator (STANDARD)
- Continuous Edge Countertops*
- Stainless Steel Farmhouse Sink*
- NEW Do-More Portable Dinette (MOST FLOORPLANS)
- 12V SMART TVs w/ Built-In Bluetooth Sound Bar & Radio
- Winegard™ Air 360+ Omnidirectional Antenna w/Wi-Fi & 4G LTE
- Pillow-Side Shelving To Accommodate 2 Cpap Machines*
- New SolarFlex™ Protect 220 Solar Power System w/ 30amp Victron Charge Controller*
- New Optional SolarFlex™ Discover 440i w/ 2000 Watt Inverter* 1-Year Limited Base Warranty & 3-Year Limited Structural Warranty (SEE KEYSTONERV.COM FOR DETAILS)

BULLET EXCLUSIVE FEATURES

- NEW High-Impact Thermoset Resin Front Cap
- NEW Slam Latch Baggage Doors
- Domed Interior Ceilings
- Aluminum Rims
- Pass-Through Peg Board Storage Panel
- NEW Dinette Storage w/ Portable Bins
- NEW Decorative Wood Accent above Dinette w/ Lights
- NEW Decorative Wood Accent above Island w/ Pendant Lights
- NEW Blackout Roller Shades
- NEW King Bed Slide (TWO MODELS)
- Residential, 60" x 80" Queen-Sized Bed
- Convertible Cabinets w/ Hanging Rods & Adjustable Shelves (SELECT MODELS)

BULLET CROSSFIRE EXCLUSIVE FEATURES

*N/A ON SINGLE AXLE FLOORPLANS (1700BH & 1900RD)

- NEW Front-End Metal Skin w/ New Upgraded Graphics
- NEW Exterior Trim Kit*
- NEW Queen-Sized Bed*
- NEW 30,000 BTU Heated & Enclosed Underbelly for Extended Season Camping*
- NEW Seamless Surface Countertops*
- NEW Cabinet Doors in Dinette*
- NEW Rear Ladder Prep*

CROSSFIRE SINGLE-AXLE TRAVEL TRAILERS

*Estimated Weights And Lengths Listed, Visit Keystonerv.com For Full Specifications

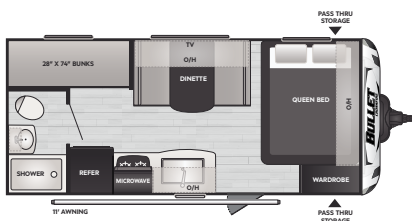

1700BH | WEIGHT **3485** | LENGTH **21' 5"**

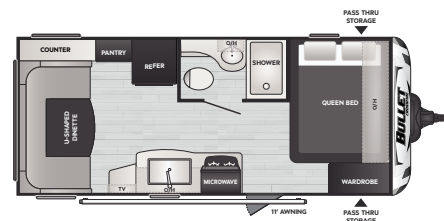

1900RD | WEIGHT **3510** | LENGTH **21' 11"**

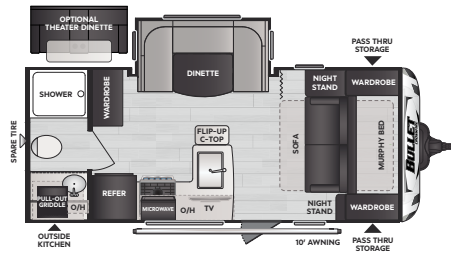

1890RB/WE | WEIGHT 4825 | LENGTH 23' 1"

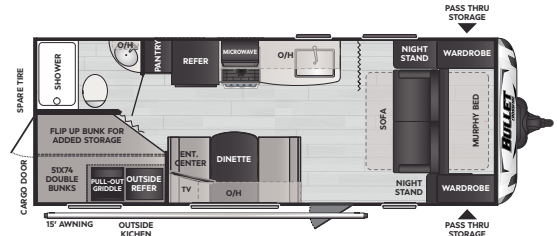

2200BH/WE | WEIGHT 4794 | LENGTH 25' 10"

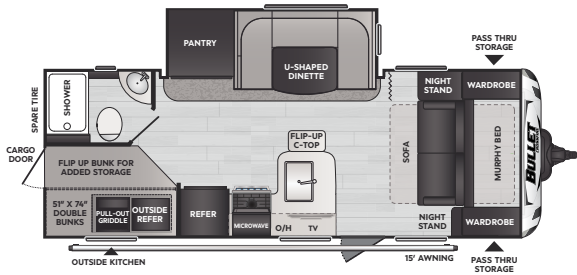

2210BH/WE | WEIGHT 5330 | LENGTH 26' 4"

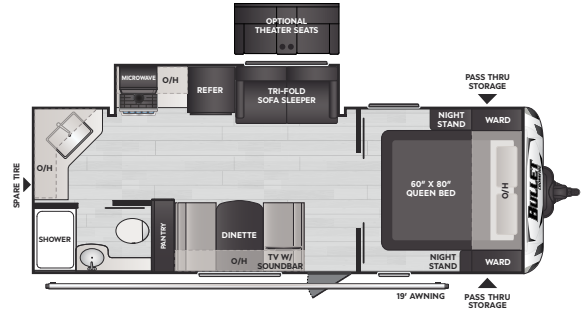

2220ML/WE | WEIGHT 5590 | LENGTH 27' 4"

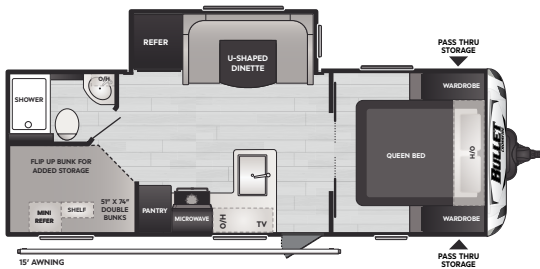

2290BH | WEIGHT 5155 | LENGTH 26' 9"

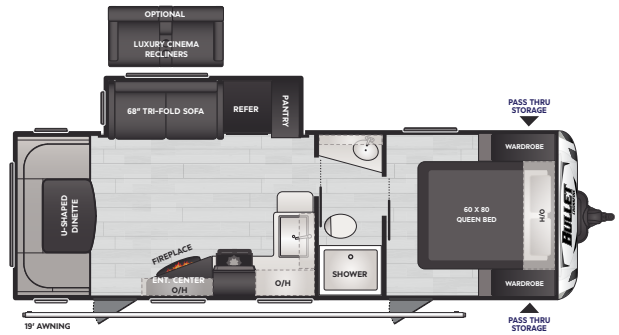

2530RD/WE | WEIGHT 5709 | LENGTH 29' 10"

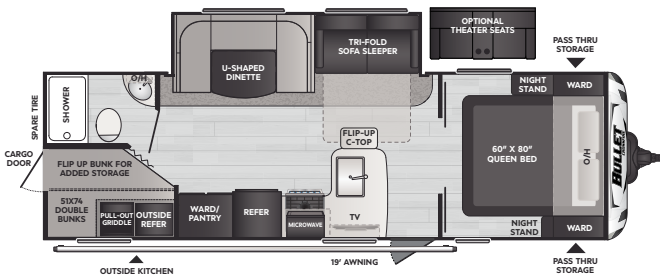

2680BH | WEIGHT 6170 | LENGTH 30' 10"

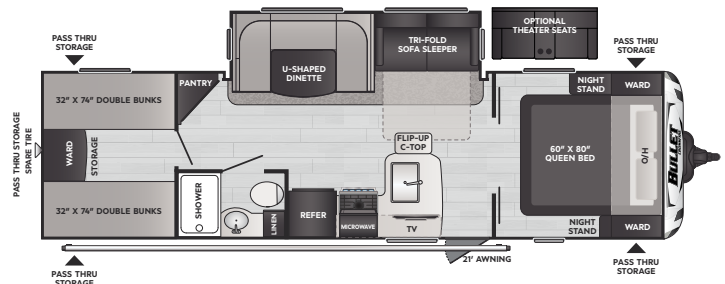

2870QB/WE | WEIGHT 6166 | LENGTH 33' 3"

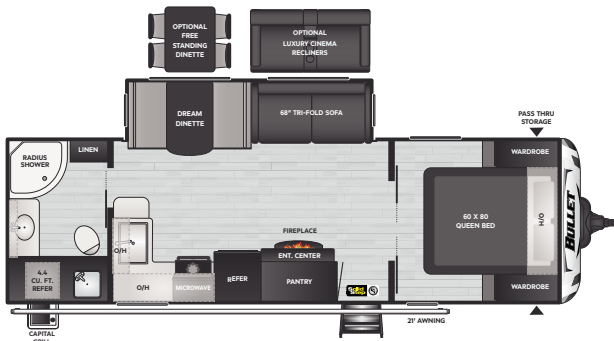

260RBS/WE | WEIGHT **6266** | LENGTH **30' 6"**

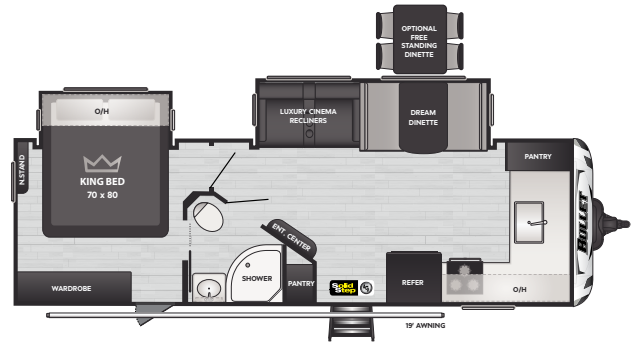

265FKS | WEIGHT **7085** | LENGTH **30' 3"**

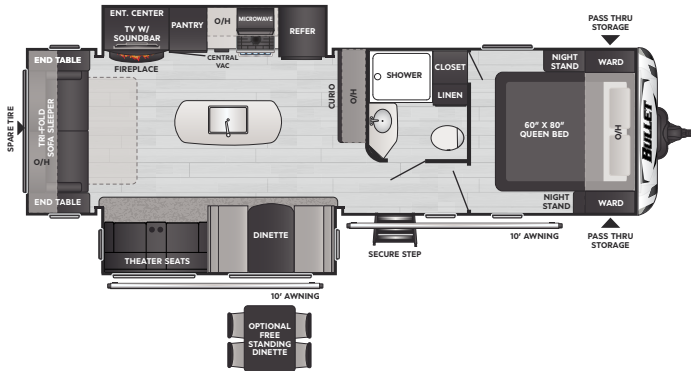

287RLS | WEIGHT **7110** | LENGTH **33' 0"**

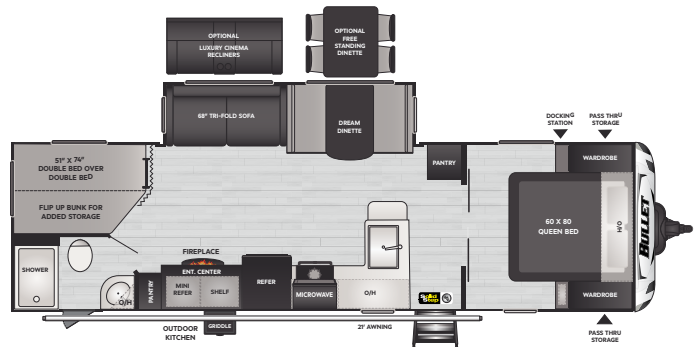

290BHS/WE | WEIGHT **6380** | LENGTH **33' 6"**

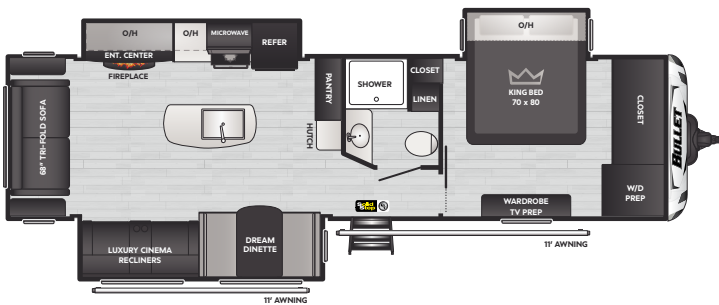

310RES | WEIGHT **7945** | LENGTH **36' 0"**

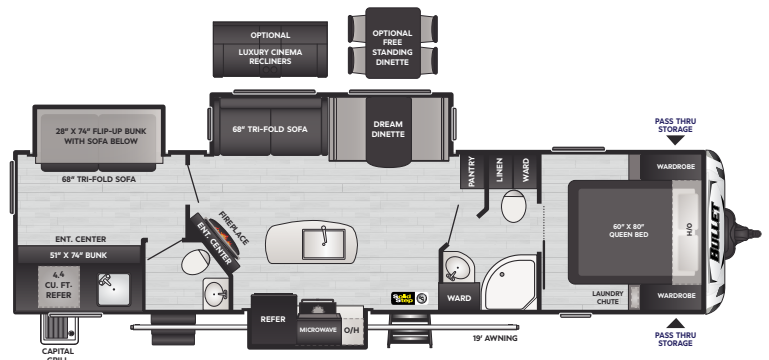

330BKQ | WEIGHT **7995** | LENGTH **37' 11"**



The Bullet 290BHS is the perfect travel trailer for our little family. We have plenty of space to store everything we need for our trips and cabinet space to spare. The separate entrance into the bathroom is what we love the most; less trekking through the camper just for a trip to the bathroom. We love having our own room, and our son looks forward to sleeping in his bunk bed every time we camp. After three years, and over 30 camping trips, we're still sure we made the right choice.

 @CAMPINERINX — BULLET 290BHS OWNERS