

BULLET

CROSSFIRE, BULLET & PREMIER TRAVEL TRAILERS



KEYSTONE
RV COMPANY

CAMP BETTER

2023 BULLET | EXCEPTIONAL FEATURES

- NORCO FRAME, SPECIFICALLY ENGINEERED FOR EACH FLOORPLAN
- WALKABLE ROOF & REAR LADDER*
- REAR LADDER PREP (CROSSFIRE ONLY)
- HYPERDECK™ WATER-RESISTANT FLOORING
- HEATED AND ENCLOSED UNDERBELLY FOR EXTENDED SEASON CAMPING
- LCI SOLID STEP*
- POWER STABILIZER JACKS, TONGUE JACK, AND AWNINGS
- GIGGY BOX 12V DISTRIBUTION CENTER FOR ADDED ORGANIZATION AND PROTECTION
- EXTERIOR DOCKING STATION*
- 51 CU. FT. PASS-THROUGH STORAGE WITH PEG BOARD STORAGE PANEL*
- DOMED CEILINGS*
- **NEW GIRARD TANKLESS WATER HEATER**
- DREAM DINETTE™ (SELECT MODELS)*
- STAINLESS STEEL FARMHOUSE STYLE SINK
- CONVERTIBLE CABINETS
- RESIDENTIAL, 60" X 80" QUEEN-SIZED BED*
- PILLOW-SIDE SHELVING, DESIGNED FOR CPAP MACHINES
- LAUNDRY CHUTE
- SOLARFLEX 200 AND 400I SOLAR POWER PACKAGES W/OPTIONAL DRAGONFLY ENERGY LITHIUM-ION BATTERIES
- FULL MOLDED FIBERGLASS FRONT CAP (PREMIER MODELS ONLY)
- SOLID SURFACE COUNTERTOPS (PREMIER ONLY)

*N/A ON CROSSFIRE MODELS

MODEL	WEIGHT	CARRYING CAPACITY	HITCH WEIGHT	FRESH WATER**	WASTE WATER	GRAY WATER	LPG	LENGTH*	WIDTH	HEIGHT	AWNING
250BHS	5607	1793	715	54	30	60	40	29' 5"	8'	10' 8"	19'
253RDS	TBD	TBD	TBD	54	30	60	40	29' 10"	8'	10' 8"	21'
258RKS	5696	1904	650	54	30	60	40	29' 9"	8'	10' 8"	19'
260RBS	5945	1655	660	54	30	60	40	30' 6"	8'	10' 8"	19'
287QBS	6201	1399	735	54	30	30	40	33' 8"	8'	10' 9"	15'
290BHS	6189	1411	705	54	30	60	40	33' 6"	8'	10' 8"	21'
312BHS	6795	1805	785	54	30	60	40	35' 9"	8'	10' 11"	21'
330BHS	7501	1099	800	54	60	30	40	37' 6"	8'	10' 11"	19'
331BHS	7127	2073	790	54	30	30	40	37' 6"	8'	10' 11"	21'
1700BH	3694	1006	375	54	30	30	40	21' 4"	8'	10' 4"	11'
1800RB	3657	743	480	54	30	30	40	21' 4"	8'	10' 5"	11'
1850RB	4175	525	430	54	30	30	40	22' 4"	8'	10' 10"	11'
1900RD	3760	940	490	54	30	30	40	21' 11"	8'	10' 5"	11'
2200BH	4487	1813	425	54	30	30	40	25' 4"	8'	10' 4"	15'
2290BH	TBD	TBD	TBD	54	30	30	40	27' 0"	8'	10' 8"	15'
2500RK	5630	1870	660	54	30	60	40	29' 11"	8'	10' 8"	19'
2730BH	5544	2056	630	54	30	30	40	31' 2"	8'	10' 8"	15'
19FBPR	4713	1787	480	54	30	30	40	24' 0"	8'	11' 0"	12'
23RBPR	5554	1446	655	54	30	60	40	27' 5"	8'	11' 0"	15'
25FKPR	6535	1065	725	54	30	60	40	30' 10"	8'	11' 0"	21'
25RKPR	6165	1435	795	54	30	60	40	29' 11"	8'	11' 0"	19'
26RBPR	6560	940	755	54	30	60	40	31' 10"	8'	11' 0"	21'
29RKPR	6890	1000	890	54	30	60	40	34' 3"	8'	11' 1"	21'
30RIPR	7241	959	865	54	30	60	40	35' 9"	8'	11' 2"	21'
31REPR	TBD	TBD	TBD	54	TBD	TBD	TBD	TBD	TBD	TBD	TBD
33BKPR	8185	1615	1050	54	60	60	40	37' 11"	8'	11' 4"	21'

**EFFECTIVE W/ MODELS BUILT ON 10/1/22 AND LATER



BULLET 287QBS



BULLET 312BHS



PREMIER 25RKPR



"I knew that I wanted a fiber-glass camper shell, no slides, a large picture window, a full kitchen, a full bathroom, a separate bedroom, and tons of storage - all in an RV under 22 feet. Keystone RV delivered. My floorplan has a murphy bed and that created the feel of a separate sleeping space while having the bed completely out of sight during the daytime. As for storage? I currently have a 4-person hot tub in the basement storage of my travel trailer!"



@ALEXISCHATEAU_ — BULLET CROSSFIRE 1800RB OWNERS



"I choose Keystone RV for the workmanship and the pride they take in their products. I choose my Keystone Premier 22RBPR because the layout fits my lifestyle perfectly. Normally I travel on my own and it's the perfect amount of space for me, and if my fiancé Ali comes there's enough space for the two of us and even our dog Piper. We love our Keystone Premier!"



@KYLE_PEPPERZ — BULLET PREMIER 22RBPR OWNER

VISIT OUR WEBSITE FOR PHOTOS,
360° TOURS, AND FULL PRODUCT DETAILS



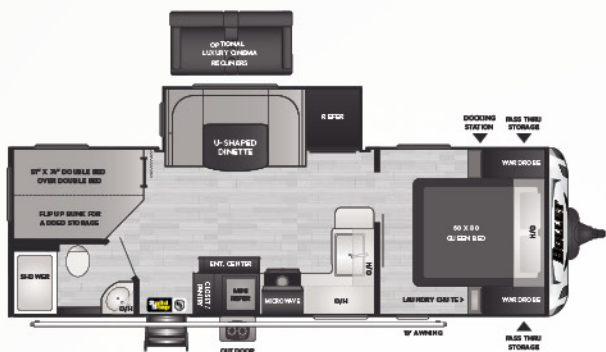

250BHS | WEIGHT 5607 | LENGTH 29' 5"

• DOUBLE BUNKS, DINETTE SLIDE, OUTSIDE KITCHEN



NEW! 253RDS | WEIGHT TBD | LENGTH 29' 10"

• PASS THROUGH BATH, REAR BOOTH DINETTE

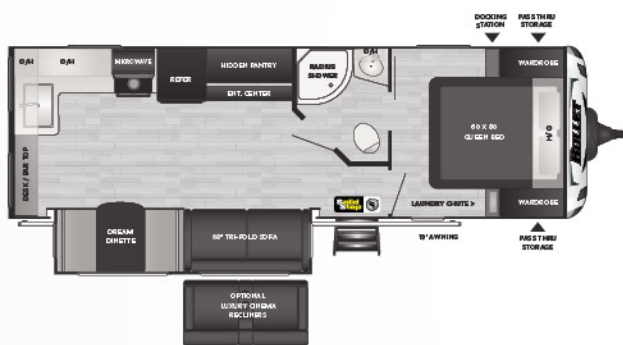

258RKS | WEIGHT 5696 | LENGTH 29' 9"

• REAR KITCHEN, SUPER SLIDE, HIDDEN PANTRY

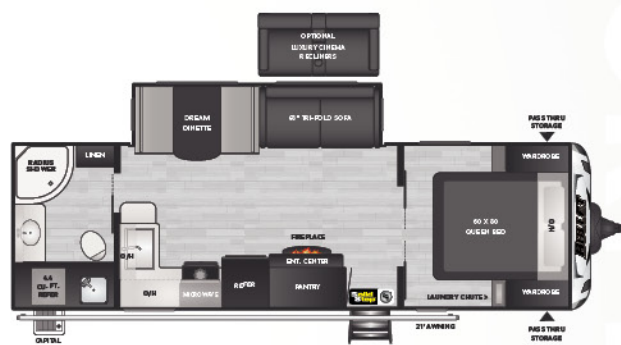

NEW! 260RBS | WEIGHT 5945 | LENGTH 30' 6"

• REAR BATH, OUTSIDE KITCHEN

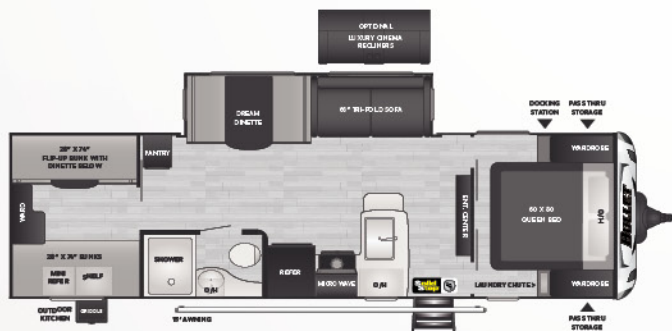

287QBS | WEIGHT 6201 | LENGTH 33' 8"

• QUAD BUNK ROOM, SUPER SLIDE, OUTSIDE KITCHEN

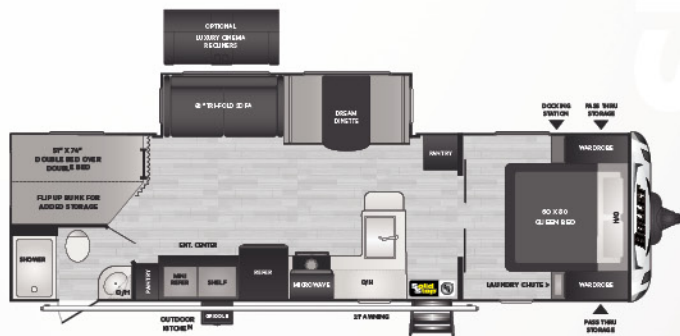

290BHS | WEIGHT 6189 | LENGTH 33' 6"

• DOUBLE BUNKS, SUPER SLIDE, OUTSIDE KITCHEN

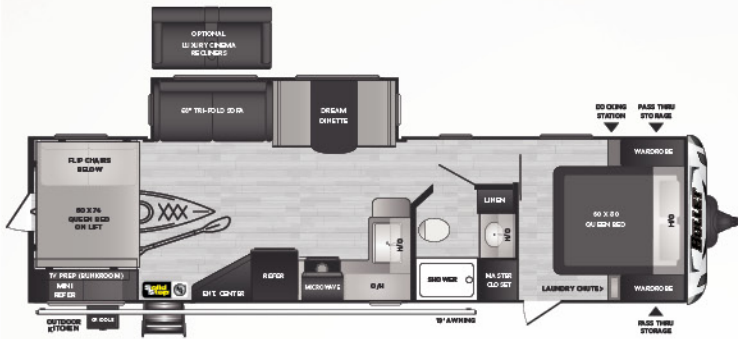

312BHS | WEIGHT 6795 | LENGTH 35' 9"

▪ BUNK LIFT W/ KIDS LOUNGE AREA, SUPER SLIDE, OUTSIDE KITCHEN

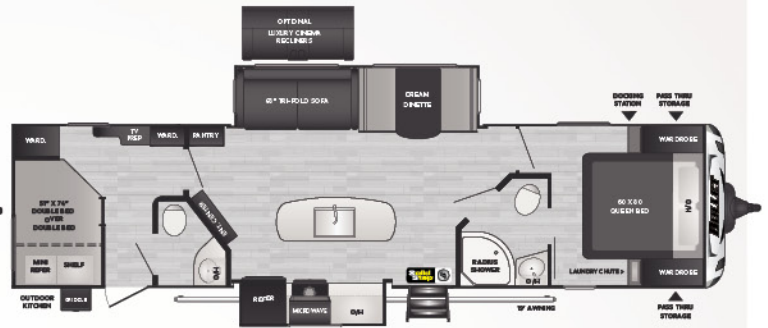

330BHS | WEIGHT 7501 | LENGTH 37' 6"

▪ DOUBLE BUNKS, 1 1/2 BATHS, ISLAND KITCHEN

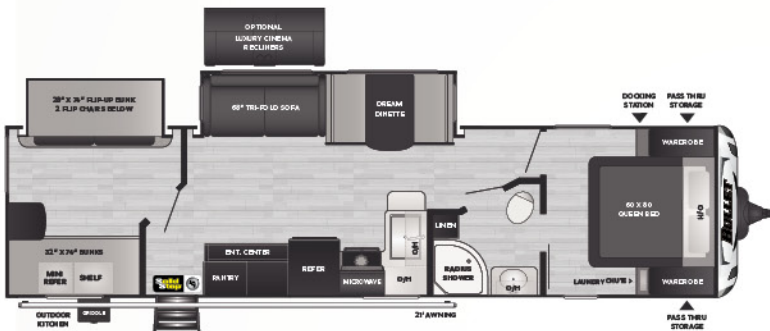

331BHS | WEIGHT 7127 | LENGTH 37' 6"

▪ BUNKROOM W/ SLIDE, SUPER SLIDE, OUTSIDE KITCHEN

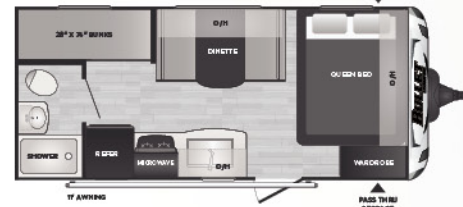

1700BH | WEIGHT 3694 | LENGTH 21' 4"

CROSSFIRE ▪ BUNKS, SINGLE AXLE

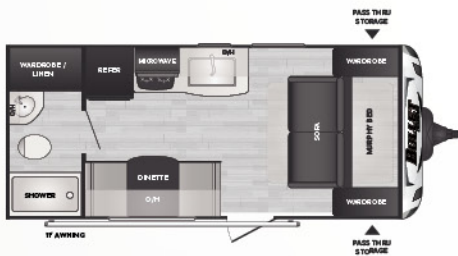

1800RB | WEIGHT 3657 | LENGTH 21' 4"

CROSSFIRE ▪ REAR BATH, MURPHY BED, SINGLE AXLE

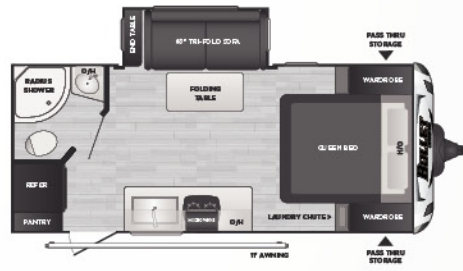

1850RB | WEIGHT 4175 | LENGTH 22' 4"

CROSSFIRE ▪ REAR LIVING, STACKABLE W/D PREP, THREE SLIDES

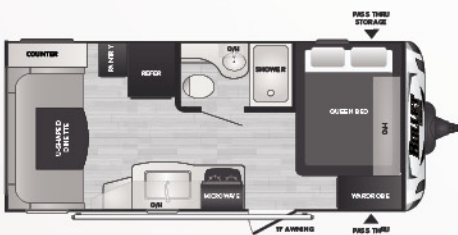

1900RD | WEIGHT 3760 | LENGTH 21' 11"

CROSSFIRE ▪ REAR DINETTE, SINGLE AXLE

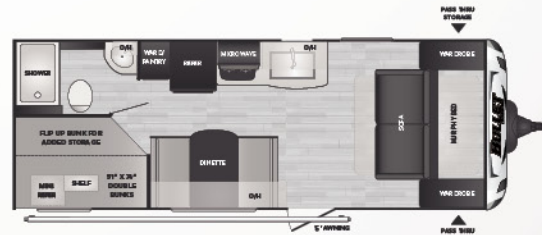

2200BH | WEIGHT 4487 | LENGTH 25' 4"

CROSSFIRE ▪ DOUBLE BUNKS, MURPHY BED, OUTSIDE KITCHEN

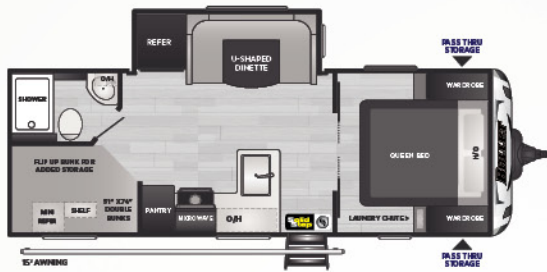

NEW! 2290BH | WEIGHT TBD | LENGTH 27' 0"
CROSSFIRE • REAR BATH, DOUBLE BUNKS

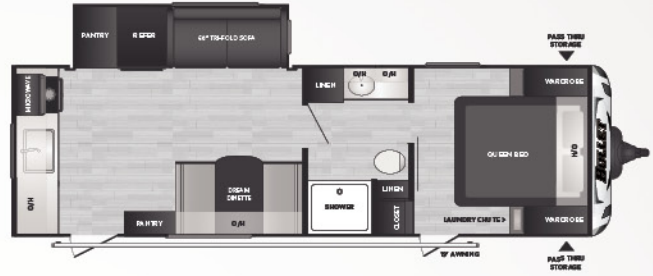

2500RK | WEIGHT 5630 | LENGTH 29' 11"
CROSSFIRE • REAR KITCHEN, SOFA SLIDE

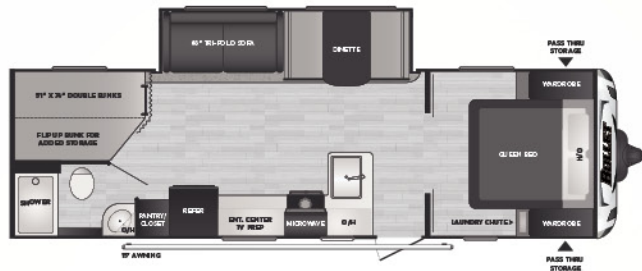

2730BHS | WEIGHT 5544 | LENGTH 31' 2"
CROSSFIRE • DOUBLE BUNKS, SUPER SLIDE

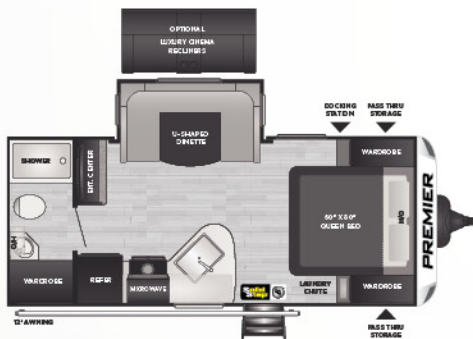

19FBPR | WEIGHT 4713 | LENGTH 24' 0"
PREMIER • REAR BATH, DINETTE SLIDE

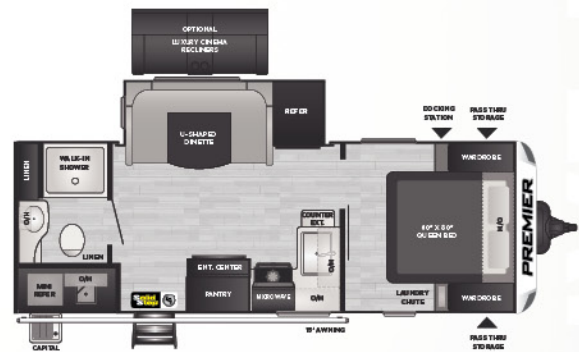

23RBPR | WEIGHT 5554 | LENGTH 27' 5"
PREMIER • REAR BATH, DINETTE SLIDE, OUTSIDE KITCHEN

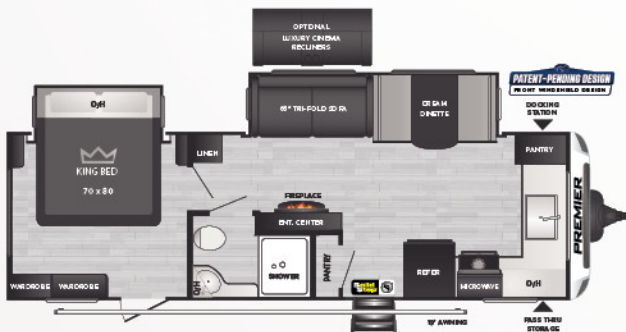

25FKPR | WEIGHT 6535 | LENGTH 30' 10"
PREMIER • FRONT KITCHEN, KING BED, BEDROOM SLIDE

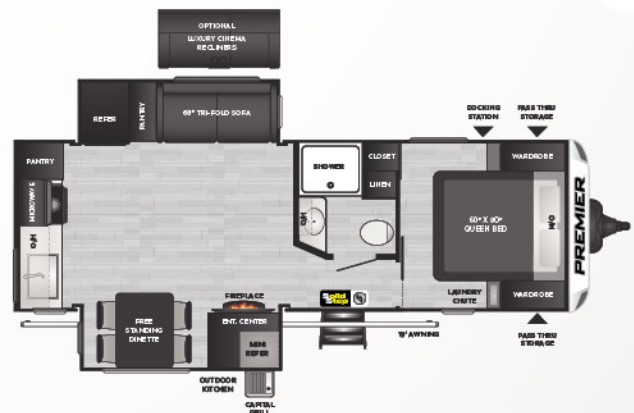

25RKPR | WEIGHT 6165 | LENGTH 29' 11"
PREMIER • REAR KITCHEN, OPPOSING SLIDES

SUNSHINE COACHES

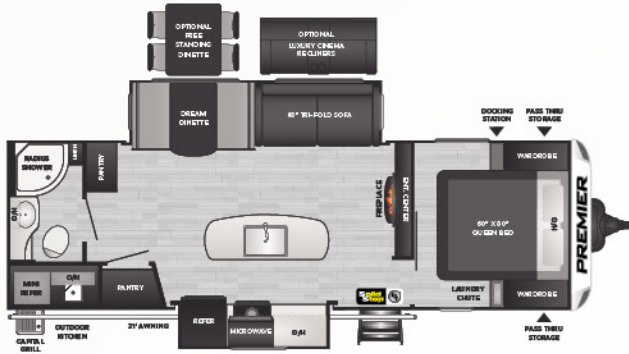

26RBPR | WEIGHT 6560 | LENGTH 31' 10"

PREMIER • REAR BATH, ISLAND KITCHEN, OUTSIDE KITCHEN

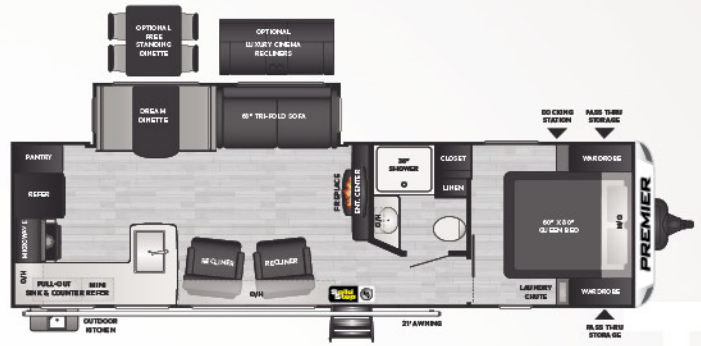

29RKPR | WEIGHT 6890 | LENGTH 34' 3"

PREMIER • REAR KITCHEN, SUPER SLIDE, OUTSIDE KITCHEN

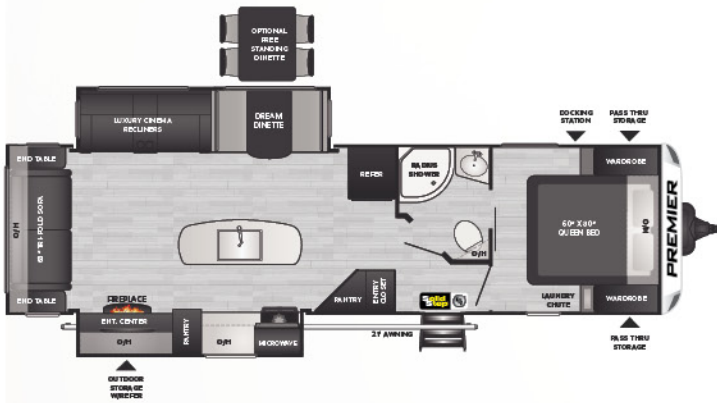

30RIPR | WEIGHT 7241 | LENGTH 35' 9"

PREMIER • REAR LIVING, ISLAND KITCHEN, OUTSIDE ENTERTAINMENT

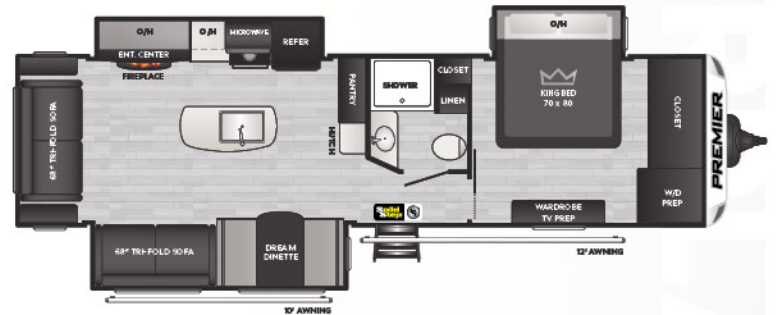

NEW! **31REPR** | WEIGHT TBD | LENGTH TBD

PREMIER • REAR ENTERTAINMENT, ISLAND KITCHEN, KING BED SLIDE

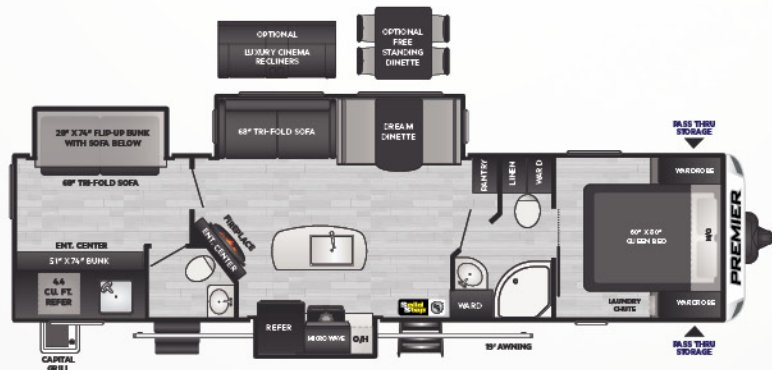

NEW! **33BKPR** | WEIGHT 8185 | LENGTH 37' 11"

PREMIER • REAR BUNKROOM, BATH AND A HALF



TAKE CHARGE OF HOW YOU CAMP

EXCEPTIONAL QUALITY, IMPOSSIBLY VERSATILE, SolarFlex™ IS SHATTERING CUSTOMER'S EXPECTATIONS OF FACTORY-INSTALLED SOLAR POWER. EXCLUSIVELY AVAILABLE ON ALL KEYSTONE RV MODELS.



Relieve battery anxiety with legendary Lithium-ion deep cycle batteries – the ultimate replacement for lead acid. Lightweight, reliable, and longer-lasting, Dragonfly Energy batteries are made in the USA and available exclusively from Keystone RV and authorized dealers.

MY KEYSTONE OWNER'S APP

THE ONLY APP YOU'LL NEED...

» MANUALS & QUICK START GUIDES

» HOW-TO VIDEOS



» FIRST-TIME CAMPER'S ADVICE

» ACCESS TO YOUR RV'S MOBILE APPS

Available for iOS and Android devices.



FOLLOW US FOR THE LATEST!



DISCLAIMER: Product Information is as accurate as possible as of the date of publication of this brochure. All features, floor plans, and specifications in this brochure are subject to change without notice. Please also consult Keystone's web site at www.keystonerv.com for more current product information and specifications. Tow Vehicle Disclaimer. CAUTION: Owners of Keystone recreational vehicles are solely responsible for the selection and proper use of tow vehicles. All customers should consult with a motor vehicle manufacturer or their dealer concerning the purchase and use of suitable tow vehicles for Keystone products. Keystone disclaims any liability or damages suffered as a result of the selection, operation, use or misuse of a tow vehicle. KEYSTONE'S LIMITED WARRANTY DOES NOT COVER DAMAGE TO THE RECREATIONAL VEHICLE OR THE TOW VEHICLE AS A RESULT OF THE SELECTION, OPERATION, USE OR MISUSE OF THE TOW VEHICLE. *Length is defined as the distance from the centerline of hitch pin/coupler to rear bumper of trailer. ** Fresh water capacity includes water heater. Please review owner's manual prior to purchase for more information on service warranties, extended use, towing and maintenance. Owner's manuals can be found at keystonerv.com.

PRINT 09.2022