

**WE ARE
PRO CLASS**



**WOLF
CREEK**

NORTHWOOD
WWW.NORTHWOODMFG.COM

NIW
PRO CLASS

ROOM

TO...

WOLF CREEK



INTERIOR COLORS



890 DESERT PALMS



850 SOLITARE AZUL



850 WINDSWEPT SERENITY

ABSOLUTE NORTHWOOD

ROOF

- ✓ Full Walk On Roof with Bonded Roof Laminated, Pinch Rolled System

FRAME

- ✓ Thick Wall Aluminum w/ Solid Anchor Blocking

FLOORS

- ✓ Commercial Grade Linoleum, Fully Insulated
- ✓ Tongue & Groove Plywood (Not Chipboard)

CABINETS

- ✓ Wall & Ceiling Mounted, Face Frame Construction

INSULATION

- ✓ A True 4-Season Coach



A ABSOLUTE NORTHWOOD CAMPER ROOF

- 1 Heavy Gauge One Piece Roof Membrane
- 2 Luaun Roof Sheathing
- 3 High Density Thick Solid Block Foam Roof
- 4 Ultra-Strong Laminated, Pinch Rolled Roof System
- 5 Interior Lamination Grade Lauan Plywood

B HIGH DENSITY ONE PIECE LAMINATED WALLS

- 6 Designer Interior Decor Vinyl Finish
- 7 Heavy Gauge Fully Welded Aluminum Superstructure
- 8 Solid Wood Fill - Full Thread Depth Anchor Blocking
- 9 Virgin 2 lb Rigid Dense Block Foam Insulation
- 10 Steel Inlaid Bonderizer Anchor Strips
- 11 Lamination Grade Lauan Plywood Exterior Wall Layer
- 12 Corona Treated High Durability Fiberglass Outer Layer



C ULTIMATE DURABILITY FLOOR STRUCTURE

- 13 Residential Quality Plush Commercial Carpeting
- 14 Commercial Grade Linoleum with 20 mil Surface
- 15 3/8" Plywood (not chipboard)
- 16 R-7 Residential Grade Fiberglass Insulation
- 17 Heated and Insulated Large Capacity Holding Tanks

D MORE ABSOLUTE NORTHWOOD QUALITY FEATURES

- 18 Aerodynamic One-Piece Fiberglass Front
- 19 4 Rieco Titan Electric Jacks (Wolf Pack)
- 20 11K BTU Air Conditioner (Optional)
- 21 Diamond Plate Basement Walls

Air space left between tanks and bottom to protect against freezing



850



ABSOLUTE QUALITY

- *Large Capacity Tanks & Amenities For Extended Camping Capability
- *Steel Reinforced, Embedded, Bolt-through Tie Down Brackets
- *Quick Recovery 6 Gallon DSI Gas/Electric Water Heater
- *Thick Wear Surface Commercial Grade Flooring
- *LED Interior/Exterior Lighting
- *Fiberglass Shower With Skylight
- *Deep Tint Safety Glass

We've had our 2013 Wolf Creek 850 Truck Camper since October 2012 and enjoy it completely! We chose the Wolf Creek camper because my family loves to camp yet we don't love tents. My daughters and I love having nice warm beds and a bathroom in the camper. My husband chose the Wolf Creek 850 and wanted it to be winterized so that we can take it up to our local ski area in Washington where we spend many weekends skiing and camping in the snow. Something we would never consider doing in a tent.

Currently, we are on a year long road trip with the family in the Wolf Creek. My husband, myself and my two daughters (8 & 11) left Seattle, WA at the end of August and headed North, through Vancouver, BC and headed all the way up to Hyder, AK then made our way down through the Canadian Rockies and back into

the US through Montana, South Dakota and through the Great Lakes Region. After Michigan we went North again and toured Montreal and Quebec City. After getting sprinkled with a bit of snow in Quebec and getting shut out of closed RV parks, we decided to head South. We went through Maine, stopped in Salem, MA to experience the Halloween festivities and explore Boston and now we are in Gettysburg, PA and are planning to continue heading South. We will spend Thanksgiving in Virginia and make our way to Florida for December before we head to the Rockies for the ski season and then head West in the Spring and back home next Summer.

All the best,
Kathy & Andrew Gorohoff



NORTHWOOD

FEATURES



890



- *Spacious Galley Design
Extra Large Custom One Piece Formed Countertops & Dinette Table with Large Overhead Storage Cabinets
- *Hardwood Cabinet Doors and Drawers
- *Roller Bearing Drawer Guides
- *NW TruRest Queen Mattress with Bedspread
- *45 Watt Solar Panel
- *LP Quick Connect
- *20K BTU Auto Ignition Furnace / Digital Tstat
- *Booth Dinette with Dream Dinette
- *180 Dinette-Kitchen View Windows





ABSOLUTE NORTHWOOD

ONE PIECE LAMINATED WALLS

Our aluminum wall frames are constructed of up to 1/8" thick aluminum tubing and all joints are welded full width, not spot welded like much of the competition.



ONE PIECE FIBERGLASS

The outer skin of our laminated wall is a single sheet of tough, corona treated fiberglass. Corona treating ensures the polyurethane is able to properly accept the hot melt adhesives. A single piece of fiberglass eliminates seams that can leak & it's stronger too.

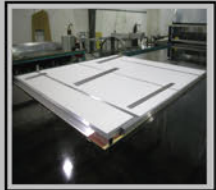

STEEL BONDERIZERS

We add steel bonderizer strips inside the wall at all mounting points. The bonderizers provide a steel anchor point for any fixtures that are mounted to the walls.

SOLID CORE ANCHOR BLOCKING

We add solid core anchor blocking in the frame perimeter. The solid blocking provides a substantial anchor medium for securing screws.

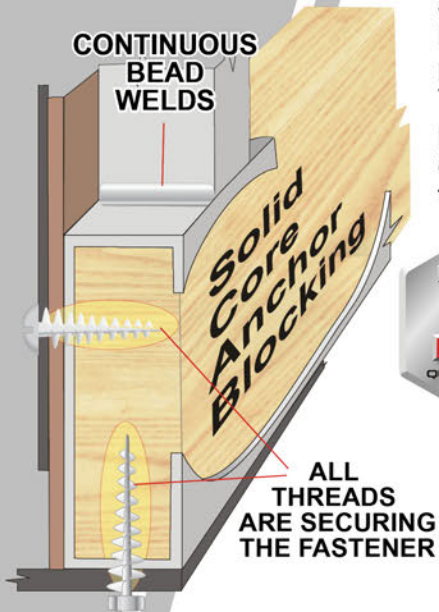
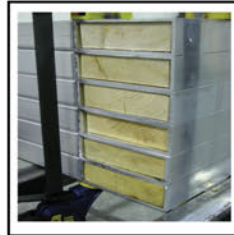

other brands

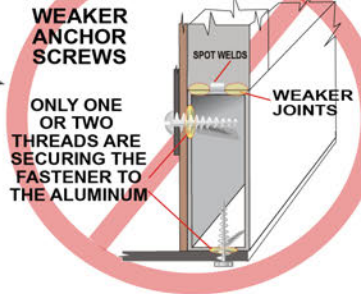

RESIDENTIAL QUALITY CABINET CONSTRUCTION

We build our own cabinets, and every cabinet is built to the best quality specifications. By building our own cabinets, we can guarantee that they will be made right and are built to last!



SOLID WOOD

All NORTHWOOD cabinets are made with residential quality material and methods. Because we use screws, they hold up better under travel/road conditions.

By integrating the cabinet with the structure of the ceiling and walls, our coaches and our cabinets are both made stronger.



FACE FRAME CONSTRUCTION

We use the same construction techniques used in quality residential cabinetry. We assemble hardwood styles with screws on a face frame machine to ensure strong, durable cabinets. The result: Beautiful, quality cabinetry and the best built truck camper!

THICK BASEMENT WALLS & ALUMINUM TRUSSES



Thick Wall Tubular Aluminum Floor Frame
Really Big holding tanks require a 'Really Big' floor structure...

That's The Wolf Creek Floor Structure!
Thick wall aluminum basement floor joists support our holding tanks under the basement of every Wolf Creek Truck Camper.



QUALITY FIRST

**CONTINUOUS
ONE PIECE
FIBERGLASS
CACOVER
AND
BULKHEAD**



**NO SEAMS THAT CAN LEAK!
NORTHWOOD SEAT STEP**

What a Great Idea!

Makes getting into the cabover a breeze.

Doubles as an additional seat.



Easy to attach and remove.

Simply hang it on the bulkhead wall.

Use as a cabover step or as a seat.

A terrific option to add to your Wolf Creek!



The **FOX LANDING** offers a large entry platform, convenient fold away stairs and intermediate step for easy access. The stairway can be installed to the left or right of the landing, and the platform folds up, out of the way, for travel or when hitching your boat or trailer. Check it out!

**MANUFACTURED
Exclusively
FOR NORTHWOOD**

- * 4 Equal Height Steps
- * Mid Step Bumper Level to Threshold
- * New Wider Bumper
- * Left or Right Hand Accessible
- * Glow Step Treads
- * Steps Fold Up in Seconds
- * Single Pin Locks Into Position

1. Steps in the down position.



2. Treads fold up....



3. Landing folds up, and pin locks it into place



FEATURES & OPTIONS

Standard Construction Features

Fully Welded, Thick-Wall Aluminum Frame Construction
One-Piece, Corona Treated, Continuous Fiberglass
Hot, Polyurethane Laminated, Multi-Layered Substrate Walls
High Density Block Foam Insulation
Laminated Floor

Standard Exterior Features

Dual Battery Compartment
1- 20 lb LPG tank w/Regulator
Diamond Plate Knee Wall Armor
Truck Storage Access Doors
Residential Wear Floor Covering
LED Exterior Lighting
6 Gal DSI Gas/Elect Quick Recovery Water Heater
20K BTU Auto Ignition Furnace
Marine Style Detachable Shore Cord
Omni Directional TV Antenna
45 Watt Solar Panel
Roof Rack and Ladder Ready
Tinted, Safety Glass Windows
Large Exterior Folding Grab Handle
Entry Door Friction Hinge
Large Exterior Folding Grab Handle
Satellite Ready / Solar Ready

Standard Interior Features

LED Interior Utility Lighting
Interior Command Center
Solid Wood Mortise & Tenon Cabinet Doors
Designer Wood Grain Finish Throughout
Roller Bearing Drawer Glides
Hidden Hinges on Cabinet Doors
Fabric Night Shades Throughout
Charge Wizard / LP Quick Connect
Smoke, LPG & CO Leak Detectors
110 Volt 55 Amp Converter

Standard Kitchen Features

High Profile Kitchen Faucet
High Output 3-Burner Cook Top
Microwave Oven / Stainless Steel Sink
Range Hood with Light and Exhaust Fan
Kitchen Overhead Storage Cabinets
Multiple Kitchen Drawer Cabinets
Large Picture Window At Dinette
Custom One Piece Formed Countertops & Dinette Table

Standard Bathroom Features

Porcelain Foot-Flush Toilet / Bath Skylight
Exhaust Fan in Bathroom
Shower Curtain with Curved Track / Full Shower

Standard Bedroom Features

NW TruRest Queen Mattress w/Bedsread
Privacy Curtin in Cab Over / Bedroom Roof Vent
Reading Lights
Night Stand / Wardrobe Curbside
Bedroom Reading Lights
USB Charging Ports on Both Sides of the Bed

Available Options

AM/FM/CD/DVD Player
19" 12v LED TV
Thermal Pane Windows
Camper Seat-Step
Fox Landing
Gen Ready (Short Box Only)
2.5 Onan LP Generator
100 Watt Solar Panel
170 Watt Solar Panel
Swing Out Brackets
Roll Over Sofa (850 only)
11 K BTU Air Conditioner
17" Oven
Coleman Mach 8 9K BTU A/C
1 Deep Drawer Under Cooktop
24" Add-A-Step
Side Box Awning-Curb Side
Side Box Awning-Road Side
Side Boxes (Short Box Only)
RV BBQ
Rear View Camera
Gateway Router



Wolf Pack

Wolf Pack is a mandatory option bundle that includes all of the following high value features:

AM/FM/CD Player w/Bluetooth
Rear Electric Awning w/ LED Lighting
Electric Jacks
5 CU' Fridge w/Insert Panels & Cold Weather Kit
Dual 5 Gallon LP Tanks
Outside Speakers
Exterior Shower
Heated Holding Tanks
Roof Rack & Phatt Ladder
Fox Landing Ready Rear Bumper
Sewer Hose Storage
Utility Light Roadside
FanTastic Vent
Combo Bunk Cab
w/Dinette Light (850 only)
Range Cover / Sink Lid
**** Weight: 310 lbs**



Send us your testimonial with your pictures and you may be featured in our future promotions.

Send your information to:
feedback@northwoodmail.com

CAMPER SAFETY TIPS:

Use **TORKLIFT** frame mounted camper tie downs for greatest safety.

For your safety while driving, use mirrors that allow you to view past the camper to the rear on both sides. Trucks can be purchased with extended mirror options or you may purchase mirror extensions. Truck manufacturers state that you should not exceed the GVWR for the vehicle that carries your camper.

The configuration of your truck will determine what size camper your vehicle can carry. A dual rear wheel truck is advisable for Wolf Creek campers. Adjustable air bags will help to level your vehicle, transfer rear axle weight forward for comfort and safety, and are recommended for all Wolf Creek applications. Some states allow passengers to ride in the camper, but it is not recommended as there are no seat belts available. When driving in any adverse weather condition it is always best to reduce your speed. The pickup should be outfitted with a durable rubber mat liner to reduce shifting while traveling. The mat will also protect the truck bed and camper from scratching while loading and unloading.

CAMPER BED DIMENSIONS

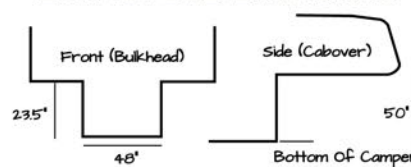

More About Torklift



| Model Number | 850 | 890 |
|-------------------------------------|---------------|---------------|
| Dry Weight Lbs | 2008 | 2284 |
| Dry Weight Kgs | 913 | 1036 |
| Width | 8'0" | 8'0" |
| Exterior Height | 7'7" | 7'7" |
| Interior Height | 6'6" | 6'6" |
| Floor Length | 8'8" | 9'1" |
| Overall Length | 16'2" | 16'7" |
| Fresh Water w/Water Heater | 33 gal | 37 gal |
| Gray Water | 19 gal | 32 gal |
| Black Water | 20 gal | 30 gal |
| LPG Capacity (approx. gallons) | 5 gal/ 20 lb* | 5 gal/ 20 lb* |
| Auto Ignition Furnace (1,000 BTU's) | 20 | 20 |

See your dealer for option availability in certain models

Your Local Dealer:

Northwood Manufacturing, 59948 Downs Rd., PO Box 3359, La Grande, OR 97850 - (541) 962-6274 - www.northwoodmfg.com

Photos, drawings, dimensions and weights are presented as accurate but may differ from current production models. We continually upgrade & improve our products and reserve the right to change any specifications without notice. Please see your authorized Northwood dealer for updated information.

Updated Dec. 2021