

ARTISANAL LUXURY

As captivating as it is liberating, Montana ownership is an unrivaled experience. This strikingly stylish camper features SolarFlex™ packages that can get you off the grid for extended stays and is warrantied for full-time RVing.

With over 20 years in production by some of the most tenured craftsmen, Keystone Montana continues to set the benchmark for luxury fifth-wheels. Thoughtfully designed and guided by over 100,000 owners, every detail is remarkably polished.

Modern Complements

- Blade Pure™
- SolarFlex™ 200 (standard)
- JBL® entertainment
- Indoor/outdoor central vacuum
- G-rated Sailun tires & TST® tire pressure monitoring
- Hardwood cabinetry and stiles
- Keystone exclusive screen assist door handle
- Pull-down spice rack
- CPAP shelves with USB & 110-volt outlets
- Full-time warranty

Unparalleled Options

- SolarFlex™
 - » 400i
 - » 1200i-L
- Dual-pane frameless windows
- CX3: 3rd 15K air conditioner
- Slide out awnings
- Legacy Package
- Full-body paint (w/ Legacy Package)

3781RL IN COTTAGE WHITE DECOR



SCAN HERE TO LEARN MORE



VISIT KEYSTONERV.COM/MONTANA FOR IN-DEPTH PRODUCT INFORMATION, VIDEOS, MODEL 360'S AND MORE.



Learn more about the SolarFlex difference and packages now available.

PRINT 9.2021

LAUNCHING AS STANDARD EQUIPMENT ON ALL KEYSTONE TRAVEL TRAILERS AND FIFTH WHEELS, FALL 2021

WARRANTY FOR FULL TIME RVING*
*REFERENCE KEYSTONE RV COMPANY OWNERS MANUAL FOR LIMITED WARRANTY DETAILS

SOLAR FLEX

MONTANA

TAKE CHARGE OF HOW YOU CAMP

The Solar Energy System You've Been Waiting For

Impossibly versatile, exceptionally designed, SolarFlex is shattering customers' expectations of factory-installed solar power. SolarFlex eliminates the guesswork to deliver affordable, high quality solar energy systems.

Montana offers SolarFlex 200 as standard, with the option to upgrade to SolarFlex 400i or SolarFlex 1200i-L.

 **KEYSTONE** RV COMPANY | **CAMP BETTER**

 **KEYSTONE** RV COMPANY | **CAMP BETTER**

MONTANA

LUXURY FIFTH WHEELS



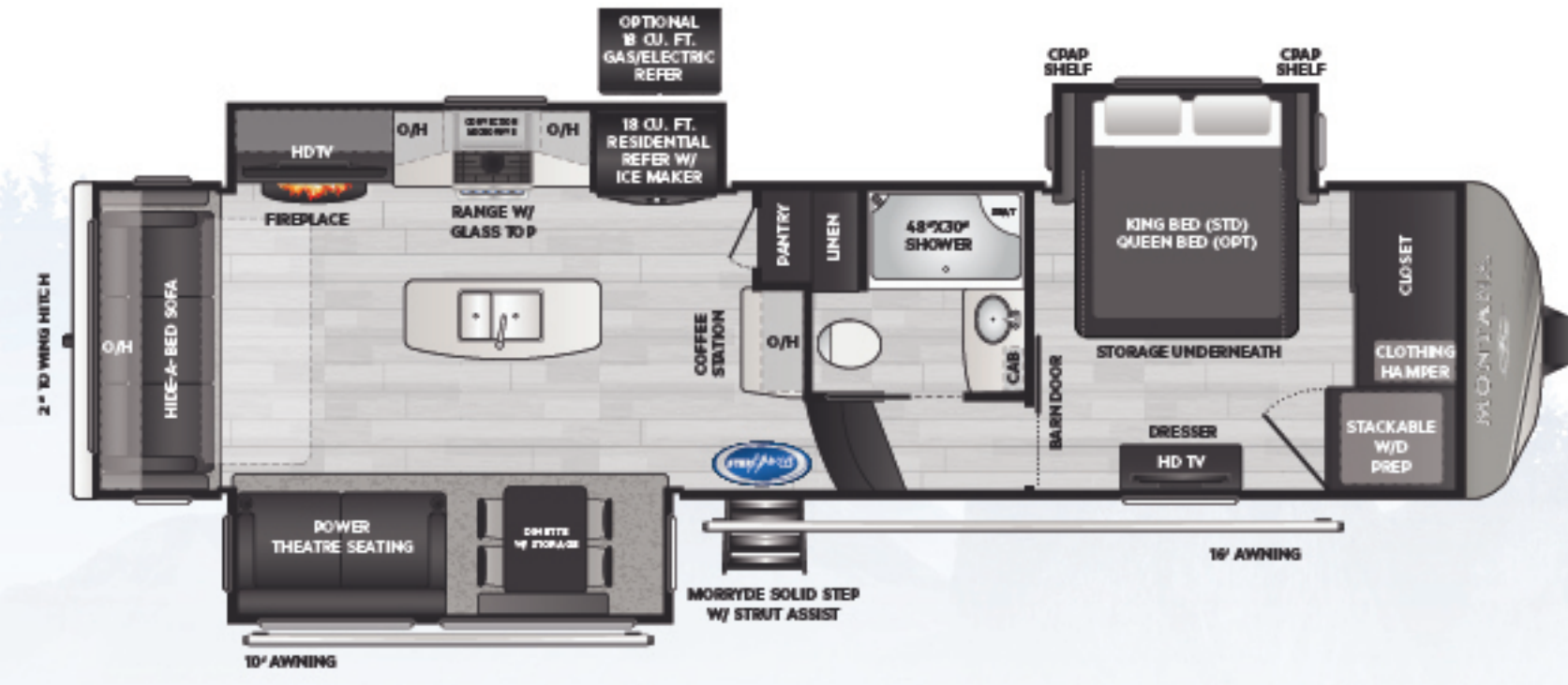

3121RL Rear living room, three slides
RESIDENTIAL REFRIGERATOR
WEIGHT 12273 LENGTH 35' 0"

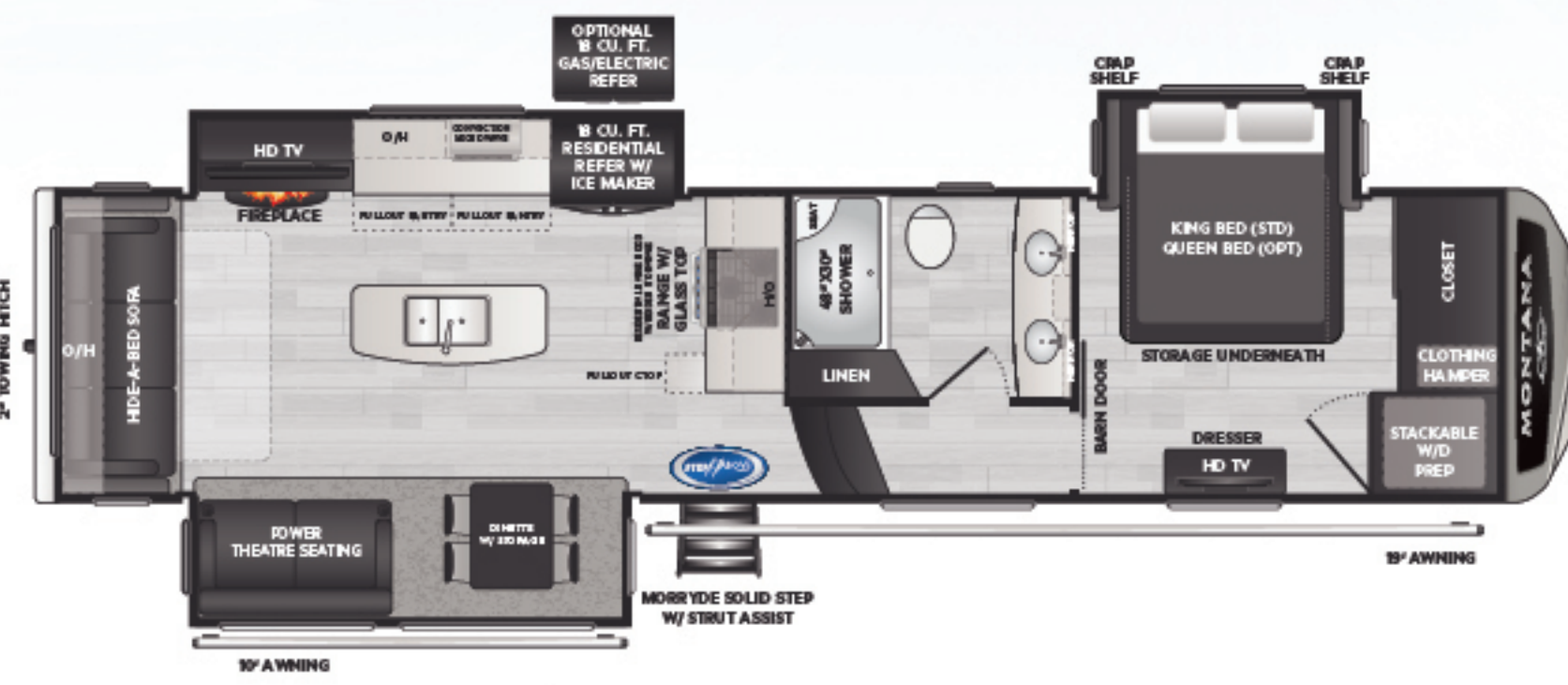

3231CK Center kitchen, three slides, dual vanity
RESIDENTIAL REFRIGERATOR
WEIGHT 12752 LENGTH 37' 5"

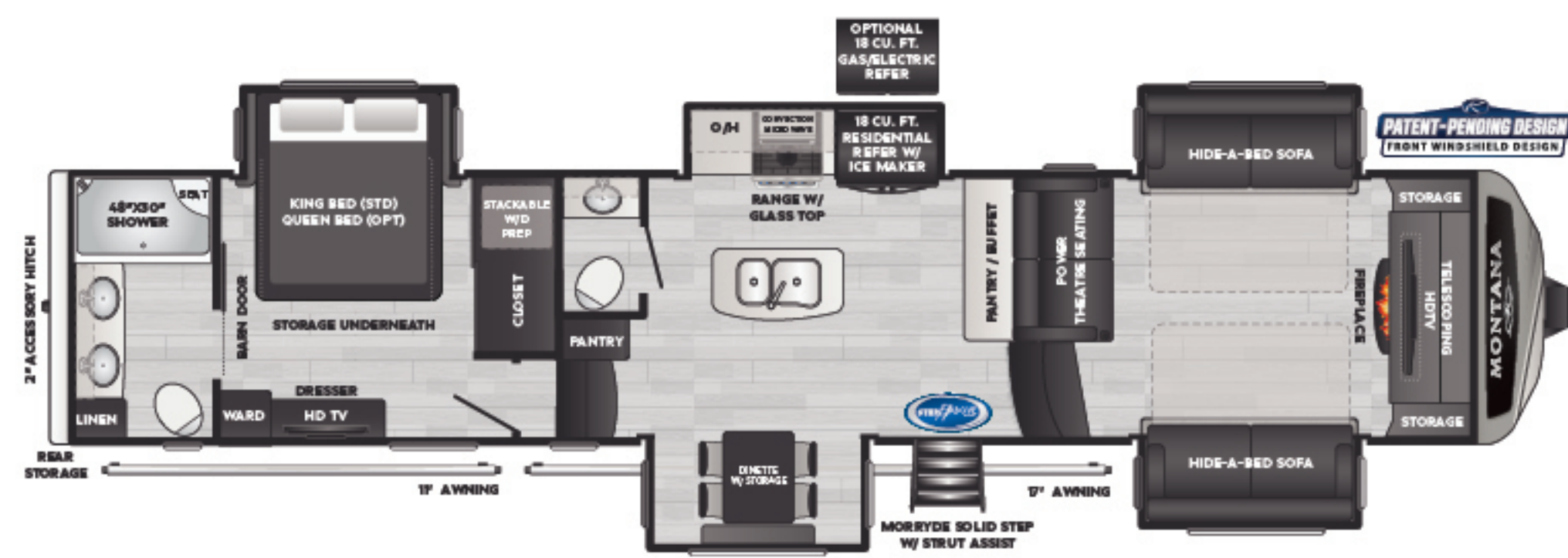

3761FL Front living, five slides, 1 1/2 baths
RESIDENTIAL REFRIGERATOR
WEIGHT 14248 LENGTH 41' 0"



3763BP Front living w/ butler's pantry, five slides
RESIDENTIAL REFRIGERATOR
WEIGHT 14202 LENGTH 41' 0"

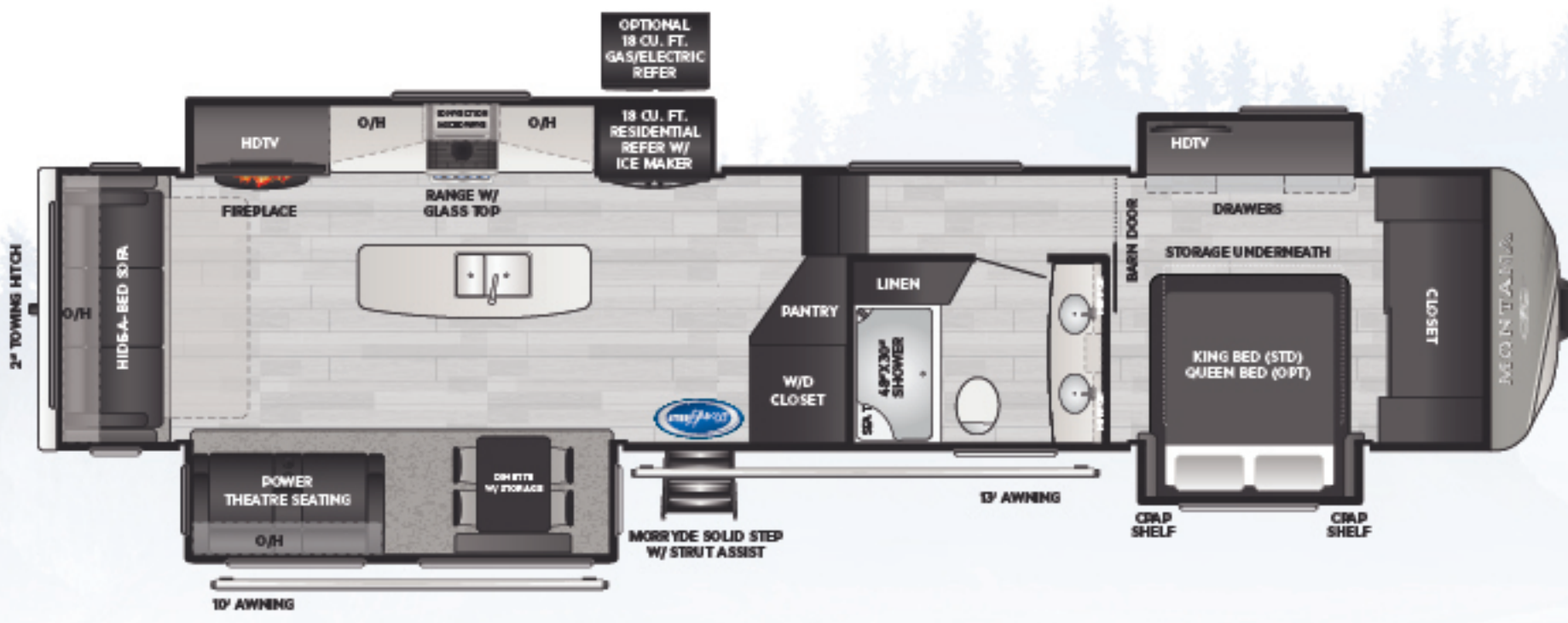

3781RL Rear living w/ double vanity bathroom & double slide bedroom
RESIDENTIAL REFRIGERATOR
WEIGHT 13485 LENGTH 41' 0"

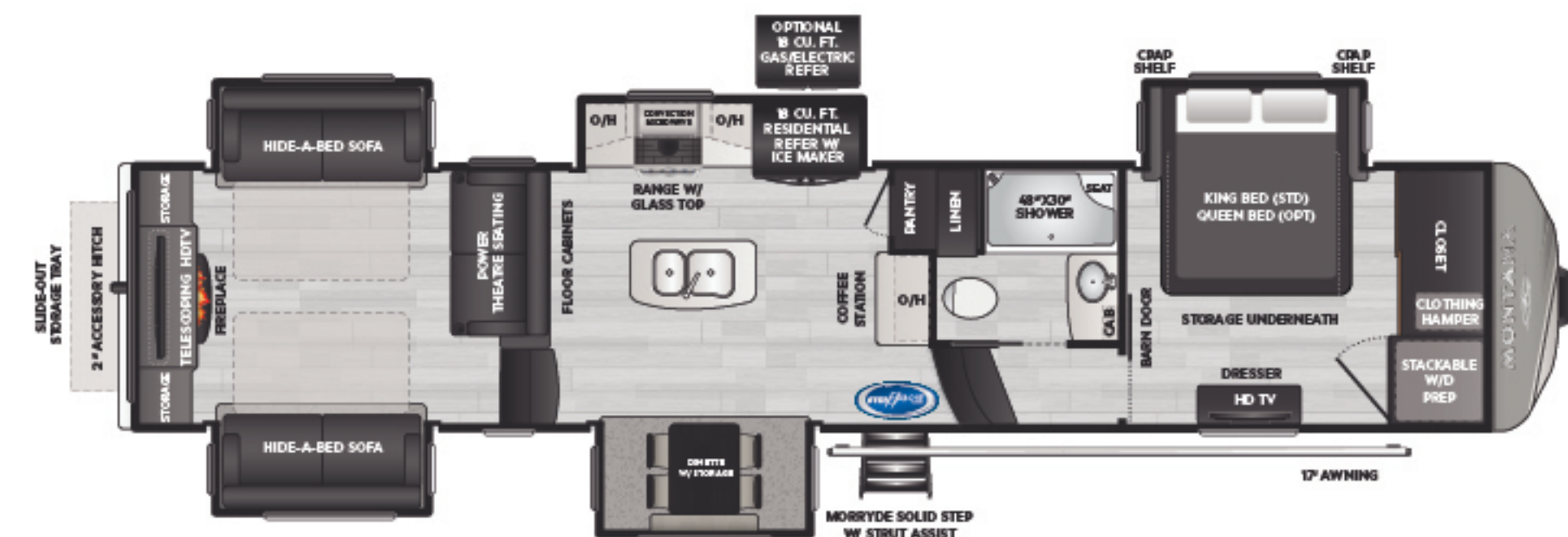

3791RD Elevated rear den w/ rear pull-out storage
RESIDENTIAL REFRIGERATOR
WEIGHT 14240 LENGTH 40' 5"

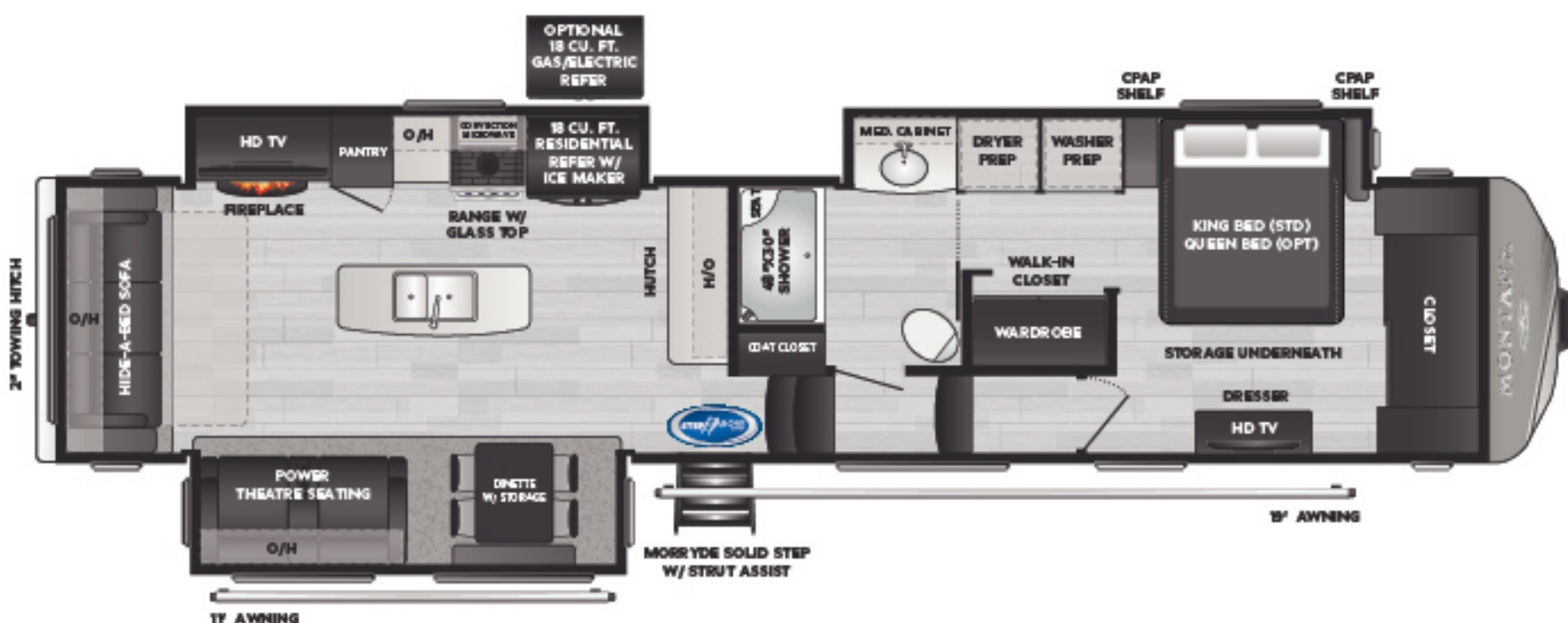

3813MS Rear living room w/ master suite & walk-in closet
RESIDENTIAL REFRIGERATOR
WEIGHT 13763 LENGTH 40' 9"

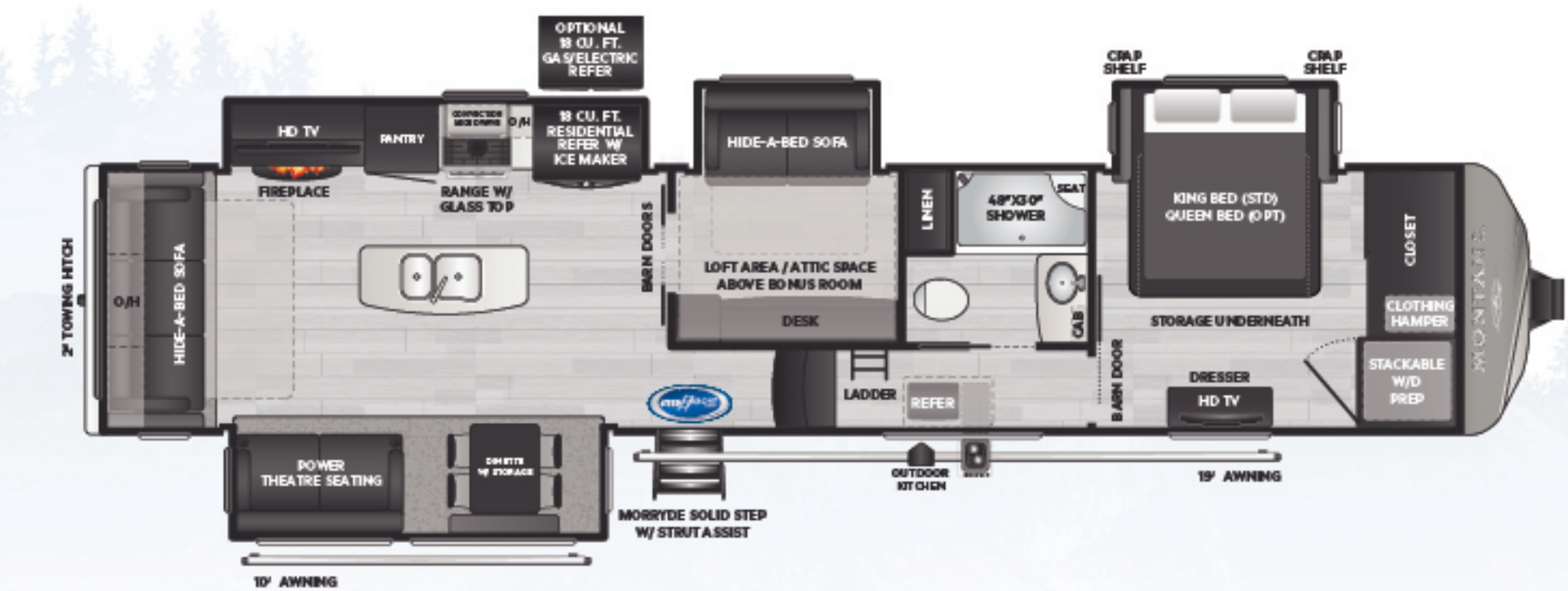

3855BR Bonus room w/ loft and outside kitchen
RESIDENTIAL REFRIGERATOR
WEIGHT 13896 LENGTH 40' 11"

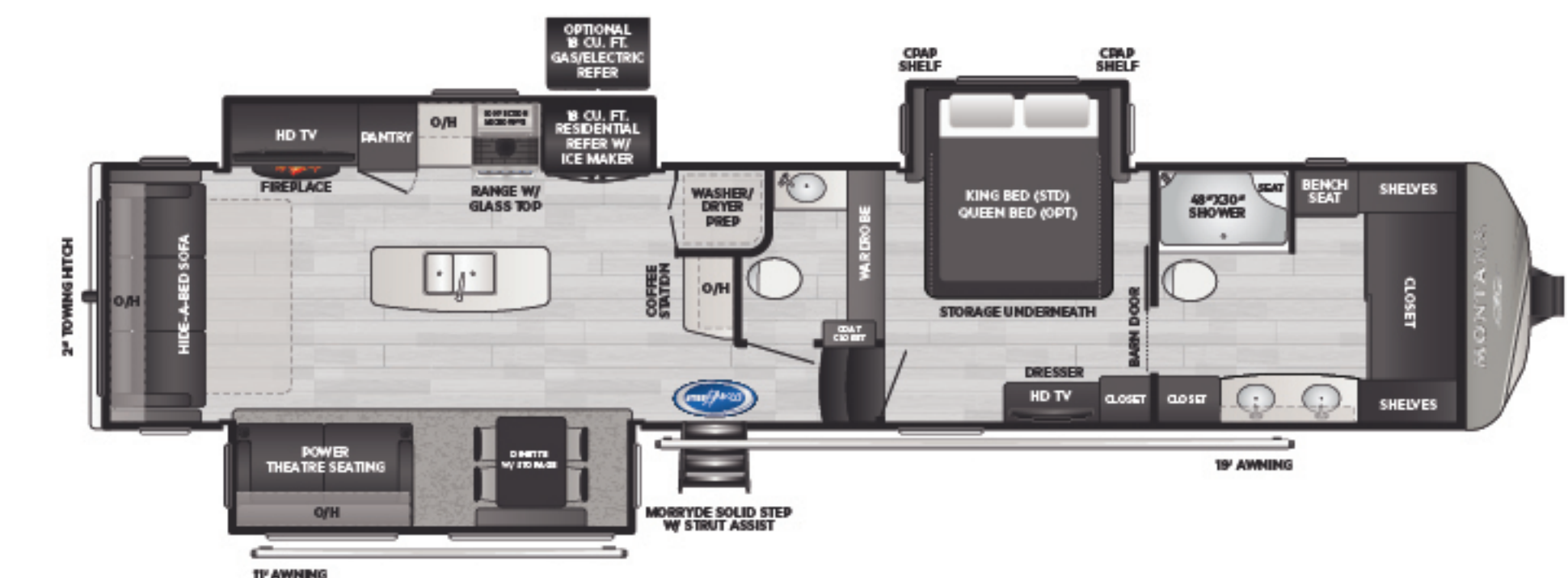

3931FB Front bathroom w/ front wardrobe
RESIDENTIAL REFRIGERATOR
WEIGHT 13533 LENGTH 41' 4"

MODEL	WEIGHT	CARRYING CAPACITY	HITCH WEIGHT	FRESH WATER	WASTE WATER	GRAY WATER	LPG	LENGTH*	WIDTH	HEIGHT	AWNING
3121RL	12273	4077	2350	66	49	88	60	35' 0"	8'	13' 4"	16' 10"
3231CK	12752	3928	2680	66	49	88	60	37' 5"	8'	13' 4"	19' 10"
3761FL	14248	2552	2880	66	88	88	60	41' 0"	8'	13' 4"	17' 11"
3763BP	14202	2778	2980	66	49	88	60	41' 0"	8'	13' 4"	17' 11"
3781RL	13485	3115	2695	66	49	88	60	41' 0"	8'	13' 4"	13' 11"
3791RD	14240	2360	2620	66	49	88	60	40' 5"	8'	13' 4"	17'
3813MS	13763	3037	2820	66	49	88	60	40' 9"	8'	13' 4"	19' 11"
3855BR	13896	3004	2940	66	49	88	60	40' 11"	8'	13' 5"	16' 10"
3931FB	13533	2967	2530	66	88	88	60	41' 4"	8'	13' 5"	19' 11"

DISCLAIMER: Product information is as accurate as possible as of the date of publication of this brochure. All features, floor plans, and specifications in this brochure are subject to change without notice. Please also consult Keystone's web site at www.keystonerv.com for more current product information and specifications. Tow Vehicle Disclaimer. CAUTION: Owners of Keystone recreational vehicles are solely responsible for the selection and proper use of tow vehicles. All customers should consult with a motor vehicle manufacturer or their dealer concerning the purchase and use of suitable tow vehicles for Keystone products. Keystone disclaims any liability or damages suffered as a result of the selection, operation, use or misuse of a tow vehicle. KEYSTONE'S LIMITED WARRANTY DOES NOT COVER DAMAGE TO THE RECREATIONAL VEHICLE OR THE TOW VEHICLE AS A RESULT OF THE SELECTION, OPERATION, USE OR MISUSE OF THE TOW VEHICLE. *Length is defined as the distance from the centerline of hitch pin/coupler to rear bumper of trailer. Please review owner's manual prior to purchase for more information on service warranties, extended use, towing and maintenance. Owner's manuals can be found at keystonerv.com.