

PREMIER FIFTH WHEELS  
AND TRAVEL TRAILERS

# COUGAR





**Keystone RV  
Company**

# ICONIC COMPANY

**COLE  
DAVIS**

Founder, Keystone RV Company  
Started Keystone RV with 110 employees  
and 1 production line in 1996.

**OUR**

Keystone a company on a mission

When Cole Davis founded Keystone RV in 1996 his vision was clear: Build a quality RV loaded with features priced thousands less than other RVs on the market. To accomplish his goal, Cole built a strong team, focused on keeping overhead low, and empowered employees closest to the customer to make decisions. Within a few short months after opening the doors, Keystone produced its very first camper. Delivering big on quality, features and value, the public fell in love and a star was born.

As customers appetite skyrocketed, new Keystone models were added to satisfy growing customer demand. Along with this tremendous growth came the need for expanded production. To meet this need, more manufacturing plants were built and staffed. By the beginning of 2000, Keystone was leading the industry in fifth wheel and trailer sales. Today, Keystone RV Company has grown to encompass over 1 million square feet of manufacturing space with facilities in Goshen, Indiana and Pendleton, Oregon. While Keystone is no longer the small “start up” we once were, our mission has remained true to Cole’s vision—“Do the job right and make sure we deliver a quality product every time.”

✓ **MOST RELIABLE PRODUCTS IN THE INDUSTRY**

✓ **QUALITY, PROCESS DRIVEN MANUFACTURING**

✓ **CONSUMER FOCUSED PRODUCTS AND SERVICE**

✓ **MOST “DEALER SATISFACTION INDEX” AWARDED RECIPIENT**



# COUGAR

by Keystone



## ICONIC BRAND



At the heart of Cougars philosophy is the belief that if we listen to our customers, and execute accordingly, the crucial combination of quality, design, weight, luxury and price, is to offer an unparalleled product. A product that will provide the finest means for families, both young and old, to create memories year after year! From growing families, to full timers, Cougar vows to provide the top travel trailer and fifth wheel floor plans and features to suit each dynamic, and maximize their unique camping experience. Growing with Cougar from a mid-level travel trailer, to a 40 foot fifth wheel, is our forte! By avoiding fads and trends, we have been able to focus more on innovation, quality, style and affordability. These attributes are what our customers rely on, and appreciate, and are the hallmarks of America's #1 selling brand. Cougar is the choice of yesterday, today and tomorrow!

Cougar remains focused on the growing popularity of lightweight luxury vehicles, and the ease of tow ability. We have ongoing commitment to create a stress free journey for all who choose to explore with us. We make it our goal that our current customers choose us for each of their subsequent voyages. Come grow with us and explore the country in a Cougar RV! Where you are always a step ahead, and luxury and lightweight meet!

### SEE COUGAR ON DISPLAY AT THE RV HALL OF FAME!



LOCATED IN ELKHART, INDIANA

# BUILT

## FOR THE LONG HAUL



**INNOVATION THAT STARTS WITH A SOLID FOUNDATION**

[WWW.KEYSTONERV.COM](http://WWW.KEYSTONERV.COM)



**Keystone RV Company**



**WIRED FOR PERFORMANCE**

**THE ONLY TOWABLE MANUFACTURER TO INCORPORATE COLOR-CODED AND NUMBERED ELECTRICAL WIRING ON ALL PRODUCTS**

- Creates a clean, well organized wiring layout
- Makes it easy to trace electrical circuits and saves troubleshooting time



**TUF-LOK THERMOPLASTIC COUPLERS FORM A PERMANENT, CRUSH-RESISTANT SEAL IN YOUR AIR-CONDITIONING DUCT**

- Securely joins ductwork and air-conditioning units
- Crush-resistant design won't pull apart due to rough roads, heat and stress
- Drastically reduces chilled-air leaks to boost cooling efficiency and comfort
- Circular racetrack style ducting improves performance over competitors that use "figure 8" style that causes additional resistance and turbulence.



**RESIDENTIAL IN-FLOOR HEAT-DUCT SYSTEM JUST LIKE IN YOUR HOME**

- A. In-floor, hot air vents spaced for greatest comfort, distributes heat evenly and warms the floor
- B. Competitors heat vent locations are determined by cabinets, causing hot and cold spots. Hot air is supplied through restrictive hoses.

UP TO 7 LAYERS OF PROTECTION



**MOST CAPS ARE FULLY PAINTED AND CLEAR-COATED IN OUR IN-HOUSE STATE OF THE ART PAINT FACILITY**

- Backed by 3-year fade and chalk limited warranty
- KeyGuard chip and rock protection is applied to the lower front area



TRU-FIT TECHNOLOGY

**TRU-FIT FIVE-POINT SLIDE ROOM CONSTRUCTION BACKED BY THE INDUSTRY'S-BEST 3-YEAR LIMITED STRUCTURAL WARRANTY**

- Rain channels direct rain away from the slide openings
- Exterior bulb-seals in a locking track stay secure through extreme heat and cold
- Composite slide-room "glide" bar enables the room to move with no binding
- Reinforced roof, walls and floor
- Beefed-up aluminum header above slide room for greater strength



**KEYSTONE EXCLUSIVE ROAD ARMOR SUSPENSION**

- 360 degrees of anti-shock protection
- 6 total inches of travel for unparalleled protection
- During testing, Road Armor decreased chatter by 31.7%



**CELEBRATING 20 YEARS OF EXCELLENCE**

- Launched in 1998, the Keystone Cougar product line was the first introduction into the emerging "half ton light" series. Today, Cougar is the leading producer of mid-profile fifth wheels and is know as a product leader in innovation, quality and affordability.
- Our commitment to delivering the best product in the industry makes Cougar FIRST in its class.



**ZERO DEGREE TESTED & RATED**

**ZERO DEGREE TESTED**

- Cougar has been zero degree tested which allows you to camp to zero degrees without worry of your tanks or water lines freezing up. (Testing and certification achieved under a constant controlled environment.)
- We also add upgraded insulation to our slide-out floors to control the hot and cold exchange and unlike our competition. We merge our skirt metal to the I-Beam for complete enclosure of your fifth wheel underbelly.

ENGINEERING

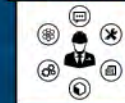

STEP 1:

ENGINEERING AND TESTING  
Multiple quality checkpoints

MANUFACTURING FACILITY



STEP 2:

375 IN-PROGRESS INSPECTIONS AND AUDITS  
Comprehensive systems and quality checks

BEST-IN-INDUSTRY

4 STAGE QUALITY PROCESS

PDI FACILITY



STEP 3:

120-POINT SECONDARY PDI  
Pre-delivery inspection

OK TO SHIP



STEP 4:

SHIPPING DEPARTMENT REVIEW  
Final review before release to dealer



**EVERY COUGAR FIFTH WHEEL HAS PATENTED MAX TURN TECHNOLOGY**

COUGAR PATENTED MAX TURN TECHNOLOGY		
Length of Truck Bed	Standard Fifth Wheel Hitch	Sliding Fifth Wheel Hitch
6' 6"	83.33°	95.66°

Combining focused design and unique product specifications, Max Turn Technology is the leader in optimum turn radius. Unlike the competition, Cougar uses continuous contoured tubular steel for optimum strength and support behind the engineered tapered fiberglass front cap. Also, Cougar is equipped with a heavy duty extended hitch. Combined - Max Turn Technology makes turning and maneuvering a breeze.



**COUGAR'S RACETRACK DUCTING**

When equipped with an optional second A/C in bedroom, Race Track ducting allows for evenly distributed airflow from the front to the back of the fifth wheel regardless of which A/C is running.

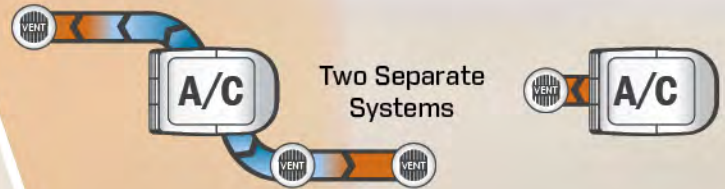

**COMPETITION**

Typical ducting creates uneven airflow which causes less cooling efficiency.

**VS.**

# O V A T I O N

## COUGAR

# 95.66°

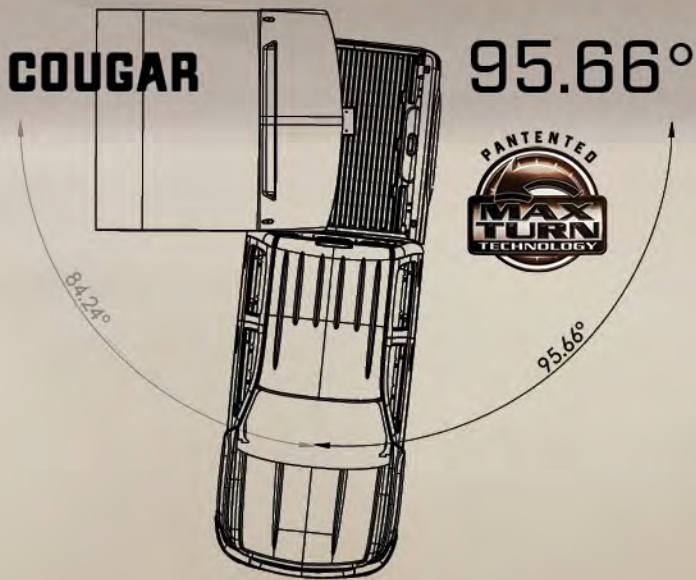

## COMPETITION

Cougar's patented Max Turn Technology provides the most optimal turn radius in its category without the need for complicated and expensive OEM swivel hitch pins that require inconvenient periodic maintenance. For peace of mind, Max Turn ensures you don't end up in a compromised truck position with your fifth wheel.



## INNOVATION VS. IMITATION

Cougar has led the mid-profile fifth wheel segment for 17 years, because of customer focused superior engineering and processes that has given nearly **150,000 CUSTOMERS** positive camping experiences and memories over the past **20 YEARS**. When choosing your next fifth wheel or travel trailer, accept nothing but the best from the leaders in the Industry. COUGAR!

## PATENT-PENDING DESIGN

### FRONT WINDSHIELD DESIGN



Keystone's unique patent-pending 5 point automotive windshield design is made of two curved sheets of glass with a layer of plastic laminated in between for safety. The windshield is then bonded in to the front cap for a permanent, waterproof installation.



PATENTED  
**HITCH VISION**  
"NO LOOKING BACK"

Cougar's patented Hitch Vision provides convenience and ease of hitching your fifth wheel. No other manufacturer offers this exclusive feature. Once you've used Hitch Vision, there's "no looking back" to the inconvenience of turning or straining to see your fifth wheel.

## BEST-IN-CLASS PASS-THRU STORAGE



78 cu. ft. of unobstructed pass-thru storage in mid-profile fifth wheels

# COUGAR by Keystone MID-PROFILE FIFTH WHEELS

366RDS SHOWN IN TWIG DECOR



## BEST-IN-CLASS ADVANTAGES

- ✔ ROAD ARMOR WHEEL SUSPENSION WITH 360 VIBRATION PROTECTION
- ✔ AUTOMATIC LEVELING SYSTEM FOR QUICK AND EASY SETUP/HOOKUP
- ✔ COUGAR EZ CAMP REMOTE POWERS SLIDES, AWNING AND MORE
- ✔ AUTOMOTIVE CLEAR COAT PAINTED FRONT CAP WITH PATENTED "HITCH VISION" BACKUP MIRROR
- ✔ HEATED AND ENCLOSED INSULATED UNDERBELLY FOR EXTENDED SEASON COMFORT
- ✔ INTERNAL AND EXTERNAL LED LIGHTS INCLUDING MOTION SENSOR LIGHTS FOR CONVENIENCE AND LONGEVITY
- ✔ OVERSIZED BAGGAGE DOORS WITH UNOBSTRUCTED PASS-THROUGH STORAGE
- ✔ OVERSIZED PANORAMIC WINDOWS THROUGHOUT
- ✔ ALUMINUM WHEELS WITH E RATED TIRES
- ✔ BED-SLIDE WITH KING BED OPTION (ALL MODELS)
- ✔ 12 CU. FT. 4 DOOR GAS/ELECTRIC REFRIGERATOR (ALL MODELS)
- ✔ OVERSIZE RESIDENTIAL MICROWAVE
- ✔ INNOVATIVE PIVOT HINGE BATHROOM DOORS
- ✔ OPTIONAL SMART-SLIDE HARDWOOD DINING TABLE WITH 4 CHAIRS
- ✔ 30" X 50" RESIDENTIAL SIZE SHOWER (N/A 367FLS)
- ✔ EXCLUSIVE SEAMLESS DYNASPAN FLOOR DECKING WITH 25 YEAR WARRANTY
- ✔ RESIDENTIAL INFLOOR HEAT DUCTING FOR MAXIMUM EFFICIENCY
- ✔ 81 GALLON FRESH WATER CAPACITY
- ✔ WASHER/DRYER PREP (ALL MODELS)
- ✔ BIKE RACK



# FLOOR PLANS



**WEIGHT** 10159 **LENGTH** 35' 4" **310RLS**



**WEIGHT** 10287 **LENGTH** 35' 6" **311RES**

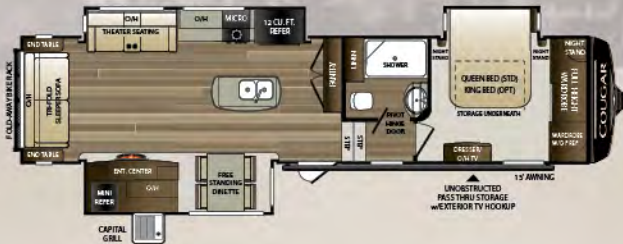

**WEIGHT** 10605 **LENGTH** 37' 2" **338RLK**



**WEIGHT** 10686 **LENGTH** 38' 1" **344MKS**



**WEIGHT** 11202 **LENGTH** 40' 1" **366RDS**



**WEIGHT** 10963 **LENGTH** 40' 1" **367FLS**



**WEIGHT** 11575 **LENGTH** 40' 1" **368MBI**



**WEIGHT** 11441 **LENGTH** 40' 2" **369BHS**

# COUGAR

HALF-TON

## WESTERN FIFTH WHEELS

30RLS SHOWN IN TWIG DECOR



## BEST-IN-CLASS ADVANTAGES

- ✓ FOLDING REAR ACCESSORY RACK FOR BIKE AND REAR TRANSPORT/STORAGE
- ✓ ROAD ARMOR WHEEL SUSPENSION WITH 360 VIBRATION PROTECTION
- ✓ EXTRA LARGE UNOBSTRUCTED EXTERIOR PASS-THRU STORAGE
- ✓ AUTOMOTIVE CLEAR COAT PAINTED FRONT CAP WITH PATENTED "HITCH VISION" BACKUP MIRROR
- ✓ BEST IN CLASS CUSTOMER CONVENIENCE CENTER
- ✓ POWER STABILIZER JACKS OR OPTIONAL AUTOMATIC LEVELING SYSTEM FOR QUICK AND EASY CAMPING SETUP AND TEARDOWN
- ✓ EZ CAMP REMOTE
- ✓ INNOVATIVE PIVOT HINGE BATH DOOR
- ✓ UPGRADED SEAMLESS COUNTERTOPS IN GALLEY AND LAV
- ✓ GLASS TOP COOKTOP WITH 22" OVEN
- ✓ 15,000 BTU AIR CONDITIONER WITH OPTIONAL DUCTED BEDROOM AIR CONDITIONER
- ✓ DUAL DUCTED "BEST IN CLASS" RACE TRACK AIR CONDITIONER SYSTEM
- ✓ 35,000 BTU FURNACE - ALL MODELS!
- ✓ ALUMINUM WHEELS WITH E RATED TIRES
- ✓ WALKABLE ROOF WITH REAR WALL LADDER
- ✓ 60 GALLON FRESH WATER CAPACITY
- ✓ 30X50 RESIDENTIAL SHOWER (ALL MODELS)

# FLOOR PLANS



**WEIGHT** 7710 **LENGTH** 29' 7" **25RESWE**



**WEIGHT** 8200 **LENGTH** 31' 4" **27RLSWE**



**WEIGHT** 8053 **LENGTH** 31' 4" **28SGS**



**WEIGHT** 8370 **LENGTH** 33' 7" **29RDBWE**



**WEIGHT** 8730 **LENGTH** 33' 7" **29RKS**



**WEIGHT** 8618 **LENGTH** 33' 7" **29RES**



**WEIGHT** 8900 **LENGTH** 34' 3" **30RLS**



**WEIGHT** 9207 **LENGTH** 36' 6" **32BHS**



**WEIGHT** 9105 **LENGTH** 36' 2" **32DBH**

# COUGAR *ULTRA-LITE "PLUS"*

HALF-TON TRAVEL TRAILERS

32R1J SHOWN IN CASHMERE DECOR



**Ground Control™ II**  
Automatic Leveling System

## ULTRA-LITE "PLUS" ADVANTAGES

- ✔ 50" LIVING ROOM TV (MOST MODELS)
- ✔ KING BED STANDARD
- ✔ OVERSIZE PANORAMIC WINDOWS THROUGHOUT
- ✔ UPGRADED PULL-OUT FAUCET WITH STAINLESS STEEL UNDER MOUNT SINK
- ✔ UPGRADED SEAMLESS COUNTERTOPS IN GALLEY AND LAVATORY
- ✔ INTERIOR AND EXTERIOR LED LIGHTS
- ✔ STANDARD 15,000 BTU AIR CONDITIONER
- ✔ STANDARD 35,000 BTU FURNACE
- ✔ FOOT FLUSH PORCELAIN TOILET
- ✔ 30 LB. LP BOTTLES
- ✔ UPGRADED EXTERIOR "CAPITAL GRILL" COOKTOP (MOST MODELS)
- ✔ 60 GALLON FRESH TANK CAPACITY
- ✔ FOLDING REAR ACCESSORY RACK FOR BIKE AND REAR TRANSPORT/STORAGE
- ✔ ONE PIECE GELCOAT FIBERGLASS FRONT CAP
- ✔ AUTOMATIC LEVELING JACKS FOR EASY SETUP (MOST MODELS)
- ✔ SLAM LATCH BAGGAGE DOORS
- ✔ ALUMINUM WHEELS WITH E RATED TIRES
- ✔ WALKABLE ROOF WITH REAR WALL LADDER
- ✔ CONVENIENCE CENTER WITH BLACK TANK FLUSH AND SPRAY PORT

# FLOOR PLANS



WEIGHT 5554 LENGTH 26' 4" **22RBSWE**



WEIGHT 6035 LENGTH 28' 9" **24SABWE**



WEIGHT 6112 LENGTH 28' 9" **25BHSWE**



WEIGHT 6593 LENGTH 30' 5" **26RBSWE**



WEIGHT 6565 LENGTH 31' 4" **27RESWE**



WEIGHT 6679 LENGTH 31' 10" **27SABWE**



WEIGHT 6885 LENGTH 34' 6" **29BHSWE**



WEIGHT 7449 LENGTH 33' 9" **29RLDWE**



WEIGHT 7141 LENGTH 34' 8" **30RKSWE**



WEIGHT 7510 LENGTH 35' 2" **31BHKWE**



WEIGHT 7537 LENGTH 35' 10" **32RESWE**



WEIGHT 8319 LENGTH 36' 6" **32RLI**



WEIGHT 8088 LENGTH 35' 10" **33MLS**



WEIGHT 8791 LENGTH 37' 7" **33SAB**

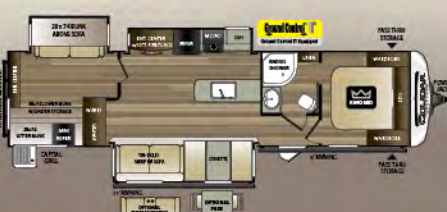

WEIGHT 8548 LENGTH 38' 1" **34TSB**



# STANDARDS & OPTIONS



**MID-PROFILE  
FIFTH WHEELS**



**HALF-TON  
FIFTH WHEELS**



**ULTRA-LITE "PLUS"  
TRAVEL TRAILERS**

CAMPING IN STYLE PACKAGE
Laminated Side Walls with 5 Sided Aluminum Superstructure
3/8" Walkable Roof Decking
Fiberglass Front Cap W/ Hitch Vision & LED Lights
Full Size Spare Tire
Cougar Vintage Maple Glazed Hardwood
Cabinet Doors with Residential Hardware
12,000 BTU Rapid Recovery 6 Gallon Rapid Recovery Gas/Electric Water Heater
16" Aluminum Wheels with 10 Ply "E" Rated Tires
Battery Disconnect Switch
LED Interior and Exterior Lighting
Easy Care Alum-Tread Folding Triple Entry Step
Friction Hinge Entry Door
COUGAR ANNIVERSARY PACKAGE
12 Cubic ft. Refrigerator
1.6 Cubic ft. Microwave Upgrade
Washer/Dryer Prep
21" Drop In Range w/ Piezo Ignition and Glass Stove Top Cover
LG Solid Surface Counter Top Upgrade in Galley
Gourmet Stainless Steel Under Mount Sink with Upgraded Chef's Faucet with Sprayer
Folding Exterior Bike/ Storage Rack with 225LB Capacity
Upgraded Road Armour Suspension Kit
COUGAR COMFORT PACKAGE
15,000 BTU Ducted Air Conditioner
35K BTU Ducted Furnace
Dual 30LB LP Tanks
50 Amp Service, Pre-Wired and Braced for Ducted Bedroom Air Conditioner Option
1000 CFM 4 Speed Maxx Air Exhaust Fan with Rain Sensor and Wall Mounted Controls
DELUXE ENTERTAINMENT/ TECHNOLOGY PACKAGE
50" LED High Definition TV in Living Area
32" LED High Definition TV in Bedroom
12 Volt AM/FM/CD/DVD/MP3/Bluetooth Player
Worry Free Omni Directional Digital TV Antenna with Booster
Exterior TV Hookup with TV Bracket
48" Real Feel 5500 BTU Electric Fireplace with Thermostat Control and Remote
Furrion Backup/Observation Camera Prep
Furrion Portable Solar Panel Prep
12 Volt USB Charging center
Cougar Quick Camp Multifunction Remote
POLAR PACKAGE PLUS
Forced-Air Heated and Enclosed Underbelly
Astrofoil Insulated Slide Floors
Astrofoil Insulated Underbelly
Enclosed Dump Valves
OPTIONAL FEATURES
70 X 80 King Size Bed (70x74 367FLS)
13.5BTU Bedroom A/C (Ducted) With Thermostat
Free Standing Dinette and Chairs (Mandatory on 338RLK)
Dual Pane Frameless Windows
Theater Seats IPO Tri-Fold (369BHS Only)
CSA Construction

CAMPING IN STYLE PACKAGE
Laminated Side Walls with 5 Sided Aluminum Superstructure
3/8" Walkable Roof Decking
Fiberglass Front Cap W/ Hitch Vision & LED Lights
Full Size Spare Tire
Cougar Vintage Maple Glazed Hardwood
Cabinet Doors with Residential Hardware
12,000 BTU Rapid Recovery 6 Gallon Rapid Recovery Gas/Electric Water Heater
15" Aluminum Wheels with 10 Ply "E" Rated Tires
Battery Disconnect Switch
LED Interior and Exterior Lighting
Easy Care Alum-Tread Folding Triple Entry Step
Friction Hinge Entry Door
HALF TON FW ANNIVERSARY PACKAGE
8 Cubic ft. Refrigerator
.9 Cubic ft. Microwave
21" Drop In Range w/ Piezo Ignition and Glass Stove Top Cover
Foil Wrap Seamless Galley and Lavatory Counter tops
Gourmet Stainless Steel Under Mount Sink with Upgraded Chef's Faucet with Sprayer
Folding Exterior Bike/ Storage Rack with 225LB Capacity
Cougar Quick Camp Multifunction Remote
Upgraded Road Armour Suspension Kit
HALF TON FW COMFORT PACKAGE
15,000 BTU Ducted Air Conditioner
35K BTU Ducted Furnace
Dual 30LB LP Tanks
50 Amp Service, Pre-Wired and Braced for Ducted Bedroom Air Conditioner Option
POLAR PACKAGE
Forced-Air Heated and Enclosed Underbelly
Astrofoil Insulated Slide Floors
Enclosed Dump Valves
OPTIONAL FEATURES
Electric Rear Stabilizing Jacks
Electric 4 Point Leveling System
Dual Pane Frameless Windows
13.5BTU Bedroom A/C (Ducted) With Thermostat
Free Standing Dinette and Chairs
Fireplaces (NA 25RESWE)
Theater Seat IPO Tri-Fold (25RESWE, 29RDBWE, 32BHSWE, 32DBHWE Only)
Theater Seat IPO Recliners (29RESWE Only)
CSA Construction

CAMPING IN STYLE PACKAGE
Laminated Side Walls with 5 Sided Aluminum Superstructure
3/8" Walkable Roof Decking
Fiberglass Front Cap W/ Hitch Vision & LED Lights
Full Size Spare Tire
Cougar Vintage Maple Glazed Hardwood
Cabinet Doors with Residential Hardware
12,000 BTU Rapid Recovery 6 Gallon Rapid Recovery Gas/Electric Water Heater
15" Aluminum Wheels with 10 Ply "E" Rated Tires
Battery Disconnect Switch
LED Interior and Exterior Lighting
Easy Care Alum-Tread Folding Triple Entry Step
Friction Hinge Entry Door
HALF TON TT ANNIVERSARY PACKAGE
8 Cubic ft. Refrigerator
.9 Cubic ft. Microwave
21" Drop In Range w/ Piezo Ignition and Glass Stove Top Cover
Foil Wrap Seamless Galley and Lavatory Counter tops
Gourmet Stainless Steel Under Mount Sink with Upgraded Chef's Faucet with Sprayer
Folding Exterior Bike/ Storage Rack with 225LB Capacity
HALF TON TT COMFORT PACKAGE
15,000 BTU Ducted Air Conditioner
35K BTU Ducted Furnace
Dual 30LB LP Tanks
POLAR PACKAGE PLUS
Forced-Air Heated and Enclosed Underbelly
Astrofoil Insulated Slide Floors
Astrofoil Insulated Underbelly
Enclosed Dump Valves
OPTIONAL FEATURES
Electric Rear Stabilizing Jacks (Mandatory 22RBSWE, 24SABWE, 25BHSWE Only)
Automatic Leveling System (Mandatory All Models Except 22RBSWE, 24SABWE, 25BHSWE)
Dual Pane Frameless Windows
Fireplace (32RESWE, 32RLI, 33MLS, 33SAB, 34TSB)
Free Standing Dinette and Chairs
Theater Seat IPO Tri-Fold (24SABWE, 25RESWE, 26RBSWE, 27RESWE, 29BHSWE, 29RDBWE)
Theater Seat IPO Recliners (32RESWE, 30RKSWE)
Theater Seats IPO Dinette (22RBSWE)
CSA Construction

Standard features and options are subject to change without notice.

## DECOR OPTIONS

CASHMERE



TWIG



# COUGAR



## STAY IN TOUCH



Cougar is always just a touch away. You'll find 360 virtual tours, location of your nearest dealer, photos, videos and all of the latest information about Cougar on our easy to navigate website. Everything you need can be accessed anytime, day or night, from home or on the road. You can also find us on the Keystone RV facebook.



## BUY LOCALLY

### PURCHASING YOUR RV LOCALLY

It's up to you where you purchase your new Cougar, but may we suggest your local dealer? Not only does it help your local economy and provide jobs, but it will also give you an opportunity to develop a service relationship with someone that will come to know you and your coach. Congratulations on finding the best built, best equipped and best value in the industry.

YOUR LOCAL DEALER IS:

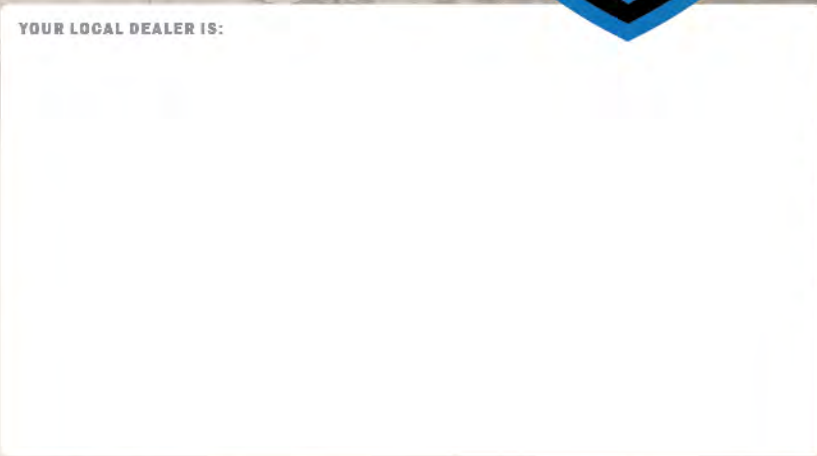

**COUGAR**  
by Keystone  
[www.keystonerv.com/Cougar](http://www.keystonerv.com/Cougar)



Go RVing.



DISCLAIMER: Product information is as accurate as possible as of the date of publication of this brochure. All features, floor plans, and specifications in this brochure are subject to change without notice. Please also consult Keystone's web site at [www.keystonerv.com](http://www.keystonerv.com) for more current product information and specifications. Tow Vehicle Disclaimer: CAUTION: Owners of Keystone recreational vehicles are solely responsible for the selection and proper use of tow vehicles. All customers should consult with a motor vehicle manufacturer or their dealer concerning the purchase and use of suitable tow vehicles for Keystone products. Keystone disclaims any liability or damages suffered as a result of the selection, operation, use or misuse of a tow vehicle. KEYSTONE'S LIMITED WARRANTY DOES NOT COVER DAMAGE TO THE RECREATIONAL VEHICLE OR THE TOW VEHICLE AS A RESULT OF THE SELECTION, OPERATION, USE OR MISUSE OF THE TOW VEHICLE. \*REFERENCE KEYSTONE RV COMPANY OWNERS MANUAL FOR LIMITED WARRANTY DETAILS. \*Length is defined as the distance from the centerline of hitch pin/coupler to rear bumper of trailer.



FEBRUARY 2018