



GAZELLE  
MICRO-LITE TRAILER



STAMPEDE  
ULTRA-LITE EXPANDABLE TRAILER



THOROUGHBRED  
ULTRA-LITE TRAVEL TRAILER



THOROUGHBRED  
ULTRA-LITE FIFTH WHEELS  
& ELITE TRAVEL TRAILERS

08

ULTRA-LITE  
TRAVEL TRAILERS &  
FIFTH WHEELS



# GAZELLE MICRO-LITE TRAVEL TRAILERS



G-178QB Shown with Slate Decor



GAZELLE  
MICRO-LITE TRAILER



STAMPEDE  
ULTRA-LITE EXPANDABLE  
TRAILER



THOROUGHBRED  
ULTRA-LITE TRAVEL TRAILER



THOROUGHBRED  
ULTRA-LITE FIFTH WHEELS  
& ELITE TRAVEL TRAILERS





G-178QB Shown with Slate Decor



G-178QB Shown with Slate Decor



G-178QB Shown with Burgundy Decor



**B**ound off to your next adventure with the light and agile Gazelle. This ultra lightweight travel trailer tows swiftly and gracefully just like its namesake. The interior is designed with beautiful efficiency that incorporates comfort and convenience to keep your family happy and focused on the fun. From queen size beds to full size bathrooms and well-equipped kitchens, the Gazelle offers everything you need in a lightweight, ready-to-go package.

## DECOR OPTIONS



Burgundy



Slate



Green





GAZELLE  
MICRO-LITE TRAILER



STAMPEDE  
ULTRA-LITE EXPANDABLE  
TRAILER



THOROUGHbred  
ULTRA-LITE TRAVEL TRAILER



THOROUGHbred  
ULTRA-LITE FIFTH WHEELS  
& ELITE TRAVEL TRAILERS

## GAZELLE MICRO-LITE TRAVEL TRAILERS STANDARDS AND OPTIONS

### STANDARDS

- 14" Tires
- 20,000 BTU Suburban Furnace
- 45 AMP Converter with Battery Charger
- A & E Awning
- Aluminum Framed Superstructure
- B.A.L. Jacks with Sand Pads (4)
- Crowned Back Dinette Seats (N/A On G-158 and G-178 FD)
- Dometic® Refrigerator – 6 Cu.Ft.
- EPDM Rubber Roof
- Exterior Fiberglass Surface
- Outside Marine Grade Speakers
- Outside Service Lights (3)
- Outside Shower
- Oversized Bathroom Skylight
- Six Gallon Gas/Elec. DSI Water Heater
- Spare Tire, Bracket and Molded Cover
- Tinted Safety Glass Windows
- Torsion Axle, Independent Suspension
- Tub Shower Surround
- TV Antenna/Cable/Sat./Phone Ready
- Two - 20 lb. LP Gas Bottles with Molded Cover
- Vacuum Bonded Laminated Construction
- Window Shades and Vented Bed End Curtains

### OPTIONS

- Air Conditioner (13,500 BTU)
- Air Conditioner (Low Profile 13,500 BTU)
- Aluminum Wheels
- AM/FM CD Player\*
- Backup Camera
- Counter Top Extension
- Create-A-Breeze™ Fan (Mandatory Option)
- DVD Player with Theater Sound and TV
- DVD Player with Theater Sound
- Diamond Plate Front
- M and T Raised Panel Cabinet Doors (Mandatory Option)
- Mattress Upgrade (N/A on G-158 and G-178 FD)
- Microwave\*
- Outside Gas Grill\*
- Raised Refer Door Upgrade (6 Panel)
- Roof Ladder
- Sliding A.B.S. Storage Tray
- Solar Panel (5-Watt)
- Slide Topper Awning (G-212, G-215 and G-230 Only)
- Stainless Steel Package (Refer Panel Included)
- Thule® Pod System\*
- Three-Burner Range with Oven\*
- Water Purifier\*

*\*Included in Travel Package*







# STAMPEDE ULTRA-LITE EXPANDABLE TRAVEL TRAILERS



GAZELLE  
MICRO-LITE TRAILER



STAMPEDE  
ULTRA-LITE EXPANDABLE  
TRAILER



THOROUGHBRED  
ULTRA-LITE TRAVEL TRAILER



THOROUGHBRED  
ULTRA-LITE FIFTH WHEELS  
& ELITE TRAVEL TRAILERS

S-21 RGS Shown with Stone Decor





S-232 Shown with Green Decor



▼ Kitchens are fully equipped with large size appliances, and extra storage is designed into each unit.



DECOR OPTIONS



Slate



Stone



Green



Espresso



Burgundy



S-232

When you're looking for fun, the Stampede lets you head out in a hurry. This ultra lite hybrid travel trailer is built for easy towing with an all-aluminum superstructure and aerodynamic design. Expandable bed ends and slide-outs transform the comfortable interior into ample living space loaded with popular features and amenities.





## STAMPEDE ULTRA-LITE EXPANDABLE TRAILERS STANDARDS AND OPTIONS

### STANDARDS

- 14" Tires
- 20,000 BTU Suburban Furnace
- 4" Tubular Steel Frame – E-Coat (S-17 and S-176 Only)
- 45 AMP Converter with Battery Charger
- A & E Awning
- Aluminum Framed Superstructure
- B.A.L. Jacks with Sand Pads (4)
- Bunk Light with Fan (1)
- Crowned Back Dinette Seats
- Dometic® Refrigerator
- Double Entry Step
- Ducted Roof Air Ready (N/A on S-17)
- Electric Slide-out System (N/A on S-17, S-176 and S-195 SD)
- EPDM Rubber Roof
- Exterior Fiberglass Surface
- I-Beam Frame – E-Coat (N/A on S-17)
- Outside Marine Grade Speakers
- Outside Service Lights (3)
- Outside Shower
- Oversized Bathroom Skylight
- Patio Light
- Satellite Ready
- Six Gallon Gas/Elec. DSI Water Heater
- Spare Tire, Bracket and Molded Cover
- Stove Cover
- Tinted Safety Glass Windows
- Torsion Axle, Rubber Ryde Suspension
- Tub Surround In Shower

- TV Antenna/Cable/Sat./Phone
- Two - 20 lb. LP Gas Bottles with Molded Cover
- Vacuum Bonded Laminated Construction
- Window Shades and Vented Bed End Curtains

### OPTIONS

- Air Conditioner (13,500 BTU)
- Air Conditioner (Low Profile 13,500 BTU)
- Aluminum Wheels
- AM/FM CD Player\*
- Backup Camera
- Counter Top Extension
- Create-A-Breeze™ Fan (Mandatory Option)
- Diamond Plate Front
- DVD Player W/ Theater Sound
- DVD Player W/ Theater Sound and TV
- M and T Raised Panel Cabinet Doors (Mandatory Option)
- Microwave\*
- Outside Gas Grill\*
- Raised Refer Door Upgrade (6 Panel)
- Roof Ladder
- Slide Topper Awning (N/A on S-17, S-176 and S-195 SD)
- Sliding A.B.S. Storage Tray
- Solar Panel (5-Watt)
- Stainless Steel Package (Refer Panel Incl.)
- Three-Burner Range with Oven\*
- Thule® Pod System\*
- Water Purifier

\*Included in Travel Package



GAZELLE  
MICRO-LITE TRAILER



STAMPEDE  
ULTRA-LITE EXPANDABLE  
TRAILER



THOROUGHbred  
ULTRA-LITE TRAVEL TRAILER



THOROUGHbred  
ULTRA-LITE FIFTH WHEELS  
& ELITE TRAVEL TRAILERS





# FLOORPLANS

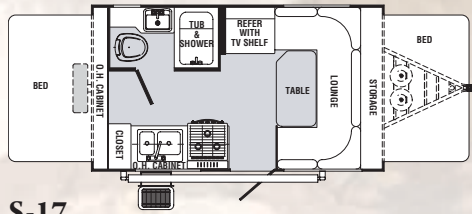

S-17

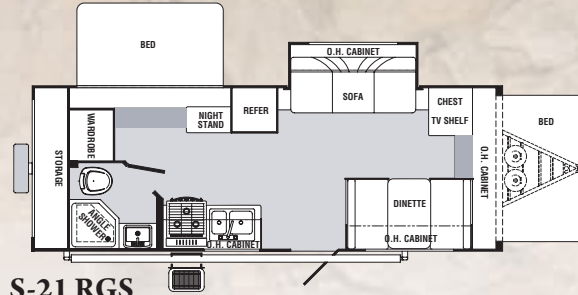

S-21 RGS

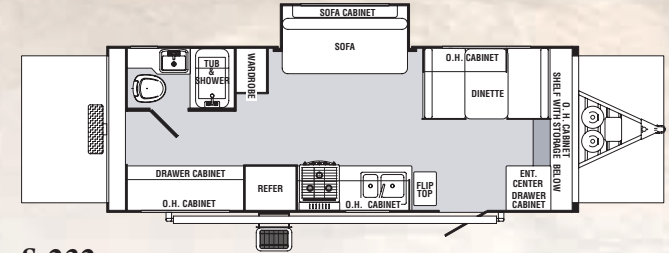

S-232

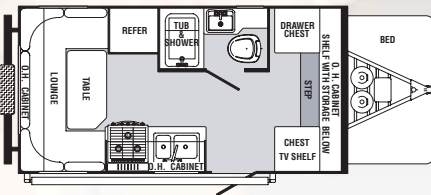

S-176

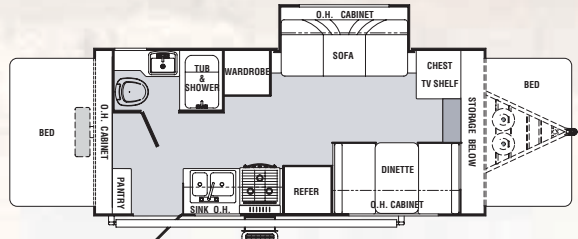

S-21 SDSL

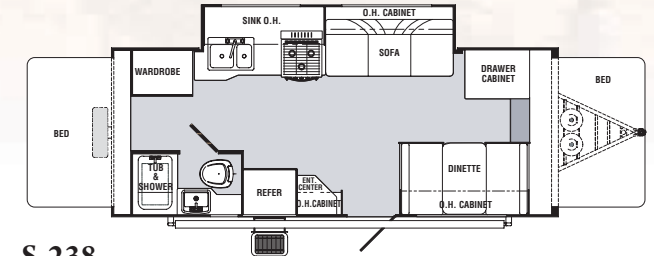

S-238

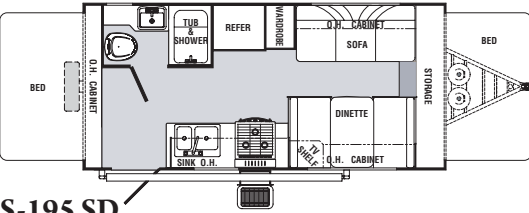

S-195 SD

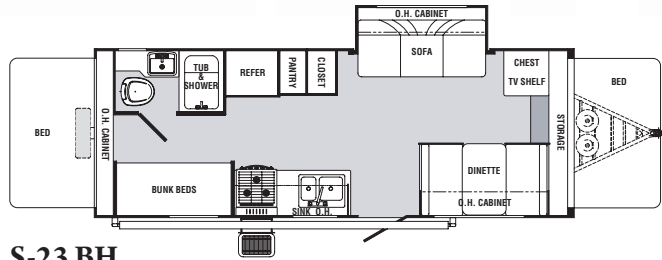

S-23 BH

STAMPEDE	S-17	S-176	S-195 SD	S-21 RGS	S-21 SDSL	S-23 BH	S-232	S-238
Hitch Dry Weight	340 lbs.	482 lbs.	271 lbs.	424 lbs.	444 lbs.	364 lbs.	317 lbs.	411 lbs.
Dry Axle Weight	2407 lbs.	2262 lbs.	3196 lbs.	3748 lbs.	3402 lbs.	3663 lbs.	3861 lbs.	3735 lbs.
Total Dry Weight	2747 lbs.	2744 lbs.	3467 lbs.	4172 lbs.	3846 lbs.	4027 lbs.	4178 lbs.	4146 lbs.
GVWR	3902 lbs.	4023 lbs.	5762 lbs.	6558 lbs.	6243 lbs.	5632 lbs.	5668 lbs.	6552 lbs.
Interior Height	76"	76"	76"	76"	76"	76"	76"	76"
Exterior Height	101"	101"	101"	101"	101"	101"	101"	101"
Exterior Width	96"	96"	96"	96"	96"	96"	96"	96"
Travel Length	17' 4"	19' 4"	20' 3"	25' 3"	21' 8"	25' 2"	25' 2"	23' 8"
Open Length	20' 10"	19' 0"	23' 7"	25' 3"	25' 2"	29'	29'	27' 5"
Fresh Water	38 Gals.	38 Gals.	38 Gals.	38 Gals.	38 Gals.	38 Gals.	38 Gals.	38 Gals.
Grey Water	31 Gals.	31 Gals.	31 Gals.	31 Gals.	31 Gals.	31 Gals.	31 Gals.	31 Gals.
Black Water	28 Gals.	28 Gals.	28 Gals.	28 Gals.	28 Gals.	32 Gals.	28 Gals.	28 Gals.





# THOROUGHBRED ULTRA-LITE TRAVEL TRAILERS

T-265 Shown with Burgundy Decor



GAZELLE  
MICRO-LITE TRAILER



STAMPEDE  
ULTRA-LITE EXPANDABLE  
TRAILER



THOROUGHbred  
ULTRA-LITE TRAVEL TRAILER



THOROUGHbred  
ULTRA-LITE FIFTH WHEELS  
& ELITE TRAVEL TRAILERS



T-26 BHSL Shown with Green Decor



T-26 BHSL Shown with Green Decor



T-265 Shown with Burgundy Decor



T-265 Shown with Burgundy Decor

Beautifully furnished interiors provide pleasing eye appeal with quality and durability to match. Numerous built-in features enhance the livability of each unit. A variety of floor plan choices ensures a perfect fit for your family.



Sleek, strong, and graceful describes this Thoroughbred line of exceptional lightweight travel trailers. Their aerodynamic design, strong aluminum superstructure, and easy handling and towing characteristics make these units remarkably road worthy for families on the go. The spacious interiors are fully furnished for comfort and convenience.

DECOR OPTIONS



Slate



Stone



Green



Espresso

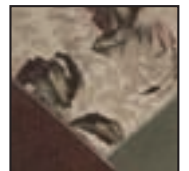

Burgundy







# THOROUGHBRED ULTRA-LITE TRAVEL TRAILERS STANDARDS AND OPTIONS



GAZELLE  
MICRO-LITE TRAILER



STAMPEDE  
ULTRA-LITE EXPANDABLE  
TRAILER



THOROUGHBRED  
ULTRA-LITE TRAVEL TRAILER



THOROUGHBRED  
ULTRA-LITE FIFTH WHEELS  
& ELITE TRAVEL TRAILERS

## STANDARDS

- 14" Tires
- 20,000 BTU Suburban Furnace
- 45 AMP Converter with Battery Charger
- A & E Awning
- Aluminum Framed Superstructure
- B.A.L. Jacks with Sand Pads (4)
- Dometic® 6 Cu. Ft. Refrigerator – Double Door
- Double Entry Step
- Electric Slide-Out System
- EPDM Rubber Roof
- Exterior Fiberglass Surface
- I-Beam Frame (E-Coat)
- Outside Marine Grade Speakers
- Outside Service Lights (3)
- Outside Shower
- Oversized Bathroom Skylight
- Patio Light
- Roof Air Ready – Ducted
- Six Gallon Gas/Elec. DSI Water Heater
- Spare Tire, Bracket and Molded Cover
- Stove Cover
- Tinted Safety Glass Windows
- Torsion Axle, Independent Suspension
- Tub/Shower Surround
- TV Antenna/Cable/Sat./Phone Ready
- Two 20 lb. LP Gas Bottles with Molded Cover
- Vacuum Bonded Laminated Construction

## OPTIONS

- Air Conditioner (13,500 BTU)
- Air Conditioner (Low Profile 13,500 BTU)
- Aluminum Wheels
- AM/FM CD Player\*
- Backup Camera
- Counter Top Extension
- Create-A-Breeze™ Fan (Mandatory Option)
- Diamond Plate Front
- DVD Player with Theater Sound
- DVD Player with Theater Sound and TV
- M and T Raised Panel Cabinet Doors
- Microwave\*
- Outside Gas Grill\*
- Pillow Top Mattress Upgrade
- Raised Refer Door Upgrade (6 Panel)
- Roof Ladder
- Slide Topper Awning
- Sliding A.B.S. Storage Tray
- Solar Panel (5 - Watt)
- Stainless Steel Package (Refer. Panel Included)
- Three-Burner Range with Oven\*
- Thule® Pod System\*
- Water Purifier\*

*\*Included in Travel Package*





# FLOORPLANS

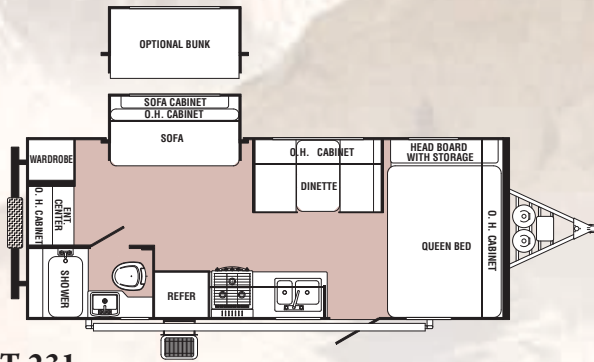

T-231

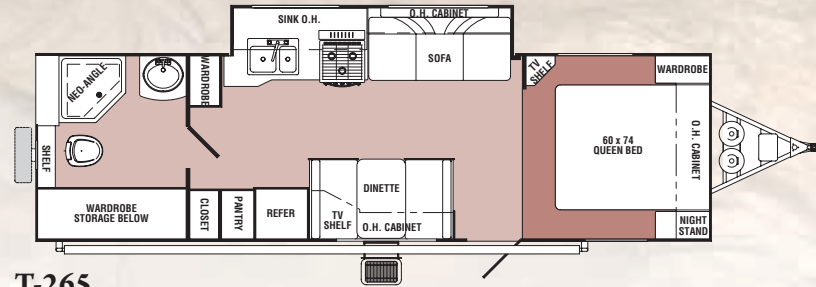

T-265

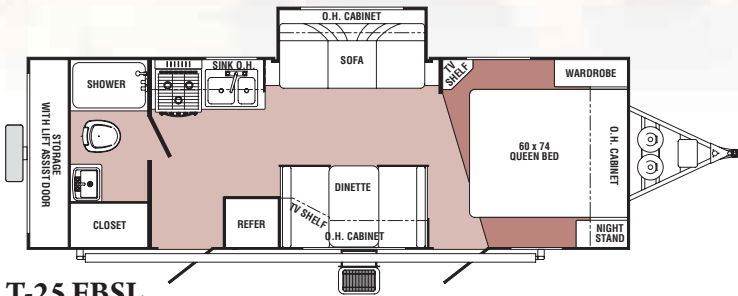

T-25 FBSL

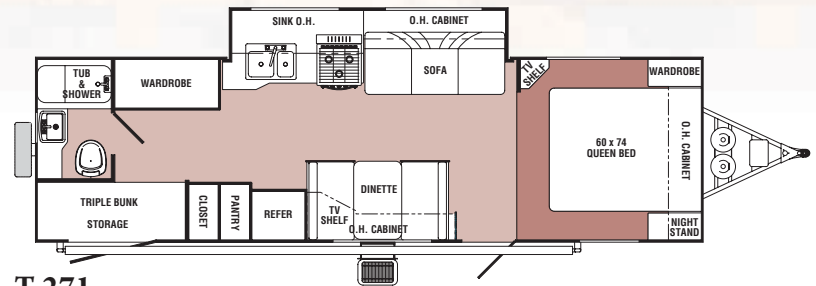

T-271

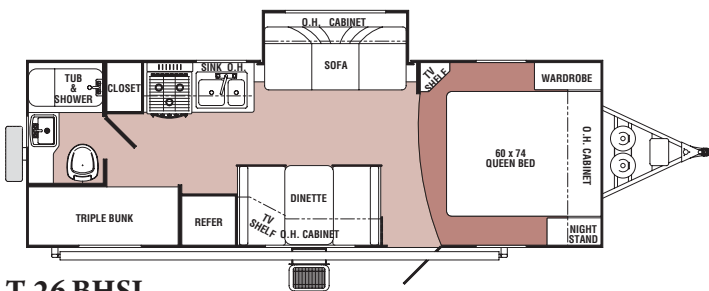

T-26 BHSL

THOROUGHbred	T-231	T-25 FBSL	T-26 BHSL	T-265	T-271
Hitch Dry Weight	358 lbs.	269 lbs.	479 lbs.	410 lbs.	379 lbs.
Dry Axle Weight	3393 lbs.	4033 lbs.	3817 lbs.	4612 lbs.	4600 lbs.
Total Dry Weight	3751 lbs.	4302 lbs.	4296 lbs.	5022 lbs.	4979 lbs.
GVWR	7358 lbs.	6672 lbs.	6643 lbs.	7426 lbs.	7393 lbs.
Interior Height	76"	76"	76"	76"	76"
Exterior Height	101"	101"	101"	101"	101"
Exterior Width	96"	96"	96"	96"	96"
Travel Length	26' 6"	27' 10"	26' 9"	31' 2"	31' 2"
Fresh Water Cap. - Under Floor Tank	38 Gals.	38 Gals.	38 Gals.	32 Gals.	32 Gals.
Gray Water Cap. - Under Floor Tank	31 Gals.	31 Gals.	31 Gals.	64 Gals.	64 Gals.
Black Water Cap. - Under Floor Tank	28 Gals.	28 Gals.	28 Gals.	32 Gals.	32 Gals.



# THOROUGHBRED ULTRA-LITE FIFTH WHEELS & ELITE TRAVEL TRAILERS



GAZELLE  
MICRO-LITE TRAILER



STAMPEDE  
ULTRA-LITE EXPANDABLE  
TRAILER



THOROUGHBRED  
ULTRA-LITE TRAVEL TRAILER



THOROUGHBRED  
ULTRA-LITE FIFTH WHEELS  
& ELITE TRAVEL TRAILERS

F-830 RE Shown with Espresso Decor



F-830 RE Shown with Espresso Decor



SPECIFICATIONS	THOROUGHBRED ELITE TRAVEL TRAILERS			THOROUGHBRED FIFTH WHEELS				
	T-829 QBS	T-829 RES	T-829 RBS	F-829 RL	F-829 BH	F-829 RK	F-830 RE	F-830 RKS
<b>Hitch Dry Weight</b>	707 lbs.	698 lbs.	TBD	1366 lbs.	1318 lbs.	1142 lbs.	1296 lbs.	1296 lbs.
<b>Dry Axle Weight</b>	5644 lbs.	5221 lbs.	TBD	4523 lbs.	4969 lbs.	4887 lbs.	5108 lbs.	4990 lbs.
<b>Total Dry Weight</b>	6351 lbs.	5919 lbs.	TBD	5889 lbs.	6287 lbs.	6029 lbs.	6404 lbs.	6286 lbs.
<b>Carrying Capacity</b>	7607 lbs.	7698 lbs.	TBD	2113 lbs.	1667 lbs.	1749 lbs.	1529 lbs.	1647 lbs.
<b>GVWR</b>	7607 lbs.	7726	TBD	8366 lbs.	8318 lbs.	8142 lbs.	8296 lbs.	8296 lbs.
<b>Interior Height</b>	76"	76"	76"	6' 6"	6' 6"	6' 6"	6' 6"	6' 6"
<b>Exterior Height</b>	101"	101"	101"	11' 10"	11' 10"	11' 10"	11' 10"	11' 10"
<b>Exterior Width</b>	96"	96"	96"	96"	96"	96"	96"	96"
<b>Travel Length</b>	33' 5"	33' 5"	TBD	30' 5"	30' 5"	30' 5"	31' 6"	31' 6"
<b>Fresh Water Capacity</b>	32 Gals.	32 Gals.	TBD	38 Gals.	38 Gals.	38 Gals.	38 Gals.	38 Gals.
<b>Gray Water Capacity</b>	31 Gals.	62 Gals.	TBD	36 Gals.	72 Gals.	72 Gals.	72 Gals.	72 Gals.
<b>Black Water Capacity</b>	28 Gals.	28 Gals.	TBD	36 Gals.	36 Gals.	36 Gals.	36 Gals.	36 Gals.



## FIFTH WHEELS

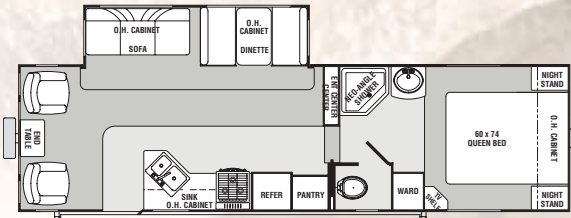

F-829 RL

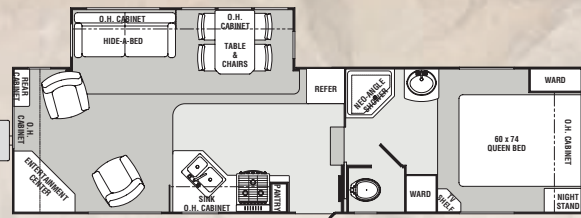

F-830 RE

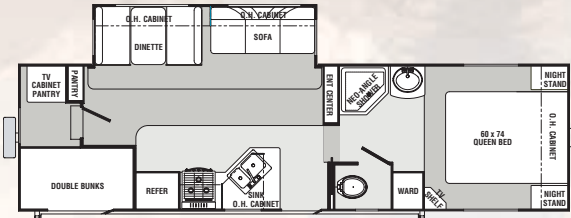

F-829 BH

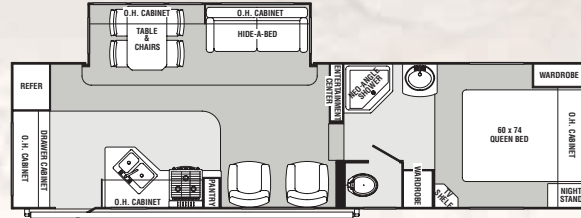

F-830 RKS

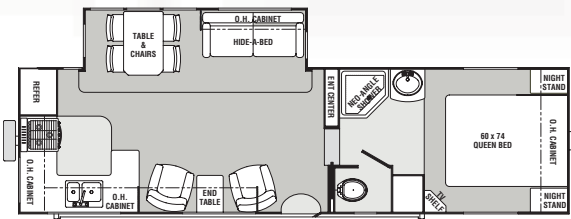

F-829 RK

## ELITE TRAVEL TRAILERS

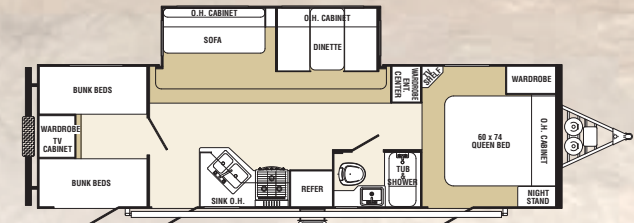

T-829 QBS

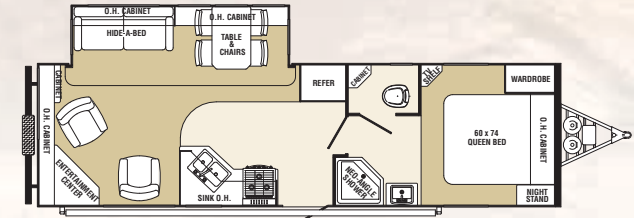

T-829 RES

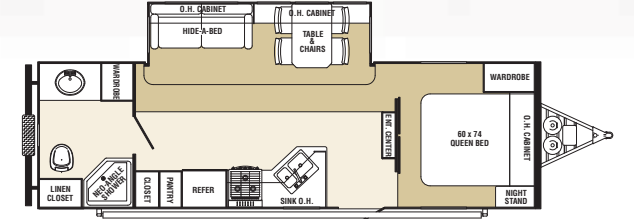

T-829 RBS

## DECOR OPTIONS



Slate



Stone



Green



Espresso



Burgundy

## THOROUGHbred STANDARDS & OPTIONS

### STANDARDS

- 15" Tires (14" on Travel Trailers)
- 30,000 BTU Suburban Furnace
- A & E Electric Awning
- Aluminum Framed Superstructure
- Bathroom Skylight
- CD/DVD/MP3 Player w/5.1 Dolby® Surround Sound
- China Toilet with Spray Attachment
- 60 AMP Converter with Battery Charger
- Day/Night Shades
- Dometic® 6 Cu. Ft. Refrigerator-Double Door
- Ducted Roof Air Ready
- Electric Slide-Out System
- EPDM Rubber Roof
- Exterior Fiberglass Surface
- Folding Entry Assist Handle
- Free Standing Table with Chairs (Opt. on F-829 RL, F-829 BH, T-829 QBS, F-830 BHS and T-829 RES)
- Heated Holding Tanks

- Hide-A-Bed Sofa (Opt. on F-829 RL, F-829 BH, T-829 QBS, F-830 BHS and T-829 RES)
- I - Beam Frame
- M and T Raised Panel Cabinet Doors
- Neo-Angle Shower
- Outside Marine Grade Speakers
- Outside Service Lights (3)
- Outside Shower
- Patio Light and (2) Scare Lights
- Pillow Shams
- Pillow Top Mattress
- Six Gallon Gas/Elec. DSI Water Heater
- Solarium Windows (Opt. on F-829 RL, F-829 BH, T-829 QBS, F-830 BHS and T-829 RES)
- Spare Tire, Bracket and Molded Cover
- Stove Cover
- Tinted Safety Glass Windows
- Torsion Axle, Independent Suspension
- Triple Entry Step
- Tub Surround - One Piece
- TV Antenna/Cable/Sat./Phone Ready

- Two - 30 lb. LP Gas Bottles with Molded Cover
- Vacuum Bonded Laminated Construction

### OPTIONS

- Air Conditioner (13,500 BTU)
- Air Conditioner (Low Profile 13,500 BTU)
- Aluminum Wheels
- Backup Camera
- Counter Top Extension
- Create-A-Breeze™ Fan
- Electric Awning (Mandatory Option)
- Free Standing Table with Chairs (Std. on F-829 RK, F-830 RE, F-830 RKS and T-829 RBS)
- Hide-A-Bed Sofa (Std. on F-829 RK, F-830 RE, F-830 RKS and T-829 RBS)
- Microwave\*
- Outside Gas Grill\*
- Raised Refer Door Upgrade (6 Panel)
- Roof Ladder
- Slide Topper Awning
- Solar Panel (5-Watt)

- Solarium Windows (Std. on F-829 RK, F-830 RE, F-830 RKS and T-829 RBS)
- Stainless Steel Package (Refer Panel Incl.)
- Three-Burner Range with Oven\*
- Thule® Pod System\*
- Water Purifier\*

\*Included in Travel Package



▲ Tinted Residential Style Solarium Windows



# PALOMINO

ULTRA-LITE

# 08

## TRAVEL TRAILERS & FIFTH WHEELS

### Palomino RV Encourages You to Buy Locally

Palomino RV strongly encourages our retail customers to purchase from their local dealership whenever possible due to the following factors:

- Our Dealers are, as a rule, independently owned and operated businesses. Outside of those customers they personally sold products to, they are not contractually obligated to perform warranty service on Palomino products that were purchased elsewhere. There **may** be an occasion that you would be required to return to the point of purchase to satisfy warranty requirements.
- Although many dealerships will eventually service products not purchased at their place of business, they will usually take care of their customers and other Palomino customers who are traveling away from their local dealer as they would their own.
- Local purchases allow a customer to establish a relationship with a dealer close to home. This relationship provides the customer with a convenient location for service and support from a "home town" professional.

- The opportunity for a thorough PDI (Pre-Delivery Inspection) and product orientation is an additional benefit of buying from your local dealer, further providing the opportunity for refresher courses or the ability to get questions answered much more conveniently.
- For our Canadian customers, there are also requirements which must be met to bring an RV purchased out of the country to their home. Although not insurmountable, these requirements may involve such things as additional inspections and certifications, taxes and fees. Your local Canadian Dealer is a professional at meeting these requirements.

Palomino RV's goal is for all RV Owners to fully enjoy their RV experience. In light of this goal, and considering the advantages of buying local, we encourage you to be thorough when determining what product to purchase and which dealer to purchase it from as both are key to your ultimate satisfaction and the realization of your dreams.



Free Emergency Roadside Assistance Service  
Administered by Coach-Net<sup>®</sup>.  
Ask your dealer for more information.

Dealer



### Palomino RV

1047 East M-86 • Colon, MI 49040

Phone: (269) 432-3271 • Fax: (269) 432-2516

[www.palominorv.com](http://www.palominorv.com)

### WARRANTY

**TENT WARRANTY** – Vinyl tents manufactured by Palomino RV are warranted for 5 years to the original owner. Free from defect in materials and workmanship under normal use and service.

EPDM Rubber Roof – 12 Years

Frame – 5 Years

Fiberglass Skin – 2 Years

AL-KO Torsion Axle – 5 Years

General Camper Coverage – 1 Year

Structural – 2 Years

All illustrations and specifications contained in this literature are based on the latest product information at time of publication. Forest River reserves the right to make changes in prices, colors, materials, equipment and specifications at anytime, without notice, and assumes no responsibility for any error in this literature. All units are shipped F.O.B. point of manufacture.

Palomino Travel Trailers and Fifth Wheels are designed to meet the varied needs of the customer. It is the responsibility of the owner to select the proper load combination for their individual needs without exceeding the listed axle weight capacities.