

# ALPINE

LUXURY FIFTH WHEELS



KEYSTONE  
RV COMPANY

CAMP BETTER

# ALPINE

## WHERE LUXURY IS NOT AN OPTION – IT'S STANDARD

One of the country's fastest growing, most exciting luxury fifth wheel brands, Alpine is crafted for campers who expect the very best. Driven to deliver an exceptional experience, features like iN-Command™ smart RV controls, exceptional solar power, season-extending weather protection, and premium construction are all part of Alpine's no-compromises standard equipment. With its unique 100" wide body, 6' 10" tall Summit slide rooms, and frameless panoramic windows, Alpine gives owners more spacious living than other luxury RV lines.

Find out for yourself why more and more discriminating RV owners are choosing Alpine.

### State-of-the-art appointments:

- 12" I-beam frame & 100" wide body
- Road Armor™ shock-absorbing suspension & hitch pin
- Dexter® heavy duty 7,000 lb axles w/ Nev-R-Adjust brakes
- SolarFlex™ 200, 400i or 600i-L solar power
- iN-Command® Generation 3 w/ Global Connect™
- Programmable, dual-zone temperature control
- 16,500 BTU electric heat pump
- On-demand water heater
- Premium hardwood cabinet doors, drawer fronts, framing, and slide fascia
- Premium sound system with zone control
- Super Cinema entertainment center
- Solid surface countertops w/ extra deep kitchen sink
- Insignia® appliance package w/ convection microwave
- Central vacuum
- Oversized fireplaces



### Polar Pack Four Season Camping

Camp down to -14° with superior whole coach insulation, fully heated & enclosed underbelly and tanks wrapped with industry's highest rated heat pads. See website for details.



### Blade PURE™

Engineered to a higher standard, Blade Pure™ removes airborne contaminants, reduces noise, and keeps you cooler than ever before.



### Full Body Paint

Make a statement with gorgeous, automotive-grade full-body paint in Champagne or Black Diamond.

SCAN HERE TO  
LEARN MORE



VISIT [KEYSTONERV.COM/ALPINE](http://KEYSTONERV.COM/ALPINE) FOR IN-DEPTH PRODUCT INFORMATION, VIDEOS, MODEL 360'S AND MORE.

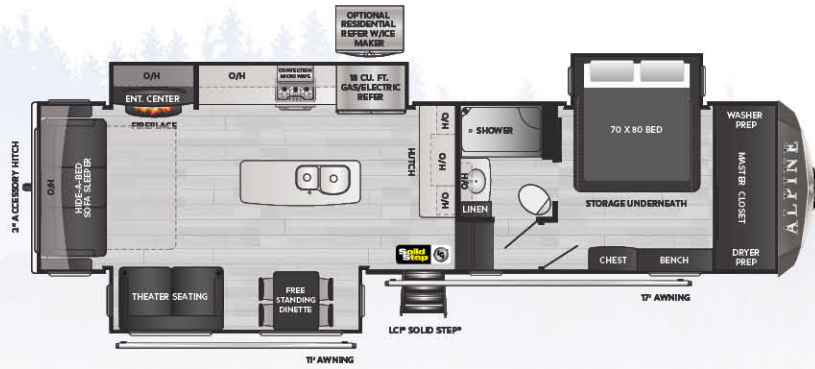

**3220RL** | Rear living, mid-kitchen, master closet  
**WEIGHT 12500 LENGTH 36' 10"**

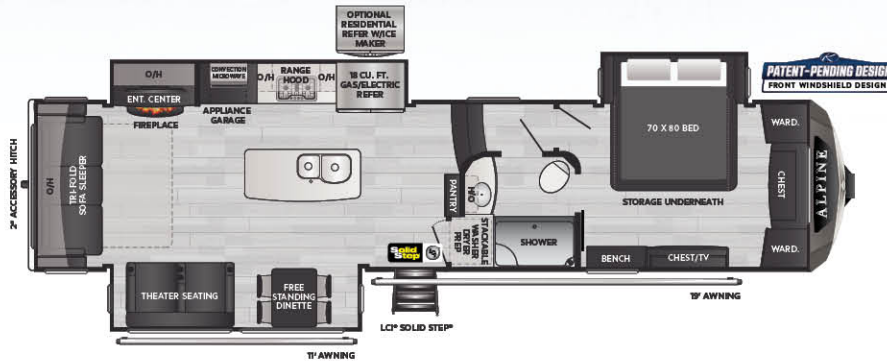

**3650RL** | Rear living, range hood, front windshield  
**WEIGHT 12713 LENGTH 38' 8"**

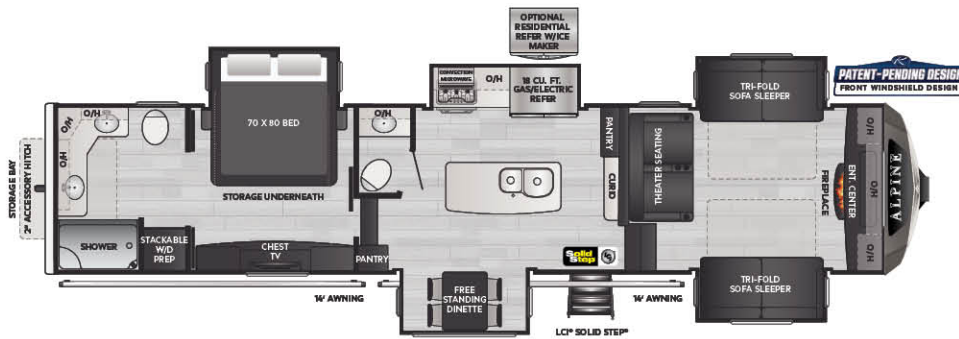

**3700FL** | Front living, 1 1/2 bath, master suite, front windshield  
**WEIGHT 13944 LENGTH 41' 6"**

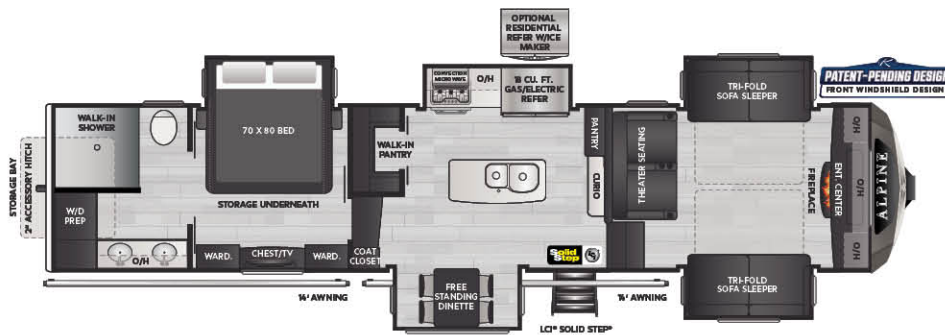

**3712KB** | Front living, walk-in pantry, master suite  
**WEIGHT 14013 LENGTH 41' 6"**

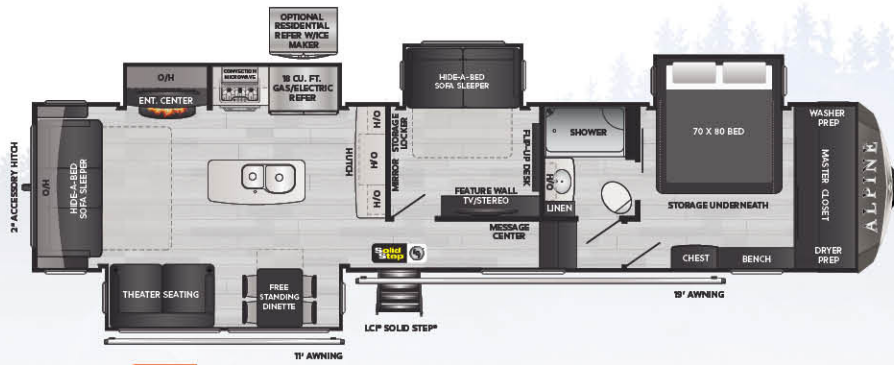

**NEW!**  
**3720MD**

Rear living, bonus room, four slides  
WEIGHT TBD LENGTH 41' 6"

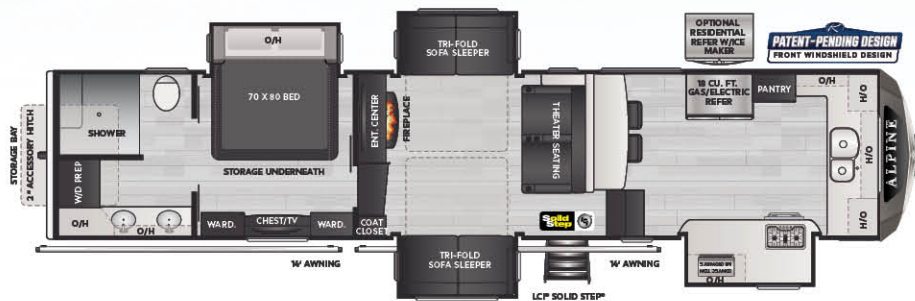

**3790FK**

Front kitchen, four slides, master suite  
WEIGHT 13508 LENGTH 41' 6"

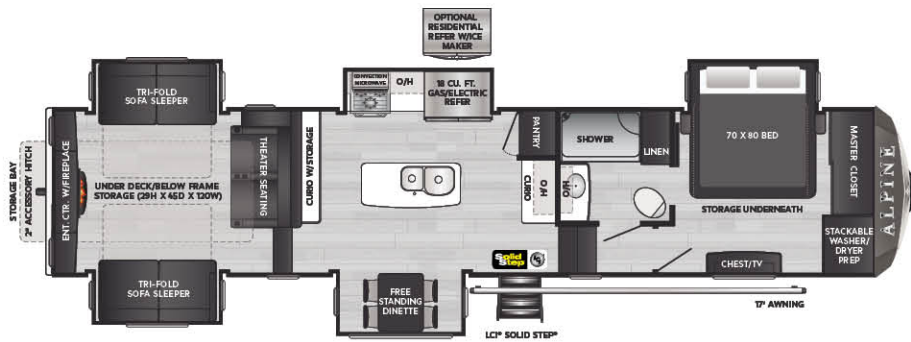

**3850RD**

Rear den, five slides, oversized storage tray  
WEIGHT 13972 LENGTH 41' 5"

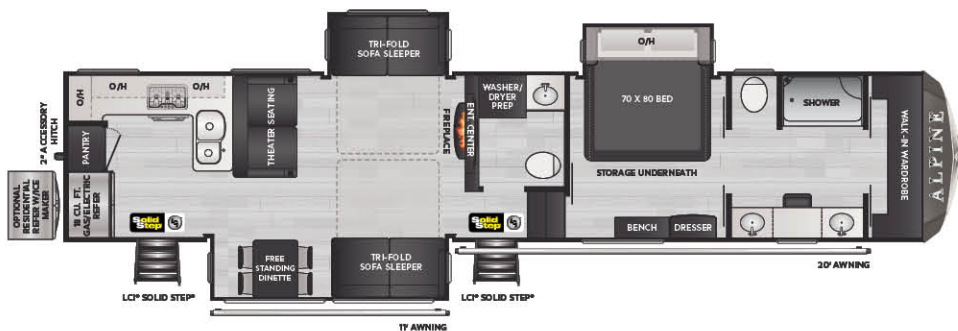

**3910FK**

Rear kitchen, 1 & 1/2 bath, front bath master suite  
WEIGHT 13517 LENGTH 43' 0"



## ALPINE | MODEL SPECIFICATIONS

MODEL	WEIGHT	CARRYING CAPACITY	HITCH WEIGHT	FRESH WATER	WASTE WATER	GRAY WATER	LPG	LENGTH*	WIDTH	HEIGHT	AWNING
3220RL	12500	3000	2470	54	49	83	60	36' 10"	8' 4"	13' 3'	17'/11'
3650RL	12713	2787	2675	54	49	83	60	38' 8"	8' 4"	13' 4"	19'/11'
3700FL	13944	2556	2775	54	78	78	60	41' 6"	8' 4"	13' 4"	14'/14'
3712KB	14013	2487	2810	54	44	78	60	41' 6"	8' 4"	13' 4"	14'/14'
3720MD	TBD	TBD	TBD	54	49	83	60	41' 6"	8' 4"	13' 4"	11'/17'
3790FK	13508	2992	2620	54	44	88	60	41' 6"	8' 4"	13' 4"	14'/14'
3850RD	13972	2528	2745	54	49	83	60	41' 5"	8' 4"	13' 4"	17'
3910RK	13517	2983	2780	54	83	83	60	43' 0"	8' 4"	13' 3"	20'/11'

DISCLAIMER: Product information is as accurate as possible as of the date of publication of this brochure. All features, floor plans, and specifications in this brochure are subject to change without notice. Please also consult Keystone's web site at [www.keystonerv.com](http://www.keystonerv.com) for more current product information and specifications. Tow Vehicle Disclaimer. CAUTION: Owners of Keystone recreational vehicles are solely responsible for the selection and proper use of tow vehicles. All customers should consult with a motor vehicle manufacturer or their dealer concerning the purchase and use of suitable tow vehicles for Keystone products. Keystone disclaims any liability or damages suffered as a result of the selection, operation, use or misuse of a tow vehicle. KEYSTONE'S LIMITED WARRANTY DOES NOT COVER DAMAGE TO THE RECREATIONAL VEHICLE OR THE TOW VEHICLE AS A RESULT OF THE SELECTION, OPERATION, USE OR MISUSE OF THE TOW VEHICLE. \*Length is defined as the distance from the centerline of hitch pin/coupler to rear bumper of trailer. Please review owner's manual prior to purchase for more information on service warranties, extended use, towing and maintenance. Owner's manuals can be found at [keystonerv.com](http://keystonerv.com).

SCAN HERE TO  
LEARN MORE



LAUNCHING AS STANDARD EQUIPMENT ON ALL KEYSTONE  
TRAVEL TRAILERS AND FIFTH WHEELS, FALL 2021



SOLAR  
FLEX

**TAKE CHARGE  
OF HOW  
YOU CAMP**

### The Solar Energy System You've Been Waiting For

Impossibly versatile, exceptionally designed, SolarFlex is shattering customers' expectations of factory-installed solar power. SolarFlex eliminates the guesswork to deliver affordable, high quality solar energy systems.



Learn more about the  
SolarFlex difference and  
packages now available.

PRINT 9.2021



**KEYSTONE**  
RV COMPANY

**CAMP BETTER**