

# ROCKWOOD

Ultra Lite • Mini Lite • Roo



ROCKWOOD Ultra Lite • Mini Lite • Roo





ROCKWOOD  
**ULTRA LITE**



IT'S THE FLOORPLAN  
**YOU WANT**  
IN THE SIZE AND WEIGHT  
**YOU NEED.**

*We have custom designed our trailers with the best in style and amenities while keeping your towing needs in mind.*

Quality craftsmanship and attention to detail have been put into our Ultra Lite trailers—all with you in mind. The fully equipped kitchens with comfortable dinettes and convenient exterior storage compartments are just a couple notable features.

**2608WS** Manhattan with Cherry



Rear bedroom with a spacious wardrobe slide



ROCKWOOD

# ULTRA LITE

2304S

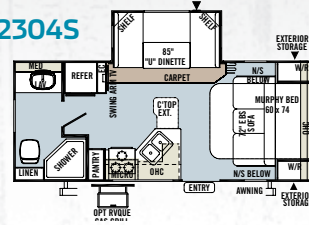

2604WS

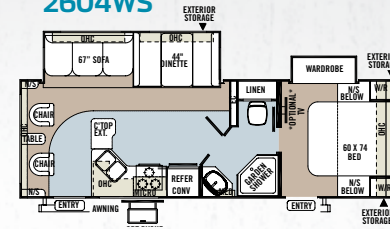

2607

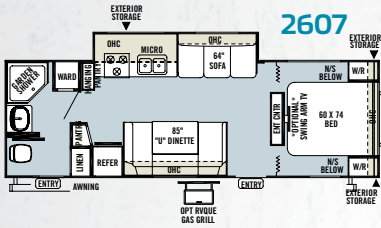

2608WS

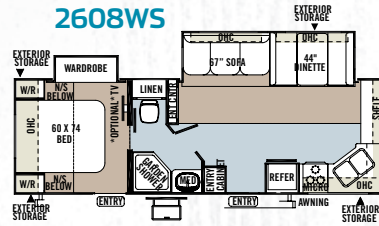

2702SS

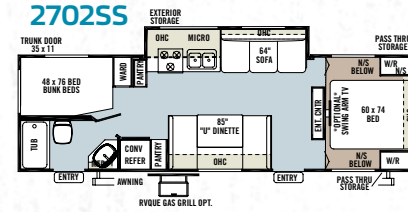

2703WS

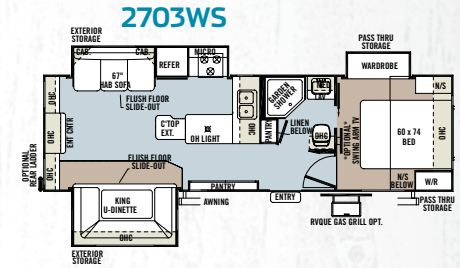

2902SS

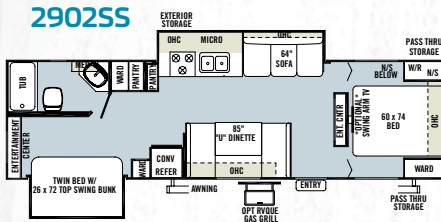

2904SS

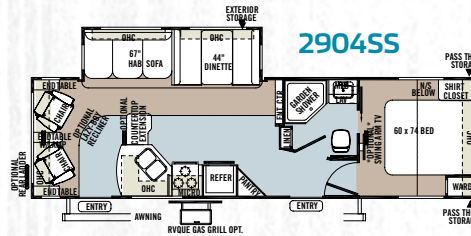

2905SS

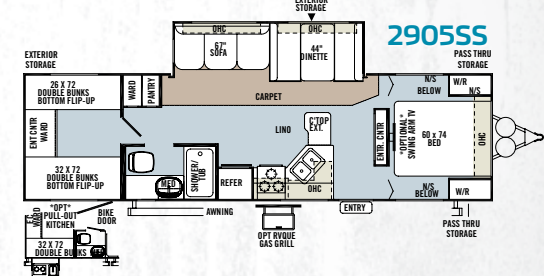

2909SS

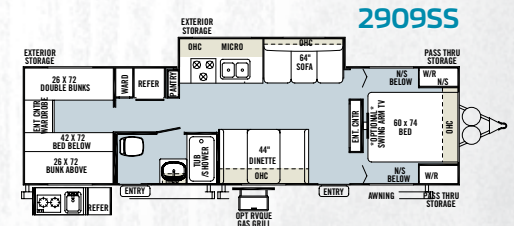

2910TS

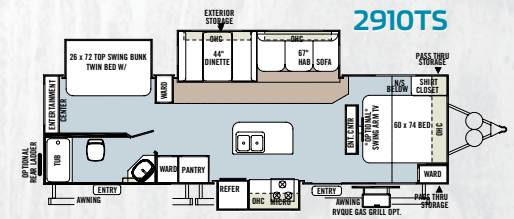

## Specifications

Model number of any particular unit does not necessarily reflect the overall length of the unit itself. Dry weight are estimates.

MODEL	2304S	2604WS	2607	2608WS	2702SS	2703WS	2902SS	2904SS	2905SS	2909SS	2910TS
BASE/DRY UNIT WEIGHT	4768	5676	4977	5635	5276	6145	5865	6074	6021	5709	6476
BASE DRY HITCH WEIGHT	614	739	532	635	613	621	668	611	754	603	892
BASE DRY AXLE WEIGHT	4768	4937	4445	5000	4663	5524	5197	5463	5267	5106	5584
CARGO CAPACITY	1808	1025	1517	962	1299	1438	1765	1499	1695	1856	1378
LENGTH	23' 9"	29' 8"	29' 8"	29' 7"	31' 11"	31' 11"	33' 8"	33' 8"	33' 8"	33' 8"	33' 8"
WIDTH	96"	96"	96"	96"	96"	96"	96"	96"	96"	96"	96"
HEIGHT W/O A/C	116"	115"	112"	116"	111"	117"	111"	114"	115"	111"	115"
INTERIOR HEIGHT	80"	80"	80"	80"	80"	80"	80"	80"	80"	80"	80"
FRESH WATER CAPACITY	36 gal	36 gal	36 gal	36 gal	36 gal	36 gal	36 gal	36 gal	36 gal	36 gal	36 gal
GRAY WATER CAPACITY	37 gal	37 gal	37 gal	74 gal	37 gal	37 gal	37 gal	37 gal	37 gal	37 gal	74 gal
BLACK WATER CAPACITY	37 gal	37 gal	37 gal	37 gal	37 gal	37 gal	37 gal	37 gal	37 gal	37 gal	37 gal

# INTRODUCING THE ULTRA LITE EMERALD PACKAGE

*Rockwood has put together a group of appealing features to enhance the appearance of the Ultra Lite series of travel trailers. The Emerald Package adds style and luxury to a trailer already packed full of value.*

A complete list of the Emerald Package contents can be found in the Standards and options section on page 15.



Tan Fiberglass Exterior with Black Trim



Tinted Bonded Frameless Windows



Slam Latches on Storage Doors



Solid Surface Corian Kitchen Counter Top



Upgrade Decorative Slide Out Fascia  
(Shown with Manhattan/Hickory Decor)



ROCKWOOD

## MINI LITE



## MINI BUT MIGHTY. ALL YOU NEED IN A SMALLER PACKAGE.

Mini Lite trailers are excellent for those who want to move from the tent camper to the Light weight towable. The light, small compact design was created for families driving vans and small sport utility vehicles. With residential amenities and excellent features, you're sure to enjoy the Mini Lites.

**2104S** Taylor Sand with Hickory



Front Bedroom and Panoramic Window with Large Picturesque View



ROCKWOOD  
**MINI LITE**



# WANT TO TOW A TRAILER BUT HAVE NO TRUCK?

When towing size and weight are your focus, You will find that these specially designed Mini Lite models offer flexible floor plans that provide you with more comfort and amenities that you would expect all within the towing capacity of many of the smaller vehicles on the road today.

## Specifications

Model number of any particular unit does not necessarily reflect the overall length of the unit itself; Dry weight are estimates.

MODEL	1901	1905	1906
BASE/DRY UNIT WEIGHT	2822	2945	2710
BASE DRY HITCH WEIGHT	345	394	417
BASE DRY AXLE WEIGHT	2477	2551	2293
CARGO CAPACITY	985	911	1169
LENGTH	20' 4"	20' 4"	20' 4"
WIDTH	90"	90"	90"
HEIGHT W/O A/C	105"	105"	105"
INTERIOR HEIGHT	78"	78"	78"
FRESH WATER CAPACITY	36 gal	36 gal	36 gal
GRAY WATER CAPACITY	30 gal	30 gal	30 gal
BLACK WATER CAPACITY	30 gal	30 gal	30 gal



Murphy Bed Shown in the Down Position



Sofa Accessible w/ Murphy Bed in Stored Position.

### 1901

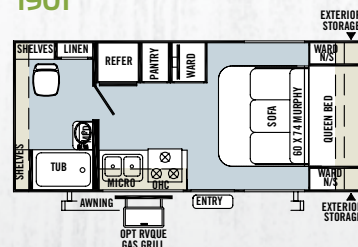

### 1905

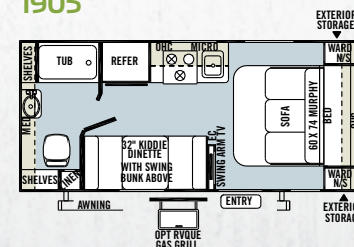

### 1906

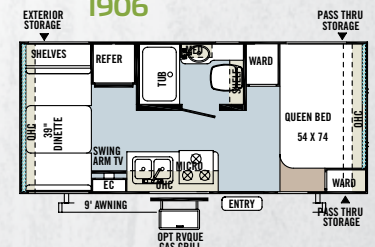



ROCKWOOD

# MINI LITE

1809S

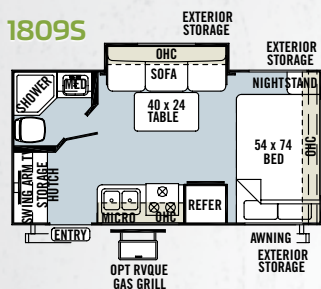

2104S

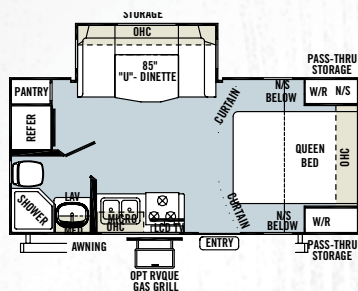

2109S

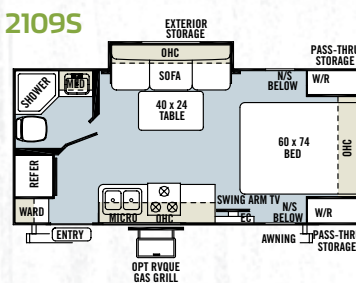

2304

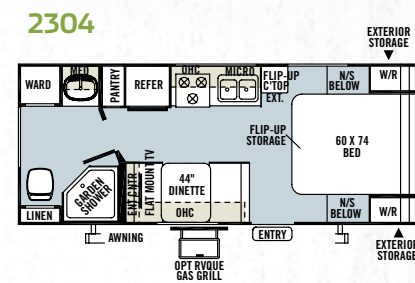

Murphy Bed Option

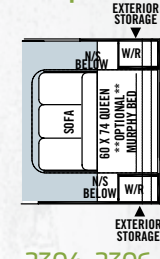

2304, 2306

2306

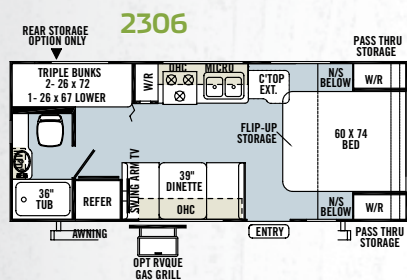

2502S

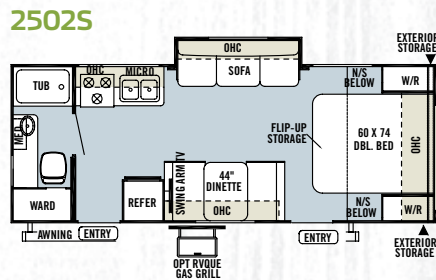

2503S

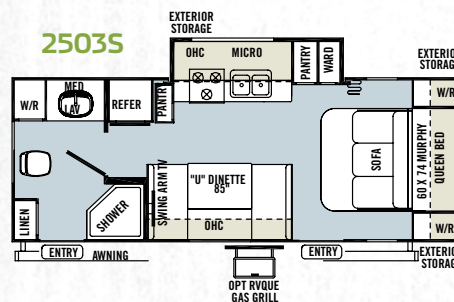

2504

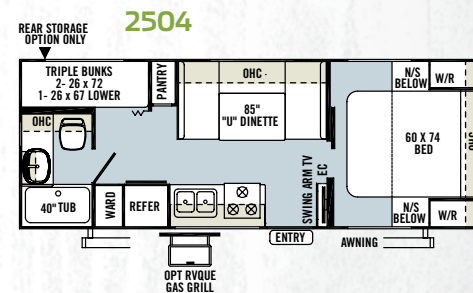

## Specifications

Model number of any particular unit does not necessarily reflect the overall length of the unit itself.  
Dry weight are estimates.

MODEL	1809S	2104S	2109S	2304	2306	2502S	2503S	2504
BASE/DRY UNIT WEIGHT	3476	3749	3624	3709	3630	4101	4357	4124
BASE DRY HITCH WEIGHT	250	330	369	569	356	400	548	459
BASE DRY AXLE WEIGHT	3226	3419	3255	3140	3274	3701	3809	3665
CARGO CAPACITY	1136	943	1107	1222	1088	1833	1833	1833
LENGTH	20'	21' 8"	21' 8"	23' 9"	23' 8"	25' 8"	25' 8"	25' 8"
WIDTH	96"	96"	96"	96"	96"	96"	96"	96"
HEIGHT W/O A/C	109"	113"	111"	108"	108"	109"	110"	117"
INTERIOR HEIGHT	80"	80"	80"	80"	80"	80"	80"	80"
FRESH WATER CAPACITY	36 gal	36 gal	36 gal	36 gal	36 gal	36 gal	36 gal	36 gal
GRAY WATER CAPACITY	30 gal	30 gal	30 gal	30 gal	30 gal	30 gal	30 gal	30 gal
BLACK WATER CAPACITY	30 gal	30 gal	30 gal	30 gal	30 gal	30 gal	30 gal	30 gal



ROCKWOOD

## QUALITY FEATURES



## FEATURES THAT MAKE YOUR TRIPS FEEL LIKE HOME.

*Rockwood takes careful consideration to each feature added into each product produced. Every detail is considered ranging from extra sleeping room, storage, comfort and convenience.*

Take time to review the features listed below and match them with the competition's products. We're confident you'll discover Rockwood is the superior choice.



1



2



3



4

ROCKWOOD

## QUALITY FEATURES

- 1 Power Awning with Adjustable Rain Dump *(Opt.)*
- 2 Solid wood Doors & Drawers *(Std.)*
- 3 Aluminum Wheels *(Opt.)*
- 4 26" LCD TV w/ 5.1 Dolby Speaker System with "Bluetooth technology" *(Opt. UL: Select Models)*





1



2



3



4



5

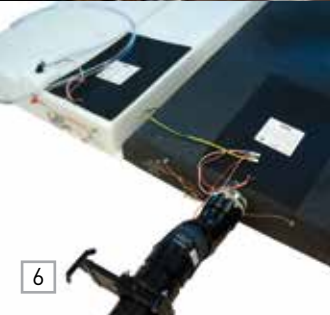

6



7



8



9

## ROCKWOOD QUALITY FEATURES

- 1 RVQ grill *(Opt.)*
- 2 Fantastic Fan *(Std. Opt.)*
- 3 Water Filter *(Std. Opt.)*
- 4 Heated Innerspring Mattresses *(Std. Opt. on ML & R)*
- 5 Outside Speakers *(Std: 1901, 1904, 1905 Opt: All Other Models)*
- 6 Heated holding tanks with 12 volt heat pads secured to the bottom *(Opt.)*
- 7 Outside Shower *(Std.)*
- 8 For convenient winterizing, easy access to the water pump/filter and outside anti-freeze inlet are provided. *(Std.)*
- 9 Roo Bunk Cables — No Support Poles Needed *(Std. All Models Except 23RS, 25RS)*

## ROCKWOOD LUXURIOUS RESIDENTIAL FABRICS



LONDON SKY



TAYLOR SAND



MANHATTAN



CHERRY DÉCOR OPTION



HICKORY DÉCOR OPTION



STANDARD FLOOR COVERING



OPTIONAL FLOOR COVERING



ROCKWOOD  
QUALITY  
CONSTRUCTION



## THE DETAILS ARE WHAT MAKE ALL THE DIFFERENCE.

*Rockwood takes pride in constructing the very best products possible in each price point. From our entry level units to our top of the line products, no short cuts are taken to achieve excellence.*

From the all-steel I-beams to the residential interior amenities to the vacuum-bonded exteriors, Rockwood products are quality-built from the ground-up.



1



3



4



5



6



7

**TORFLEX**  
RUBBER TORSION SUSPENSION AXLES



8

ROCKWOOD  
QUALITY  
CONSTRUCTION

- 1 Glued and screwed wood cabinetry
- 2 Aluminum dinette frames for added strength and weight savings
- 3 Extra large dinette storage drawers
- 4 Full extension metal drawer guides in the kitchen
- 5 Vacuumed bonded floor with 16" on center aluminum floor joists (*Std. Ultra Lite, select Roo models*)
- 6 Enclosed underbelly protects trailer components as well as increasing aerodynamics (*Std. Ultra Lite Models Only*)
  - Independent wheel suspension and self-damping action
  - Rubber cushioning eliminates metal-to-metal contact.
  - Forged torsion arm for maximum strength
- 8 Aluminum Frame Construction with fiberglass exterior and deluxe graphics



ROCKWOOD

# QUALITY CONSTRUCTION

## ROOF CONSTRUCTION



Vacuum bonded radius roof with vaulted ceiling providing superior insulation and more interior height.



4" thick roof with built-in insulated A/C ducts.



Built strong to enable you to conveniently perform periodic roof maintenance.

## WALL STRENGTH



Structurally engineered materials makes our vacuum-bonded walls some of the strongest in the industry.

## VACUUM-BONDED LAMINATED CONSTRUCTION



Rockwood is one of the few light weight manufacturers that is a fully **6 sided vacuum-bonded trailer**. Our walls, floors, roof, fronts and backs are all built vacuum-bonded to ensure a light weight strong structural trailer.





WHEN WE ARE DEVELOPING  
**THE ROO,**  
WE CREATE DIFFERENT MODELS  
TO MEET THE NEEDS OF CAMPER  
**LIKE YOU.**

Whether you are interested in the expanded interior space provided by the spacious drop down bunks with heated innerspring mattresses or the ability to bring an ATV along or the feel of a traditional trailer with solid wall expanding slides, the Rockwood Roo will deliver with the quality and amenities you expect. Rockwood has redefined camping by allowing you to have the necessities of residential living on the campsite.



REAR SLIDE MODELS



FRONT STORAGE DECK MODELS



Spacious cabinets, bathroom and second drop down bunk are located in the back.



# ROCKWOOD ROO

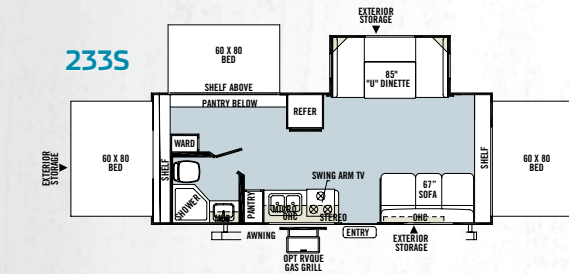
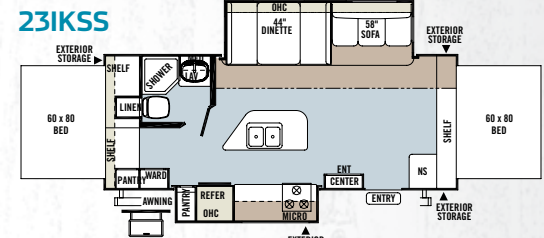
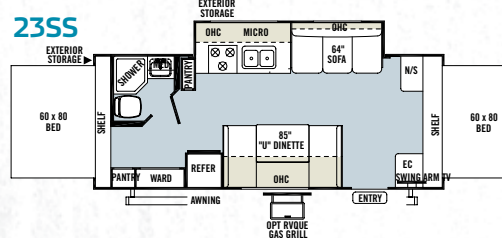
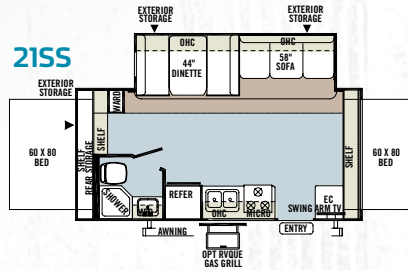
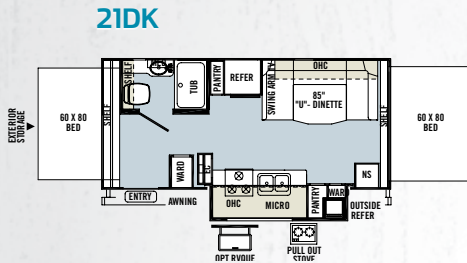
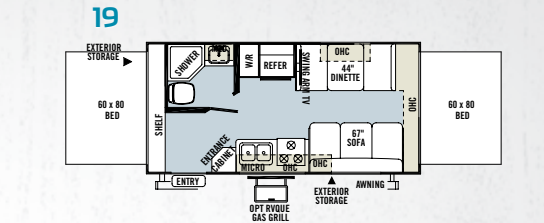
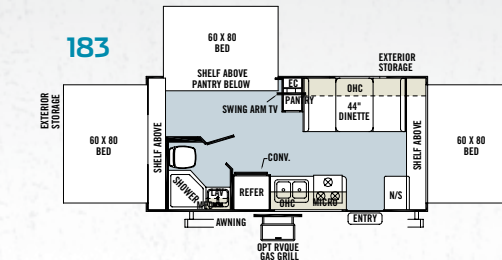
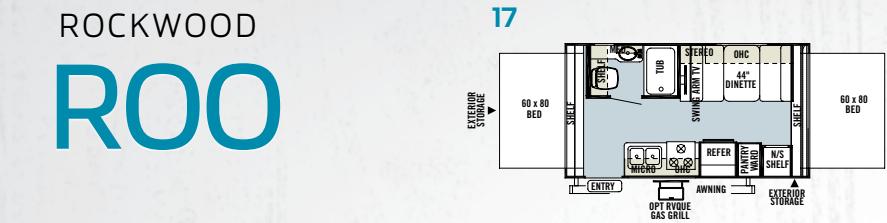

## REAR SLIDE MODELS

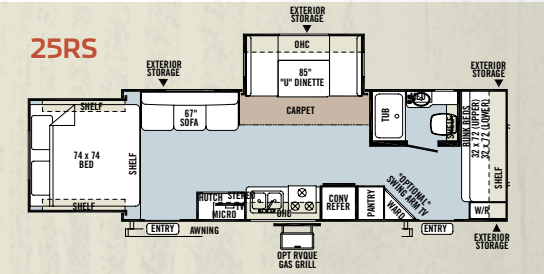
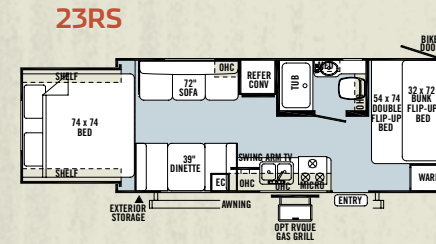

## Specifications

Model number of any particular unit does not necessarily reflect the overall length of the unit itself. Dry weight are estimates.

MODEL	17	183	19	21DK	21SS	231KSS	23SS	233S	23RS	25RS	19L	21SSL
BASE/DRY UNIT WEIGHT	2969	3459	3494	3785	4267	4936	4322	4372	4143	4841	4432	4995
BASE DRY HITCH WEIGHT	360	406	379	523	585	432	435	585	499	502	321	418
BASE DRY AXLE WEIGHT	2609	3053	3115	3262	3682	4504	3887	3787	3644	4339	4111	4577
CARGO CAPACITY	853	1309	1247	1100	1233	1458	1833	1833	1833	1624	2900	2385
LENGTH	19'	20' 9"	20' 9"	21' 9"	21' 9"	24' 10"	24' 10"	24' 10"	23' 10"	27' 5"	30' 1"	31' 1"
TRAILER LENGTH (Open)	23' 4"	25' 1"	25' 1"	26' 3"	26' 3"	29' 2"	29' 2"	29' 2"	28' 5"	32'	33' 5"	35' 2"
WIDTH	96"	96"	96"	96"	96"	96"	96"	96"	96"	96"	96"	96"
HEIGHT W/O A/C	111"	110"	110"	113"	117"	115"	111"	111"	116"	116"	118"	117"
INTERIOR HEIGHT	80"	80"	80"	80"	80"	80"	80"	80"	80"	80"	80"	80"
FRESH WATER CAPACITY	36 gal	36 gal	36 gal	36 gal	36 gal	36 gal	36 gal	36 gal	36 gal	36 gal	36 gal	36 gal
GRAY WATER CAPACITY	30 gal	30 gal	30 gal	30 gal	30 gal	30 gal	30 gal	30 gal	30 gal	30 gal	30 gal	30 gal
BLACK WATER CAPACITY	30 gal	30 gal	30 gal	30 gal	30 gal	30 gal	30 gal	30 gal	30 gal	30 gal	30 gal	30 gal

## FRONT STORAGE DECK MODELS

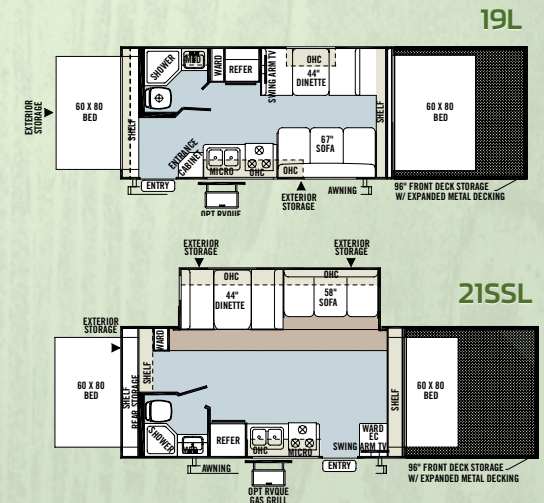



## ROCKWOOD STANDARDS & OPTIONS

Standards & Options are subject to change.

# ULTRA LITE, MINI LITE & ROO

MODELS	UL	ML	R
<b>INTERIOR FEATURES</b>			
• Hickory or Cherry (w/ Solid Cherry Hand Rubbed Cabinet Doors) Interior	O	O	O
• Upgraded Decorative Wood Slide Out Fascia	EP	--	--
• Solid Wood and Raised Panel Doors and Drawers	S	S	S
• Screwed and Glued Wood Cabinetry	S	S	S
• Residential Full Extension Metal Drawer Guides in Kitchen	S	S	S
• Flooring: Carpet and an Engineered Mold and Mildew Resistant Floor Covering (21SS, 21SSL, 23IKSS, 23SS Only, All UL Models)	S	--	S*
• Engineered Mold and Mildew Resistant Floor Covering	S	S	S*
• Minimum Carpet	O	--	--
• Ducted Furnace (2304S Only)	S*	S	S
• Floor Ducted Furnace (N/A 2304S)	S*	--	--
• 13,500 BTU Ducted Air (N/A 1901, 1905, 1906, 1809S, 2104S, 2109S, 2304, 2306, 17, 183, 19, 19L)	S	S*	S*
• 15,000 BTU A/C	O	O	O
• 13,500 Roof A/C (Std. 1809S, 2104S, 2109S, 2304, 2306, 17, 183, 19, 19L) (Opt. 1901, 1905, 1906)	--	O*/S*	S*
• Carbon Monoxide Detector	SO	SO	SO
• 12 Volt Power Plug Hook-up	S	S	S
• CSA	O	O	O
• Monitor Panel Switch Station	S	S	S
• 55 Amp Converter With Charger	S	S	S
• Battery Disconnect Switch	S	S	S
• LED 12 Volt Interior Lighting	S	S	S
• Directional Reading Lights on Sofa Slides	S	S	S
• Bunk Fan/Light Combination with Each Bed	--	--	S
• Mounted 22" LCD TV (Opt. 1901, 1905, 1906)	S	O*/S	S
• Bedroom Mounted 22" LCD TV (Opt. All UL Models Except 2304S, 2504, 23IKSS, 23SS, 233S)	O*	O*	O*
• 26" LCD TV With 5.1 Digital Dolby Surround Sound Speaker System (N/A 2304S)	O	--	--
• 32" LCD TV With 5.1 Digital Dolby Surround Sound			

UL = ULTRA LITE  
ML = MINI LITE  
R = ROO

S = STANDARD  
SO = STANDARD OPTION  
O = OPTIONAL

MODELS	UL	ML	R
Speaker System (Std. 2703WS Opt. 2607, 2702SS, 2902SS, 2904SS, 2905SS, 2910TS)	S*/O*	--	--
• Digital AM/FM/CD/DVD w/ Remote	S	S	S
• MP3 Player Hook-Up	S	S	S
• Decorative Valances	--	S	S
• Designer Valances w/ Lambrequin Arms	S	--	--
• Mini Blinds	S	--	--
• Night Shades	--	O	O
• Day/Night Shades	O	--	--
• Swivel Chairs (Std. 2604WS Only)	S*	--	--
• Serta Recliners (Std. 2904SS Only)	S*	--	--
• End Table with Attached Lamp (Std. 2604WS, 2904SS)	S*	--	--
• Air Hide-A-Bed Sofa w/ Storage (Std. 2604WS, 2608WS, 2703WS, 2904SS, 2905SS, 2910TS) (Opt. 21SS, 21SSL, 23IKSS)	S*	--	O*
• Jack Knife Sofa (2902SS Only)	O*	--	--
• Aluminum Bed and Dinette Frames	S	S	S
• 44" Family Dinette (N/A 2104S, 2504, 2304S, 2607, 2702SS, 2703WS, 2902SS, 21DK)	S*	S*	S*
• 48" X 84" Spacious King-U-Style Dinette (Std. 2104S, 2504, 2304S, 2607, 2702SS, 2703WS, 2902SS, 21DK)	S*	S*	S*
• Free Standing High Pressure Laminated Table with Swing Level Legs (Swing Level Legs N/A 1901, 1905, 1906, 1809S, 2109S)	S	S*	S
• Free Standing Table and Chairs (2604WS, 2608WS, 2703WS, 2904SS, 2905SS, 2910TS Only)	S*	--	--
• Stainless Steel Appliances	O	O	O
• Raised Refrigerator Panels	O	O	O
• Auto Gas/Electric Refrigerator	S	S	S
• Three Burner High Output Gas Range	S	S	S
• Gas Oven (Required 21DK, 23IKSS, 23SS, 2503S)	S	S	O*
• Microwave	S	S	S
• Solid Surface Corian Counter Tops in Kitchen	EP	--	--

-- NOT AVAILABLE  
\* = SELECTED MODELS  
OP = OPTIONAL PACKAGE

MODELS	UL	ML	R
• Double Bowl Sink w/ Residential Style Faucet (N/A 1905)	S	S	S
• Residential One-Piece Sink Cover	S	S	S
• Cutting Board	S	S	S
• Counter Top Extension (Available 2304S, 2604WS, 2703WS, 2904SS, 2905SS Only)	O	--	--
• Water-Pur Filtration System	SO	SO	SO
• Tub Surround	S	S	S
• Bathroom Skylight	S	S	S
• 110 DSI Gas/Electric Six Gallon "Quick Recovery" Water Heater	S	S	S
• Water Heater By-Pass Kit	S	S	S
• Foot Flush Toilets	S	S	S
• Create-A-Breeze Three Speed Fantastic Fan with Vent Covers	SO	SO	SO
• Extra Create-a-Breeze Fan	O	O	S
• Murphy Bed System for Unmatched Floor Plan Flexibility (Std. 2503S, 1901, 1905, 2304S Opt. 2304, 2306 Only)	S*	S*/O*	--
• Heated Mattress	O	SO	SO
• Serta Upgrade Mattress All Walk Around Beds	S	--	--

## EXTERIOR FEATURES

• Fully Laminated Aluminum Frame (Floor, Sidewall, & Roof)	S	S	S
• Insulation Factors R-7 Side Wall, R-12 Floor and R-14 Ceiling	S	S	S
• Radius Roofs w/ Interior Vaulted Ceilings (N/A 1901, 1905, 1906)	S	S*	S
• Vinyl / Rubber Composite Roofing Membrane	S	S	S
• TV Antenna w/ Cable & Satellite Hook-Up	S	S	S
• Laminated Fiberglass Sidewalls	S	S	S
• Laminated Tan Fiberglass Sidewalls	EP	--	--
• Electric Slide-Out (All Slide Out Models)	S	S	S

CP = CONVENIENCE PACKAGE  
EP = EMERALD PACKAGE





## MODELS

	UL	ML	R
• Lower Front Diamond Plate Panel (N/A w/ 1901, 1905, 1906)	S	S*	--
• Decorative Frame Skirting	S	--	S
• Industrial Lockable Bed Latches	--	--	S
• Easy Step Assist to Access Bed Latches	--	--	S
• Bed Cable System (No Poles)	--	--	S
• Rear Ladder	O	--	--
• Power Awning With Adjustable Rain Dump	S	O	O
• Awning	--	S	S
• Awning Slide Topper	O	O	O
• Entrance / Screen Door	S	S	S
• Grab Handle Next to Entrance Door	--	S	S
• Large Assist Grab Handles	S	--	--
• Lighted Entry Stop and Scare Light	EP	--	--
• Radius Corner Windows and Doors	S	S	S
• Windows w/ Tinted Safety Glass	S	S*	S
• Tinted Bonded Frameless Windows	EP	--	--
• Storm Windows available	O	O	O
• Large Dinette Picture Window	S	S	S
• Outside Grill Prep	S	S	S
• Outside Gas Grill and Worktable	S	S	O
• Outside Speakers	S	S	S
• Outside Shower	S	S	S
• 1/2 Sliding Storage Tray (N/A 1901, 1905, 1906, 2304, Models w/ Murphy Bed Opt, 17, 183, 19, 19L, 23SS, 23IKSS, 2304S)	O	O	O
• Outside Antifreeze Stations in Storage Compartments	S	S	S
• Slam Latches on Pass Through Storage Doors	EP	--	--
• Two-20 Lb Gas Bottles	S	S	S
• Molded Bottle Cover	S	S	S
• Surface Coated Steel I-Beam Frame (N/A 1901, 1905, 1906)	S	S*	S
• 96" Front Storage Deck (19L, 21SSL Only)	--	--	S*
• Power Tongue Jack	O	O	O
• Stabilizer Jacks	S	S	S
• Power Stabilizer Jacks	O	--	--
• Torsion Axle, Rubber-Ryde Suspension	S	S	S
• Easy Lube Axles	S	S	S

## MODELS

	UL	ML	R
• Radial Tires	S	S	S
• 14" Tires with Double Step	S	S	S
• Off Road Package (Includes: 15" Off Road Tires and Aluminum Wheels) (19L, 21SSL Only)	--	--	O*
• Chrome-look Wheel Covers	O	O	O
• Aluminum Wheels	O	O	O
• Spare Tire Carrier & Cover	S	S	O
• Electronically Controlled Heated Holding Tanks	O	O	O
• Enclosed Holding Tanks	S	--	--
• Black Water Flush	S	--	--

### CONVENIENCE PKG. B INCLUDES:

SO	--	--
13,500 BTU Ducted Air		
Mounted 22" LCD TV w/ AM/FM Stereo, CD, DVD Player		
Gas Oven		
Microwave		
110 DSI Gas/Electric Six Gallon "Quick Recovery"		
Water Heater		
Power Awning		
Large Assist Grab Handle		
Windows w/ Tinted Safety Glass		
Outside Grill and Worktable		
Outside Speakers		
Spare Tire Carrier & Cover		

### EMERALD PACKAGE INCLUDES:

O	--	--
Tan Colored Fiberglass		
Deep Tinted Frameless Bonded Windows		
Slam Latches on Storage Doors		
Exterior Step and "Scare" Light		
Solid Surface Corian Kitchen Countertop		
Upgraded Slide Fascia		

### OPTION PKG. G (1901, 1905, 1906 ONLY)

INCLUDES:	--	SO*	--
Gas Oven			
Microwave			
110 DSI Gas/Electric Six Gallon "Quick			

## MODELS

	UL	ML	R
Recovery" Water Heater			
TV Antenna w/ Cable & Satellite Hook-up			
Spare Tire Carrier & Cover			
Outside Speakers			

### CONVENIENCE PKG. A (N/A 1901, 1905, 1906)

INCLUDES:	--	SO*	--
13,500 BTU Roof A/C (1809S, 1901, 1905, 1906 Only)			
13,500 BTU Ducted Air (All Except 1809S, 1901, 1905, 1906)			
Mounted 22" LCD TV w/ AM/FM Stereo, CD, DVD Player			
Microwave			
110 DSI Gas/Electric Six Gallon "Quick Recovery"			
Water Heater			
Awning			
Windows w/ Tinted Safety Glass			
Outside Grill and Worktable			
Outside Speakers			
Spare Tire Carrier & Cover			

### CONVENIENCE PACKAGE C INCLUDES:

--	--	SO
13,500 BTU Roof A/C (17, 183, 19, 19L)		
13,500 BTU Ducted Air (21DK, 21SS, 21SSL, 23SS, 23IKSS, 233S, 23RS, 25RS)		
Mounted 22" LCD TV w/		
TV Antenna & Cable Hook-up		
Microwave		
110 DSI Gas/Electric Six Gallon "Quick Recovery"		
Water Heater		
Awning		
Windows w/ Tinted Safety Glass		
Outside Speakers		





#### PRE-DELIVERY INSPECTION FACILITY

20,000 square feet of quality assurance. The bare essentials for a premium product. This state-of-the-art facility gives immediate daily feedback to production for quality assurance in every unit built.



**Forest River, Inc. encourages our customers to purchase their Forest River products from a local dealership whenever possible for the following reasons:**

- 1) Forest River, Inc. dealers are independently owned and operated businesses so priority service and scheduling is at their discretion and is often provided to customers that purchased their unit at that dealership.
- 2) Purchasing locally allows customers to establish meaningful relationships with a dealer, enhancing the RV experience through assistance with product questions, user tips or RV regulations for your state or country, and much more!
- 3) Canadian customers must meet requirements to bring an RV purchased out of the country to their home. These requirements may involve additional inspections and certifications, taxes and fees. Your local Canadian Dealer is a professional at meeting these requirements.
- 4) Scheduling timely warranty repairs and adjustments through a local dealership provides far greater flexibility and convenience to you, the customer!

It is the goal of Forest River, Inc. that all of our RV owners fully enjoy the RV experience and that customer satisfaction meets or exceeds their expectations!



ROCKWOOD

# WARRANTY

*For details on Rockwood's complete warranty program, see your Rockwood dealer. When it comes to backing products with the same quality and commitment it has when it begins the manufacturing process, the only name you have to remember when you're looking for a recreational vehicle is Rockwood. Rockwood offers the following additional limited warranties to the original purchasers. Consult written warranty for details.*

1. Twelve-year vinyl roof warranty, 2. Two-year fiberglass warranty, 3. Five-year axle warranty, 4. Five-year tent warranty, 5. One-year bumper to bumper warranty, 6. Available second-year warranty

YOUR ROCKWOOD DEALER

Colton RV & Marine  
3122 Niagara Falls Blvd  
North Tonawanda, NY 14120  
(716) 694-0188  
[www.ColtonRV.com](http://www.ColtonRV.com)

Colton RV & Marine  
3443 Southwestern Blvd  
Orchard Park, NY 14127  
(716) 957-3250  
[www.Coltonrv.com](http://www.Coltonrv.com)

201 West Elm Millersburg, IN 46543 | [www.forestriverinc.com/rockwood](http://www.forestriverinc.com/rockwood)  
574.642.2640



**Learn More**  
Scan this barcode using a QR Reader on your smart phone to learn more about Forest River.



A Berkshire Hathaway company.

All specifications contained herein are based on the latest product information at time of printing. Forest River reserves the right to make changes in colors, materials, equipment and specifications at any time without notice and assumes no responsibility for any errors in this brochure. Litho. U.S.A 2013.05.13

#### 24/7 EMERGENCY ROADSIDE ASSISTANCE

For a worry-free ownership experience Forest River includes one year of Coach-Net RV Technical & Roadside Assistance with each RV purchase. Whether new to the RV lifestyle or an experienced RV enthusiast, Forest River owners have 24/7 access to technical, operational and emergency road service coverage throughout the US & Canada. Coach-Net's fast, dependable service is just a phone call away.

**Coach-Net®**  
RV Technical & Roadside Assistance

