

PRE-PRODUCTION PREVIEW

MODEL Z 3210

Colton RV & Marine
3122 Niagara Falls Blvd
North Tonawanda, NY 14120
(716) 694-0188
www.ColtonRV.com

Colton RV & Marine
3443 Southwestern Blvd.
Orchard Park, NY 14127
(716) 957-3250
www.Coltonrv.com

Standard Run MSRP \$125,722

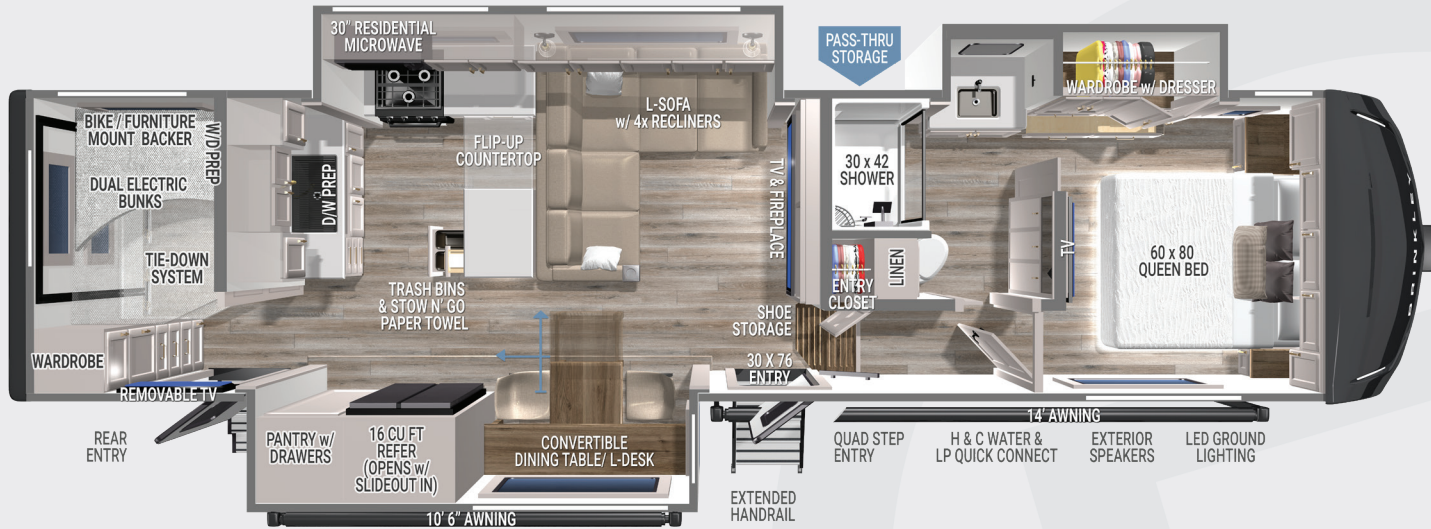

FEATURES:

- L-Sofa w/ 4 Recliners
- 65" Smart TV
- Convertible Dining Room Table/L Desk (Seating up to 4)
- 80" Pantry w/ Pull-Out Drawers & Appliance Outlet
- Brinkley CraftSense™ Wood Trim Construction
- Premium Residential Cabinets & Drawers w/ Dovetail Joints
- Waterfall Island Flip-Up Countertop
- Kitchen & Living Room/Dining Room Flush Floor Slides
- Pet Feeder w/ Removable Pet Bowls
- Bedside Shelves & Outlets w/ USB & USB-C
- Tip-To-Clean Quad Entry Steps
- Rockford Stereo w/ App Control
- Square Euro Frameless Windows w/ 6" Openings
- Integrated Window Screens & Insulated Blackout Blinds (No Valances)

- Automotive-Grade Front Cap, Lights, & Lens
- Sleek & Clean Styling w/ Automotive-Grade Graphics
- 13.5k Front AC w/ Heat Pump
- Furrion 18k Chill® Cube Rear AC w/ Heat Pump
- Over 130 Cu. Ft. of Exterior Storage w/ Tough Ply Liner
- 2 - Hot/Cold Outdoor Showers (BOTH sides of coach)
- One-Touch Automatic 4-Point Leveling System
- CURT Touring Coil Suspension System, ABS Brakes, Sway Control w/ Brake Boosters
- CURT Helux™ King Pin w/ Coil Spring & Shock-Absorber
- Built-in Wire Conduit from Roof to Basement
- Industry First Brass Plumbing Connections
- Industry First Low Maintenance Roof
- Basement Utility Access w/ Motion Lights
- Electric Waste Valves w/ Indicator Light & Manual-Override

- 370W Solar Panel w/ 50AMP MPPT Controller (Inverter Prep & Lithium Ready)

Bunk Room Highlights:

- Dual Electric Bunks (51"x72")
- Floor to Ceiling Wardrobe
- 8k AC & 32" Smart TV
- Washer/Dryer Prep
- Cargo Tie-Down System & Bike Rack Prep

FACTORY OPTIONS:

- Dual Pane Windows \$1,731
- Gen-Y® Executive Gooseneck w/ SnapLatch Torsion Flex \$1,876
- Premium Exterior Pkg. w/ Full Body Paint (Silver, White, or Gold) \$23,900

SPECIFICATIONS:

- UVW – 12,871 lbs.
- GVWR – 15,995 lbs.
- Hitch Weight – 2,331 lbs.
- Exterior Length – 34' 11"
- Overall Height w/ AC – 13' 3"
- Width – 96"
- Bath & Bedroom Height - 79 ½"
- Slide Height - 76"
- Axles – Tandem 7,000 lbs.
- Wheels & Tires – 17.5" H-Rated (16 ply)
- Fresh Water Capacity – 75 gal
- Gray Water Capacity – 85 True + 30 gal
- Black Water Capacity – 40 gal
- Insulation – Floors/Ceiling R40, Walls R11

Optional equipment & props may be shown.
All content is subject to change without notice.
Please consult with your dealer for current information.



For More Information, Photos, Videos
& Why Brinkley go to BrinkleyRV.com



010726