

# Blue Ridge

CABIN EDITION by Forest River



Colton RV & Marine  
3122 Niagara Falls Blvd.  
North Tonawanda, NY 14120  
(716) 694-0188  
www.ColtonRV.com

Colton RV  
489 Bushkill Plaza LN #9665  
Wind Gap, PA 18091  
(610) 863-5239  
www.ColtonRV.com

## Cabin Edition – Blue Ridge Style at a Remarkable Value

The Cabin Edition has plenty of room for friends and family. This spacious, wide body fifth wheel offers full profile Blue Ridge style, convenience and generous storage, at a mid profile price.

CABIN by BLUE RIDGE	304SR	378LF
Length (Center of Pin to Rear of Bumper)	37' 3"	41' 2"
Shipping Weight	11449	13084
UVW	11508	13143
Hitch Weight	2202	2244
GAWR	12000	13680
GVWR	14202	15924
Cargo Carrying Capacity (CCC)	2694	2781
Exterior Height	13' 6"	13' 6"
Exterior Width	100"	100"
Interior Height (Bedroom)	81"	81"
Interior Height (Living area)	106 1/2"	106 1/2"
Tire Size ST235/80R16E	■	■
Brake Size	12"	12"
Fresh Water	64 gal.	64 gal.
Waste Water	120 gal.	120 gal.
Water Heater	10 gal.	10 gal.
Furnace	42000 BTU	42000 BTU
Patio Awning	16'	18'
Exterior Storage (Cu. ft.)	85	85

### WIDE BODY FIFTH WHEELS

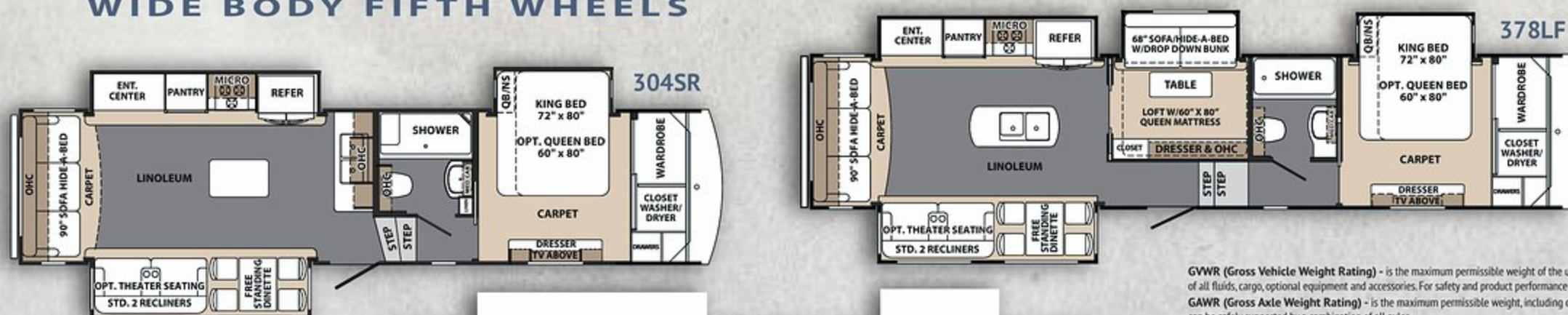

NEW FLOORPLAN COMING SOON!

**GVWR (Gross Vehicle Weight Rating)** - is the maximum permissible weight of the unit when fully loaded. It includes all weights, inclusive of all fluids, cargo, optional equipment and accessories. For safety and product performance do NOT exceed the GVWR.

**GAWR (Gross Axle Weight Rating)** - is the maximum permissible weight, including cargo, fluids, optional equipment and accessories that can be safely supported by a combination of all axles.

**UVW (Unloaded Vehicle Weight)** - is the typical weight of the unit as manufactured at the factory. It includes all weight at the unit's axle(s) and tongue or pin and LP Gas. The UVW does not include cargo, fresh potable water, additional optional equipment or dealer installed accessories.

**CCC (Cargo Carrying Capacity)** - is the amount of weight available for fresh potable water, cargo, additional optional equipment and accessories. CCC is equal to GVWR minus UVW. Available CCC should accommodate fresh potable water (8.3 lbs. per gallon). Before filling the fresh water tank, empty the black and gray tanks to provide for more cargo capacity.

\*Estimated Average based on standard build optional equipment.

\*\*Estimated average based on standard build optional equipment.

Each Forest River RV is weighed at the manufacturing facility prior to shipping. A label identifying the unloaded vehicle weight of the actual unit and the cargo carrying capacity is applied to every Forest River RV prior to leaving our facilities.

The load capacity of your unit is designated by weight, not by volume, so you cannot necessarily use all available space when loading your unit.



## WIDE BODY FIFTH WHEELS STANDARD FEATURES

### INTERIOR

- Flat Panel Shaker Doors
- Crown Molding
- Solid Wood Drawer Boxes (Baltic Birch)
- Ball Bearing, Full Extension Drawer Guides
- Beaufort® Flooring (7-Year Cold Crack warranty)
- Residential Carpet
- Residential Cabinet Hardware and Accents
- Satin Nickel Plumbing Fixtures
- Decorative Slide Room Fascia Frame
- Solid Wood Exit Assist Handle
- Fireplace

### GALLEY

- LG Solid Surface Polished Counter Tops with Under Mount Sink
- Double Bowl Stainless Steel Kitchen Sink
- High Rise "J" Spout Kitchen Faucet
- MaxxAir Fan with Rain Sensor
- Flush Floor Kitchen Slide-out

### LIGHTING

- LED Running and Tail Lights
- LED Lighting Throughout
- Decorative Ceiling Light above Dinette
- Hanging Lighting above Sink with Decorative Mount
- Ceiling Fan
- Exterior LED Docking Lights (2 Mounted into front cap)
- Exterior Security Lights (2)
- Exterior Amber Patio Light
- LED Awning Light Strip

### FURNITURE/WINDOW COVERINGS

- Swivel/Glider Recliners (2)
- Free Standing Dinette Table with Dual Leafs and (2) Chairs with Flip-up Storage (2 Folding chairs)
- Three Seat Rear Sofa with Hide-A-Bed
- Bonded Leather Sofa and Recliners
- Pleated Night Shades
- Designer Fabric Window Treatments (Where available)

### BATHROOM

- 12 Volt Power Roof Vent
- HPL Vanity Top with Oversized Residential Bowl
- Toilet with Foot Flush
- Mega Shower
- Glass Shower Door
- Shower Skylight/Dome
- Adjustable Shower Head
- Medicine Cabinet with Mirrored Door
- Dedicated Heat and A/C Duct

### BEDROOM

- Premium, Innerspring Mattress
- King Bed
- Designer Headboard, Bedspread, Pillows and Sham
- Full Height Hanging Wardrobe

- French Mirrored Closet Doors
- Stackable/Combination Washer/Dryer Prep
- Chest of Drawers
- Underbed Storage
- (2) Bedside Windows in Slide-Out
- (2) Reading Light with Individual Controls
- (2) Bedside Power Outlets

### APPLIANCES

- Residential Refrigerator with 2000 Watt Inverter (304SR, 378LF)
- 3-Burner, High Output Range with 22" Oven
- Recessed Glass Range Cover
- 30" Microwave
- 42K BTU LP Furnace
- Wire and Frame for Second A/C
- Dometic Quiet Cool 15K Ducted AC
- 10 Gal. Gas/electric DSI Water Heater
- "Shurflo" On-demand High Output Water Pump (3g/min @ 55 psi)
- LP Leak Detector
- Carbon Monoxide Detector

### ELECTRONICS

- 40" LED TV with HD Steel Swing Arm
- Furion Theater System with Bluetooth, HDMI, DVD, AM/FM, Weather Band
- Digital TV Antenna with Signal Booster
- Cable TV Hook-ups (Bedroom)
- Cable TV Hook-up Exterior Garage Bulkhead
- Satellite Prep (Side mounted)
- Exterior Outdoor Speakers

### EXTERIOR

- Fiberglass Exterior on All Walls
- Front Cap: Molded Fiberglass with LED Light Accents
- Front Cap Design: Engineered with Extended Turning Radius (Chamfered front)
- Laminated Front Bulkhead
- Slam Latch Baggage Doors
- Slide End Walls: Laminated Fiberglass
- 32" x 76" Entry and Screen Door
- 45° Angled Skirting
- Automotive Hehr Windows
- Roof Ladder
- Electric Awning with LED Light Strip
- Entry Assist Handle (XL-Folding)
- 1.5" Aluminum Black Belt Rail with Caps (No exposed screws)
- Roto-cast Spun Seamless Water/Waste Tanks
- PEX Plumbing System
- Enclosed, Heated Underbelly and Heated Tanks (Forced air heat)
- Dual Roof Vents
- LP Quick Disconnect

### SLIDE ROOM SEAL/GASKET SYSTEM

- Aluminum "H" Frame Slide Room Perimeter
- Dual Neoprene Squeegee Seals
- Exterior and Interior "D" Seals
- Exterior "H" Seals

### UTILITY DOCKING COMPARTMENT

- 12 Volt Light
- Outside Shower (Hot and cold)
- Black Tank Flush System
- Water Heater Bypass Valve
- Full Coach Water Filtration System
- Winterizing Bypass System
- Protected/Insulated Pull Waste Valves
- Waste Hose Storage Tube
- Slam Latch Baggage Doors

### CHASSIS/FOUNDATION

- Chamfered Frame Technology
- 10" Beams: 304SR
- 12" Beams: 378LF
- Dexter® Dual 6K Axles with Nev-R-Adjust® Brakes: 304SR
- Dexter® Dual 7K Axles with Nev-R-Adjust® Brakes: 378LF
- E-Z Lube® Hubs
- MOR/ryde 3000 Suspension System
- (8) Lug Hubs
- Aluminum Rims 16"
- Radial Tires (E-rated)
- Spare Tire
- Electric Jacks
- Triple Steel Entry Steps: 304SR
- Four Steel Entry Steps: 378LF
- Flush Floor Slide Design with Steel Ramp and Glide Bar (Main Slide Room)
- 18K Extended Hitch Pin

### CONSTRUCTION

- Wide Body Construction
- Sidewalls: 2" Welded Aluminum Framed Vacuum Bonded Laminated Walls
- Roof: 5" Dual Radiused Wood Roof Trusses on 16" Centers
- Roof: Alpha Super Flex II TPO Roof Material
- Front Wall: Welded Aluminum Frame
- Rear Wall: 2" Welded Aluminum Frame Vacuum Bonded Laminated Wall
- Main Floor: 2" Vacuum Bond Laminated with Welded Aluminum Trusses
- Bath/Bed Floor/Deck: Welded Aluminum Frame
- Slide Floor: 1" Wood Flooring
- Slide End Walls: 2" Welded Aluminum Frame, Laminated

### INSULATION

- Sidewalls: High Density Block Foam Insulation (R-9)
- Roof: Aluminum Radiant Foil Insulation and Fiberglass Insulation (R-38)
- Main Floor: High Density Block Foam Insulation and Aluminum Radiant Foil Insulation (R-38)
- Sub Floor: 1/4" Honey Combed Plastic with Aluminum Radiant Foil Insulation and Direct Forced Air Heat

- Front Cap: Fiberglass Insulation and Aluminum Radiant Foil Insulation (R-38)
- End Wall: High Density Block Foam Insulation (R-9)

### ELECTRICAL SYSTEMS

- Centralized Command Center and Monitor Panel
- 70 AMP Converter with Charge Wizard
- 50 AMP Service
- Marine Grade Detachable 50 AMP Power Cord
- 12 Volt Battery Disconnect
- Battery Prep Box (2)
- Solar Prep

## OPTIONS

### INTERIOR

- 32" LED HD Bedroom TV
- 39" LED TV (378LF Bunkhouse only)
- Theater Seats
- 18 Cu. Ft. Gas/Electric Refrigerator

### EXTERIOR

- "Level Up" One-touch Automatic 4 or 6-Point Leveling System (304SR: 4 Point, 378LF: 6 Point)
- Generator Prep
- Dometic Quiet Cool 13.5 Ducted A/C in Bedroom
- Bike Rack



**Blue Ridge**  
CABIN EDITION  
by Forest River

58277 State Road 19 South ■ Elkhart, IN 46517 ■ (574) 296-7700  
www.forestriverinc.com/blueridge ■ www.forestriveraccessories.com  
fb.me/blueridgefifthwheels



Learn More  
Scan this barcode using  
a QR Reader on your  
smart phone to learn  
more about Forest River.



Find us on  
**Facebook**

All information contained in this brochure is believed to be accurate at the time of publication. However, during the model year, it may be necessary to make revisions and Forest River, Inc., reserves the right to make all such changes without notice, including prices, colors, materials, equipment and specifications as well as the addition of new models and the discontinuance of models shown in this brochure. Therefore, please consult with your Forest River dealer and confirm the existence of any materials, design or specifications that are material to your purchase decision.  
©2016 Blue Ridge, a Division of Forest River, Inc., a Berkshire Hathaway company. All rights reserved 11/16