

BOOST

20XLR 21

TOY HAULERS

XLR
TOY HAULERS

ACTION CAMPING™

685 E. Main Street / Butler, IN 46721
Phone: 574-327-2686
E-mail: XLRinfo@forestriverinc.com



Visit our website at: forestriverinc.com/rvs/toy-haulers/xlr-boost
for everything Boost has to offer.

YOUR XLR ACTION CAMPING DEALER:

Colton RV & Marine
3122 Niagara Falls Blvd.
North Tonawanda, NY 14120
(716) 694-0188
www.ColtonRV.com

Colton RV
489 Bushkill Plaza LN #9665
Wind Gap, PA 18091
(610) 863-5239
www.ColtonRV.com



ACTION CAMPING™





CHOOSE FROM THREE DISTINCT SERIES DESIGNED WITH YOU IN MIND



WELCOME TO ACTION CAMPING™



From Side-by-Sides to golf carts, kayaks to _____ (you fill in the blank) hobbies; we are excited to introduce a whole new breed of RVers. You are **Action Camping™** folks because that's what you do. And XLR Toy Haulers make it happen in complete comfort, with the most rugged construction features available today.

BOOST FIFTH WHEEL

This is the best value on the market in Fifth Wheel Toy Haulers! The Boost series will make you a believer. These 102" wide models are ready to get you out on the road and back in the woods. You'll find four distinct floorplans to choose from.

BOOST TRAVEL TRAILER

These 102" Wide Body Boost Travel Trailers are four-seat Side-by-Side ready! Our 27QBX model is for those wanting a Bunkhouse. It also has a versatile rear deck. This spacious series allows for extra room for all the family, friends and toys.

MICRO BOOST TRAVEL TRAILER & FIFTH WHEEL

We offer 96" Micro Boost models in both Travel Trailers and Fifth Wheels. They're 6" narrower than our Wide Bodies and have lower ceilings. If you need lighter weight because of your tow vehicle, Micro Boost is for you. A Bunkhouse/Toy Hauler on a budget with a rear deck, that's gold!

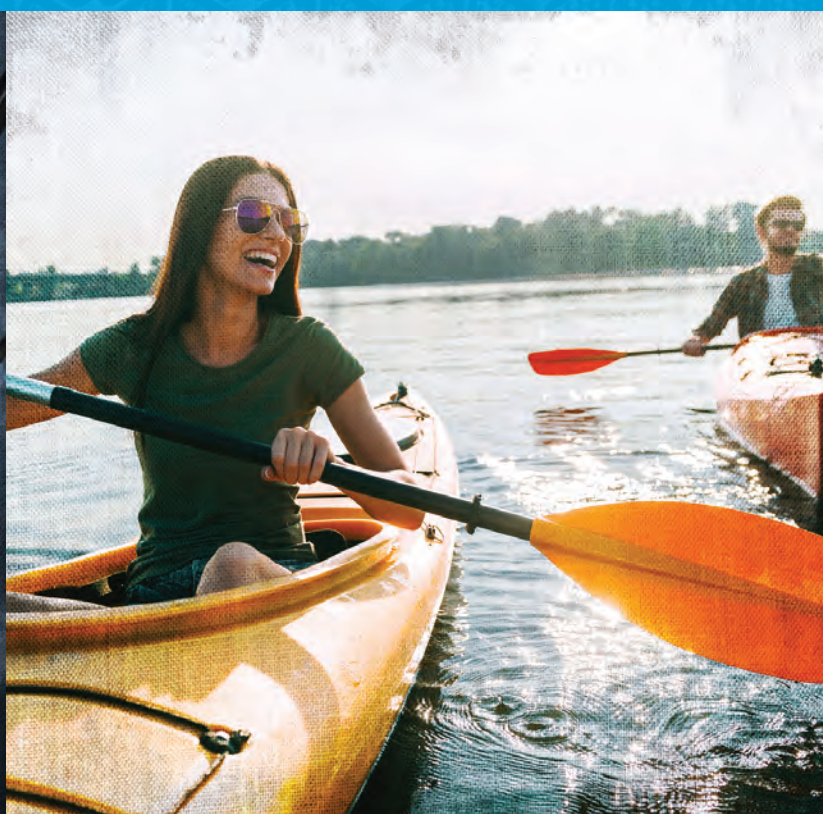

TOP BOOST FEATURES



**Action Camping™
Approved**
Bikes, Kayaks, Canoes,
ATVs, Golf Carts, you name it!



Holding Tank Capacities
These are best-in-class allowing you to better enjoy your Toy Hauler experience without frequent interruptions to drain or fill the liquids. 100-gallon fresh water tank is standard on Boost.



Body Armor Underbelly
This is a PVC laminated to a foil radiant barrier insulation to ensure the protection of your undercarriage, and also improve your in-cabin comfort level.

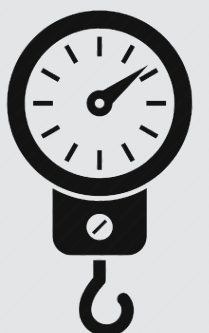

5,000-lb. Tie-Downs
XLR continues to offer the strongest 5,000-lb. tie-down anchor system in the industry. Only the best to secure your precious cargo.

BOOST

MICRO
BOOST

Our Boost and Micro Boost series are designed for the Action Camping™ crowd that wants to get out as much as possible during the year. These light weight haulers are designed to be used and enjoyed—no matter the weather. Now get out there!



A wide body Fifth Wheel with a dual seating living area, 50" TV, plenty of storage plus 11' garage (35DSX11 shown).

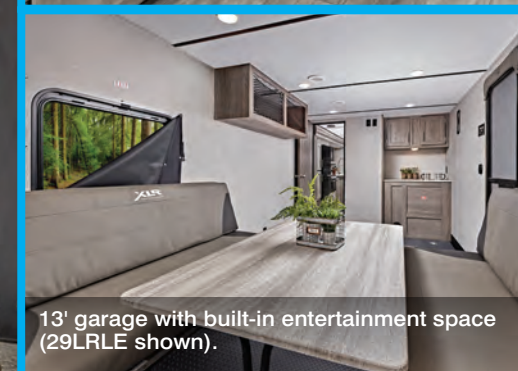

13' garage with built-in entertainment space (29LRLE shown).

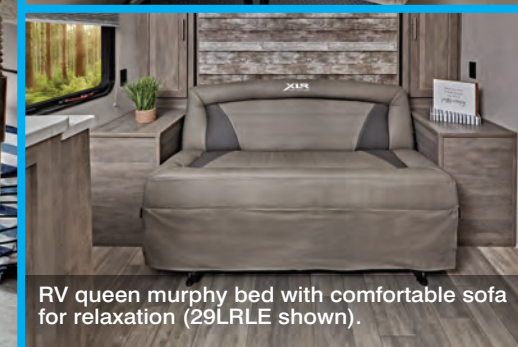

RV queen murphy bed with comfortable sofa for relaxation (29LRLE shown).



Full-sized bathroom with skylight in the shower (29LRLE shown).



The 35DSX11 bedroom features an XLR king bed, accent wall and cross ventilating windows.



The 29LRLE features a fireplace and all the amenities of home plus a 13' garage.

BOOST

The Boost series continues to be a game-changer in the world of Toy Haulers. It's a more affordable unit to get you into the new world of **Action Camping™**. Get reacquainted with nature. XLR's Boost series is what you need to venture out there. Just load up one of these great floorplans and go!



COMPRESSOR REFRIGERATOR

Our energy-efficient, 10 cu/ft, road-ready 12-Volt compressor refrigerator has integrated RV travel door latches, LED lighting, adjustable glass shelving, and clear door bins. Plus an off-grid feature to conserve energy (29LRLE shown).



QUEEN BED DINETTE

Furniture in the garage changes the ordinary to extraordinary! Dine at the back deck or transform the space into two queen beds for kids or guests (29LRLE shown).

FIFTH WHEEL FLOORPLANS

Boost Fifth Wheels come with either a 11', 13', 14' or 16' garage floorplans. We provide a choice of open and closed garage models help making sure you have room space you need. The length and weight of each model was taken into consideration to marry to the most common trucks on the market.

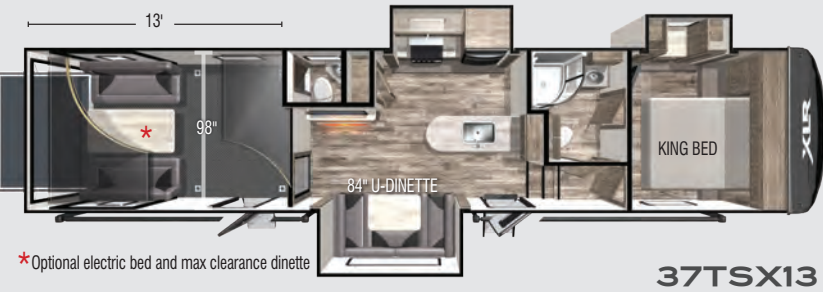
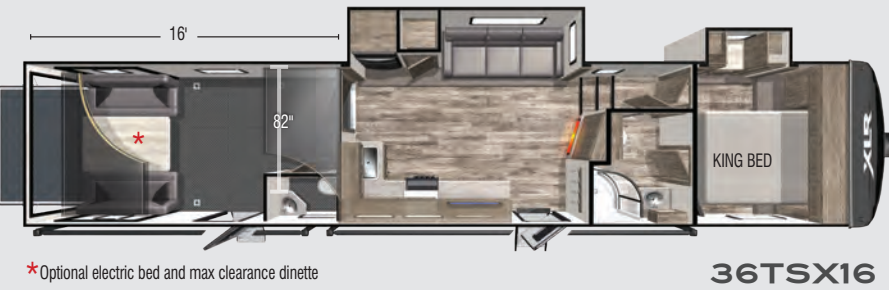
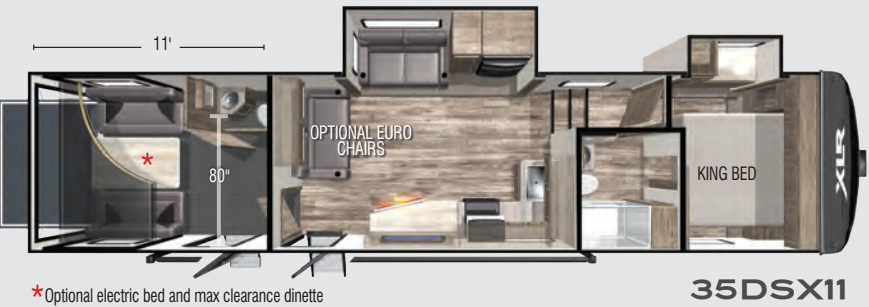

TRAVEL TRAILER WIDE BODY FLOORPLANS

These Wide Body Travel Trailer floorplans have two enclosed garage models and three open floorplan models. All but the 27QBX will fit a four-seat Side-by-Side inside. The 27QBX is that crossover Toy Hauler/Bunkhouse.

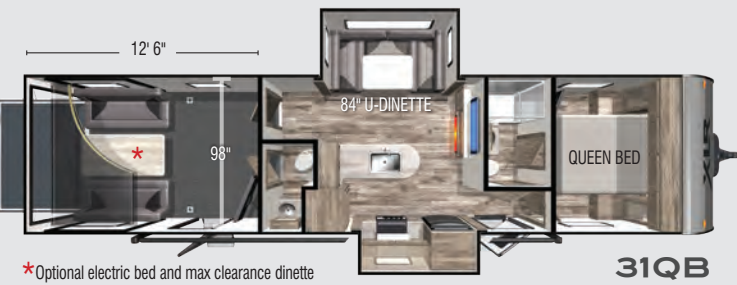
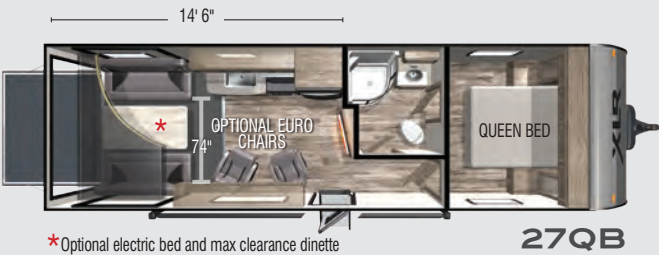
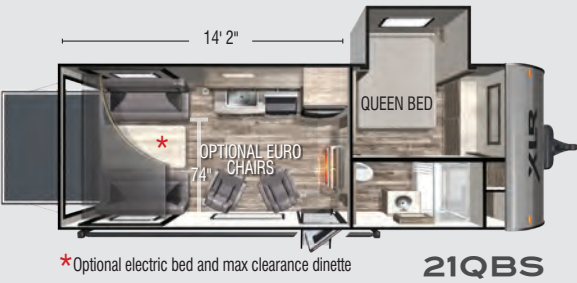

MICRO BOOST

MICRO BOOST NARROW BODY FLOORPLANS

Easier to tow and lighter weight highlight the Micro Boost series in both Travel Trailers and Fifth Wheels. They are narrower, yet offer high quality builds and many of the luxuries of home. These floorplans and series offer a quality camping trailer with a ramp and room to haul your toys!

TRAVEL TRAILERS

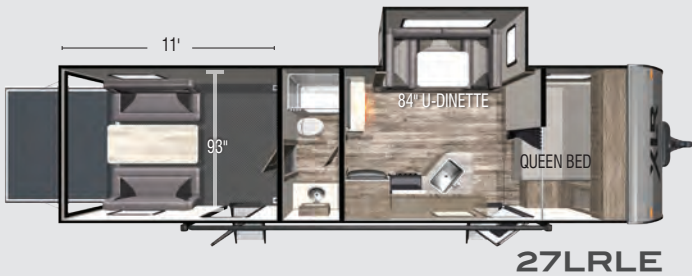
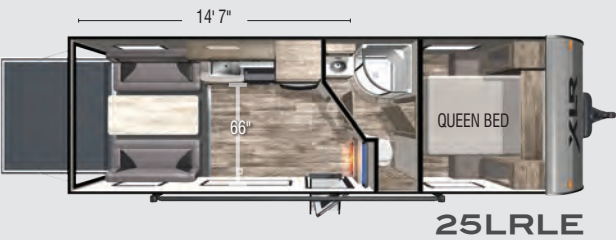

FIFTH WHEELS

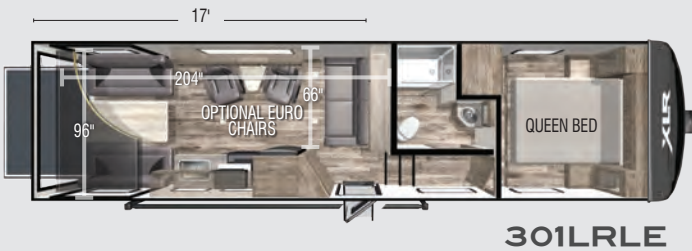

STANDARDS & OPTIONS

EXTERIOR

- 13.5K Main A/C w/ Ducted Roof Vents
- 15K Main A/C w/ Ducted Roof Vents (36TSX16 only)
- Friction Hinge Main Entry Door w/ Large Grab Handle
- Smooth Metal Front (TT)
- Color Metal Bands On Sidewall
- Body Armor Enclosed & Insulated Underbelly
- Heated Underbelly
- Enclosed Holding Tanks
- Extra Large 1-1/2" Fresh Water Drain Valve
- Seamless PVC Roof System
- Premium Electric Coated or Powder Coated Frames
- Digital TV Antenna
- Marine Grade External Speakers
- Moisture Barrier Floor Enclosure
- Pet Leash
- Hot & Cold Shower Box
- 30 gal Fuel Station w/ Gen Prep (N/A 27QBX)
- 12'-21' Power Awning w/ LED Lighting
- Under Unit Accent Lighting
- 5" Radius Wood Framed Roof
- Laminated Aluminum Framed Weather Proof Ramp Door
- Insulated Storage Doors
- 100 Gallon Fresh Water Tank
- Oversized Tank Capacities
- Battery Disconnect Switch
- High Capacity Water Pump
- 20# LP Bottles (2) w/ Cover
- Radius Safety Glass Windows
- Full Sized Spare Tire
- Black Tank Flush

- Back Up Camera Prep
- Roof Solar Prep
- Rear Spoiler Over Ramp Door
- Rear LED Strip Lighting Over Door
- Black Steel Wheels w/ Nitrogen Filled Radial Tires
- 5,000 lb. D-Rings
- RVQ Quick Connect LP
- No Wheel Wells
- 48" LED Front Fiberglass Cap Lighting (FW)
- Fiberglass Front Cap w/ Paint (FW)
- Diamond Plate Front Rock Guard (TT)
- 30AMP Service (TT)
- 50AMP Service (FW)
- Detachable Marine Grade Power Cord
- Upgraded Main Entry Step
- Walk on Roof
- Oil and Gas Resistant Residential Linoleum
- Power Tongue Jack or Landing Gear

INTERIOR

- Dual Zone / HDMI / BT / 2 Zone / APP
- 2 Interior Speakers
- 17" Black Oven w/ Glass Cooktop LED Lighting
- .9 Black Microwave
- 10CF - 12VDC Black Refrigerator
- 35,000 BTU Forced Air Ducted Furnace
- Deep Seated Stainless Steel Kitchen Sink
- Oval Residential Stainless Steel Lavy Sink
- Residential Pull Down Sprayer Faucet
- Stainless Steel Sink Cover Grate / Cutting Surface

- Residential Seamless Countertops
- Ball Bearing Extension Drawer Guides
- Pre-drilled and Screwed Cabinetry
- Solid Core Cabinet Stiles
- LED Interior Lighting
- High Definition LED Television
- Quick Recovery Water Heater
- Double Entrance Bathroom (FW)
- Skylight Over Shower
- Power Vent Fan
- Medicine Cabinet With Mirror
- Plastic Foot Flush Toilet
- Residential Walk In Showers
- Night Stands / Bedside Shelves
- USB Chargers
- Master Suite Queen Bed (TT)
- Master Suite King Bed (FW)
- Outside TV Brackets
- Sat and Cable Prep
- Magnetic Screen Wall
- Oil and Gas Resistant Garage Flooring (FW)
- Oil and Gas Resistant Residential Linoleum
- Large Panoramic Windows, Upgraded Residential Furniture
- Residential Decorative Sheet
- Solid Interior Passage Doors
- Fireplace - 5,000 BTU

REV PACKAGE

- LED TV
- 100 Gallon Fresh Water Capacity
- 30 Amp Service w/ Detachable Cord (Travel Trailers Only)

- 50 Amp Service w/Detachable Cord (Fifth Wheels Only)
- Fireplace
- Back Up Camera Ready, Bathroom Vent Fan
- 10CF - 12V Black Refrigerator
- 17" Oven w/ 3 Burner Cooktop w/ Glass Cover
- .9 Microwave
- Slim Range Hood Vent
- 2 Zone, HDMI, BT Radio, 2 Interior Speakers & 2 Exterior Speakers
- External Fuel Cell w/ Pump (N/A on 27QBX)
- External LED Strip Lighting
- LED Frame Lighting
- Friction Door Hinge
- Generator Prep (N/A on 27QBX)
- LED Interior Lights
- Outside TV Bracket and Hook Ups
- Power Awning
- Power Tongue Jack (Travel Trailers Only)
- Residential Kitchen Faucet
- Ramp Light
- RVQ Quick Connect LP
- Roof Solar Prep
- Decorative Vinyl Flooring
- Spare Tire
- Black Steel Wheels
- Battery Disconnect
- 5,000lbs Tie-downs
- Hot and Cold Outdoor Shower
- Enclosed Under Belly
- Pre-prepped for 4-pt leveling system (FW) (N/A 36TSX16)
- Magnetic Screen Wall

OPTIONAL EQUIPMENT

- 15k Main A/C IPO 13.5K
- 2nd 13.5K A/C (Requires 50AMP - 31QB & 29QBS Located In Garage) (N/A 21QBS)
- 2nd 15K BTU A/C Bedroom (N/A 21QBS) (37TSX13 & 36TSX16 Only)
- 50 AMP Service (TT)
- 4.0 Generator Powered by Yamaha (TT) (N/A with 50AMP or 27QBX)

- 5.5 Generator Powered by Yamaha (Requires 50AMP on TT) (N/A 27QBX & 21QBS)
- Electric Stabilizer Jacks
- Industrial Garage Rubber Floor (TT)
- Electric Bed w/ Max Clearance Pass Thru Dinette (TT) (N/A 27QBX)
- Electric Bed w/ Max Clearance Pass Thru Dinette (FW)
- Ramp Door Patio System

- Roof Ladder - Collapsible
- Ultracold Weather Heated Holding Tank 12V Pads
- Euro Recliner
- Sofa Slide IPO Dinette Slide (29QBX, 31QB, 37TSX13)(STD 36TSX16)
- 58" Steel Roll Over Sofa Door Side (21QBS, 27QB N/A, 32RZR14)
- TT Highgloss Fiberglass Ext Sidewall

- FW Highgloss Fiberglass Ext Sidewall (Mandatory 35DSX11, 36TSX16 & 37TSX13)
- 8CF Gas/Electric RV Refrigerator
- Alumafoil Insulation
- Inverter 1500W
- Renewable Energy Pkg (100W Flex Solar Panel, Control Panel, Wiring)
- Tri-glass Shower Door (STD 27QB, 32RZR14, 36TSX16 & 37TSX13)

| | 21QBS | 27QB | 27QBX | 29QBX | 31QB | 32RZR14 | 35DSX11 | 36TSX16 | 37TSX13 |
|-------------------|---------|--------|--------|---------|--------|---------|---------|-----------|-----------|
| Hitch Weight (lb) | 992 | 1,082 | 1,238 | 1,594 | 1,465 | 2,226 | 2,300 | 2,705 | 2,958 |
| UVW (lb) | 6,310 | 6,385 | 7,479 | 9,114 | 9,320 | 9,560 | 10,900 | 13,055 | 12,687 |
| CCC (lb) | 4,882 | 3,600 | 3,959 | 4,480 | 4,145 | 4,666 | 3,362 | 4,800 | 4,999 |
| Exterior Length | 26' 11" | 31' 0" | 33' 7" | 36' 11" | 39' 3" | 33' 8" | 38' 8" | 43' 9" | 39' 9" |
| Exterior Height | 12' 5" | 12' 5" | 12' 5" | 12' 5" | 12' 5" | 13' 5" | 13' 5" | 13' 5" | 13' 5" |
| Exterior Width | 102" | 102" | 102" | 102" | 102" | 102" | 102" | 102" | 102" |
| Fresh Water (gal) | 100 | 100 | 100 | 100 | 100 | 100 | 100 | 100 | 100 |
| Gray Water (gal) | 38 | 38 | 76 | 38 | 38 | 38 | 38 | 76 | 38 |
| Black Water (gal) | 38 | 38 | 38 | 76 | 76 | 38 | 76 | 76 | 76 |
| Awning Size | 15' | 15' | 15' | 21' | 15' | 15' | 21' | 12' & 12' | 12' & 12' |

SPECIFICATIONS

STANDARDS & OPTIONS

EXTERIOR

- 13.5K Main A/C w/ Ducted Roof Vents
- Friction Hinge Main Entry Door w/ Large Grab Handle
- Smooth Metal Front
- Color Metal Bands On Sidewall
- Body Armor Enclosed & Insulated Underbelly
- Heated Underbelly
- Enclosed Holding Tanks
- Extra Large 1 1/2" Fresh Water Drain Valve
- Seamless PVC Roof System
- Premium Electric Coated or Powder Coated Frames
- Digital TV Antenna
- Marine Grade External Speakers
- Moisture Barrier Floor Enclosure
- Pet Leash
- 12'-21' Power Awning w/ LED Lighting
- 5" Radius Wood Framed Roof
- Laminated Aluminum Framed Weather Proof Ramp Door
- Insulated Storage Doors
- Oversized Tank Capacities
- Battery Disconnect Switch
- High Capacity Water Pump
- 20# LP Bottles (2) w/ Cover
- Radius Safety Glass Windows
- Full Sized Spare Tire
- Black Tank Flush
- Back Up Camera Prep
- Roof Solar Prep
- Rear LED Strip Lighting Over Door

- Black Steel Wheels w/ Nitrogen Filled Radial Tires
- 5,000 lb. D-Rings
- RVQ Quick Connect LP
- No Wheel Wells
- Diamond Plate Front Rock Guard
- 30AMP Service (TT) 50AMP (FW)
- Detachable Marine Grade Power Cord
- Upgraded Main Entry Step
- Walk on Roof
- Oil and Gas Resistant Residential Linoleum
- Power Tongue Jack or Landing Gear

INTERIOR

- Dual Zone / HDMI / BT / 2 Zone / APP
- 2 Interior Speakers
- 17" Black Oven w/ Glass Cooktop LED Lighting
- .9 Black Microwave
- 10CF - 12VDC Black Stainless Steel Refrigerator
- 20,000 BTU Forced Air Ducted Furnace
- Deep Seated Stainless Steel Kitchen Sink
- Oval Residential Stainless Steel Lavy Sink
- Residential Seamless Countertops
- Ball Bearing Extension Drawer Guides
- Pre-drilled and Screwed Cabinetry
- Solid Core Cabinet Stiles
- LED Interior Lighting
- Quick Recovery Water Heater
- Skylight Over Shower
- Power Vent Fan
- Medicine Cabinet With Mirror

- Foot Flush Toilet
- Residential Walk In Showers
- Night Stands / Bedside Shelves
- USB Chargers
- Master Suite Queen Bed
- Outside TV Brackets
- Sat and Cable Prep
- Magnetic Screen Wall
- Oil and Gas Resistant Residential Linoleum
- Large Panoramic Windows
- Upgraded Residential Furniture
- Residential Decorative Sheet
- Solid Interior Passage Doors
- Fireplace - 5,000 BTU (NA 301LRLE)

XPLORE PACKAGE

- Main Entry Upgraded Step
- VIP Patio Deck
- 30AMP Service w/ Detachable Power Cord (Travel Trailer Only)
- 50AMP Service (Fifth Wheels Only)
- LED Step Light
- Fireplace (N/A 301LRLE)
- Back Up Camera Ready
- Bathroom Vent Fan
- 10CF - 12V Black Refer
- 17" Oven w/3 Burner Cooktop with Glass Cover
- .9 Microwave
- Slim Range Hood Vent
- 2 Zone / HDMI / BT Radio
- 2 Interior Speakers
- 2 Exterior Speakers
- 6 Gallon Gas/Electric DSI Water Heater
- External LED Strip Lighting

- Power Awning
- Power Tongue Jack
- Residential Kitchen Faucet
- Ramp Light
- LED Interior Lights
- Roof Solar Prep
- Black Tank Flush
- Stainless Steel Kitchen & Lavy Sinks
- Residential Kitchen Faucet
- Outside TV Bracket and hookups
- USB Charging Station
- Digital TV Antenna
- Spare Tire
- Black Steel Wheels
- Pet Leash
- Rear Beaver Tail Frame

OPTIONAL EQUIPMENT

- 15K A/C IPO 13.5K Main A/C
- 2nd 13.5K A/C (Fifth Wheels Only) (Standard 50AMP Service)
- Ultracold Weather Heated Holding Tank 12V Pads
- Spray Port
- 8CF - Gas / Electric RV Refrigerator
- Oil & Gas Resistant Garage Flooring
- LED TV
- Euro Recliner
- Renewable Energy Package
- Inverter 1500 W
- Sleep N Store Manual Bed Lift (FW Mandatory)
- Sofa Slide IPO Dinette Slide (27LRLE)
- Highgloss Fiberglass Ext Sidewall
- Electric Stabilizer Jacks (Fifth Wheels Only)



| | 25LRLE | 27LRLE | 29LRLE | 301LRLE | 335LRLE |
|-------------------|--------|--------|---------|---------|-------------|
| Hitch Weight (lb) | 768 | 1,060 | 1,130 | TBD | 1,310 |
| UVW (lb) | 5,012 | 6,056 | 6,426 | TBD | 7,910 |
| CCC (lb) | 2,634 | 1,966 | 4,904 | TBD | 3,592 |
| Exterior Length | 28' 9" | 33' 5" | 33' 11" | TBD | 31' 11-3/4" |
| Exterior Height | 10' 9" | 10' 9" | 10' 9" | TBD | 10' 9" |
| Exterior Width | 96" | 96" | 96" | TBD | 96" |
| Fresh Water (gal) | 46 | 46 | 46 | TBD | 46 |
| Gray Water (gal) | 38 | 38 | 76 | TBD | 38 |
| Black Water (gal) | 38 | 38 | 38 | TBD | 38 |
| Awning Size | 15' | 15' | 21' | TBD | 15' |

SPECIFICATIONS

XTRA STORAGE

Fifth Wheel exterior storage increased 40% this year. We added storage space over the generator area and an additional compartment access door.



SOUND

Our new JBL Marine Series Speakers are ready to take on anything Mother Nature throws your way. These powerful speakers feature waterproof motor structures, a one-piece cast polymer basket, a sealed magnet and rubber surrounds.



WHY XTRA MATTERS?











What's XTRA BUILT? If you compare us to other Travel Trailers and Fifth Wheels, you'll see that an XLR Toy Hauler is simply built right. We know that Action Campers use their RV's the way they play—harder. So stronger construction and features mean you'll be ready for the road (or offroad).



XTRA CONSTRUCTION FEATURES

- 1 Body Armor Underbelly
- 2 16" On-Center Studs
- 3 3/8" Roof Decking for Full Walk-On Strength
- 4 5000-lb. D-Rings (Best In Class)
- 5 Oversized Axles
- 6 Larger Holding Tanks
- 7 5/8" Tongue-and-Groove Flooring
- 8 Gelcoat Fiberglass Walls (Optional on all Boost & Micro Boost)
- 9 NXG Frames (N/A 36TSX16)
- 10 Cable Slide Systems Main Floor

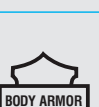
CONSTRUCTED TO LAST

| | |
|--|--|
|  <p>NXG frames are constructed with High Strength Low Alloy (HSLA) prime steel with specifically controlled properties.</p> |  <p>Holding tank capacities are best in class allowing you to better enjoy your Toy Hauler experience without frequent interruptions to drain or fill the liquids. 100-gallon fresh tank standard on Boost.</p> |
|  <p>Heavy-duty LCI® axles offer you the best in class carrying capacities.</p> |  <p>Stainless steel kitchen and bathroom sinks, with residential faucets, provide modern appointments to hold up to all the activities like home.</p> |
|  <p>Our Nitro-Fill™ radial tires offer a “No Excuses Guarantee” unmatched in the industry.</p> |  <p>Solar Prep is provided on the roof of your unit for an optional, flexible solar panel and monitor which is pre-wired in the unit. They are marked with a locator decal.</p> |
|  <p>5/8" tongue-and-groove plywood caps the traditional wood constructed floor structure.</p> |  <p>XLR continues to offer the strongest 5,000-lb. tie-down anchor system in the industry to secure your precious cargo.</p> |
|  <p>Body Armor Underbelly is a PVC laminated to a foil radiant barrier insulation to ensure the protection of your undercarriage and improve your in-cabin comfort.</p> |  <p>Our 1.5" fresh water drain provides a lightning fast way to empty your tank.</p> |

ACTION CAMPING™



THE VOTES ARE IN!

RV owners have voted our Boost and Mirco Boost Toy Haulers as top picks in Trailer Life Readers' Choice Awards.

WHY ACTION CAMPING™ MATTERS?

Action Camping is what you do, it's who you are! That's why every XLR Boost that we build is focused on making your adventures come true. Getting there, enjoying and making memories, and doing it all in a vehicle purpose-built for Action Camping is what you'll find here.



PRE-DELIVERY INSPECTION FACILITY
20,000 square feet of quality assurance. The bare essentials for a premium product. This state-of-the-art facility gives immediate feedback to production for quality assurance in every unit built.



**24/7 EMERGENCY
ROADSIDE ASSISTANCE
WITH VEHICLE PURCHASE***

TOWING
JUMP-STARTS
TIRE CHANGES
FLUID DELIVERY
LOCKOUT
SERVICE

WINCH-OUT
MOBILE MECHANIC
TECHNICAL
SUPPORT
DEALER LOCATOR
SERVICES



FREE MEMBERSHIP
to Forest River Owners' Group

www.forestriverfrog.com



Learn More
Scan this barcode using
a QR Reader on your
smart phone to learn
more about Forest River.



FOREST RIVER
OWNER DIGITAL
KIT APP

Now you can have your Owner's Manual with you where ever you are. Download our FREE app from the App Store or Google Play and you'll have the information at your fingertips.



Actual towing capacity is dependent on your particular loading and towing circumstances, which includes GVWR, GAWR and GCWR, as well as adequate trailer brakes. Please refer to the Owner's Manual of your vehicle for further information. All information contained in this brochure is believed to be accurate at the time of publication. However, during the model year, it may be necessary to make revisions and Forest River, Inc., reserves the right to make all such changes without notice, including prices, colors, materials, equipment and specifications as well as the addition of new models and the discontinuance of models shown in this brochure. Therefore, please consult with your Forest River dealer and confirm the existence of any materials, design or specifications that are material to your purchase decision. ©2020 XLR, a Division of Forest River, Inc., a Berkshire Hathaway company. All Rights Reserved. 10/20