

HIDEOUT

TRAVEL TRAILERS • SPORT TRAVEL TRAILERS

Colton RV & Marine
3122 Niagara Falls Blvd.
North Tonawanda, NY 14120
(716) 694-0188
www.ColtonRV.com

Colton RV
489 Bushkill Plaza LN #9665
Wind Gap, PA 18091
(610) 863-5239
www.ColtonRV.com



KEYSTONE
RV COMPANY

CAMP BETTER



HIDEOUT 29DFS



HIDEOUT 29DFS

2023 HIDEOUT | EXCEPTIONAL FEATURES

- SOLARFLEX™ 200 SOLAR POWER SYSTEM W/OPTIONAL DRAGONFLY ENERGY LITHIUM-ION BATTERY
- **NEW** GIRARD TANKLESS WATER HEATER
- CENTRAL VACUUM (N/A ON SPORT)
- BLADE™ HIGH-PERFORMANCE AIR FLOW SYSTEM (N/A ON SPORT)
- TINTED WINDOWS (N/A ON SPORT)
- PORCELAIN TOILET (N/A ON SPORT)
- **NEW** MEDICINE CABINET ABOVE BATHROOM SINK
- **NEW** RESILIENT VINYL FLOORING IN SLIDE ROOMS (N/A ON SPORT)
- SEAMLESS KITCHEN COUNTERTOPS
- **NEW**.040" SMOOTH METAL FRONT (N/A ON SPORT)
- SOLIDSTEP® AT MAIN ENTRY DOOR (N/A 38s)
- EXTRA-LARGE GRAB HANDLE
- WINEGARD™ AIR 360+ OMNIDIRECTIONAL ANTENNA WITH WI-FI/4G LTE
- POWER STABILIZER JACKS (N/A ON SPORT & 38s)
- POWER TONGUE JACK (N/A ON SPORT & 38s)

MODEL	WEIGHT	CARRYING CAPACITY	HITCH WEIGHT	FRESH WATER**	WASTE WATER	GRAY WATER	LPG	LENGTH*	WIDTH	HEIGHT	AWNING
174RK	4085	1115	525	21	30	30	20	21' 5"	8'	10' 2"	10'
175BH	3428	972	485	21	30	30	20	21' 5"	8'	10' 2"	10'
176BH	3810	690	520	21	30	30	20	21' 5"	8'	10' 2"	10'
177RD	3397	1003	540	21	30	30	20	21' 5"	8'	10' 2"	10'
179RB	3753	727	480	21	32	30	20	21' 5"	8'	10' 2"	10'
181BH	TBD	TBD	TBD	21	30	60	20	22' 9"	8'	10' 4"	15'
186SS	4291	709	610	21	30	30	20	22' 10"	8'	10' 4"	14'
201BH	TBD	TBD	TBD	21	TBD	TBD	TBD	TBD	8'	TBD	TBD
20RDN (202RD)	TBD	TBD	TBD	37	39	39	40	24' 11"	8'	10' 3"	12'
22MLS	TBD	TBD	TBD	37	39	39	40	26' 4"	8'	11' 1"	16'
24RBS	TBD	TBD	TBD	37	TBD	TBD	TBD	TBD	8'	TBD	TBD
25BHN (262BH)	TBD	TBD	TBD	37	30	39	40	29' 3"	8'	10' 3"	12'
25BHS	TBD	TBD	TBD	37	TBD	TBD	TBD	TBD	8'	TBD	TBD
25RDS	6195	1405	1010	37	30	39	40	29' 7"	8'	11' 1"	18'
26BHS (272BH)	TBD	TBD	TBD	37	30	30	40	30' 8"	8'	11' 1"	16'
28RKS	7012	2648	860	37	39	78	40	32' 11"	8'	11' 1"	18'
29DFS	7126	2554	920	37	30	78	40	33' 11"	8'	11' 1"	16'
29QBS (290QB)	TBD	TBD	TBD	37	39	39	40	33' 3"	8'	11' 1"	18'
31BRD (318BR)	TBD	TBD	TBD	37	39	69	40	35' 11"	8'	11' 2"	18'
32LBH	7516	2284	1045	37	30	69	40	36' 6"	8'	11' 0"	18'
34FKDS	8394	1506	1100	37	39	78	40	38' 11"	8'	11' 2"	18'
38BHDS	8306	1664	1170	37	39	39	60	39' 11"	8'	11' 2"	18'
38FDDS	8519	1481	1205	37	39	39	60	39' 11"	8'	11' 2"	18'
38FKTS	9286	1714	1200	37	39	78	60	39' 11"	8'	11' 4"	18'
38FQTS	9350	2010	1200	37	78	78	60	39' 11"	8'	11' 4"	18'

HIDEOUT

Keystone Hideout RVs make it incredibly easy to become a camper. Choose from a wide selection of floorplans from sport travel trailer models to bunkhouses roomy enough for the entire family (and a few neighbor kids)! You'll fall in love with Hideout's airy interiors and dialed-in features – all at affordable price points.



"The layout of our unit is perfect for us. We are retirees with two small dogs. The dinette slideout gives us and the puppies plenty of floor space. The countertop space is great and gives us room for our small TV and food prep. The Murphy bed with the couch is also a big plus. Pulling this small RV with my half-ton is also easy."

— HIDEOUT 174RK OWNER

VISIT OUR WEBSITE FOR PHOTOS,
360° TOURS, AND FULL PRODUCT DETAILS



NEW TO CAMPING? Keystone RV's Matt Ardnt & Bart Taylor walk you through everything you need to know from your pre-travel checklist to full campsite set-up. You can find this series on Keystone's YouTube channel or follow this QR code to our website.

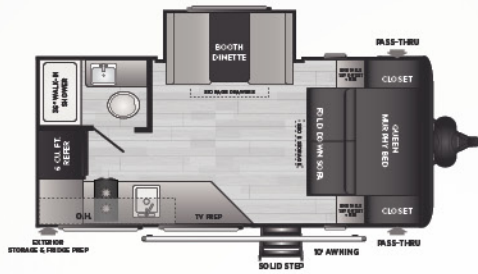

174RK

WEIGHT **4085** | LENGTH **21' 5"**

SPORT • BOOTH DINETTE, REAR KITCHEN SLIDE, MURPHY BED

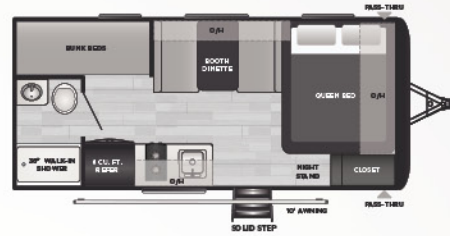

175BH

WEIGHT **3428** | LENGTH **21' 5"**

SPORT • NON-SLIDE, SINGLE BUNKS

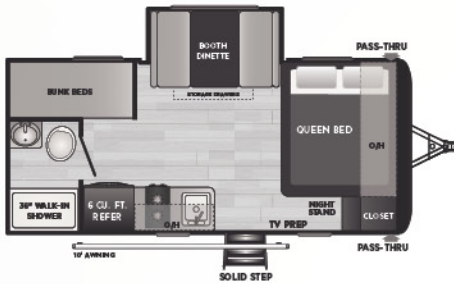

176BH

WEIGHT **3810** | LENGTH **21' 5"**

SPORT • BOOTH DINETTE SLIDE, SINGLE BUNKS

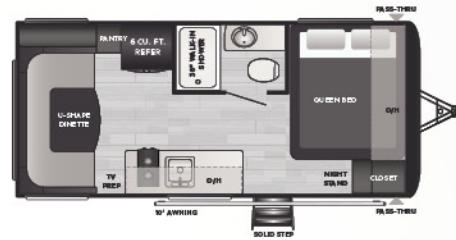

177RD

WEIGHT **3397** | LENGTH **21' 5"**

SPORT • NON-SLIDE, REAR DINETTE

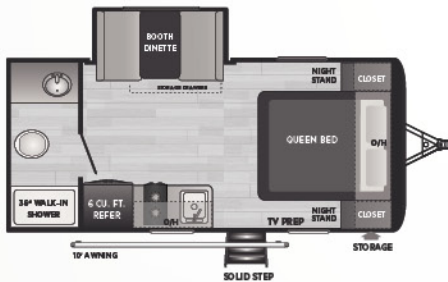

179RB

WEIGHT **3753** | LENGTH **21' 5"**

SPORT • BOOTH DINETTE SLIDE, REAR BATHROOM

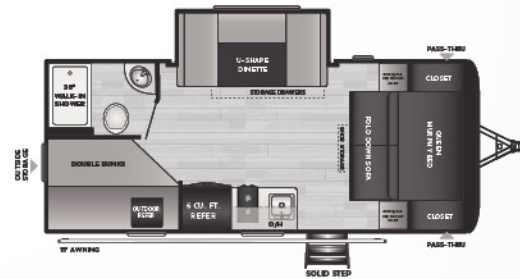

181BH

WEIGHT **4580** | LENGTH **22' 9"**

SPORT • U-SHAPE DINETTE SLIDE, DOUBLE BUNKS, MURPHY BED

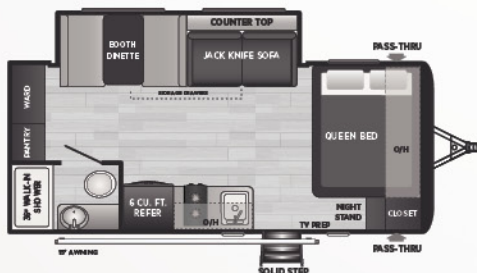

186SS

WEIGHT **4291** | LENGTH **22' 10"**

SPORT • SUPER SLIDE, REAR PANTRY/WARDROBE

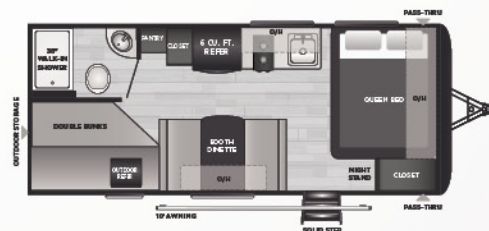

201BH

WEIGHT **TBD** | LENGTH **TBD**

SPORT • NON-SLIDE DOUBLE BUNKS

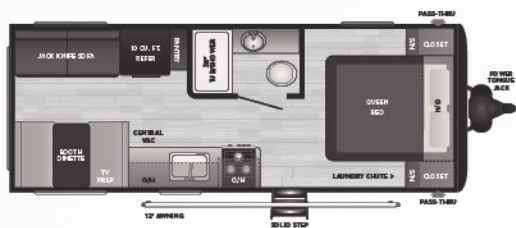

20RDN | WEIGHT TBD | LENGTH 24' 11" |
 ▪ NON-SLIDE, REAR DINETTE, LARGE REAR WINDOWS

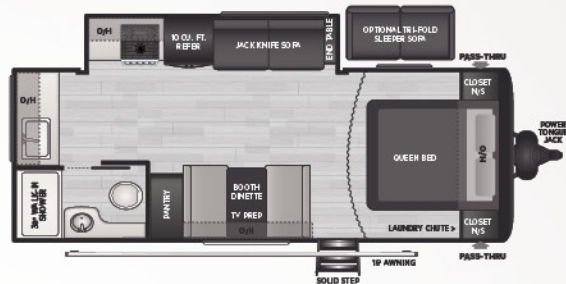

NEW! 22MLS | WEIGHT 5525 | LENGTH 26' 4" |
 ▪ COMBO SLIDE, MIDDLE LIVING, OPEN CONCEPT

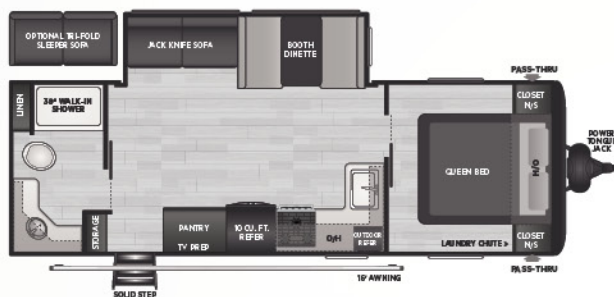

NEW! 24RBS | WEIGHT TBD | LENGTH TBD |
 ▪ SUPER SLIDE, REAR BATH, OUTDOOR KITCHEN

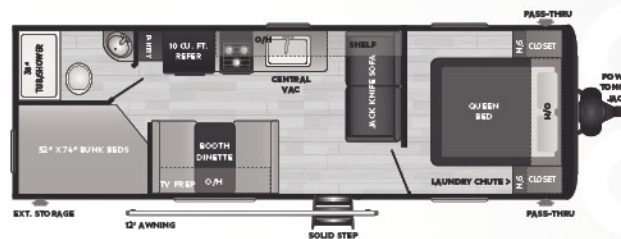

NEW! 25BHN | WEIGHT TBD | LENGTH 29' 3" |
 ▪ NON-SLIDE, DOUBLE BUNKS, PRIVATE BEDROOM

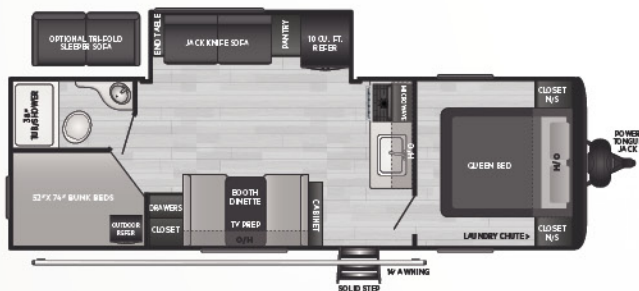

NEW! 25BHS | WEIGHT TBD | LENGTH TBD |
 ▪ COMBO SLIDE, DOUBLE BUNKS, OUTDOOR KITCHEN

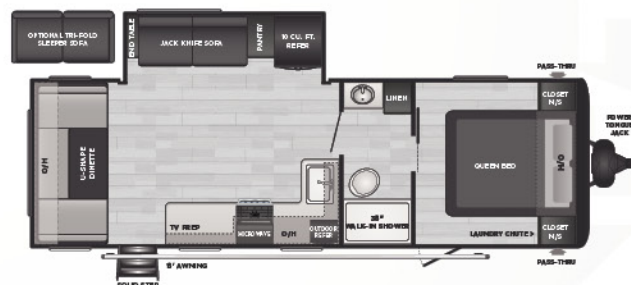

NEW! 25RDS | WEIGHT 6195 | LENGTH 29' 7" |
 ▪ COMBO SLIDE, REAR DINETTE, OUTDOOR KITCHEN

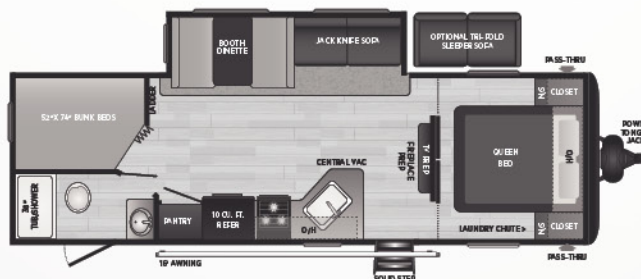

26BHS | WEIGHT TBD | LENGTH 30' 8" |
 ▪ SUPER SLIDE, DOUBLE BUNKS, DOUBLE ENTRY

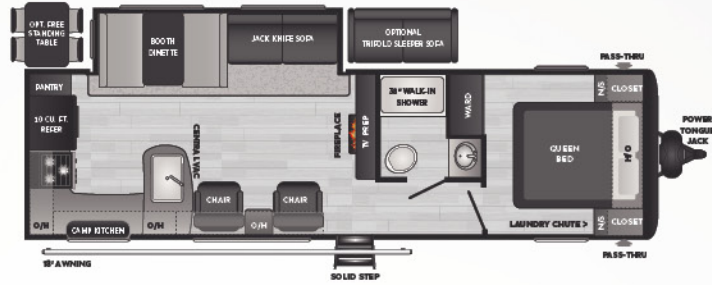

28RKS | WEIGHT 7012 | LENGTH 32' 11"

- SUPER SLIDE, REAR KITCHEN, OUTSIDE KITCHEN

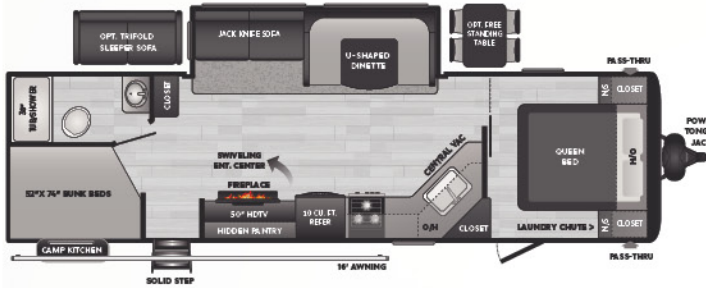

29DFS | WEIGHT 7126 | LENGTH 33' 11"

- SUPER SLIDE, DOUBLE BUNKS, HIDDEN PANTRY

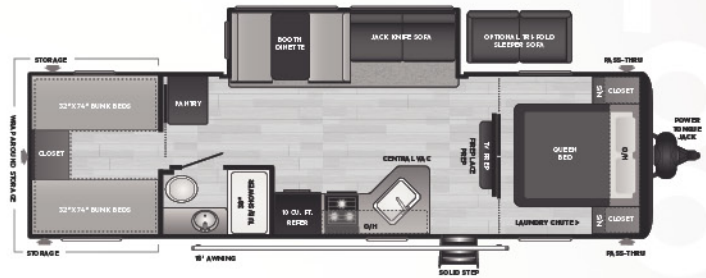

29QBS | WEIGHT TBD | LENGTH 33' 3"

- SUPER SLIDE, FOUR SINGLE BUNKS, LARGE WRAP AROUND EXTERIOR STORAGE

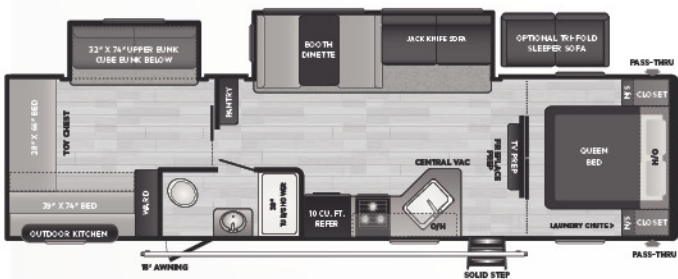

31BRD | WEIGHT TBD | LENGTH 35' 11"

- DOUBLE SLIDE, BUNKROOM W/ SLIDE, LARGE OUTSIDE KITCHEN

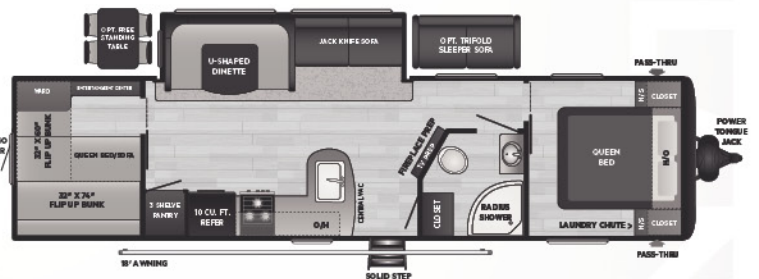

32LBH | WEIGHT 7516 | LENGTH 36' 6"

- SUPER SLIDE, BUNKROOM, BIKE DOOR

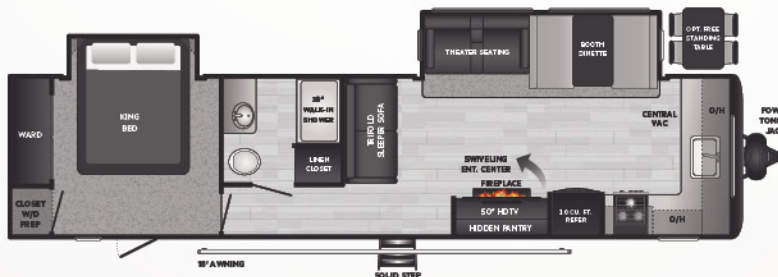

34FKDS | WEIGHT 8394 | LENGTH 38' 11"

- DOUBLE SLIDE, KING BED SLIDE, WASHER/DRYER PREP

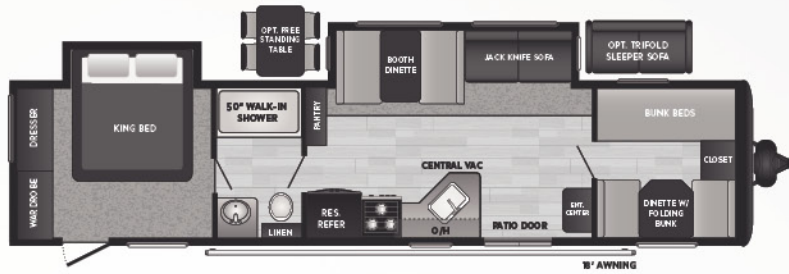

38HDS | WEIGHT 8306 | LENGTH 39' 11"

▪ DOUBLE SLIDE, KING BED SLIDE, FRONT BUNKROOM

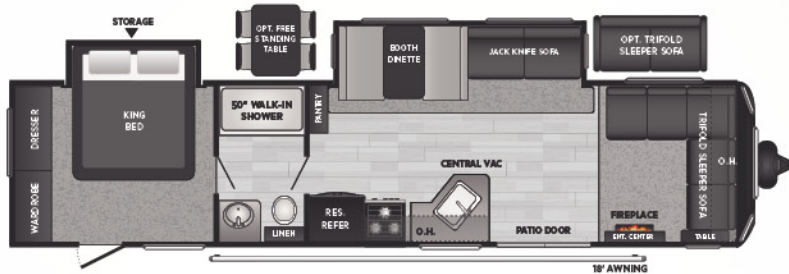

38FDDS | WEIGHT 8519 | LENGTH 39' 11"

▪ DOUBLE SLIDE, KING BED SLIDE, FRONT SECTIONAL

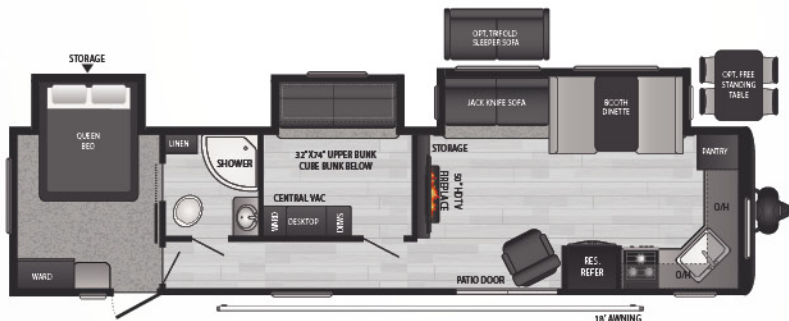

38FKTS | WEIGHT 9286 | LENGTH 39' 11"

▪ TRIPLE SLIDE, QUEEN BED SLIDE, MID-BUNKROOM W/ SLIDE

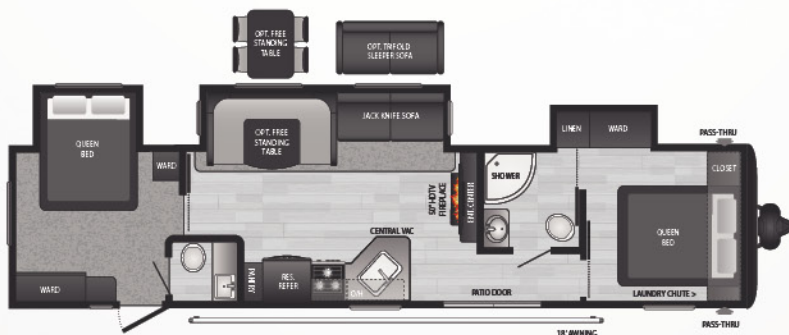

38FQTS | WEIGHT 9350 | LENGTH 39' 11"

▪ TRIPLE SLIDE, QUEEN BED SLIDE, FRONT QUEEN W/ WARDROBE SLIDE



TAKE CHARGE OF HOW YOU CAMP

EXCEPTIONAL QUALITY, IMPOSSIBLY VERSATILE, SolarFlex™
IS SHATTERING CUSTOMER'S EXPECTATIONS OF FACTORY-INSTALLED SOLAR POWER.
EXCLUSIVELY AVAILABLE ON ALL KEYSTONE RV MODELS.



Relieve battery anxiety with legendary Lithium-ion deep cycle batteries — the ultimate replacement for lead acid. Lightweight, reliable, and longer-lasting, Dragonfly Energy batteries are made in the USA and available exclusively from Keystone RV and authorized dealers.

MY KEYSTONE OWNER'S APP

THE ONLY APP YOU'LL NEED...

» MANUALS & QUICK START GUIDES

» HOW-TO VIDEOS

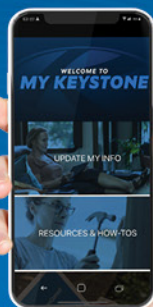

» FIRST-TIME CAMPER'S ADVICE

» ACCESS TO YOUR RV'S MOBILE APPS

Available for iOS
and Android devices.



FOLLOW US FOR THE LATEST!



DISCLAIMER: Product information is as accurate as possible as of the date of publication of this brochure. All features, floor plans, and specifications in this brochure are subject to change without notice. Please also consult Keystone's web site at www.keystonerv.com for more current product information and specifications. Tow Vehicle Disclaimer. CAUTION: Owners of Keystone recreational vehicles are solely responsible for the selection and proper use of tow vehicles. All customers should consult with a motor vehicle manufacturer or their dealer concerning the purchase and use of suitable tow vehicles for Keystone products. Keystone disclaims any liability or damages suffered as a result of the selection, operation, use or misuse of a tow vehicle. KEYSTONE'S LIMITED WARRANTY DOES NOT COVER DAMAGE TO THE RECREATIONAL VEHICLE OR THE TOW VEHICLE AS A RESULT OF THE SELECTION, OPERATION, USE OR MISUSE OF THE TOW VEHICLE. *Length is defined as the distance from the centerline of hitch pin/coupler to rear bumper of trailer. ** Fresh water capacity includes water heater. Please review owner's manual prior to purchase for more information on service warranties, extended use, towing and maintenance. Owner's manuals can be found at keystonerv.com.

PRINT 09.2022