

BULLET
ULTRA LITE

LIGHTWEIGHT VEHICLES • CROSOVER VEHICLES • 1/2 TON TRUCKS

 **Keystone RV
Company**

BULLET

ULTRA LITE

by Keystone



A NEW ERA IN ULTRA LITES
www.keystonerv.com/bullet

BULLET
ULTRA LITE
by Keystone



284RLS | SHOWN IN SADDLE DECOR

1

WHAT IS BULLET?

The Bullet is a full-featured ultra lite travel trailer designed to be towed by the new fuel-efficient SUVs, crossover vehicles and 1/2-ton pick-up trucks.

www.keystonerv.com/bullet

CONVENIENCE, COMFORT AND STYLE

While other ultra lite trailers cut corners to save weight, with Bullet you enjoy ultra lite towing without sacrificing features and eye appeal. For example, Bullet's sleek aerodynamic front profile, wide-stance axle system, and contoured fender skirts create a trailer that tows with ease and looks great. Front diamond-plate rockguard, radius crowned roof, lighted pass-thru storage, gas-strut entrance door assist, oversized jalousie windows and electric awning are more features you'll find in the Bullet that you won't see on other ultra lites.

Bullet's attention to detail doesn't stop with the exterior. Inside Bullet you'll appreciate the plush, high back sofa, upgraded fabrics, window night shades, hardwood cabinet doors, 9" single basin kitchen sink, visionary sofa, upgraded dinette, and comfortable queen-sized bed with memory foam mattress. You will truly feel at home. Bullet's careful attention to detail and thoughtful use of space result in the most livable ultra lite on the market today.



298BHS | BUNK ROOM IN GARDEN VIEW DECOR

2



248RKS | SHOWN IN GODIVA DECOR

3



1

The **plush interior** of the 284RLS is sure to help you relax. Take a seat in the large pillow backed swivel chairs and gaze outside the huge rear window. Bullet is the only travel trailer in its class to offer a visionary memory foam sofa sleeper, which is much more comfortable than a thin foam pad!

2

The **kiddie dinette** gives your little campers a playroom of their own with the sleeping space to go with it.

3

The **rear kitchen** of the 248RKS offers both plenty of countertop space and storage designed with the needs of today's camper in mind.

4

Enjoy the amenities of an **outdoor kitchen** without having to pull all of the weight of a traditionally built travel trailer. The 286QBS weighs in at approximately 5250 lbs.!



286QBS | OUTDOOR KITCHEN

4

#1 MANUFACTURER

Own with confidence. Bullet is a division of Keystone RV Company, the number one manufacturer of towable RVs in North America. You can count on Keystone for quality and support in the years ahead.

BULLET

www.keystonerv.com/bullet **ULTRA LITE**
by Keystone

EXTERIOR FEATURES



Largest **pass-thru storage** in its class. 40.3 cubic ft. of storage provides an abundance of space for all of your camping gear.



Jalousie windows allow you to keep the windows open for air flow, even when it's raining.



Electric awning with adjustable arms makes it easy to extend/retract the awning as well as adjust the ends for water run-off.



Gas struts eliminate the concerns of replacing brittle plastic door catches.



Wide stance axles provide a better towing experience by reducing bounce and sway during travel.



Exterior shower comes equipped with a fixed shower head and access to both hot and cold water.



1. Quick Access LP Cover
2. Integrated Dual Battery Tray
3. Diamond Plate Stone Guard
4. Aerodynamic Front Profile
5. Hurricane Straps
6. 5" Radius Galvanized Roof Trusses
7. Fully Insulated Roof
8. Durable Roof Decking
9. 13.5 Quick Cool Air Conditioning
10. One Piece EPDM Rubber Roof
11. Full Length Rain Gutter and Spouts
12. Smooth Fiberglass Exterior
13. 1/8" Luan Wall Backing

14. Hi-Density Block Foam Insulation
15. 1 1/2" Box Welded Aluminum Frame Structure
16. Decorative Interior Wall Board
17. Bullet's Multi Seal and Track Slide System
18. Radial Tires with Electric Breaks (4)
19. Wide Stance Axle System
20. Easy Lube Axles

21. Residential Stain Resistant Linoleum
22. 1st Layer Floor Decking
23. 2nd Layer Floor Decking
24. Hi-Density In Floor Block Foam Insulation
25. Welded Aluminum Floor Joists

LIGHTWEIGHT SOLID CONSTRUCTION



- 26. 3rd Layer Floor Decking
- 27. Paco/I - Beam Frame
- 28. Darco Moisture Barrier Wrap
- 29. Enclosed Underbelly
- 30. Radius Entry Steps

INTERIOR FEATURES



Laundry chute provides a convenient place to dispose of dirty clothes until you get home.



9" Single Basin Kitchen Sink allows enough size and depth for washing pots & pans.



Monitor Panel provides a central location for patio awning, slideout and light switches



Large Radius Dinette provides enough room for four adults to sit and enjoy a meal.



Blackout shades provide a durable, kid-friendly alternative for blocking out sunlight.



CD/DVD/AM/FM Stereo w/ MP3 hookup gives you multiple options for entertainment on those rainy days at the campground.



Visionary Sofa offers a relaxed place to lounge during the day and gives your guests a comfortable sleeping option at night.



Swivel TV (per floorplan) eliminates the need to bring a second television for the master bedroom.

BULLET

www.keystonerv-bullet.com **ULTRA LITE**
by Keystone



204RBS



246RBS



248RKS



286QBS

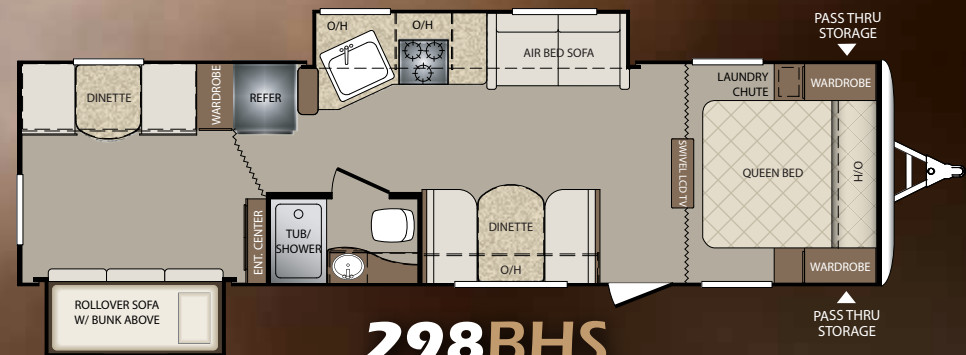

298BHS

DUNE
DECORSADDLE
DECORGARDEN VIEW
DECOR

CONSTRUCTION STANDARDS

- Aggressive Front Profile for Increased Towability
- Aluminum Framed Front, End and Side Walls
- Laminated Fiberglass Exterior Side Walls
- 2" Thick Laminated Aluminum Floor
- In-Frame Fresh, Grey, and Black Water Tanks
- 6" and 8" I-Beam with Welded Outriggers
- ¼" ABS Enclosed Underbelly
- Darco Moisture Barrier
- One Piece Seamless Rubber Roof
- E-Z Lube Axles
- Electric Brake System (4 wheels)
- R-11 Insulation in Floor
- R-7 Insulation in Sidewalls
- R-11 Insulation in Roof

EXTERIOR CAMPING PACKAGE

- Wide Stance E-Z Lube Axles
- 6 Gallon Gas/Electric DSI Water Heater
- Radius Entry Door with Gas Strut
- Outside Speakers
- Outside Shower (Hot & Cold Water)
- Tinted Safety Glass Windows
- 4 Stabilizer Jacks
- 4 Antenna & Cable Hook-Up
- Electric Awning with Adjustable Arms
- Radial Tires

EXTERIOR FEATURES

- Dual Propane Tanks with Cover
- Front Diamond Plate
- In Frame Dual Battery Rack
- Oversized Exterior Pass Thru Storage with Lighting
- Contoured Fender Skirts for Increased Air-Flow
- LP Quick Connect
- Amber Patio Light
- Spare Tire
- Extended 4" Down Spouts
- Double Entry Steps
- Oversized Grab Handle (main door)

INTERIOR CAMPING PACKAGE

- 13.5 BTU Ducted A/C
- Night Shades
- CD/DVD/AM/FM Stereo with Aux & I-Pod Hookup
- 21" LCD TV
- Microwave
- 7 cu./ft. Double Door Refrigerator
- 3 Burner High Output Range
- 9" Deep Oversized Single Basin Sink with High Rise Faucet
- Glazed Hardwood Cabinet Doors
- Foot Flush Toilet
- Tub Surround with Shelves
- Full Extension Drawer Glides
- Visionary Sofa (Select Models)

INTERIOR FEATURES

- 78" Interior Height
- Trekk Fiberglass Reinforced Flooring
- Swivel Rockers (Per Floor Plan)
- Memory Foam Furniture
- Swivel TV with Mirror (Per Floor Plan)
- Water Heater-By-Pass for Winterization
- Night Shades in Living Area
- 17" Oven
- Decorative Wall Border
- Radius Dinette

BATHROOM

- Towel Hooks
- Deluxe Curved Shower Curtain
- Power Vent Fan
- Solid Wood Medicine Cabinet
- Linen Storage

MASTER BEDROOM

- Upgraded Memory Foam Mattress
- Dual 110V Outlets
- Mirrored Wardrobes
- Laundry Chute
- Under Bed Storage
- Full Blackout Window Treatments
- Individual Reading Lights

BUNK ROOMS

- Oversized Rollover Sofa with Rear Storage (298BHS)
- Cable & TV Hookups (Per Floorplan)
- Full Blackout Window Treatments
- Oversized Wardrobe with Rod (Some Floor Plans)

THERMAL PACKAGE



- Heated & Enclosed Underbelly
- 2" Pipe off of Furnace to Underbelly
- 30K BTU Furnace & Residential Heat Ducts

SAFETY EQUIPMENT

- Carbon Monoxide Detector
- Smoke Alarm
- Fire Extinguisher
- Electric Brakes
- Safety Chains
- Tinted Safety Glass Windows
- Egress Windows (Fire Escape)
- GFI Electrical Outlets

OPTIONS

- Bumper Mounted Aussie Grill (N/A 286QBS)
- Champagne Fiberglass Exterior
- 15K A/C
- Aluminum Wheels



www.keystonerv.com/bullet

BULLET
ULTRA LITE
by Keystone

 **Keystone RV Company**
www.keystonerv.com

2642 Hackberry Drive | PO Box 2000
Goshen, IN 46527-2000
(574) 535-2100



Get the free app at
<http://gettag.mobi>
and scan this tag.

YOUR LOCAL DEALER

Colton RV & Marine
3122 Niagara Falls Blvd.
North Tonawanda, NY 14120
(716) 694-0188
www.ColtonRV.com

Colton RV
489 Bushkill Plaza LN #9665
Wind Gap, PA 18091
(610) 863-5239
www.ColtonRV.com

Product information is as accurate as possible at the date of publication of this brochure. Features, floor plans, and specifications are subject to change without notice. Please also consult Keystone's web site at www.keystonerv.com for more current product information and specifications. Tow Vehicle Disclaimer. CAUTION: Owners of Keystone recreational vehicles are solely responsible for the selection and proper use of tow vehicles. All customers should consult with a motor vehicle manufacturer or their dealer concerning the purchase and use of suitable tow vehicles for Keystone products. Keystone disclaims any liability or damages suffered as a result of the selection, operation, use or misuse of a tow vehicle. KEYSTONE'S LIMITED WARRANTY DOES NOT COVER DAMAGE TO THE RECREATIONAL VEHICLE OR THE TOW VEHICLE AS A RESULT OF THE SELECTION, OPERATION, USE OR MISUSE OF THE TOW VEHICLE. 11/2012

Go RVing
Life's A Trip

Member
RVIA
RECREATION VEHICLE
INDUSTRY ASSOCIATION