

Jayco | Jay Flight Travel Trailer

# JAY FLIGHT

#1 SELLING TRAVEL TRAILER FOR 15 YEARS



**2+3**  
YEAR | YEAR  
WARRANTY





# INTERIOR DESIGN



## CLASSIC COTTAGE



Wood



Floor



Countertop

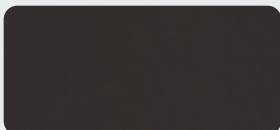

Main Fabric



Accent Fabrics

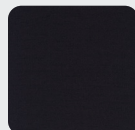

## MODERN FARMHOUSE

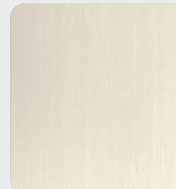

Wood

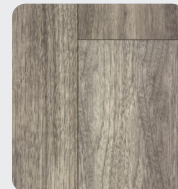

Floor

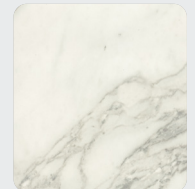

Countertop

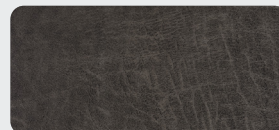

Main Fabric



Accent Fabrics

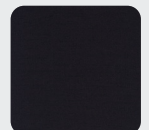



**24RBS**

OPTIONS: A, G

**28BHOK**

OPTIONS: B, C, G

**MICRO**
**OHC**
**FRIDGE**
**WARD**
**STORAGE**
**MICROWAVE**
**OVERHEAD CABINETS**
**REFRIGERATOR**
**WARDROBE**
**28BHS**

OPTIONS: B, C, G

**29RKS**

OPTIONS: A, B, C, G



**OPTIONS**
**A**

Table &amp; Chairs

**B**

Theater Seat

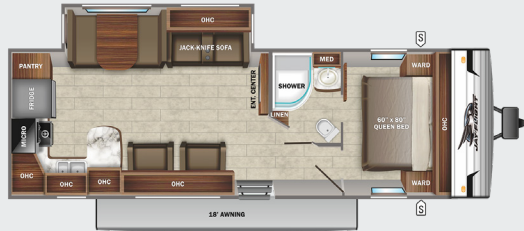
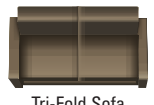
**C**

Tri-Fold Sofa

**D**

Jackknife Sofa &amp; Bunk

**E**

Front Quad Bunk

**F**

Queen Bed

**G**

King Bed

**32BHDS**

OPTIONS: B, C, G

**32TSBH**

OPTIONS: B, C, G

**33RBTS**

OPTIONS: A, B, C, D, G

**34RLOK**

OPTIONS: C, G

**34RSBS**

OPTIONS: A, C, G

**38BHDS**

OPTIONS: B, C, E, F, G

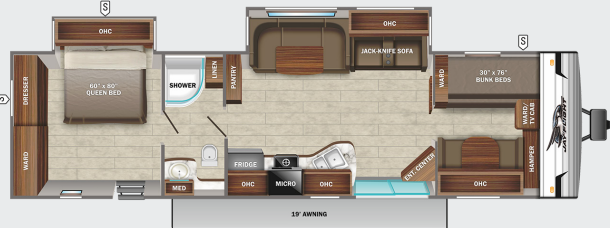

# STANDARDS & OPTIONS

## EXTERIOR

Axles with electric, self-adjusting brakes and easy-lube hubs  
I-Class™ cambered structural steel I-beams  
Fully integrated A-frame  
5/8 in. tongue-and-groove plywood floor decking  
Magnum Truss™ Roof  
Seamless roof material with 20 year warranty  
Large exterior downspouts  
30 in. x 72 in. main entrance door  
Galvanized steel, impact-resistant wheel wells  
30-amp service  
Front diamond plate  
Stabilizer jacks (4)  
Exterior TV mount and bracket  
LED exterior lighting  
Friction hinge entry door with shade-prep window  
G20 dark tinted safety-glass privacy windows  
LP quick connect (outside gas grill prep)  
Detachable power cord  
Backup & side marker camera prep

## INTERIOR

81 in. ceiling height  
Solid hardwood cabinet doors  
LED interior lighting  
Decorative dinette and slideout room lighting (SuperSlide models)  
Hidden switch command/charging center  
J-Steel™ jackknife sofa with armrest  
Vinyl flooring throughout (including slide floors)  
Vented windows in slideout room end walls (SuperSlide models)  
Window shades  
Smoked-glass cabinet door inserts (select models)  
Adjustable and removable dinette table (main booth dinette only)  
Residential-style kitchen countertops  
3-burner range with glass cover  
Oven with glass door and interior light  
Heavy-duty, 75 lb., full-extension, steel ball-bearing drawer guides  
Range hood  
Vented kitchen window  
Queen mattress  
Cubby storage area under bed (select models)

Plywood bed platforms  
Main bed struts  
300 lb. rated bunk beds (select models)  
600 lb. rated bunk beds (double bunks)  
Privacy curtains in bunk areas (select models)  
Vented bunk windows (select models)  
4 in. thick bunk mats (select models)  
Wooden bedroom doors (select models)  
Glass shower door (select models)  
Shower curtain with curved shower track (select models)

## CUSTOMER VALUE PACKAGE (MANDATORY)

13,500-BTU, roof-mounted A/C  
30 lb. propane bottles with cover (2)  
6 gal. gas/electric DSI water heater (10 gal. in 38BHDS & 38FDDS)  
Cable/satellite TV hookup  
Digital TV antenna  
Goodyear® Endurance® tires (made in the USA)  
Outside shower  
Power tongue jack  
Spare tire with cover  
Water heater bypass  
Power awning with LED lights  
Marine grade exterior speakers  
Keyed-Alike™ entry and baggage doors  
JaySMART™ (Safety Markers And Reverse Travel) LED lighting (patent-pending)  
8 cu. ft. gas/electric refrigerator (N/A 38BHDS & 38FDDS)  
Bathroom power vent  
Bathroom skylight  
Tub surround

## ELITE PACKAGE (MANDATORY)

Upgraded exterior metal & graphics package  
Slideout end-wall windows  
Black tank flush  
Second fresh water tank (total 80 gal. capacity)  
Large main entry door grab handle  
Rooftop solar prep  
Aluminum rims  
Hardwood frame mission-style cabinet doors

Premium multimedia sound system with MP3/iPod input jacks and Bluetooth® connectivity  
Kitchen skylight with shade  
Full-height kitchen backsplash  
Upgraded kitchen faucet with pull-out sprayer  
Kitchen sink covers and rolling drying rack  
Deluxe bedspread with pillows  
Bathroom medicine cabinet  
Porcelain foot flush toilet

## OPTIONS

15,000-BTU, roof-mounted A/C  
Thermal package: insulated, heated, and enclosed underbelly and reflective foil insulation in main roof and slideout floors  
Outside griddle with bumper mount  
Cargo accessory receiver  
Electric stabilizer jacks (4)  
Fiberglass sidewalls  
Patio door (29RKS & 34RSBS) (standard on 38BHDS & 38FDDS)  
MORryde® StepAbove™ entry steps  
Solar Power Package (100W roof solar panel & 30-amp digital controller)  
50-amp service with second A/C prep (select models) (standard in 34RLOK & 34RSBS)  
Wall-hugger theater seating (select models)  
Rear sofa with folding bunk (33RBTS)  
JAYCOMMAND® "Smart RV" system with TPMS  
Fireplace (28HBHE, 29RKS, 32BHDS, 32TSBH, 33RBTS & 38BHDS) (standard on 34RLOK & 34RSBS)  
Free-standing table with 4 chairs (select models) (standard in 34RLOK)  
LED TV  
Hide-a-bed with tri-fold mattress (select models)  
10 cu. ft. 12V stainless steel refrigerator (18 cu. ft. residential refrigerator in 38FDDS, N/A 38BHDS)  
King bed  
2nd A/C in bedroom (select models)  
Front quad bunk (38BHDS)  
Front queen bed (38BHDS)

\*Indicates split tanks

FLOORPLAN	EXTERIOR TRAVEL LENGTH	EXTERIOR WIDTH	EXTERIOR HEIGHT (WITH A/C)	INTERIOR HEIGHT	UNLOADED VEHICLE WEIGHT	DRY HITCH WEIGHT	GVWR	CARGO CARRYING CAPACITY	FRESH WATER CAPACITY (INCLUDING WATER HEATER)	GRAY WASTE WATER CAPACITY	BLACK WASTE WATER CAPACITY	SLEEPING CAPACITY
24RBS	28' 10"	8' 0"	11' 0"	6' 9"	TBD	TBD	TBD	TBD	82	39	39	3-4
28BHOK	TBD	TBD	TBD	TBD	TBD	TBD	TBD	TBD	TBD	TBD	TBD	8-10
28BHS	33' 4"	8' 0"	11' 2"	6' 9"	6,525	770	8,850	2,325	82	78*	39	8-10
29RKS	33' 11"	8' 0"	11' 2"	6' 9"	TBD	TBD	TBD	TBD	86	78*	39	4-6
32BHDS	36' 4"	8' 0"	11' 2"	6' 9"	7,915	890	10,250	2,334	86	41	39	8-10
32TSBH	36' 4"	8' 0"	11' 2"	6' 9"	TBD	TBD	TBD	TBD	86	41*	39	9-11
33RBTS	37' 10"	8' 0"	11' 2"	6' 9"	8,640	1,070	10,950	2,310	86	71.5*	39	8-10
34RLOK	37' 10"	8' 0"	11' 1"	6' 9"	TBD	TBD	TBD	TBD	86	78*	39	3-4
34RSBS	37' 8"	8' 0"	11' 3"	6' 9"	8,520	1,265	11,250	2,730	86	71.5*	39	4-6
38BHDS	40' 6"	8' 0"	11' 3"	6' 9"	TBD	TBD	TBD	TBD	90	39	39	8-9

Meet your Jayco Dealer

Colton RV & Marine  
3122 Niagara Falls Blvd.  
North Tonawanda, NY 14120  
(716) 694-0188  
www.ColtonRV.com

Colton RV  
489 Bushkill Plaza LN #9665  
Wind Gap, PA 18091  
(610) 863-5239  
www.ColtonRV.com



Scan QR code for specification definitions



Some specs at the time of print may include estimates.  
For the most updated information, please visit  
Jayco.com/jay-flight

Jayco, Inc. | P.O. Box 460 | Middlebury, IN 46540  
See dealer for further information and prices. All information in this brochure and on www.jayco.com is the latest available at the time of publication approval. Jayco reserves the right to make changes and to discontinue models without notice or obligation. Photography may show optional equipment or props used for decoration purposes only. RVs built for sale in Canada may differ to conform to Canadian codes. JAYCO and the JAYCO BIRD IN FLIGHT are registered trademarks of Jayco, Inc. Printed in USA 11/21 ©2021 Jayco, Inc. 257080

Jayco - Part of the Jayco Family of Companies