

PRE-PRODUCTION PREVIEW

MODEL G 3520

Standard Run **MSRP \$210,828**
with \$18,463 of Premium Build Options

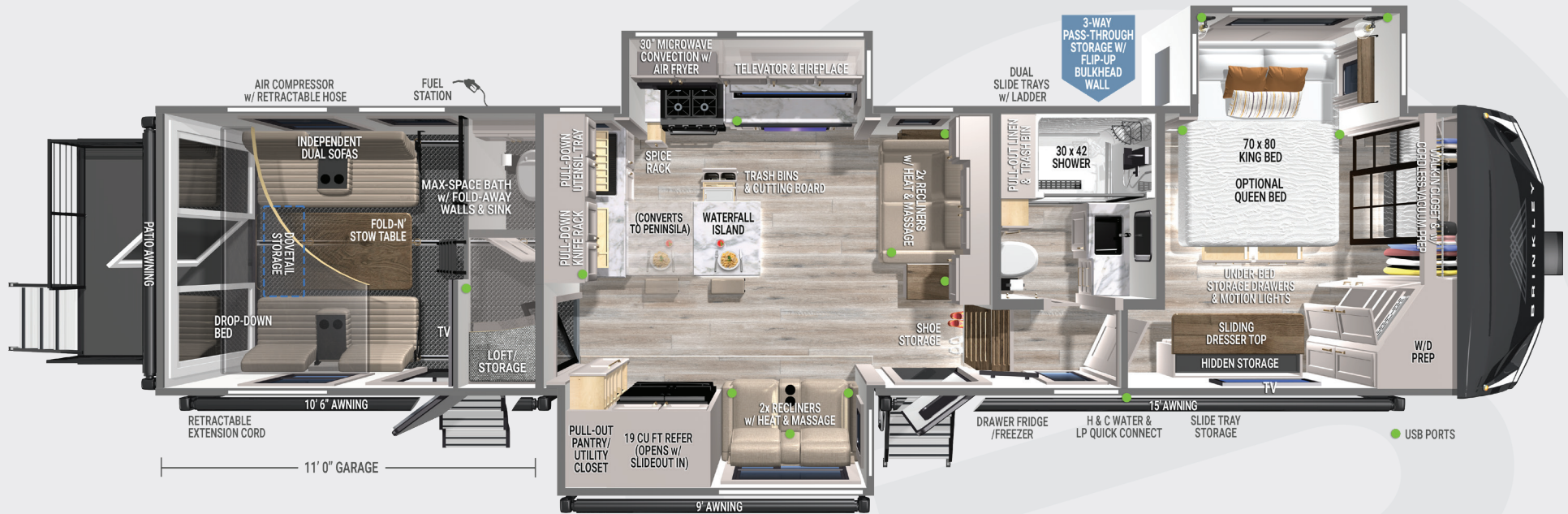

SPECIFICATIONS:

- UVW – 17,496 lbs.
- GVWR – 22,000 lbs. (Triple Axle)
- Hitch Weight – 3,150 lbs.
- Exterior Length – 40' 3"
- Overall Height – 13' 4"
- Overall Width – 101"
- Garage Length – 11' 0"
- Garage Door Capacity – 3,000 lbs.
- Garage Door Patio Capacity – 1,500 lbs.
- Fresh Water Capacity – 150 gal.
- Gray Water Capacity – 156 gal. (104 True + 52)
- Black Water Capacity – 85 gal.
- Fuel Station Tank – 60 Gal. (30+30)
- Wheels & Tires – 17.5" H-Rated (16-Ply)
- Insulation:
 - Floors, Ceiling, Front Cap – R-40
 - Walls – R-11

092925

Optional equipment & props may be shown.
All content is subject to change without notice.
Please consult with your dealer for current information.



For More Information, Photos, Videos
& Why Brinkley go to **BrinkleyRV.com**



MODEL G 3520

Colton RV & Marine
3122 Niagara Falls Blvd
North Tonawanda, NY 14120
(716) 694-0188
www.ColtonRV.com

Colton RV & Marine
3443 Southwestern Blvd.
Orchard Park, NY 14127
(716) 957-3250
www.Coltonrv.com

SPECIFICATIONS & FEATURES

EXTERIOR & CONSTRUCTION:

- 3-Way Pass-through Storage w/ Multi-Functional Flip-Up Bulkhead Dividers (Best-in-Class)
- Under I-Beam Storage – Industry 1st (Patent Pending) w/ 3x 48" Slide-Tray Storage Drawers
- Clear2Go™ Baggage Door Indicator Light
- 50 Amp Push-Button Power Cord Reel
- Air Compressor (135 PSI) w/ 50' Retractable Air Hose
- 45' Retractable Extension Cord
- 65' Retractable City Water Hose
- Electric Waste Valves w/ Indicator Light & Manual-Override
- 100" Zero-Gravity Ramp Door w/ Electric Top Latches
- 3 Season Patio Doors w/ Screens & Tinted Windows
- Residential Style Wire Patio Railing, Power Awning, & Steps
- 3x Power Side Awnings (Black)
- Neon Awning Lights (Dimmable)
- ☑ Slideout Toppers \$2,020
- Brinkley Automotive-Grade Sealant Package
- ☑ Premium Exterior Pkg. w/ Full Body Paint (Silver or White) \$24,000
- Impact Guard Fiber-Reinforced Poly Roof
- Euro Square Frameless Windows w/ 6" Openings (Industry 1st)
- ☑ Dual Pane Euro Square Frameless Windows w/ 6" Openings \$2,600
- LED Flood Lights (At Fuel & Water Connection)
- RGBW Underbody Lighting (Dimmable)
- MAX-Vision™ Reverse Lighting System (Includes High-Lumens Under-Bumper Lights + Awning, Underbody, & Flood Lights)
- Automotive-Grade Front Cap w/ Lenses & RGBW Lighting
- Integrated Front Cap & Midship Turn Signals
- Under-Step Lighting (Front & Garage Side Steps)
- 3x Neon Pass-through Storage Area Lights
- Gen & Solar Storage Area Motion Activated Lighting
- Portable 14.5' Telescoping Ladder

KITCHEN & DINING:

- Pull-Out Cutting Board (Removable for Cleaning)
- Premium Residential Cabinets & Drawers w/ Dovetail Joints
- Adjustable Overhead Cabinet Shelves
- Pull-Down Utensil Tray
- Pull-Down Magnetic Knife Rack
- Pull-Out Pantry w/ Adjustable Shelves & Drawers
- Pull-Out Spice Rack & Cookie Sheet Storage Space
- Under Oven Storage Drawer w/ Matching Drawer Front
- Pull-Out Trash & Recycling Bins
- Large Adjustable Drawer Organizer
- Residential Solid Surface Countertops & Backsplash
- Residential Bar Pendant Light
- Kitchen Work Lighting Under Overhead Cabinets
- Flip-Up Waterfall Island Countertop (Converts To Peninsula w/ Four-Person Eating Area)

BED & BATHROOM:

- Pull-Out Linen Closet w/ Adjustable Shelves
- Pull-Out Bathroom Trash Bin
- Backlit Recessed Medicine Cabinet (Main Bath)
- Residential Shower System w/ Head, Body, & Handheld Sprayer
- Neon Shower Lighting
- Dual Bedside Outlets w/ USB & USB-C Ports
- Dual Bedside Shelves
- Hidden Sliding Dresser Top Storage Compartment
- 4x Under-Bed Storage Drawers
- Residential 9" Memory Foam King Mattress w/ Gel Topper (70"x80")
- ☑ Residential 9" Memory Foam Queen Mattress w/ Gel Topper (60"x80") & Nightstands \$428
- LED Closet Lights
- Dual Motion Activated LED Bed Lights

ELECTRONICS:

- Rockford Fosgate – Model G Exclusive
 - 4x Independent Zones & 3x Amps
- Interior:
 - 2x Remote Panels, 4x Ceiling Speakers & 12" Subwoofer
- Exterior:
 - Remote Panel (Campside), 4x Speakers, 10" Subwoofer & 4x Patio Speakers
- Brinkley Firefly Smart-Command™ Center Package (Includes Touch Screen, App Control From Anywhere & Garage Linked Control Panel, & Precise Holding Tank Monitors)
- Rear & Side Camera System w/ 7" Screen
- Winegard Air 360+ TV & FM Antenna
- 65" Phillips Smart TV (Main)
- 43" Phillips Smart TV (Garage)
- 32" Phillips Smart TV (Bedroom)

POWER:

- FlexPower 5500 w/ EFI Dual Fuel Inverter Generator (Gas or LP)
- Victron Smart Energy Package
 - 3000W Victron Pure Sine Wave Inverter
 - 50 Amp MPPT Solar Charge Controller
 - Orion-Tr Smart 30 Amp DC-DC Charger (Non-Isolated)
 - Cerbo GX Performance Optimizing Communication Hub
- 800W of Solar Panels
- 200 Ah of Lithium Batteries (Self-Heating)
- 2x 30 Gallon Fuel Tanks w/ Pump Station
- 2x 30 lbs. LP Tanks (Room for 20 to 40 lbs. Bottles)
- Magnetic Wire Access Hatch (Behind Toilet)
- Southwire Transfer Switch w/ Surge, Low Voltage, Miswired Pedestal, & Open +/- Protection

INTERIOR:

- Residential Interior w/ Brinkley's CraftSense™ Wood Trim Construction
- Floating Entrance Steps w/ Indirect Lighting
- & Double Deep Shoe Storage & Tray
- Theater Sofas w/ 4x Recliners Heat & Massage
- Residential Dimmable Ceiling Can Lighting
- Window Integrated Day Screens & Blackout Shades w/ Reflective Insulation + Full Bug Screens
- Pet-Friendly Package (Child/Pet Defender Screen Protector, 100% Carpet Free, Ductless Floors, & Pull-Out Removable Bowls)

APPLIANCES:

- GE Energy Star 19 Cu. Ft. Fridge w/ Ice Maker & Filtered Water
- 12V Heated Ice Maker Line (Industry 1st)
- Three Stage Residential Water Filters (Plus in Fridge Filter)
- GE Profile Microwave (w/ Air Fryer, US Market Only)
- 24" GE Profile Oven w/ 4 Burner Range & Storage Drawer
- Tankless Water Heater (Controller in Main Bath)
- GE Low-Profile 13.5k AC w/ Heat Pump (Main, Bedroom & Garage)
- Exterior Drawer Fridge/Freezer – 24 Can Capacity (12V Power)
- Fireplace w/ 5,000 BTU Electric Heat
- Stackable Washer & Dryer Prep (Bedroom)
- 2x MAXXair Fans w/ Rain Sensor (Kitchen & Bathroom)
- Power Wall Fan in MAX-Space™ 1/2 Bath

GARAGE:

- 11' Garage/Residential Flex Space w/ MAX-Space™ 1/2 Bath
- ☑ 11' Garage w/ Washer/Dryer Prep (Delete 1/2 Bath) \$2,317 Credit
- Garage Dovetail Storage Box (Lockable)
- Happijac® Sofa & Bed Lift System w/ Independent Sofa Operation
- Overhead Loft/Storage w/ Cable Railing, Twin Mattress, & Ladder
- Adjustable Tie-Down System w/ 3x Recessed L-Tracks
- Neon Garage Lighting (Dimmable)
- Fold n' Stow Table

RUNNING GEAR & TOWING:

- 3x Heavy-Duty 7k lbs. Axles w/ Hydraulic Disc Brakes & 8k lbs. Leaf Springs
- ☑ MORryde Independent Suspension (IS) w/ 24k lbs. Capacity & Hydraulic Disc Brakes \$13,500
- SumoSprings® (Unmatched Stability, 68% Reduction in G-Forces)
- 30k Gen-Y® Executive Torsion Flex Pin-Hitch Box (Fifth Wheel)
- ☑ 30k Gen-Y® Executive Torsion Flex Pin-Hitch Box (Gooseneck) \$399
- Commercial Grade H-Rated Cooper 16-Ply Tires
- 17.5" Custom Aluminum Luxury Wheels
- Dexter EZ-Flex Suspension Equalizer System
- Banded Tire Pressure Monitoring System (TPMS) w/ Wireless Display