

ODYSSEY SE

2026 Class C Motorhome

22A | 22AF

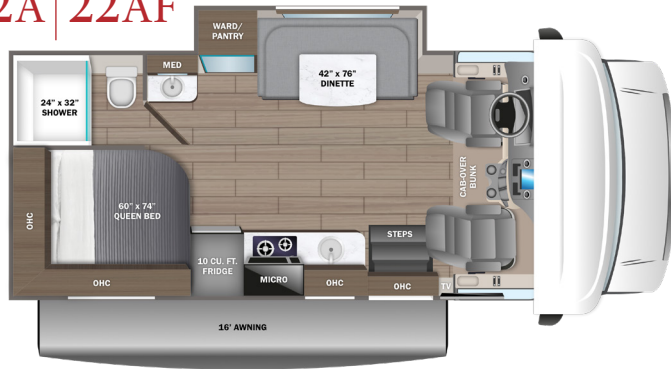

22C | 22CF

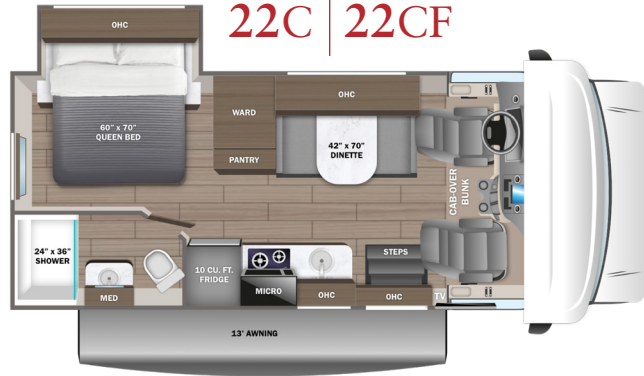

22E | 22EF

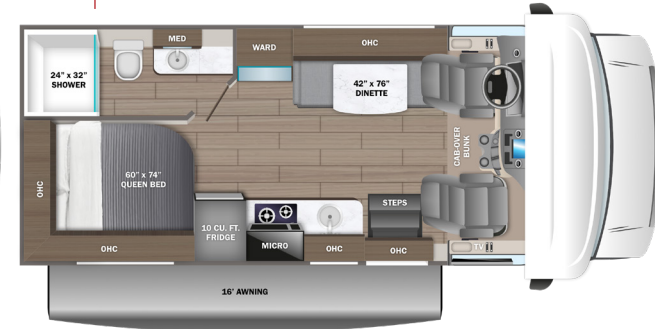

22T | 22TF

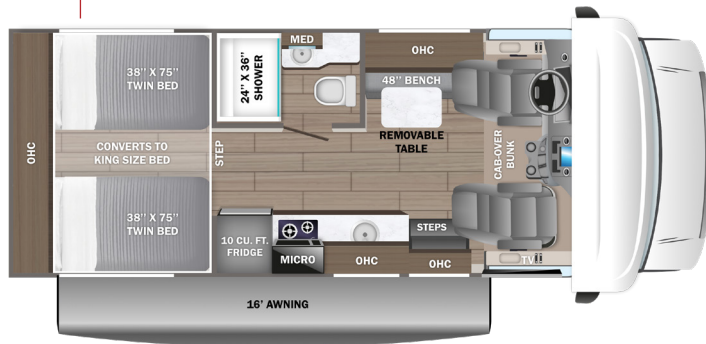

29KF

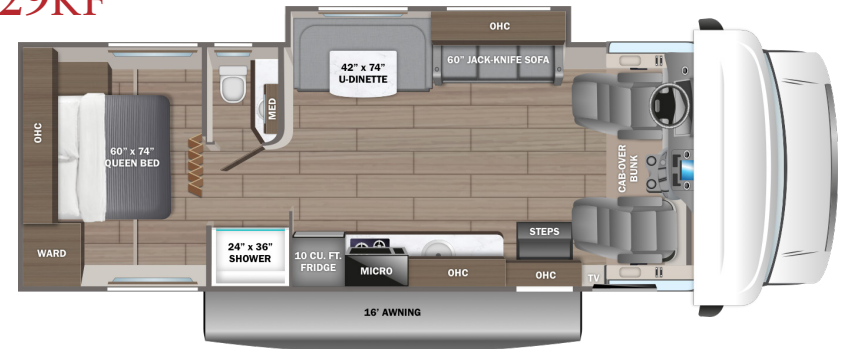

31FF

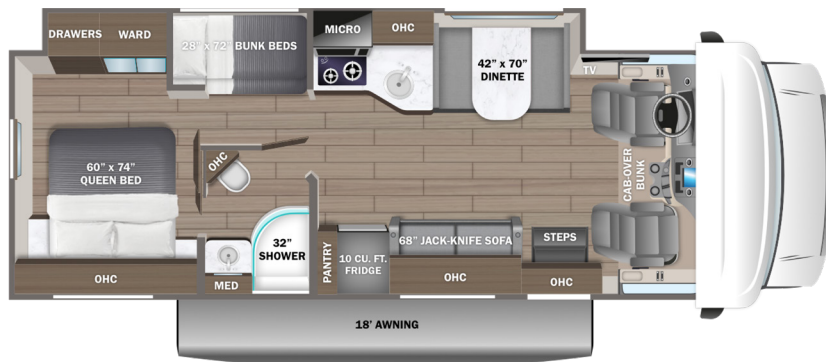

EXTERIOR

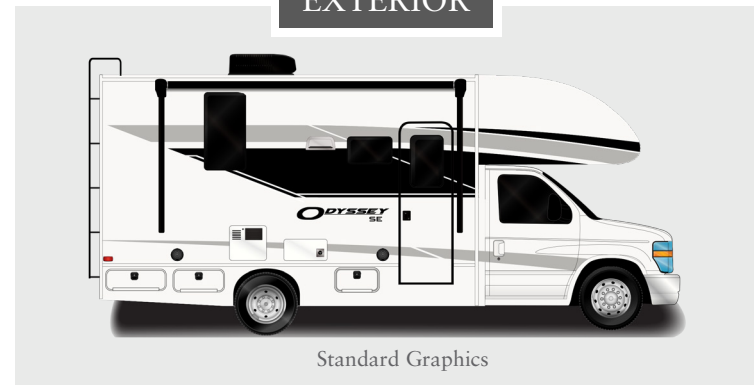

ODYSSEY SE

CUSTOMER VALUE PACKAGE

One-piece, seamless, fiberglass front cap
Electric patio awning
Heated holding tanks (12V pads)
Black holding tank sprayer
Backup camera
LED HD Smart TV

STANDARD CHASSIS EQUIPMENT

Chassis Equipment for 22A, 22C, 22E, 22T

Chevy® 4500 chassis
GVWR - 14,200 lb.
GCWR - 20,000 lb.
6.6L Vortec V8 401 HP engine with 464 ft.-lb. torque
Hydra-matic 6-speed automatic transmission with overdrive
150-amp alternator
StabiliTrak stability control system
OnStar with 4G LTE
5,000 lb. hitch with 500 lb. tongue capacity and 7-pin plug

Chassis Equipment for 22AF, 22CF, 22EF, 22TF

Ford® E-350 chassis
GVWR - 12,500 lb.
GCWR - 18,500 lb.
7.3L V-8 325 HP engine with 450 ft.-lb. torque
6-speed TorqShift® series transmission with overdrive
210-amp alternator
Tire pressure monitoring system (TPMS)
Catalytic converter theft deterrent
Electronic stability control
Traction control
5,000 lb. hitch with 500 lb. tongue capacity and 7-pin plug

Chassis Equipment on 29KF, 31FF

Ford® E-450 chassis
GVWR: 14,500
GCWR: 22,000
7.3L V-8 325HP engine with 450 ft.-lb. torque
6-speed TorqShift® series transmission with overdrive
210-amp alternator
Tire pressure monitoring system (TPMS)
Catalytic converter theft deterrent
Electronic stability control
Traction control
7,500 lb. hitch with 750 lb. tongue capacity and 7-pin plug

Chassis Equipment on All Floorplans

E-rated highway tires - LT225/75R16
12V chassis battery
Power anti-lock brakes with power steering
Remote-controlled, side-view mirrors

STANDARD EXTERIOR EQUIPMENT

TuffShell™ vacuum-bond laminated roof, floor and sidewalls
Bead-foam insulation (R-24 max roof, R-9 max floor, R-5 max walls)
Tufflex™ PVC laminated roof
Aluminum running boards
Fiberglass exterior walls with vinyl graphics
Entrance door with industry's largest travel-view window
Electric-powered entrance step with integrated house battery compartment
Third brake light
Cable TV hookup with RG-6 coax
Digital antenna with signal booster
4,000W generator
Solar prep
12V house battery
Transfer switch with reverse polarity protection
30-amp electrical service
12.2 gal. propane tank (41 lb.)
LP quick-connect hookup
Exterior utility center
Winterization drain system
Outside shower
12V demand water pump
Water filtration system

STANDARD COCKPIT EQUIPMENT

Remote-controlled, side-view mirrors
Hill start assist
Tilt steering wheel
Cruise control
Electronic stability control
Traction control
Power windows and door locks
Auxiliary start switch
Driver and passenger airbags

Standards & Options

STANDARD INTERIOR EQUIPMENT

Overhead bunk with 750 lb. capacity
84 in. ceiling height
High-intensity, recessed LED ceiling lights
Ball-bearing drawer guides
Entegra-exclusive, easy-operation legless dinette table (22C, 22CF, 29KF, 31FF)
2-point lap safety belts in all designated seating locations
42 in. x 76 in. U-shaped dinette (22A, 22AF, 22E, 22EF)
48 in. dinette bench with removable table (22T, 22TF)
Interior entrance door grab handle
Interior command center
Pleated blackout shades
13,500 BTU ducted A/C
30,000 BTU auto-ignition furnace
6 gal. gas/electric DSI auto-ignition water heater
Smoke alarm
Carbon monoxide detector
Fire extinguisher
10 cu. ft. 12V refrigerator
2-burner cooktop with flush cover
Convection microwave oven
Stainless steel kitchen sink
Queen-size bed with bedspread (22A, 22AF, 22C, 22CF, 22E, 22EF, 29KF 31FF)
(2) twin-size beds with filler cushion convert to king-size bed (22T, 22TF)
Bunks with industry-exclusive 300 lb. capacity each (31FF)
Large wardrobes (select models)
Shower with decorative ABS surround
Stainless steel bathroom sink
Toilet with foot flush

OPTIONS

Automatic hydraulic leveling jacks
200W solar panel with dual controller and second house battery

2+3
YEAR | YEAR
WARRANTY

NO ONE OFFERS A BETTER WARRANTY

At Entegra Coach, we build our RVs to handle every adventure, then back them with our industry-leading 2+3 limited warranty. Our 2-year limited warranty has you covered for 2 camping seasons. That's 730 days. In addition, our 3-year structural limited warranty has you covered for 3 camping seasons or 1,095 days. You won't find a better limited warranty in the business, because the only strings we attach are those that deliver the ultimate in reliability. For a copy of our 2-year limited + 3-year structural limited warranty with complete terms and conditions, please contact your local Entegra Coach dealer.

Floorplan	GVWR (lbs.)	GCWR (lbs.)	Wheel Base	Overall Length	Exterior Height w/ A/C & Satellite	Exterior Width	Interior Height	Fresh Water Capacity (gal.)	Grey Waste Water Capacity (gal.)	Black Waste Water Capacity (gal.)
22A	14,200	20,000	159"	25' 4"	11' 6"	100"	84"	44	40	32
22C	14,200	20,000	159"	25' 4"	11' 6"	100"	84"	44	40	31
22E	14,200	20,000	159"	25' 4"	11' 6"	100"	84"	44	40	31
22T	14,200	20,000	159"	25' 4"	11' 6"	100"	84"	44	40	31
22AF	12,500	18,500	158"	24' 9"	11' 6"	100"	84"	44	40	32
22CF	12,500	18,500	158"	24' 9"	11' 6"	100"	84"	44	40	31
22EF	12,500	18,500	158"	24' 9"	11' 6"	100"	84"	44	41	31
22TF	12,500	18,500	158"	24' 9"	11' 6"	100"	84"	44	41	31
29KF	14,500	22,000	223"	32' 7"	11' 6"	100"	84"	47	41	31
31FF	14,500	22,000	223"	32' 7"	11' 6"	100"	84"	47	41	31

It is important for your safety and enjoyment that you are aware of the weights and tow ratings of the RV you select. Consult a competent advisor for questions or advice. Whether you are new to RVing or a veteran, get a feel for the performance of your RV before heading out on the roadways. When you tow a vehicle with your RV, you must drive differently than when you drive a single vehicle. Practice hooking up, driving, backing up and braking in a safe environment or seek out professional instruction. Jayco affixes a weight label to each RV which lists weight information for that vehicle. Refer to that label to verify the vehicle will meet your requirements. Gross Vehicle Weight Rating (GVWR): The maximum permissible weight of the motorhome, including the Unloaded Vehicle Weight (UVW) plus passengers, personal items, all cargo, fluids, options and dealer-installed accessories. The GVWR is equal to or greater than the sum of the UVW and the Cargo Carrying Capacity. Gross Combined Weight Rating (GCWR): The maximum allowable combined weight of the motorhome used as a tow vehicle and the attached towed vehicle.

Colton RV & Marine
3122 Niagara Falls Blvd.
North Tonawanda, NY 14120
(716) 694-0188
www.ColtonRV.com



Part of Jayco Family of Companies

Entegra Coach, Inc., P.O. Box 460, Middlebury, IN 46540, www.entegracoach.com. See dealer for further information and prices. All information in this brochure is the latest available at the time of publication approval. Entegra Coach reserves the right to make changes and to discontinue models without notice or obligation. Photos in this brochure may show optional equipment and props for photography purposes. RVs built for sale in Canada may differ to conform to Canadian codes. ©2025 Entegra Coach, Inc. Printed in U.S.A. 2033068



entegracoach.com/odyssey-se

LEGACY ISN'T LEFT,
IT'S LIVED.