



KEYSTONE
RV COMPANY

RAPTOR

2025 | TOY HAULER FIFTH WHEELS



433

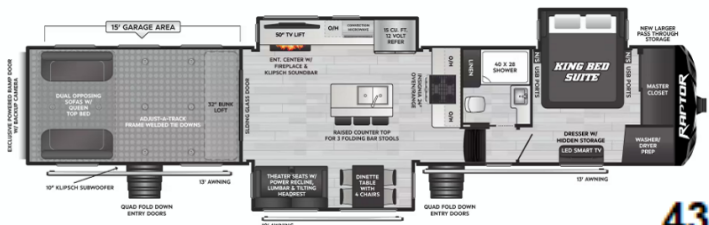

430

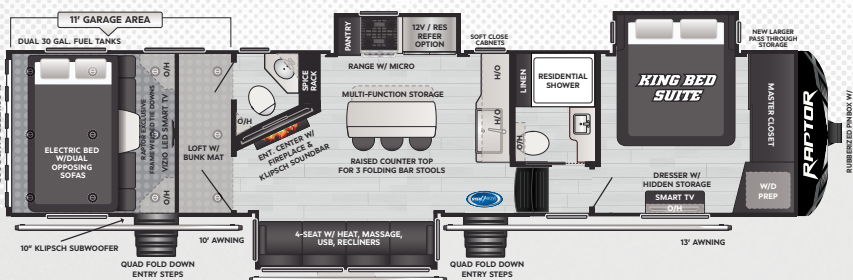

352

WEIGHT 14480 | LENGTH 39' 0"

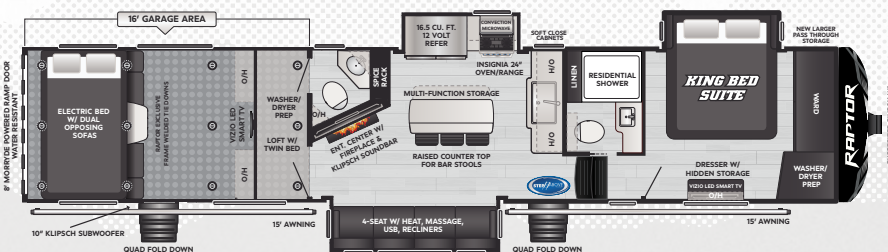

415

WEIGHT 16065 | LENGTH 44' 0"

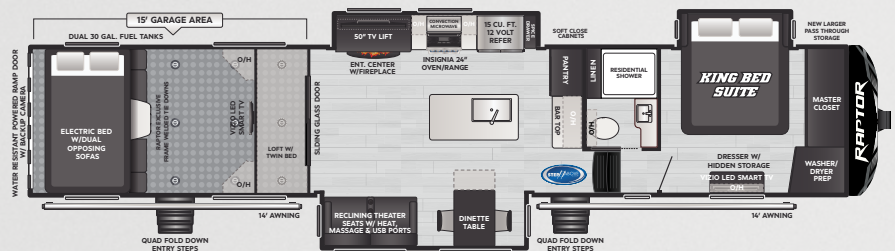

428

WEIGHT 16140 | LENGTH 44' 5"

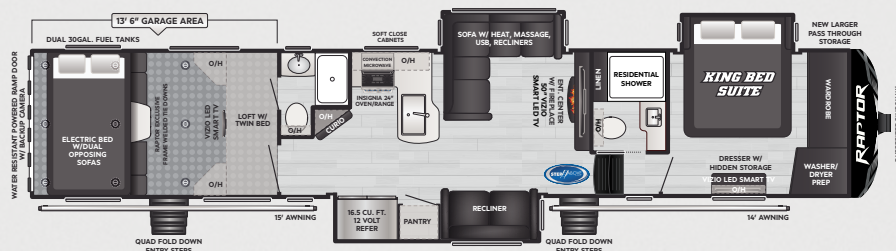

431

WEIGHT 16316 | LENGTH 44' 11"

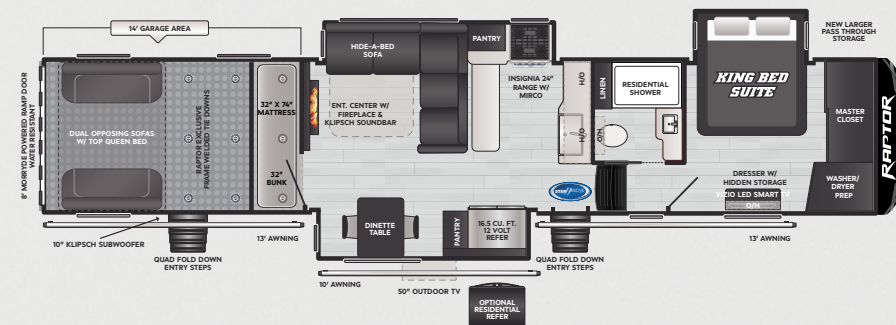

441

WEIGHT 17095 | LENGTH 44' 9"

DISCLAIMER: Product information is as accurate as possible as of the date of this publication. All features, floor plans, and specifications are subject to change without notice. Pre-production estimated weights & lengths may be listed; visit Keystonerv.com for the most current product information and specifications.

CAMP BETTER
KINDNESS · COMMUNITY · PLANET



EXTERIOR

- » New Exterior Graphics
- » (2) Full Body Paint Designs Offering Matte And Gloss Finishes With Multiple Color Options
- » Electric Through Frame Flush Floor Slides
- » New Front Cap With Integrated LED Lights
- » New Chassis W/ Best In Class Pass Through Storage, Including Equal Size Access On Door & Off Door Side Of The Unit
- » Best In Class Tank Capacity (173 Gallon Fresh, 104 Grey/Black Tanks)
- » Additional Battery Top Down Access Door In Pass Through Storage
- » Best In Class Standard 8K LBS. Dexter® Axles
- » 17.5 Inch Rims With H-Rated Sailun Tires
- » Upgraded Dexter® Suspension
- » Improved GVWR Rating
- » Keystone Exclusive Power Ramp Door
- » RV Mobile Power™ Flex Power® Generator 5500i W/ Dual Fuel Gasoline And LP Capabilities
- » Collapsible Solid Four Step Garage and Main Entry Steps
- » MORryde Safe-T-Rail Collapsible Grab Handle
- » Square Windows With Integrated Blinds
- » 50-Amp Power Cord Reel *Now Standard*
- » Integrated Air Compressor *Now Standard*
- » Banded TPMS System *Now Standard*
- » Girard® Cassette Awnings
- » New Skirt Metal & Fender
- » Standard Klipsch® Outdoor Sound System With Enclosed 10" Sub, 7" Speakers, And 400 Watt Amplifier

INTERIOR

- » Interior Design Overhaul
- » New Floorplans/Floorplan Redesigns
- » New Island Design With (3) Free Standing Bar Stools, Raised Bar Top, (2) Built In Trash Cans, Cutting Board, 11" Bank Of Drawers, Paper Towel Holder, And Cabinet With Pull Out Shelf
- » New Cabinet Construction
- » Adjust-A-Track™ Frame Welded Tie Downs & 38 Points Of Contact
- » Upgraded 20 Cu. Ft. 12V Refrigerator
- » Standard Klipsch® Living Room Sound Bar And Subwoofer
- » New Bathroom Design
- » New Larger Shower
- » New Pull-Out Linen Storage
- » Larger Vanity Countertops

BEST IN CLASS

- » Best In Class Pass Through Storage
- » Best In Class Equal Size Access On Door & Off Door Side Of Unit
- » Best In Class Tank Capacity (173 Gallon Fresh, 104 Grey/Black Tanks)
- » Best In Class Standard 8K LBS. Dexter® Axles
- » Keystone Exclusive Power Ramp Door

STANDARD FEATURES & OPTIONS



Colton RV & Marine
3122 Niagara Falls Blvd.
North Tonawanda, NY 14120
(716) 694-0188
www.ColtonRV.com

Colton RV
489 Bushkill Plaza LN #9665
Wind Gap, PA 18091
(610) 863-5239
www.ColtonRV.com

