

TRAVEL TRAILERS | FIFTH WHEELS
keystonerv.com/hideout

HIDEOUT

EASTERN



**Keystone RV
Company**

The ultimate
ownership experience.

The ultimate ownership experience.

The goal of Keystone RV Company is to surprise and delight our owners at each and every touchpoint. We're happy when our campers are happy, and we are committed to providing the very best ownership experience in the industry.



1 EASIER SHOPPING.

At Keystone, we make choosing an RV as easy as finding the Big Dipper on a dark summer night. With comprehensive online product information, Key Connect™ product advisors, and an unparalleled dealer network, we will help you select the perfect RV for your family's adventure.

2 INNOVATIVE THINKING.

The road's a nicer place when you have the industry's smartest features behind you. Keystone leads the pack in patented innovations that make our RVs safer, more comfortable, and easier to operate.

3 LONG HAUL QUALITY.

To keep you on the road, there are certain things we just won't build a Keystone RV without. Game-changing features like our Unified Wiring Standard, Tru-Fit™ five-point slide construction, and no-fail Tuf-Lok™ A/C duct joiners combined with exhaustive testing and inspections are some of the reasons why Keystone is able to offer our owners the industry's best 3-year limited structural warranty.

4 WORRY-FREE CUSTOMER SERVICE.

Wherever the road takes you, you're never too far from an authorized Keystone service center. We also offer live service assistance, ultra-fast parts shipping, online maintenance tips and tricks, and a single-point warranty claims policy. *That's* peace of mind.

5 KEYSTONE NATION.

When you choose Keystone, you become a part of one of the largest camping families in the country. We're Keystone Nation. A friendly community where people share photos, travel tips and amazing stories – all in the spirit of camaraderie and adventure. Come join us.

Experience the hideout lifestyle by visiting [#keystonehideout](https://www.instagram.com/keystonehideout)



HIDEOUT



SINGLE-AXLES | LHS TRAVEL TRAILERS | LUXURY TRAVEL TRAILERS | LUXURY FIFTH WHEELS

Ready for an RV lifestyle? Start with a Hideout.

If you are looking to get out on the open road, you have arrived. The Hideout brand is the perfect introduction with its small single-axle travel trailers all the way up to our easy-to-tow fifth wheels. Hideout offers unparalleled features and amenities, combined with an extensive floorplan offering, allowing you to camp anywhere with the ones you love. Hideout's crisp, clean look will inspire you to get out and see the world through fresh eyes.

Keystone EXCLUSIVE Innovations

Year after year, Keystone RV's experienced team delivers Built For the Long Haul quality you expect and exclusive innovations you won't find anywhere else.



IT'S ELECTRIC!

All units now standard with electric stabilizers or leveling*.
[*EXCLUDING SINGLE-AXLE MODELS & NON-SLIDE MODELS]



4G LTE and Wi-Fi Prep

All units are equipped with a new antenna that integrates 4G LTE and Wi-Fi with standard VHF/UHF/AM/FM reception.



3-year Limited Structural Warranty, 1-year Limited Base Warranty

Every new Keystone RV comes with the industry's best three-year limited structural warranty AND a one-year limited base warranty.



Color-Coded Wiring

Easy-to-trace circuits simplify electrical and entertainment system troubleshooting.



In-Floor Heating Ducts

Ducting allows for more airflow that distributes heat evenly for optimal comfort.

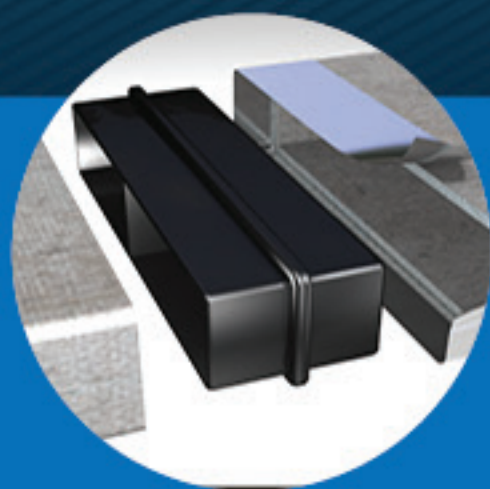

Tuf-Lok™ A/C Duct Joiners

Crush resistant design securely joins A/C ductwork, drastically reducing chilled-air leaks and boosting cooling efficiency and comfort.



Tru-fit™ slide construction

A more durable slide room design that minimizes functional motor and structural stress, resists leaking.

Exclusive and Unexpected Features



LCI SolidStep® (n/a 38' models)
Ultra safe and secure main entry step.
(N/A on 38' or LHS models.)



Furrion® Backup & Side Camera Prep
Makes installation a breeze.



8 cu. ft. Refrigerator (n/a LHS & single axle)
Stock up without sacrifice.



Power Tongue Jack (n/a single axle)
Easy-to-use jack makes RV setup fast and simple.



Central Vacuum System (n/a single axle)
Class exclusive built-in, easy cleanup. No need to bring along any extras.



32" Electric Fireplace (n/a non-slide & single axle)
Sit back and relax indoors on chilly days.



Stacked Stone Accent Wall
Decorative entertainment setting makes movie night feel like home.



Hidden Pantry (Select Models)
Extra storage for snacks aplenty.



Front Windshield (FW only)
Allows an abundance of natural light into the coach.



50" HDTV (select models)
Large screen offers premium entertainment viewing.



Laundry Chute (n/a single axle & fifth wheel)
Conveniently stores dirty clothes out of sight.



more product detail at
www.keystonerv.com/hideout



Slip into something a little more comfortable

From beginners to seasoned adventurers, families will enjoy the modern functionality of our newly re-designed Hideout lineup. Contemporary graphics, textured-glass cabinet doors, and distinctive batten ceiling strips are just a few of the luxurious touches that simply cannot be found on most other RVs at this price point. Other amenities include stylish reclaimed wood-inspired flooring, deep tint windows throughout, and hard-valance window treatments.

Two Décor Options

Lighten up with Timber's parchment leatherette, paired with tonal window treatments and wall coverings (shown right and left) or go bold with Lodge's rich browns and dramatic accents (shown below).

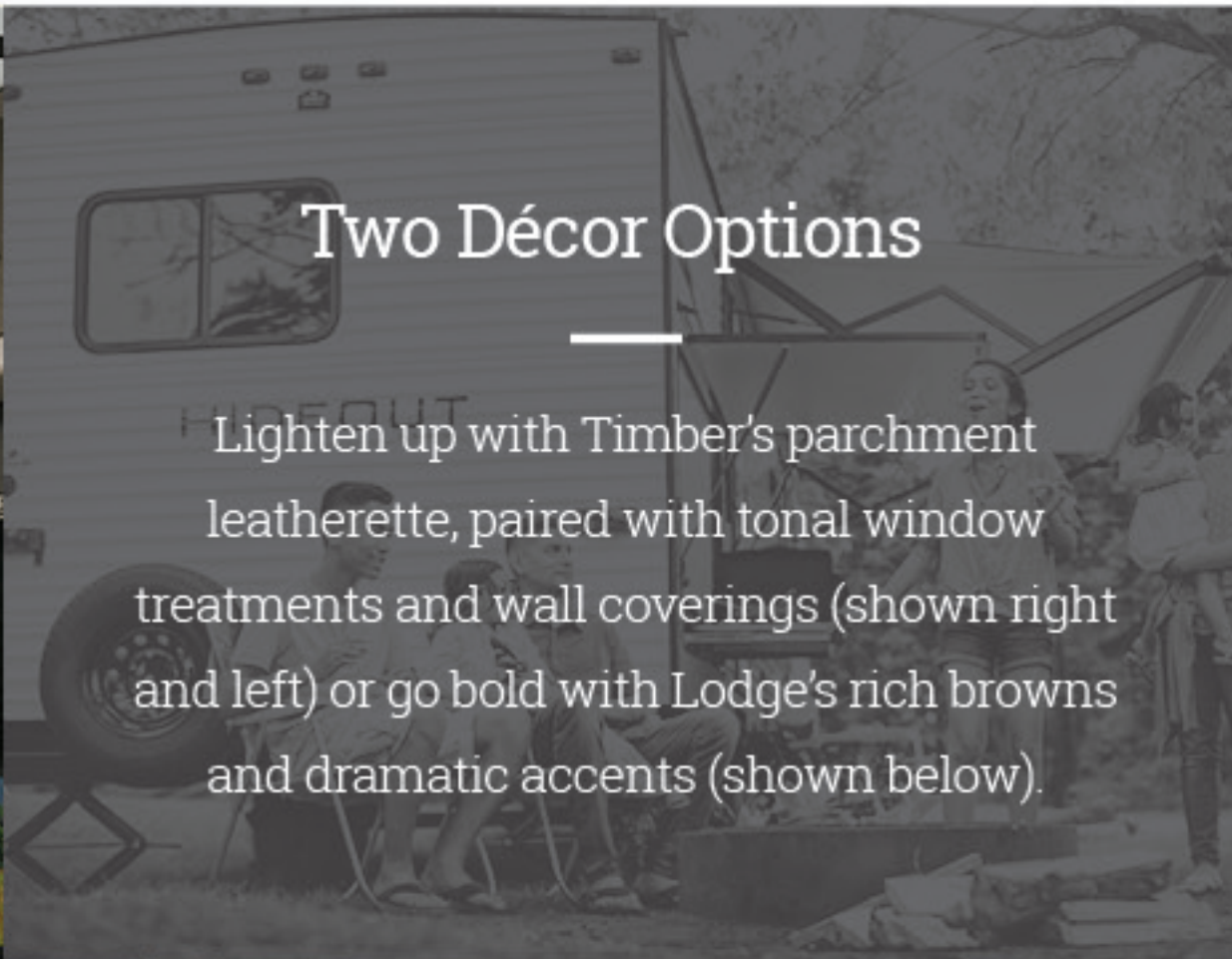

Hidden Pantry

Behind the entertainment center we've tucked away an impressive floor-to-ceiling pantry maximizing your storage space.

*Select models





SINGLE AXLE TRAVEL TRAILERS

- **NEW** exterior graphics
- LCI SolidStep® entry
- Furrion® back up and side camera prep
- Blue led exterior speakers
- Friction hinge entry door
- Solar prep
- **NEW** interior cabinets - platinum maple
- **NEW** Burlap Shale wall board

- **NEW** White Cascade countertop
- Wood plank feature wall
- Black cabinet hardware
- Blackout night shades
- Furrion® bluetooth radio
- All new backsplash
- Greystone microwave
- 38" walk-in shower



LHS TRAVEL TRAILERS

- Power stabilizer jacks - slideout models only
- **NEW** exterior graphics
- LCI SolidStep® entry
- Furrion® back up and side camera prep
- Blue LED exterior speakers
- Friction hinge entry door
- **NEW** Platinum Maple interior cabinets
- **NEW** rectangular diamond glass inserts on cabinet uppers
- **NEW** Burlap Shale wallboard
- **NEW** White Cascade countertop
- **NEW** backsplash

- **NEW** Glacier Gray carpet
- 32" Greystone fireplace-slide models only
- Stacked Stone Mink accent wall (select floorplans)
- Black cabinet hardware
- Blackout night shades
- Furrion® bluetooth radio
- Greystone microwave
- Greystone range hood
- 38" walk-in shower (select floor plans)
- Fitted gray bedding
- Designer stitching on dinette cushions



LUXURY TRAVEL TRAILERS

- Power stabilizer jacks
- **NEW** exterior graphics
- LCI SolidStep® entry - n/a with patio door
- Furrion® back-up and side camera prep
- Blue LED exterior speakers
- Friction hinge entry door
- 8 cu ft refrigerator
- **NEW** Platinum Maple interior cabinets
- **NEW** rectangular diamond glass inserts on cabinet uppers
- **NEW** Burlap Shale wallboard
- **NEW** one piece countertop
- **NEW** backsplash

- 32" Greystone fireplace-slide models only
- Stacked Stone Mink accent wall (select floor plans)
- Black cabinet hardware
- **NEW** Glacier Gray carpet
- Blackout night shades
- Furrion® bluetooth radio
- Greystone microwave
- Greystone range hood
- 38" walk-in shower (select floor plans)
- Fitted gray bedding
- Designer stitching on dinette cushions



LUXURY FIFTH WHEELS

- 6" taller profile
- Painted front cap with windshield
- **NEW** exterior graphics
- LCI SolidStep® entry
- Furrion® back up and side camera prep
- Blue led exterior speakers
- Friction hinge entry door
- 6" More head room-bed/bathroom
- Added third step to upper deck
- Handrail to upper deck
- **NEW** headboard
- **NEW** bedroom with bedside wardrobes
- **NEW** floor to ceiling wardrobe in bedroom-select floor plans
- **NEW** Platinum Maple interior cabinets

- **NEW** rectangular diamond glass inserts on cabinet uppers
- **NEW** Burlap Shale wallboard
- **NEW** one-piece countertop
- **NEW** backsplash
- **NEW** Glacier Gray carpet
- 50" TV now standard on all floorplans
- 32" Greystone fireplace
- Stacked Stone Mink accent wall-select floorplans
- Black cabinet hardware
- Blackout night shades
- Furrion® bluetooth radio
- Greystone microwave / greystone range hood
- 38" Walk-in shower replaces tub (select floor plans)
- Fitted gray bedding
- Designer stitching on dinette cushions



Hideout

LHS TRAVEL TRAILERS

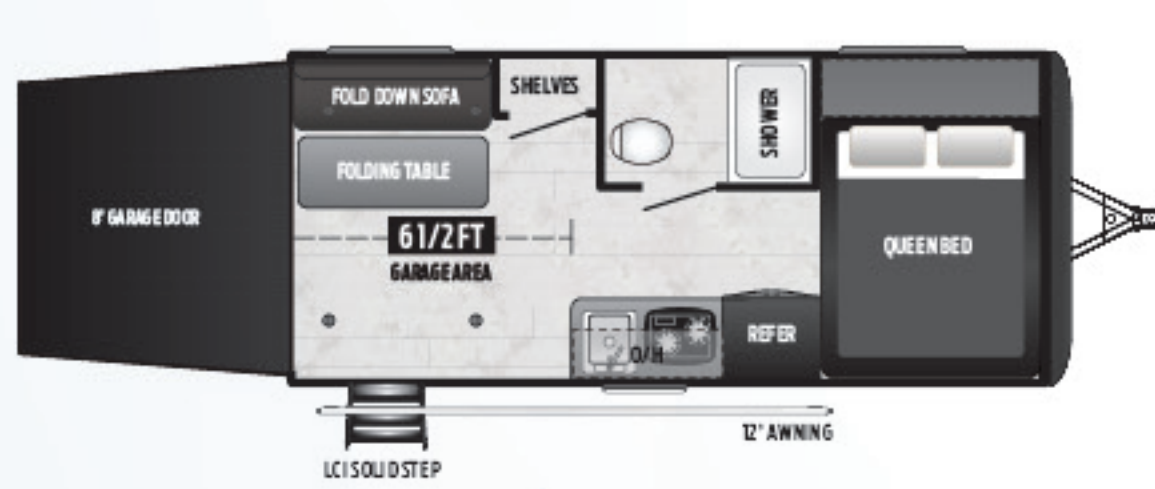

NEW! 172LHS | **GARAGE, QUEEN BED**
Weight: TBD LBS. | Length: TBD

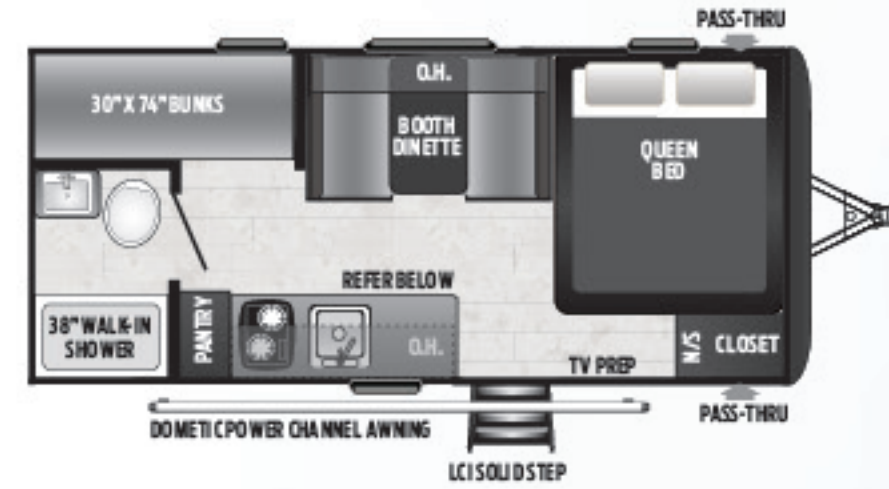

175LHS | **SINGLE-OVER-SINGLE BUNKHOUSE**
Weight: 3381 LBS. | Length: 21' 5"

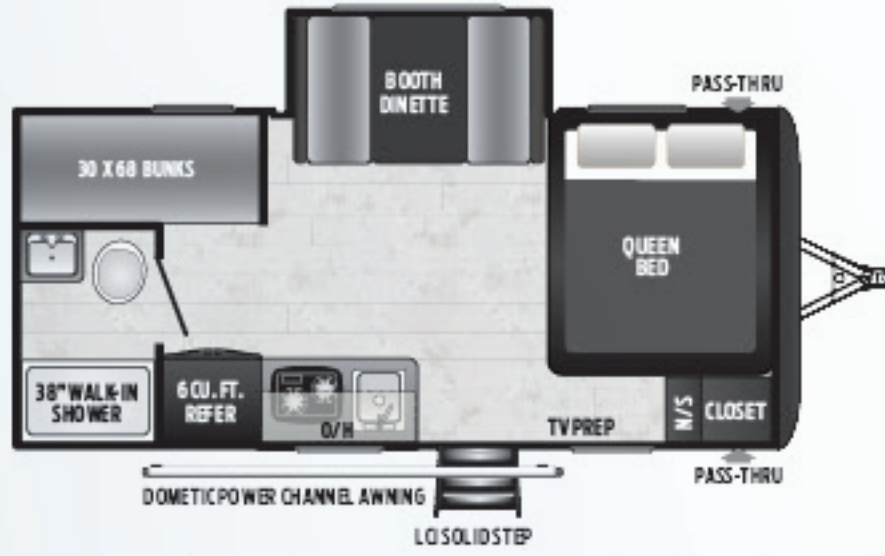

176LHS | **ONE SLIDE, DOUBLE BUNKS, ROOF-MOUNT A/C**
Weight: 3763 LBS. | Length: 21' 5"

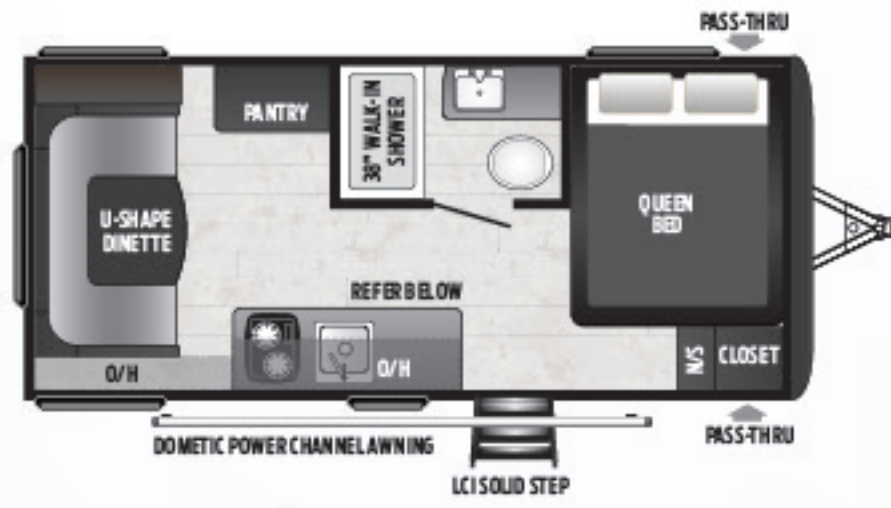

177LHS | **REAR DINETTE, QUEEN BED**
Weight: 3383 LBS. | Length: 21' 5"

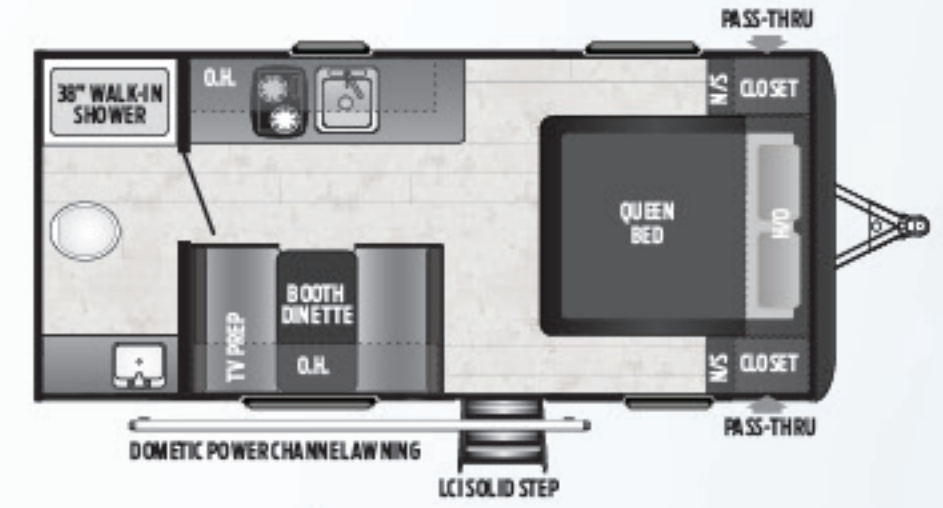

178LHS | **REAR BATH, QUEEN BED**
Weight: 3327 LBS. | Length: 21' 5"

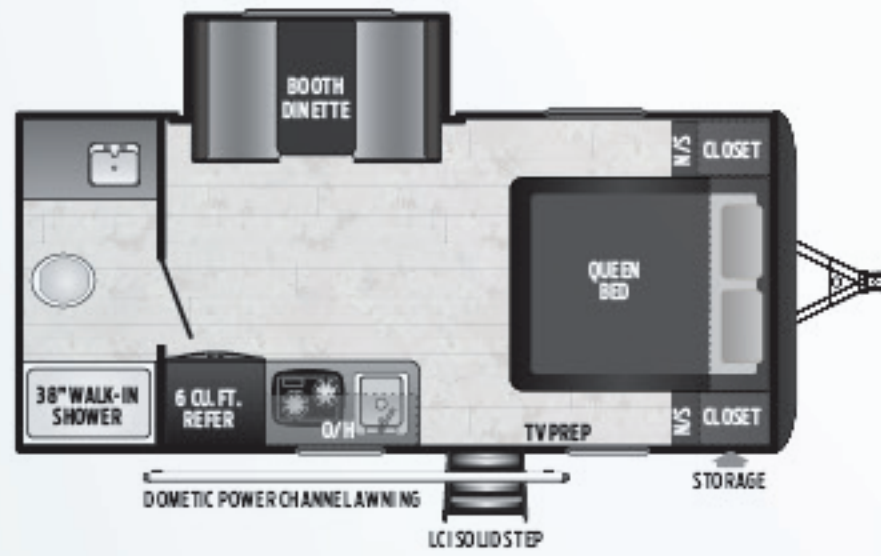

179LHS | **REAR BATHROOM, ROOF-MOUNT A/C & 6 CU. FT. FRIDGE**
Weight: 3735 LBS. | Length: 21' 5"

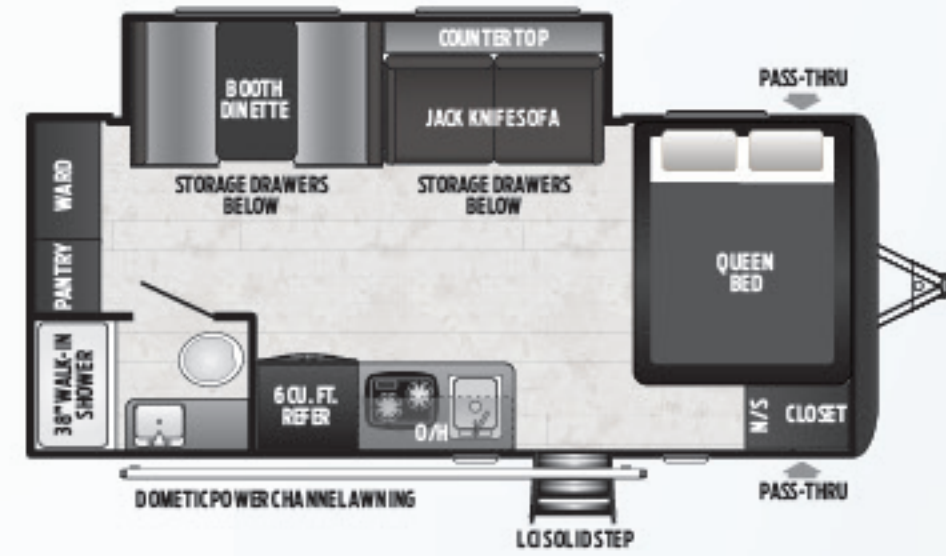

NEW! 186LHS | **LARGEST PANTRY/WARD IN ITS CLASS & 6 CU. FT. FRIDGE**
Weight: 4185 LBS. | Length: 22' 10"

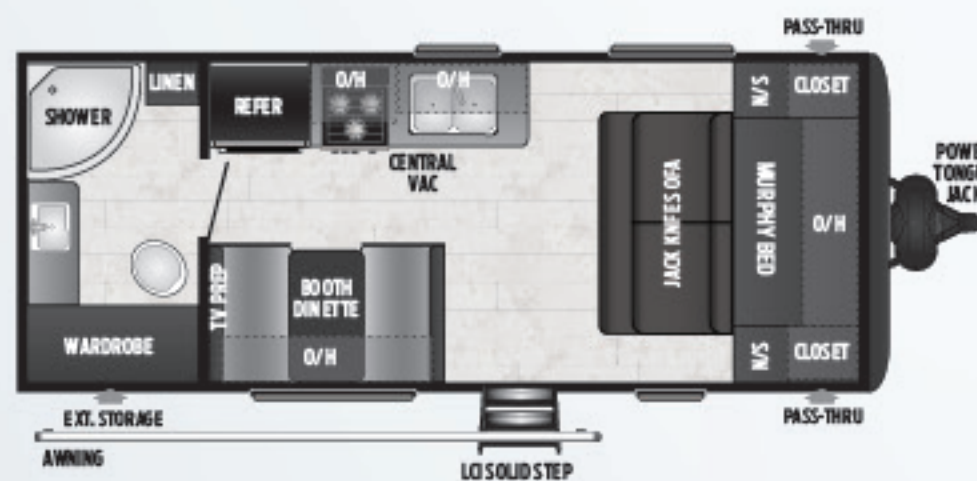

192LHS | **DOUBLE-AXLE NON-SLIDE, REAR BATHROOM, MURPHY BED**
Weight: 4470 LBS. | Length: 23' 11"

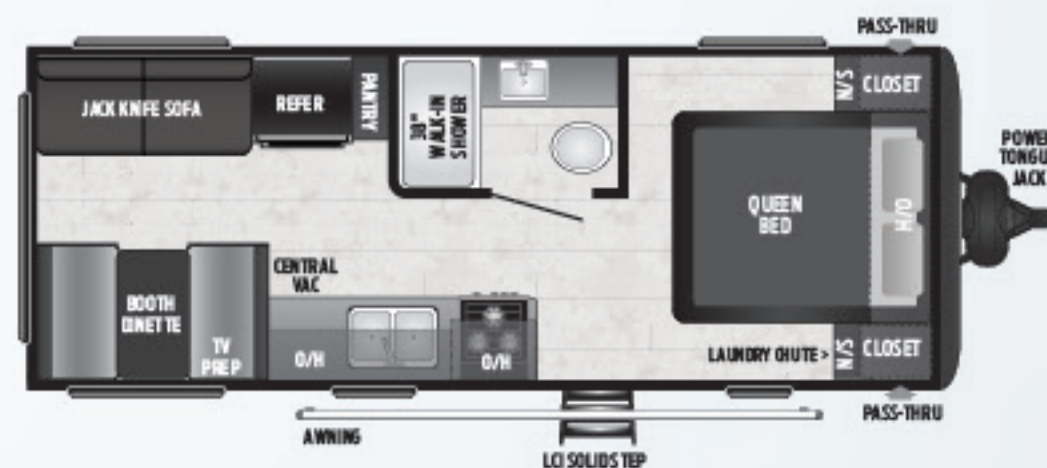

202LHS | **NON-SLIDE, REAR DINETTE**
Weight: 4483 LBS. | Length: 24' 11"

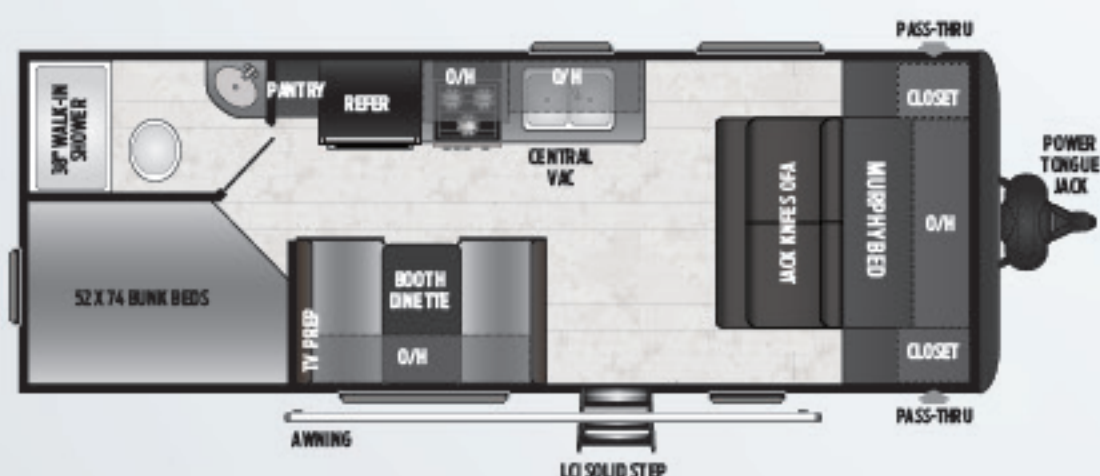

212LHS | **NON-SLIDE, DOUBLE-OVER-DOUBLE BUNKHOUSE, MURPHY BED**
Weight: 4758 LBS. | Length: 26' 4"

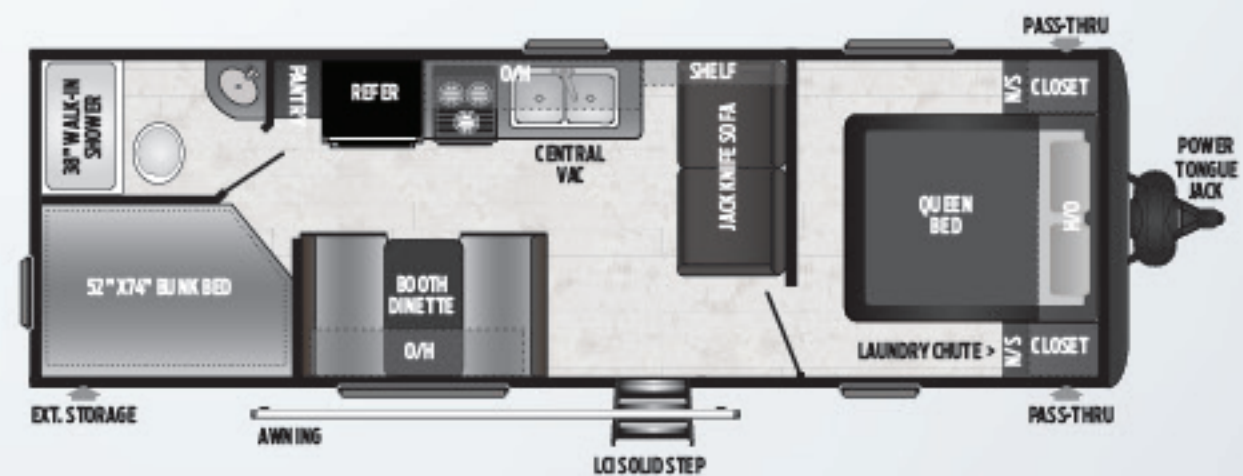

262LHS | **NON-SLIDE, DOUBLE-OVER-DOUBLE BUNKHOUSE, PRIVATE BATHROOM**
Weight: 5056 LBS. | Length: 29' 3"

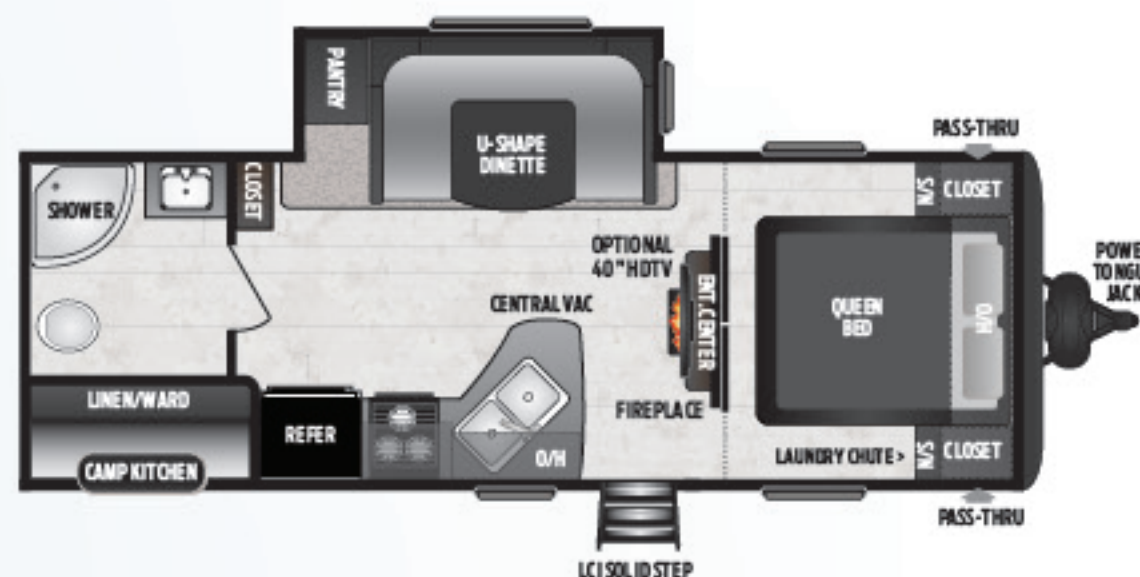

232LHS | ONE-SLIDE, REAR BATHROOM, U-SHAPE DINETTE, CAMP KITCHEN
Weight: 5594 LBS. | Length: 28' 1"

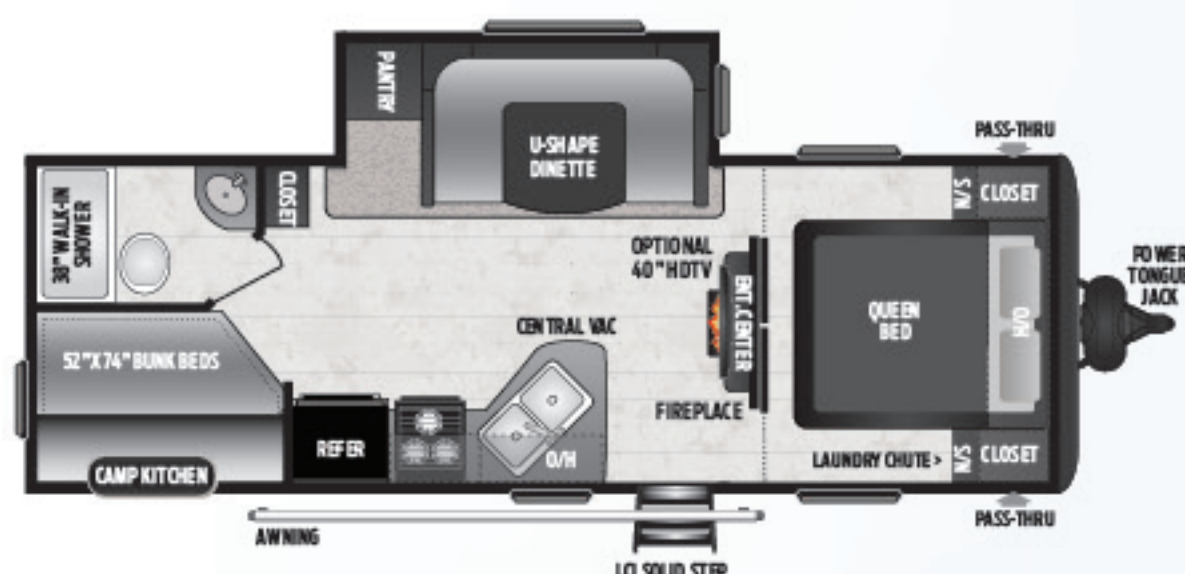

242LHS | ONE-SLIDE, DOUBLE-OVER-DOUBLE BUNKHOUSE, U-SHAPE DINETTE
Weight: 5627 LBS. | Length: 28' 5"

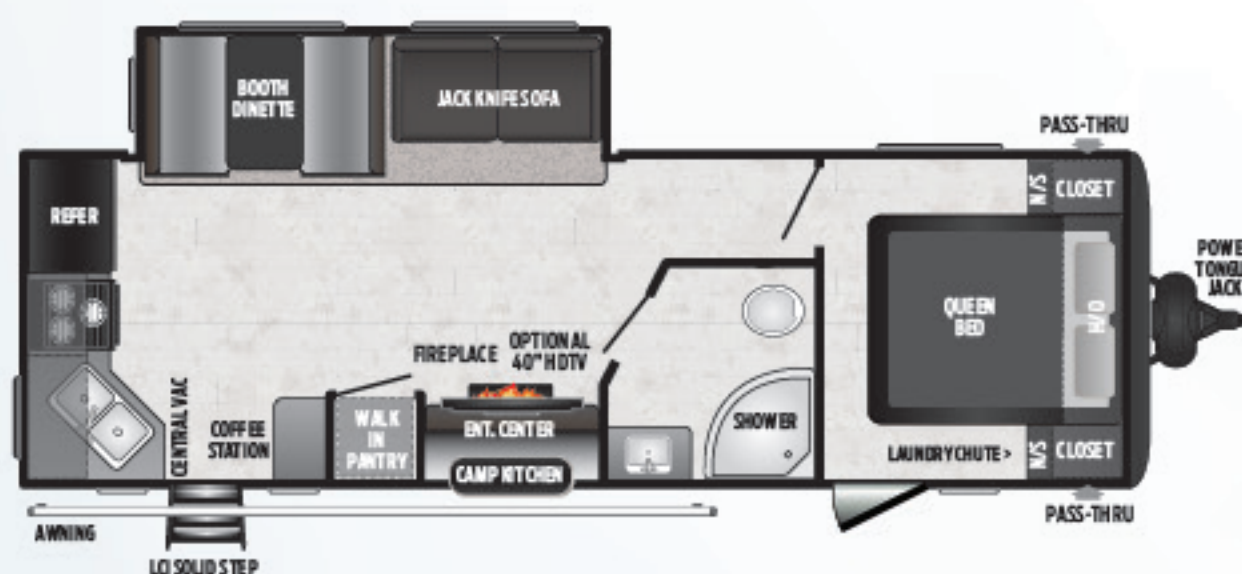

258LHS | ONE-SLIDE, REAR KITCHEN, PRIVATE BATHROOM, CAMP KITCHEN
Weight: 6178 LBS. | Length: 29' 11"

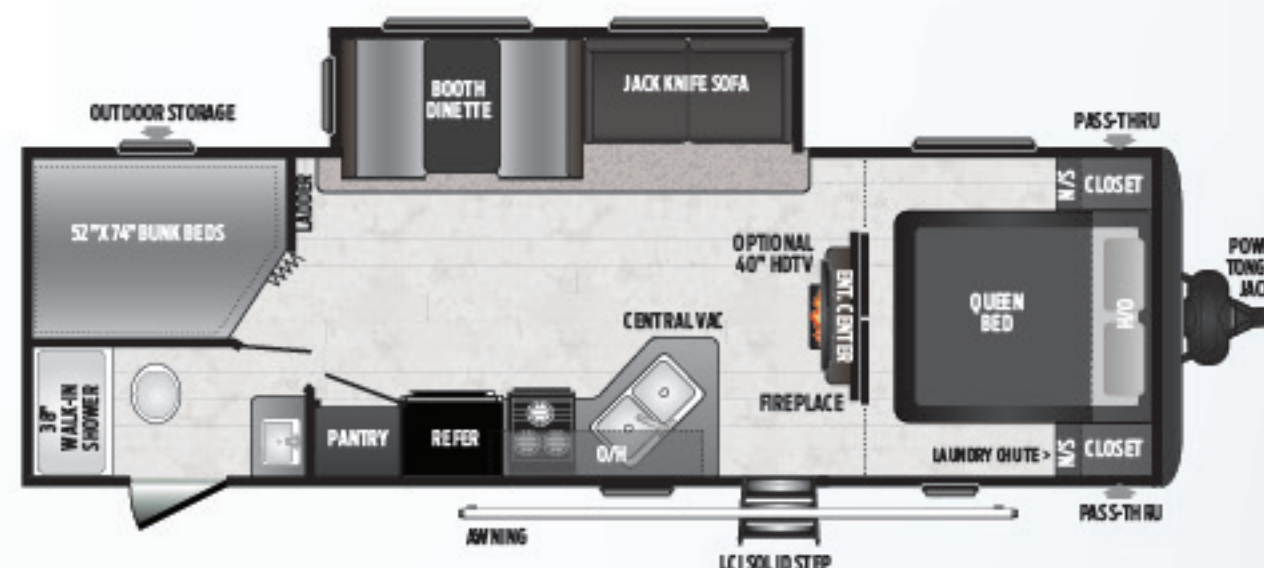

272LHS | ONE-SLIDE, DOUBLE-OVER-DOUBLE BUNKHOUSE, DUAL ENTRY
Weight: 6069 LBS. | Length: 30' 8"

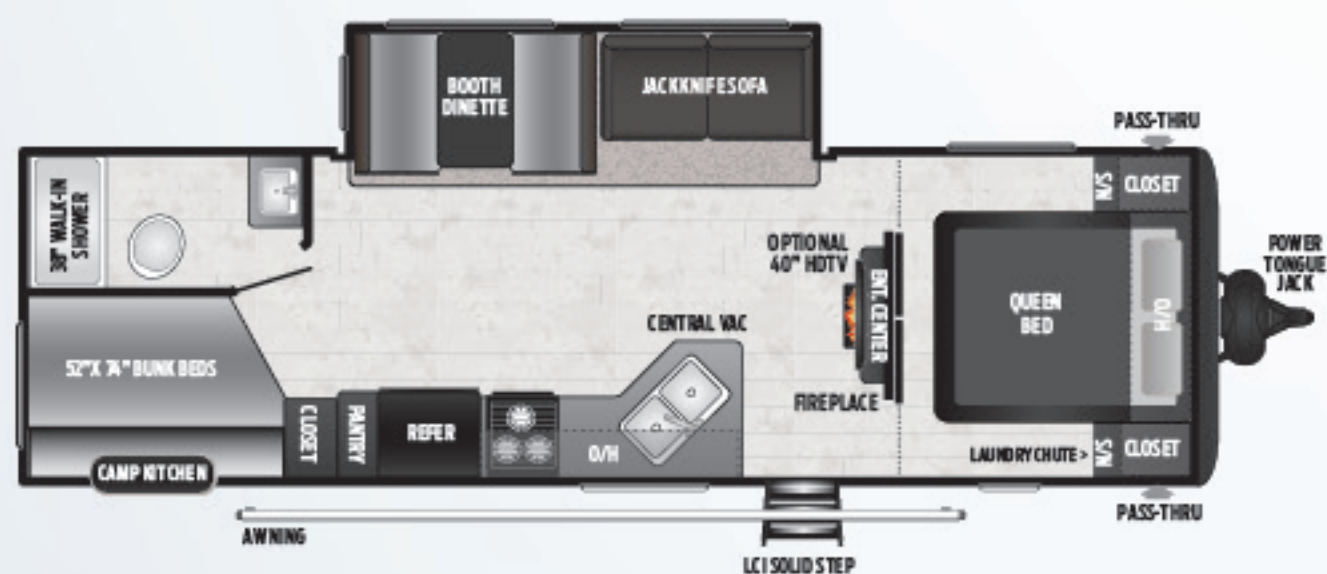

274LHS | ONE-SLIDE, DOUBLE-OVER-DOUBLE BUNKHOUSE, CAMP KITCHEN
Weight: 6218 LBS. | Length: 31' 6"

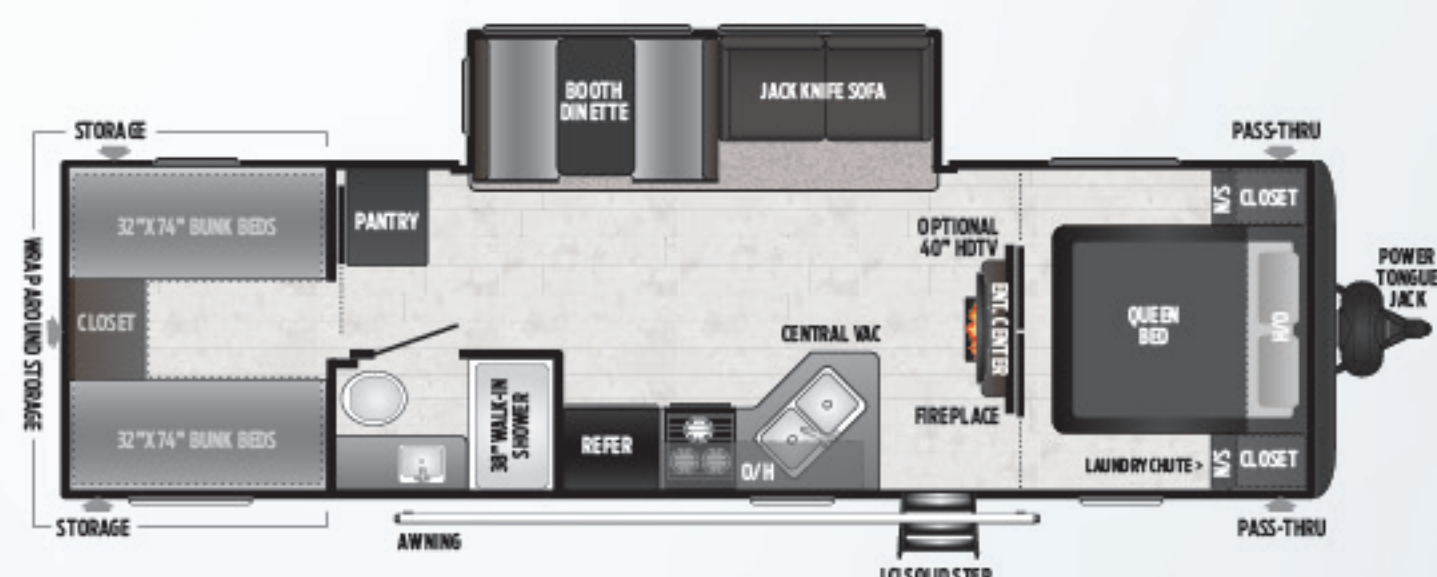

NEW! 290LHS | ONE-SLIDE, PRIVATE BUNKROOM, MASSIVE WRAPAROUND STORAGE
Weight: 6565 LBS. | Length: 33' 4"

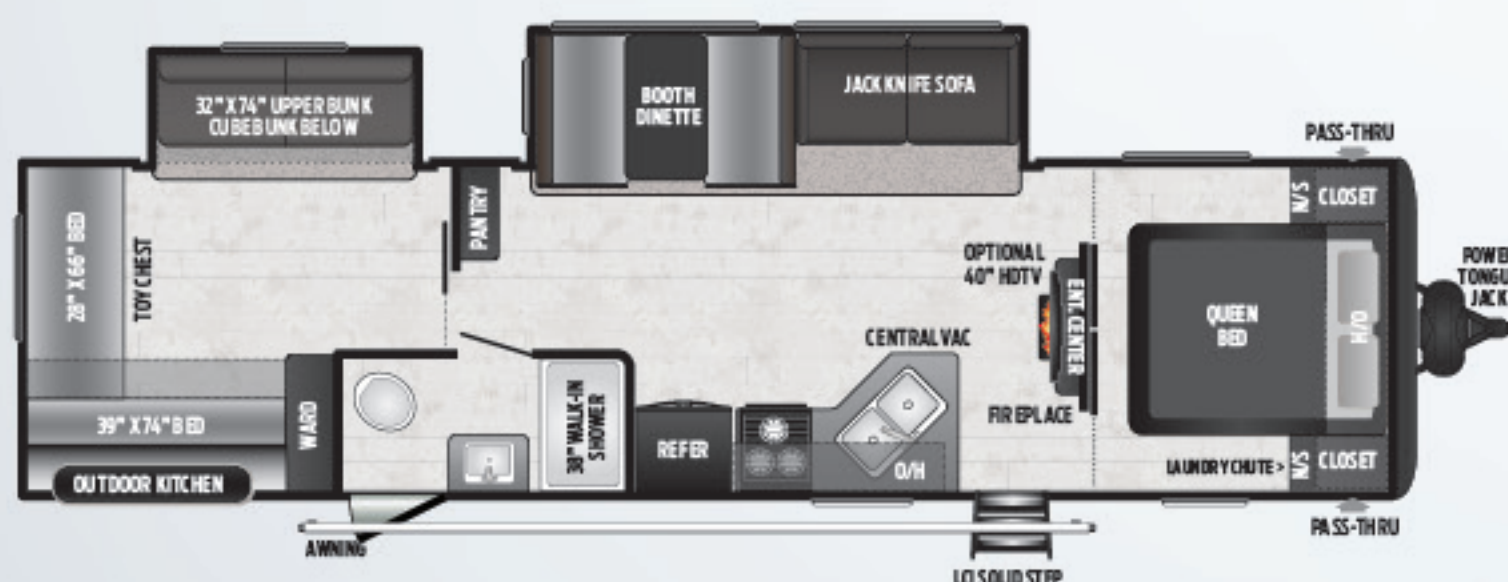

318LHS | TWO-SLIDE, PRIVATE BUNKROOM, OUTDOOR KITCHEN
Weight: 7686 LBS. | Length: 35' 11"



338LHS | TWO-SLIDE, PRIVATE BUNKROOM, BATH & A HALF, OUTDOOR KITCHEN
Weight: 8061 LBS. | Length: 37' 11"



Hideout

TRAVEL TRAILERS

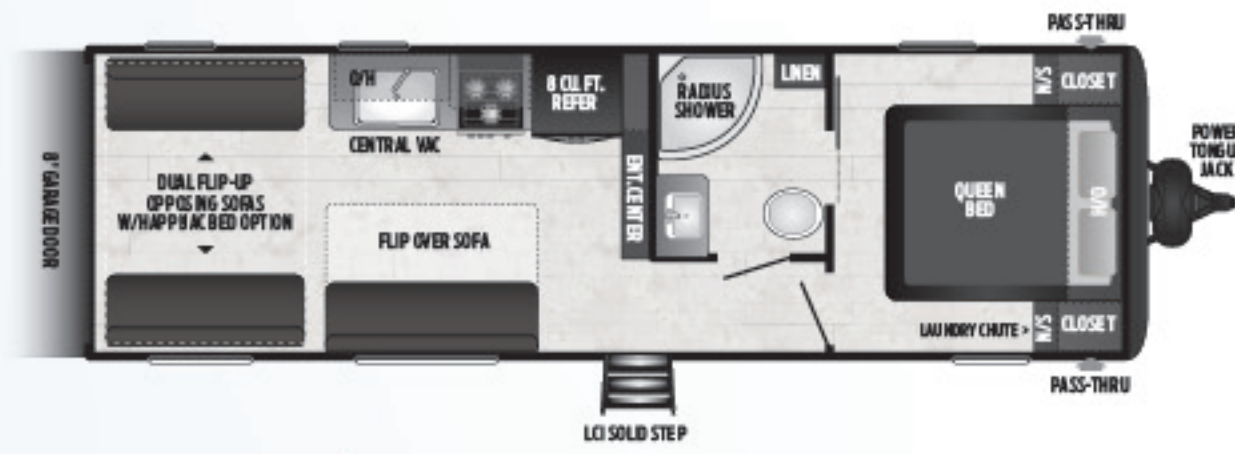

25TH | NON-SLIDE, TOY HAULER W/ HAPPIJAC IN REAR
Weight: 6092 LBS. | Length: 29' 11"

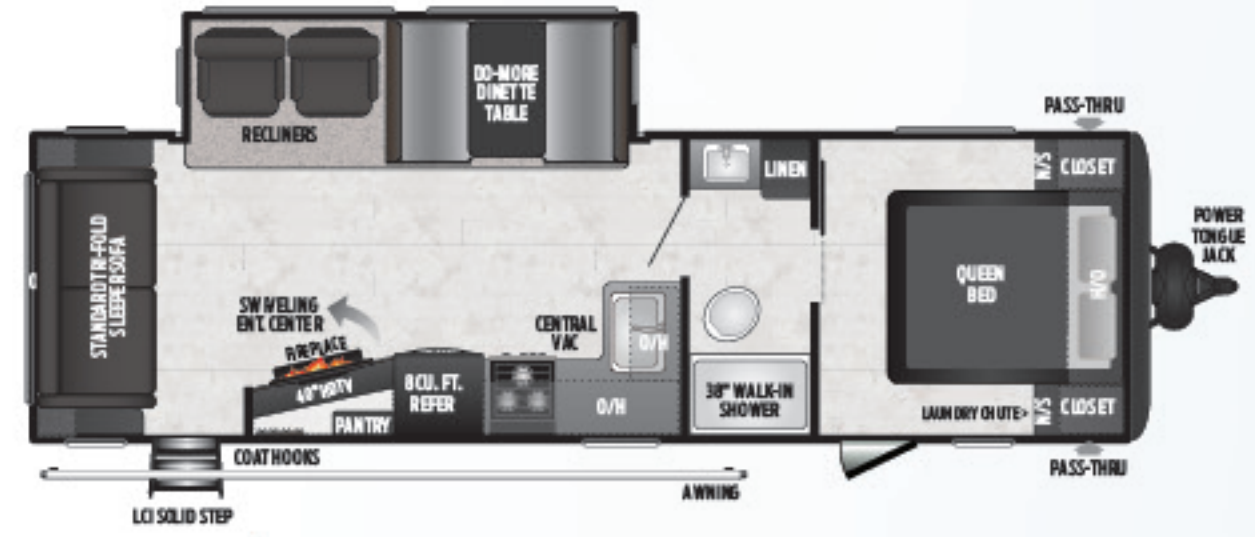

NEW! 27RLS | REAR LIVING ROOM W/ RECLINERS, HIDDEN PANTRY, & WALK-IN SHOWER
Weight: 6680 LBS. | Length: 31' 11"

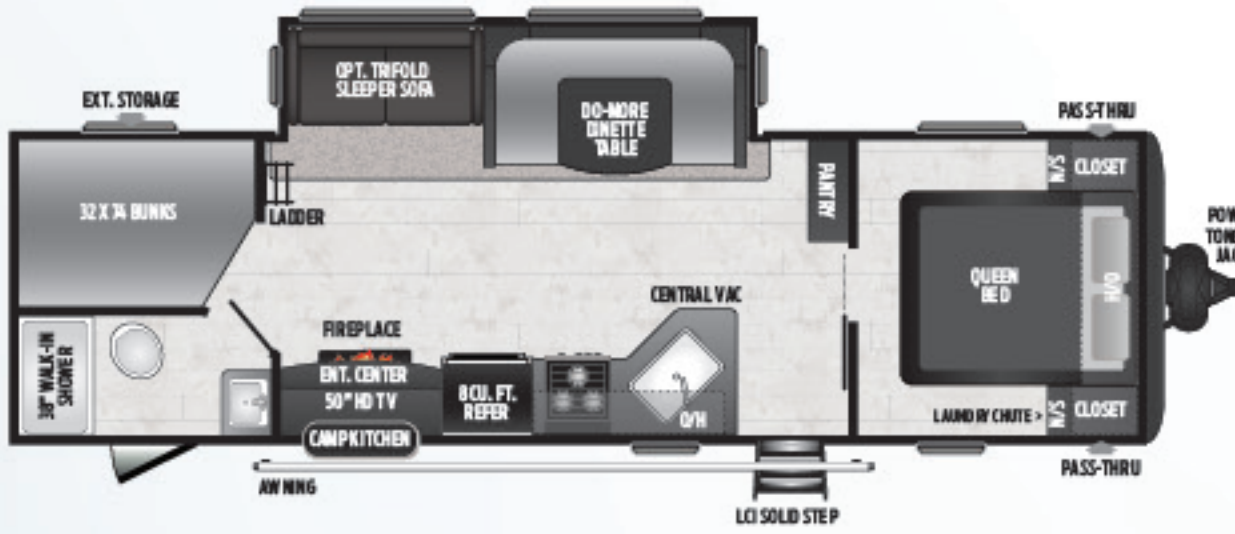

28BHS | ONE-SLIDE, DOUBLE-OVER-DOUBLE BUNKHOUSE, CAMP KITCHEN, 50" HDTV
Weight: 6916 LBS. | Length: 32' 9"

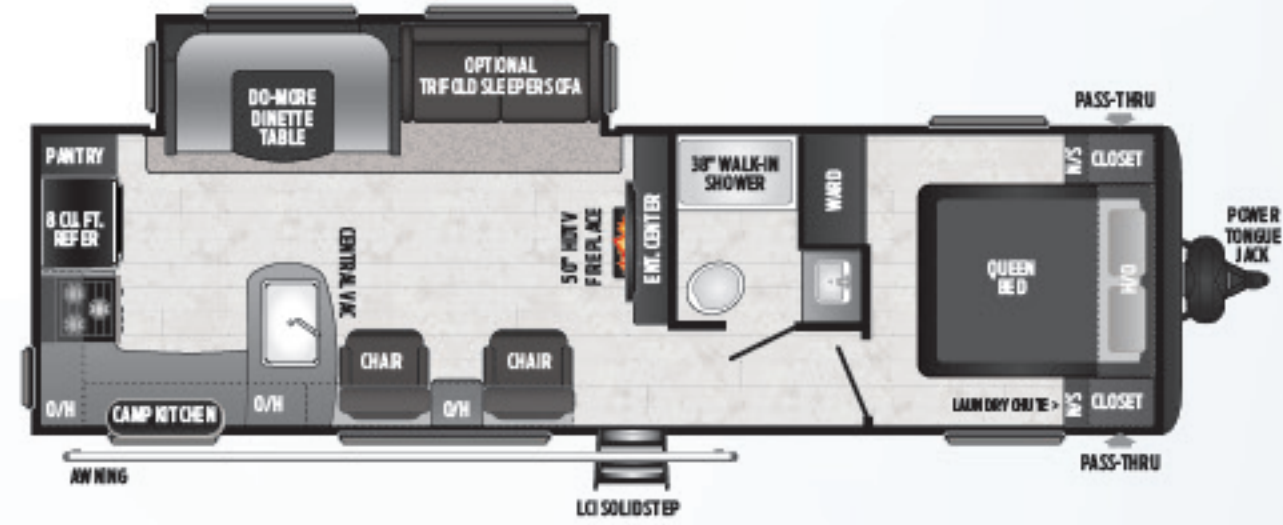

28RKS | ONE-SLIDE, REAR KITCHEN, CAMP KITCHEN, 50" HDTV
Weight: 7008 LBS. | Length: 32' 11"

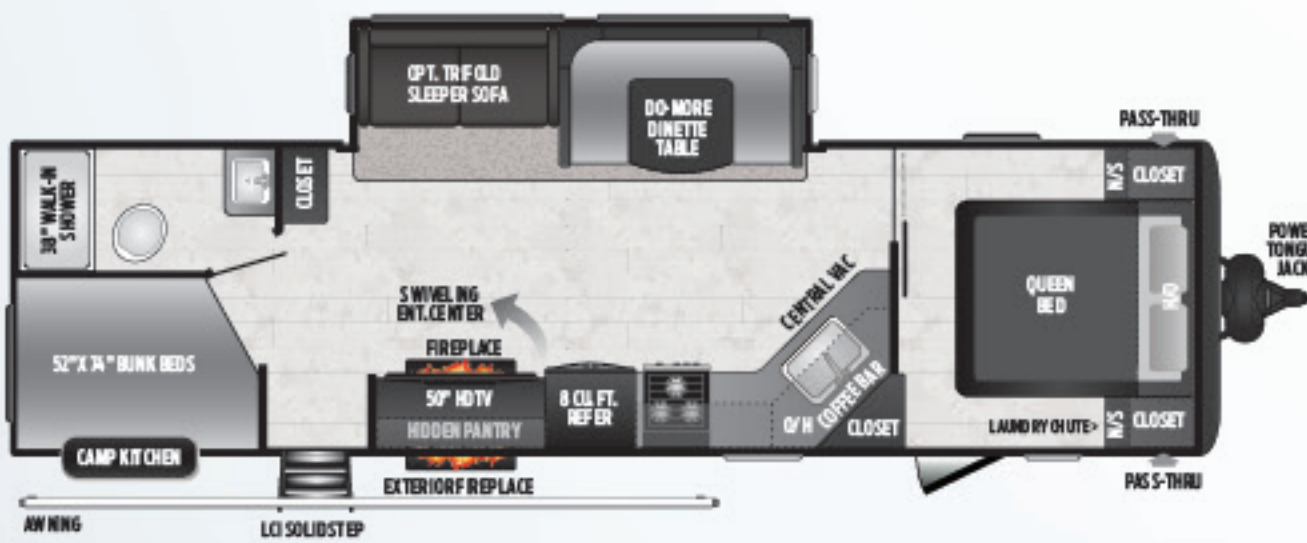

29DFS | ONE-SLIDE, DOUBLE BUNKS, EXCLUSIVE HIDDEN PANTRY, EXTERIOR FIREPLACE
Weight: 7162 LBS. | Length: 33' 11"

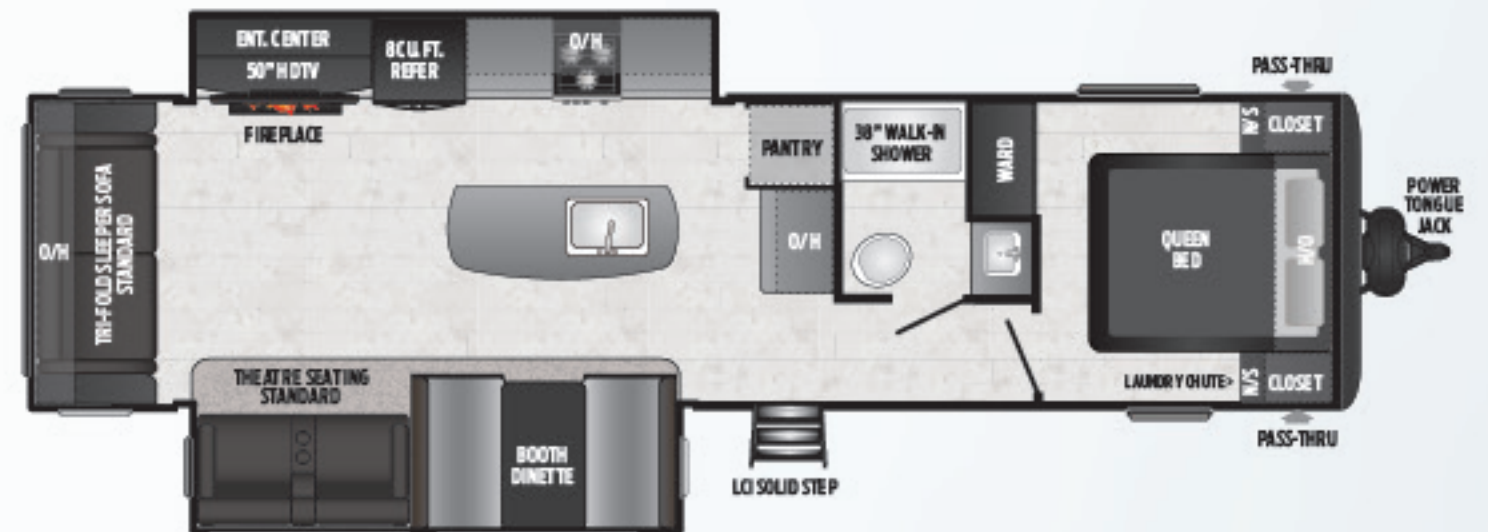

NEW! 30RLDS | TWO-SLIDE, REAR LIVING ROOM W/ THEATER SEATING, KITCHEN ISLAND, PANTRY
Weight: TBD LBS. | Length: TBD

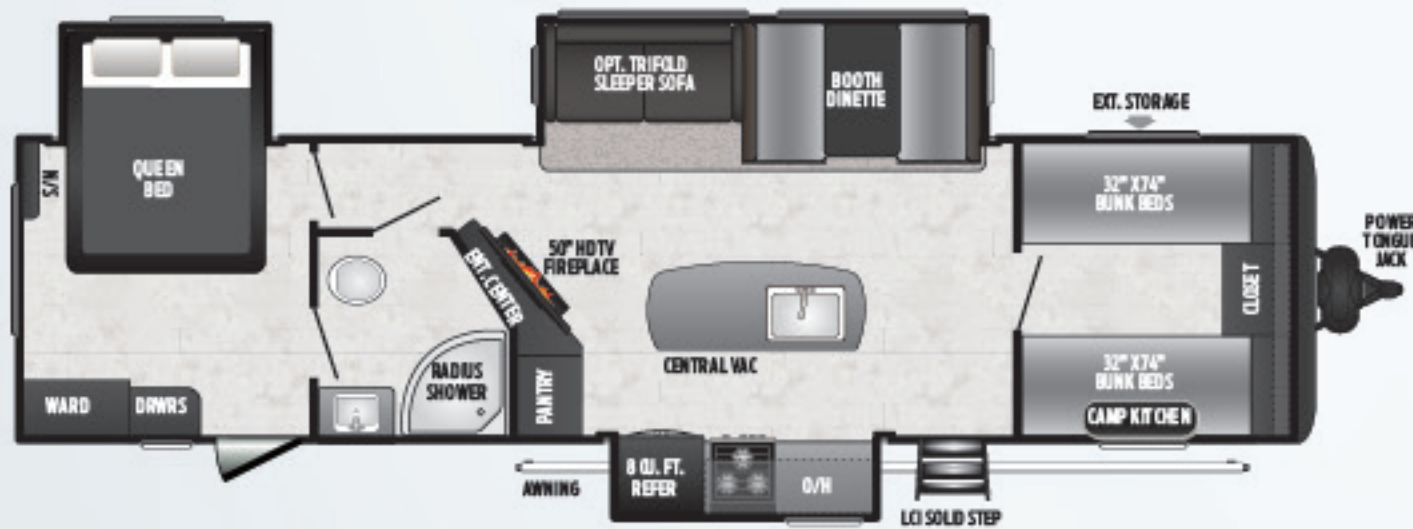

32FBTS | TWO-SLIDE W/ BED SLIDE, FRONT QUAD BUNK, CAMP KITCHEN, 50" HDTV
Weight: 8663 LBS. | Length: 36' 11"

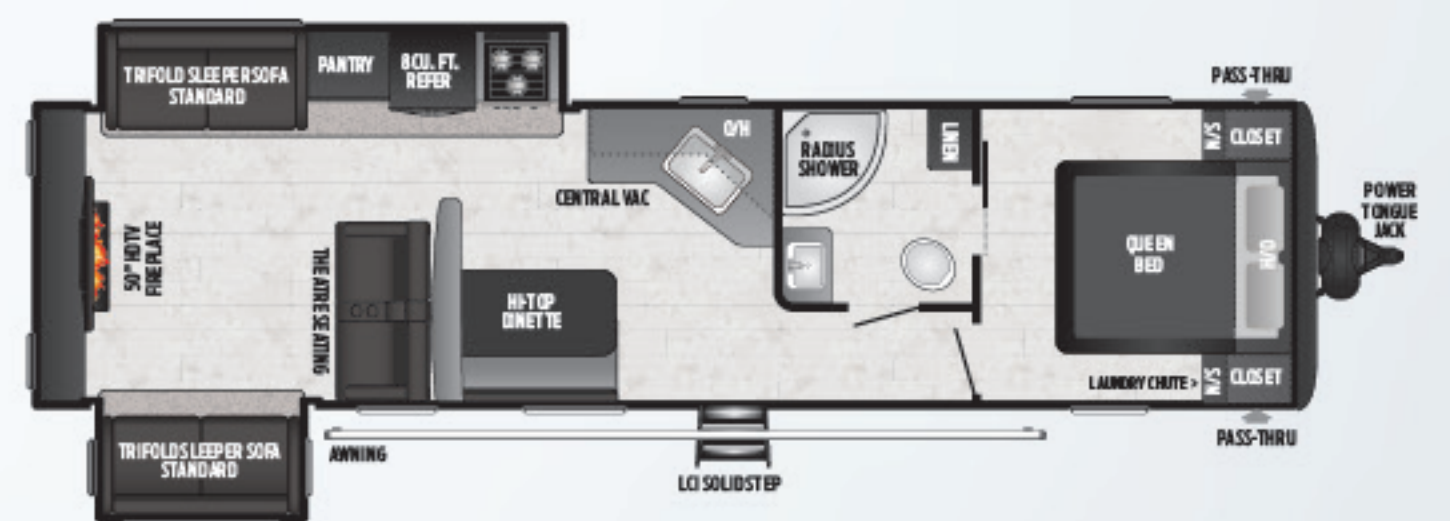

32RDDS | TWO-SLIDE, REAR LIVING ROOM W/ THEATER SEATING, TRI-FOLD SOFAS, 50" HDTV
Weight: 7901 LBS. | Length: 36' 8"



NEW! 34FKDS | FRONT KITCHEN, HIDDEN PANTRY, W/D PREP
Weight: TBD LBS. | Length: 38' 11"

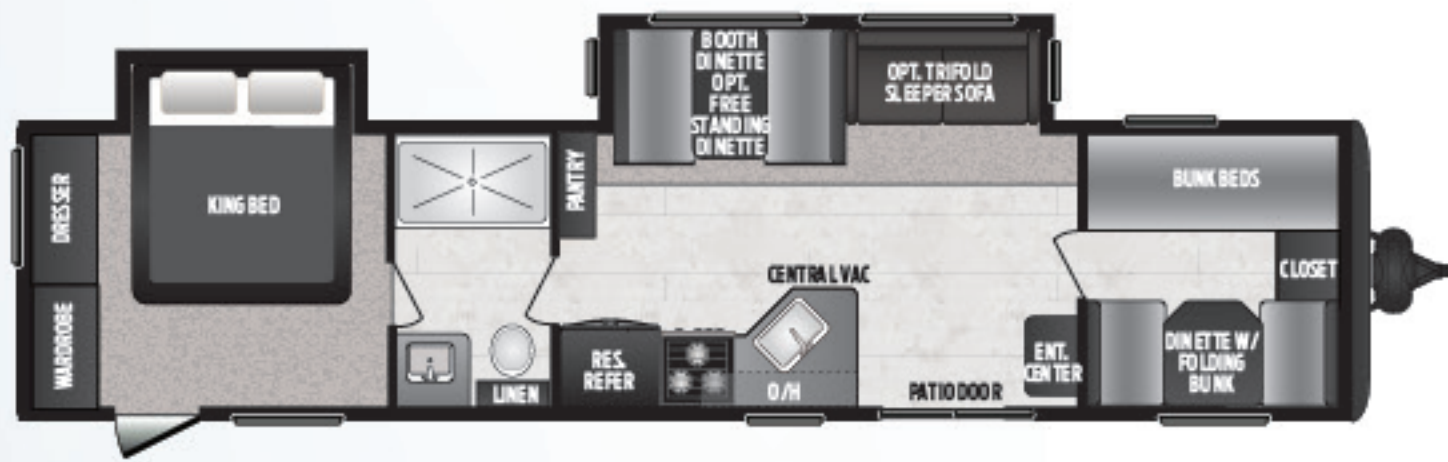

38BHDS | TWO-SLIDE W/ BED SLIDE, BUNKHOUSE, RESIDENTIAL FRIDGE, PATIO DOOR
Weight: 8486 LBS. | Length: 39' 11"

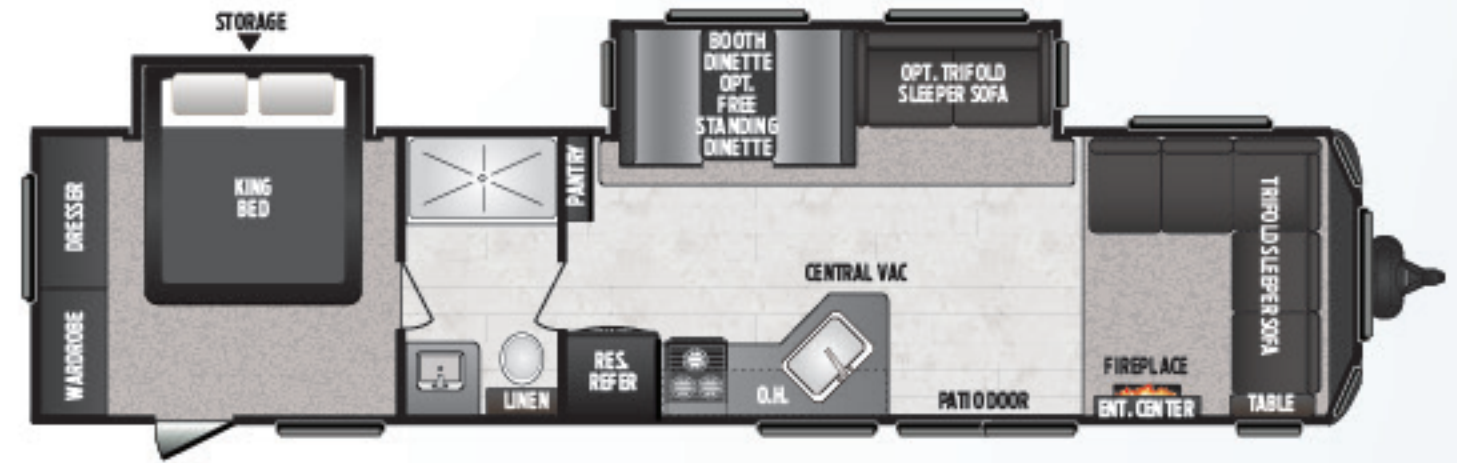

38FDDS | TWO-SLIDE W/ BED SLIDE, FRONT SECTIONAL, RESIDENTIAL FRIDGE, PATIO DOOR
Weight: 8477 LBS. | Length: 39' 11"

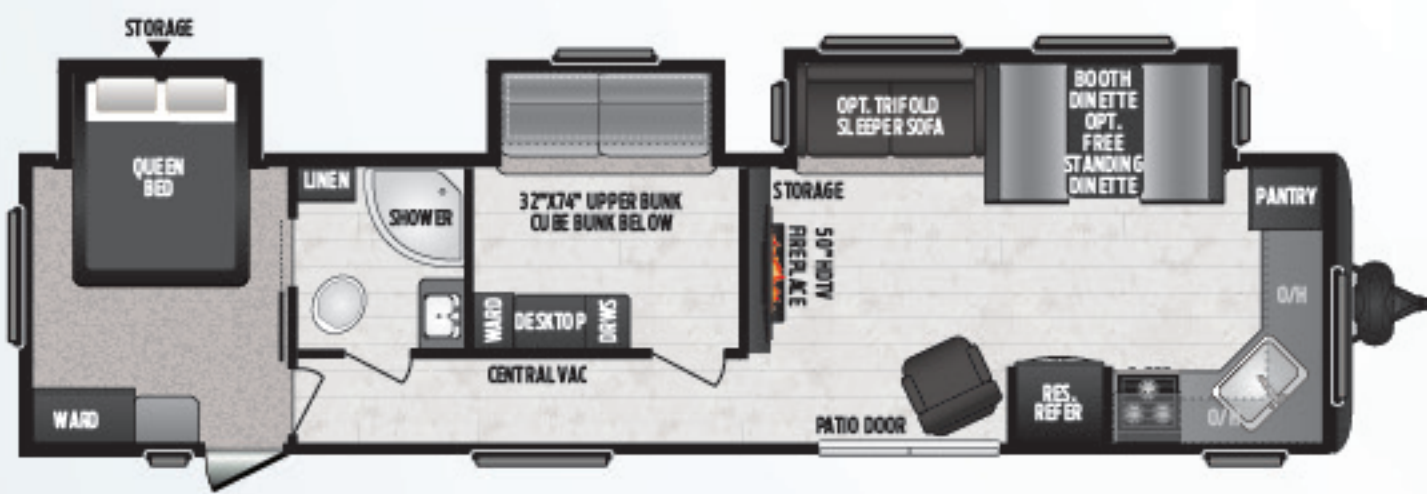

38FKTS | THREE-SLIDE, MID-BUNKHOUSE, RESIDENTIAL FRIDGE, PATIO DOOR
Weight: 9275 LBS. | Length: 39' 11"

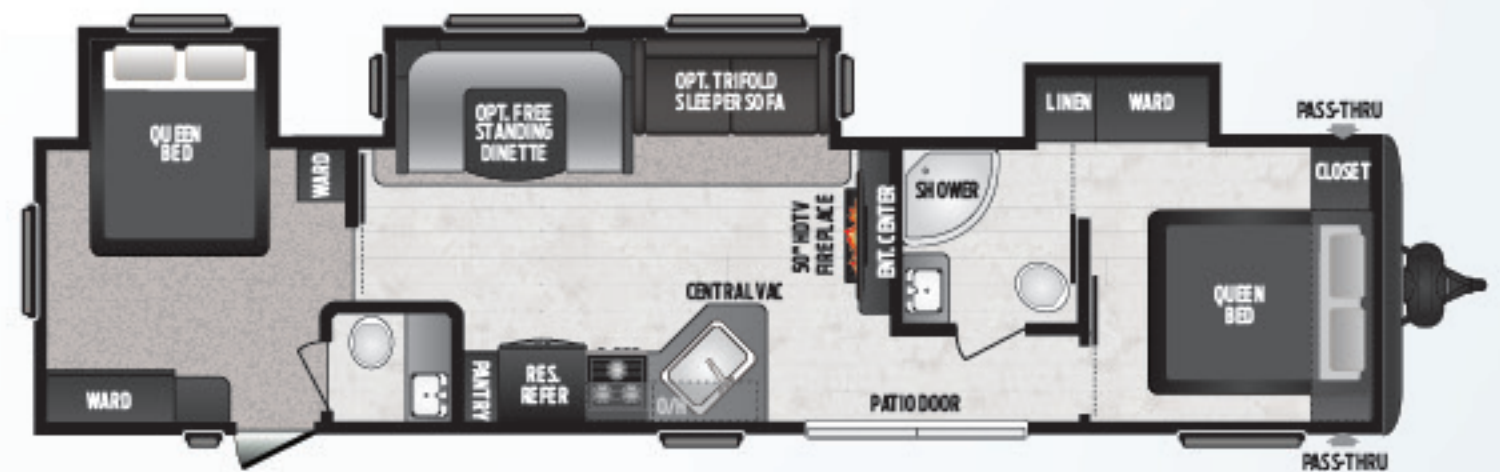

38FQTS | THREE-SLIDE, DOUBLE QUEEN BEDROOM, BATH & A HALF, RESIDENTIAL FRIDGE, PATIO DOOR
Weight: 9403 LBS. | Length: 39' 11"

Worry-free Extended Season Camping

Interested in camping longer into the fall and getting out earlier in the spring? Hideout offers a Cold Mountain Package that makes this possible. An enclosed underbelly with forced heat helps prevent tanks from freezing when temperatures start to dip. Water lines are given an extra measure of protection by being run in your Hideout's flooring.

Cold Mountain Package is not available on LHS or single-axle models.



Hideout

FIFTH WHEELS

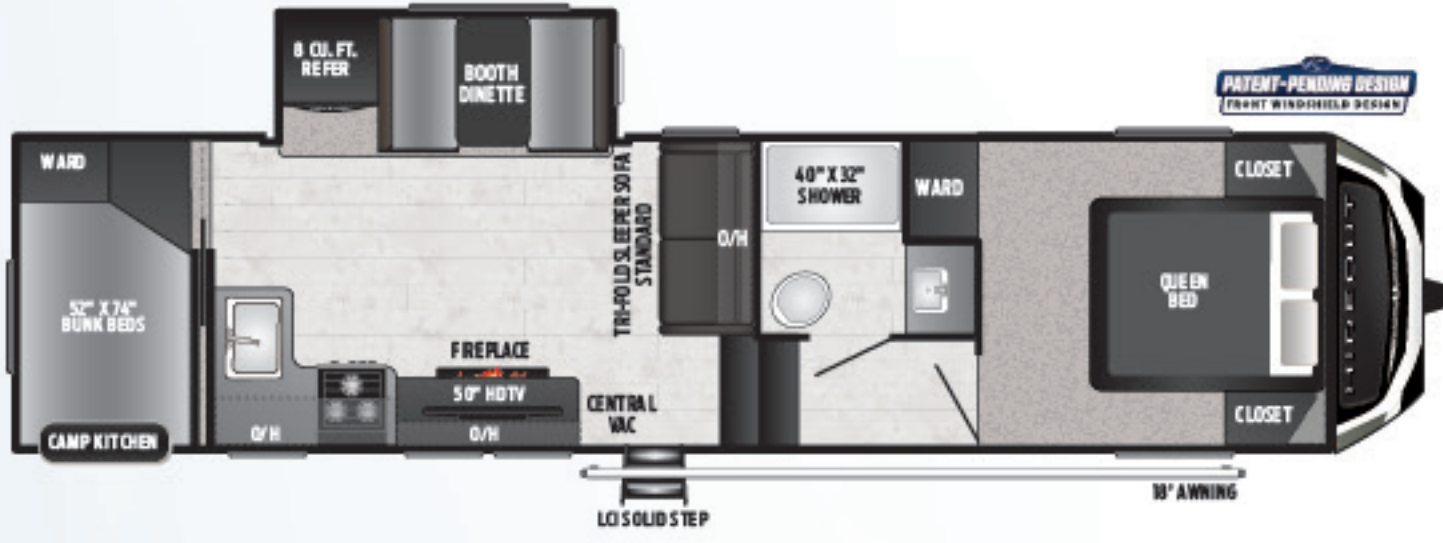

295BHS | ONE-SLIDE, DOUBLE-OVER-DOUBLE BUNKHOUSE, CAMP KITCHEN
Weight: 8450 LBS. | Length: 33' 4"

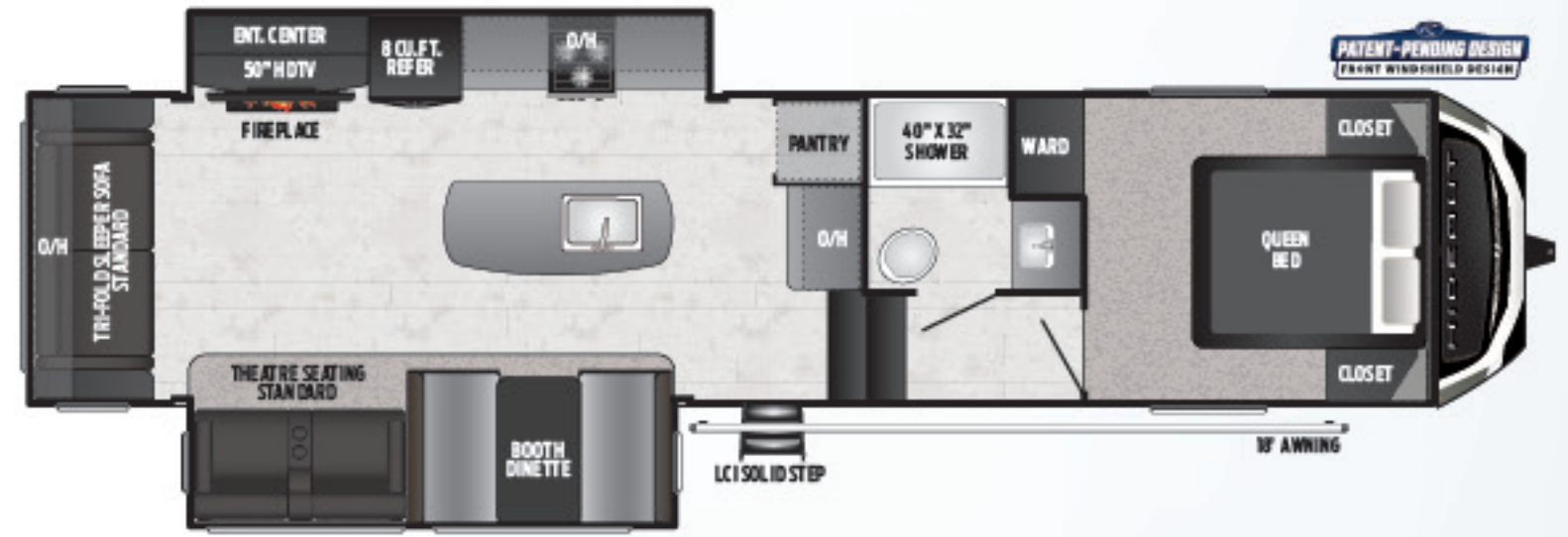

NEW! 300RLDS | DOUBLE SLIDE, REAR LIVING, MASSIVE ISLAND, HUGE PANTRY
Weight: 9345 LBS. | Length: 34' 4"

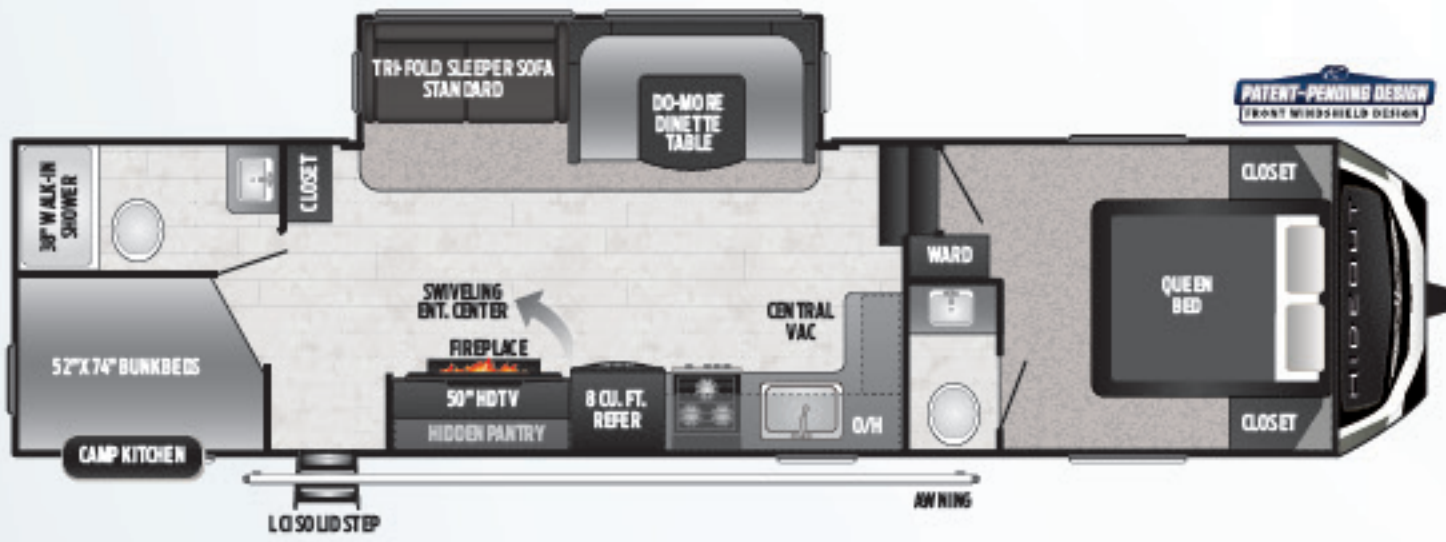

NEW! 301DBS | ONE SLIDE, DOUBLE-OVER-DOUBLE BUNKS, HIDDEN PANTRY, BATH AND A HALF
Weight: 8725 LBS. | Length: 34' 2"

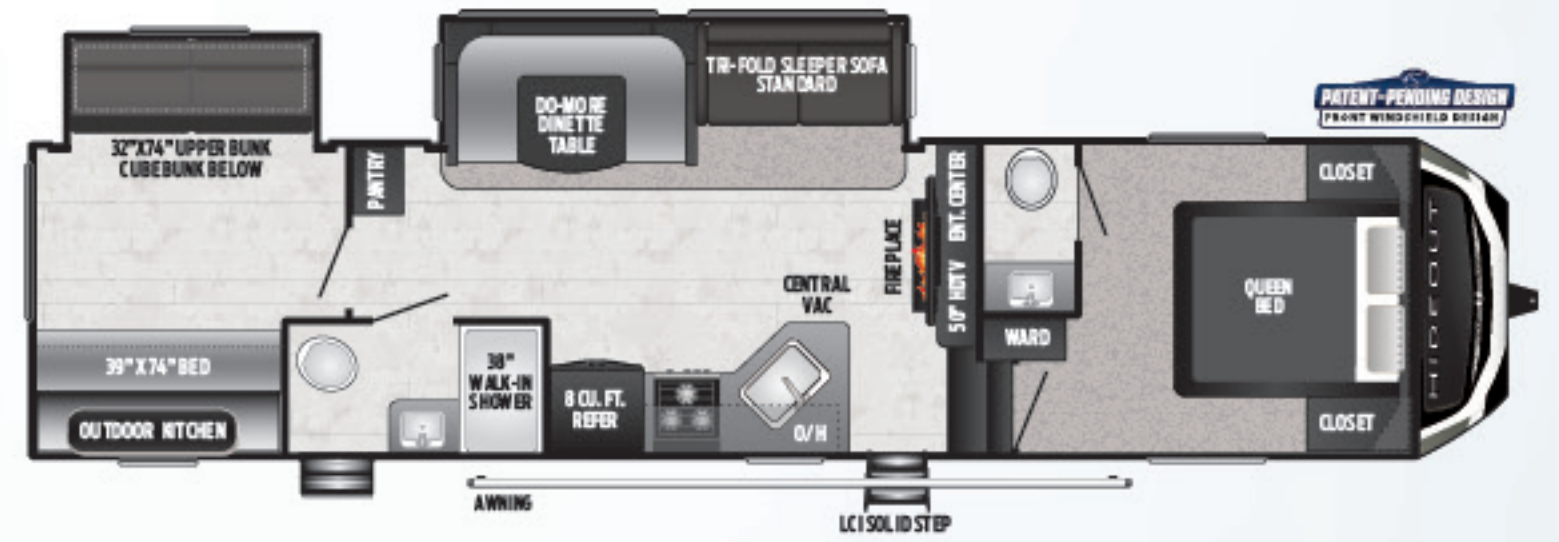

308BHDS | TWO-SLIDE, PRIVATE BUNKROOM, BATH & A HALF, 50" HDTV, OUTDOOR KITCHEN
Weight: 9240 LBS. | Length: 35' 5"

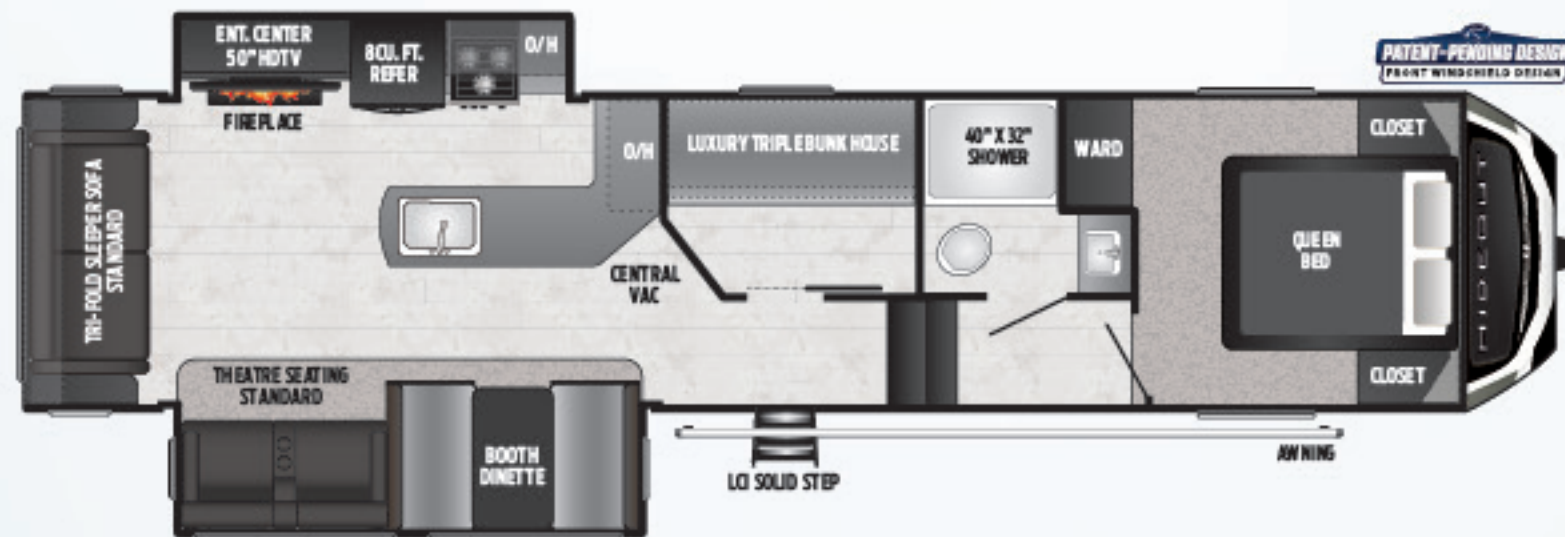

NEW! 320MBDS | TWO SLIDE, LUXURY TRIPLE BUNK, MASSIVE COUNTERTOP
Weight: TBD LBS. | Length: 39' 6"

LHS TRAVEL TRAILERS AND SINGLE AXLES

MODEL	WEIGHT	CARRYING CAPACITY	HITCH WEIGHT	FRESH WATER	WASTE WATER	GRAY WATER	LPG	LENGTH*	HEIGHT
172LHS	TBD	TBD	TBD	TBD	TBD	TBD	TBD	TBD	TBD
175LHS	3381	1019	485	27	30	30	20	21' 5"	10' 2"
176LHS	3763	737	520	27	30	30	20	21' 5"	10' 2"
177LHS	3383	1017	540	27	30	30	20	21' 5"	10' 2"
178LHS	3327	1113	440	27	30	32	20	21' 5"	10' 2"
179LHS	3735	745	480	27	32	30	20	21' 5"	10' 2"
186LHS	4185	815	615	27	30	30	20	22' 10"	10' 4"
192LHS	4470	2530	540	43	30	30	40	23' 11"	10' 3"
202LHS	4483	2717	490	43	39	39	40	24' 11"	10' 3"
212LHS	4758	2442	545	43	30	39	40	26' 4"	10' 3"
232LHS	5594	2016	610	43	30	39	40	28' 1"	11' 1"
242LHS	5627	2023	650	43	30	30	40	28' 5"	11' 1"
258 LHS	6178	1582	760	43	39	69	40	29' 11"	11' 1"
262LHS	5056	2489	545	43	30	39	40	29' 3"	10' 3"
272LHS	6069	1711	780	43	30	30	40	30' 8"	11' 1"
274LHS	6218	1552	775	43	30	39	40	31' 6"	11' 0"
290LHS	6565	3085	875	43	39	39	40	33' 4"	11' 0"
318LHS	7686	2014	900	43	39	69	40	35' 11"	11' 2"
338LHS	8061	1639	935	43	78	69	40	37' 11"	11' 2"

LUXURY TRAVEL TRAILERS

MODEL	WEIGHT	CARRYING CAPACITY	HITCH WEIGHT	FRESH WATER	WASTE WATER	GRAY WATER	LPG	LENGTH*	HEIGHT
25TH	6092	3608	900	43	39	39	40	29' 11"	11' 3"
27RLS	6680	2820	815	43	39	39	40	31' 11"	11' 0"
28BHS	6916	2749	865	43	39	69	40	32' 9"	11' 0"
28RKS	7008	2652	860	43	39	78	40	32' 11"	11' 0"
29DFS	7162	2518	920	43	30	78	40	33' 11"	11' 0"
30RLDS	TBD	TBD	TBD	TBD	TBD	TBD	TBD	TBD	TBD
32FBTS	8663	2837	1150	43	39	39	40	36' 11"	11' 2"
32RDDS	7901	1869	970	43	39	39	40	36' 8"	11' 2"
34FKDS	TBD	TBD	TBD	43	39	117	60	38' 11"	11' 2"
38BHDS	8486	1484	1170	43	39	39	60	39' 11"	11' 2"
38FDDS	8477	1523	1205	43	39	39	60	39' 11"	11' 2"
38FKTS	9275	1725	1200	43	39	78	60	39' 11"	11' 4"
38FQTS	9403	1957	1200	43	78	78	60	39' 11"	11' 4"

LUXURY FIFTH WHEELS

MODEL	WEIGHT	CARRYING CAPACITY	HITCH WEIGHT	FRESH WATER	WASTE WATER	GRAY WATER	LPG	LENGTH*	HEIGHT
295BHS	8450	2550	1780	43	39	78	60	33' 4"	12' 11"
300RLDS	9345	2755	1910	43	39	78	60	34' 4"	12' 11"
301DBS	8725	3375	1840	43	69	60	60	34' 2"	12' 11"
308BHDS	9240	2760	1915	43	78	39	60	35' 5"	12' 11"
320MBDS	TBD	TBD	TBD	43	39	78	60	39' 6"	12' 11"

DISCLAIMER: Product information is as accurate as possible as of the date of publication of this brochure. All features, floor plans, and specifications in this brochure are subject to change without notice. Please also consult Keystone's web site at www.keystonerv.com for more current product information and specifications. Tow Vehicle Disclaimer. CAUTION: Owners of Keystone recreational vehicles are solely responsible for the selection and proper use of tow vehicles. All customers should consult with a motor vehicle manufacturer or their dealer concerning the purchase and use of suitable tow vehicles for Keystone products. Keystone disclaims any liability or damages suffered as a result of the selection, operation, use or misuse of a tow vehicle. KEYSTONE'S LIMITED WARRANTY DOES NOT COVER DAMAGE TO THE RECREATIONAL VEHICLE OR THE TOW VEHICLE AS A RESULT OF THE SELECTION, OPERATION, USE OR MISUSE OF THE TOW VEHICLE. *Length is defined as the distance from the centerline of hitch pin/coupler to rear bumper of trailer. Please review owner's manual prior to purchase for more information on service warranties, extended use, towing and maintenance. Owner's manuals can be found at keystonerv.com.

	SA	LHS	TT	FW
EXTERIOR				
Power stab jacks	N/A	S-FP	S	S
Power tongue jack	N/A	S	S	S
Black tank flush	N/A	N/A	S	S
Gas/electric water heater	N/A	N/A	S	S
Power awning	S	S	S	S
LCI® Solid Step®	S	S	S	S
Friction hinge door (n/a on 38' destination TT models)	S	S	S	S
Furrion® backup and side camera prep	S	S	S	S
Blue LED lighted ext. speakers	S	S	S	S
Tinted windows	S	S	S	S
Solar prep	S	S	S	S
XL entry assist handle	N/A	N/A	S	S
110v outside receptacle	S	S	S	S
Front diamond plate	S	S	S	S
Gas DSI water heater	S	S	N/A	N/A
Winegard® antenna	S	S	S	S
Laminated fiberglass sidewalls	N/A	N/A	N/A	S
Painted front cap with windshield	N/A	N/A	N/A	S
Max Turn Technology™ front cap with Hitch Vision™	N/A	N/A	N/A	S
Rota-Flex™ pin box	N/A	N/A	N/A	S
Electric adjustable front landing gear	N/A	N/A	N/A	S
Aluminum wheels	N/A	N/A	N/A	S
INTERIOR				
8K BTU A/C	S	N/A	N/A	N/A
13.5K BTU A/C	O	S	S	N/A
3 cu. ft. refrigerator	S-FP	N/A	N/A	N/A
6 cu. ft. refrigerator	S-FP	S	N/A	N/A
8 cu. ft. refrigerator (n/a 38' destination TT models)	N/A	N/A	S	S
20K BTU furnace	S	N/A	N/A	N/A
30K BTU furnace	N/A	S	S	S
Residential refrigerator (38' destination TT models only)	N/A	N/A	N/A	N/A
Platinum Maple interior cabinets	S	S	S	S
Black cabinet hardware	S	S	S	S
Blackout night shades	S	S	S	S
Central vacuum	N/A	S	S	S
Electric fireplace	N/A	S-FP	S	S
HD TV (40" or 50" by floorplan)	N/A	O	S	S
Furrion® bluetooth radio	S	S	S	S
Stacked stone accent wall	S	S	S	S
Opening bunk room windows	S	S	S	S
Cubby bear bunk matts	S-FP	S-FP	S-FP	S-FP
Do-More dinette table	N/A	N/A	S	S
High-rise faucet	N/A	S	S	S
Stainless-steel sink	N/A	N/A	S	S
Tub surround	N/A	S	S	S
Porcelain foot flush toilet	N/A	S	S	S
Curved shower rod	S	S	S	S
Laundry chute	N/A	S	S	S

Hideout					STANDARDS / OPTIONS				
					SA	LHS	TT	FW	
INTERIOR (CONT.)									
Mirrored wardrobe		N/A	S	S	S				
USB charging station		S	S	S	S				
Monitor panel		N/A	N/A	S	S				
Under-bed storage		S	S	S	S				
Kitchen sink cover		N/A	N/A	S	S				
Furrion® oven with glass top		N/A	S	S	S				
Storage under dinette		S	S	S	S				
Hidden pantry		N/A	N/A	S-FP	S-FP				
Seamless pressed countertops		N/A	N/A	S	S				
Backsplash		S	S	S	S				
Patio door (38' destination TT models only)		N/A	N/A	N/A	N/A				
38" walk-in shower		S	S	S	S				
Accent lighting		N/A	S	S	S				
SAFETY									
Fire extinguisher		S	S	S	S				
Smoke detector		S	S	S	S				
LP detector		S	S	S	S				
CO detector		S	S	S	S				
Safety chains		S	S	S	S				
Emergency breakaway switch		S	S	S	S				
CONSTRUCTION									
Full walk on roof		N/A	S	S	S				
Dual battery rack		N/A	S	S	S				
Residential in-floor heating ducts		N/A	S	S	S				
Color coded and numbered wiring		S	S	S	S				
Powder coated frame		S	S	S	S				
Dexter E-Z Lube® axle		S	S	S	S				
Full width outriggers		S	S	S	S				
Tru-fit five point slideout construction		S	S	S	S				
Rotocast holding tanks		S	S	S	S				
Hurricane straps		S	S	S	S				
Radial tires		S	S	S	S				
Cambered chassis		S	S	S	S				
Seamless 5/8" thick floor decking		S	S	S	S				
Tuf-lok A/C duct joiners		S	S	S	S				
41/2" crowned roof		S	S	S	S				
Flex pex tubing with 10 year warranty		S	S	S	S				
Insulated water lines		S	S	S	S				
Heated and enclosed underbelly		N/A	N/A	S	S				
<div> <div>SA - SINGLE AXLE LHS TRAVEL TRAILER</div> <div>LHS - LHS TRAVEL TRAILER</div> <div>TT - LUXURY TRAVEL TRAILER</div> <div>FW - LUXURY FIFTH WHEEL</div> </div> <div> <div>S = STANDARD / O = OPTIONAL</div> <div>N/A = NOT AVAILABLE / S-FP = SELECT FLOORPLANS</div> </div>									

BUILT FOR THE LONG HAUL



PRINT 10.2019



Colton RV & Marine
3122 Niagara Falls Blvd.
North Tonawanda, NY 14120
(716) 694-0188
www.ColtonRV.com

Colton RV
3443 Southwestern Blvd.
Orchard Park, NY 14127
(716) 957-3250
www.ColtonRV.com

Colton RV
489 Bushkill Plaza LN #9665
Wind Gap, PA 18091
(610) 863-5239
www.ColtonRV.com