



**STANDARD Exterior graphics**  
(Standard on LE, Classic, MBS & TS Models)



Scan here for  
available specs

# FORESTER

BY FOREST RIVER

Colton RV & Marine  
3122 Niagara Falls Blvd  
North Tonawanda, NY 14120  
(716) 694-0188  
www.ColtonRV.com

Colton RV & Marine  
3443 Southwestern Blvd.  
Orchard Park, NY 14127  
(716) 957-3250  
www.Coltonrv.com

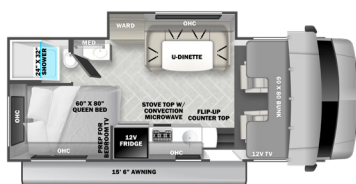

2151SLE (Available on Ford E350/Chevy 3500)

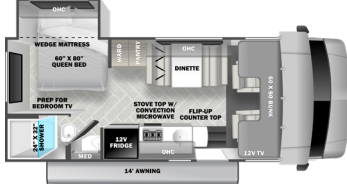

2251SLE (Available on Ford E350/Chevy 3500)

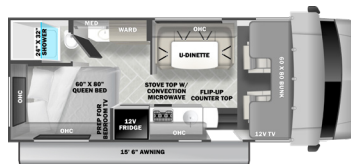

2351LE (Available on Ford E350/Chevy 3500)



2551DSLE (Available on Ford E450)

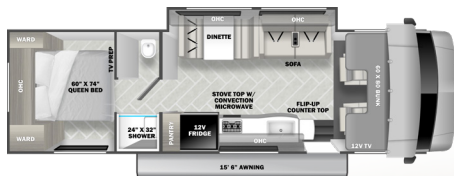

2851SLE (Available on Ford E450)

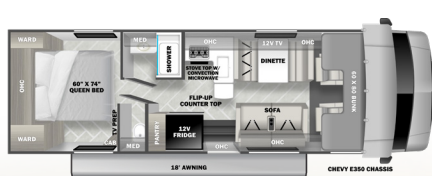

2951SLE (Available on Ford E450)

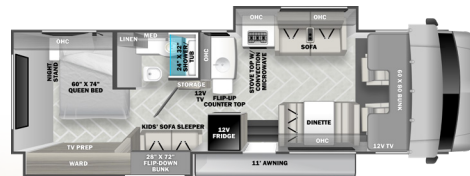

3251DSLE (Available on Ford E450)



**SAPPHIRE Full Body Paint**



**SCARLET Full body paint**



Scan here for  
available specs

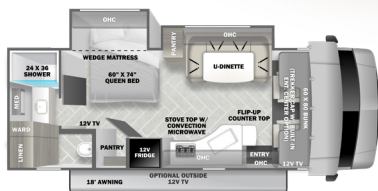

2441DS (Available on Ford E450)

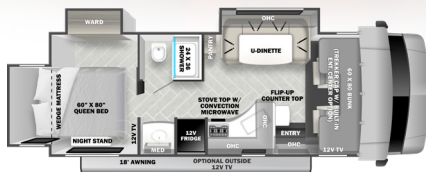

2501TS (Available on Ford E450)

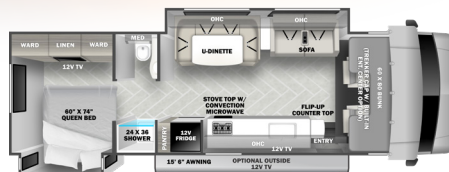

3011DS (Available on Ford E450)

## OPTION



12V POWER  
THEATER SEATING



2861DS (Available on Ford E450)

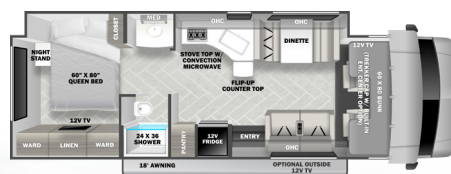

3051S (Available on Ford E450)



**ADMIRAL Full body paint**  
(also available on Transit)



**GRANITE Full body paint**  
(also available on Transit)

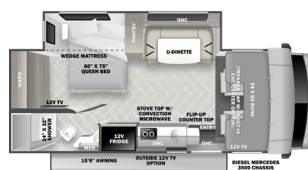

2401B (Available on Sprinter 3500)

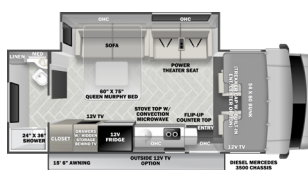

2401T (Available on Sprinter 3500)



Scan here for  
available specs



Mercedes-Benz



Scan here for  
available specs

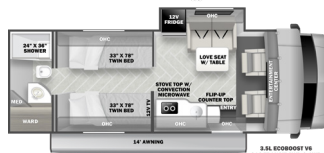

TS2371 (Ford EcoBoost 3.5L gas engine)

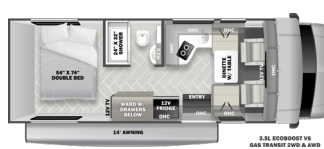

TS2381 (Ford EcoBoost 3.5L gas engine)



2031RP (Dodge ProMaster 3.6L V6 AWD)



ALL-WHEEL  
DRIVE  
STANDARD

# STANDARD FEATURES & OPTIONS

O: OPTION • S: STANDARD • -: NOTAPPLICABLE

WARRANTY	LE	CL	MBS	TS
12 Months/12,000 mile basic limited warranty	S	S	S	S
Chassis warranty (see owners manual)				
SYSTEMS	LE	CL	MBS	TS
Battery disconnect	S	S	S	S
Water heater bypass	S	S	S	S
(2) Deep cycle coach batteries	O	S	S	-
(1) Deep cycle coach battery	S	-	-	S
LED lighting	S	S	S	S
Easy Access battery in step-well	S	S	S	S
30 Amp service with power cord	S	S	S	S
60 Amp Progressive Dynamics converter	S	S	S	S
6 Gallon DSI gas/electric water heater	S	S	S	-
30,000 BTU furnace	S	S	S	-
Truma Combi water heater/furnace	-	-	-	S
Emergency start switch	S	S	-	S
Satellite/cable connection	S	S	S	S
13,500 BTU ceiling ducted high efficiency roof air with heat pump	-	-	-	S
15,000 BTU ceiling ducted, ultra quiet roof air with heat pump (N/A w/dual AC option)	S	S	S	-
4.5 KW Gas generator (Ford/Chevy only)	S	S	-	-
3.6 KW LP generator (Mercedes only)	-	-	S	-
2.8 KW Gas generator (Only available on gasoline model)	-	-	-	S
EZ Ryde upgraded suspension system (Ford only)	-	S	-	-
Heated, enclosed holding tanks and valves (N/A 2251SLE, 2551DSLE)	S	S	-	-
Arctic Package (12V tank heaters)	S	S	S	S
Optional dual A/C with heat pump with power shedding system (Most models)	-	O	-	-
CO, LP and smoke detector	S	S	S	S
Winegard Air 360+ digital antenna	S	S	S	S
Gateway 4G WiFi capability	-	S	S	S
Side-mounted solar prep connection (N/A with roof-mounted solar)	S	S	S	S
190 Watt roof-mounted solar powered 12V charging system (IPO side-mounted charger prep)	O	O	O	O
EXTERIOR	LE	CL	MBS	TS
2" Aluminum framed laminated sidewalls	S	S	-	-
1.5" Aluminum framed laminated sidewalls	-	-	S	S
Superlite composite substrate	S	S	S	S
Gel Coat exterior fiberglass	S	S	S	S
Block foam insulation	S	S	S	S
Power patio awning with LED light strip	S	S	S	S
Slide-out awnings	S	S	S	S
Fiberglass roof	S	S	S	S
One-piece fiberglass front cap	S	S	S	S
Roto-cast storage compartments	S	S	S	S
Driver side security light	-	S	S	-
Fiberglass running boards (Standard on Full Paint Classics)	-	O	S	S
Aluminum running boards	S	S	-	-
Tinted sliding windows	S	S	-	-
Tinted frameless windows	-	-	S	S

EXTERIOR	LE	CL	MBS	TS
Heated, remote exterior mirrors	-	S	S	S
7,500 Lbs. hitch, 7-pin connector (E450)	S	S	-	-
5,000 Lbs. hitch, 7-pin connector (Chevy/E350)	S	S	-	-
4,200 Lbs. hitch, 7-pin connector	-	-	S	-
Spare tire	-	S	-	S
Integrated entry step	S	S	-	S
Power entry step	-	-	S	-
Automatic leveling system (4-point) (N/A on Chevy)	O	O	O	-
Stabilizer jacks (2-point)	-	-	S	-
LP quick connect	S	S	S	S
Full body paint	-	O	O	O
Outside shower	-	S	S	S
Outside 12V LED TV (See floorplans)	-	O	O	-
Black tank flush	S	S	S	S
On-The-Go™ Ladder Bracket (most models)	S	S	S	S
CAB AREA	LE	CL	MBS	TS
10" Touch screen CarPlay/Android radio with USB and Bluetooth	-	S	S	S
Power windows and door locks	S	S	S	S
Keyless entry (N/A Chevy)	S	S	S	S
Backup camera/side view cameras with 3-way monitor	S	S	S	S
Swivel driver seat (Ford only)	-	O	-	S
Swivel passenger seat (Ford only)	-	O	-	S
Ultra leather driver and passenger seats (N/A Chevy)	-	S	-	-
Power heated leather swivel driver and passenger seats	-	-	S	-
KITCHEN	LE	CL	MBS	TS
Recessed 3-burner range with flush glass cover	S	S	-	-
Recessed 2-burner range with flush glass cover	-	-	S	S
1.3 Cu. ft. convection microwave (Transit - .9 cu. ft.)	S	S	S	S
10.7 Cu. ft. 12V refrigerator	S	S	S	-
5.3 Cu. ft. lightweight LP/Electric 110V refrigerator	-	-	-	S
Soft touch self-closing drawer guides	S	S	S	S
Cordless 12V charging plate	S	S	S	S
BATHROOM	LE	CL	MBS	TS
Electric roof fan	S	S	S	S
Oxygen-infused shower head with flexible extension	S	S	S	S
Motion sensor light	-	S	S	S
Shower skylight	S	S	S	S
BEDROOM	LE	CL	MBS	TS
Black-out roller shades	S	S	S	S
12V Bedroom TV	-	S	S	S
LIVING ROOM	LE	CL	MBS	TS
Convertible dinette for additional sleeping capacity	S	S	S	-
Theater seats (Standard on 2400T MBS)	-	O	O	-
Black out roller shades	S	S	S	S
12V LED flat panel adjustable side TV	S	S	S	S
Child seat head tethers in dinette	S	S	S	-
Maxx Air multi-speed power fan with cover	S	S	S	S
12V USB charging station	-	S	S	S

## POPULAR FEATURES

- Fiberglass laminated roof
- Enclosed underbelly (N/A MBS, Transit, 2251SLE, 2551DSLE)
- Winegard 360 plus antenna with Gateway WIFI capability
- 15K AC with heat pump (Some models offer Dual AC option)
- 10.7 Cu. Ft. 12V refrigerator
- Optional 12V dual solar charging system (Chassis and house batteries)

**FORESTER**  
BY FOREST RIVER

Visit: [www.forestriverinc.com/forester](http://www.forestriverinc.com/forester)  
914 CR 1 • Elkhart, IN 46514  
574.262.2212 • 800.445.2825



Learn More  
Scan this barcode using  
a QR Reader on your  
smart phone to learn  
more about Forest River.



All information contained in this brochure is believed to be accurate at the time of publication. However, during the model year, it may be necessary to make revisions and Forest River, Inc., reserves the right to make all such changes without notice, including prices, colors, materials, equipment and specifications as well as the addition of new models and the discontinuance of models shown in this brochure. Therefore, please consult with your Forest River dealer and confirm the existence of any materials, design or specifications that are material to your purchase decision. ©2023 Forester - a Division of Forest River, Inc. - a Berkshire Hathaway Company 9/23

