

MODEL Z 3610

Standard Run MSRP \$138,268

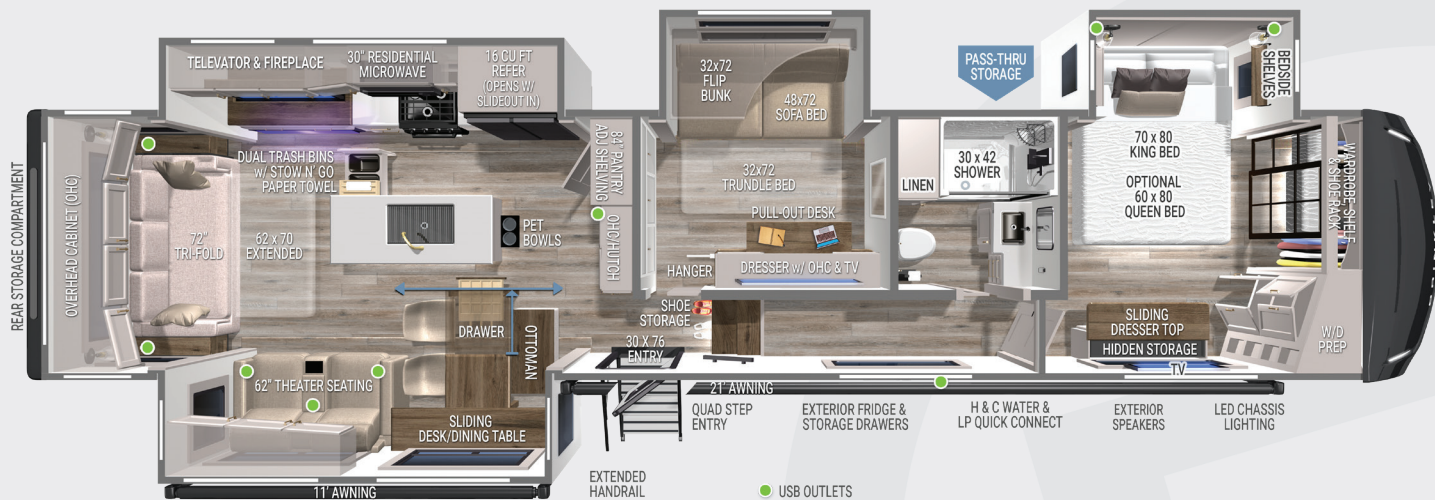

SPECIFICATIONS:

- UVW – 14,859
- GVWR – 17,695
- Hitch Weight – 2,591
- Exterior Length – 41' 9"
- Overall Height w/ AC – 13' 4"
- Width – 96"
- Bath & Bedroom Height - 79 ½"
- Slide Height - 76"
- Axles – Tandem 8,000 lbs.
- Wheels & Tires – 17.5" H-Rated (16 ply)
- Fresh Water Capacity – 75 gal
- Gray Water Capacity – 90 gal (True)
- Black Water Capacity – 45 gal
- Insulation – Floors/Ceiling R40, Walls R11

FEATURES:

- Sliding Desk/Dining Table w/ Extending Leaves & Storage Drawer (Seats up to 4)
- Pet Feeder w/ Removable Pet Bowls
- Kitchen & Living Room/Dining Room Flush Floor Slides
- 84" Pantry w/ Adjustable Shelves & Appliance Outlet
- Brinkley CraftSense™ Wood Trim Construction
- Premium Residential Cabinets & Drawers w/ Dovetail Joints
- Residential End Tables w/ Flip-Up Charging & Storage
- Bedside Shelves & Outlets w/ USB & USB-C
- Hidden Sliding Dresser Top Storage Compartment
- 24+ outlets and 6 outlets w/ USB & USB-C
- Square Euro Frameless Windows w/ 6" Openings (Dual Pane Optional)
- Integrated Window Screens & Insulated Blackout Blinds (No Valances)
- Industry First Brass Plumbing Connections
- Automotive Grade Front Cap, Lights, & Lens
- Basement Utility Access w/ Motion Lights
- 2 - Hot/Cold Outdoor Showers (BOTH sides of coach)
- Large Exterior Storage Compartments w/ Tough Ply Liner
- Rear Storage Compartment (48"x40"x15")
- Built-in Wire Conduit from Roof to Basement
- Industry First Low Maintenance Roof
- Rockford Stereo w/ App Control + Subwoofer Prep
- CURT Helux™ King Pin w/ Coil Spring & Shock-Absorber
- CURT Touring Coil Suspension System w/ ABS Brakes
- Electric Waste Valves w/ Indicator Light & Manual-Override
- Wide Stance 6-Point Hydraulic Leveling Jacks & Oversized Front Storage
- 370W Solar Panel w/ 50AMP MPPT Controller (Inverter Prep & Lithium Ready)

- 13.5k Front AC & 13.5k Bonus Room AC w/ Heat Pumps + Furrion 18k Chill® Cube Rear AC
- Exterior Refrigerator & Storage Drawers w/ Work Surface

Bonus Room Highlights:

- Sofa Bed (48"x72")
- Trundle Bed (32"x72")
- Overhead Flip Bunk (32"x72")
- Dresser w/ 50" Smart TV & Pull-Out Desk (27"x41.5")

FACTORY OPTIONS:

- Queen Bed w/ Nightstands \$428
- Dual Pane Windows \$1,731
- 72" Trifold Sofa (62"x70" Sleeper w/ Reclining Back) \$428
- Gen-Y® Executive Gooseneck w/ SnapLatch Torsion Flex \$1,876

Optional equipment & props may be shown.
All content is subject to change without notice.
Please consult with your dealer for current information.



For More Information, Photos, Videos
& Why Brinkley go to **BrinkleyRV.com**



081525