



TRAVEL TRAILERS & FIFTH WHEELS

# MEMORIES: UNCHARTED



**Highland**  
RIDGE RV

Own the Outdoors





# TRAVEL TRAILERS



OT310BHS



OT323RLS



OT324RES



OT328BHS



OF313RKS



OF314RLS



OF337RLS



OF370RBS



OF371MBH



OF373RBS



OF374BHS



OF375RDS



OF376FBH



OF384RLS

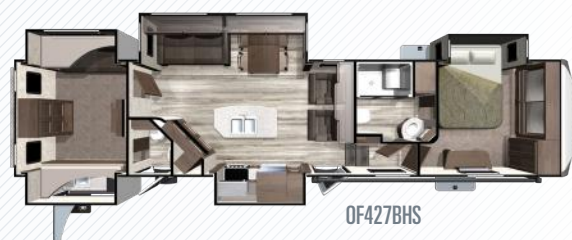

OF427BHS

# FIFTH WHEELS

## FLOORPLANS

## FEATURES

## STANDARDS

## OPTIONS

- » 100" Wide Body Frame
- » 76" x 27" Entrance & Screen Door
- » ACCU-SLIDE Slide System (42" Deep with 4-Corner Compression)
- » 15k Quiet Residential Return Air A/C
- » Nitrogen Filled Tires with Aluminum Rims
- » Frameless Windows
- » Aluminum Tread Entry Steps
- » No Carpet in Kitchen and Most Living Areas
- » Patent Flush Floor Slides with Vinyl Flooring (No Carpet)
- » PVC Roofing Membrane (15 Year Warranty/ Non-Prorated)
- » Power Awning with LED Light & FLX Guard
- » Heat & Massage Theatre Seats
- » Observation Camera Prep
- » Solar Prep
- » Pet Friendly
- » Key Alike System
- » Wall Controlled Power Vent (Kitchen)
- » Front & Rear Stabilizers
- » Washer/Dryer Prep
- » 100lb. Ball Bearing Drawer Guides
- » Ladder
- » Battery Disconnect
- » 84" Slide-Out Height (FW)
- » Night Roller Shades
- » Oven with Flush Glass Stove Top
- » 4 and 6 Point Auto Leveling with JT Strong Arm Stabilizers (FW)
- » French Door to Bedroom
- » Motion Sensor Light in Bedroom & Hallway
- » LED Lighting in Ceiling
- » Fiberglass Front Cap with LED Lights
- » 13.5k BTU Ducted A/C (Master Bedroom)
- » BBQ Grill
- » Dual Pane Windows
- » Extreme Arctic Package
- » Fan - Wall Control Power Vent in Kitchen, Living Room (370, 376)
- » Fireplace - Wall Mount (310, 328)
- » King Bed ipo Std Queen Bed (N/A 376, 310)
- » Observation Camera
- » Power Front & Rear Stabilizer Jacks (TT)
- » Rear Storage Tray (TT)
- » Generator Prep - LP (FW ONLY)
- » 18cu.-ft. RV Gas/Electric Refrigerator (N/A 310, 323, 324, 337), Residential 18cu. ipo 8cu (337, 310, 323, 324), - Residential 23cu. ipo 8cu (N/A 337,310, 323, 324)
- » TV - Bunk Room (371), Outside Kitchen (310, 328, 374)
- » U-Lounge ipo Std. Theater Seats/Table (310, 328, 374, 376)
- » Slide-Out Awning Covers

## SPECIFICATIONS

	OT310BHS	OT323RLS	OT324RES	OT328BHS	OF313RKS	OF314RLS	OF337RLS	OF370RBS	OF371MBH	OF373RBS	OF374BHS	OF375RDS	OF376FBH	OF384RLS	OF427BHS
Square Feet	367	366	366	367	378	376	350	429	430	429	425	413	429	430	430
UVW	9265	8815	9320	9860	10625	10685	10010	12145	12505	12665	12300	12434	12015	12100	12800
Hitch Weight	1227	1081	1117	1280	1900	2130	2375	2640	2515	2680	2520	2680	2785	2545	2290
GVWR	11500	11435	11480	11300	13900	14130	14375	16470	16470	16680	16470	16680	16460	16545	16290
Cargo (Gross)	2235	2620	2160	1440	3275	3445	4365	4325	3965	4015	4170	4246	4445	4445	3490
Length (Pin to Rear)	37' 3"	37' 8"	37' 8"	37'11"	36'	35'10"	34'	41' 6"	41' 4"	41' 6"	40' 6"	42' 9"	41' 11"	39' 10"	39' 6"
Ext. Height	140"	140"	140"	140"	155"	155"	155"	155"	155"	155"	155"	155"	155"	155"	155"
Ext. Width	100"	100"	100"	100"	100"	100"	100"	100"	100"	100"	100"	100"	100"	102"	100"
Ext. Width (Slides Out)	165"	165"	165"	165"	165"	165"	179"	165"	165"	165"	155"	165"	165"	169"	165"
Interior Height (Overall)	84"	84"	84"	84"	98"	98"	98"	98"	98"	98"	98"	98"	98"	100"	100"
Interior Height (Upper Deck)	-	-	-	-	77"	76"	76"	76"	76"	77"	76"	77"	76"	77"	78"
Fresh Water (Gal.)	50	50	50	50	85	85	85	85	85	85	85	85	85	85	85
Gray Water (Gal.)	62	114	114	82	82	57	57	82	114	82	98	82	98	82	82
Waste Water (Gal.)	31	31	31	82	41	41	41	41	41	82	82	41	82	41	82
LP Capacity (lbs.)	60	60	60	60	60	60	60	60	60	60	60	60	60	60	60
Tire Size	16"	16"	16"	16"	16"	16"	16"	16"	16"	16"	16"	16"	16"	16"	16"
Awning Size	19'	15'	15'	11', 9'	16', 11'	16'	16'	18', 12'	19'	14', 16'	16', 11'	20'	19'	19'	16', 12'

## 1 SLIDE OUTS

- » Best in class slide height and depth
- » Flush floor slides with linoleum
- » Accu-Slide cable system with four points of compression
- » Laminate components plus 3M flashing tape along corners to prevent leaks

## 2 DOORS & LOCKS

- » Oversize entrance door with large window, built-in screen doors, and integrated window shades
- » Double-insulated passage and storage doors with slam latches on secure and convenient key-alike system

## 3 ROOF

- » Double batten insulation layered with radiant foil
- » Screw-mounted plywood decking topped with premium quality PVC
- » No treatment required! Will not chalk or spot
- » Heat reflecting properties keep coach cooler in the summer

## 4 FLOORS

- » Double-welded framed floors
- » Insulated with rigid foam wrapped in radiant foil, anti-puncture moisture barrier woven underbelly material, and strengthened with an overlapping double layer of laminate

## 5 SIDEWALLS

- » Lightweight, double-welded aluminum walls
- » Slide roof frames laminated with rigid foam insulation

## 6 MAIN BODY

- » Built with 8" & 10" steel I-beams
- » 6,000 & 7,000 lb. axles
- » Aluminum wheels with nitrogen-filled tires

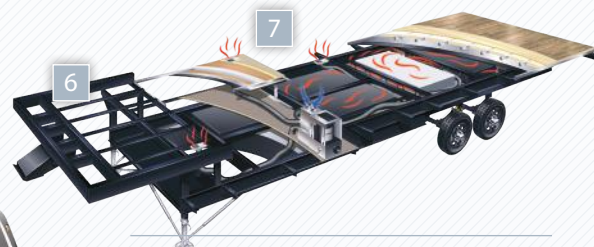
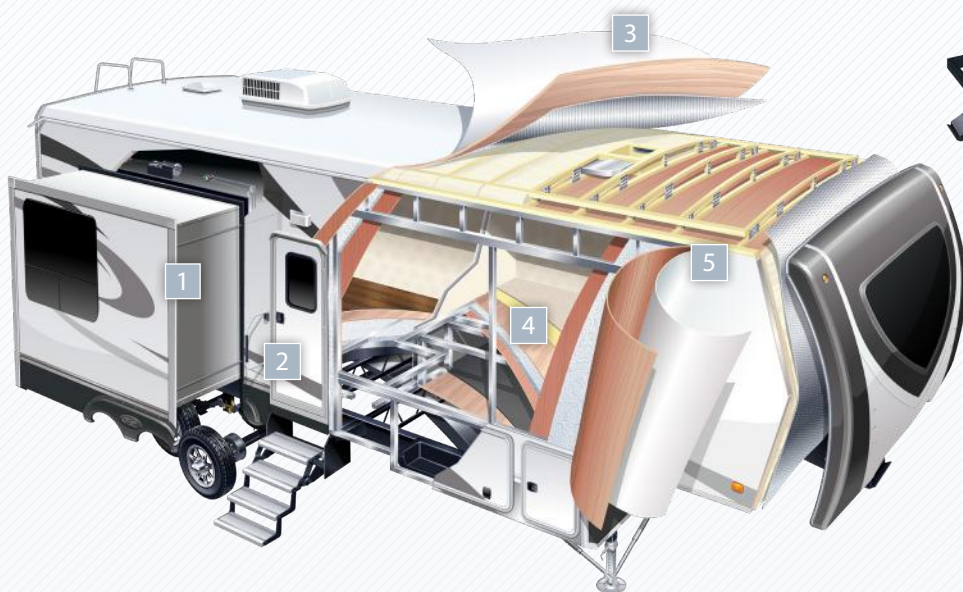

## 7 INDUSTRY-LEADING HEATING SYSTEM

Oversize 4-inch heat ducts run from the furnace down to the fully enclosed underbelly and wrap around the tanks suspended between the chassis I-beams. Holding tanks are warmed by the forced air heat which prevents freeze-ups.

A return at the end of the tank connecting back into the coach provides the necessary air flow.



We stand behind our products. At Highland Ridge RV, we are one of the few manufacturers that have a 3-Year Limited Structural Warranty.

MORE ROOM  
LESS WEIGHT

This is our mission at Highland Ridge RV. It drives us to innovate and revolutionize the RV industry and it's why our products are 10 - 15% lighter than the competition.



Our Pet Friendly units offer linoleum throughout the main living areas, and no floor registers.

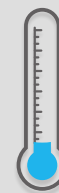

ZERO DEGREE  
TESTED

We put our products into a zero degree chamber for five hours with thermometers placed in key areas throughout the unit. The results speak for themselves.

Your Open Range Dealer:

Colton RV & Marine  
3122 Niagara Falls Blvd  
North Tonawanda, NY 14120  
(716) 694-0188  
[www.ColtonRV.com](http://www.ColtonRV.com)

Colton RV & Marine  
3443 Southwestern Blvd.  
Orchard Park, NY 14127  
(716) 957-3250  
[www.Coltonrv.com](http://www.Coltonrv.com)



**Highland**  
RIDGE RV

*Own the Outdoors*

For more information visit us at:  
**[www.HighlandRidgeRV.com](http://www.HighlandRidgeRV.com)**

Due to continual research and advances, manufacturer reserves the right to change specifications, design, price, and equipment without notice, and assumes no responsibility for any error in the literature. Some items shown are not included as standard or optional equipment.