

PRE-PRODUCTION PREVIEW

MODEL Z 2810

Colton RV & Marine
3122 Niagara Falls Blvd
North Tonawanda, NY 14120
(716) 694-0188
www.ColtonRV.com

Colton RV & Marine
3443 Southwestern Blvd.
Orchard Park, NY 14127
(716) 957-3250
www.Coltonrv.com

AVAILABLE STARTING IN JUNE
Standard Run MSRP \$108,658

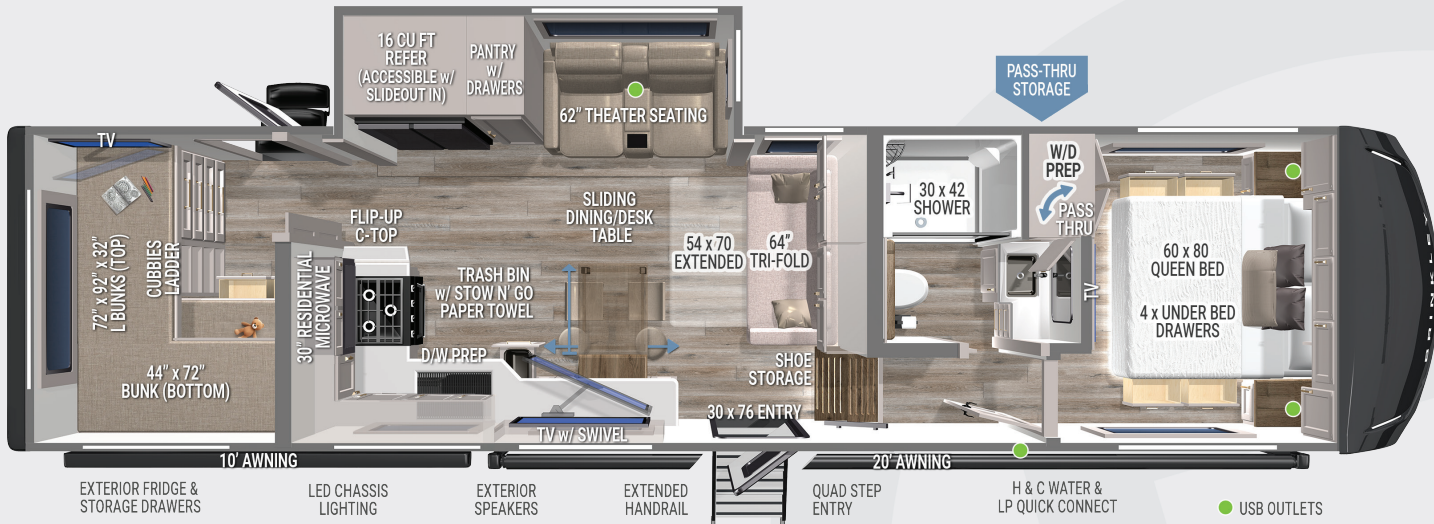

SPECIFICATIONS:

- UVW – 11,894 lbs.
- GVWR – 14,995 lbs.
- Hitch Weight – 1,998 lbs.
- Exterior Length – 34' 9"
- Overall Height w/ AC – 13' 3"
- Width – 96"
- Bath & Bedroom Height - 79 ½"
- Slide Height - 76"
- Axles – Tandem 7,000 lbs.
- Wheels & Tires – 17.5" H-Rated
- Fresh Water Capacity – 75 gal
- Gray Water Capacity – 80 True + 40 gal
- Black Water Capacity – 40 gal
- Insulation – Floors/Ceiling R40, Walls R11

FEATURES:

- Private Bunkroom w/ Large Bottom Bunk, Extra Large L Shaped Top Bunk, & Storage Drawers
- 64" Trifold Sofa (54"x70" Sleeper)
- Sliding Desk/Dining Table w/ Storage Drawer
- 50" Articulating TV
- Rockford Stereo w/ App Control + Subwoofer Prep
- Solid Surface Countertops
- Dishwasher Prep
- Brinkley CraftSense™ Wood Trim Construction
- Premium Residential Cabinets & Drawers w/ Dovetail Joints
- Kitchen & Living Room Flush Floor Main Slide
- Road Mode: Access to Fridge, Bedroom, Bunks & Bathroom w/ Slide In
- 13.5k Front AC
- Furrion 18k Chill® Cube Rear AC
- Large Pantry w/ Pull-Out Drawers
- One-Piece Fiberglass Shower
- Washer/Dryer Prep (Stackable or Combo)
- Residential Queen Memory Foam Mattress w/ Nightstands, Outlets & USB & USB-C
- Square Euro Frameless Windows w/ 6" Openings
- Integrated Window Screens & Insulated Blackout Blinds
- Brinkley Automotive-Grade Sealant Package
- Automotive-Grade Front Cap, Lights, & Lens
- Sleek Styling w/ Automotive-Grade Exterior Graphics
- 2 - Hot/Cold Outdoor Showers (BOTH Sides of Coach)
- Tankless On-Demand Water Heater
- Heated Enclosed Underbelly (Circulated)
- Below I-Beam Storage Compartments
- Exterior Refrigerator & Storage Drawers w/ Work Surface
- One-Touch Automatic 4-Point Leveling System
- On-Command™ Utility Center w/ Retractable 65' Water Hose
- Heated Tanks w/ Electric Waste Valves w/ Manual-Override
- CURT Touring Coil Suspension System w/ ABS Brakes + Anti-Sway + Dynamic Brake Boosters
- CURT Helux™ King Pin w/ Coil Spring & Shock-Absorber
- 370W Solar Panel w/ 60AMP MPPT Controller (Inverter Prep & Lithium Ready)

FACTORY OPTIONS:

- Dual Pane Windows \$1,731
- Gen-Y® Executive Gooseneck w/ SnapLatch Torsion Flex \$1,876

061025

Optional equipment & props may be shown.
All content is subject to change without notice.
Please consult with your dealer for current information.



For More Information, Photos, Videos
& Why Brinkley go to **BrinkleyRV.com**

