

FIFTH WHEELS



THE INTELLIGENT FIFTH WHEEL . . .



www.primetimerv.com

Sanibel

by PRIME TIME Mfg.

. . . THE INTELLIGENT CHOICE



Sanibel

North America's
Favorite RV Company!

Sanibel

by PRIME TIME Mfg.



INTELLIGENT.

» **in-tel-li-gent**, *adj. smart; clever; sensible or rational; showing or resulting from an ability to think and understand things clearly and logically.*

Prime Time Manufacturing is proud to offer Sanibel — a luxury fifth wheel built to stand unequivocally on its own with a level of intelligence that far exceeds the status quo. Our objective for Sanibel is simple: to outperform by every measure and to invoke an experience that anticipates and satisfies your every need with thoughtful and intelligent design. From its well-designed, spacious interior, to its modern amenities and extra creature comforts, the Sanibel is your home away from home.

Within minutes of entering, Sanibel transforms you. The interior is crafted around comfort, sight, and convenience. Modern cabinetry, residential appointments, and rich textures create a sophisticated space of warmth and elegance. Fabrics are specially treated to provide the softest touch and breathability for comfort in heat or cold. Every element of Sanibel will create a personal connection with the user that focuses on enjoyment and satisfaction.





LIVING ROOM.

The Intelligent Lighting Package

When choosing lighting for Sanibel, we took the same uncompromising approach to intelligent design. For instance, the “Stay Cool” LED lights found at the critical seating areas offer both a stunning presence and smarter thinking. Along with lower energy consumption and longer life, the LEDs emit significantly less heat, helping to maximize your comfort both day and night.





The Intelligent Kitchen!

The Intelligent Kitchen is symbolic of the genius behind Sanibel's inspiration. Work spaces and storage areas have been carefully designed and positioned for instinctive reach and use. Premium components have been selected for long term durability. An advanced appliance package will indulge your residential desires while brilliant cabinet doors and drawers made from Native American Cherry Wood will welcome you with handsome looks. The Intelligent Kitchen, like each and every detail of the Sanibel, has been examined and questioned to ultimately provide a single result — the highest level of owner satisfaction.

BEDROOM.



All bedrooms are NOT created equal. LED lights, "Quiet Cool" ducted air conditioning, and extra storage details, make the Sanibel bedroom an Intelligent choice.

The Intelligent Bedroom!

The expansive interior of the Sanibel was astutely designed to adapt its volume to your needs. A quick examination under the king size bed will expose a massive storage area that is up to 300% larger. Shoe storage in the wardrobe, six large vanity drawers, and multiple overhead cabinets are additional examples of intelligent space utilization. However, the creation of space was also a priority with Sanibel. That's why you will find extra "convenience inches" in the bed slide and large "hidden" drawers recessed into the front wall. Our designers even added radius corners to the Denver Mattress® to assist in traffic flow.



CONSTRUCTION.

Intelligent Construction

Roof Construction (R-52)*

1. Dual Attic Vents
2. Heavy Duty TPO Roof with 12 Year Warranty
3. Walk-on Roof with 3/8" Decking
4. Radiant Shield Technology (R-38)
5. Two Layers of Fiberglass Insulation (R-14)
6. 5" Snow Load Approved Rafters on 16" Centers
7. 1/8" Plywood
8. Stain Resistant Vinyl Ceiling

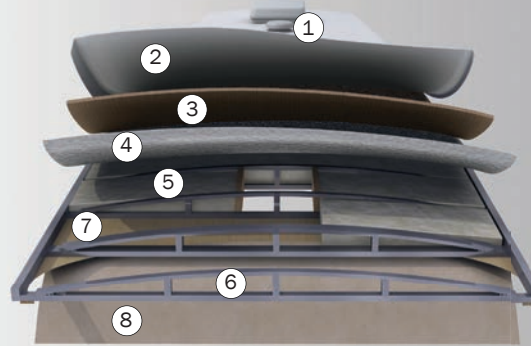

Attic Vent

Intelligently designed and placed, two Attic Vents are installed on your roof helping to eliminate condensation and moisture.

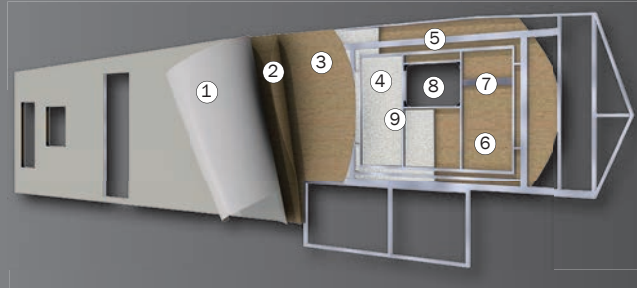

Sidewall Construction (R-14)

- » 1. "Dura Gloss" Gel Coated Fiberglass
- » 2. First Layer of 1/8" Plywood
- » 3. Second Layer of 1/8" Plywood
- » 4. Hi Density EPS Foam
- » 5. Heavy Gauge Aluminum Framing
- » 6. Interior Layer of 1/8" Plywood Decor Board
- » 7. Strategically Placed Sheet Metal Backing Strips
- » 8. Aluminum Framed Window, Door, and Baggage Cut-Outs
- » 9. Radius Corner Blocks

Floor Construction (R-52)*

1. 12" I Beam Powder Coated Frame (Most Models)
2. Enclosed Underbelly
3. Floor Vapor and Moisture Barrier Wrap
4. Radiant Shield Technology (R-38)
5. 1/8" Plywood
6. 3" Heavy Gauge Aluminum Floor Joists
7. 3" Hi-Density EPS Foam (R-14)
8. 1/8" Plywood
9. 5/8" One-Piece Floor Decking
10. Residential Grade Carpet Pad
11. Deep Pile Residential Grade Carpeting
12. Enclosed and Heated Galley Water Lines
13. In-Floor Straight Line Heat Ducting

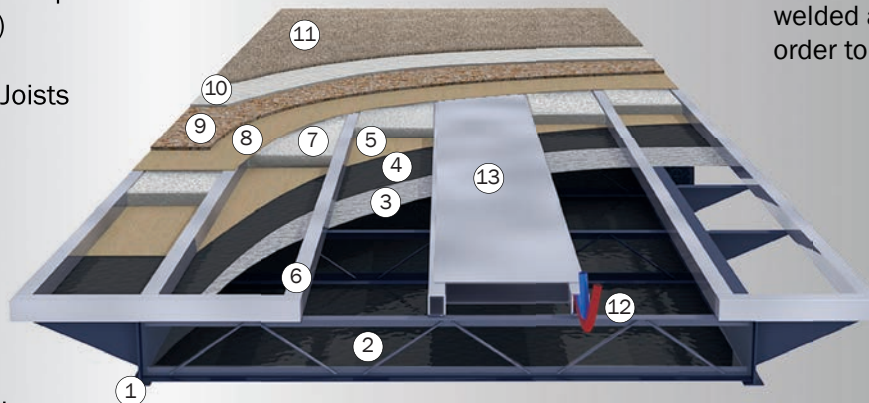

ETERNABOND® Construction

Sanibel is built with Prime Time's ETERNABOND® Construction Technology. Every wall, floor and slide-out roof is made up of welded aluminum framework that is then laminated together in order to build a stronger, longer lasting Recreational Vehicle!



* R-Values calculated at 80° Ambient Temperature

HEATING & COOLING.

Intelligent Thermal Package

- Tested at -13 Degrees
- Heated, Enclosed Water Lines
- Enclosed Underbelly
- Heated Holding Tanks
- 12 Volt Holding Tank Heat Pads
- Radiant Shield Technology Wrapped Holding Tanks (R-38)
- Double Layer of Fiberglass Insulation In Roof (R-14)
- Radiant Shield Technology In Roof (R-38)
- 3" Hi-Density EPS Foam in Main Floor (R-14)
- Radiant Shield Technology Under Main Floor (R-38)
- Double Layer of Fiberglass Insulation In End Walls (R-14)
- Radiant Shield Technology In End Walls (R-38)
- Insulated Slide Room Floors (R-38)
- Insulated Bath and Bed Deck Floors (R-38)
- Heated Pass Thru Storage
- Heated Universal Docking Center
- Dual Zone "Quiet Cool" Air Conditioners
- Dual Attic Vents
- 40,000 BTU Furnace



Sanibel extends intelligent design to all parts of the fifth wheel including how the holding tanks are heated. Each tank is equipped with oversized ① 12 Volt heating pads for direct heat application. Every tank is then wrapped with ② Radiant Shield Technology (R-38) to help spread the heat over the tank surface while protecting it from cold exterior temperatures. This intelligent design ensures that ALL of your holding tanks are adequately protected while also ensuring that ALL of the heat from your furnace stays INSIDE your Sanibel to maximize your comfort. Unlike forced air applications, customers also appreciate that you can activate the heat pads during transit for additional protection.

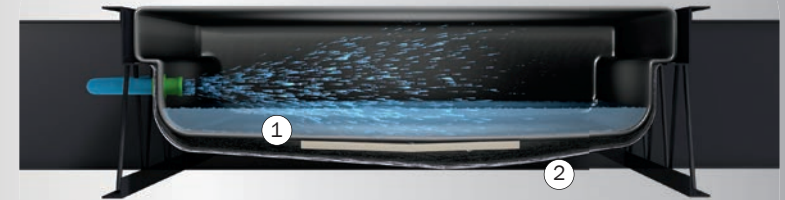

SUSPENSION.

Intelligent Suspension

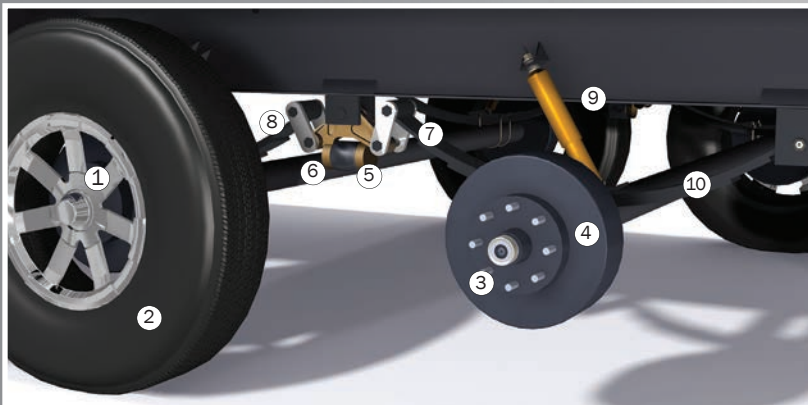

1. 16" Aluminum Wheels
2. Upgraded Radial Tires
3. "E-Z LUBE" Axle Hubs
4. Heavy Duty 8-Lug Hub Face
5. "E-Z FLEX" Rubberized Suspension
6. Eight Point "Wet" Bolt Assembly
7. Heavy Duty Brass Bushing Assembly
8. Heavy Duty 1/2" Shackle Plates
9. Heavy Duty Gas Shocks (4)
10. Heavy Duty 7,000 lb. Axles

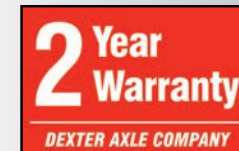

NEW.

Sanibel's design team is constantly looking for ways to improve upon the success of North America's favorite luxury fifth wheel. The all-new Sanibel 3800 and 3801 with residential refrigerator are perfect examples of these efforts. This innovative floorplan utilizes every available inch of the interior to maximize comfort, livability, and storage. You might find yourself thinking, "this is the best floorplan I've ever seen!"



SPECIFICATIONS	3250	3251	3550	3551	3600	3601	3700	3701	3800	3801	3900	3901
LENGTH	38' 4"	38' 4"	39' 2"	39' 7"	40' 2"	40' 2"	42' 2"	42' 2"	42' 2"	42' 2"	41' 10"	41' 10"
HEIGHT	13' 4"	13' 4"	13' 4"	13' 4"	13' 4"	13' 4"	13' 4"	13' 4"	13' 4"	13' 4"	13' 4"	13' 4"
HITCH WEIGHT	2,472 lb.	2,522 lb.	2,370 lb.	2,498 lb.	2,335 lb.	2,396 lb.	2,171 lb.	2,311 lb.	2,375 lb.	2,375 lb.	2,541 lb.	2,649 lb.
UNLOADED VEHICLE WEIGHT (UVW)	12,461 lb.	12,977 lb.	12,319 lb.	13,053 lb.	126,40 lb.	12,651 lb.	12,806 lb.	13,187 lb.	13,640 lb.	13,640 lb.	13,165 lb.	13,979 lb.
CARGO CARRYING CAPACITY (CCC)	2,980 lb.	2,523 lb.	3,122 lb.	2,447 lb.	2,801 lb.	2,790 lb.	2,986 lb.	2,254 lb.	1,860 lb.	1,860 lb.	2,276 lb.	1,462 lb.

UVW (Unloaded Vehicle Weight)* is the typical weight of the unit as manufactured at the factory. It includes all weight at the unit's axle(s) and tongue or pin and LP Gas. The UVW does not include cargo, fresh potable water, additional optional equipment or dealer installed accessories. *Estimated Average based on standard build optional equipment.

CCC (Cargo Carrying Capacity)** is the amount of weight available for fresh potable water, cargo, additional optional equipment and accessories. CCC is equal to GVWR minus UVW. Available CCC should accommodate fresh potable water (8.3 lbs per gallon). Before filling the fresh water tank, empty the black and gray tanks to provide for more cargo capacity. ** Estimated average based on standard build optional equipment.

See back page for additional specification definitions.

SANIBEL - FLOORPLANS

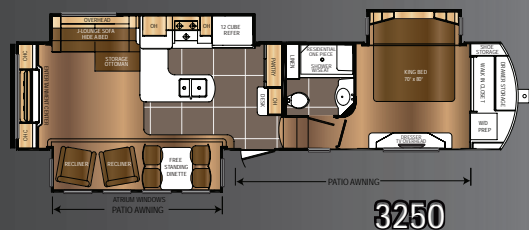

3250

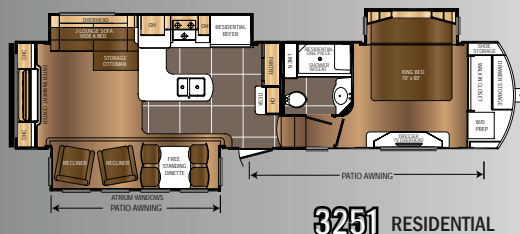

3251 RESIDENTIAL

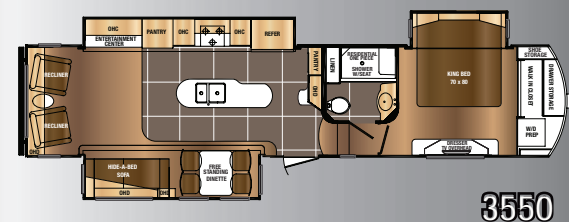

3550

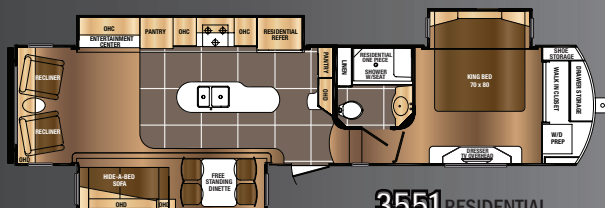

3551 RESIDENTIAL

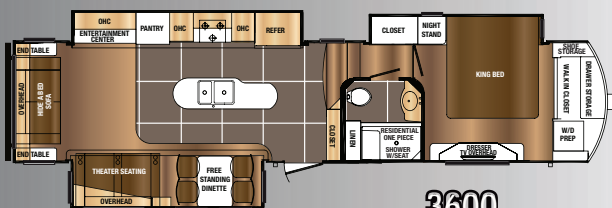

3600



3601 RESIDENTIAL

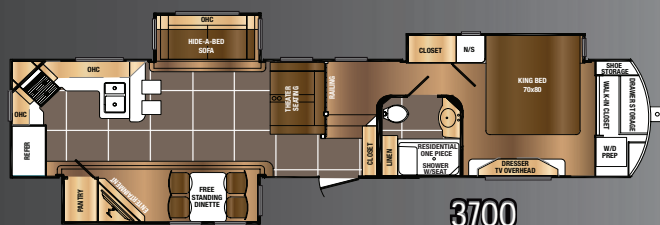

3700

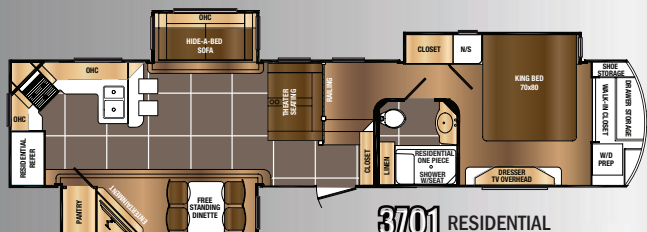

3701 RESIDENTIAL

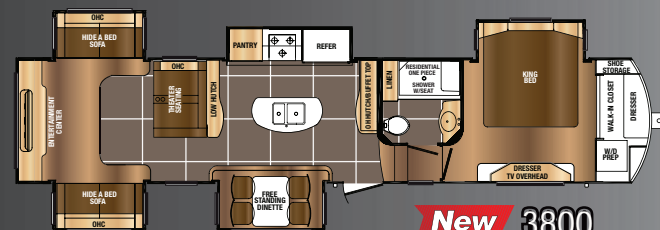

New 3800

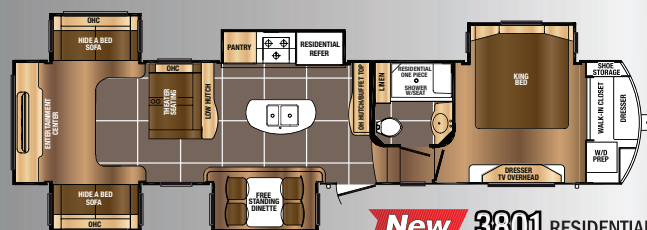

New 3801 RESIDENTIAL

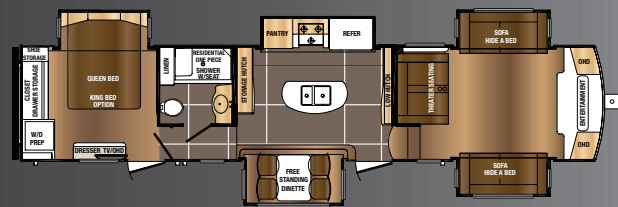

3900

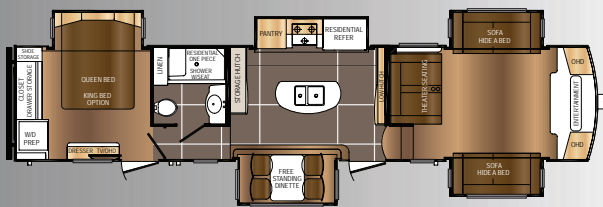

3901 RESIDENTIAL



Sanibel
by PRIME TIME MFG.

PRIME TIME
Manufacturing



SANIBEL - FEATURES

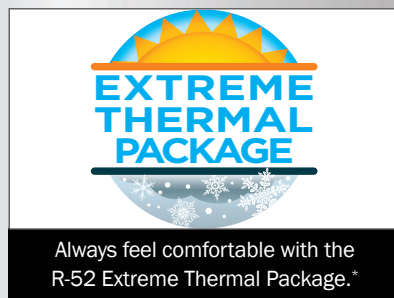
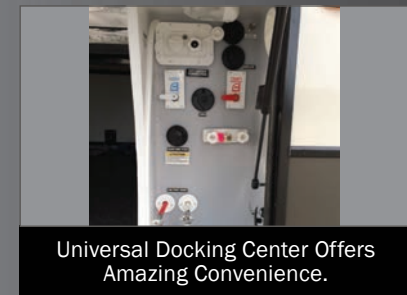
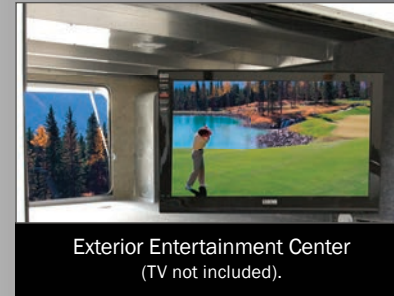

* R-Values calculated at 80° Ambient Temperature

SANIBEL - STANDARDS AND OPTIONS

ADVANTAGE PACKAGE**

- **ETERNABOND® Construction:**
 - 2” Laminated Aluminum Framed Sidewalls
 - 3” Laminated Aluminum Framed Main Floor
 - 5/8” One-Piece Floor Decking
 - Laminated Aluminum Framed Slide Room Walls and Roofs
 - Welded Construction
 - 100% Glue Coverage on All Laminated Parts
 - EGS Backers in Walls and Floors
- **The Intelligent Thermal Package:***
 - Tested at -13 Degrees
 - Heated, Enclosed Water Lines
 - Enclosed Underbelly
 - Heated Holding Tanks
 - 12 Volt Holding Tank Heat Pads
 - Radiant Shield Technology Wrapped Holding Tanks (R-38)*
 - Double Layer of Fiberglass Insulation in Roof (R-14)
 - Radiant Shield Technology In Roof (R-38)*
 - 3” Hi-Density EPS Foam In Main Floor (R-14)
 - Radiant Shield Technology Under Main Floor (R-38)*
 - Double Layer of Fiberglass Insulation in End Walls (R-14)
 - Radiant Shield Technology in End Walls (R-38)*
 - Insulated Slide Room Floors (R-38)*
 - Insulated Bath and Bed Deck Floors (R-38)*
 - Heated Pass Thru Storage
 - Heated Universal Docking Center
- “DURA GLOSS” Fiberglass Sidewalls
- 15,000 BTU Premium Air Conditioner
- “Quiet Cool” Vented Return Air Ducting System
- 2nd A/C In Bedroom - “Quiet Cool” with Dual Zone Temperature Sensors
- 50 AMP (110) Power
- Frameless Windows

• The Intelligent Suspension:

- “E-Z FLEX” Rubberized Suspension
- Heavy Duty Shock Absorbers
- 16” Aluminum Wheels
- 8 Lug Wheels
- Upgraded Radial Tires
- Eight Point Greasable “Wet” Bolts
- Long Lasting Brass Bushings
- Long Lasting 1/2” Shackle Plates
- 7,000 Pound Axles
- “E-Z LUBE” Greasable Axle Hubs

Exterior Entertainment Center That Includes:

- Swing Arm TV Bracket
- Exterior AM/FM/CD Stereo With Speakers
- Coax TV Connection
- 110 V Electrical Outlet

• Universal Docking Center That Includes:

- Outside Shower Flex Hose
- Black Tank Flush
- EZ Winterization Valve And Connection
- Easy Access Low Point Drains
- Low Point Drain Shut-Offs
- City Water Connection
- Battery Disconnect
- Separate Cable And Satellite Connection
- Holding Tank Gate Valve Pull Handles
- Light
- Ducted Heat
- No Mess Drain Tube
- Electric Awning with LED Lights
- Slam Latch Baggage Doors with “Dura Gloss” Finish
- Rear Back-Up Lights (Most Models)
- Native American Glazed Cherry Hardwood Cabinet Doors
- Native American Glazed Cherry Hardwood Drawers
- 12’ SBS Refrigerator
- 20’ CU. FT. Residential Refrigerator (Residential Models Only)
- 30” OTR Microwave
- Deluxe Range with Heavy Grates
- LG Solid Surface Kitchen Countertop
- LG Solid Surface Flush Mount Sink Covers
- Large LED Television
- Residential Hide-A-Bed Sofa
- Residential Recliners (Where Applicable)
- Residential DVD Player With 5.1 Speakers
- LED Bedroom TV
- King Size Luxury Foam Pillowtop Mattress (Most Models)

CONSTRUCTION

- 5” Truss Rafters, 16” On Center
- 3/8” Walk-On Roof Decking
- One-Piece TPO Roof with 12 Year Warranty
- Powder Coated I-Beam Frames
- Drop Frame Storage Oversized Pass Thru Storage with Intelligent Design
- Pass Thru Luggage Tie Downs
- “SUPER TURN” Aerodynamic Fiberglass Front Cap
- Automotive Styled Fiberglass Rear Cap (Most Models)
- Upgraded Oetiker Clamp Ring Water Line Fittings

UTILITIES

- Electric Rear Jacks
- Hydraulic Front Landing Gear
- “SOLID STANCE” Front Jack Legs
- “SOLID STANCE” Oversized Landing Pads
- Convenient Hydraulic Selector Valves
- 40,000 BTU Furnace
- Digital Thermostat

- 10 Gallon Quick Recovery Water Heater
- Direct Spark Ignition On Water Heater
- Water Heater By-Pass
- Hi-Capacity Water Pump
- Detachable Power Cord
- Large 12 Volt Converter
- Washer/Dryer Prep
- Dual 30# LP Bottles
- CO Detector
- LP Detector
- Smoke Detector
- Fire Extinguisher
- Magnetic Baggage Door Catches
- 30” Wide Radius Entrance Door
- Swing-Out Grab Handle
- Hitch Cover
- Digital Ready TV Antenna with Booster
- Dual Vented Attic
- Rear Back-Up Lights (Most Models)
- 2 Scare Lights
- DOT Approved Deep Tint Safety Glass
- Easy Access Fresh Water Drain Valve
- Extra Large PVC Sewer Hose Storage
- Extended Drip Spouts

INTERIOR STANDARDS

- Baltic Birch Residential Drawer Boxes
- **The Intelligent Kitchen:**
 - High Arch Kitchen Faucet with Sprayer
 - Stainless Steel Kitchen Sink with Extra Deep Bowls
 - 13 Gallon Trash Can (Most Models)
 - Pots-N-Pans Drawer
 - Full Extension Drawer Guides
 - Large Easy-To-Pull Cabinet Pull Handles
- Day/Night Shades In Living Area
- Dinette With Leaf And Storage Drawer
- (4) Dinette Chairs With Hidden Storage
- “Atrium” Dinette Windows
- Decorative “Space Saving” Atrium Window Moldings
- Laptop/Cell Phone Charging Station at Dinette

INTELLIGENT LIGHTING

- “Stay Cool” Adjustable LED Reading Lights Above Sofa
- “Stay Cool” Adjustable LED Reading Lights Above Recliners
- “Stay Cool” Adjustable LED Reading Lights Above Bed
- “Stay Cool” LED Ceiling Light Above Sofa
- “Stay Cool” LED Vanity Light In Bath
- Flush Mount LED Ceiling Lights
- Easy-To-Reach Welcome Home Lighting
- Safety Step Lights With Illuminated Switch

BATHROOM STANDARDS

- King Size Showers
- Deluxe “Skyview” Skylight with 6’8” of Headroom
- “STOR MOR” Shower Caddy
- Dual Lever Bath Faucet
- Linen Cabinet
- 12V Power Vent Fan In Bath
- Hi-Rise Porcelain Toilet
- Heated Bathroom

INTELLIGENT BEDROOM

- 30” Deep Bedroom Slide Room (Most Models)
- Massive Under-Bed Storage
- Walk In Closet with Easy Access Light Switch
- Shoe Storage in Closet
- Extra Wide Vanity with Six Large Storage Drawers
- Four Hidden Drawers in Front Cap
- Decorative Bedroom Pillows
- Stackable Washer/Dryer Prep
- Solid Cherry Sliding Wardrobe Doors
- Easy-To-Use Wardrobe Door Travel Locks
- Glass Bedroom Entrance Door
- Cell Phone Charging Station

TANK CAPACITY

- FRESH WATER: 64 Gallons
- GREY WATER: 90 Gallons
- BLACK WATER: 50 Gallons

OPTIONS

- Roto-Flex Pin Box
- Dual Pane Windows
- Slide Out Awnings
- Fireplace
- Generator Prep
- Generator Install - Onan 5.5KW
- Central Vacuum With 30’ Hose
- “LEVEL UP” 6 Point Auto Leveling System
- Champagne High Gloss Fiberglass (Mandatory)
- G-Rated Tires

*R-Values Calculated at 80° Ambient Temperature

**Mandatory 1/1/2016

DSI QUALITY CIRCLE AWARD WINNER - 2010, 2011, 2012, 2013, 2014, 2015

Prime Time Manufacturing is proud to be recognized as an industry leader in value, reliability, and overall quality by the Recreational Vehicle Dealers Association. This was accomplished by committing ourselves to "A Higher Standard" in design, construction, testing, and customer service. Check us out — we know you'll be impressed!



Seal Tech Air Pressure Test



ETERNABOND®
Construction



Rain Bay



Seek-A-Leak Pressure Test



65 Point Secondary PDI



Web Based
Customer Service



Executive Quality Audits



Advanced Engineering

ADDITIONAL SPECIFICATIONS:

GAWR (Gross Axle Weight Rating) is the maximum permissible weight, including cargo, fluids, optional equipment and accessories that can be safely supported by a combination of all axles.

Each Forest River RV is weighed at the manufacturing facility prior to shipping. A label identifying the unloaded vehicle weight of the actual unit and the cargo carrying capacity is applied to every Forest River RV prior to leaving our facilities. The load capacity of your unit is designated by weight, not by volume, so you cannot necessarily use all available space when loading your unit.



www.primetimerv.com
PO Box 330 • 55470 CR 1 • Elkhart, IN 46515

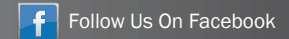

HERE'S JUST A SAMPLE OF THE BENEFITS*

- Mobile Mechanic
- Free Jump Starts
- Tire Changes
- \$2000 Trip Interruption
- Appointment Assistance
- Lock Out Service
- Fuel Delivery
- Service Assistance
- Custom Trip Routing and Maps
- 24 Hour Emergency Messaging

*Exclusions and restrictions apply. See member guide for details.

**FROG™ the Forest
River Owners' Group!**

FREE MEMBERSHIP
to Forest River Owners' Group
www.forestriverfrog.com



Forest River, Inc. encourages our customers to purchase their Forest River products from a local dealership whenever possible for the following reasons:

- 1) Forest River, Inc. dealers are independently owned and operated businesses so priority service and scheduling is at their discretion and is often provided to customers that purchased their unit at that dealership.
- 2) Purchasing locally allows customers to establish meaningful relationships with a dealer, enhancing the RV experience through assistance with product questions, user tips or RV regulations for your state or country, and much more!
- 3) Canadian customers must meet requirements to bring an RV purchased out of the country to their home. These requirements may involve additional inspections and certifications, taxes and fees. Your local Canadian Dealer is a professional at meeting these requirements.
- 4) Scheduling timely warranty repairs and adjustments through a local dealership provides far greater flexibility and convenience to you, the customer!

It is the goal of Forest River, Inc. that all of our RV owners fully enjoy the RV experience and that customer satisfaction meets or exceeds their expectations!

All information contained in this brochure is believed to be accurate at the time of publication. However, during the model year, it may be necessary to make revisions and Forest River, Inc., reserves the right to make all such changes without notice, including prices, colors, materials, equipment and specifications as well as the addition of new models and the discontinuance of models shown in this brochure. Therefore, please consult with your Forest River, Inc., dealer and confirm the existence of any materials, design or specifications that are material to your purchase decision.

©2015 Prime Time Manufacturing

A Division Of Forest River, Inc.,
A Berkshire Hathaway Company.
All Rights Reserved



Learn More
Scan this barcode using a QR Reader on your smart phone to learn more about Forest River.



Colton RV
North Tonawanda, NY 14120
(716) 694-0188
(800) 628-4889
www.ColtonRV.com

Colton RV
Orchard Park, NY 14127
(716) 957-3250
(800) 628-4889
www.Coltonrv.com

DEALER