

# ALPINE



the **NEXT GENERATION** of RVs  
[www.keystonerv.com/Alpine](http://www.keystonerv.com/Alpine)



**Keystone RV  
Company**

# ALPINE

Keystone RV is proud to introduce its most *Livable, Innovative and Luxurious* full time fifth wheel - Alpine.

Extensive planning went into the creation of this "*Next Generation*" RV. Alpine showcases many game changing features like its *Spacious Wide Body Interiors, Huge Panoramic Frameless Windows and Enormous Slide Room Heights*. These features simply won't be found in other high profile fifth wheel brands.

Alpine was designed with you in mind - a customer who deserves and demands the highest level of *Quality and Craftsmanship* available in the marketplace today.

-Team Alpine

## NEXT GENERATION *Innovation*



**PATENTED FRONT CAP** THAT ISN'T DYED LIKE COMPETITORS. INCLUDES 5 YEAR WARRANTY ON FRONT CAP 4MM GRAPHICS



**100" WIDE BODY** WITH REAR LED TAIL LIGHTS



**SUMMITT SLIDES** WITH HUGE WINDOWS FOR BEAUTIFUL PANORAMIC VIEWS

# TABLE OF CONTENTS

Construction.....	pg 4-5
3535RE Interior .....	pg 6-7
3600RS Interior .....	pg 8-9
Floorplans .....	pg 10-11
3620FL Interior .....	pg 12-13
Interior Features .....	pg 14-15
Standard Features.....	pg 16
Level Up System .....	pg 17
Interior Decor Options.....	pg 18
Standards & Options.....	pg 19
Full Paint Options .....	Back Cover

## NEXT GENERATION *Comfort*

-4° Outside



72° Inside

### COMFORT INDOORS

With an impressive list of industry- leading construction advancements, Alpine sets the bar in four season living. But don't just take our word for it — look at these official test results from a world leader in heating and cooling technology — Dometic Corporation. Subjected to below zero temperatures inside their legendary test chamber, the following temperatures were recorded inside an Alpine with the thermostat set at 74°;

Living room .....	72°
Bedroom .....	70°
Bathroom .....	75°
Pass-Thru/Utility Center....	58°*

Of course, inside temperatures are only part of the story. With our industry leading “Therma-Shield 37” package, all the holding tanks and dump valves remained completely operational on our test unit with recorded temperatures consistently above 50° in these critical areas.

Not everyone needs this kind of protection, but when four season comfort becomes important, make sure you demand the very best... demand an Alpine!

\*Testing was done in a controlled independent environment.



# ALPINE

## -4° NEXT GENERATION *Construction*

With an impressive list of industry-leading construction advancements, Alpine sets the bar for four season living.

### WALL CONSTRUCTION (R-10)

1. High Gloss fiberglass exterior walls, baggage doors, and entry door
2. Dual 1/8" luan backers with staggered seams
3. High density block foam insulation
4. Radius window corner blocks for additional integrity
5. 2" Welded aluminum sidewall studs
6. Fiberglass batten insulation
7. Thermo-foil insulation
8. Patented fiberglass cap with 4mm coated graphics (5 year warranty on front cap graphics)
9. Metal backing strips for added support
10. Cambered steel cap backing for increased turning radius - "Max Turn" Thermo-foil insulation

### ROOF CONSTRUCTION (R-28)\*

11. Aluminum radius roof corner molding wrap
12. One-piece T.P.O. roof with 12-year warranty
13. 3/8" Fully walkable roof decking
14. Thermo-Foil insulation
15. Fiberglass batten insulation
16. 1/8" Ceiling decking with vinyl protection
17. Vented attice allowing air flow and circulation

### FLOOR CONSTRUCTION (R-40)\*

18. Residential grade high density Shaw 28 oz. carpet with stain protection
19. Residential grade carpet padding
20. 6 layer "Bedrock" laminated floor system featuring: Darko wrap, wood backing, aluminum structure, high density block foam, and Astro-Foil insulation, thermo-insulation
21. Thermo-Shield holding tank insulation featuring: one piece fluted polypropylene fully enclosed subfloor; fiberglass batten insulation, and ducted heat

### TIRES AND CHASSIS

22. 12" steel "powder coated" steel I-beams
23. 16" E-Load radial tires
24. EZ-Lube 8 lug, 7,000lb axles
25. EZ-Flex Suspension with 1/2" steel shackles and 8 greasable fittings with brass bushings

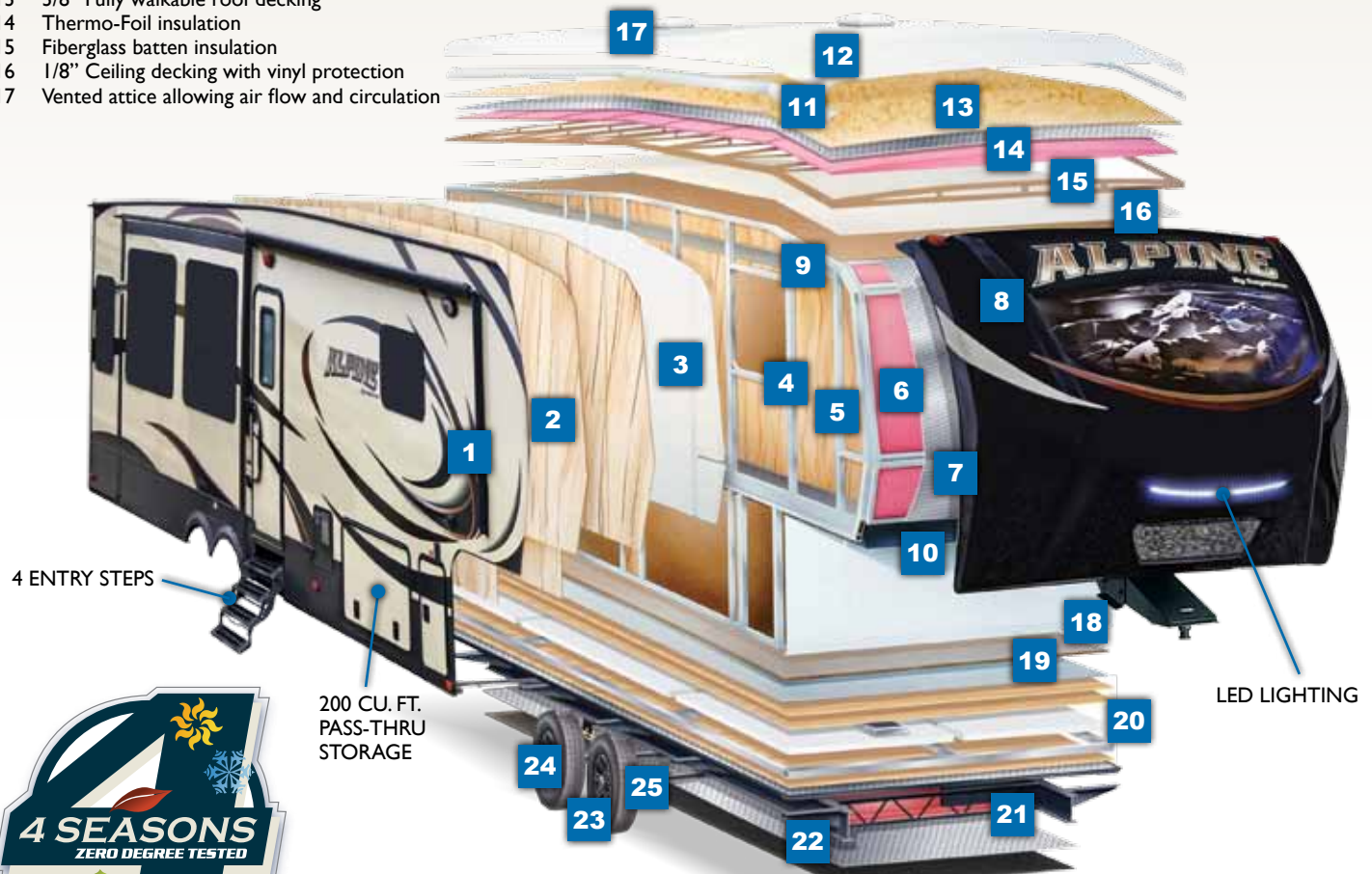

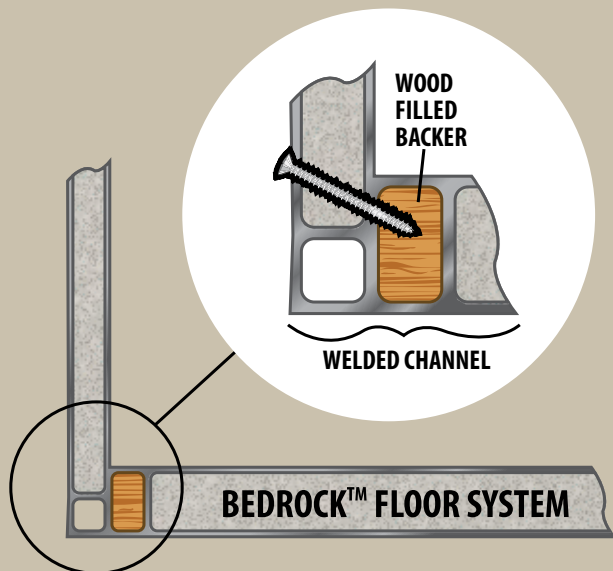

# TRUE WALL 2X CHANNEL TECHNOLOGY

- ✓ 110 CU. FT. OF LIVING SPACE IN UNITS - WIDE BODY 2X
- ✓ CUSTOM EXTRUDED ALUMINUM SUPPORT CHANNEL
- ✓ WELDED FOR MAXIMUM STABILITY
- ✓ PATENT PENDING

## BEDROCK LAMINATED FLOOR SYSTEM (6 LAYER LAMINATED FLOOR)

- High density block foam insulation with aluminum framing throughout (highest insulation R-values)
- Thermo Shield holding tank insulation featuring R37 wrapped tanks w/ forced heat

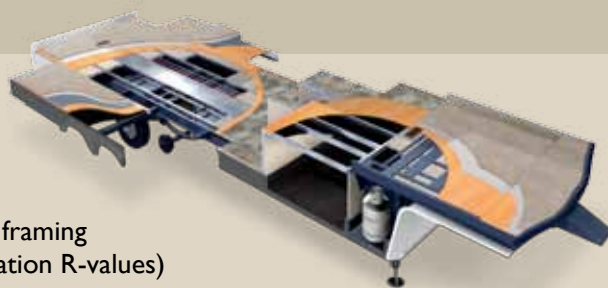

 Dometic

## 30,000 BTU WHISPER AIR SYSTEM

- Residential cold air return
- "Whisper Deluxe" HVAC System (Quietest cooling system ever developed)
- Most Powerful heating (42,000 BTU) and AC system (30,000 BTU) w/ heat pump in Industry
- Programmable dual zone controlling air conditioner w/digital thermostat for multi zone comfort



**ALPINE**

[www.kestonerv.com/Alpine](http://www.kestonerv.com/Alpine)





# ALPINE

## NEXT GENERATION

*Style*

3535RE SHOWN IN  
IVY LEAGUE DECOR





**3535RE KITCHEN**

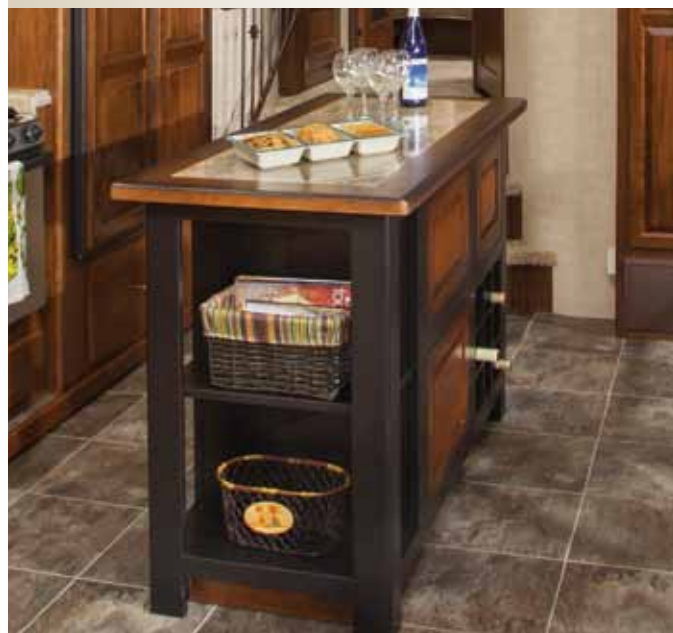

**COUNTRY ISLAND IN 3535RE KITCHEN**



**3535RE BEDROOM SHOWN IN  
IVY LEAGUE DECOR**

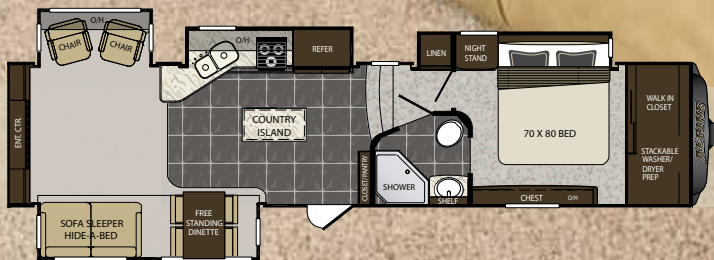





3600RS PANTRY



3600RS GRAND ENTRY

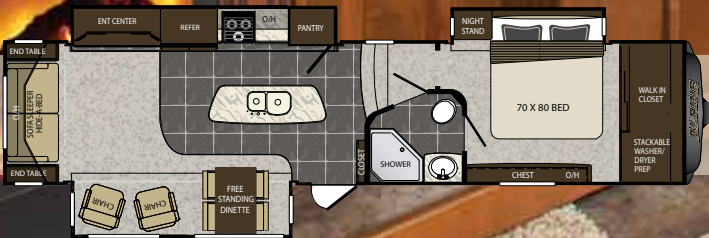





# ALPINE

## NEXT GENERATION

*Style*

3600RS SHOWN IN  
EBONY VINE DECOR

[www.keystonerv.com/Alpine](http://www.keystonerv.com/Alpine)

# ALPINE FLOOR

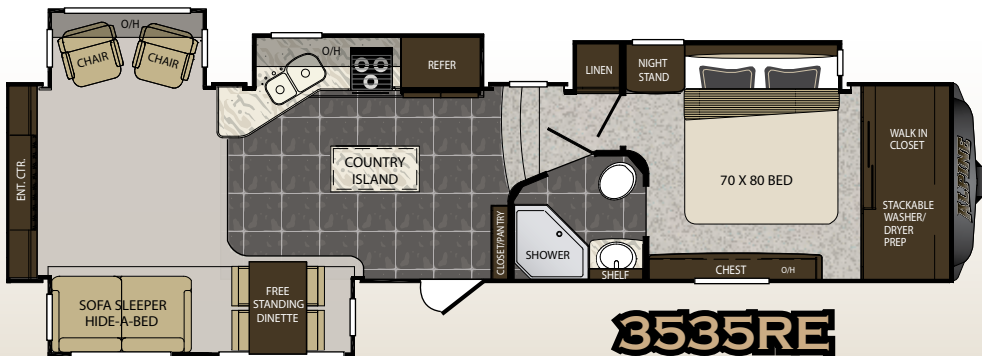
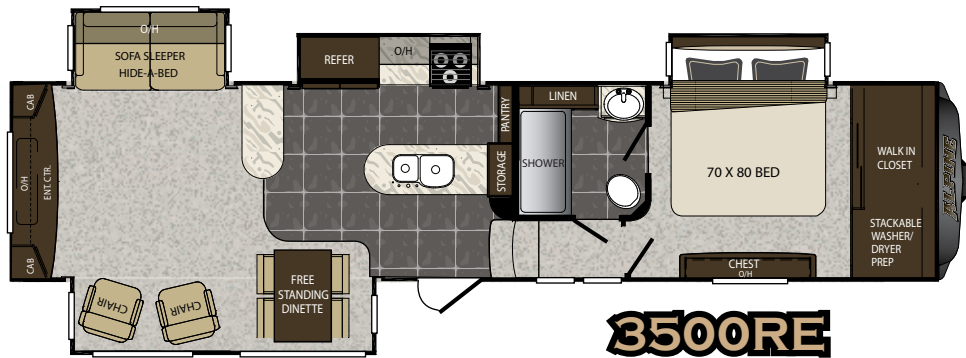
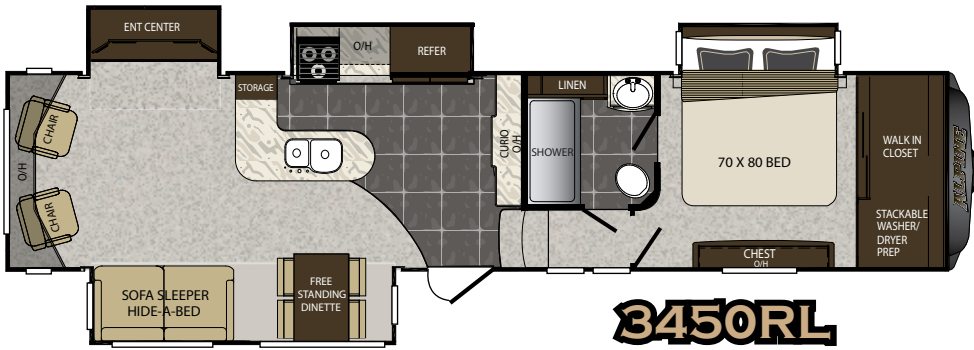
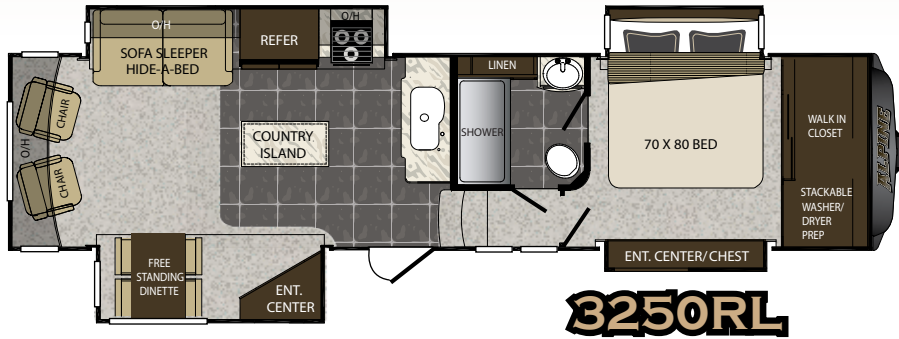
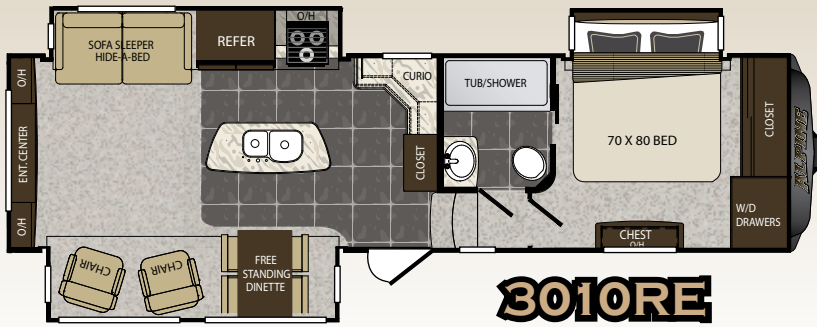

## SPECIFICATIONS

MODEL	3010RE	3250RL	3450RL	3500RE
SHIPPING WEIGHT	11595	TBD	TBD	12720
CARRYING CAPACITY	3405	TBD	TBD	2780
HITCH WEIGHT	2440	TBD	TBD	2395
EXTERIOR LENGTH	34' 10"	37' 4"	39' 8"	37' 9"
EXTERIOR WIDTH	8' 4"	8' 4"	8' 4"	8' 4"
EXT. HEIGHT - A/C TOP	12' 8"	12' 8"	12' 8"	12' 8"
FRESH WATER (GAL.)	66	66	66	66
WASTE WATER (GAL.)	50	50	50	50
GRAY WATER (GAL.)	82	82	82	82
LP CAPACITY (LBS.)	60	60	60	60
AWNING LENGTH	18'	18'	18'	18'

DISCLAIMER: Product information is as accurate as possible as of the date of publication of this brochure. All features, floor plans, and specifications in this brochure are subject to change without notice. Please also consult Keystone's web site at [www.keystonerv.com](http://www.keystonerv.com) for more current product information and specifications. Tow Vehicle Disclaimer. CAUTION: Owners of Keystone recreational vehicles are solely responsible for the selection and proper use of tow vehicles. All customers should consult with a motor vehicle manufacturer or their dealer.



# ALPINE PLANS



## CONFIGURATIONS

3535RE	3555RL	3590RS	3600RS	3620FL	3720FB
12670	12575	12840	12410	12505	12800
2830	2925	2660	3090	2995	2700
2505	2650	2665	2400	2670	2510
39' 1"	38' 7"	40' 1"	38' 11"	40' 3"	39' 2"
8' 4"	8' 4"	8' 4"	8' 4"	8' 4"	8' 4"
12' 8"	12' 8"	12' 8"	12' 8"	12' 8"	12' 8"
66	66	66	66	66	66
50	50	50	50	82	82
82	82	82	82	82	82
60	60	60	60	60	60
18'	18'	19'	19'	14'	18'

concerning the purchase and use of suitable tow vehicles for Keystone products. Keystone disclaims any liability or damages suffered as a result of the selection, operation, use or misuse of a tow vehicle. KEYSTONE'S LIMITED WARRANTY DOES NOT COVER DAMAGE TO THE RECREATIONAL VEHICLE OR THE TOW VEHICLE AS A RESULT OF THE SELECTION, OPERATION, USE OR MISUSE OF THE TOW VEHICLE. \*Length is defined as the distance from the centerline of hitch pin/coupler to rear bumper of trailer. Add 6 inches for MOR/ryde pin box. \*\* Add 6 inches for second A/C.

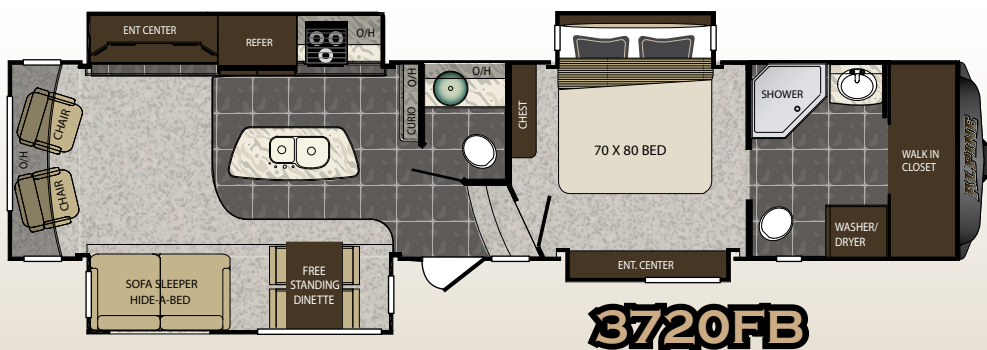
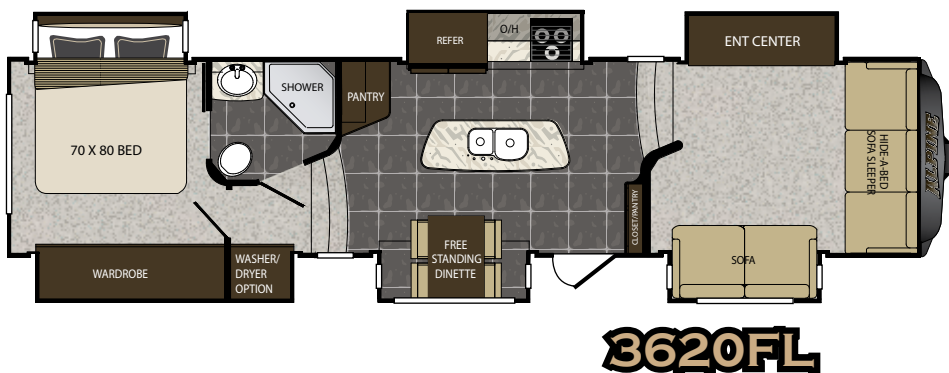
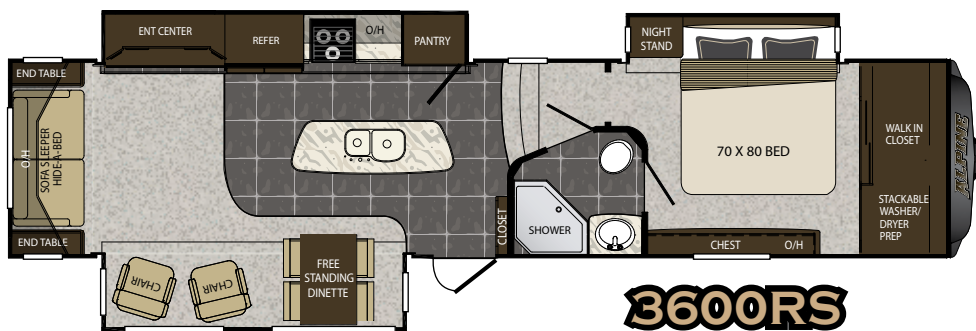
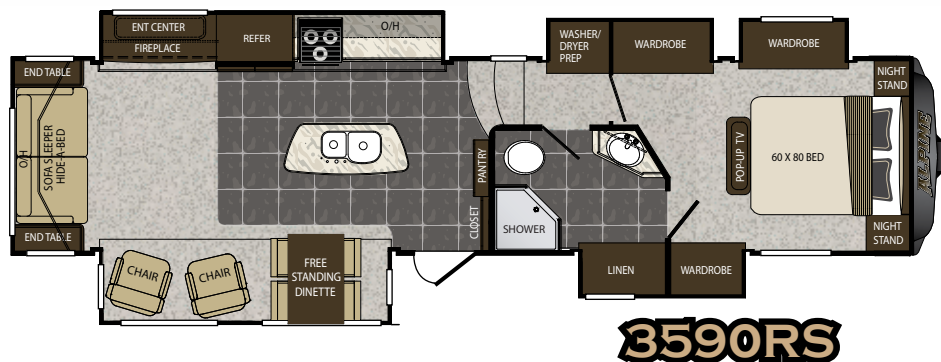
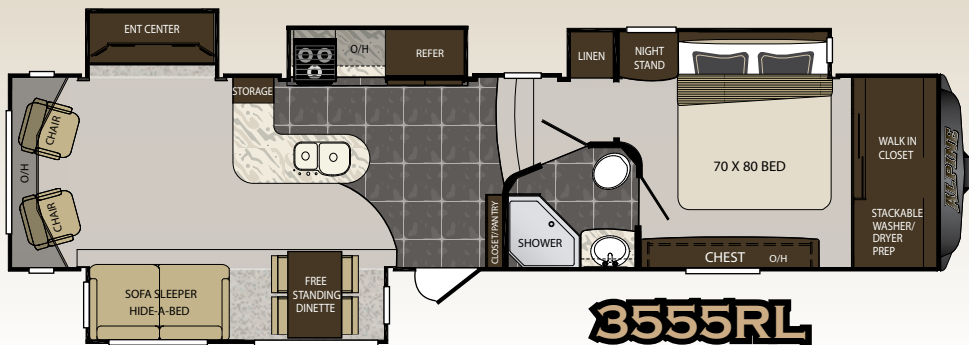



# ALPINE

## NEXT GENERATION

*Style*

3620FL SHOWN IN  
FOREST FLOOR DECOR





**3620FL ENTERTAINMENT CENTER**



**3620FL SHOWN IN FOREST FLOOR DECOR**



**3620FL PANTRY**

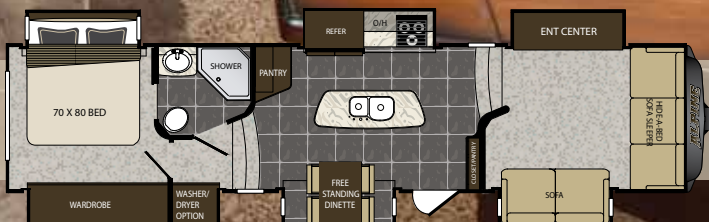





**SOLID WOOD ROPE TRIM SLIDE ROOM FASCIA  
ON ALL FLOORPLANS**



**CEDAR WALK-IN CLOSETS IN MOST FLOOR  
PLANS FEATURING WASHER/DRYER PREP**



**3620FL FRONT LIVING ROOM  
SHOWN IN FOREST FLOOR DECOR**



**3010RE SHOWN IN  
IVY LEAGUE DECOR**





**WINDOWS HAVE MCD SHADES IN EVERY ALPINE FLOORPLAN**

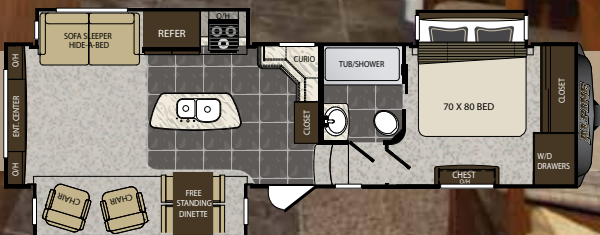
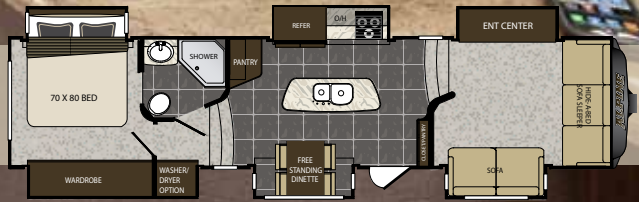

**LARGE SHOWERS IN MOST MASTER BATHROOMS**

**ALPINE**  
[www.keystonerv.com/Alpine](http://www.keystonerv.com/Alpine)





A

# NEXT GENERATION *Features*

**A. OVERSIZED PASS THROUGH STORAGE** – Alpine boasts the industry's largest pass-through storage at over 170 cubic feet. You won't have to worry about your possessions sliding around as we have used non-skid rubber diamond flooring and metal D-rings to secure them. Plus, ducted heat in the storage area as well.

**B. KETTLE STORAGE UNDER REFRIGERATOR** allows for extra storage for large pots and pans.

**C. The Alpine's FULLY ENCLOSED AND HEATED "WATER WORKS"** compartment houses your dump valves, low point drains, exterior high pressure sprayer, black tank flush hookup, quick winterization kit and city water hookups.

**D. FRAMELESS WINDOWS** add to the sleek and luxurious look of the Alpine exterior

**E. Storage compartments** are easy to access in the Avalanche thanks to the motorhome style **"SLAM" BAGGAGE DOORS**. These compartment doors feature easy opening pad handles with locks for added security of your stored valuables.

**F. CORIAN® SOLID SURFACE COUNTERS, SINK COVERS, HINGED RANGE COVER** – Alpine uses some of the finest solid surface material available and includes fitted sink covers and range cover. The range cover is hinged so that storage is convenient, easy, and out of the way.

B



C



F



E

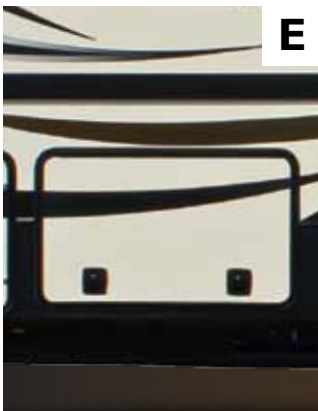

D





# SET UP YOUR CAMPSITE IN SECONDS

Camp sites and dry camping opportunities are rarely level. Even well maintained sites can have an uncomfortable slope. Once the unit is hooked up to your site, other nuances can occur: coach rocking, doors swinging, cookware rolling or sliding, or appliances not functioning properly. Setting up camp can be equally as annoying. To achieve level, as many as four manual or electric jacks may need to be adjusted. Manual jacks can rust over time making this job even more difficult and time consuming. Simply put, camping shouldn't be this difficult! Enough is enough! It's time for Level Up!

..... **OPTIONAL** .....

## ONE TOUCH 6-POINT LEVEL-UP SYSTEM



- ✓ Power up/power down system that weighs less than 80 lbs. TOTAL, but can lift 60,000 lbs!
- ✓ Leveling jacks operate in pairs, eliminating the worry of twisting and damages
- ✓ Extruded jack legs made of 6061-TG anodized aluminum alloy



One touch **AUTO LEVEL** feature!





FOREST FLOOR

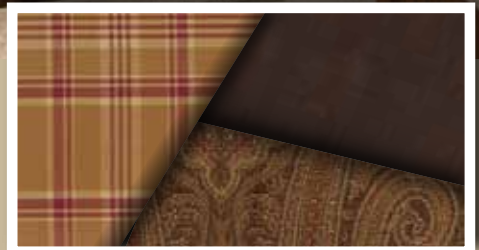

CHURCHILL

# *ALPINE* INTERIOR DECOR OPTIONS



IVY LEAGUE

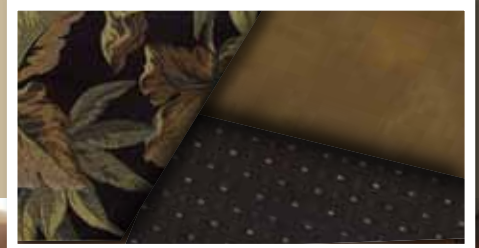

EBONY VINE





# STANDARDS & OPTIONS

## **EXTERIOR FEATURES**

- 16" E-load radial tires w/ 8 wheel lugs
- Heavy duty 7,000lb axles
- Easy lube axles
- 12" -Beams with Z-frame technology
- "No Sweat" vented attic system
- 50 AMP service w/ detachable power cord
- Hydraulic selector valves for slideouts
- Hydraulic front landing jacks w/ 8" diameter all-terrain landing pads
- Gutters w/ rain spouts
- Rear Ladder
- One-Touch electric awning package w/ adjustable arms
- Tinted 80% safety-glass windows
- Electric rear jacks
- MAX TURN high-gloss fiberglass front cap and rear with 30% better turning radius, aerodynamic design w/ 18% better drag efficiency and hitch Assist back up mirror
- High Gloss exterior sidewalls, baggage doors, and entry door
- Class "A" style dual latch "slam" baggage doors
- Easy open 4-step entry steps w/ recessed rope lighting for visibility
- Super-size 6'4" tall, 30" wide entry door
- Deluxe Graphics package
- High Gloss fiberglass rear cap
- One piece polypropylene underbelly
- Triple insulated, ducted and heated holding tanks

## **ALL-IN-ONE "WATERWORKS" EXTERIOR UTILITY CENTER**

- Easy siphon winterization system
- Water heater bypass
- Enclosed low point drain valves
- Ducted heat for cold weather protection
- Dump valves
- 110V outlet
- Black tank spray hookup
- 2" high pressure sprayer

## **SUSPENSION**

- Improved impact absorption
- Improved axle equalization
- 8 Greasable "wet" bolts
- Long lasting 1/2" steel shackles plates
- Long lasting bronze bushings

## **UPGRADED APPLIANCE PACKAGE**

- Stainless steel stove, range, convection
- Whirlpool 30" convection oven/microwave
- 12 Gallon DSI 2-way water heater
- 42,000BTU furnace
- Digital "Smart" Thermostat with dual zone capability
- Heavy duty residential ball bearing drawer guides
- Extra deep, fully extendable drawers

## **DELUXE SOLID SURFACE PACKAGE**

- Corian® countertops
- Flush Mounted solid surface range cover
- Corian sink cover
- Stainless steel extra deep sink w/ dual bowls

- High rise, single lever kitchen faucet w/ sprayer
- Maximized kitchen storage w/ more drawers and pantry space

## **SUPER CINEMA PACKAGE**

- Huge Samsung 46" LED TV
- Bose® Solo TV Sound System
- Samsung Blu-Ray player
- Digital TV antenna w/ built in booster
- Dual cable & satellite hookups

## **INTERIOR FEATURES**

- "Sleep & Store" upgraded sofa w/ memory foam in living room
- 2 high back custom dinette chairs with built-in storage
- Folding chairs (2)
- Extra tall 6' 8" main slide height
- MCD shades
- Ceiling fan with upgraded lighting fixtures
- Electric roof vent in kitchen
- LP leak detector
- "One Place Command Center" centrally located operational switches & gauges
- Translucent glass shower door and enclosure
- Hand held massaging shower head
- Skylight over shower
- Porcelain toilet
- Single level master bedroom suite
- "Cloud Nine" 70" x 80" pillow top king bed mattress (60" x 80" Queen Bed in 3590RS)
- Residential style headboard w/shelves
- Cross ventilation bedroom windows where available
- Quilted bedspread and pillows

## **ALPS PACKAGE**

### **NORTH FACE INSULATION PACKAGE**

- Triple insulated
- Heated basement
- Heat ducting to tanks
- Heated "Water Works" area

## **SURE-ROAD BUNDLE**

- Class "A" style slam baggage doors
- Rear power jacks
- Hydraulic front jacks
- High gloss sidewalls & doors
- Electric one-touch awning
- Suspension system

## **BEDROCK-BUNDLE**

- Double laminated flooring
- 12" I-beams w/ Z-frame technology
- Industry's largest pass-through storage

## **CHATEAU PACKAGE**

### **WHISPER AIR BUNDLE**

- Dual 15,000BTU air conditioners w/ cold air return vents
- Digital "Smart" Thermostat with dual zone capability
- Heat pump standard
- Fully programmable dual zone temperature control

## **ULTIMATE KITCHEN BUNDLE**

- Corian countertops, sink, and range cover
- Stainless steel appliances
- Range w/ sealed burners & 22" oven microwave
- Maximized kitchen storage w/ more drawers and pantry space

## **RETREAT COLLECTION**

- Deluxe Black Forest Cherry wardrobe doors
- Cedar lined walk-in closet w/ dressing bench and storage
- Stackable washer/dryer prep
- Cloud Nine pillow top mattress

## **PEAKS ALPINE PACKAGE**

- Big body width with "Next Generation" construction
- Summit slides with super sized windows
- Premium Plus Performance System (Bose Solo acoustic sound system, 46" Samsung LED TV, Samsung Blu-Ray player, Harman/Kardon Bluetooth streaming system)
- Pearl Oyster exterior with dyed rear cap
- Custom painted front cap
- Designer window pull down shades with metal ends
- Hidden hinges at cabinet doors
- Pressurized metal Anderson valve control switch at water hook up
- Amish quality, cherry fascia and bedroom headboard
- Wood window valance boxes with fabric accents
- Victorian bead board wainscot with chair rail in main slide
- Front and rear exterior LED lighting
- Import designer furniture
- Bottomless dining room table with two oversized and two folding chairs

## **OPTIONS**

- Trail air pin box
- Slide awning package
- Generator prep
- 12 cu ft refer (mandatory option)
- Central vac
- Electric fireplace
- Vent fan in bedroom
- Dual pane windows
- End table w/ lamp
- Winterization kit
- Canadian compliance
- RVIA seals
- Go RVIA MEP fee
- Bedroom TV
- 6-Point self-leveling System
- 50 AMP cord caddy
- 30" Convection oven
- 5500 LP generator

# ALPINE

## FULL PAINT OPTIONS

Choose between three different full paint options



■ Malibu Sand

■ Arctic Sky

■ Midnight Merlot

*\*Full paint options are available on all Alpine fifth wheels.*

## BUY LOCALLY

### PURCHASING YOUR RV LOCALLY

It's up to you where you purchase your new Alpine, but may we suggest your local dealer? Not only does it help your local economy and provide jobs, but it will also give you an opportunity to develop a service relationship with someone that will come to know you and your coach. Congratulations on finding the best built, best equipped, best value in the industry, and happy travels!

#### YOUR LOCAL DEALER:

Colton RV  
North Tonawanda, NY 14120  
(716) 694-0188  
(800) 628-4889  
[www.ColtonRV.com](http://www.ColtonRV.com)

Colton RV  
Orchard Park, NY 14127  
(716) 957-3250  
(800) 628-4889  
[www.Coltonrv.com](http://www.Coltonrv.com)

VISIT OUR WEBSITE TO VIEW INTERIOR PHOTOS,  
360 VIRTUAL TOURS AND MUCH MORE.



## ALPINE

[www.keystonerv.com/Alpine](http://www.keystonerv.com/Alpine)



Go RVing  
Life's A Trip

2642 Hackberry Drive  
PO Box 2000  
Goshen, IN 46527-2000  
(574) 535-2100



**Keystone RV  
Company**

[www.keystonerv.com](http://www.keystonerv.com)

Product information is as accurate as possible as of the date of publication of this brochure. Features, floor plans, and specifications are subject to change without notice. Please also consult Keystone's web site at [www.keystonerv.com](http://www.keystonerv.com) for more current product information and specifications. Tow Vehicle Disclaimer: CAUTION: Owners of Keystone recreational vehicles are solely responsible for the selection and proper use of tow vehicles. All customers should consult with a motor vehicle manufacturer or their dealer concerning the purchase and use of suitable tow vehicles for Keystone products. Keystone disclaims any liability or damages suffered as a result of the selection, operation, use or misuse of a tow vehicle. KEYSTONE'S LIMITED WARRANTY DOES NOT COVER DAMAGE TO THE RECREATIONAL VEHICLE OR THE TOW VEHICLE AS A RESULT OF THE SELECTION, OPERATION, USE OR MISUSE OF THE TOW VEHICLE.

November 2013