

# Going my way?



**STARCRAFT**

CAMPING | *pure and simple.*



2010 AUTUMN RIDGE® AND AUTUMN RIDGE SE® | TRAVEL TRAILERS BY STARCRAFT®

# A perfect fit.



Autumn Ridge 246RKS / Skyy



The 2010 Autumn Ridge is the perfect travel trailer for anyone looking for a comfortable, reliable way to experience the RV camping lifestyle. And with two series to choose from, each boasting a level of standard equipment and optional upgrades normally limited to more expensive units, it's the perfect travel trailer for anyone looking to experience a great value.

Autumn Ridge 368FBHU / Camel



## EXPANDABILITY

Featuring multiple slideout options and sleeping configurations, some Autumn Ridge models can comfortably sleep up to 10 adults.



## TRANQUILITY

A cozy sofa-dinette slideout provides plenty of room for you and your family to spread out and relax (some models).



## SIMPLICITY

With Autumn Ridge, you'll never pay for features and gadgets you'll never use. Our campers are built for camping. Nothing more, and nothing less.



# Families welcome.

Long on the features you need and short on price, Autumn Ridge travel trailers are designed to make the RV lifestyle accessible to everyone. Each model comes with a fully functional kitchen and bath, plus an open, comfortable living area. Other features include multiple slideouts, DVD/surround sound system, bathroom power vent, solid raised-panel cabinet doors and air conditioning.



Autumn Ridge SE 329BHU / Camel

With table seating for four, plus an available breakfast bar, space is never an issue with Autumn Ridge.



Autumn Ridge SE 285RBS / Cilantro

Clean up in Autumn Ridge's modern bathroom, featuring two medicine cabinets, two sinks and a glass-enclosed shower (in select models).



Autumn Ridge SE 285RBS / Cilantro

There's plenty of storage in Autumn Ridge's comfy, cozy bedroom with overhead cabinets and queen bed.

# STANDARDS AND OPTIONS

- ◆ AUTUMN RIDGE TRAVEL TRAILERS
- ◆ AUTUMN RIDGE SE TRAVEL TRAILERS

## STANDARD BATHROOM EQUIPMENT

- ◆ ABS tub surround
- ◆ Bar and towel ring
- ◆ Bathroom exhaust fan
- ◆ Glass shower door (select models)
- ◆ Large sink in bathroom
- ◆ Marine toilet with foot flush
- ◆ Medicine cabinet with mirror
- ◆ Residential 6-panel passage door
- ◆ Shower curtain with curved shower track (select models)
- ◆ Toilet paper holder
- ◆ Vinyl flooring

## STANDARD BEDROOM EQUIPMENT

- ◆ 312-coil innerspring mattress with 1" padding
- ◆ Bedroom roof vent
- ◆ Carpeting with padding (select models)
- ◆ Privacy curtain (select models)
- ◆ Quilted bedspread (select models)
- ◆ Shirt wardrobe in bedroom
- ◆ Sliding, pocket-style door (select models)
- ◆ Under-bed storage, bed lifts easily on gas struts (select models)

## STANDARD KITCHEN EQUIPMENT

- ◆ 3-burner range with 9,000-BTU SuperBurner™
- ◆ Access doors to the dinette booth
- ◆ Acrylic residential-style sink
- ◆ Brown Sugar raised-panel doors and drawers on overhead cabinetry
- ◆ Brown Sugar raised-panel on refrigerator
- ◆ Dream Dinette™ mechanism, raises and lowers table top (select models)
- ◆ Extra large picture window at dinette
- ◆ Large pedestal dinette table
- ◆ Mixing high-rise faucet
- ◆ Oversized oven
- ◆ Range hood with light and exhaust fan
- ◆ Spice rack, built-in under kitchen sink (select models)
- ◆ Sponge holder under sink

## STANDARD CONSTRUCTION FEATURES

- ◆ .024" aluminum exterior skin
- ◆ 1/2" plywood dinette, bed and bunk platforms
- ◆ 5/8" tongue-and-groove plywood main floor decking
- ◆ 2" x 3" longitudinal floor joists on 16"-18" centers
- ◆ 81" living room ceiling height
- ◆ Electric-powered slideout (all slideout models)
- ◆ Fully-decked roof with 3/8" plywood
- ◆ I-Class® cambered structural-steel I-beam frame
- ◆ One-piece, seamless, rubber roof material
- ◆ Poly Flex™ one-piece underbelly covering
- ◆ R-7 fiberglass insulation in sidewalls, roof and floor
- ◆ Roof rafters, constructed of residential-style tapered 4-1/2" trusses
- ◆ Wall studs on 16" centers

- ◆ AUTUMN RIDGE TRAVEL TRAILERS
- ◆ AUTUMN RIDGE SE TRAVEL TRAILERS

## STANDARD EXTERIOR EQUIPMENT

- ◆ 15" radial tires
- ◆ 60" patio door (368FBHU)
- ◆ Amber patio light with inside switch
- ◆ Baggage doors are lockable and radius-cornered with heavy-duty grab handle
- ◆ Big Easy™ entrance step with 10" deep treads (select models)
- ◆ Bumper with drain hose carrier and end caps
- ◆ Chrome hub caps
- ◆ Exterior speakers, high-output marine-grade (2)
- ◆ E-Z Lube® axles
- ◆ Foldable, exterior grab handle
- ◆ Front window, with flush-mounted stone guard (186BH)
- ◆ Galvanized steel wheel wells (insulated on non-slide models)
- ◆ Painted bottom radius skirting
- ◆ Propane gas bottle cover, made of molded ABS
- ◆ Radius-cornered fiberglass entrance door with screen door
- ◆ Rain guttering, molded with drip spouts
- ◆ Roof ladder
- ◆ Stabilizer jacks (2 pairs)
- ◆ Tinted, black, radius-cornered awning-style windows

## STANDARD INTERIOR EQUIPMENT

- ◆ 22" LCD HDTV in living area
- ◆ Ball bearing drawer guides 50-lb. capacity with full-drawer extension
- ◆ Brown Sugar doors and drawers
- ◆ Cable and satellite TV prepped
- ◆ Cable TV hookup with RG6 coax cabling
- ◆ Carpet with padding
- ◆ Crank-up digital TV antenna with signal booster
- ◆ Decorative nickel lighting over sofa and dinette
- ◆ Fabric-covered box valances with lambrequin legs
- ◆ Hardwood message center
- ◆ J-Steel™ convertible sofa
- ◆ Marine-grade table leg and pedestal base
- ◆ Overhead cabinetry in slideout room above sofa
- ◆ Pleated night shades
- ◆ Residential furniture, designed and made by Starcraft®
- ◆ Roof-mounted antenna for radio
- ◆ Swivel rocker(s) (1 or 2 on select models)
- ◆ Wallpaper border

## STANDARD HEAT, POWER AND WATER EQUIPMENT

- ◆ 6-gal. gas water heater (N/A 368FBHU)
- ◆ 10-gal. gas water heater (368FBHU)
- ◆ 12V demand water pump
- ◆ 12V electrical system with deluxe 110V 45-amp power converter
- ◆ 30-amp power cord
- ◆ 120V G.F.C.I. protected exterior receptacle
- ◆ ABS holding tanks
- ◆ A/C ChillGrille™
- ◆ Auto-ignition furnace with wall thermostat
- ◆ Double 30-lb. propane gas bottles with regulator
- ◆ Hook-up for city water
- ◆ In-floor ducted heat
- ◆ Outside shower
- ◆ Systems monitor panel
- ◆ Water system winterization kit

- ◆ AUTUMN RIDGE TRAVEL TRAILERS
- ◆ AUTUMN RIDGE SE TRAVEL TRAILERS

## STANDARD SAFETY EQUIPMENT

- ◆ Break-away switch
- ◆ Deadbolt lock on entrance door
- ◆ Dual hitch safety chains
- ◆ Egress window
- ◆ Fire extinguisher
- ◆ Propane/carbon monoxide alarm
- ◆ Safety-glass windows
- ◆ Smoke alarm
- ◆ Tinted safety-glass windows

## OPTIONS

- ◆ Bike rack/cargo tray system
- ◆ Canadian standards
- ◆ Customer Convenience Package
- ◆ Customer Convenience Package with 15,000-BTU A/C
- ◆ Extendable dinette (select models)
- ◆ Foil insulation package
- ◆ Free-standing table with 4 chairs (select models)
- ◆ Front diamond plate
- ◆ Hide-a-bed (select models)
- ◆ Hide-a-bed on door side (336RESA)
- ◆ Insulated, heated and enclosed underbelly
- ◆ Ledgestone fireplace with 32" LCD HDTV (336RESA)
- ◆ Linoleum in living area (select models)
- ◆ Outside grill
- ◆ Quad bunk in lieu of standard bunk/dinette (368FBHU)
- ◆ Satellite kit
- ◆ Sofa in lieu of chairs (315RKS)
- ◆ Spare tire with tire carrier
- ◆ Trundle bed in lieu of futon (329BHU)
- ◆ Water purifier

## CUSTOMER CONVENIENCE PACKAGE

- ◆ 13,500-BTU or 15,000-BTU A/C with wall thermostat with louvered-directional ceiling vents
- ◆ ABS tub surround
- ◆ Bathroom power vent
- ◆ Bi-fold cover for range
- ◆ Carefree® patio awning
- ◆ Carefree® Travel'r™ 12V electric patio awning
- ◆ Double 30-lb. propane gas bottles with regulator
- ◆ Microwave oven with carousel
- ◆ Multi-media sound system™ AM/FM/CD stereo with MP3 input jack
- ◆ Multi-media sound system™ AM/FM/CD/DVD stereo with MP3 input jack
- ◆ Quilted bedspread
- ◆ Shirt wardrobe in bedroom
- ◆ Sink cover/cutting board (1)
- ◆ Tub/shower skylight
- ◆ Water heater bypass system

## FLOORPLANS

◀ = outside storage  
LAV. = bathroom sink

MICRO. = microwave  
OHC. = overhead cabinets

REFRIG. = refrigerator  
WARD. = wardrobe

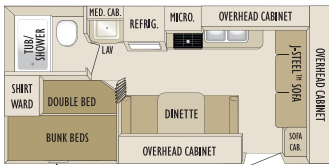

15-FOOT AWNING (OPTIONAL)

## Autumn Ridge 186BH

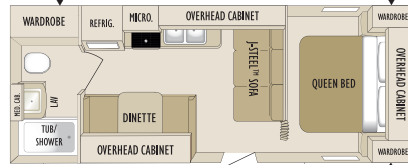

**15-FOOT AWNING (OPTIONAL)**

## Autumn Ridge 235FB

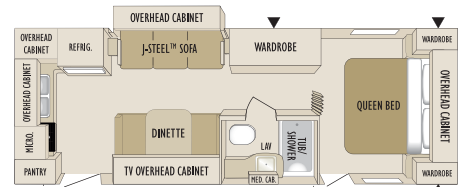

15-FOOT AWNING (OPTIONAL)

## Autumn Ridge 246RKS

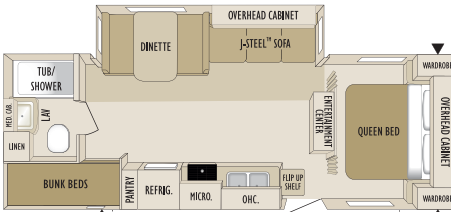

16-FOOT AWNING (OPTIONAL)

## Autumn Ridge 256BHS

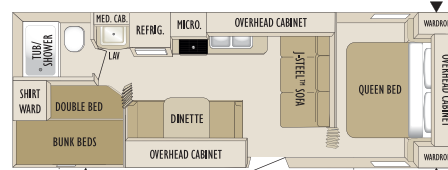

16-FOOT AWNING (OPTIONAL)

## Autumn Ridge 278BH

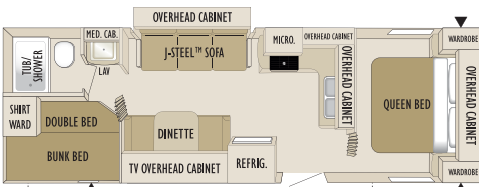

**18-FOOT AWNING (OPTIONAL)**

## Autumn Ridge 297BHS

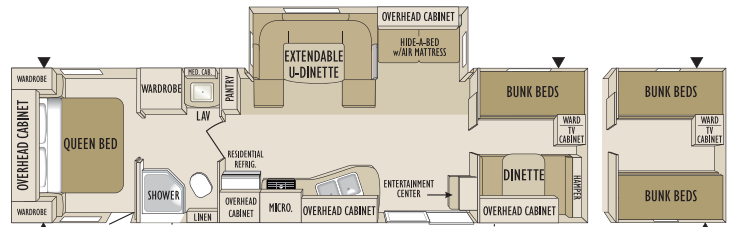

18-FOOT AWNING (OPTIONAL)

### Autumn Ridge 368FBHU

## DÉCOR

- |   |      |
|---|------|
| 1 | Sofa |
| 6 | Wood |

- 2 Chair  
7 Wall panel

- 3 Accent fabric  
8 Countertop

- 4 Bedspread  
9 Flooring

- 5 Drapery  
10 Carpet

SKYY



CILANTRO



## SPECIFICATIONS

[illegible]



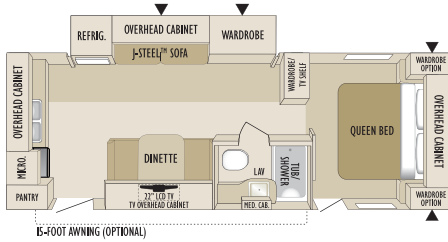

Autumn Ridge SE 264RKS

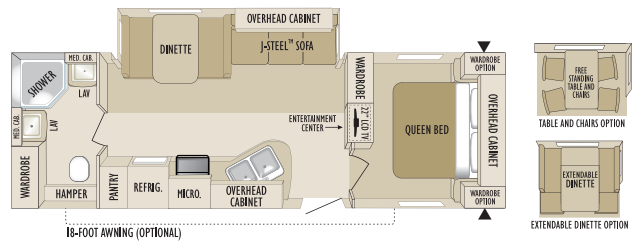

Autumn Ridge SE 285RBS

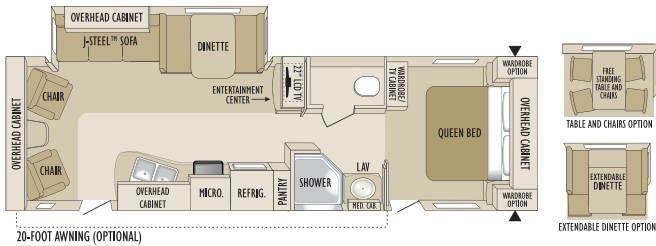

Autumn Ridge SE 295RLS

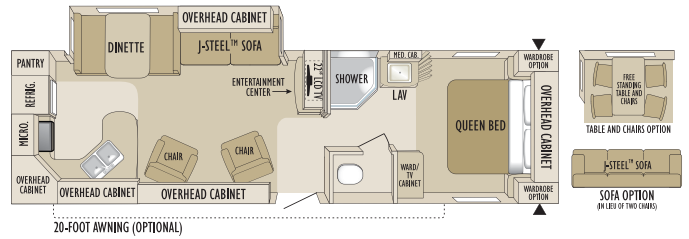

Autumn Ridge SE 315RKS

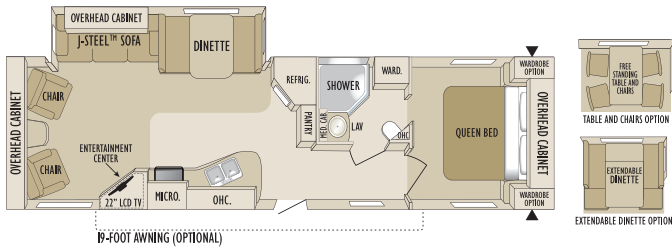

Autumn Ridge SE 325RLSA

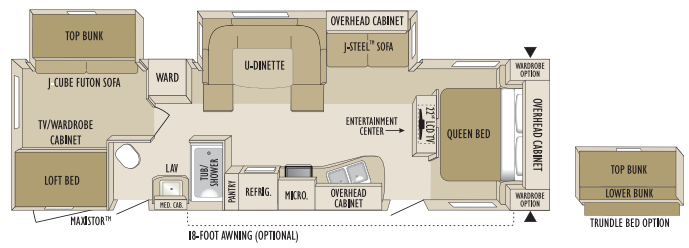

Autumn Ridge SE 329BHU

## CAMEL

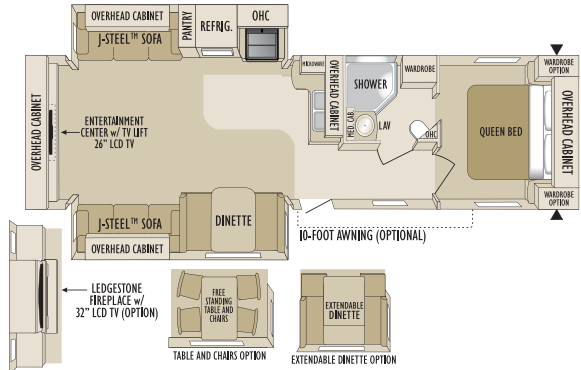

Autumn Ridge SE 336RESA

**Unloaded Vehicle Weight (UVW):** Sometimes referred to as "Dry Weight," UVW means the typical weight of this trailer as built at the factory. The UVW, as used in product literature and other promotional materials, does not include cargo, fresh water, propane, options or dealer-installed accessories.

**Gross Vehicle Weight Rating (GVWR):** GVWR means the maximum permissible weight of the trailer, including the UVW plus passengers, personal items, all cargo, fluids, options, and dealer-installed accessories. The GVWR is equal to or greater than the sum of the UVW and the CCC.

**Cargo Carrying Capacity (CCC):** CCC means the maximum weight of all passengers, personal items, food, fresh water, propane, tools, other cargo and dealer-installed accessories that can be carried by the trailer. CCC is equal to or less than GVWR minus UVW. The addition of options will decrease the CCC.

**Hitch Weight (HW):** The hitch weight, as used in product literature and other promotional materials, does not include cargo, fresh water, propane gas, options or dealer-installed accessories. The addition of these types of items will either add to or subtract from the stated hitch weight.

It is important for your safety and enjoyment that your tow vehicle be adequately sized and equipped to tow and handle the GVWR of the RV you select. Review weights and rating of your tow vehicle and consult a competent advisor for questions or advice. Whether you are new to RVing or a veteran, get a feel for the performance of your tow vehicle and the RV together before heading out on the roadways. When you tow an RV, you must drive differently than you do when driving a single vehicle. Practice hooking up, driving, backing up and braking in a safe environment or seek out professional instruction. Starcraft affixes a weight label to each RV which lists weight information for that vehicle. See specification chart above.

## Built right.

We built our reputation making affordable, reliable and durable campers with an Amish-inspired attention to detail. We use the highest-quality materials available, state-of-the-art production techniques and time-tested design principles. Because the last thing you need to worry about when you're camping is your camper.

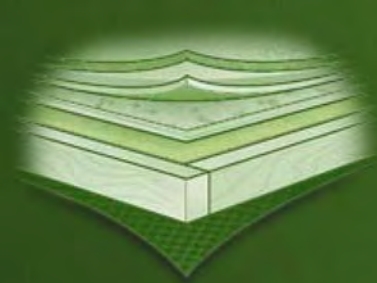

### FLOOR

Because a camper is only as strong as its foundation, we use a  $\frac{5}{8}$ " tongue-and-groove plywood deck on 2" x 3" floor joists and R-7 fiberglass insulation to create one of the industry's strongest floors.



### WALLS

Our walls are built with 2" x 2" wooden studs, .024" aluminum exterior siding and R-7 fiberglass insulation, to create a strong, durable structure.



### ROOF

Moisture and aging don't stand a chance against our roof, which combines wood rafters with 4- $\frac{1}{2}$ " arched trusses,  $\frac{3}{8}$ " plywood decking, a one-piece seamless rubber membrane and R-7 fiberglass insulation.

## Built on tradition.

The Starcraft name has been around for more than 40 years—becoming one of the most dependable names in the camping industry. Today, our strong balance sheet and family-oriented business approach means we'll be around for decades to come. And you can bet our campers will continue to come with everything you need to have a great time in the great outdoors, at a price that guarantees you will.

### Why a Local Starcraft Dealer is Important to You

Establishing a solid relationship with your local Starcraft dealer is a key component in the enjoyment of your new Starcraft. By purchasing from a local dealer, you will have a convenient location for sales, parts and service support.

Budget RV Outlet of Buffalo  
4817 Lake Ave.  
Blasdell, NY 14219  
716-685-3546  
[www.budgetrvoutlet.com](http://www.budgetrvoutlet.com)

### One-year warranty

The Starcraft warranty is a manufacturer's limited warranty. Each Starcraft is warranted to the original purchaser for twelve (12) months from the original date of purchase against defects in materials and workmanship. Starcraft's limited warranty is not transferable. For a copy of the limited warranty with full terms and conditions, ask your local Starcraft dealer.

Starcraft RV • PO Box 460 • Middlebury, IN 46540 

[www.starcraftcamping.com](http://www.starcraftcamping.com)

See dealer for further information and prices. All information in this brochure is the latest available at the time of publication approval. Starcraft reserves the right to make changes and to discontinue models without notice or obligation. Photos in this brochure may show optional equipment and props for photography purposes. RV's built for sale in Canada may differ to conform to Canadian codes.

©2010 Starcraft RV 10-ARDG - PL - 0909-50K Printed in USA.

# STARCRAFT

CAMPING | *pure and simple.*