



YOUR JOURNEY BEGINS HERE!



www.primetimerv.com

North America's
Favorite RV Company!





32QBI Back to Front

For both the first-time buyer and seasoned camping veteran, the value-conscious Avenger often represents a customer's first experience with a recreational vehicle from Prime Time Manufacturing. Since first impressions are critical - and last a lifetime - we've insisted that Avenger combine comfort, convenience, and style with the industry's highest standard of quality and construction. By providing a GREAT ownership experience, Avenger is Prime Time's way of welcoming you to our family. We hope that your future journeys will always include a Prime Time RV.



27DBS Front to Back



28RKS Kitchen



28RKS Dinette

To guarantee that Avenger provides true customer satisfaction, our engineers carefully examined every component, every small detail, and every process that went into Avenger's creation. It was important to offer industry-leading beauty, so real Native American Cherry hardwood cabinet doors were paired with premium fabrics, flooring, and countertops for a luxurious appearance. Features and design elements that are considered to be "Best In Class" were specified to fully maximize customer enjoyment. Demanding testing standards and innovative construction techniques like EVERLAST® were developed to ensure long-term quality and durability. If "Your Journey Begins Here," Avenger is sure to please.



32FBI Bedroom



32QBI Bunkhouse

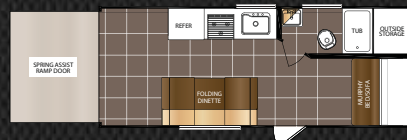

18TH Toy Hauler



21TH Toy Hauler



25TH Toy Hauler



22RB

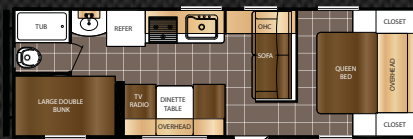

26BH

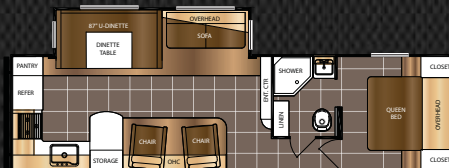

28RKS

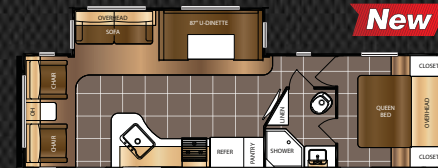

28RLS

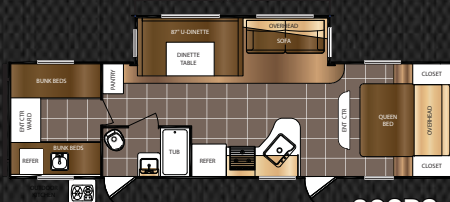

30QBS

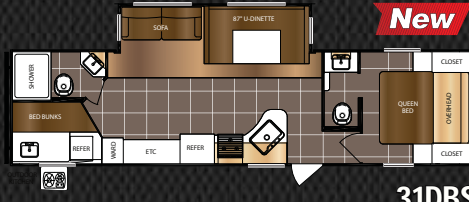

31DBS

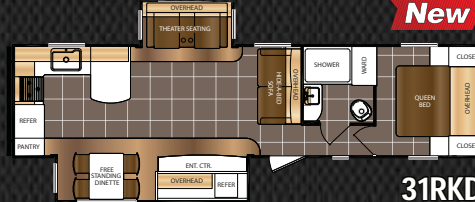

31RKD

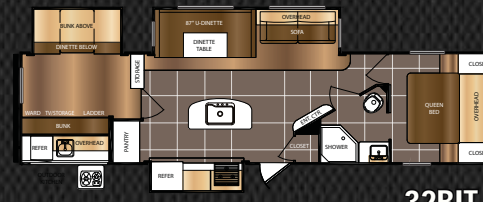

32BIT



32 FBI

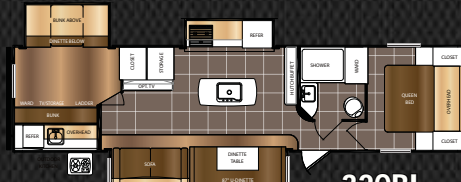

32QBI

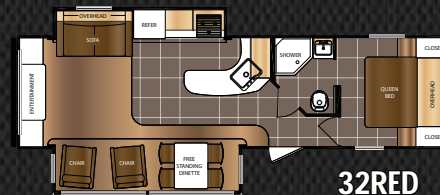

32RED

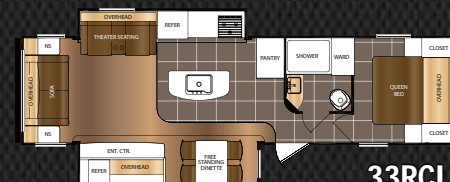

33RCI

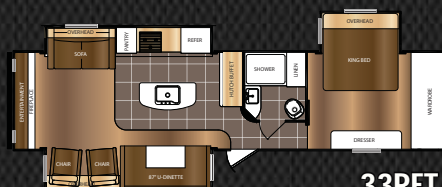

33RET

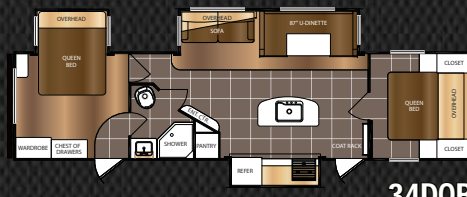

34QDB



SPECIFICATIONS	18TH	21TH	25TH	22RB	26BH	28RKS	28RLS	30QBS	31DBS	31RKD	32BIT	32FBI	32QBI	32RED	33RCI	33RET	34QDB
LENGTH	24' 0"	26' 4"	32' 0"	26' 9"	28' 11"	34' 4"	33' 5"	33' 11"	35' 9"	36' 6"	37' 8"	34' 4"	37' 11"	34' 9"	35' 11.5"	38' 5"	37' 10"
HEIGHT	10' 7"	10' 10"	10' 10"	10' 7"	10' 7"	11' 2"	11' 2"	11' 2"	11' 2"	11' 4"	11' 4"	11' 4"	11' 4"	11' 4"	11' 4"	11' 4"	11' 4"
HITCH WEIGHT	725 lb.	772 lb.	1,073 lb.	624 lb.	580 lb.	680 lb.	695 lb.	885 lb.	789 lb.	928 lb.	871 lb.	680 lb.	1,000 lb.	758 lb.	938 lb.	1,102 lb.	922 lb.
UNLOADED VEHICLE WEIGHT (UVW)	4,618 lb.	4,971 lb.	5,874 lb.	4,663 lb.	4,850 lb.	6,789 lb.	6,983 lb.	7,113 lb.	7,189 lb.	8,159 lb.	8,393 lb.	8,460 lb.	9,029 lb.	7,389 lb.	7,976 lb.	9,190 lb.	8,334 lb.
CARGO CARRYING CAPACITY (CCC)	3,107 lb.	4,601 lb.	3,999 lb.	2,877 lb.	2,692 lb.	2,691 lb.	2,557 lb.	2,534 lb.	2,400 lb.	3,169 lb.	2,840 lb.	2,885 lb.	2,371 lb.	3,731 lb.	3,324 lb.	2,540 lb.	3,037 lb.



27RBS Bathroom

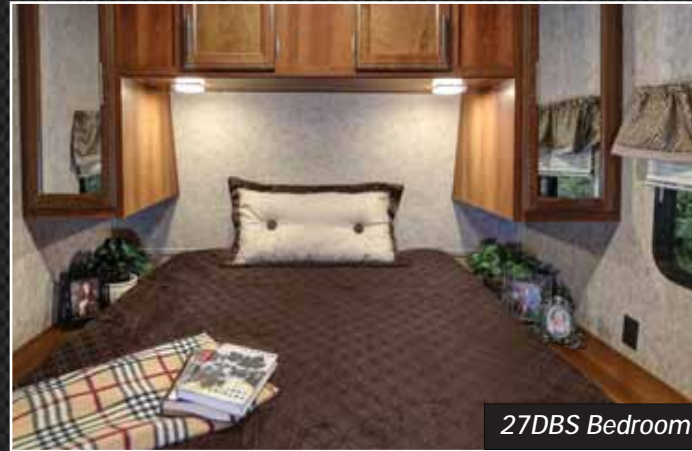

27DBS Bedroom



27DBS Outdoor Kitchen

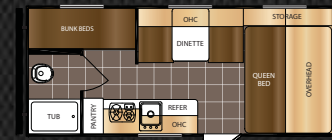

17BH

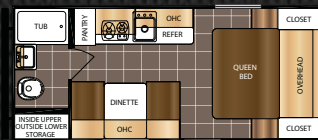

17QB

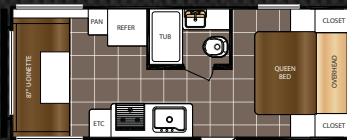

20RD



21RB

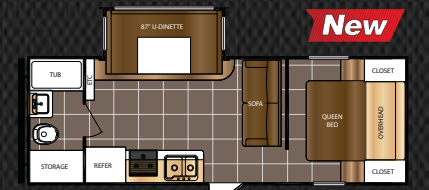

21RBS

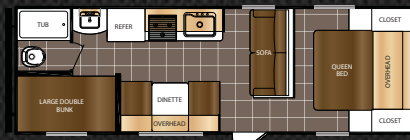

26BB

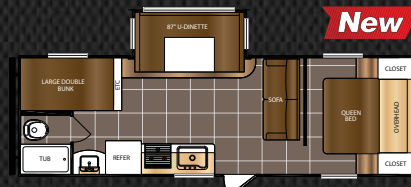

26BS



26BK



27DBS

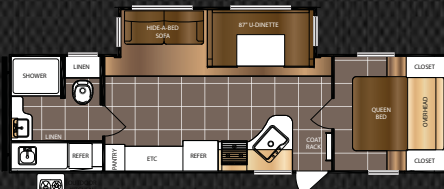

27RBS

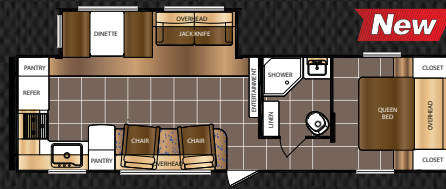

27RKS

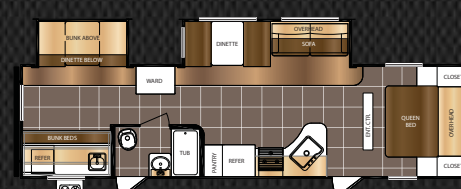

32BS



UVW (Unloaded Vehicle Weight)* is the typical weight of the unit as manufactured at the factory. It includes all weight at the unit's axle(s) and tongue or pin and LP Gas. The UVW does not include cargo, fresh potable water, additional optional equipment or dealer installed accessories. *Estimated Average based on standard build optional equipment.

CCC (Cargo Carrying Capacity)** is the amount of weight available for fresh potable water, cargo, additional optional equipment and accessories. CCC is equal to GVWR minus UVW. Available CCC should accommodate fresh potable water (8.3 lbs per gallon). Before filling the fresh water tank, empty the black and gray tanks to provide for more cargo capacity. ** Estimated average based on standard build optional equipment. See back page for additional specification definitions.

SPECIFICATIONS	17BH	17QB	20RD	21RB	21RBS	26BB	26BS	26BK	27DBS	27RBS	27RKS	32BS
LENGTH	21' 8"	21' 4"	24' 11"	26' 9"	27' 7"	28' 11"	30' 5"	28' 11"	32' 11.5"	32' 11"	32' 11"	35' 11"
HEIGHT	10' 2"	10' 2"	10' 3"	10' 3"	10' 8"	10' 3"	10' 8"	10' 3"	10' 8"	10' 8"	10' 8"	11' 4"
HITCH WEIGHT	416 lb.	441 lb.	510 lb.	587 lb.	790 lb.	552 lb.	658 lb.	474 lb.	721 lb.	765 lb.	681 lb.	831 lb.
UNLOADED VEHICLE WEIGHT (UVW)	3,250 lb.	3,176 lb.	4,256 lb.	4,499 lb.	5,294 lb.	4,680 lb.	5,626 lb.	4,680 lb.	6,652 lb.	6,663 lb.	6,586 lb.	7,563 lb.
CARGO CARRYING CAPACITY (CCC)	628 lb.	727 lb.	3,326 lb.	3,050 lb.	2,496 lb.	2,834 lb.	2,032 lb.	2,834 lb.	2,869 lb.	2,902 lb.	2,895 lb.	2,030 lb.

AVENGER STANDARDS & OPTIONS

- AVENGER ADVANTAGE PACKAGE
- “EVERGREEN” Select Luxury Mattress
 - Double Door Refrigerator
 - Carousel Microwave
 - Ducted A/C With Directional Vents
 - Deluxe Power Awning with LED Lights
 - 6 Gallon Gas/Electric DSI Water Heater
 - 18 Gallon/HR Quick Recovery Mode For Water Heater
 - Water Heater Bypass
 - Exterior Shower With Hot/Cold Water
 - EZ Winterization Kit
 - Thermal Package Plus
 - Enclosed Underbelly
 - Enclosed Heated Holding Tanks (N/A 18TH, 21TH, 25TH)
 - Extended Season Enjoyment
 - “E-Z LUBE” Axles
 - Tub Surround
 - Radial Tires
 - Coach-Net® 24 HR Roadside Assistance
 - Aluminum Rims

- CONSTRUCTION
- Cambered High Strength Alloy Steel Frame
 - 8’ Exterior Width
 - Aluminum Exterior Skin
 - R-7 Insulation Throughout
 - 2 x 3 Floor Joists On 16” Centers
 - 5/8” Seamless Floor Decking With 25 Year Warranty

- 5” Snow Load Roof Rafters on 16” Centers
 - Walk-On Roof With 3/8” Roof Decking
 - One Piece TPO Roof
 - PEX Plumbing System
 - Upgraded Oetiker Water Line Fittings
 - EVERLAST® CONSTRUCTION
 - 2” Wall Construction On 16” Centers
 - Cross Banded Construction
- BEDROOM
- Residential Bed Spread
 - Bunk Mats (*Where Applicable*)
 - Bedroom TV Cable/Antenna Connection
 - Dual Shirt Closets (N/A 18TH, 32FBI, 33RET)
 - Massive Under Bed Storage
 - Bed Platform Prop For Ease of Access
 - Extra Large Overhead Cabinets Above Bed

- INTERIOR STANDARDS
- Oversized MAX Slide
 - Massive 87” U-Shape Dinette on MAX Slide Models (N/A 32RED, 33RCI)
 - Deep Overhead Cabinets In MAX Slide
 - Fully Vented Windows In MAX Slide
 - Pleated Shades In Living & Dining Room (N/A 18TH, 21TH, 25TH, 22RB, 26BH)
 - Mini Blinds In Living & Dining Room (18TH, 21TH, 25TH, 22RB, 26BH)
 - Predrilled And Screwed Cherry Finish Cabinetry

- Solid Wood Core Cabinets
- Extended Ball Bearing Drawer Glides
- Residential HAB Sofa (*All Slide Models*)
- Residential Grade Carpet in Select Areas
- 82” Interior Ceiling Height
- Seamless Residential Countertops

- EXTERIOR STANDARDS
- Solar Prep
 - Black Tank Flush
 - 4 Heavy Duty Stabilizer Jacks
 - Extended Drip Spouts
 - Black Framed Radius Windows with Deep Tint
 - DOT Approved Safety Glass Windows
 - Fully Vented Windows Throughout
 - Dual LP Bottles
 - City Water Fill
 - Gravity Fresh Tank Fill
 - Color Coordinated Front With Diamond Rock Guard
 - Outside Shower
 - Radial Tires
 - Marine Grade Outdoor Speakers
 - Radius Entrance Door With Window
 - Bumper With Sewer Hose Storage And End Caps
 - Large Entry Door Grab Handle
 - Outdoor Kitchen (30QBS, 31DBS, 31RKD, 32BIT, 32FBI, 32QBI, 33RCI)

- APPLIANCES and EQUIPMENT
- Exterior TV Coax Connection
 - Cable TV Hook-Up With RG6 Coax
 - Digital TV Antenna With Signal Booster
 - AM/FM/CD/DVD with Bluetooth
 - 13,500 BTU Air Conditioner
 - 3 Burner Range With High Output Front Burner
 - Large Oven
 - Range Hood With Light And Exhaust Fan
 - High Capacity Furnace
 - In Floor Ducted Heat
 - Auto Ignition Furnace With Wall Thermostat
 - Systems Monitor Panel
 - 12V Electrical System With 55AMP Power Converter
 - 110V GFCI Protected
 - 12V High Capacity Water Pump
 - 30AMP Power

- KITCHEN
- Deep Single Bowl Sink
 - High Rise Kitchen Faucet
 - Spice Rack Valance (N/A Island Kitchen Models)
 - Pot and Pan Drawer Under Stove
 - Pan Drawer Under Refrigerator (N/A Island Kitchen Models, 32RED)

- BATHROOM
- Shower Curtain With Curved Track

- Glass Neo Angle Shower (*Select Models*)
- 12V Power Vent Fan
- Medicine Cabinet With Mirror

- SAFETY EQUIPMENT OWNER PROTECTION
- CO Detector
 - LP Detector
 - Fire Extinguisher
 - Smoke Alarm
 - Dual Hitch Safety Chains
 - Leak-Guard Assurance Process

- POPULAR OPTIONS
- 15,000 BTU Air Conditioner
 - Sleep & Play Sofa (32BIT, 32QBI Only)
 - Free Standing Dinette & 4 Chairs (32RED, 33RCI Mandatory. N/A 18TH, 21TH, 25TH, 22RB, 26BH)
 - Flat Screen Television (28RKS, 32RED, 33RET, 33RCI Mandatory)
 - Spare Tire With Cover
 - 50AMP Service, Wired & Framed For 2nd A/C (33RET Mandatory. N/A 18TH, 21TH, 25TH, 22RB, 26BH)

- TANK CAPACITY
- FRESH WATER: 48 Gallons
 - GREY WATER: 30 Gallons*
 - BLACK WATER: 30 Gallons*

**Some models vary. See website for additional details.*

AVENGER ATI STANDARDS & OPTIONS

- AVENGER ADVANTAGE PACKAGE
- “EVERGREEN” Select Luxury Foam Mattress
 - Refrigerator
 - Carousel Microwave
 - Deluxe Patio Awning
 - 6 Gallon Gas DSI Water Heater
 - “E-Z” Lube Axle
 - Radial Tires
 - Coach-Net® 24 HR Roadside Assistance

- CONSTRUCTION
- Cambered High Strength Alloy Steel Frame
 - Aluminum Exterior Skin
 - R-7 Insulation Throughout
 - 2 x 3 Floor Joists On 16” Centers
 - 5/8” Seamless Floor Decking With 25 Year Warranty
 - 5” Snow Load Roof Rafters On 16” Centers
 - Walk-On Roof With 3/8” Roof Decking
 - One Piece TPO Roof
 - PEX Plumbing System
 - Upgraded Oetiker Water Line Fittings

- EVERLAST® CONSTRUCTION
 - 2” Wall Construction on 16” Centers
 - Cross Banded Construction

- EXTERIOR STANDARDS
- Exterior Shower (N/A - 17BH, 17QB)
 - 4 Stabilizer Jacks
 - Extended Drip Spouts
 - Black Framed Radius Windows With Deep Tint
 - DOT Approved Safety Glass Windows
 - Fully Vented Windows Throughout
 - LP Bottle
 - City Water Fill
 - Gravity Fresh Tank Fill
 - Color Coordinated Front With Diamond Rock Guard
 - Radius Entrance Door With Window
 - Solar Prep

- INTERIOR STANDARDS
- Mini Blinds Throughout
 - Predrilled And Screwed Cherry Finish Cabinetry
 - Solid Wood Core Cabinets

- APPLIANCES/EQUIPMENT
- Cable TV Hook-Up With RG6 Coax
 - Digital TV Antenna With Signal Booster
 - AM/FM/CD Radio
 - 13,500 BTU Air Conditioning
 - 2 Burner Range With High Output Front Burner (17BH,17QB)
 - 3 Burner Range With High Output Front Burner (N/A - 17BH,17QB)
 - Range Hood With Light And Exhaust Fan
 - 3 Cubic Foot Dometic® Refrigerator (17BH,17QB)
 - Large Double Door Refrigerator (N/A - 17BH,17QB)
 - 6 Gallon DSI Gas Water Heater
 - Water Heater Bypass

- EZ Winterization Hookup
- Auto Ignition Furnace With Wall Thermostat
- Systems Monitor Panel
- 110V GFCI Protected
- 12V High Capacity Water Pump
- 30AMP Power

- BATHROOM
- Shower Curtain With Curved Track

- KITCHEN
- Deep Bowl Kitchen Sink

- SAFETY EQUIPMENT
- CO Detector
 - LP Detector
 - Fire Extinguisher
 - Leak Guard Assurance Process
 - Smoke Alarm

- OPTIONS
- Spare Tire With Cover
 - 15K A/C (27DBS, 27RBS, 27RK, 32BBS Only)
 - Power Awning (Mandadory)
 - 50” TV (Mandatory: 27DBS, 27RBS, 27RKS, 32BBS)
 - Free Standing Table and Chairs (27RBS, 27RKS)

- TANK CAPACITY
- FRESH WATER: 48 Gallons
 - GREY WATER: 30 Gallons*
 - BLACK WATER: 30 Gallons*

**Some models vary. See website for additional details.*

TOURING EDITION 7.0

**LIMITED
TIME OFFER**

See your local dealer for details and availability of Touring Edition 7.0.

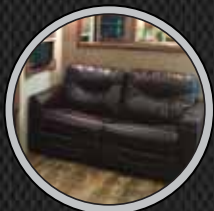

**RESIDENTIAL
FURNITURE**

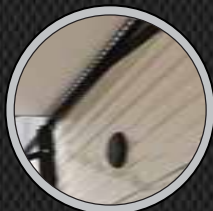

**LED LIGHTED
AWNING**



ALUMINUM RIMS



**FLUSH MOUNT
GLASS STOVE TOP**



**EXTRA LARGE
GRAB HANDLE**



**DVD WITH
BLUETOOTH**



ELECTRIC AWNING



**LED INTERIOR
LIGHTING**



BLACK TANK FLUSH



**NEW SOLAR
PREP**



Extended Drip Spouts



Exterior TV Hook-Ups



**82" Interior height with the MAX
Slide at nearly 6 ft. WOW!**



Enclosed Underbelly



87" U-Shaped Dinette



**MAX Slide Features a
Residential Hide-A-Bed Sofa**



Avenger Has Ducted Heat & Air



**18 Gallon/HR Water
Heater Recovery**



Dual Pots-N-Pans Drawers



Easy Access Low Point Drains



Pocket Screwed Cabinets



Outside Shower

DSI QUALITY CIRCLE AWARD

Prime Time Manufacturing is proud to be recognized as an industry leader in value, reliability, and overall quality by the Recreational Vehicle Dealers Association. This was accomplished by committing ourselves to "A Higher Standard" in design, construction, testing, and customer service. Check us out – we know you'll be impressed!



www.primetimerv.com
PO Box 330 • 55470 CR 1 • Elkhart, IN 46515



**FROG™ the Forest
River Owners' Group!**

FREE MEMBERSHIP
to Forest River Owners' Group
www.forestriverfrog.com



Seal Tech Air Pressure Test



EVERLAST® Cross
Banded Construction



Advanced Engineering

CUSTOMER SATISFACTION



www.ForestRiverBuyLocal.com

24/7 EMERGENCY ROADSIDE ASSISTANCE

For a worry-free ownership experience Forest River includes one year of Coach-Net RV Technical & Roadside Assistance with each RV purchase. Whether new to the RV lifestyle or an experienced RV enthusiast, Forest River owners have 24/7 access to technical, operational and emergency road service coverage throughout the US & Canada. Coach-Net's fast, dependable service is just a phone call away.

Coach-Net®

RV Technical & Roadside Assistance



65 Point
Secondary PDI



ADDITIONAL SPECIFICATIONS:

GVWR (Gross Vehicle Weight Rating) - is the maximum permissible weight of the unit when fully loaded. It includes all weights, inclusive of all fluids, cargo, optional equipment and accessories. For safety and product performance do NOT exceed the GVWR.

GAWR (Gross Axle Weight Rating) is the maximum permissible weight, including cargo, fluids, optional equipment and accessories that can be safely supported by a combination of all axles.

Each Forest River RV is weighed at the manufacturing facility prior to shipping. A label identifying the unloaded vehicle weight of the actual unit and the cargo carrying capacity is applied to every Forest River RV prior to leaving our facilities. The load capacity of your unit is designated by weight, not by volume, so you cannot necessarily use all available space when loading your unit.



PRE-DELIVERY INSPECTION FACILITY

20,000 square feet of quality assurance. The bare essentials for a premium product. This state-of-the-art facility gives immediate daily feedback to production for quality assurance in every unit built.



Seek-A-Leak
Pressure Test



Web Based
Customer Service



Executive Quality Audits



Rain Bay

All information contained in this brochure is believed to be accurate at the time of publication. However, during the model year, it may be necessary to make revisions and Forest River, Inc., reserves the right to make all such changes without notice, including prices, colors, materials, equipment and specifications as well as the addition of new models and the discontinuance of models shown in this brochure. Therefore, please consult with your Forest River, Inc., dealer and confirm the existence of any materials, design or specifications that are material to your purchase decision.

©2016 Prime Time Manufacturing, a Division Of Forest River, Inc., a Berkshire Hathaway Company. All Rights Reserved.



Learn More
Scan this barcode using a QR Reader on your smart phone to learn more about Forest River.



A Berkshire Hathaway company.

Colton RV
North Tonawanda, NY 14120
(716) 694-0188
(800) 628-4889
www.ColtonRV.com

Colton RV
Orchard Park, NY 14127
(716) 957-3250
(800) 628-4889
www.ColtonRV.com

DEALER